



GOOLOO G1500 Plus Multi Function Car Jump Starter User Guide

[Home](#) » [GOOLOO](#) » GOOLOO G1500 Plus Multi Function Car Jump Starter User Guide 

GOOLOO G1500 Plus Multi Function Car Jump Starter User Guide



Contents

1 INSTALLATION INSTRUCTION

2 Product Layout

3 Operation Guidance

4 Parts List

5 Technical Specification

6 Trouble Shooting

7 Toxic and Harmful Substances

8 FAQ

9 Q1: What is GOOLOO G1500-PLUS operating temperature and how to store it?

10 2: How to jump start a car with G1500-PLUS?

10.1 Documents / Resources

10.1.1 References

10.2 Related Posts

INSTALLATION INSTRUCTION

Thank you for choosing the GOOLOO! Always follow basic safety precautions when using electrical appliances. Read all instructions carefully. Please keep this instruction manual for easy reference.



www.gooloobox.com

Product Layout

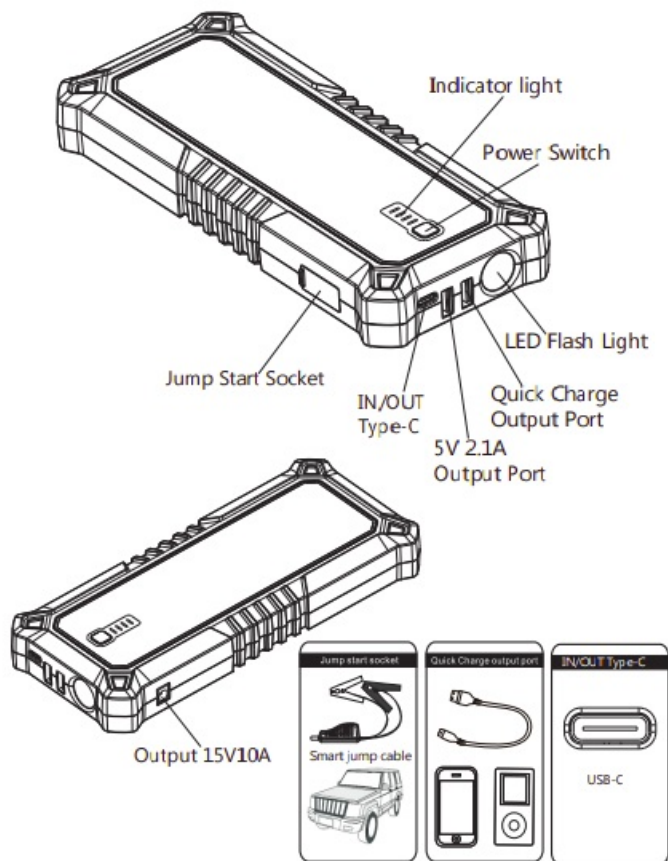

Operation Guidance

Indicator Light:

Press the switch to check the storage level:

Indicator	1 Flashing	1 Solid	2 Solid	3 Solid	4 Solid
Storage Level	0%	25%	50%	75%	100%

The indicator light will flash one by one during the period of charging. Different numbers of solid indicators show different storage level of G1500-PLUS. All indicators light will go off automatically, when the charging is paused or completed.

How to Charge

1. Connect the Type-C cable with a cigarette car adapter or a wall charger.
2. Connect the Type-C connector to the host. **(Note:** Both the car charger and home charger can charge the host. The car charger should be separately bought)

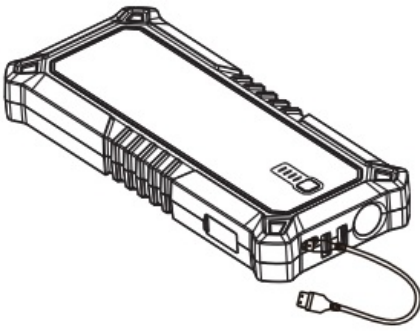

or

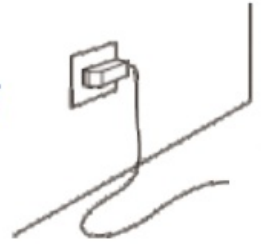

How to Jump Start a Vehicle Make sure it is over 60% charged. If have not use it more than two months, should charge it first.

1. Connect the smart cable plug to jump starter .

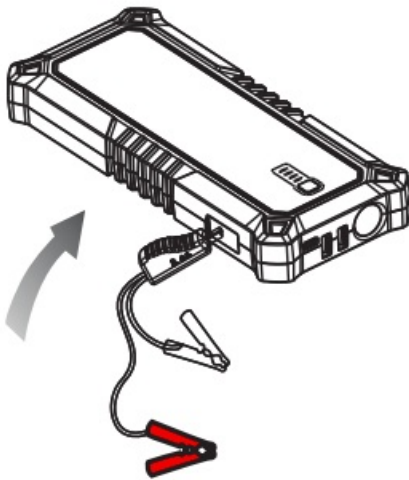

2. Red clamp connect "+", black clamp connect "-".

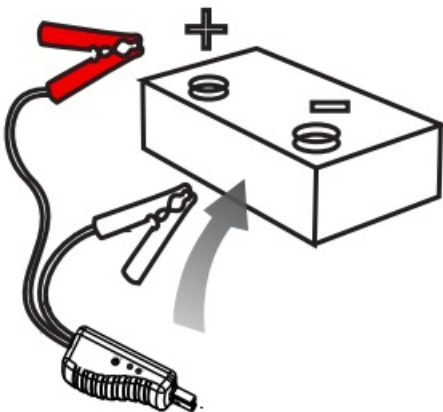

3. Start the vehicle.



START

4. Remove the plug from the jump starter.

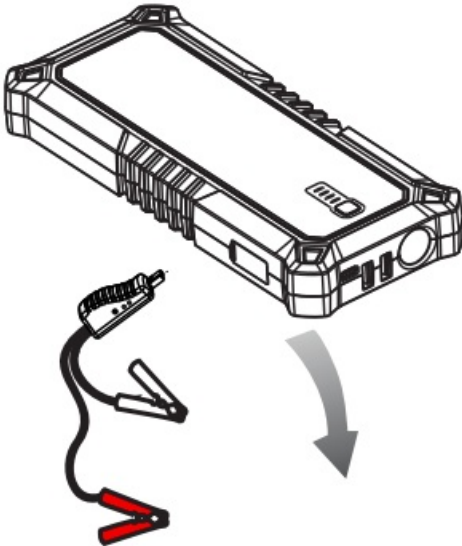

5. Remove the clamp from the battery.

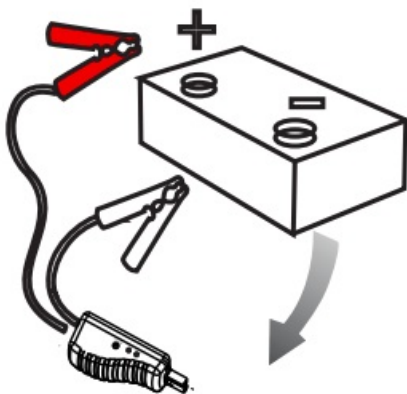

How to Use the Smart Cable

Connect the blue plug fully seated into the host, and make sure the Cable Indicator is off.

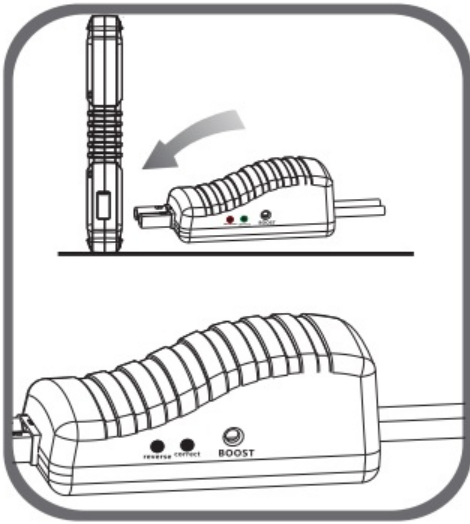

Operate following the instruction of the Cable Indicator

Green Light On:

The connection is correct and the circuit is working, you can turn on the engine to boost directly.

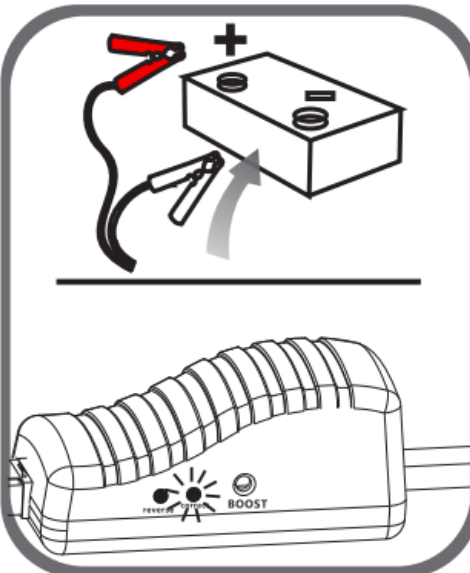

Red Light On with Buzzing:

The connection is wrong, DO NOT start the engine, and must reconnect it properly as step2 mentioned above, until the Green Light light.

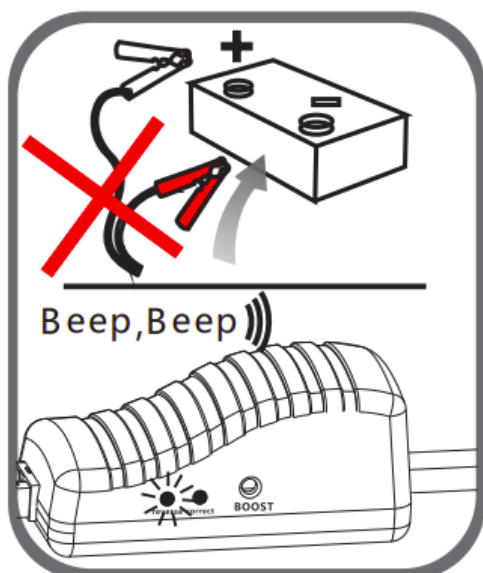

Green Light Blinking with Buzzing: The vehicle battery is low, press the “BOOST” button, wait for the Green Light stability, then start the engine within 30s.

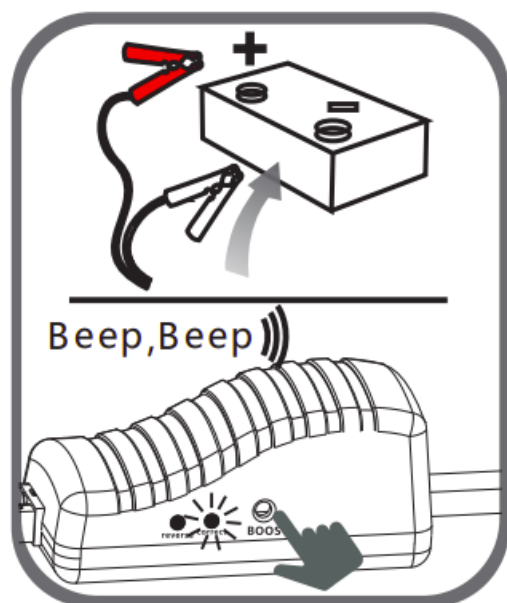

No Lights on, No buzzing:

The vehicle's battery maybe damaged, confirm the clamps connection, press the “BOOST” button, wait for the Green Light stability, then start the engine within 30s.

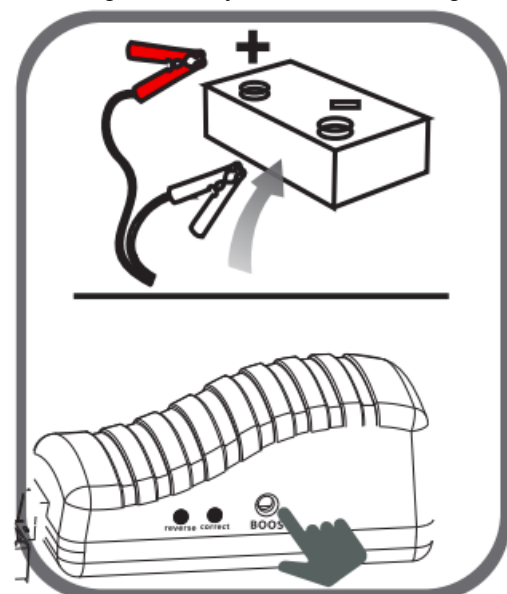

How to Switch the LED Light

Press slightly to switch 3 lighting mode: Flash light, Strobe light, SOS Signal flash.
Turn off the light also use this switch.
Press the LED Switch 3 seconds to start the LED light.

Parts List

#	Part Name	Quantity
1	Host	1
2	Type-C to Type-C cable	1
3	USB To Type-C Cable	1
4	Smart Jumper Cable	1
5	Wall Charger	1
6	Kit Bag	1
7	User Manual	1

Technical Specification

Input:	Type-C 60W Max (5V/3A, 9V/3A, 12V/3A, 15V/3A, 20V/3A)
Output:	Type-C 60W Max (5V/3A, 9V/3A, 12V/3A, 15V/3A, 20V/3A),Quick charge(5V/2.4A, 9V/2A,12V/1.5A),5V/2.1A,15V/10A
Capacity:	19800mah/73Wh
Starting Current:	500A
Peak Current:	1500A
Size:	228*99.5*33mm
Weight:	630g
Operating Temp.	-20°C —60°C/-4°F~140°F
Lifetime	>1000 cycles
Full Charging Time:	5-6Hours

Trouble Shooting

Finding

No response when pressing the switch button.

Cause

Low voltageprotec on is started

Remedies

Plug the adapter into input port to activate the device.

Toxic and Harmful Substacnes

Composition and amount of toxic or harmful substance in G1500-PLUS. Jump Start Socket

Pb	Hg	Cd	Cr(Vi)	PBB	PBDE
0	0	0	0	0	0

Indicate that the content of harmful substances in all homogeneous materials is all lower than the prescribed limit of MCV (the standard 2002/95/EC/RoHs)

FAQ

Q1: What is GOOLOO G1500-PLUS operating temperature and how to store it?

: The car jump starter G1500-PLUS is lithium-ion, operating temperature is -20~60°C/-4~140°F, if the ambient temperature is higher than 60°C/140°F, the internal instruction of lithium-ion cells will be changed, it may swell and will be unsafe. So DO NOT store it in car for long time, especially in summer.

2: How to jump start a car with G1500-PLUS?



Documents / Resources

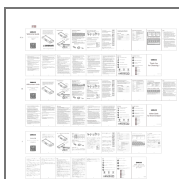

[GOOLOO G1500 Plus Multi Function Car Jump Starter](#) [pdf] User Guide
G1500 Plus Multi Function Car Jump Starter, G1500 Plus, Multi Function Car Jump Starter, Function Car Jump Starter, Car Jump Starter, Jump Starter, Starter

References

-  [Manual-Hub.com - Free PDF manuals!](#)
- [User Manual](#)

[Manuals+](#), [Privacy Policy](#)

This website is an independent publication and is neither affiliated with nor endorsed by any of the trademark owners. The "Bluetooth®" word mark and logos are registered trademarks owned by Bluetooth SIG, Inc. The "Wi-Fi®" word mark and logos are registered trademarks owned by the Wi-Fi Alliance. Any use of these marks on this website does not imply any affiliation with or endorsement.