

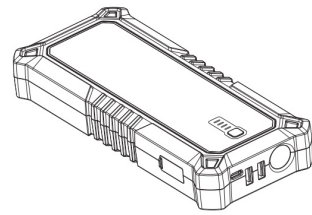

**GOOLOO 3000A
Portable Lithium
Jump Starter**



GOOLOO 3000A Portable Lithium Jump Starter User Manual

[Home](#) » [GOOLOO](#) » GOOLOO 3000A Portable Lithium Jump Starter User Manual 

Contents

- 1 [GOOLOO 3000A Portable Lithium Jump Starter](#)
- 2 [Product Information](#)
- 3 [Parts and Functional Description](#)
- 4 [Operation Instructions](#)
- 5 [How to Start a Vehicle](#)
- 6 [How to Use the Smart Cable](#)
- 7 [How to Charge Your Phone or Tablet](#)
- 8 [How To Turn On/Off The LED Flashlight](#)
- 9 [Product Highlights](#)
- 10 [Package Content](#)
- 11 [Technical Specification](#)
- 12 [Trouble Shooting](#)
- 13 [Toxic and Harmful Substances](#)
- 14 [Your Warranty Includes](#)
- 15 [Disclaimer](#)
- 16 [Customer Service](#)
- 17 [FAQ](#)
- 18 [Documents / Resources](#)
 - 18.1 [References](#)



GOOLOO 3000A Portable Lithium Jump Starter

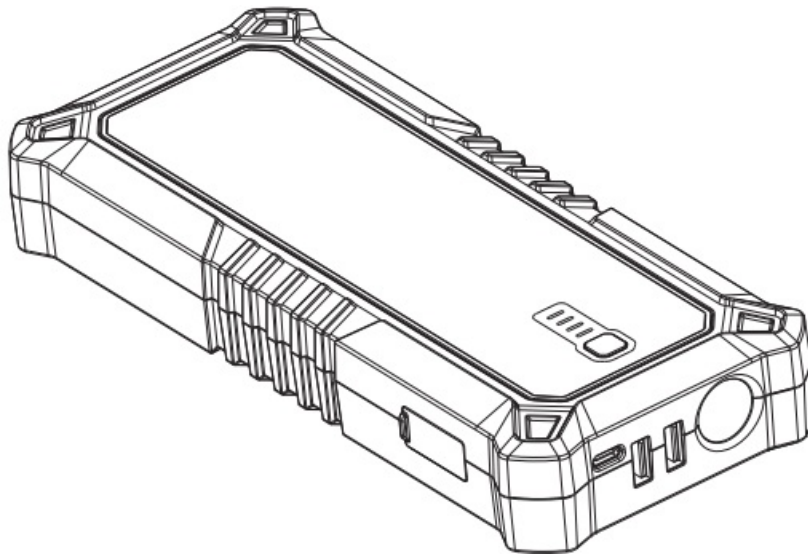

Product Information

- Model: S2H2A
- Power Source: Lithium-based battery
- Temperature Range: Up to 60°F (14°C)
- Warranty: 30 days

Thank you for choosing GOOLOO jump starter. To ensure a good user experience, personal safety, and property security, please read all of the instructions carefully before using this product, please keep this manual for easy reference.

Charge It First!

While reading through the manual, you can begin to charge up your GP3000 with your mobile phone charger and the type-c cable attached.

Parts and Functional Description

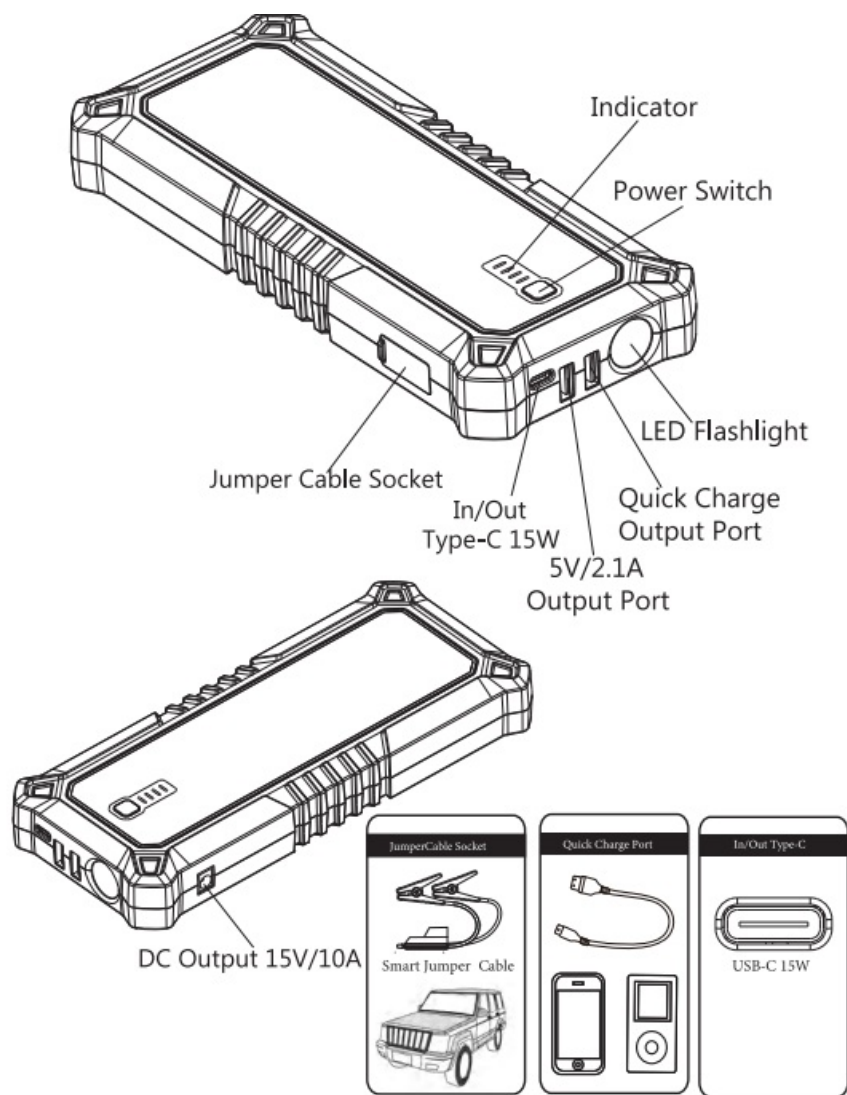

Operation Instructions

Battery Indicator :

Press the power switch to check the battery power:

Indicator	Unlit	1 Solid	2 Solid	3 Solid	4 Solid
Battery Power	0%	25%	50%	75%	100%

The indicator will blink one by one during the period of charging. Different numbers of solid indicators show different battery power. All indicators will be turned off automatically when the charging process has finished.

How to Charge the GP3000

This unit can be charged with a type-c cable attached and a 5V wall charger(phone charger) or car charger. (Note: SV wall charger and car charger is not included)

(Only via the QC3.0 wall charger or car charger can achieve the quick charge input function, QC3.0 wall charger and car charger can be purchased separately.)

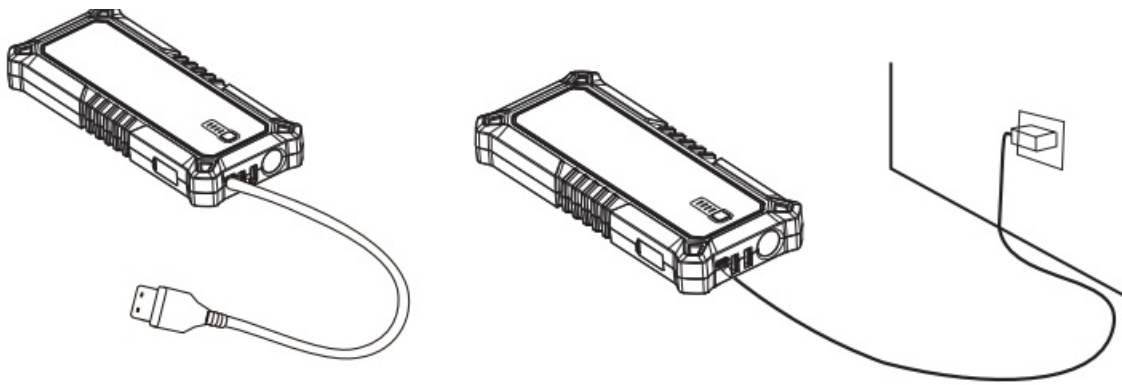

How to Start a Vehicle

Make sure this unit is over 50% charged (check the battery indicator > 2 bars). If this unit has not been used in more than two months, you should charge it first.

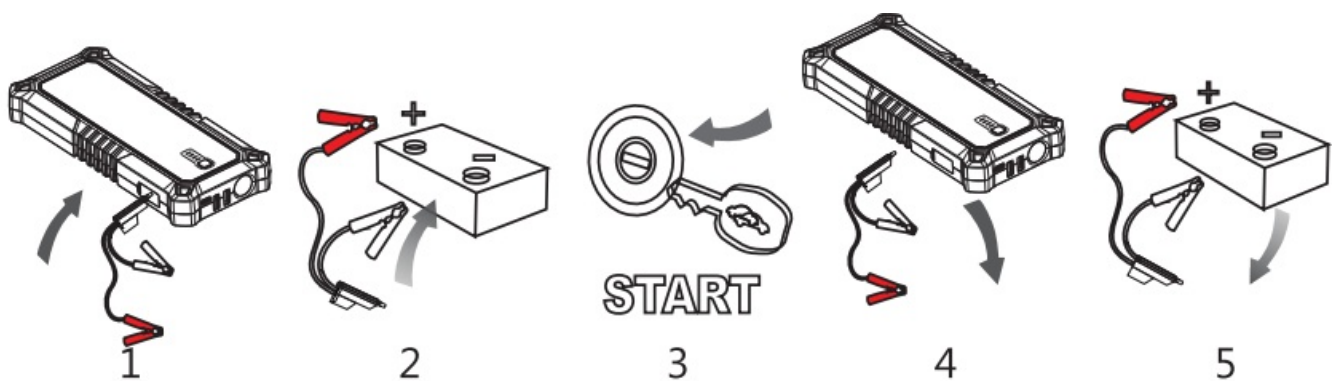

How to Use the Smart Cable

1. First, plug the blue connector of the intelligent battery clamp into the main unit, ensuring that the clamp's indicator light is off.
2. Next, correctly connect the battery clamp to the positive and negative terminals of the car battery. Attach the red clamp to the positive terminal (+) and the black clamp to the negative terminal (-).
3. Then, follow the corresponding operation based on the battery clamp's indicator light:

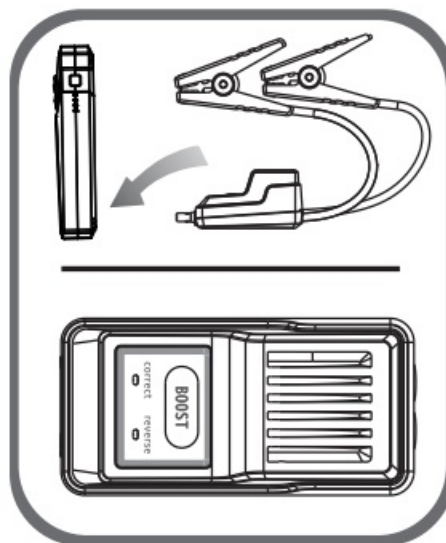

- Solid green light: This indicates that the connection is correct and powered on. You can now proceed with the emergency jump-start.

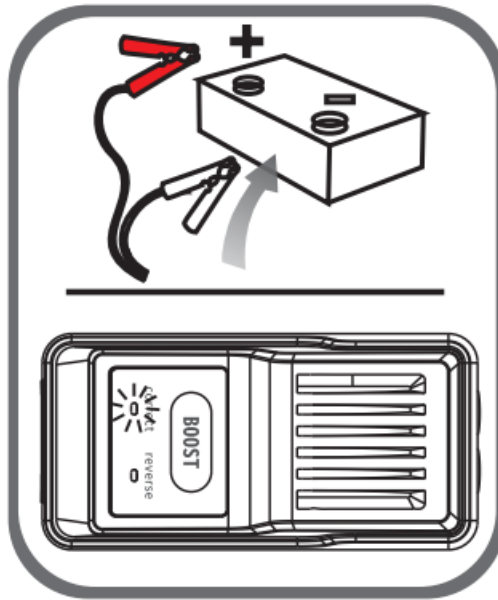

- Solid red light: This indicates that the positive and negative terminals are incorrectly connected. Please reconnect them correctly, and once the green light turns solid, proceed with the emergency jump-start.
 - Flashing green light: This indicates that the battery voltage is too low. Press the BOOST button, and once the green light turns solid, complete the jump-start within 30 seconds.
 - No red or green light: This may indicate that the battery is completely damaged. Ensure the positive and negative terminals are correctly connected, then press the BOOST button.
- Once the green light turns solid, complete the jump-start within 30 seconds.

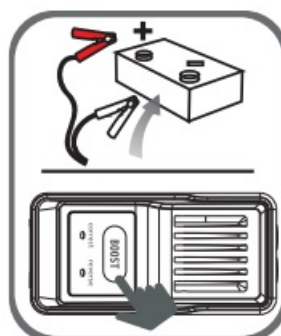
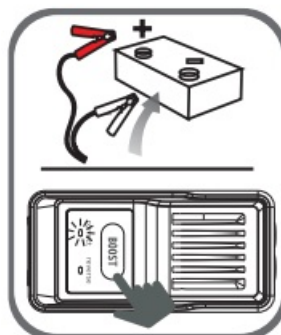
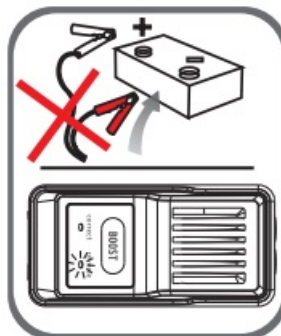

15V/10A DC Output (12-16.SV,IS0W Max)

cigarette Lighter Socket Output

Connect the 12V devices that need to be powered by a cigarette lighter socket (the Cigarette Lighter Socket Adapter is not included).

5.5*2.1mm DC Output

You can connect the 12V devices that need to be powered by the 12V DC port. Please check if the devices support 12V DC input (the diameter of the DC port is 5.5*2.1mm) . If not, you will not be able to use the DC output.

Protection Mode

Short Circuit /Overload Protection: If the 15V/10A DC port is short-circuited or overloaded (load power> 150W), this unit will shut off automatically for self-protection. Resolve short circuit or overload problems and recharge this unit to reset from protection mode.

How to Charge Your Phone or Tablet

1. Plug the charging cable into USB-A port and your devices.
2. Press the power switch, the unit can identify your device and charge it automatically. The battery indicators will be lit up when charging.

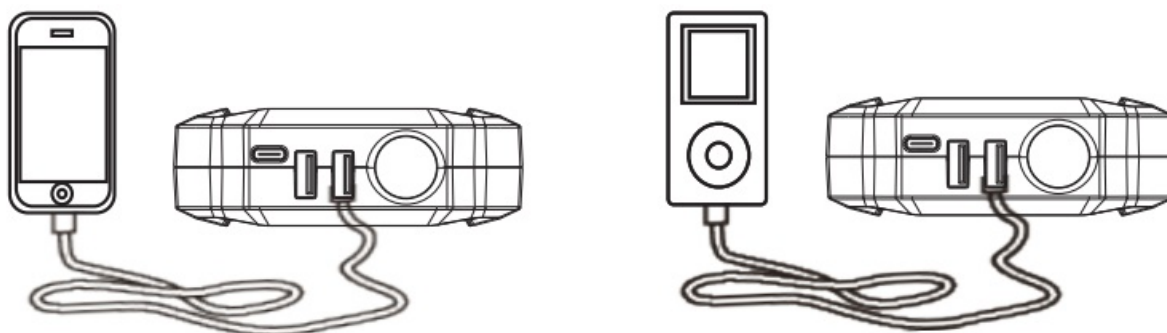

How To Turn On/Off The LED Flashlight

Long press the power switch 3 seconds to start the LED light. There are 3 modes of LED light appear in order (Normal, Strobe, SOS, Off) if you press slightly.

Product Highlights

- Starts Most Dead Car Batteries: GOOLOO GP3000 Jump Starter is powerful enough to start your vehicle quickly and easily (up to 9.0L Gasoline Engine/7.0L Diesel Engine) with heavy duty jumper clamps (included). Even if the battery voltage is low or there is no battery, pressing the “BOOST” button will force the car to restart. What’s more, it can even work in extreme climates -4-140 °p.
- Portable Power Supply: More than a car battery charger, the GP3000 jump starter includes three USB Ports (15W TYPE-C, USB 5V/9V/12V Quick Charge, USB SV / 2.1A).
- Safe and Secure: SUPERSAFE is a safety protection technology by GOOLOO, which automatically detects reverse polarity to ensure a precise connection before providing power to most automotive batteries or electrical devices.
- Compatible with Most 12V Car Types: The GP3000 jump starter is suitable for trucks, motorcycles, boats,

yachts, lawnmowers, ATVs, SUVs, snowmobiles, pickups, and more. If your car will not start do not call a tow truck service or wait on the side of the road for help. Use these tools to start your car battery in a matter of seconds.

- Ergonomic Design with Multi-Features

GOOLOO GP3000 jump starter is lightweight, easy to carry, and includes an integrated LED super bright work light with three lighting modes (flashlight, SOS, strobe), providing maximum convenience and flexibility.

- Affordable and Powerful

Get an all-in-one car starter, power bank, LED flashlight at an affordable price

Package Content

#	Part Name	Quantity
1	Host	1
2	Cloth bag	1
3	USB to Type-C Cable	1
4	Type-C to Type-C Cable	1
5	Smart Jumper Cable	1
6	User Manual	1

Technical Specification

Input :	Type-C 15W(SV/3A)
Output:	Type-C 15W(SV/3A), Quick Charge (SV/2.4A,9V/2A, 12V/1. SA), SV/ 2.1 A,15/ 1 0A
Capacity:	59.2Wh
Starting Current:	600A
Peak Current:	3000A
Size:	228* 99.5*33mm
Weight:	630g
Operating Temp:	-20°C~60 °C/ -4 °F~14 0°F
Lifetime :	> 1000 cycles
Full Charging Time:	5-6 Hours (5V/3A)

Trouble Shooting

TROUBLE	REASON	REMEDIES
It has charged for a long time, but the fourth battery indicator is still blinking.	Battery power recognition problem.	Disconnect the charging cable and plug it in again, try to continue charging for hours.
No response when pressing the power switch.	Low voltage protection is started.	Try to charge the unit with wall charger to activate it.
This unit can not be charged, the first battery indicator blinks all the time.	The unit is over discharged or defective	Please contact us at fiona@gooloo.com
This unit is overheated or swelled.	The unit is over discharged or defective	Please contact us at fiona@gooloo.com

If there is any other problem with this unit, please contact us directly at fiona@gooloo.com, we will do our best to solve the problem within 24 hours.

Toxic and Harmful Substances

Composition and amount of toxic or harmful substance in this product

Pb	Hg	Cd	Cr(Vi)	PBB	PBDE
0	0	0	0	0	0

0: Indicate that the content of harmful substances in all homogeneous materials is all lower than the prescribed limit of MCV (the standard 2002/95/EC/RoHs)

Warning

1. Read this instruction manual carefully before using this unit.
2. Use caution while using this unit. Injury to self, or damage to the unit or the vehicle battery if precautions are not followed.

3. Do Not allow to use by persons who do not have proper knowledge or ability to operate the device without supervision.
4. Do Not use as a toy. Keep the unit away from children to avoid accident.
5. This unit is for 12V vehicles only, it may not be suitable for other vehicles. It is forbidden to use for other machines such as aircraft, boats, etc.
6. Do Not use this unit if any cable, clamp, or cord is damaged or if the unit is overheated or swelled or leaking fluid.
7. Do Not use in place of a vehicle battery or as a vehicle battery charger.
8. Do Not use the unit to start a vehicle while charging the internal battery.
9. Only use the jumper cable attached and use the correct and qualified charger to charge this unit.
10. Do Not let this unit over-discharge (do not let the battery run to empty), please charge it regularly; it would be best to recharge it every 3 months.
11. Make sure the blue plug of the jumper cable is plugged fully into the jumper socket; otherwise, the blue plug could melt.
12. Make sure the battery terminal are clean before starting, and make sure the battery clamps are well connected. If the battery terminals on the vehicle are dirty or corroded, the output power of the unit will be lessened.
13. Do Not connect the two clamps together.
14. Do Not connect the jump starter's clamps to the battery reversely while pressing the "BOOST" button to avoid accident.
15. Only use this unit to start the vehicle when the battery indicator is more than 2 bars.
16. Do Not keep the unit connected to the vehicle battery after successfully starting the engine. Remove the product from the vehicle battery after starting the engine. If not, it could lead to damage.
17. Do Not recharge this product immediately after using it to start the vehicle, please cool it down for 30 minutes before charging.
18. Do Not allow the product to become wet and Do Not immerse in water.
19. Do Not operate the product in explosive atmospheres, such as in the presence of flammable liquids, gases, or dust.
20. Do Not modify or disassemble the unit. Only a repair technician may repair this unit.
21. Do Not expose product to extreme heat or fire.
22. Do Not drop or crush the unit. If the unit has received a sharp blow or is damaged in any other way, a qualified battery technician should check it.
23. Do Not store in locations where the temperature may exceed 60°C/140°F.
24. Charge only at ambient temperature between -10~45°C /14~113°F
25. Under extreme conditions, the battery may leak. If a liquid is leaking from the unit, Do Not handle with bare hands. In case of skin contact wash with soap and water immediately. If the liquid contacts to eyes, rinse eyes with cold running water for at least 10 minutes and get medical treatment immediately.
26. The unit contains lithium-based batteries. At end of the product life, or if the unit is leaking liquid, dispose the unit according to local regulation.

Your Warranty Includes

18 Months Online After-sales service

Within 18 months, we will provide timely and effective online after-sales service after your purchase.

30 Days Money Back Guarantee

Within the first 30 days after your purchase, you can apply return for it when you have any issues.

Disclaimer

- A. The warranty is valid upon presentation of the original receipt (Order ID)by the original purchaser with the product need to be repaired or replaced.
- B. The warranty does not cover damage or product failure resulting from normal wear and tear, physical abuse, improper installation, misuse, modification or repairs by unauthorized third parties.
- C. We are not liable for any incidental or consequential damage that arises from incorrect use or misuse of this product.
- D. All warranty claims are limited to repair or replacement of the defective product and at the sole discretion of GOOLOO.

Attention



Do Not Submerge In Water



Do Not Disassemble



Do Not Drop



Avoid Extreme Temperatures



Do Not Place Near or Into Fire



Overcharge/discharge
Protection



Fuse Protection



Against-reverse
Plug

Customer Service

- 18 Months Limited Warranty Service;
- Lifetime Technical Service

- Feel Free to Contact Us
fiona@gooloo.com (US Recommend) Support.eu@gooloo.com (EU Recommend)
- For FAQ and More Information
www.gooloo.com
- 1-888-886-1805
Mon.-Fri. PST 9:00a.m.-5:00p.m.

Manufacturer	Shenzhen Carku Technology Co.,Ltd		
Address	No.103, block A, Qixing Creative factory, GaoFeng community, Dalang street, LongHua, Shenzhen, Guangdong, China		
Importer	shen zhen shi lan de wo ke ji you xian gong si		
Address	Guangdong, Shenzhen, Longgang, 2nd Floor, Building 12, Shenao Cultural Industry Park, Dafapu Community, Bantian Street		
Tel	+442921680945		
UK Representative Name and contact	<table border="1"> <tr> <td>UK</td><td>REP</td></tr> </table> EVATOST CONSULTING LTD Office 101 32 Threadneedle Street, London, United Kingdom, EC2R 8AY OST_UK_20220608000011 contact@evatost.com <small>We simply act as UK representative for cross-border sellers, and are not manufacturers/importers/distributors for the product, nor involved in the manufacture/import/sale of the product. Therefore, we are not responsible for any after-sales services related to the product. In case of any product quality or infringement issues, the manufacturer/importer/seller shall be solely held responsible.</small>	UK	REP
UK	REP		

Office 101 32 Threadneedle Street, London, United Kingdom, EC2R 8AY contact@evatost.com

FAQ

- **Q1: What is the operating temperature of this unit and how to store it?**

A: This unit is lithium polymer battery, operating temp is -20-60 °C/ -4-140°F. If the ambient temperature is higher than 60°C/140°F, the internal construction of the polymer lithium-ion cells will be damaged, it may swell and become unsafe. So don't store the device in vehicle which parked in hot weather for long periods of time.

- **Q2: How to start a vehicle with this unit?**

A: Please refer to the instructions about "How to Start a 12V Vehicle."

- **Q3: How do you know if this unit is connected to the vehicle correctly?**

A: With the battery clamps connected to the vehicle battery, when the indicator on the jumper cable shines a steady green light, it means it's connected correctly. If red light is on and solid, it means it's reverse connection.

- **Q4: What should I do if this unit can't start a vehicle?**

A: Recharge this unit fully, and try to press the "BOOST" button on the jumper cable, wait the GREEN LIGHT on and solid, then start the vehicle within 30s. If it still does not work, contact us at: fiona@gooloo.com (Attach your order ID).

- **Q5: What should I do if this unit can't be charged?**

A: Charge it with a USB-C cable and 5V wall charger to activate it. If it still does not work, contact us at fiona@gooloo.com (Attach your order ID.).

- **Q6: What should I do if this unit can't charge other devices?**

A: Try to use another charging cable to charge it again. If it can charge with another one, the charging cable attached is defective; Contact us we will provide you a new one. If it still does not work, email us at: fiona@gooloo.com (Attach your order ID).

- **Q7: How to turn off this unit?**

A: The unit will be turned off automatically in 30 seconds when it has no load

- **Q8: Can this unit charge other devices while it is being charged?**

A: Yes.

- **Q9: Can this unit charge other devices while starting a vehicle?**

A: No.

- **Q10: How often does this unit need to recharge?**

A: It would be best to be recharged every 3 months.

- **Q11: Why it shuts off in 30s when charging for other devices?**

A: This product may not be able to charge for devices that need weak current like iphone 6 series, headphones, smart watch,etc. Because this unit has a minimum load current (200mA). it will be automatically off after 30s if the load current is less than 200mA.

Documents / Resources

 <p>The image shows the cover of the user manual for the Gooloo 3000A Portable Lithium Jump Starter. It features the Gooloo logo at the top, followed by the text 'User Manual Jump Starter 3000A'. Below this is a photograph of the device, which is a rectangular, silver-colored unit with a black handle and red and blue clamps. The model number 'GP3000' is printed at the bottom.</p>	<p>GOOLOO 3000A Portable Lithium Jump Starter [pdf] User Manual 3000A Portable Lithium Jump Starter, 3000A, Portable Lithium Jump Starter, Lithium Jump Starter, Jump Starter, Starter</p>
---	--

References

- [User Manual](#)

[Manuals+](#). [Privacy Policy](#)

This website is an independent publication and is neither affiliated with nor endorsed by any of the trademark owners. The "Bluetooth®" word mark and logos are registered trademarks owned by Bluetooth SIG, Inc. The "Wi-Fi®" word mark and logos are registered trademarks owned by the Wi-Fi Alliance. Any use of these marks on this website does not imply any affiliation with or endorsement.