



# GOODWE LX F6.6-H Rechargeable Lithium Ion Battery System Installation Guide

[Home](#) » [GOODWE](#) » GOODWE LX F6.6-H Rechargeable Lithium Ion Battery System Installation Guide 

GOODWE LX F6.6-H Rechargeable Lithium Ion Battery System



## Contents

### 1 Safety Precaution

- 1.1 General Disclaimer
- 1.2 Safety Disclaimer
- 1.3 Emergency Measures
- 1.4 Label Description
- 1.5 Check Before Power ON
- 1.6 EU Declaration of Conformity

### 2 Product Introduction

- 2.1 Parts Introduction (PCU)
- 2.2 Parts Introduction (Battery) Parts Introduction (Battery Base)
- 2.3 Dimensions

### 3 Battery System Installation

- 3.1 Deliverables (PCU)
- 3.2 Deliverables (Battery Module)
- 3.3 Space Requirements
- 3.4 Angle Requirements
- 3.5 Battery Quantity Requirements
- 3.6 Installation Requirement For Locking Bracket
- 3.7 Battery System Installation(Without adjustable leveling feet)
- 3.8 Battery System Installation(With adjustable leveling feet)
- 3.9 Installation of PCU

### 4 Electrical Connection

- 4.1 Wiring Diagram for battery systems
- 4.2 Connecting the PE cable
- 4.3 Connecting the Power Cable(Type1)
- 4.4 Connecting the Power Cable(Type2)
- 4.5 Parallized battery systems

### 5 Power ON and OFF

- 5.1 Single battery system
- 5.2 Parallized battery systems

### 6 Commissioning

- 6.1 Commissioning via SolarGo APP
- 6.2 Monitoring via SEMS Portal APP

### 7 Customer Support

### 8 Documents / Resources

- 8.1 References

### 9 Related Posts

## Safety Precaution

### General Disclaimer

- The information in this user manual is subject to change due to product updates or other reasons. This guide cannot replace the product labels or the safety precautions in the user manual unless otherwise specified. All descriptions in the manual are for guidance only.
- Before installations, read through the quick installation guide. For additional information, please see the user manual.
- All installations should be performed by trained and knowledgeable technicians who are familiar with local standards and safety regulations.
- Check the deliverables for correct model, complete contents, and intact appearance. Contact after sales service if any damage is found or any component is missing.

- Use insulating tools and wear personal protective equipment (PPE) when operating the equipment to ensure personal safety. Wear anti-static gloves, cloths, and wrist strips when touching electron devices to protect the equipment from damage.
- Strictly follow the installation, operation, and configuration instructions in this guide and relative user manual. The manufacturer shall not be liable for equipment damage or personal injury if you do not follow the instructions. For more warranty details, please visit: <https://en.goodwe.com/warranty>.

## Safety Disclaimer

## Instructions during Installation

- The battery system is a high voltage system. High voltage exists when the equipment is running. Please keep Power Off before any operations to avoid danger. Strictly follow all safety precautions outlined in this manual and safety labels on the equipment during the operation.
- The inverter used with the battery shall be approved by the battery manufacturer. The approved list of batteries and the matched inverter can be obtained through the official website.
- Do not disassemble, modify, or replace any part of the battery or the power control unit without official authorization from the manufacturer. Otherwise, it will cause electrical shock or damages to the equipment, which shall not be borne by the manufacturer.
- Do not hit, pull, drag, squeeze or step on the equipment or put the battery into fire. Otherwise, the battery will be exploded.
- Do not place the battery in a high temperature environment. Make sure that there is no heat source near the battery and no direct sunlight. When the ambient temperature exceeds 60 °C, it will cause a fire.
- Do not use the battery or the power control unit if it is defective, broken, or damaged. The damaged battery may leak electrolyte.
- To protect the battery pack and its components from damage during transportation, please ensure that the transportation personnel are professionally trained. All operations during the transportation have to be recorded. The equipment shall be kept in balance, thus avoiding falling down.
- The battery equipment is heavy. Please equip the corresponding personnel according to its weight, so that the equipment does not exceed the weight range of the human body can carry, and smash the personnel.
- Contact after-sale service immediately if the battery is not able to be started. Otherwise, the battery might be damaged permanently.
- Do not move the battery system if it is connected with external battery modules. Contact after-sale service if the battery shall be replaced or added.

## Emergency Measures

### Battery Electrolyte Leakage

If the battery module leaks electrolyte, avoid contact with the leaking liquid or gas. The electrolyte is corrosive. It will cause skin irritation or chemical burn to the operator. Anyone contacts the leaked substance accidentally has to do as following:

- **Breath in the leaked substance:** Evacuate from the polluted area, and seek immediate medical assistance.
- **Eye contact:** Rinse your eyes for at least 15 minutes with clean water and seek immediate medical assistance.

- **Skin contact:** Thoroughly wash the touch area with soap and clean water, and seek immediate medical assistance.
- **Ingestion:** Induce vomiting, and seek immediate medical assistance.

## **Fire**

- The battery may explode when the ambient temperature exceeds 150°C. Poisonous and hazardous gas may be released if the battery is on fire.
- In the event of a fire, please make sure that the carbon dioxide extinguisher or Novac1230 or FM-200 is nearby.
- The fire cannot be put out by water or ABC dry powder extinguisher. Firefighters are required to wear full protective clothing and self-contained breathing apparatus.

## **Label Description**

	Potential risks exist. Wear proper PPE before any operations.		Keep the equipment away from open flame or ignition source.
	HIGH VOLTAGE HAZARD. High voltage exists during the equipment's running. Ensure the equipment is powered off before any operations.		Keep the equipment away from children.
	Operate the equipment properly to avoid explosion danger.		No extinguishing with water.
	The equipment contains corrosive electrolytes. In case of a leak in the equipment, avoid contact with the leaked liquid or gas.		Do not dispose of the equipment with household garbage at its end of life. Dispose of it according to local laws and regulations, or send it to the manufacturer.
	Batteries contain flammable materials, beware of fire.		Recycle regeneration mark.
	Read through the user manual before any operations.		CE Marking
	Pay attention to wearing PPE during installation, operation and maintaining of the equipment.		Grounding point.

#### Check Before Power ON

No.	Check Item
1	The battery is firmly installed in a clean place where is well-ventilated and easy to operate.
2	The PE cable, power cable, communication cable, and the terminal resistors are connected correctly and securely.
3	Cable ties are intact, routed properly and evenly.
4	Unused ports and terminals are sealed.

## EU Declaration of Conformity

GoodWe Technologies Co., Ltd. hereby declares that the equipment without wireless communication modules sold in the European market meets the requirements of the following directives:

- Electromagnetic compatibility Directive 2014/30/EU (EMC)
- Electrical Apparatus Low Voltage Directive 2014/35/EU (LVD)
- Battery Directive 2006/66/EC and Amending Directive 2013/56/EU
- Waste Electrical and Electronic Equipment 2012/19/EU
- Registration, Evaluation, Authorization and Restriction of Chemicals (EC) No 1907/2006 (REACH)

You can download the EU Declaration of Conformity on the official website: <https://en.goodwe.com>.

## Product Introduction

### Parts Introduction (PCU)

1. DC Terminal (BAT)
2. Ventilation Valve
3. Communication Terminal (COM)<sup>TM</sup>
4. Grounding Point
5. Circuit Breaker
6. SOC Indicator
7. Button Indicator
8. Rectangular Connector

Right View

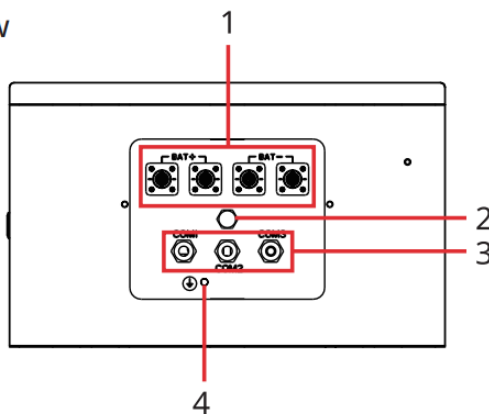

Left View

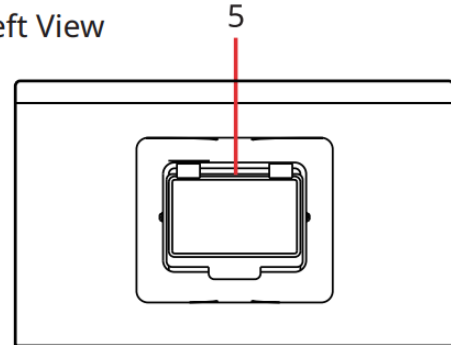

Front View

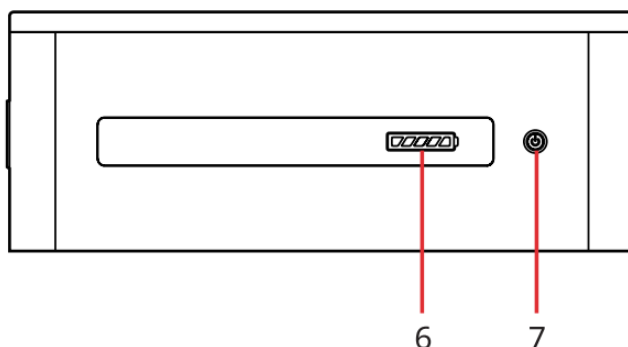

Bottom View

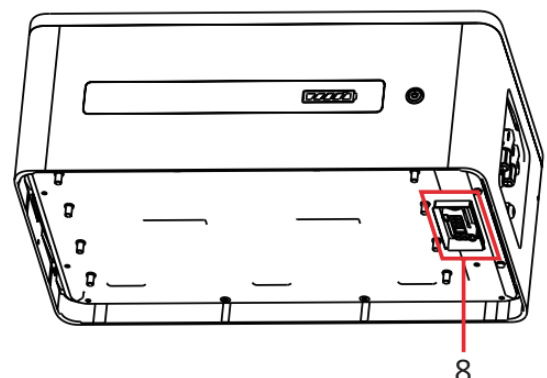

## Parts Introduction (Battery) Parts Introduction (Battery Base)

1. Ventilation Valve
2. Rectangular Connector
3. Grounding Point
4. Adjustable Leveling Feet (Optional)

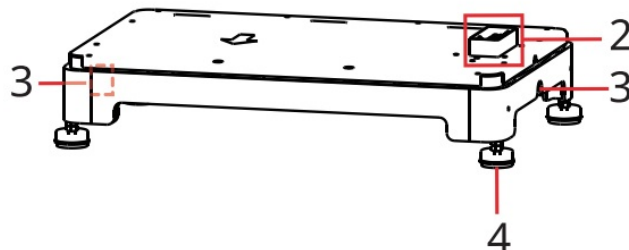
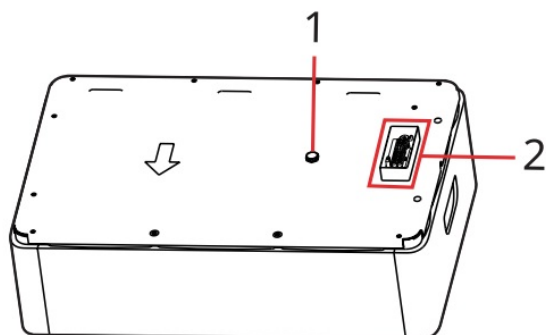

## Dimensions

- Lynx home F series

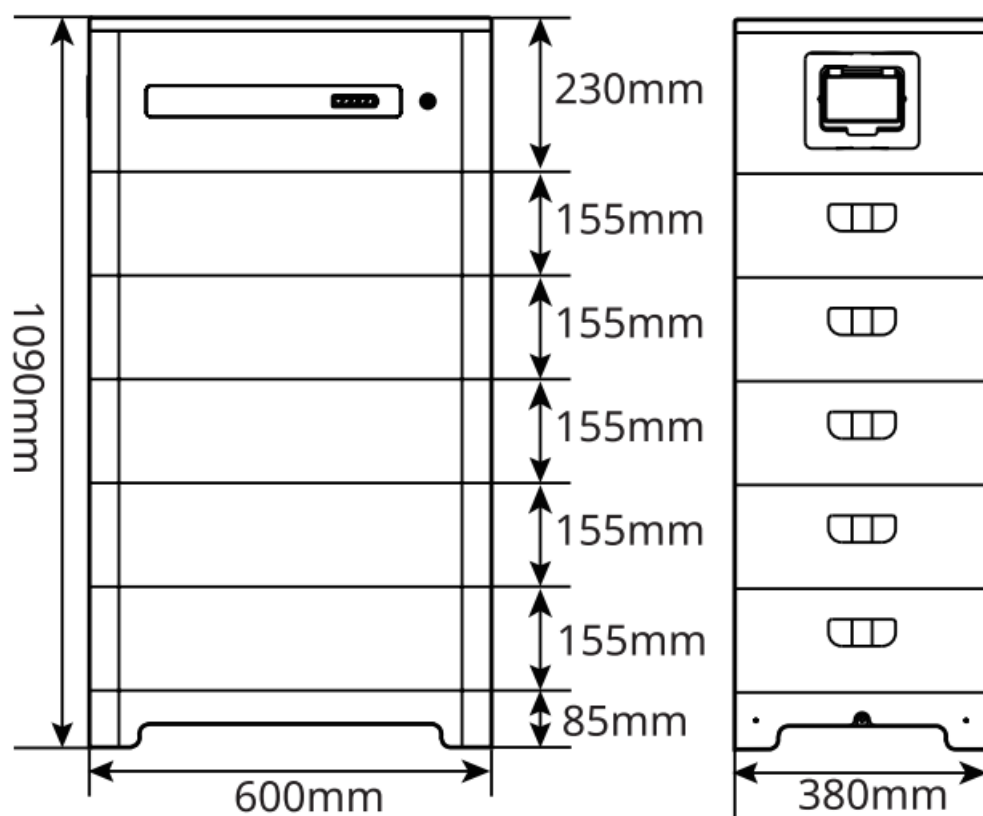

- Lynx home F Plus+ series



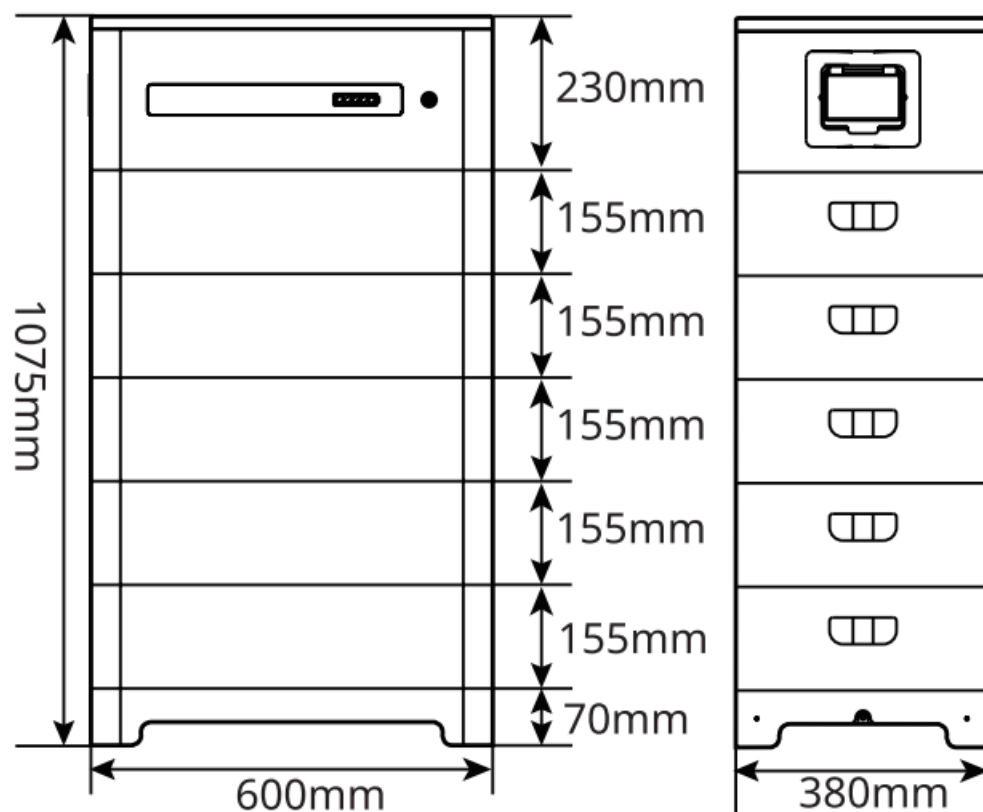

## Battery System Installation

### Deliverables (PCU)

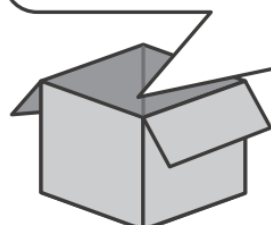
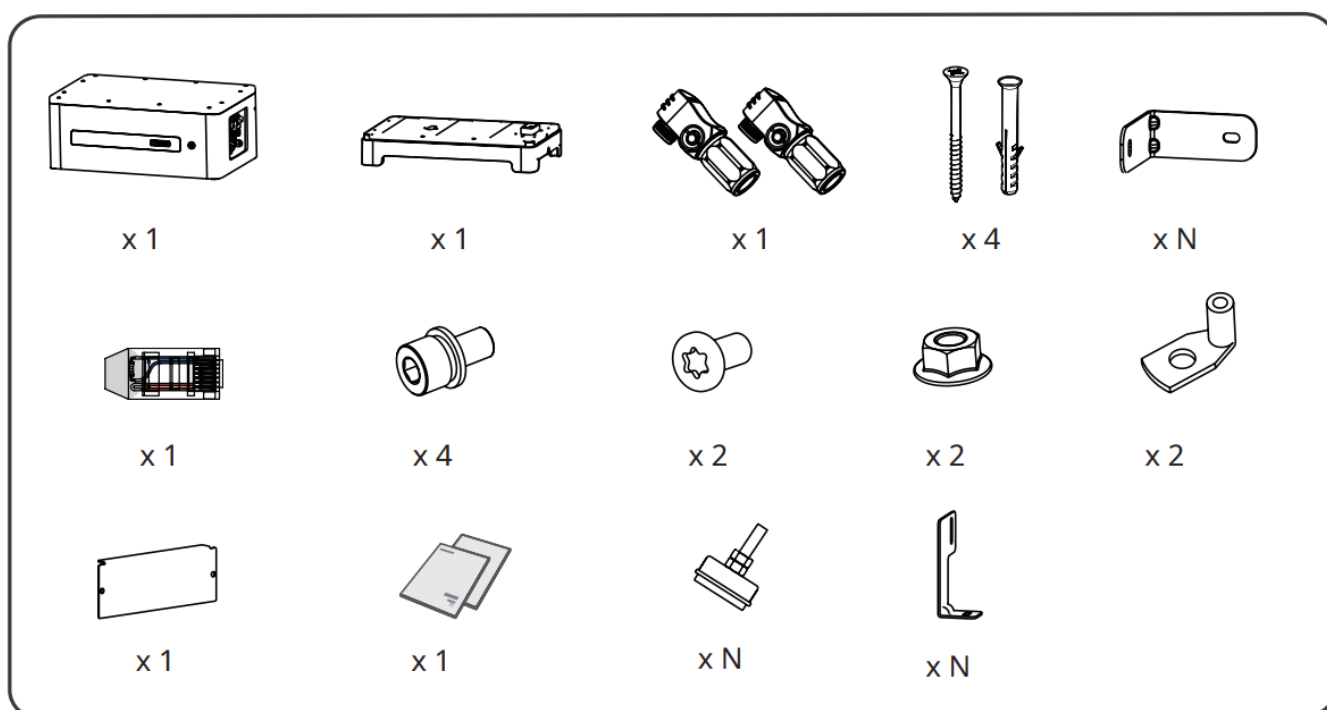

N = Quantity depends on the battery system.

## Deliverables (Battery Module)

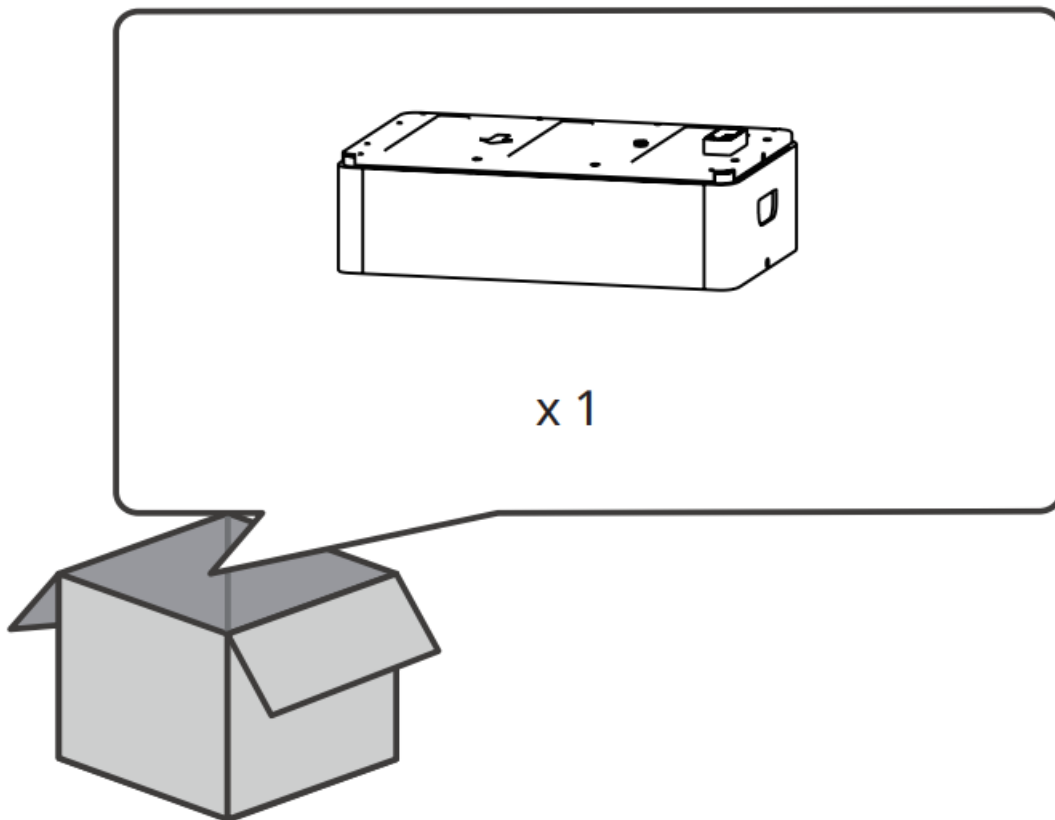

## Space Requirements

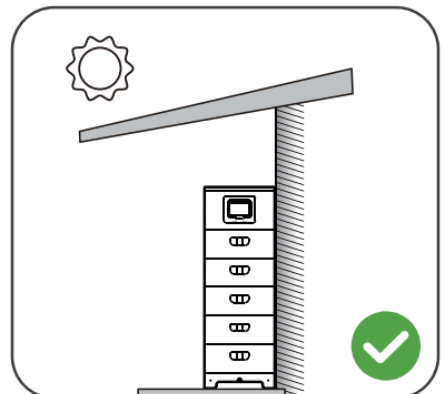
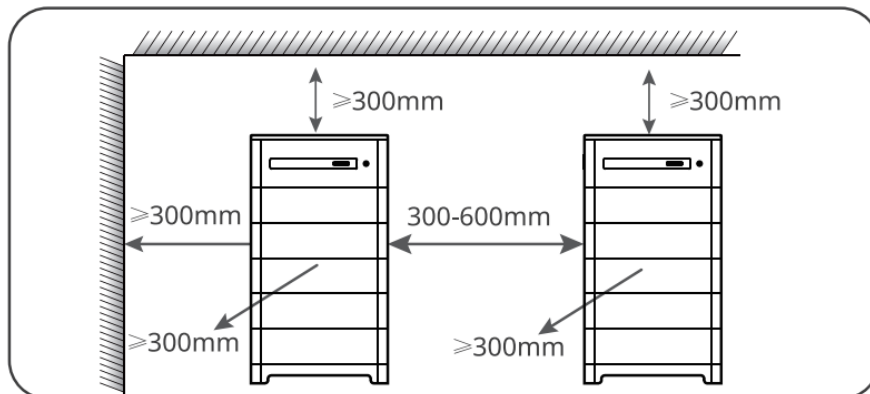
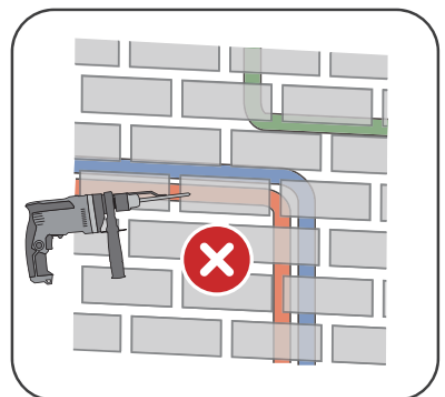

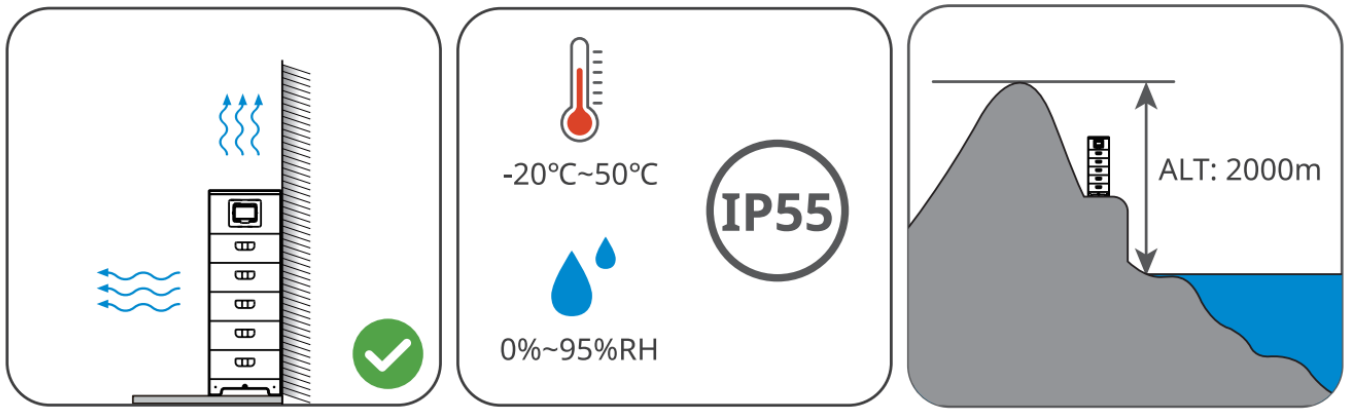

### Angle Requirements

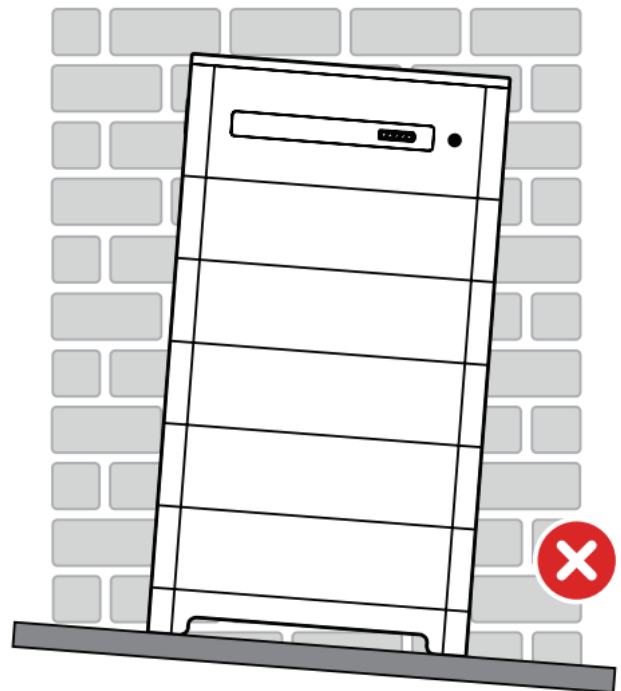
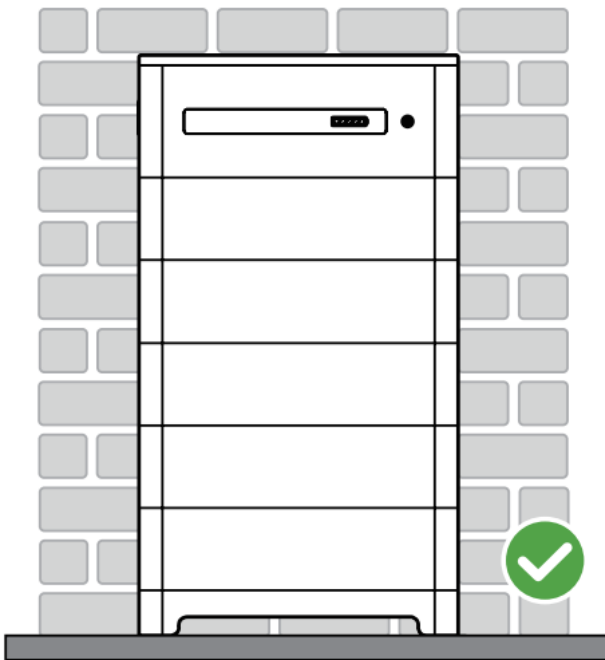

### Battery Quantity Requirements

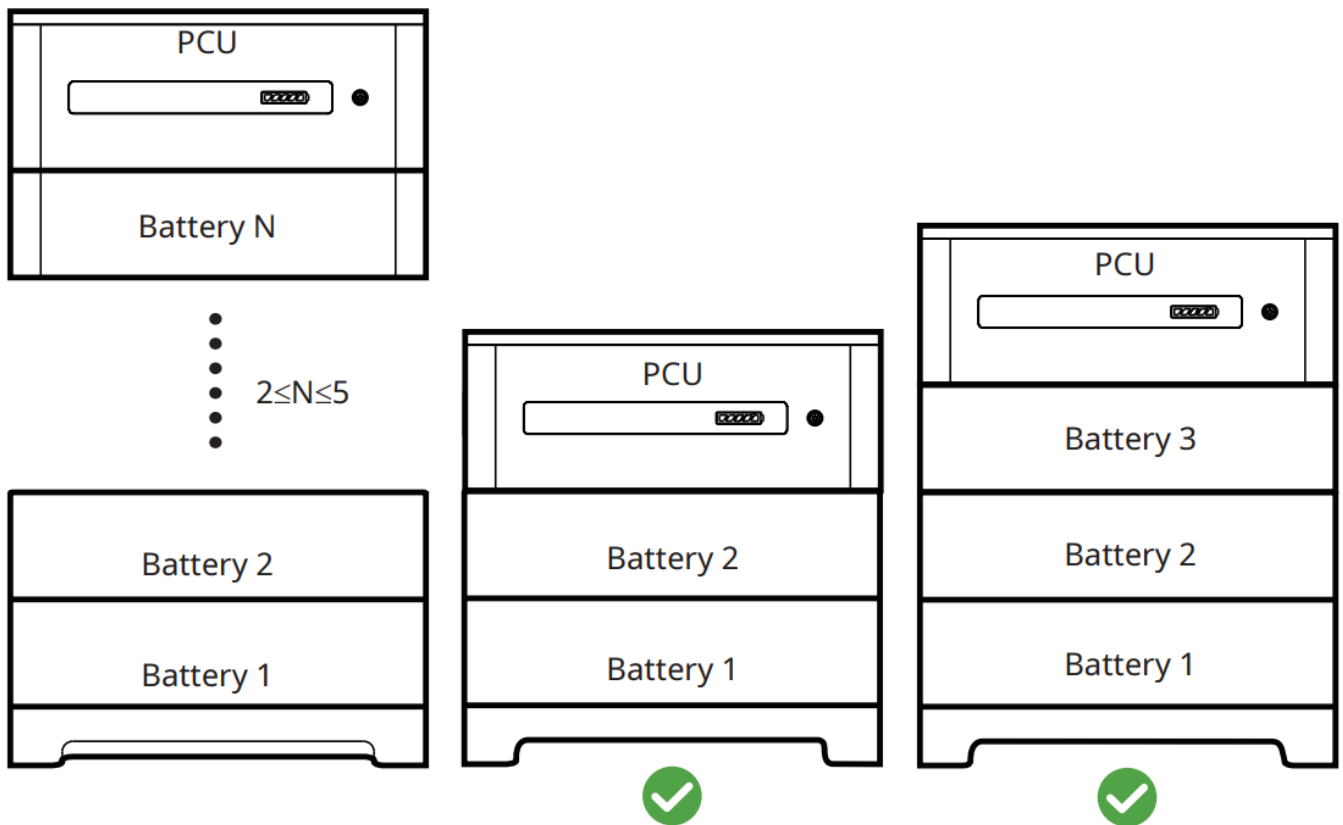

#### Installation Requirement For Locking Bracket

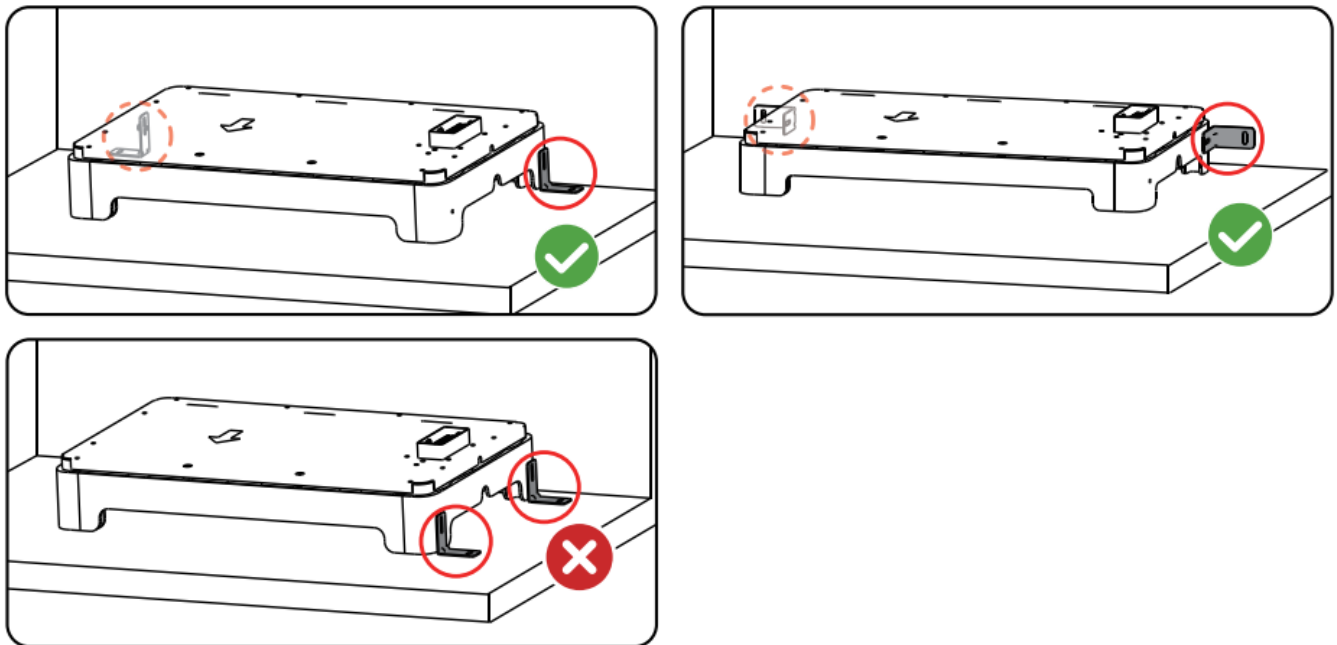

#### Battery System Installation(Without adjustable leveling feet)

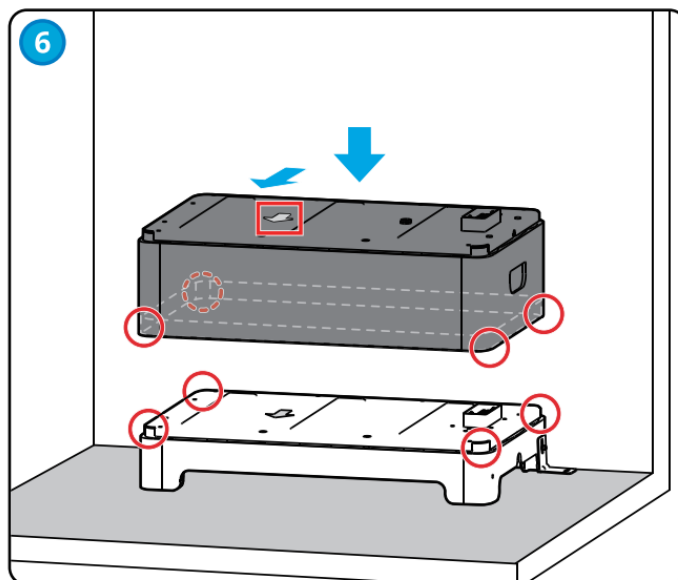
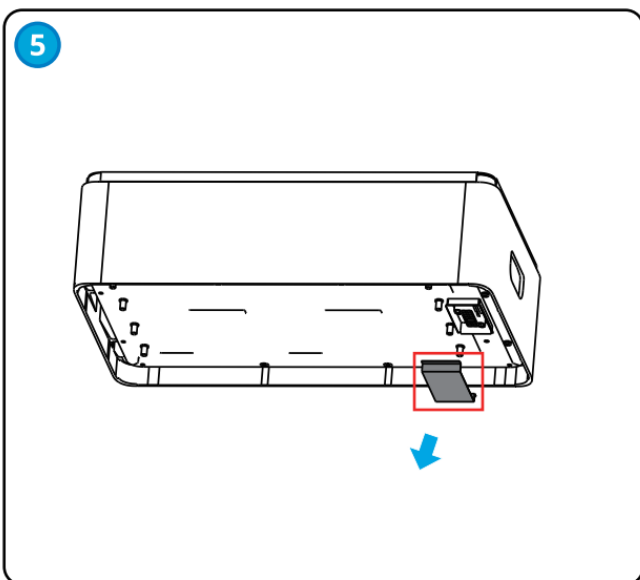
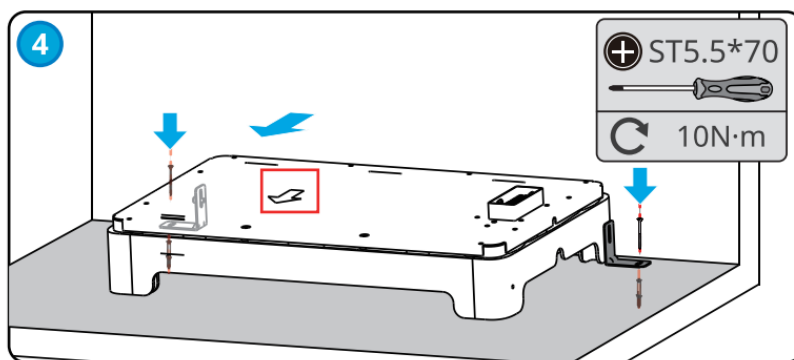
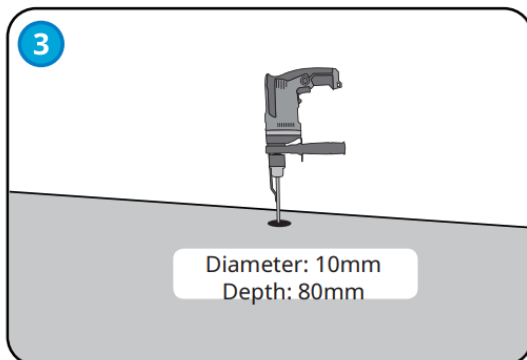
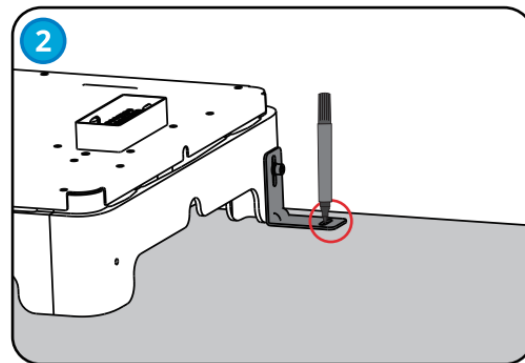
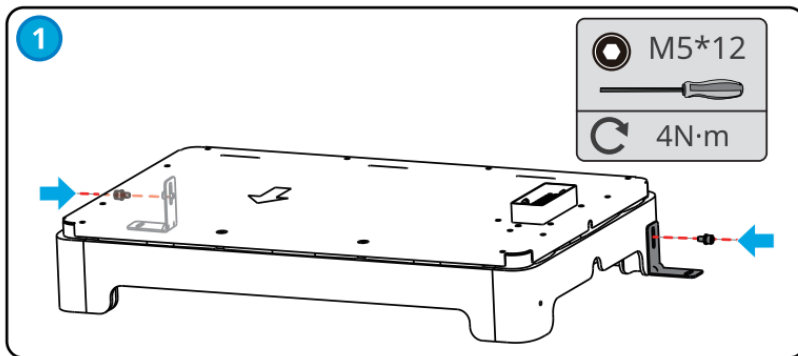

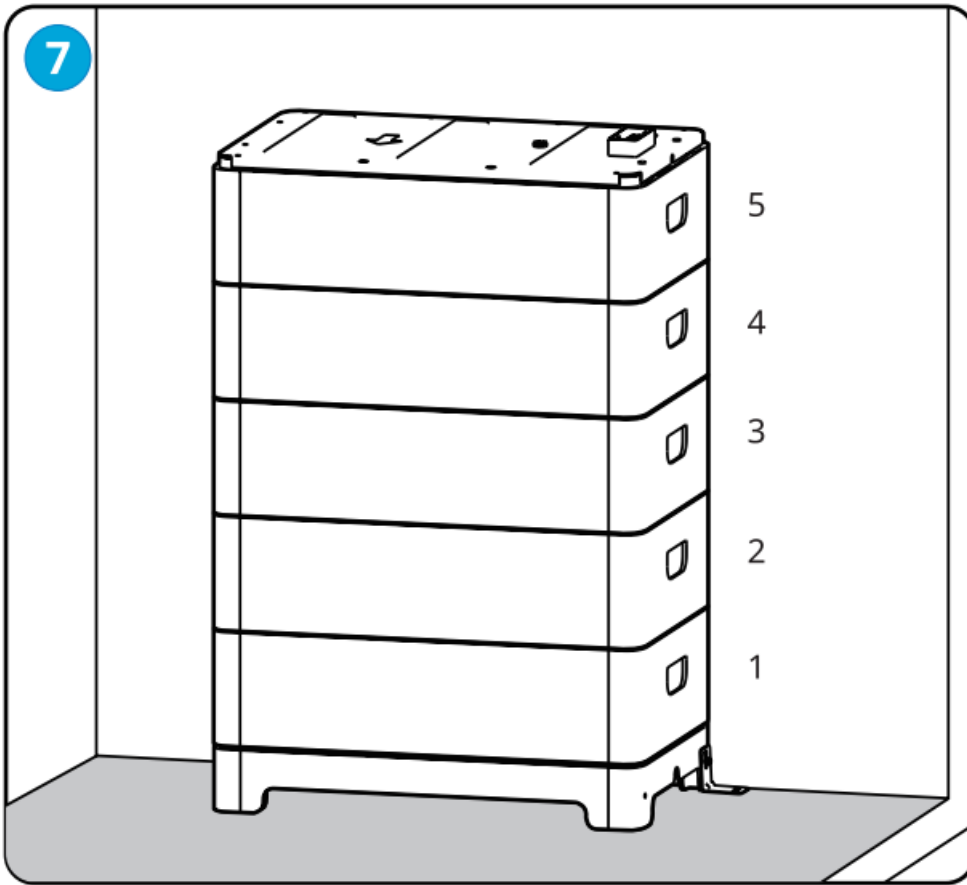

**Battery System Installation(With adjustable leveling feet)**

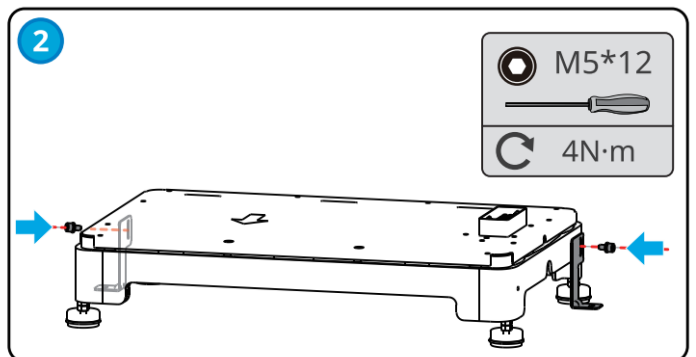
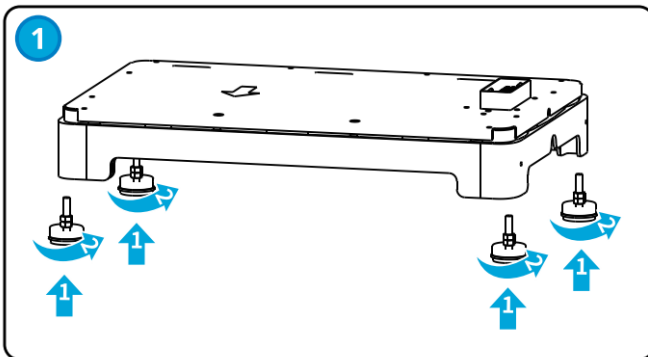

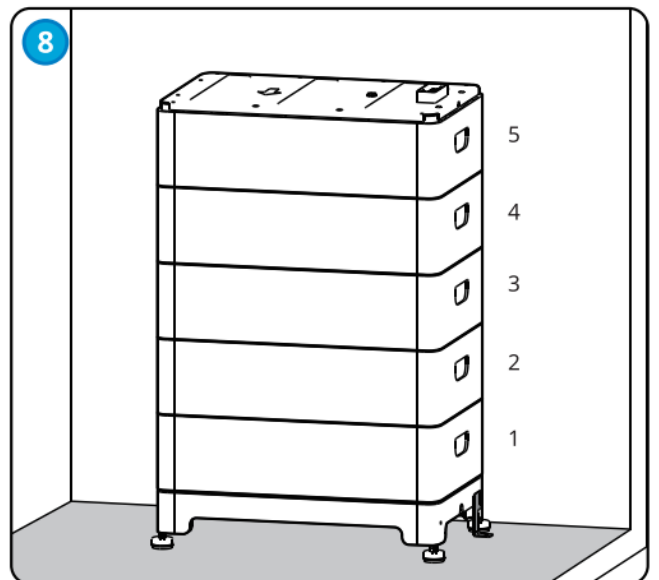
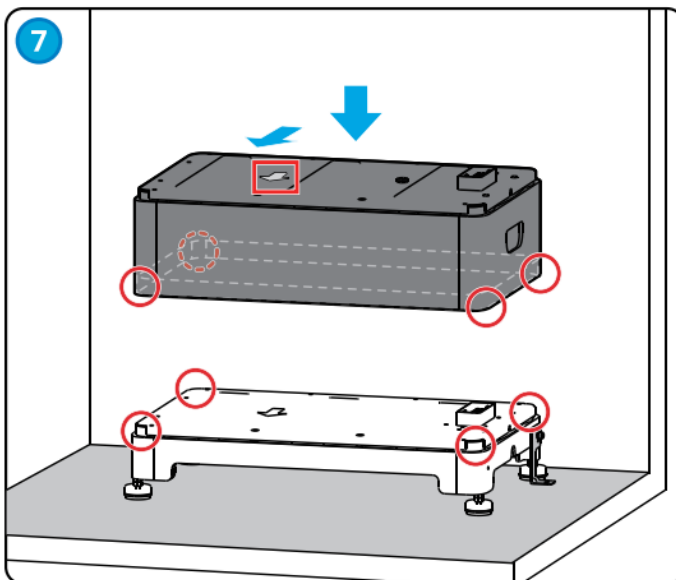
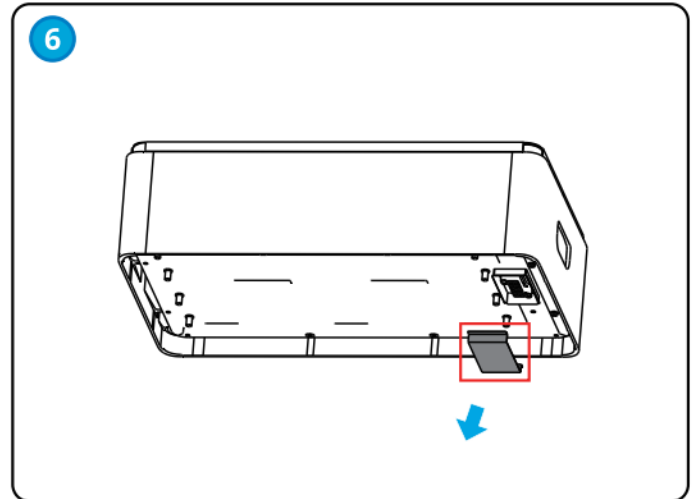
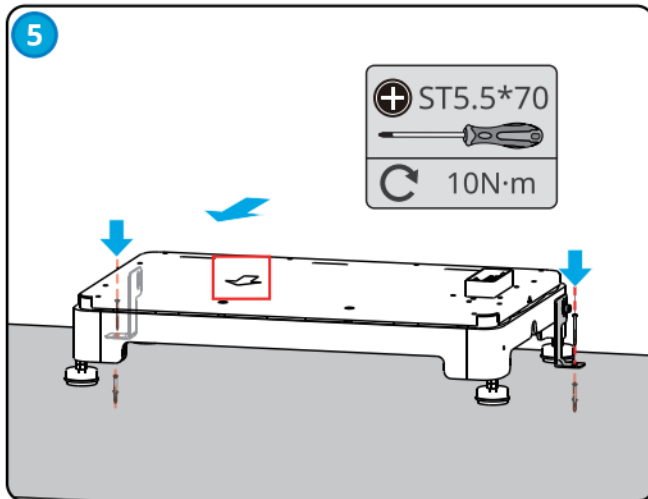
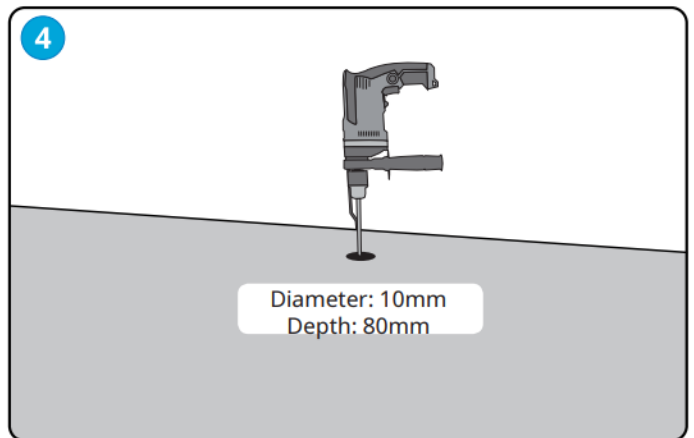
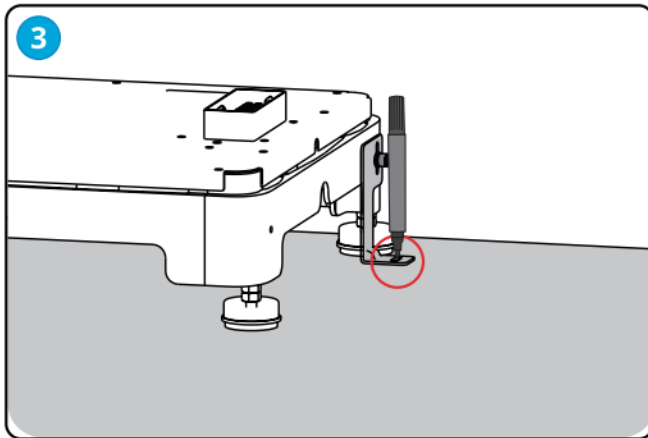

Installation of PCU

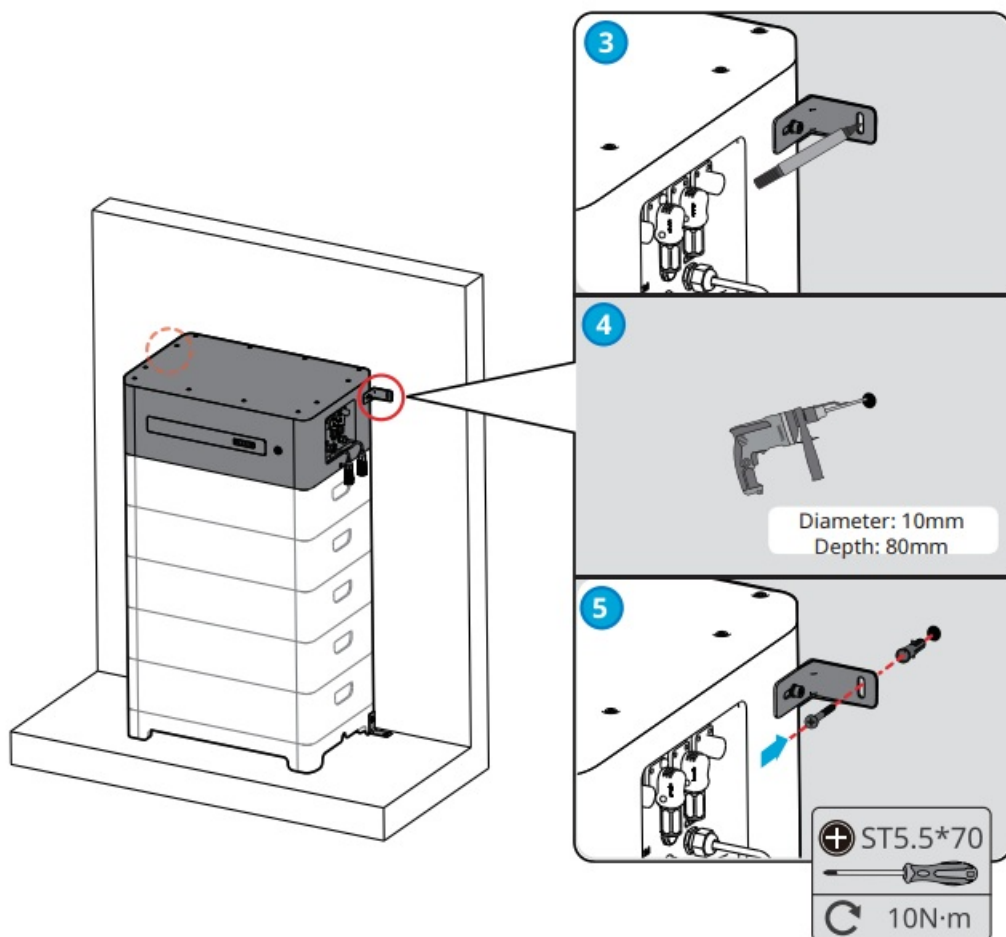
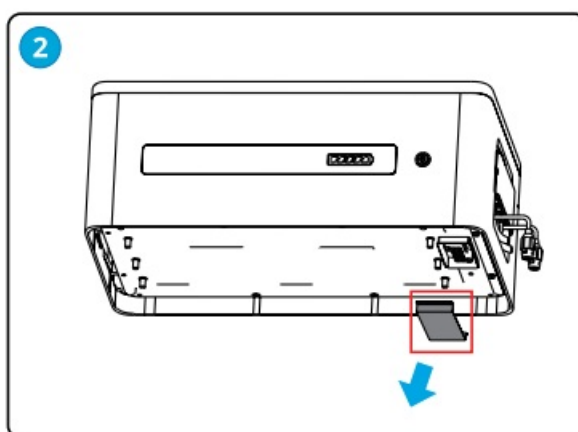
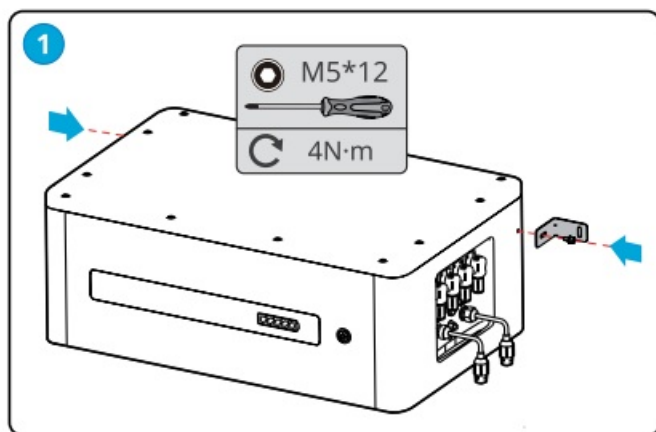

## Electrical Connection

### Wiring Diagram for battery systems

Single battery system

For Lynx home F series and Lynx home F Plus+ series.



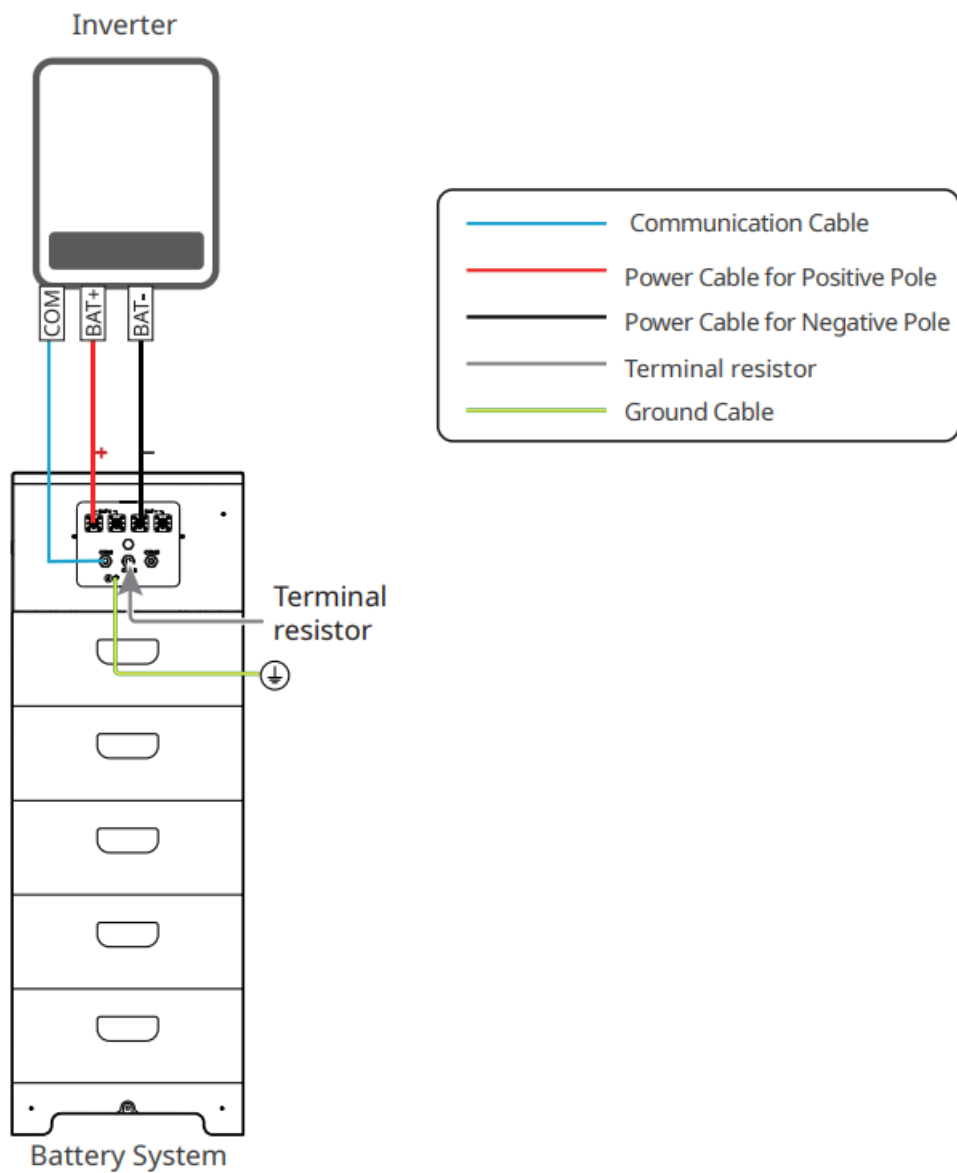

Parallized battery systems  
Only for Lynx home F Plus+ series.

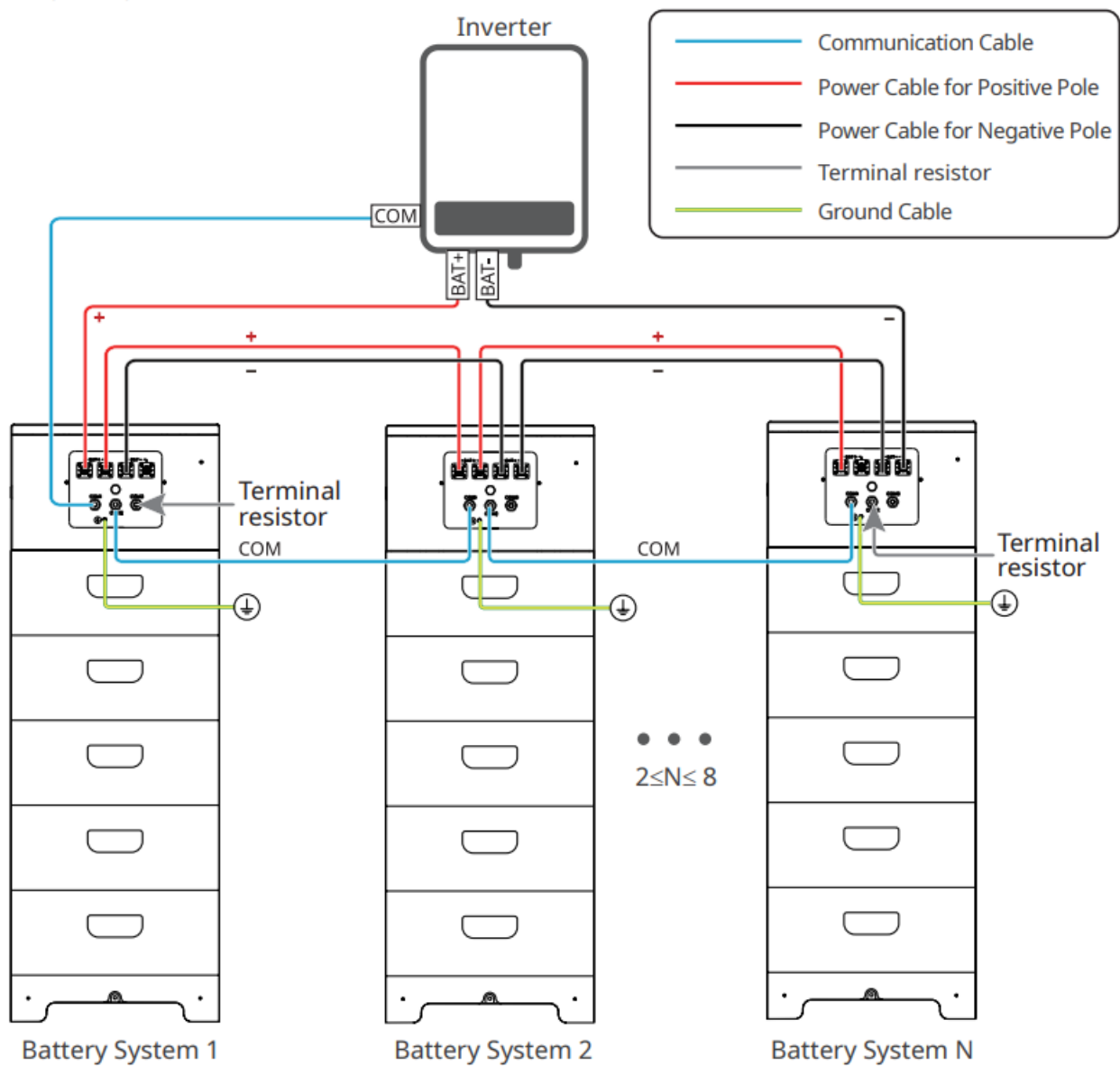

### Connecting the PE cable

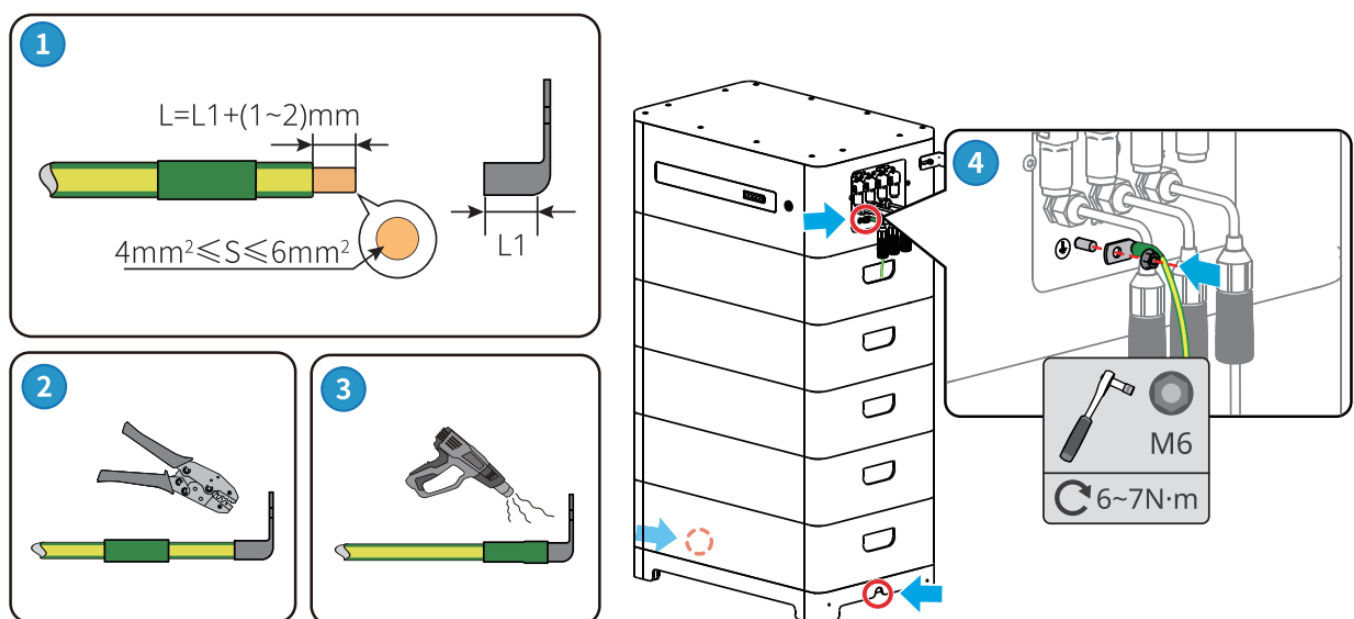

### Connecting the Power Cable(Type1)

Cross-sectional area of the power cable S:  $14\text{mm}^2 \leq S \leq 16\text{mm}^2$   
For Lynx home F series and Lynx home F Plus+ series.

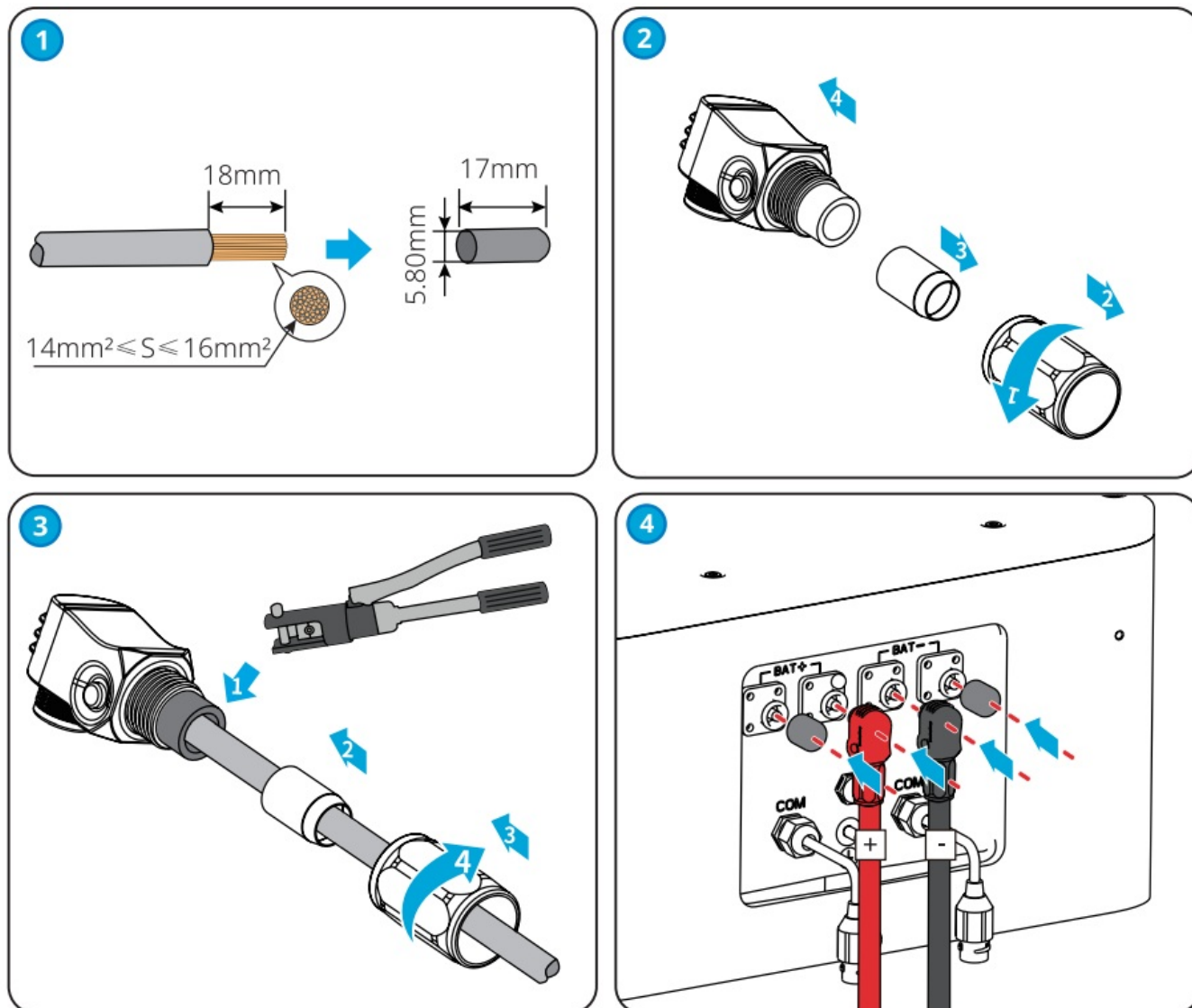

Cross-sectional area of the power cable S:  $4\text{mm}^2 \leq S \leq 6\text{mm}^2$   
For Lynx home F series and Lynx home F Plus+ series.

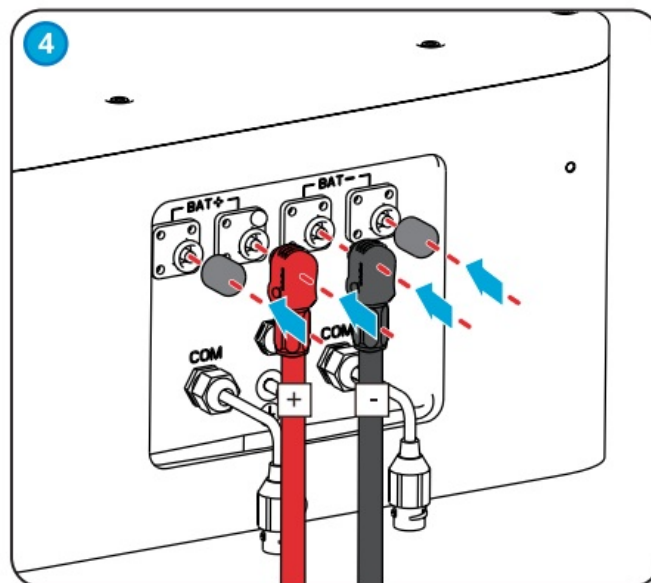
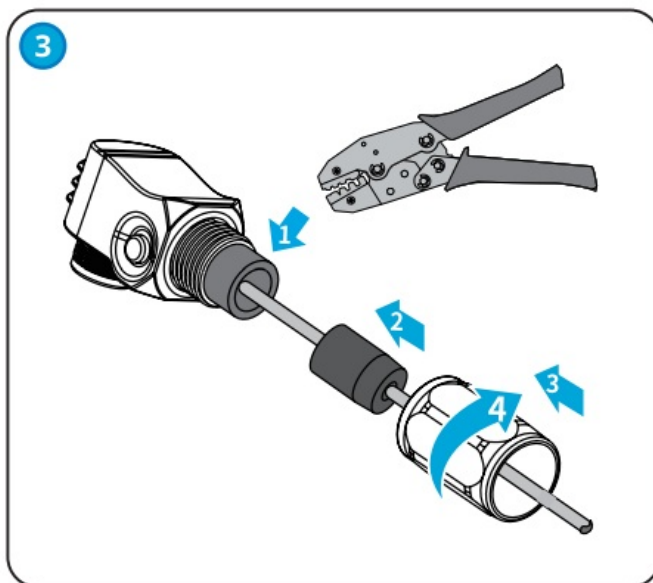
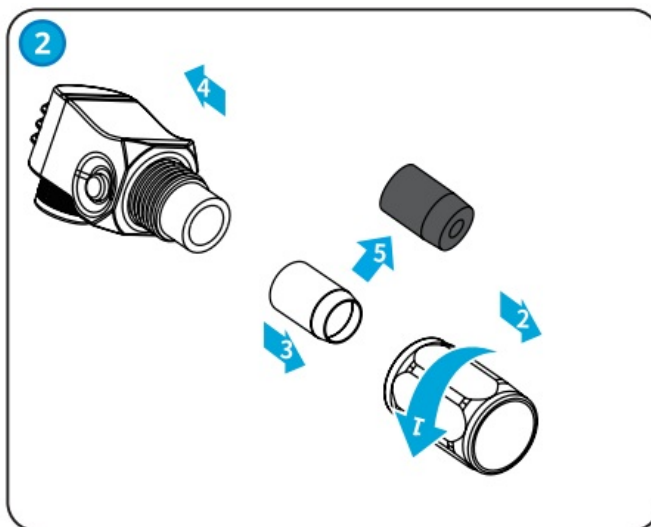
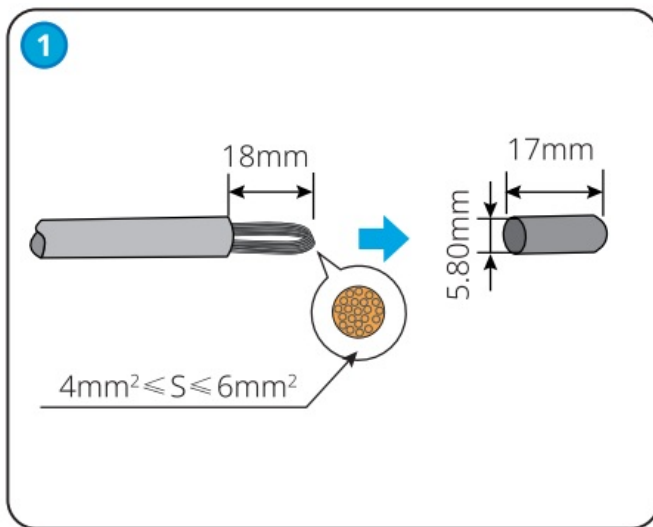

### Connecting the Power Cable(Type2)

Only for Lynx home F Plus+ series.

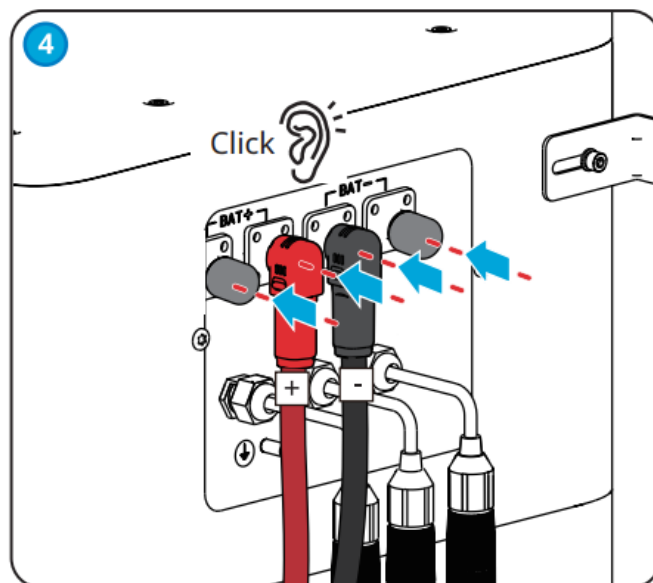
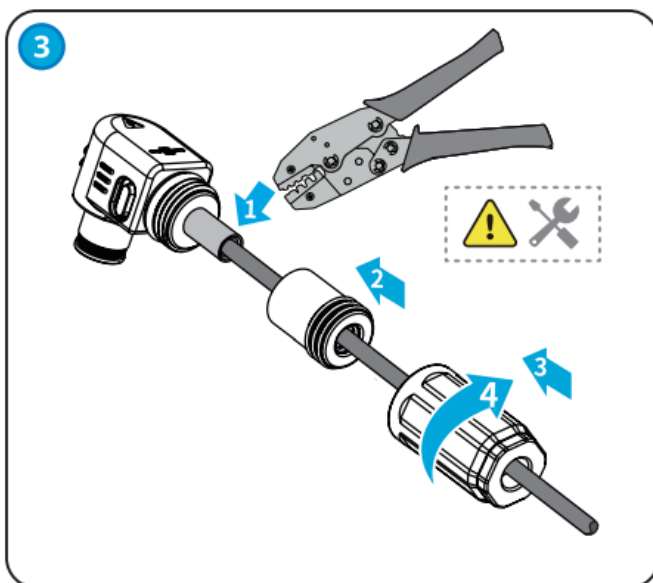
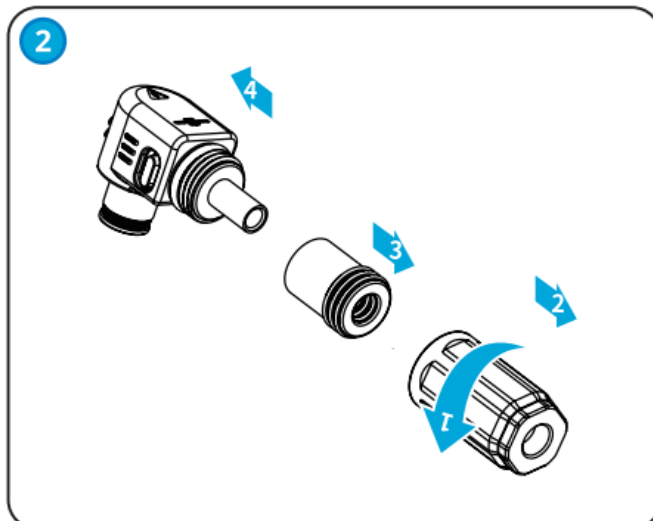
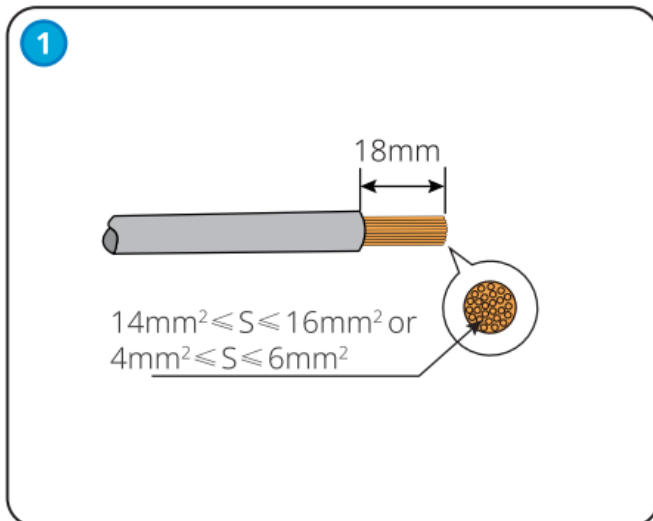

## Connecting the Communication Cable

Lynx home F series  
RJ45 Connector

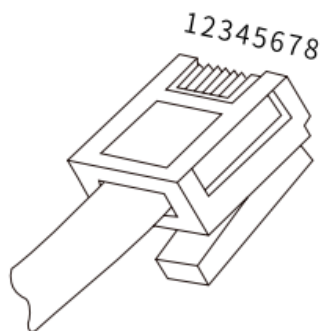

PIN	COM	Description
4	CAN_H	BMS communication
5	CAN_L	
1,2,3,6,7,8	N/A	

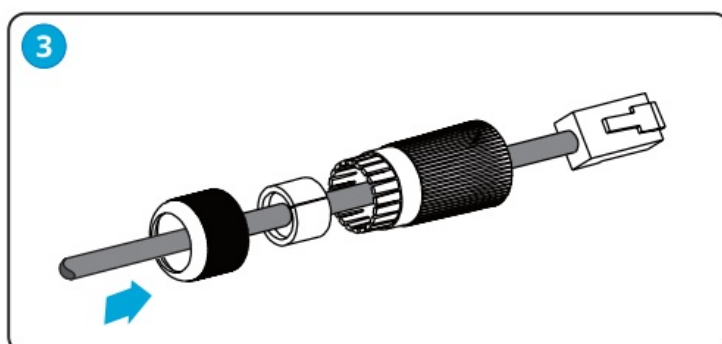
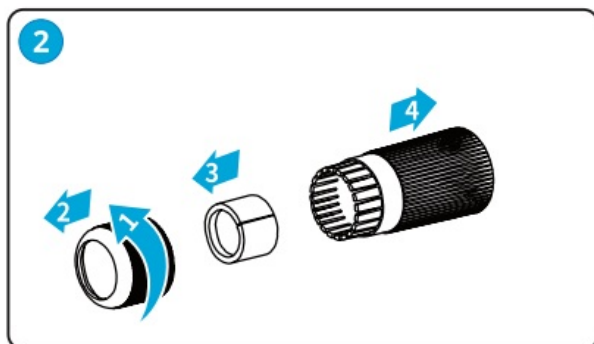
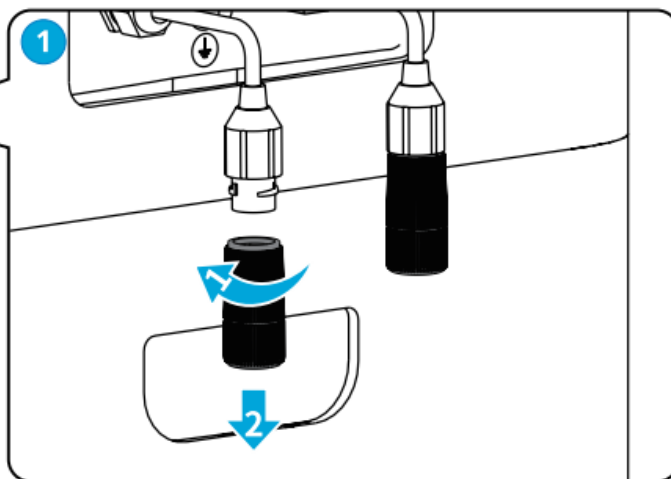
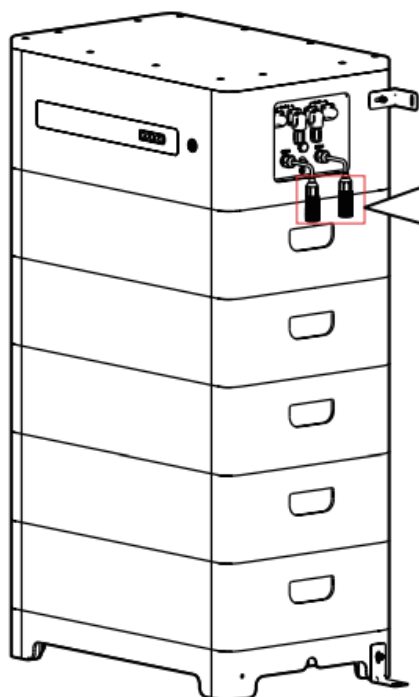

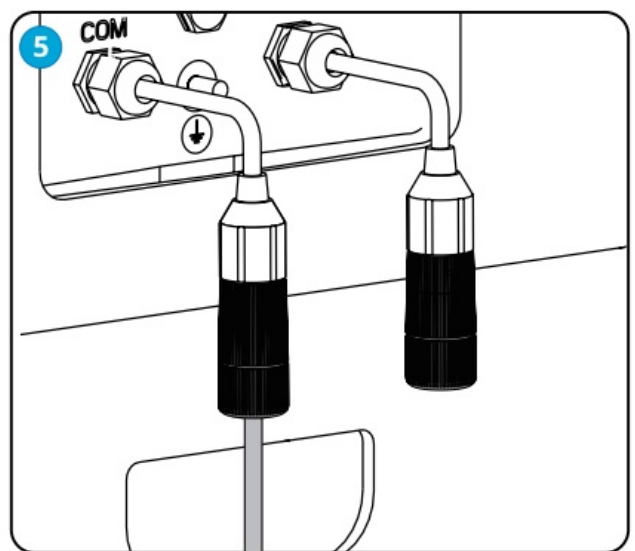
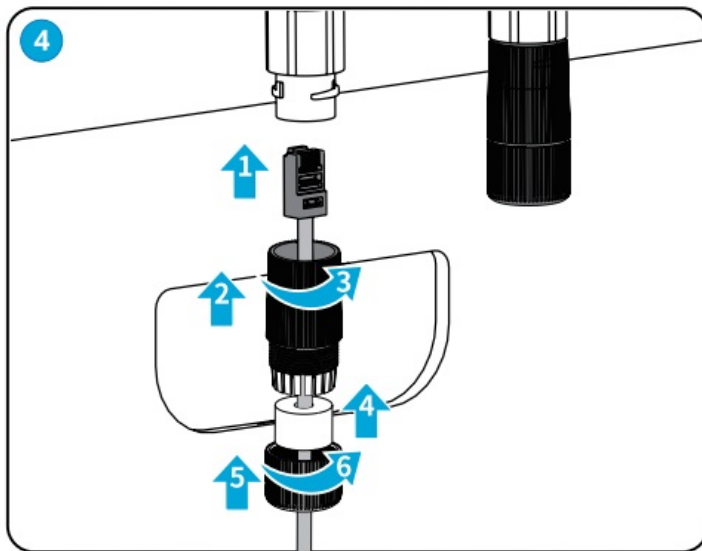

Lynx home F Plus+ series  
RJ45 Connector

PIN	COM1	COM2	COM3	Description
1	CAN_3H	CAN_3H	CAN_3H	BMS communication for battery system parallel connection
2	CAN_3L	CAN_3L	CAN_3L	
3	N/A	N/A	N/A	Reserved
4	CAN_2H	N/A	N/A	COM1: connects to the inverter BMS communication port to communication with the inverter COM2, COM3: reserved
5	CAN_2L	N/A	N/A	
6	GND	GND	GND	PIN for grounding.
7	HVIL_IN	HVIL_IN	N/A	COM1, COM2: interlock function COM3: reserved
8	HVIL_OUT	HVIL_OUT	N/A	

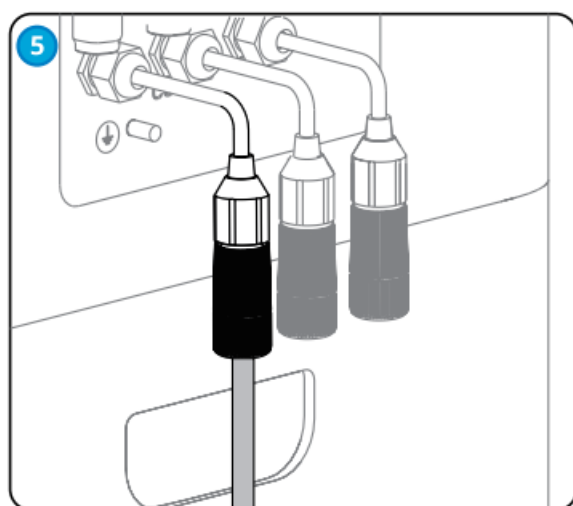
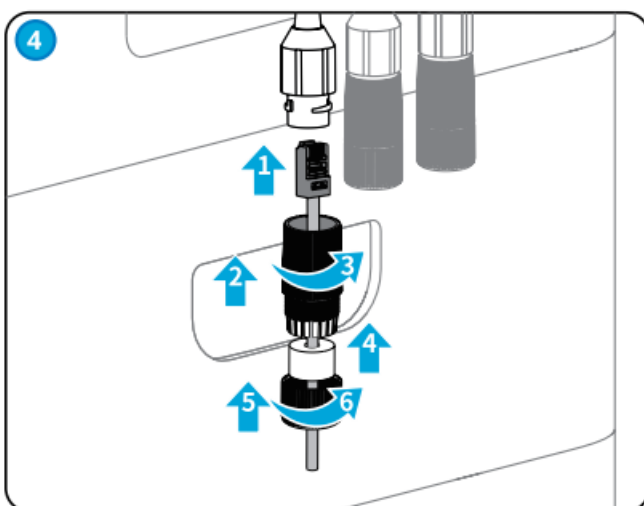
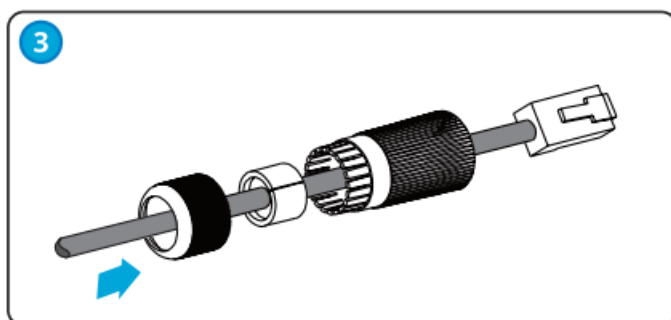
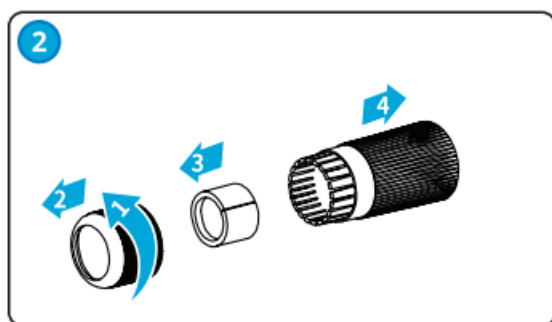
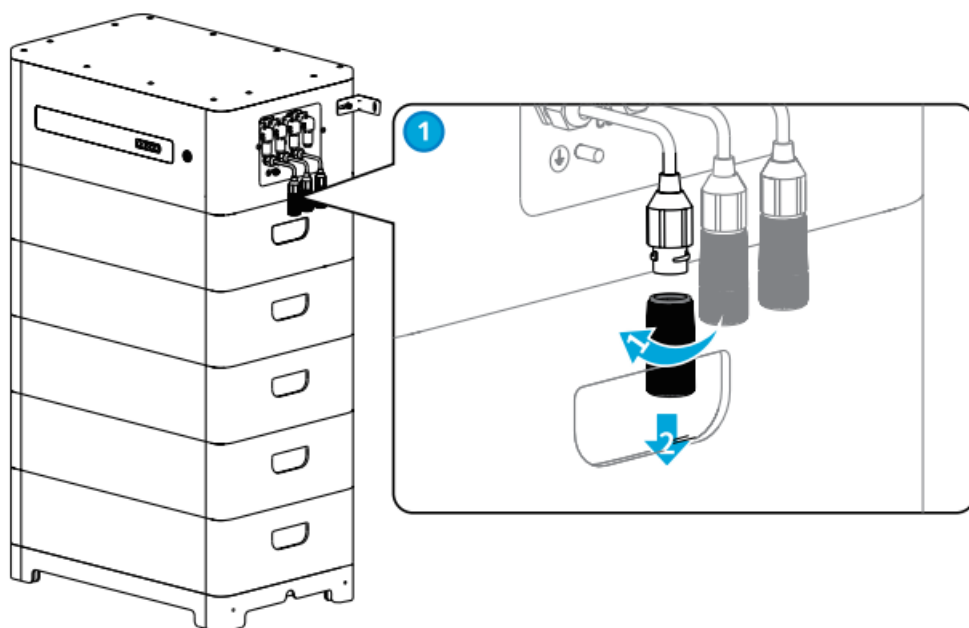
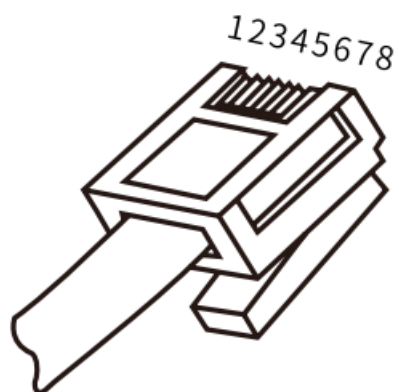

Installing the terminal resistor



## Lynx home F series

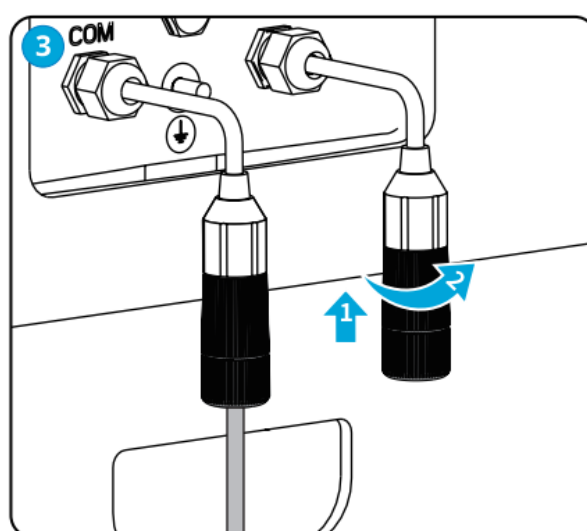
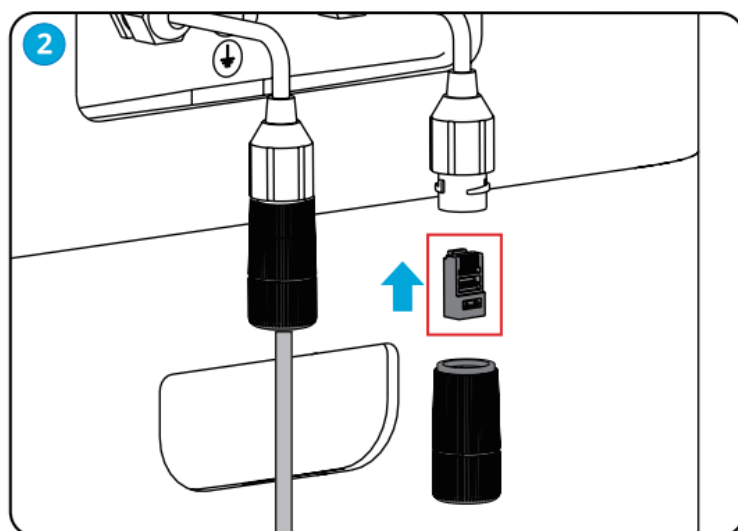
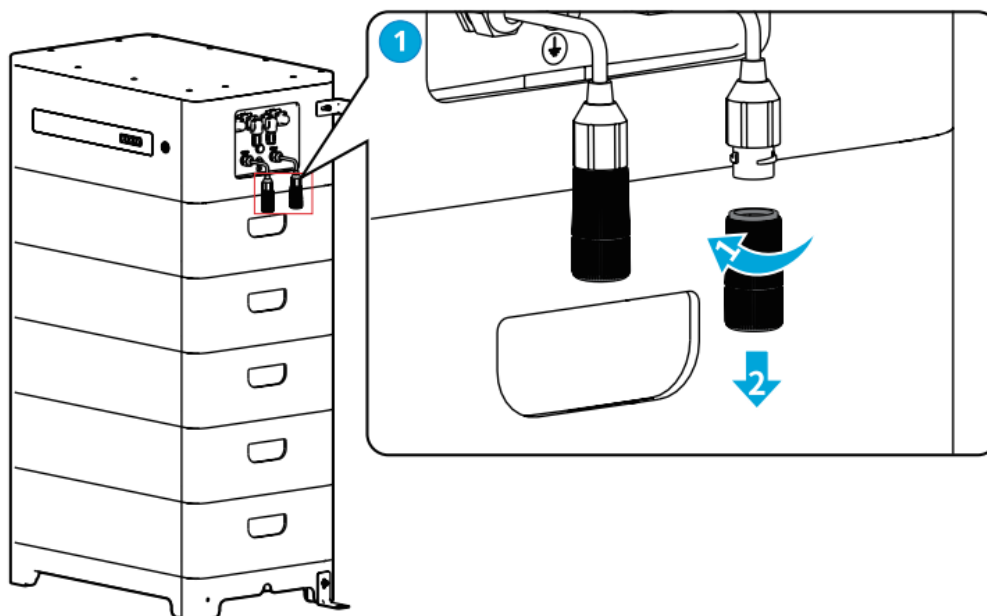

## Lynx home F Plus+ series

Single battery system

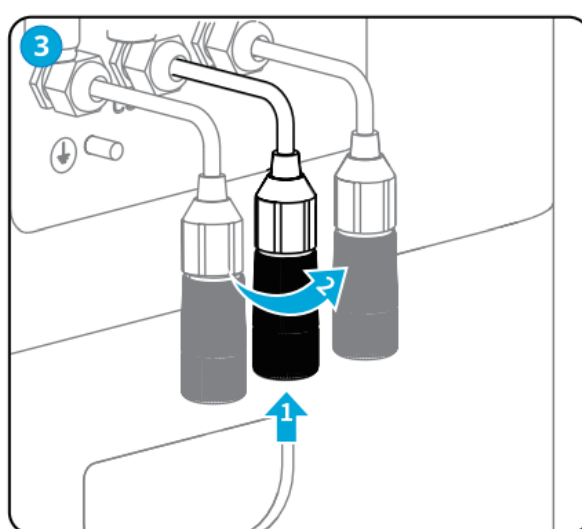
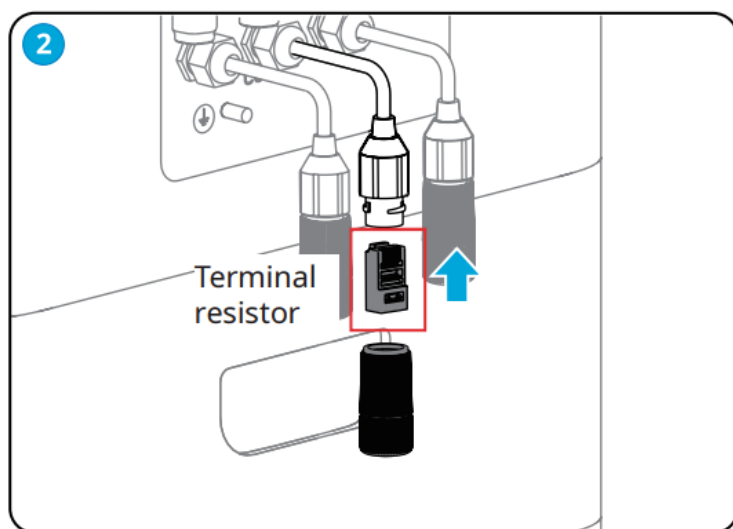
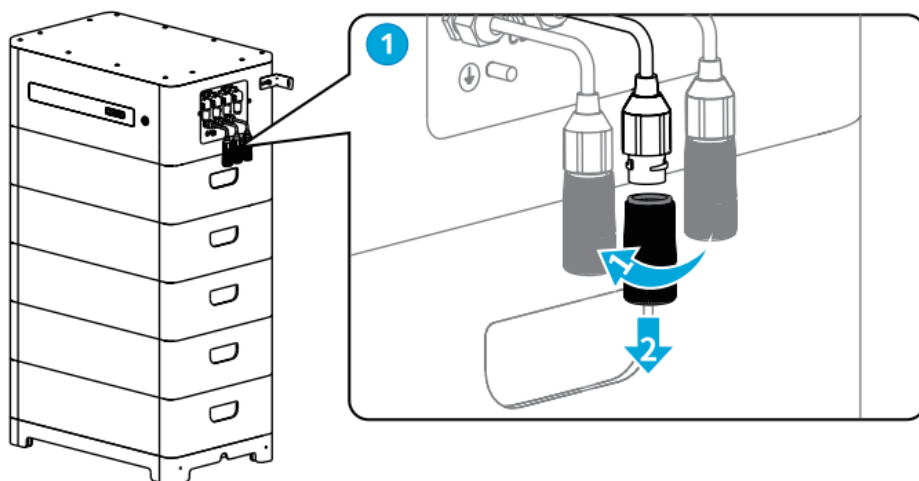

## Parallized battery systems

For Battery 1

For Battery 1

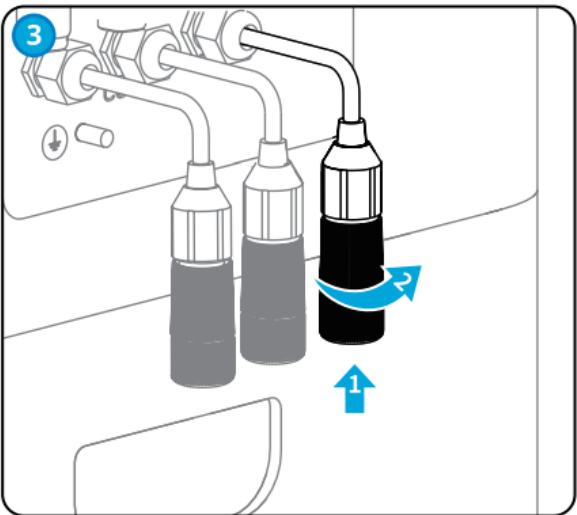
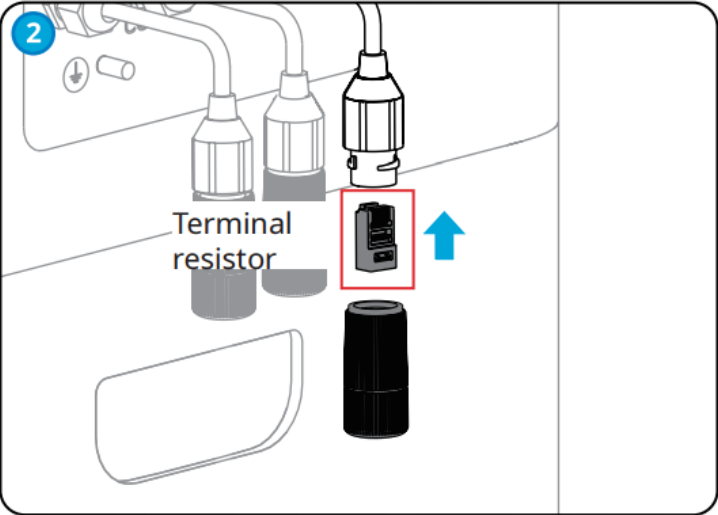
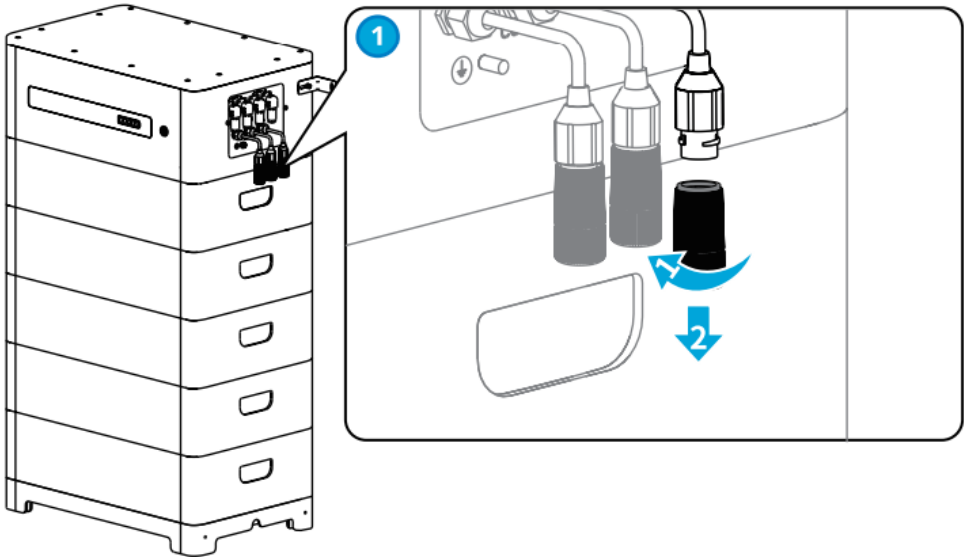

For Battery N

## For Battery N

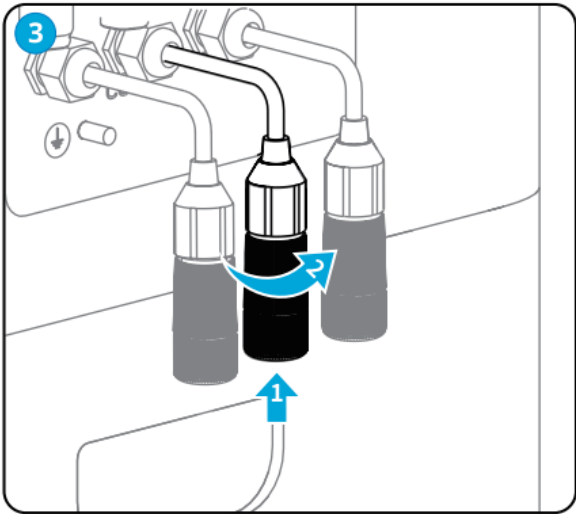
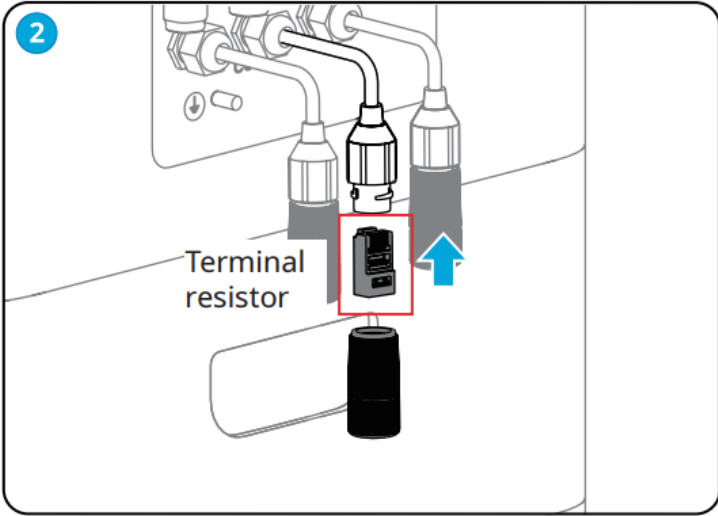
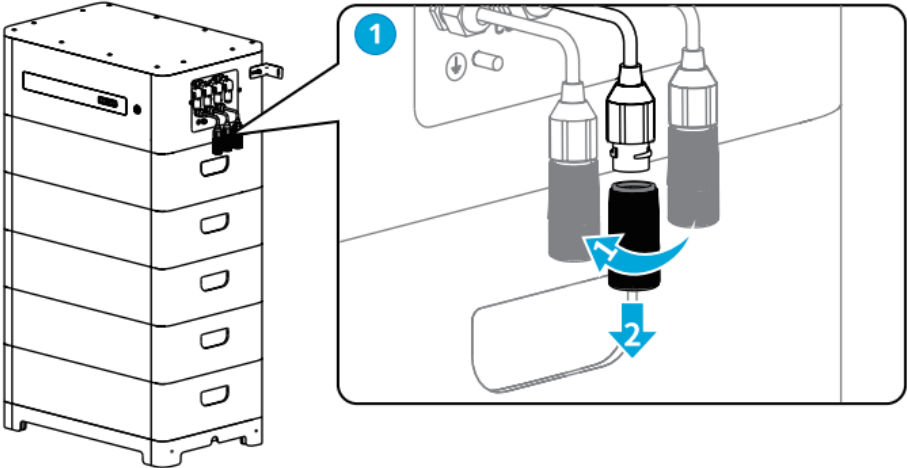

## Installing the protection cover

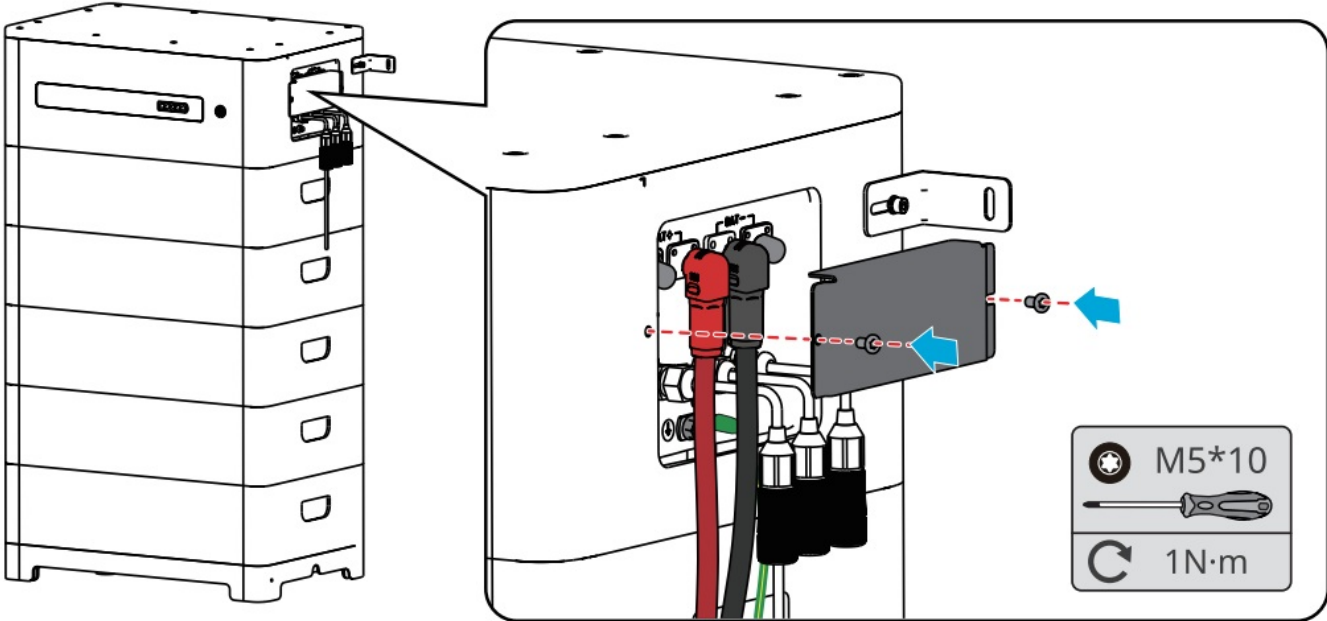

## Power ON and OFF

## NOTICE

The DC breaker between the inverter and the battery (DC Breaker 2), and between the two batteries (DC Breaker 5), shall be installed in accordance with local laws and regulations.

### Single battery system

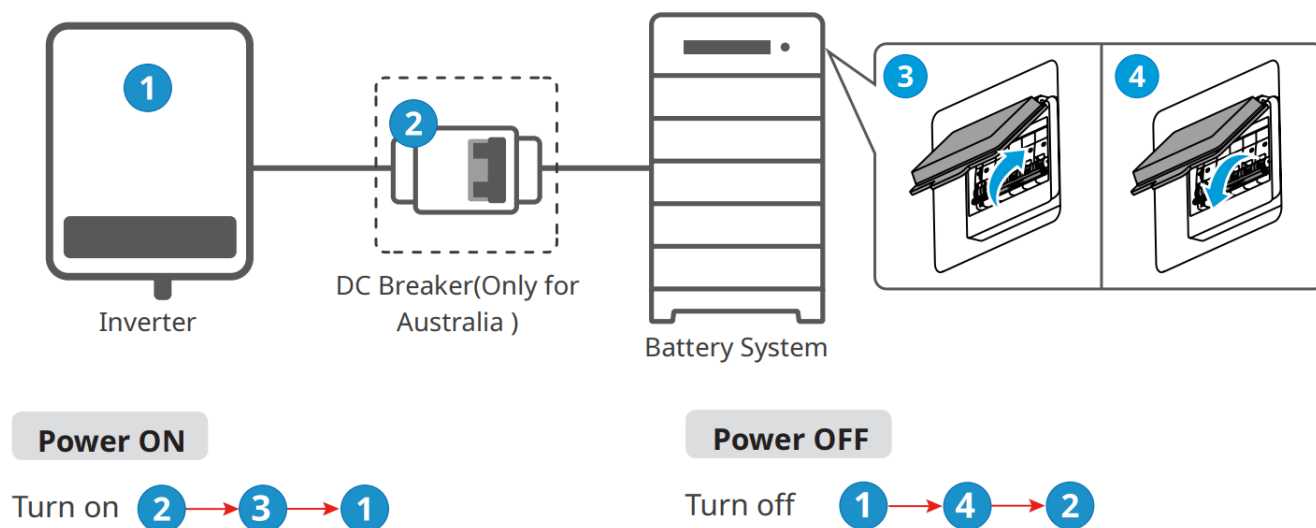

### Parallized battery systems

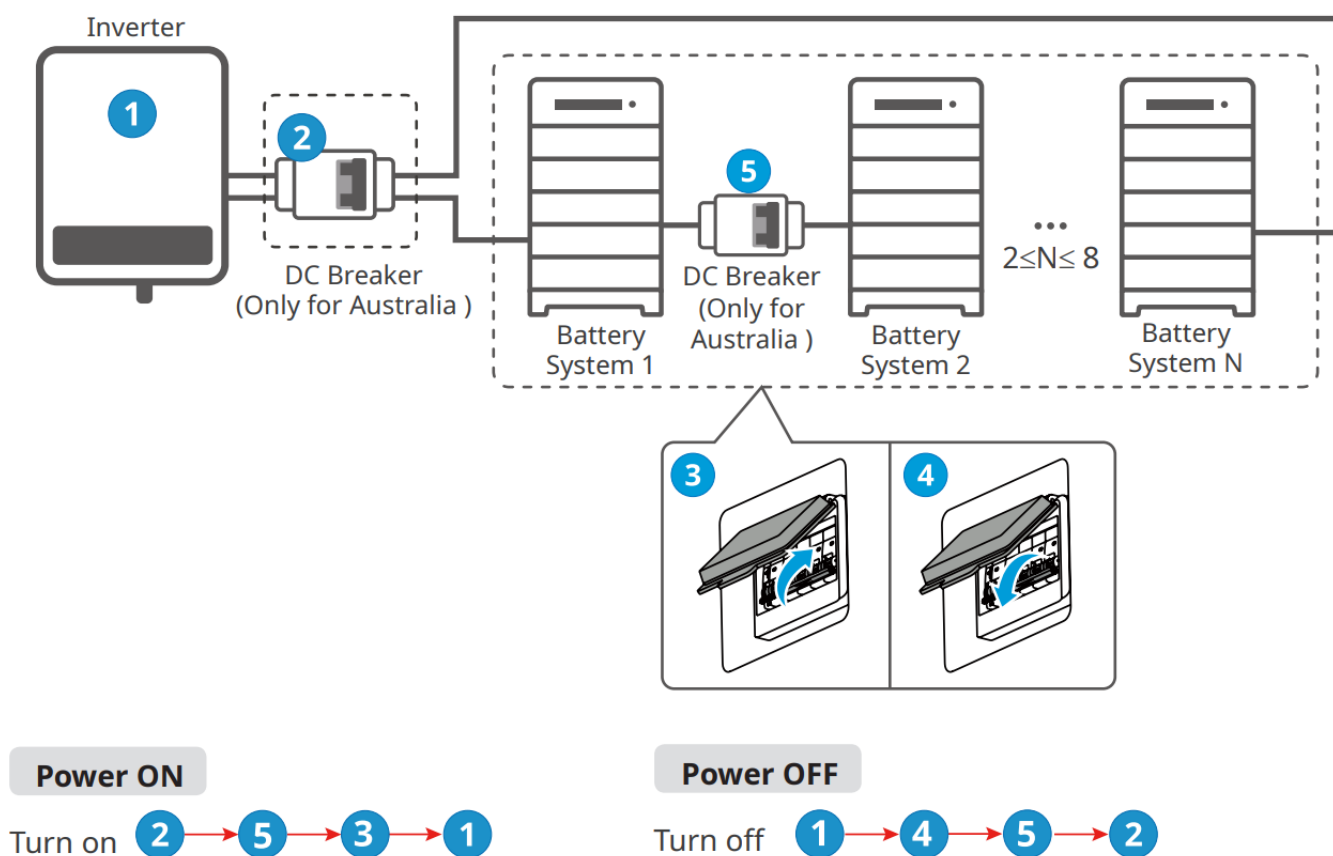

### Commissioning

#### Commissioning via SolarGo APP

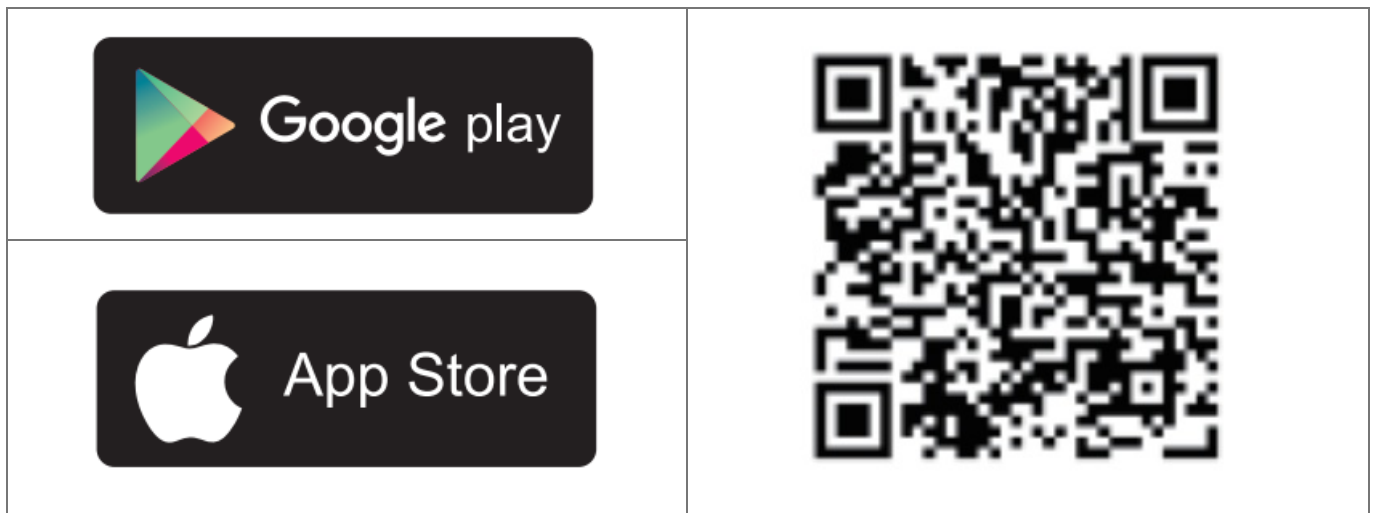

**Monitoring via SEMS Portal APP**

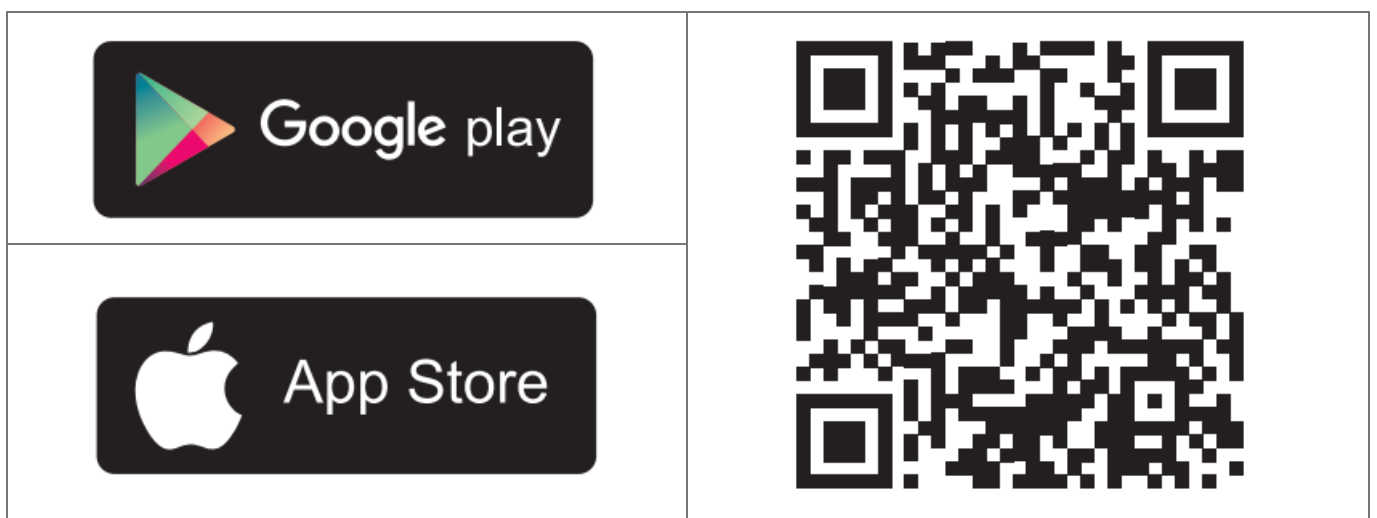

**For more information, please scan the following QR for User Manual.**

- Lynx Home F,Lynx Home F Plus+ Series User Manual



- SolarGo App User Manual



- SEMS Portal User Manual



## Customer Support



No. 90 Zijin Rd., New District, Suzhou, 215011, China



[www.goodwe.com](http://www.goodwe.com)



[service@goodwe.com](mailto:service@goodwe.com)



Documents / Resources

 <p><b>Quick Installation Guide</b> Rechargeable Lithium Ion Battery System LX F6.6-H, LX F9.8-H, LX F13.1-H, LX F16.4-H, LX F6.6-H Rechargeable Lithium Ion Battery System, LX F6.6-H, Rechargeable Lithium Ion Battery System, Lithium Ion Battery System, Ion Battery System, Battery System</p>	<p><a href="#">GOODWE LX F6.6-H Rechargeable Lithium Ion Battery System</a> [pdf] Installation Guide LX F6.6-H, LX F9.8-H, LX F13.1-H, LX F16.4-H, LX F6.6-H Rechargeable Lithium Ion Battery System, LX F6.6-H, Rechargeable Lithium Ion Battery System, Lithium Ion Battery System, Ion Battery System, Battery System</p>
--	--

References

- [W](#) \_\_\_\_\_
- [W](#) [GoodWe: Smart Energy Innovator](#)
- [W](#) [Warranty](#)