



GonHui B0B5D4J5FD RGB Smart Floor Lamp User Manual

[Home](#) » [GonHui](#) » GonHui B0B5D4J5FD RGB Smart Floor Lamp User Manual 

Contents

- 1 [GonHui B0B5D4J5FD RGB Smart Floor Lamp](#)
- 2 [Packing list](#)
- 3 [Precautions](#)
- 4 [How to install your floor lamp](#)
- 5 [How to control your lamp with the remote control](#)
- 6 [How to use your mobile phone to control floor lamp](#)
- 7 [Connect the floor lamp through the APP](#)
- 8 [APP Interface Display](#)
- 9 [Customize your light mode](#)
- 10 [DIV your floor lamp length](#)
- 11 [To control two or more RGB floor lamps simultaneously](#)
- 12 [Control the floor lamp with Alexa](#)
- 13 [Product specification](#)
- 14 [Documents / Resources](#)
 - 14.1 [References](#)
- 15 [Related Posts](#)

GonHui

GonHui B0B5D4J5FD RGB Smart Floor Lamp



Unpacking inspection

Thank you for purchasing our products. Please read this manual carefully before use. The manual contains necessary safety advice and instructions for use. Follow the manual to avoid damaging the product due to misuse. Check if the product is damaged when you receive it.

Packing list

- 4 removable tubes
- 1 Remote control
- 1 Controller
- 1 Base
- 1 Power adapter
- 1 User manual

Precautions

1. This product is an LED lamp, suitable for indoor use and decoration.
2. This product has no built-in battery and needs to be plugged in.
3. Children under 16 years of age should use it in the company of an adult.

How to install your floor lamp

- **Step 1:** The bottom nut hole of the round tube with the power cord, but the threaded rod of the disc base, and rotate to tighten
- **Step 2:** Install the remaining three lamp tubes in turn to complete the lamp body installation.

Note: The interface of the controller power cord must be installed in the correct direction, otherwise the product may be damaged and even cannot be used normally.

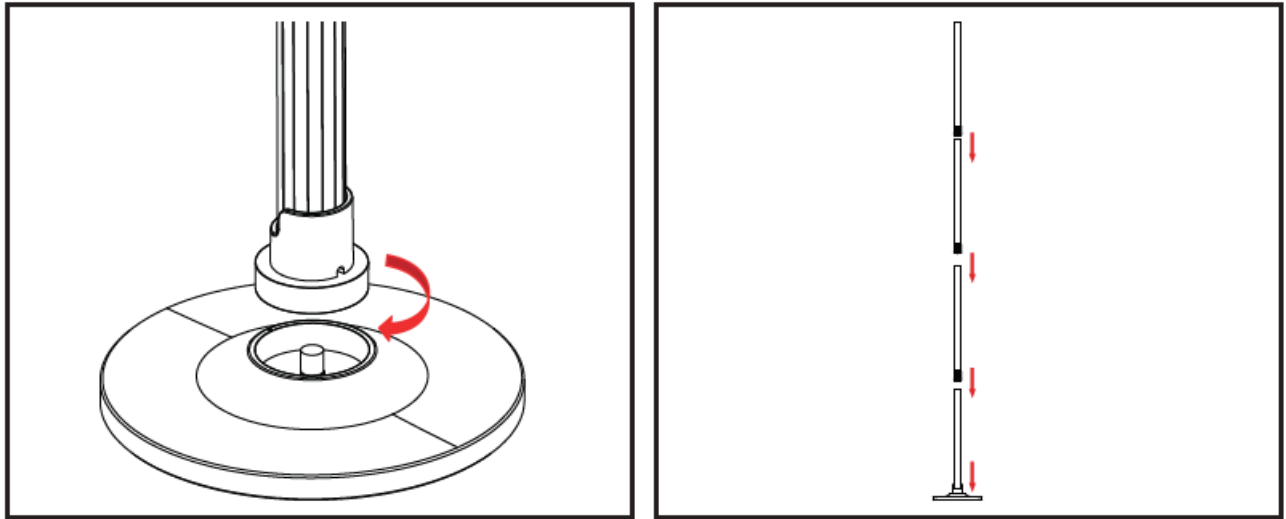

Finally, the power cord of the lamp body is plugged into the power supply and powered on for use.

How to control your lamp with the remote control

The instructions for the button functions of the remote control are shown below.

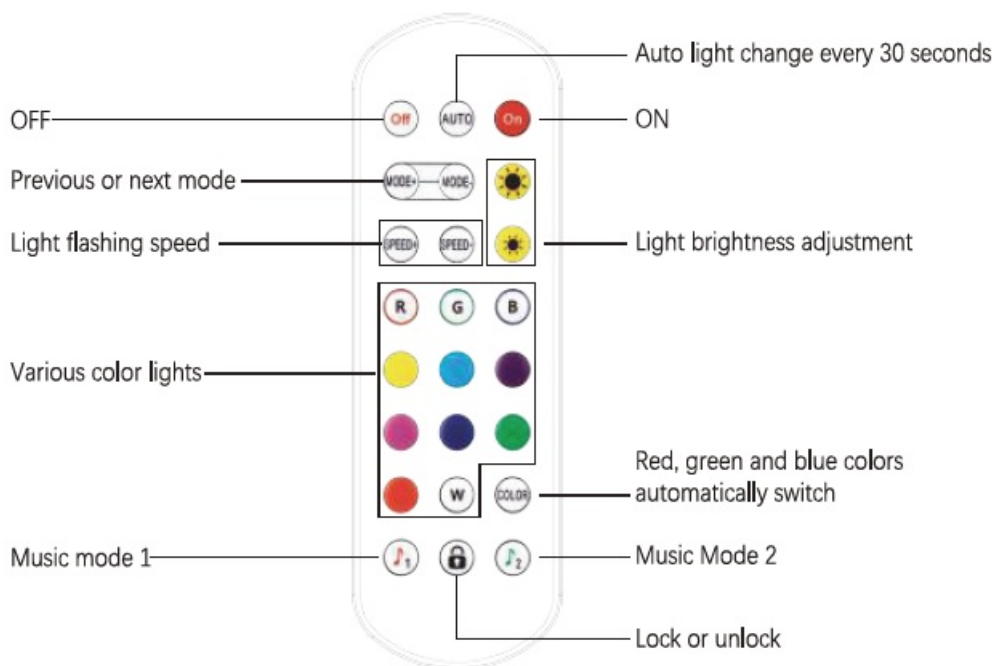

How to use your mobile phone to control floor lamp

Step 1: Install App

Scan the QR code below or search for “Smart Life” in the APP Store (for Apple IOS) and Google Play (for Android) and download and install it.

Note:

To ensure normal use, your mobile operating system must be Android 5.0 or iOS 9.0 or later.



Step 2: Run APP

- **Note:** The APP function only supports Wi-Fi connection to a 2.4GHz channel.
- Run the “Smart Life” App on your phone and click “Register” to create an account with your email address (sign in if you have one) and verify your account with the verification code sent to your email.

Connect the floor lamp through the APP

- **Step 1:** Open the App and click “+” to add a device.
- **Step 2:** Select Lighting– Strip Lights (Wi-Fi)
- **Step 3:** Select the 2.4GHZ WIFI wireless network enter the password (if the WIFI network has a password set) and log in to your WIFI network.

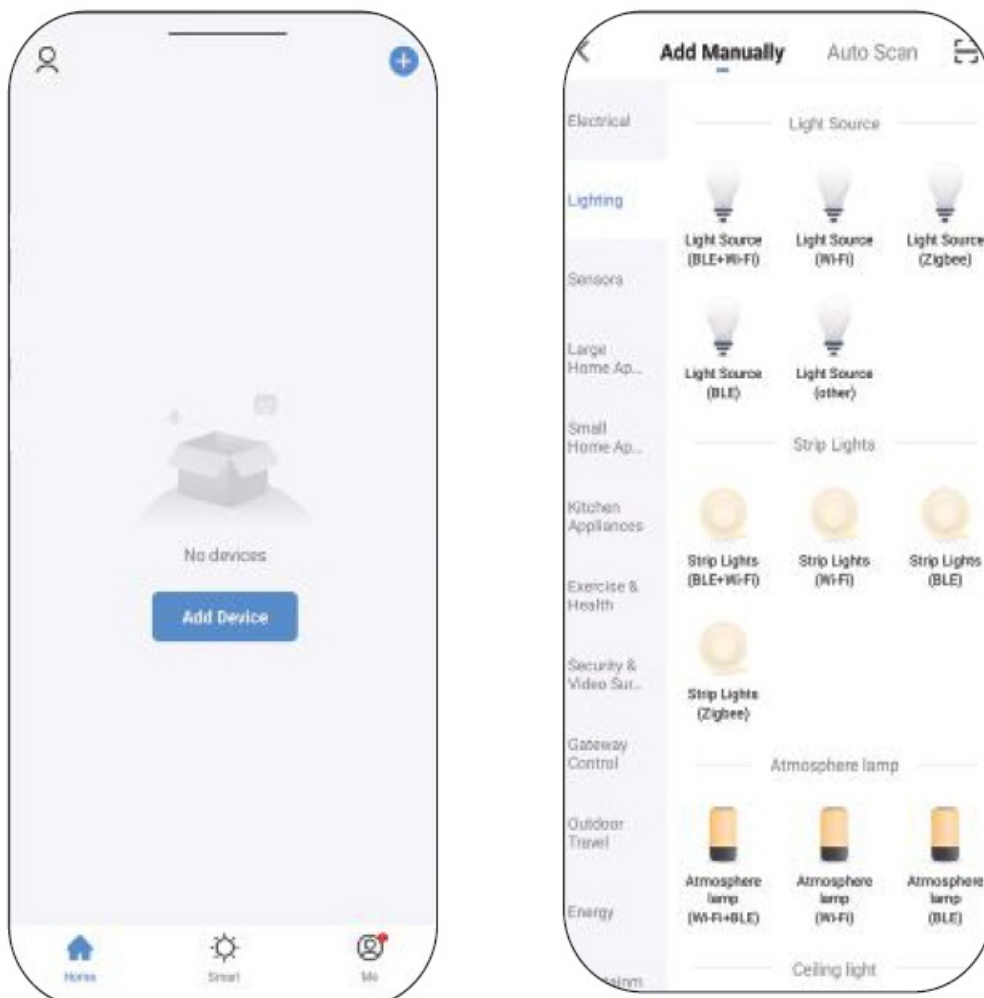

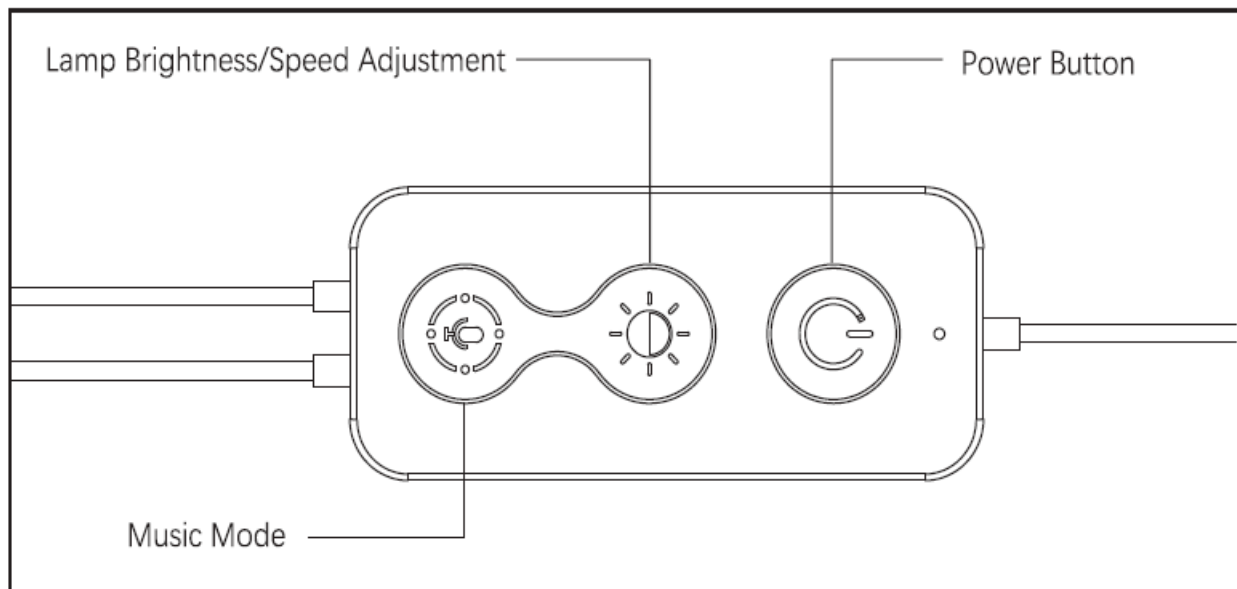

- **Step 4:** Confirm that the floor lamp is powered on, then long press the controller power button for 5 seconds, and then release it. The light will enter the flash mode (red light flashing uninterruptedly).
- **Step 5:** After confirming the light flash, directly click Next on the APP page. The connection will be OK in about 30 seconds.

Note: if the connection fails, please check whether your WiFi channel is 2.4GHz, power off and restart the floor lamp, let it flash again (red light flashing continuously), and connect WiFi again.

Note:

1. Only support 2.4GHz WI-FI
2. Restart the light, press and hold the controller for 5 seconds until the light flashes quickly, you can connect again

APP Interface Display

1. White Color mode

You can adjust color temperature and brightness



2. Color mode

You can adjust the color, saturation, and brightness.



1. Edit options
2. Various lighting modes
3. Set the number of control chips
4. Slide to change color
5. Drag to change brightness
6. Drag to change saturation
7. ON or OFF
8. Timed OFF
9. Schedule settings

3. Static mode

The system comes with 12 Static modes, including Candle, Christmas Candy, Santa Claus, Romantic, Green Rain, Blue Purple Strip, FireEye, Gold Ring, Fired Blue, Halloween, Super Man, and Dazzling.

4. Dynamic mode

The system comes with 12 Dynamic modes including Color Spectrum, Rainbow, Cylon, Confetti, Color Swing, Light Snow, Fire, Christmas Candy, Santa Claus, Halloween, Dazzling, and Party.



5. DIY mode

The system has 12 custom lighting modes preset, including Blink, Breath, Colorful Cylon, Color Wipe, Twinkle, BlueFire, Two Color Chase, One ColorChase, ThreeColorChase, Color Strip, Ribbon, Marquee.

6. Local music scene mode

The system comes with 7 music rhythm modes with a built-in high-sensitivity microphone, which can be used at a distance of 10m. The microphone sensitivity can be adjusted separately for each music rhythm scene, including Shooting Rainbow, Shooting Star, Falling Star, Sky Rainbow, Star Rainbow, Sky Star, Color Flow

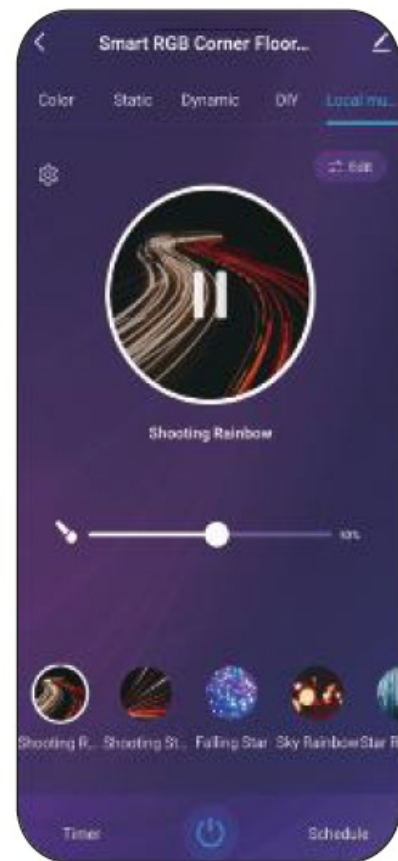
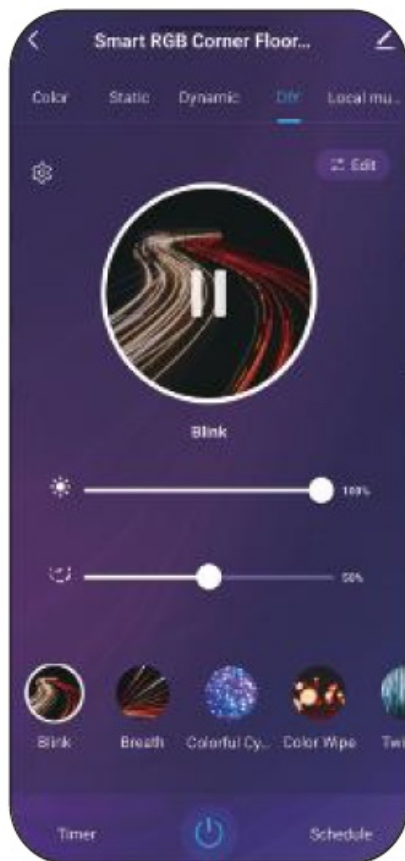

Customize your light mode

1. **Step 1:** Click "Edit" in DIY mode
2. **Step 2:** You can customize the name, picture, color, etc. of the light. If you still like the mode set by the system, you can click "Reset".



Click Edit



DIV your floor lamp length

1. The lamp consists of four removable tubes, so you can DIY single or multiple tubes for use.
2. Each tube has 8 control chips, and you can set the number of control chips to achieve DIY (single or multiple) tube light.

Methods:

Keep the number on the left "00"

1. When it is set to 08 units, only the lowest tube will light up.
2. When it is set to 16 units, the bottom two tubes will light up.
3. When it is set to 24 units, the bottom three tubes will light up.
4. When it is set to 32 units, all four tubes will light up.



To control two or more RGB floor lamps simultaneously

- **Method 1:** Use the remote control (effective range 30 degrees, 5m from the infrared receiver)
- **Method 2:** Use the Mobile APP (Smart Life)
 - **Step 1:** Add a new device according to the above steps
 - **Step 2:** Click Edit in the upper right corner, then click Create A Group, and add lights to be controlled at the same time in the group. A new control interface will be generated after saving.

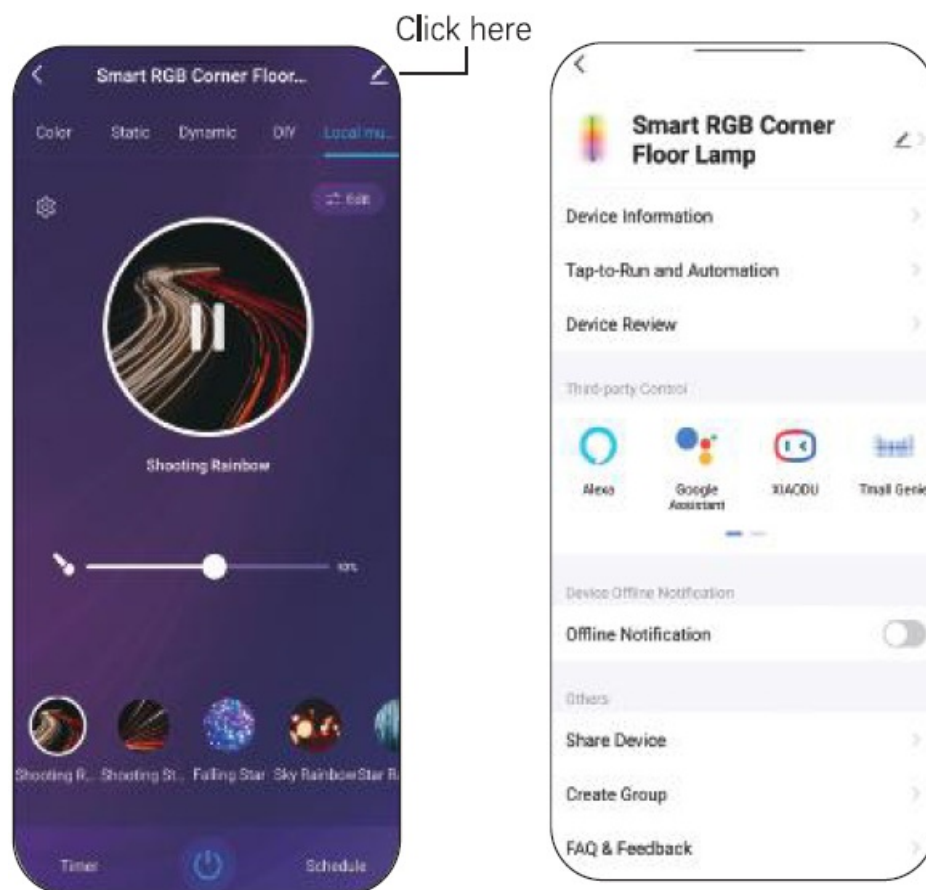

Control the floor lamp with Alexa

- **Step 1:** Click Alexa on the Smart Life App
- **Step 2:** Click “View more ways to link”, and then click “Link with Account Password”. Then you can play the video and see the detailed connection steps.



Product specification

Input power	12 V/2 A
Working Temperature	-15°C to +45°C
Material	PVC+ABS+ aluminum alloy
Lamp beads	96 Pcs
Luminance	1500 LM
Color Temperature	2200-6500K
Scene mode	43 Modes

Documents / Resources

	GonHui B0B5D4J5FD RGB Smart Floor Lamp [pdf] User Manual B0B5D4J5FD RGB Smart Floor Lamp, B0B5D4J5FD, RGB Smart Floor Lamp, Smart Floor Lamp, Floor Lamp, Lamp
---	---

References

- [User Manual](#)