



Golden Vision T1 Smart Camera User Manual

[Home](#) » [Golden Vision](#) » Golden Vision T1 Smart Camera User Manual 

Golden Vision T1 Smart Camera User Manual



Contents

- [1 Product Introduction](#)
- [2 Component Description](#)
- [3 Install APP](#)
- [4 Add The Device-Scan QR code mode](#)
- [5 The light](#)
- [6 Other Connection Methods](#)
- [7 Matters Need Attention](#)
- [8 FCC Statement](#)
- [9 Documents / Resources](#)
- [10 Related Posts](#)

Product Introduction

Packing list: Smart Camera x 1, Manual x 1, Power Adapter x 1, Screw Accessories Package x 1

- Smart Camera

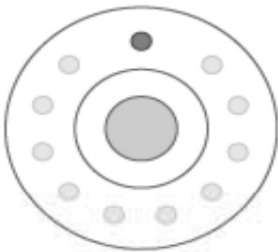

- Screw Accessories Package

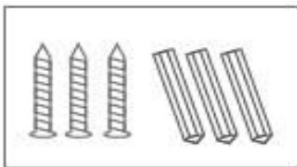

- Manual

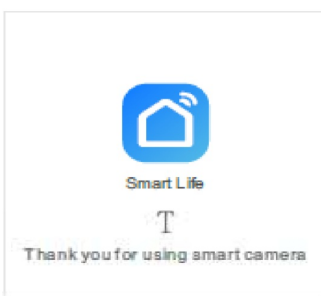

- Power Adapter

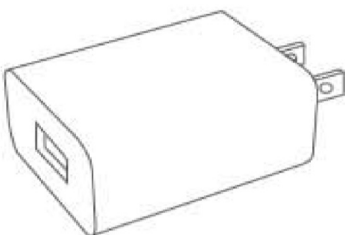

Basic Parameters

Product Name :Smart Camera		
Pixel	3.0MP	Wireless Encryption: WEP/WPA/WPA2 Encryption
	2.0MP	Power Input: 5V 1A(Min)
Video compression	H.265 High Profile	
	H.664 High Profile	
Image Enhancement :Digital Wide Dynamic 3D Noise Reduction		Total Power Consumption: 5W (Max)
Local Storage: MicroSD Card		Wireless Standard : 2.4G 802.11 b/g/n
Support Platform: Andriod/iOS		The Light: Full Color Night Vision
		Infrared Night Vision

Component Description

Reset Button: Long Press"reset" Hole 5sec Success.

It is Recommended To Insert 8-128GB High-Speed Micro SD Card, Otherwise It Will Not Be Able To Store ,View Historical Video and Support Important Functions Such As Firmware Upgrading

Install APP

Download App:Scan the QR Code Below to Download and Install.

Register and Login: Open the "Smart Life" APP To Register and Login According To The Prompts.



Add The Device-Scan QR code mode

- Make sure Wi-Fi is available and connected to the Internet.
- Connect the camera to the power. then system startup completed.
- Open "Smart Life" APP, press the '+' in the upper right corner of the main screen (Picture 01); choose "Security & Sensor", click "Smart Camera" (Picture 02) to add camera: and then click "Next step" (Picture 03)

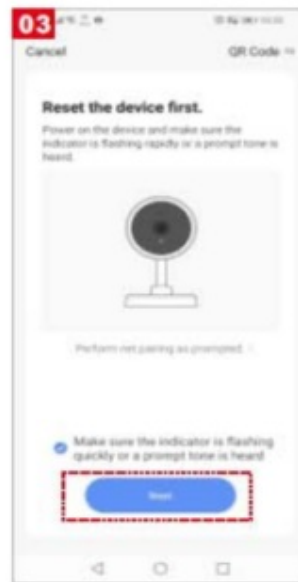
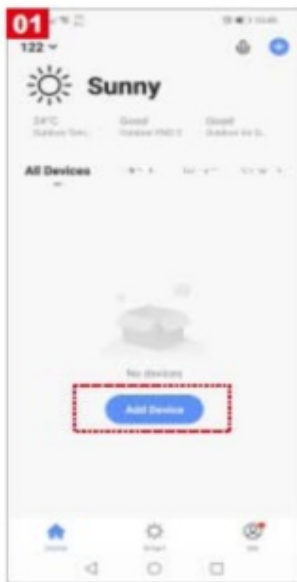

- If the mobile phone is not connected to wi-fi, please click “Connect to Wi fi” (Picture 04);
- It will skip to the WLAN interface and connects Wi-Fi (Picture 05). Please note that only 2.4 GH Wi-Fi network is supported;
- If the phone is connected to Wi-Fi (Picture 06);

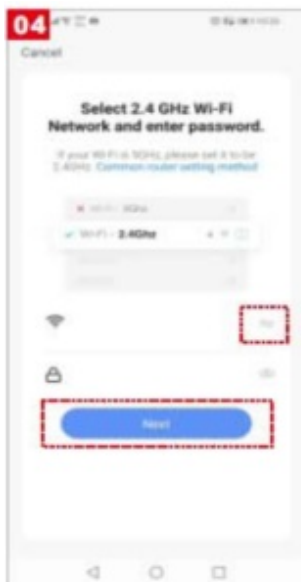

- A QR code will prompt on your screen and you need to scan it with the Smart Camera. (the camera is about 20-30 cm away from the mobile phone lens). Then click “hear the prompt sound” (Picture. 07).
- “connecting” (Picture. 08);



- connection completed(Picture 09), and click “Finish”;
- It will skip to preview interface (Picture 10)
- After closing the device preview interface, the interface returns to the APP home page. At this time, the connected device will appear on the APP home page (Picture 11). Then you can click directly to the device interface to see the monitoring situation without re-adding afterwards.

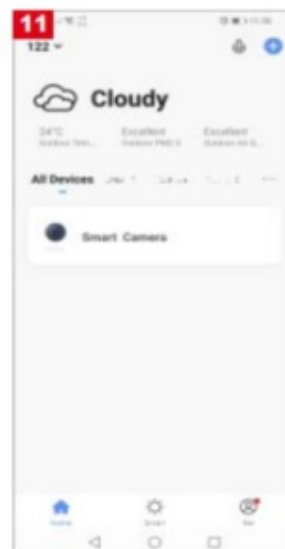
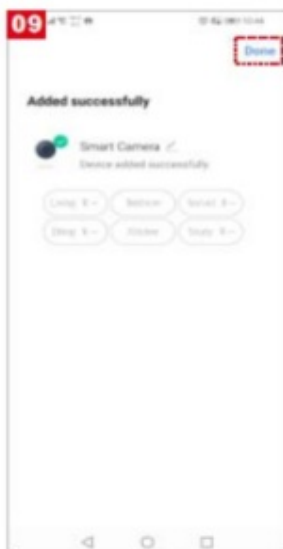

The light

Machine distinction: with light and with out light. Machine with lights, operation diagram.



Other Connection Methods



recommend 

1. QR Code

Camera Aiming At QR Code

2. AP Mode

Mobile Phone Search Machine Signal Code

3. EZ Mode

Mobile APP-wifi-Search Machine

Matters Need Attention

Try To Keep Away From The Metal Space:

Avoid The Furniture , Microwave Oven Blocked:

Avoid The Space Where The Audio,Video And Data Lines Are Wound, And Keep The Space Away From Them As Large As Possible:

Ensure That As Close As Possible To The Coverage Of Wireless Wi-Fi Signals .Switching Network Environment ,Please Press The Reset Hole About 5 Seconds ,Then Connect To The Network.

The name and content of the harmful substances in the product

	Harmful Substance					
Part Name	pb	Hg	Cd	Cr(VI)	PBB	PBDE
shell	0	0	0	0	0	0
Board	X	0	0	0	0	0
charger	0	0	0	0	0	0
annex	0	0	0	0	0	0
This form is based on the provisions of SJ/T 113640						

This product conforms to RoHS environmental protection requirements. At present, there is no mature technology in the world to replace or reduce the lead content in the electronic ceramics. porcelain, optical glass. steel and copper alloy.

Maintenance records: _____

Maintenance time: _____

Fault conditions: _____

Fault cause: _____

Troubleshooting : _____

Return and exchange proof: _____

Date of validity: _____

Original device ID: _____

New device ID: _____

maintenance personnel signature: _____

Maintenance Department seal: _____

FCC Statement

This equipment has been tested and found to comply with the limits for a Class B digital device, pursuant to part 15 of the FCC Rules. These limits are designed to provide reasonable protection against harmful interference in a residential installation. This equipment generates, uses and can radiate radio frequency energy and, if not installed and used in accordance with the instructions, may cause harmful interference to radio communications. However, there is no guarantee that interference will not occur in a particular installation. If this equipment does cause harmful interference to radio or television reception, which can be determined by turning the equipment off and on, the user is encouraged to try to correct the interference by one or more of the following measures:

- Reorient or relocate the receiving antenna.
- Increase the separation between the equipment and receiver.
- Connect the equipment into an outlet on a circuit different from that to which the receiver is connected.
- Consult the dealer or an experienced radio/TV technician for help.

Caution: Any changes or modifications to this device not explicitly approved by manufacturer could void your authority to operate this equipment. This device complies with part 15 of the FCC Rules. Operation is subject to the following two conditions: (1) This device may not cause harmful interference, and (2) this device must accept any interference received, including interference that may cause undesired operation.

RF Exposure Information:

This Equipment Complies with FCC Radiation Exposure Limits Set Forth For An Uncontrolled Environment .This Equipment Should Be Installed And Operated With Minimum Distance 20cm Between The Radiator And Your Body.

Documents / Resources

	Golden Vision T1 Smart Camera [pdf] User Manual T1, 2APD7-T1, 2APD7T1, T1 Smart Camera, Smart Camera
---	---