



# Godox TimoLink TX Wireless DMX Transmitter Instruction Manual

[Home](#) » [Godox](#) » Godox TimoLink TX Wireless DMX Transmitter Instruction Manual 

## Godox TimoLink TX Wireless DMX Transmitter Instruction Manual



### Foreword

Thank you for purchasing!

TimoLink TX is a plug-and-play wireless DMX transmitter that supports Type-C power supply. It can transmit DMX signals to wireless DMX transmitter TimoLink RX via 2.4G wireless within 300 meters, this series together are often used in large stage shows, concerts, bars, etc.



## Warning



Always keep this product dry. Do not use in rain or damp conditions.



Please reset the transmitter and receiver before connecting for better connection.



Do not leave or store the product if the ambient temperature reads over 45°C.



Do not disassemble. Should repairs become necessary, this product must be sent to our Company or an authorized maintenance center.

## Contents

[1 Name of Parts](#)

[2 Operation Instruction](#)

[3 Connection Illustration](#)

[4 Technical Data](#)

[5 Declaration of Conformity](#)

[6 Warranty](#)

[7 Maintenance and Service Support Information](#)

[8 Documents / Resources](#)

[9 Related Posts](#)

## Name of Parts

### TimoLink TX

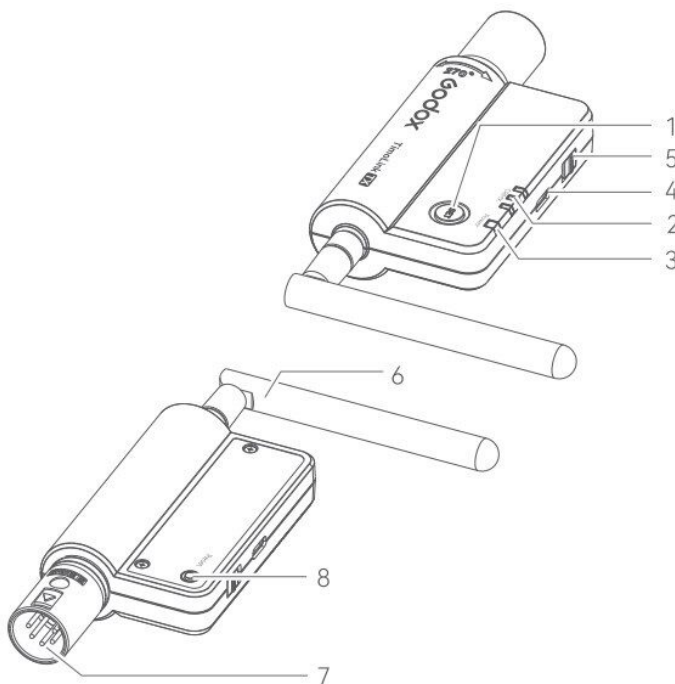

1. Set Button

2. Signal Indicator

3. Power Indicator
4. Type-C Port
5. DMX Test Button
6. Antenna
7. 5-pin DMX Male Port
8. Reset Button

### **TimoLink RX**

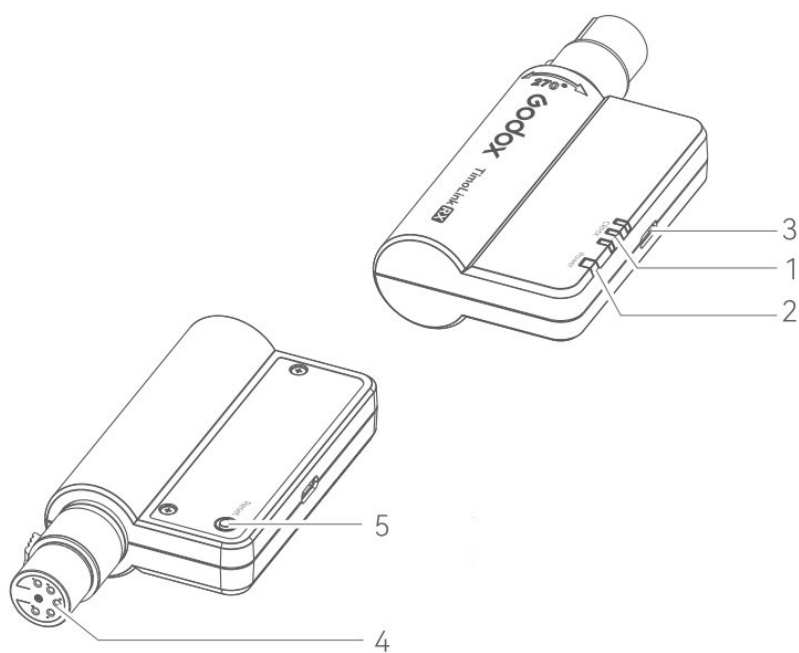

1. Signal Indicator
2. Power Indicator
3. Type-C Port
4. 5-pin DMX Female Port
5. Reset Button

### **Item List for TimoLink TX**

Wireless DMX Transmitter \*1



Instruction Manual \*1



Charging Cable +1

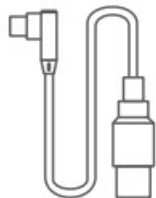

### Item List for TimoLink RX

Wireless DMX Receiver \*1



Charging Cable \*1

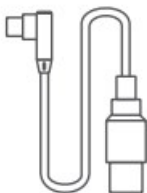

Instruction Manual +1



### Separately Sold Accessories



DMX Adapter DA5F3M

### Operation Instruction

1. Insert the transmitter TimoLink TX into the female port of DMX512 controller, connect to DC power source with charging cable.

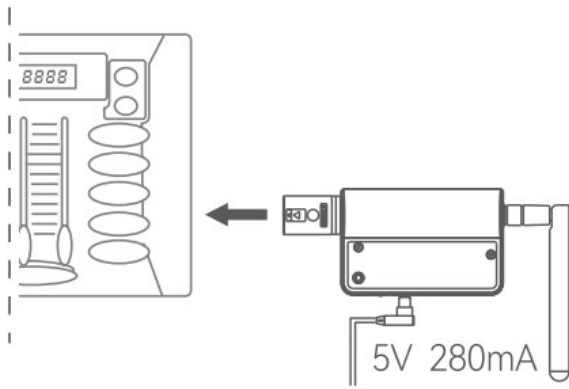

2. Insert the receiver TimoLink RX into the male port of the fixture, connect to DC power source with charging cable.

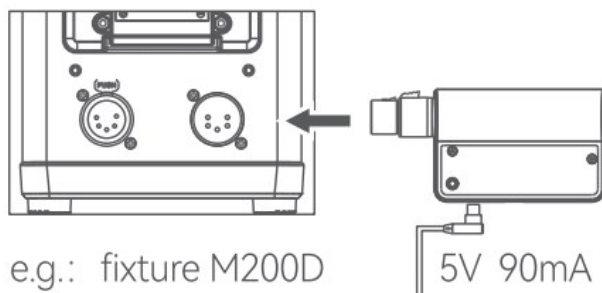

3. Short press the reset buttons of the transmitter TimoLink TX and receiver TimoLink RX to reset to them.

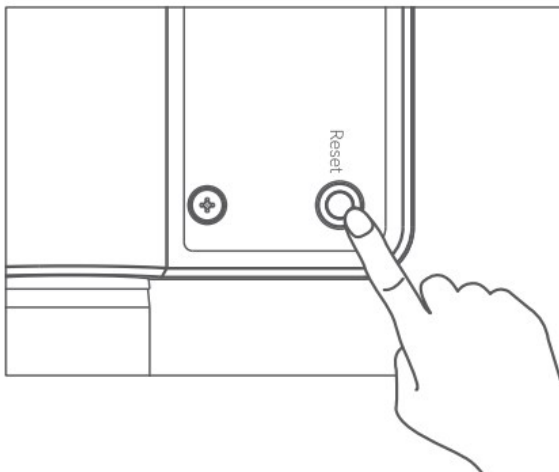

4. Short press the set button of transmitter TimoLink TX with the DMx test button off the signal indicator flashes quickly means connecting with the receiver TimoLink RX, the signal indicator flashes slow down means connected, then the transmitter and the receiver will be constant on the same color.

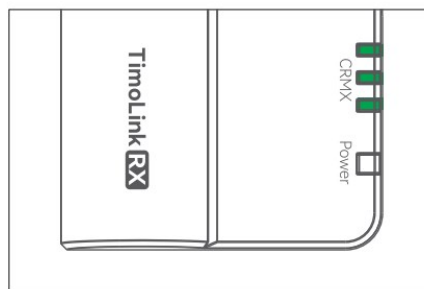
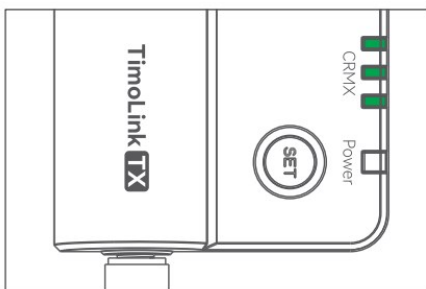

**Note:** When the transmitter is about to connect to multiple receivers, be sure to reset all receivers and connect them to power source, then short press the transmitters' 'set buttons to connect. Short press set button of the transmitter twice can switch the color of the signal indicator among 8 colors.

## DMX Testing Functions

In order to ensure the DMX signal is successfully outputted, toggle the

DMX test button to ON after the above settings of <Operation Instruction>. If there is DMX signal, the indicators of TX and RX will be constant on, and fixture will test the effects according to the established procedure, after which, please toggle the DMX test button to OFF.

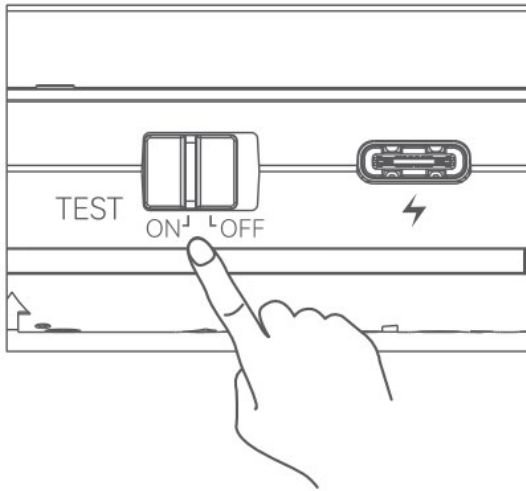

## Connection Illustration

### Multi fixtures controlled by one controller

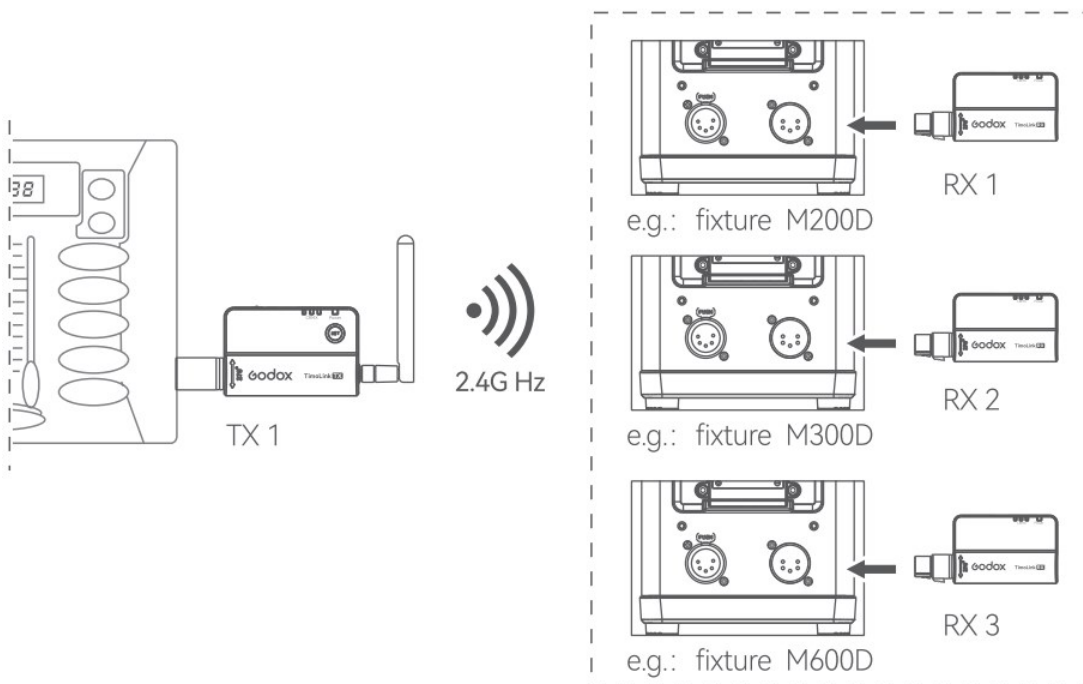

### Multi fixtures controlled by one controller

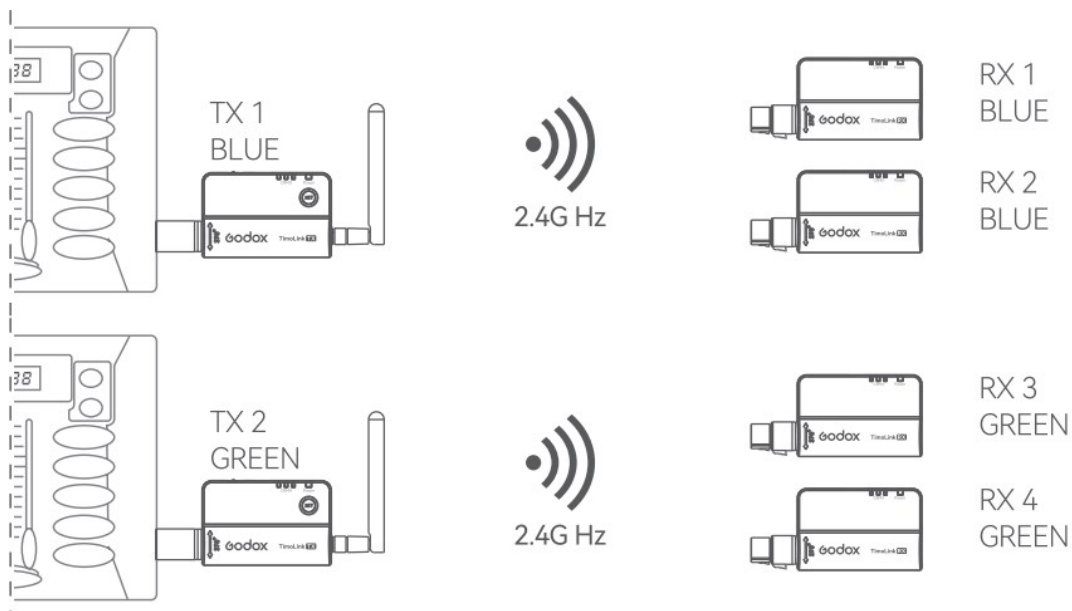

**Note:** The DMX512 controller is sold separately, and the pictures are for reference only.

## Technical Data

Name	WirelessDMX Transmitter	WirelessDMX Receiver
Model	TimoLink TX	TimoLink RX
Input Parameter	5V =280mA	5V =90mA
Colors of Signal Indicator	8	
Power Supply Port Compatible Models	Type-CDMX512 Controller /DMX240 Controller (incompatible with New Sunny 512 Controller)	Fixtures with DMX functions
DMX plug rotatable angle	270°	
Controlling Distance	Max. 300m(in an open and barrier-free environment)	
Working Environment Temperature	-20~45°C	
Dimension	141mm*96mm*26mm	110mm*53mm*26mm
Net Weight	89g	80g

## FCC

This device complies with part 15 of the FCC Rules. Operation is subject to the following two conditions:

- (1) This device may not cause harmful interference, and
- (2) this device must accept any interference received, including interference that may cause undesired operation.

Any Changes or modifications not expressly approved by the party responsible for compliance could void the user's authority to operate the equipment.

**Note:** This equipment has been tested and found to comply with the limits for a Class B digital device, pursuant to part 15 of the FCC Rules.

These limits are designed to provide reasonable protection against harmful interference in a residential installation. This equipment generates uses and can radiate radio frequency energy and, if not installed and used in accordance with the instructions, may cause harmful interference to radio communications. However, there is no guarantee that interference will not occur in a particular installation. If this equipment does cause harmful interference to radio or television reception, which can be determined by turning the equipment off and on, the user is encouraged to try to correct the interference by one or more of the following measures:

- Reorient or relocate the receiving antenna.
- Increase the separation between the equipment and receiver.
- Connect the equipment into an outlet on a circuit different from that to which the receiver is connected.
- Consult the dealer or an experienced radio/TV technician for help.

The device has been evaluated to meet general RF exposure requirement.  
The device can be used in portable exposure condition without restriction.

### Warning

**Operating frequency:** 2412.99MHz — 2464.49MHz

**Maximum EIRP Power:** 5dBm

### Declaration of Conformity

GODOX Photo Equipment Co.,Ltd. hereby declares that this equipment are in compliance with the essential requirements and other relevant provisions of Directive 2014/53/EU. In accordance with Article 10(2) and Article 10(10), this product is allowed to be used in all EU member states. For more information of DoC, Please click this web link: [https://www.godox.com/DOC/Godox\\_TimoLink\\_Series\\_DOC.pdf](https://www.godox.com/DOC/Godox_TimoLink_Series_DOC.pdf).

The device complies with RF specifications when the device used at Omm from your body.

### Warranty

Dear customers, as this warranty card is an important certificate to apply for our maintenance service, please fill in the following form in coordination with the seller and safekeep it.

Thank you!

Product Information	Model	Product Code Number
Customer Information	Name	Contact Number
	Address	
Seller Information	Name	
	Contact Number	
	Address	
	Date of Sale	
Note:		

**Note:** This form shall be sealed by the seller.



## **Applicable Products**

The document applies to the products listed on the Product Maintenance Information (see below for further information). Other products or accessories (e.g. promotional items, giveaways and additional accessories attached, etc.) are not included in this warranty scope.

## **Warranty Period**

The warranty period of products and accessories is implemented according to the relevant Product Maintenance Information. The warranty period is calculated from the day(purchase date) when the product is bought for the first time, And the purchase date is considered as the date registered on the warranty card when buying the product.

## **How to Get the Maintenance Service**

If maintenance service is needed, you can directly contact the product distributor or authorized service institutions, You can also contact the Godox after-sale service call and we will offer you service, When applying for maintenance service, you should provide valid warranty card, If you cannot provide valid warranty card, we may offer you maintenance service once confirmed that the product or accessory is, involved in the maintenance scope, but that shall not be considered as our obligation,

## **Inapplicable Cases**

'The guarantee and service offered by this document are not applicable in the following cases: (1), The product or accessory has expired its warranty period; (2), Breakage or damage caused by inappropriate usage, maintenance or preservation, such as improper packing, improper usage, improper plugging in/out external equipment, falling off or squeezing by external force, contacting or exposing to the improper temperature, solvent, acid, base, flooding and damp environments, etc; (3). Breakage or damage caused by non-authorized institution or staff in the process of installation, maintenance, alternation, addition and detachment; (4). The original identifying information of product or accessory is modified, alternated, or removed; (6). No valid warranty card; (6). Breakage or damage caused by using illegally authorized, nonstandard or non-public released software; (7). Breakage or damage caused by force majeure or accident; (8). Breakage or damage that could not be attributed to the product itself. Once met these situations above, you should seek solutions from the related responsible parties and Godox assumes no responsibility, The damage caused by parts, accessories and software that beyond the warranty period or scope is not included in our maintenance scope, The normal discoloration, abrasion and consumption are not the breakage within the maintenance scope,

## **Maintenance and Service Support Information**

The warranty period and service types of products are implemented according to the following Product Maintenance Information:

Product Type	Name	Maintenance Period(mon th)	Warranty Service Type
Parts	Circuit Board	12	Customer sends the product to d esignated site
	Battery	3	Customer sends the product to d esignated site
	Electricalparts e.g.battery char ger, etc.	12	Customer sends the product to d esignated site
Other Items	Flash tube, modeling lamp, la mp body,lamp cover, lockingde vice, package, etc.	No	Without warranty

Godox After-sale Service Call 0755-29609320-8062

## Documents / Resources

	<p><a href="#">Godox TimoLink TX Wireless DMX Transmitter</a> [pdf] Instruction Manual TimoLink TX Wireless DMX Transmitter, TimoLink RX, TimoLink TX Wireless DMX Transmitter, Wireless DMX Transmitter, DMX Transmitter, Transmitter</p>
---	--