

Godox TimoLink TRX Wireless DMX Transceiver



Godox TimoLink TRX Wireless DMX Transceiver Instruction Manual

[Home](#) » [Godox](#) » Godox TimoLink TRX Wireless DMX Transceiver Instruction Manual 

Contents

- [1 Godox TimoLink TRX Wireless DMX Transceiver](#)
- [2 Name of Parts](#)
- [3 What's Inside](#)
- [4 Operating Instruction](#)
- [5 Connect the "Godox KNOWLEDGE" App to the Fixture](#)
- [6 DMX Test Function](#)
- [7 Technical Data](#)
- [8 Warranty](#)
- [9 Maintenance and Service Support Information](#)
- [10 Documents / Resources](#)
 - [10.1 References](#)



Godox TimoLink TRX Wireless DMX Transceiver



Foreword

Thank you for purchasing

The Timolink TRX is a wireless transmitter and receiver device that combines both functions into one. It is plug-and-play and supports USB-C power supply. When used as a transmitter, it can be plugged into a DMX512 controller to remotely control lights with CRMX receiver functionality. Alternatively, it can be connected to "Godox KNOWLED" app to remotely control lights with CRMX receiver functionality. When used as a receiver, it can be plugged into lights that have OMX functionality but do not have CRMX receiver capability, allowing them to receive CRMX signals.

Warning

- Always keep this product dry. Do not use in rain or damp conditions.
- Do not leave or store the product if the ambient temperature reads over 50°C .
- Do not disassemble. Should repairs become necessary, this product must be sent to our company or an authorized maintenance centre.

Name of Parts

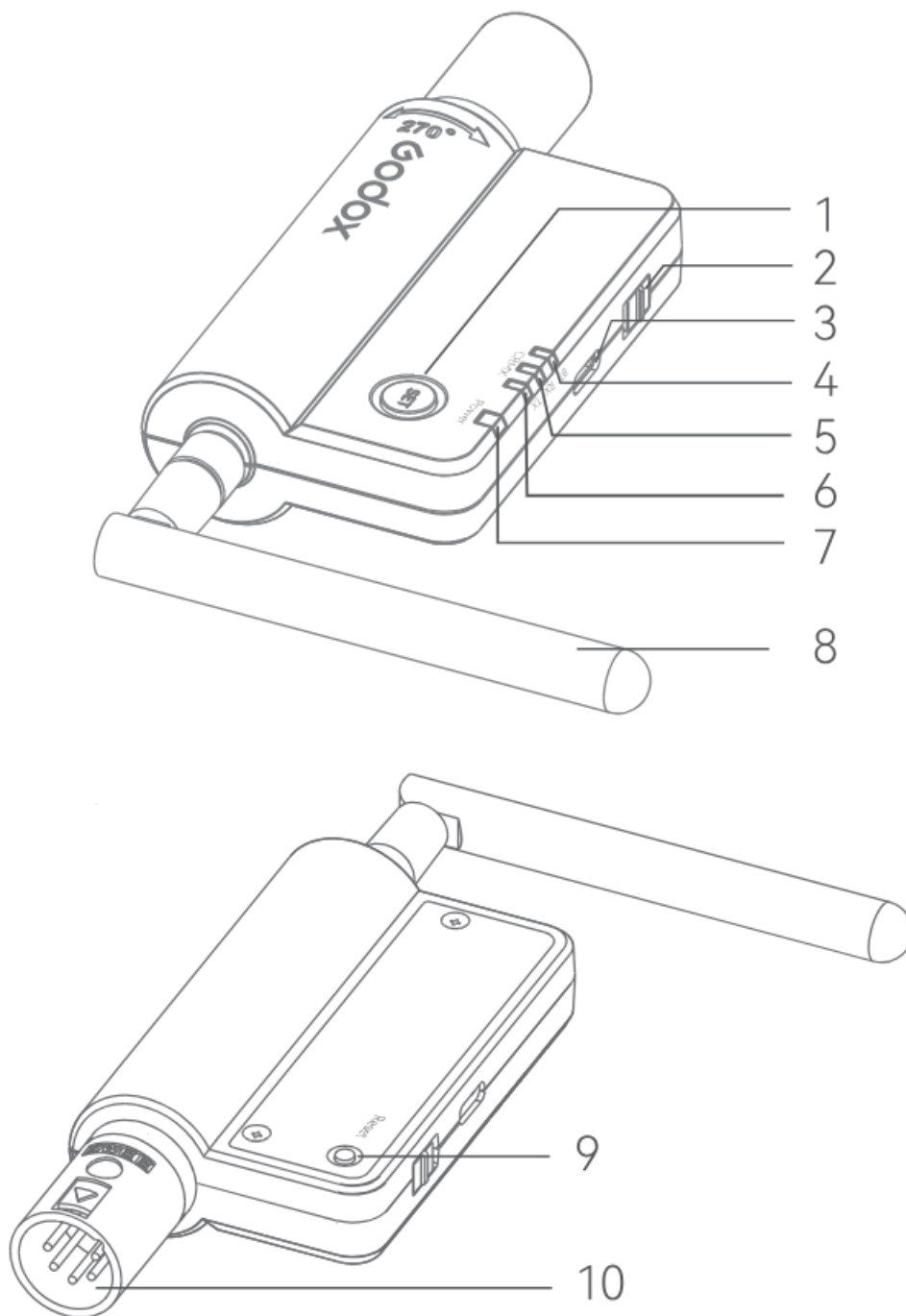

1. SET Button
2. DMX Test Button
3. USB-C Port
4. BT Signal Indicator
5. Receiver (RX) Indicator
6. Transmitter (TX) Indicator
7. Power Indicator
8. Antenna
9. Reset Button
10. 5-pin DMX Male Port

What's Inside



Wireless DMX Transceiver × 1

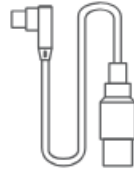

Charging Cable × 1



Instruction Manual×1

Optional Accessories



DMX Adapter DA5F3M

Operating Instruction

Check Mode/Check BT(Activate mode menu) The device combines both transmission and reception functions. You can simultaneously press the SET button and the Reset button to activate the mode menu, where you can check whether the device is in transmission mode or reception mode, and whether BT is turned on or off.

1. In transmission mode, the TX signal light will be on.
2. In reception mode, the RX signal light will be on.
3. When BT is turned on, the BT signal light will be on.
4. When BT is turned off, the BT signal light will be off.

Switching Modes

After activating the mode menu, press the SET button briefly to switch between transmission and reception modes.

Switching BT

After activating the mode menu, press the Reset button briefly to switch between turning on and off.

Connecting the Controller with the Fixtures

The following instructions are based on using one Timolink TRX as the transmitter and one Timolink TRX as the receiver

1. **Transmitter:** Insert the transmitter into the female connector of the DMX512 controller, and use the charging cable to connect to the DC power supply. Simultaneously press the SET button and the Reset button to activate the mode menu. Press the SET button to switch to the transmit mode. Once the settings are complete, simultaneously press the SET button and the Reset button to exit the mode menu.

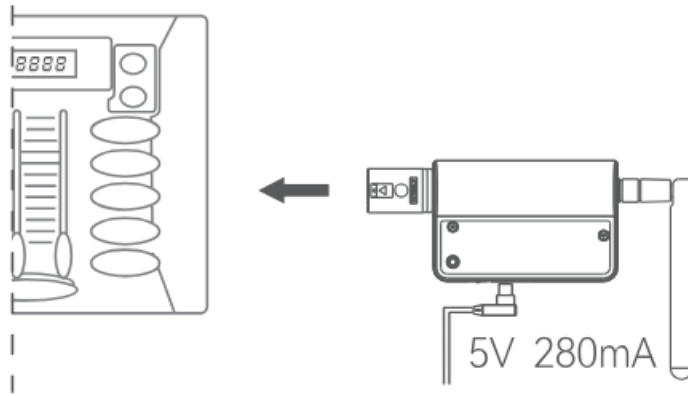

2. **Receiver:** Insert the receiver into the fixture's DMX 5-pin female port, using the charging cable to connect to the DC power supply. Simultaneously press the SET button and the Reset button to activate the mode menu. Press the SET button to switch to receiver mode. Once the settings are complete, simultaneously press the SET button and the Reset button to exit the mode menu.

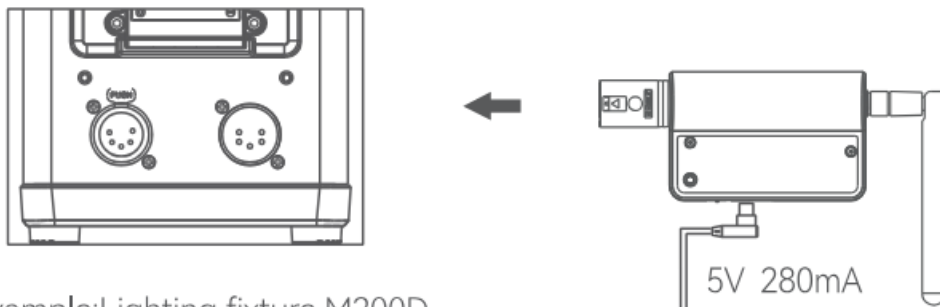

Example: Lighting fixture M200D

3. The test button on the transmitter should be turned OFF. Press the SET button on the transmitter once, and the signal indicator light will start flashing rapidly, indicating that it is connecting with the receiver. Once the connection is successful, the signal indicator light will change to a slow flash. At this point, both the transmitter and receiver will have the same colour for their signal indicator lights

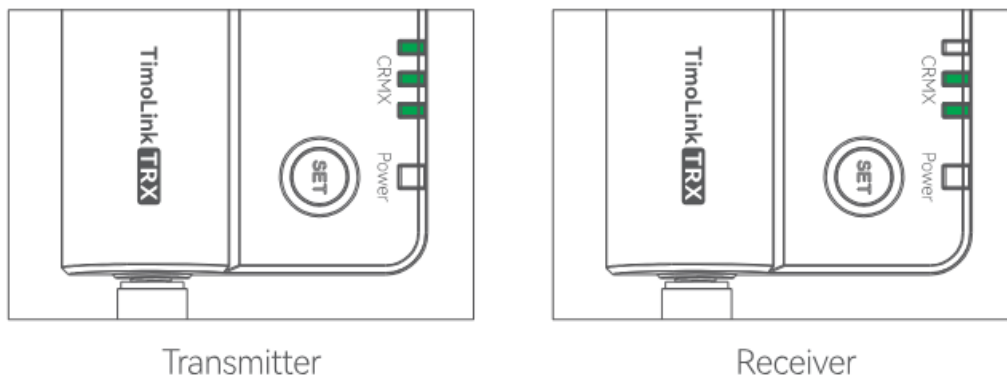

Note:

- The transmitter and receiver have been paired with other devices before, press the RESET button to unpair them.
- After unpairing the transmitter, all paired receivers will be unpaired simultaneously (except for those not powered on or out of range)

Connect the “Godox KNOWLEDGE” App to the Fixture

The following instructions are based on using one Timolink TRX as the transmitter and another Timolink TRX as

the receiver.

1. **Transmitter:** Connect the DC power supply using the charging cable. Press and hold the SET button+ Reset button to activate the mode menu. Then, press the SET button briefly to switch to the transmitter mode. Press the Reset button briefly to enable BT. Once the settings are done, press and hold the SET button+ Reset button to exit the mode menu.

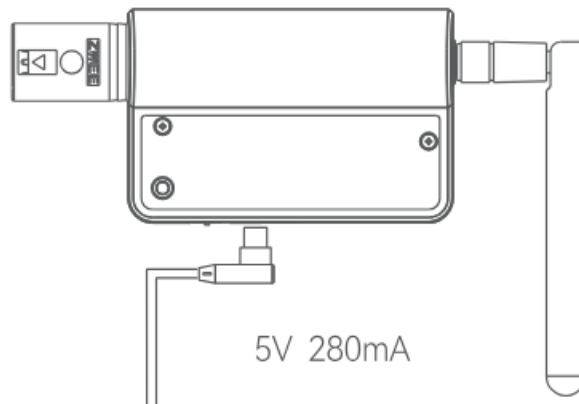

2. “Godox KNOWLED” App:

Scan the QR code to download “God ox KN OWLED” app on your tablet



“Godox KNOWLED” App Settings: Register and log in to your app account → Create a project → Create a scene → Enter device settings → Connect configuration → Select BT Select BT, the interface displays as follows: Multiple available BT devices are shown on the interface. Click on the BT “Timolink TRX” to connect the transmitter. After a successful connection, the interface displays “Connection successful”

Note: BT on the tablet needs to be turned on in order to establish a successful connection. If BT is not enabled, please check if BT is turned on and authorize the current app on iOS tablets. For Android tablets, please check if BT and system location are turned on and authorize the current app. God ox KN OWLED App only supports BT communication devices with LumenRadio CRMX modules

3. **Receiver:** Insert the receiver into the OMX 5-pin female-port, and connect it to a DC power source using a charging cable. Press the SET button and Reset reset button simultaneously to activate the mode menu. Press the SET button to switch to receiver mode, and press the Reset reset button to enable BT. After setting is done, press the SET button and Reset reset button simultaneously to exit the mode menu.

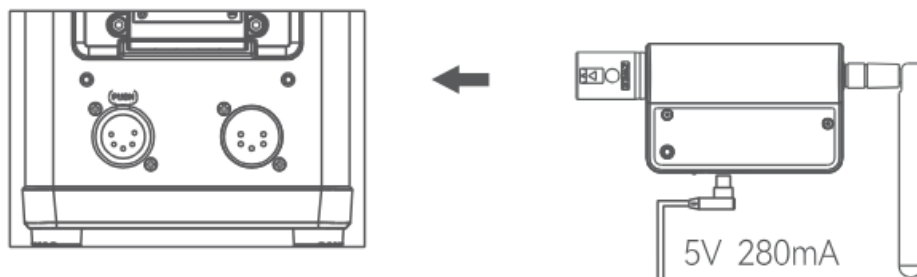

Example: Lighting fixture M200D

4. The test button on the transmitter should be set to OFF (closed). Press the SET button on the transmitter once,

and the signal indicator light will start flashing quickly, indicating that it is connecting to the receiver. After a successful connection, the signal indicator light will change from fast flashing to slow flashing. At this point, the signal indicator lights on the transmitter and receiver will be the same colour.

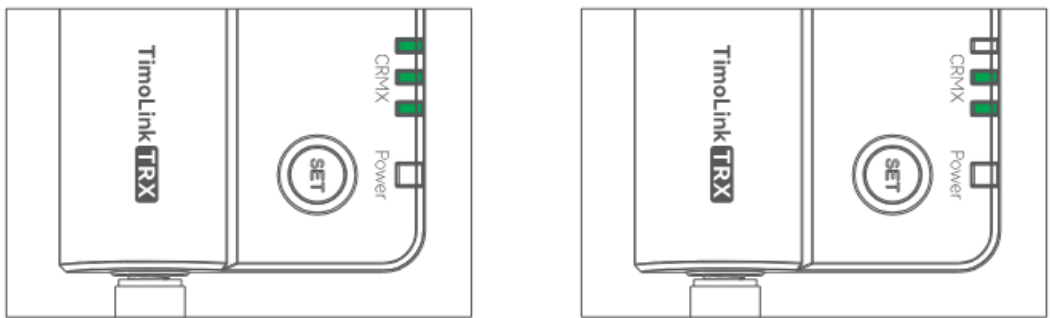

Note:

1. If the transmitter and receiver have been previously paired with other devices, press the RESET button to unpair them.
2. When the transmitter is unpaired, all currently paired receivers will also be unpaired at the same time (except for those not powered on or out of control range)
3. When connecting the transmitter to multiple receivers, make sure all receivers are powered on before pressing the SET button on the transmitter to connect.
4. Pressing the SET button on the transmitter twice can toggle the color of the signal indicator light, with a total of eight colors available.

DMX Test Function

To ensure the successful output of the DMX signal, follow the instructions provided above for setup. Once the setup is complete, switch the OMX test switch to the ON position. If an OMX signal is present, both the transmitter and receiver signal indicator lights will remain constantly lit. The lighting fixture will undergo a predefined program to test the lighting effects. After completing the test, switch the OMX test switch to the OFF position. Only then will the controller be able to control the lighting fixture.

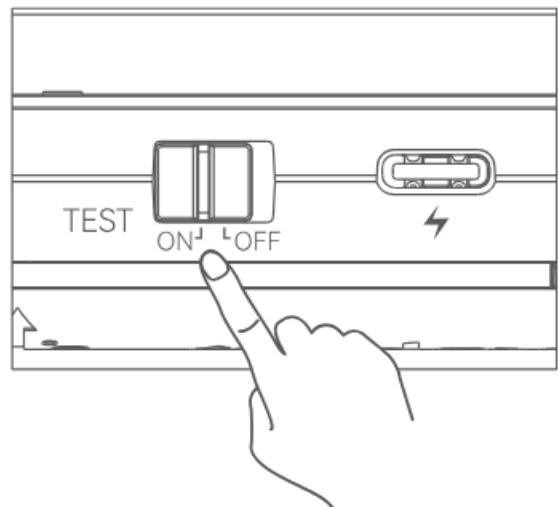

Special Note

- When the machine is in transmit mode, the signal indicator light will be at maximum level

- When the machine is in receive mode, the test button and SET button do not function. This is not a malfunction but a normal behavior.
- In the BT connection control status, the machine testing function is invalid. You can perform data transmission tests through the App.

Connection Display

When one controller controls multiple lighting fixtures

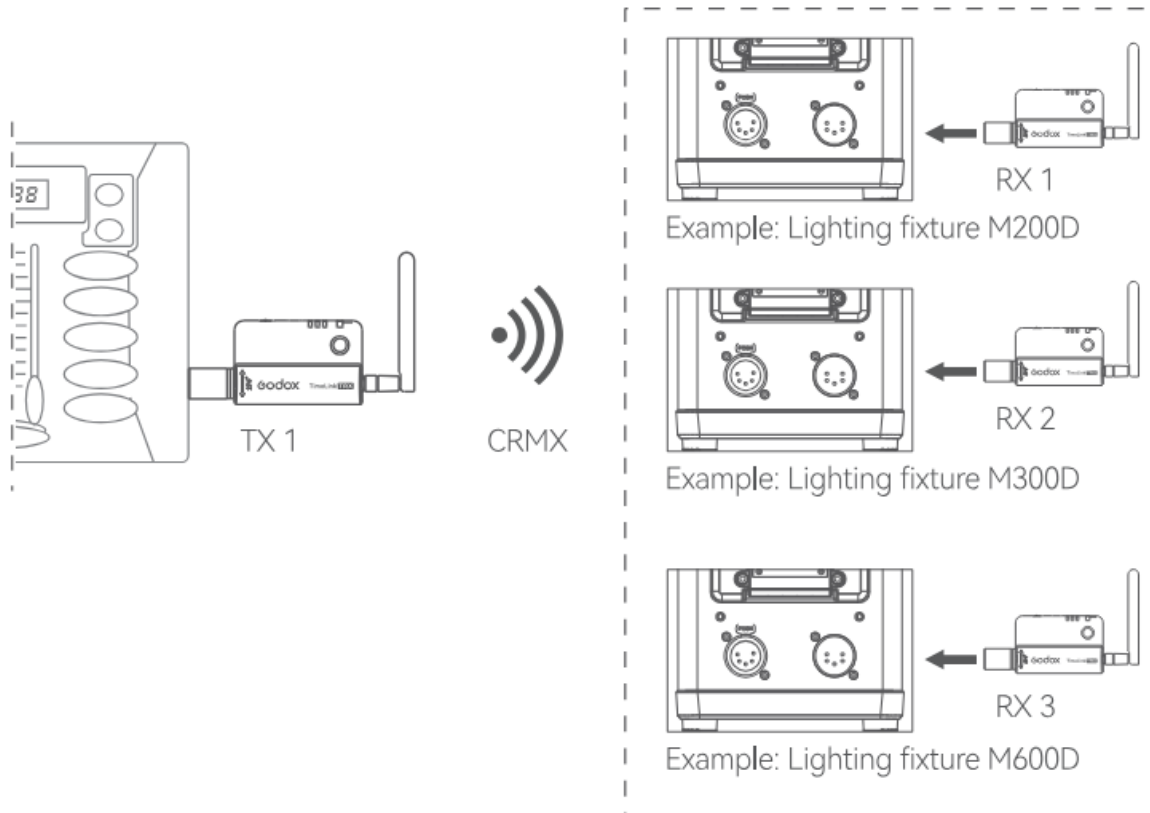

When multiple consoles control multiple lighting fixtures:

TX 1
Indicator light: Blue.

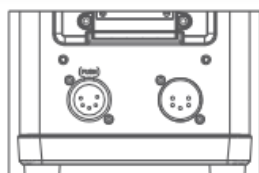
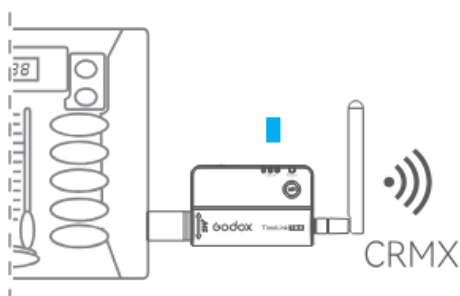

Example:
Lighting fixture M200D



RX 1
Indicator light: Blue.

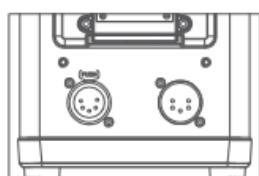

Example:
Lighting fixture M200D



RX 2
Indicator light: Blue.

TX 2
Indicator light: Green.

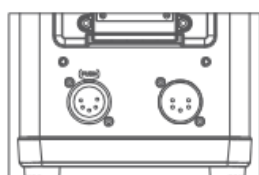
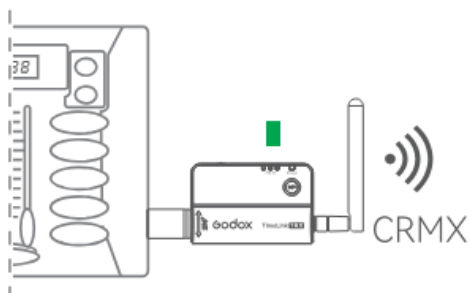

Example:
Lighting fixture M200D



RX 3
Indicator light: Green.

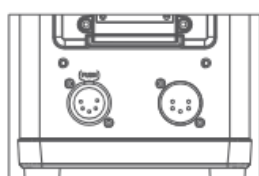

Example:
Lighting fixture M200D



RX 4
Indicator light: Green.

Note: The DMX512 controller needs to be purchased separately. The above illustrations are for reference purposes only

When the “Godox KN OWLED” App controls lighting fixtures with a built-in CRMX receiver

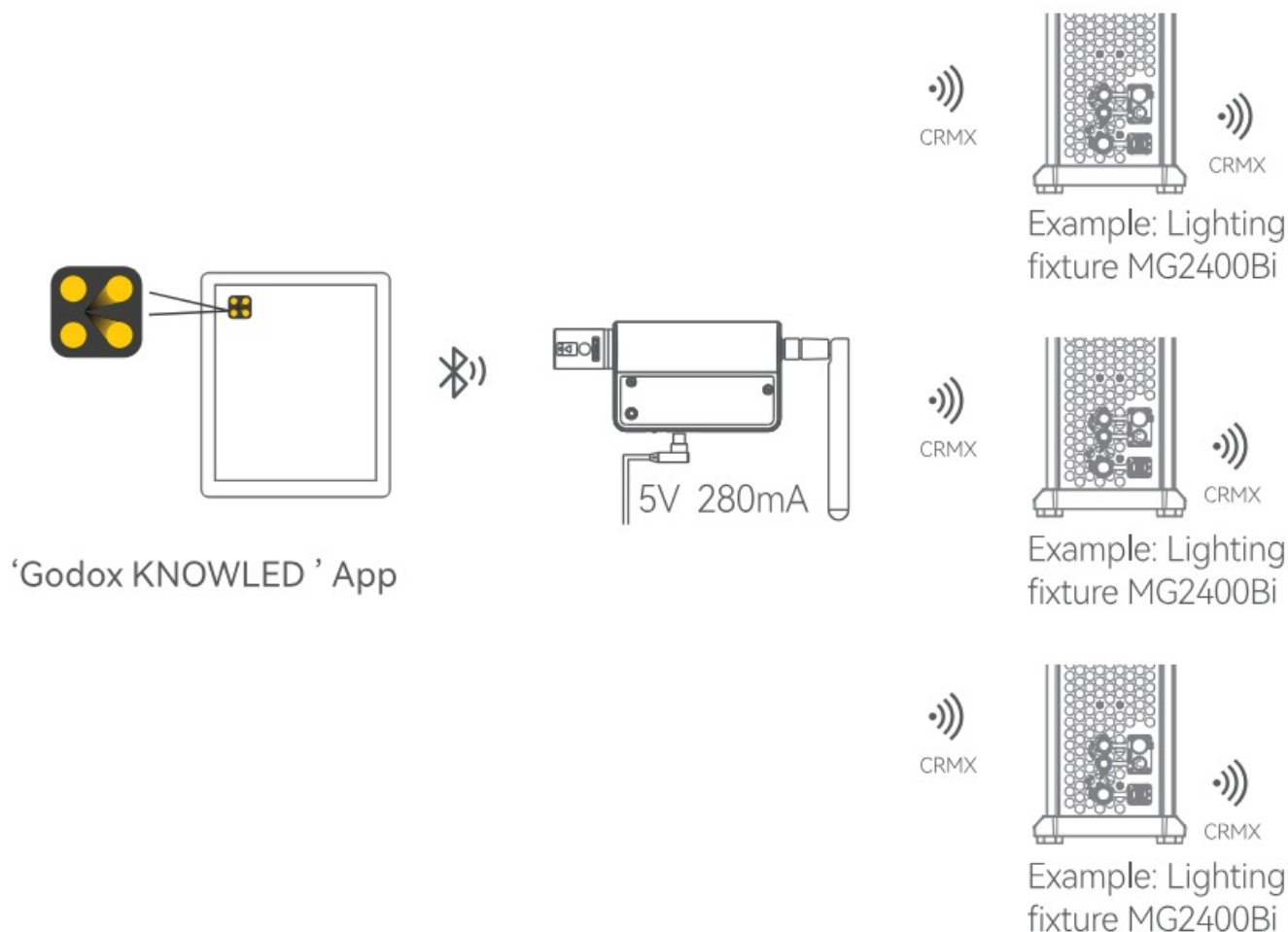

When “Godox KNOWLED” App controls lighting fixtures with DMX capabilities but without CRMX receiver function

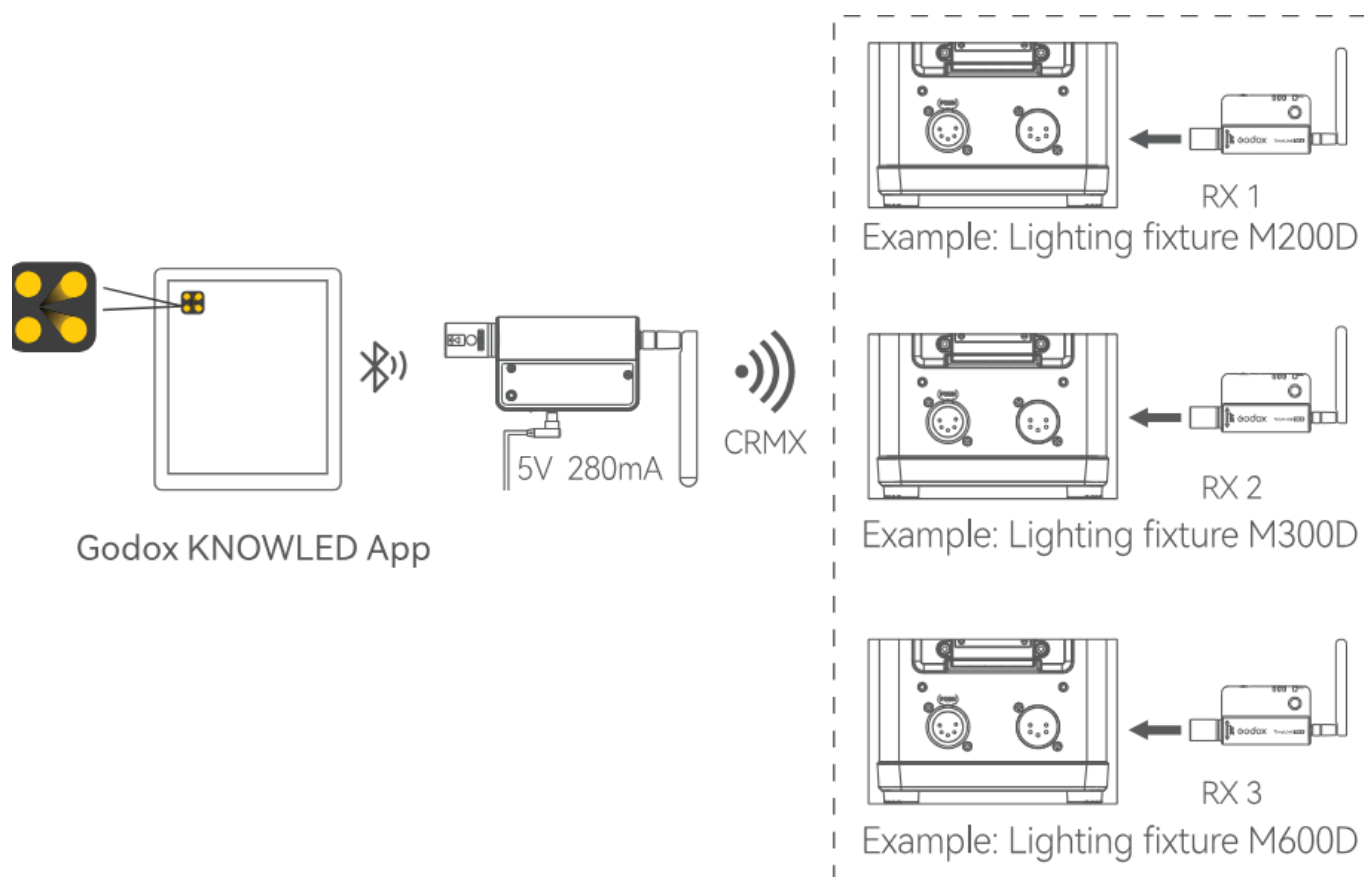

Technical Data

Model	TimoLink TRX
Input Parameter	5V---280mA
Colors of Signal Indicator	8 types
Power Supply Port	USB-C
Compatible Devices	DMX512 Controller/DMX240 Controller/Fixture with DMX functionality/"Godox KNOWLED "App
DMX Plug Rotatable Angle	270°
CRMX Transmission Distance	Max. 200m (In an open environment)
BT Transmission Distance	Max. 30m (In an open environment)
Working Environment Temperature	-20~45°C
Dimension	5.55" × 3.78" × 1.02"
Net Weight≈	90g

FCC Statement

This device complies with part 15 of the FCC Rules.

Operation is subject to the following two conditions:

1. This device may not cause harmful interference, and
2. this device must accept any interference received, including interference that may cause undesired operation.

Any Changes or modifications not expressly approved by the party responsible for compliance could void the user's authority to operate the equipment.

Note: This equipment has been tested and found to comply with the limits for a Class B digital device, pursuant to part 15 of the FCC Rules.

These limits are designed to provide reasonable protection against harmful interference in a residential installation. This equipment generates uses and can radiate radio frequency energy and, if not installed and used in accordance with the instructions, may cause harmful interference to radio communications. However, there is no guarantee that interference will not occur in a particular installation.

If this equipment does cause harmful interference to radio or television reception, which can be determined by turning the equipment off and on, the user is encouraged to try to correct the interference by one or more of the following measures:

- Reorient or relocate the receiving antenna.
- Increase the separation between the equipment and receiver.
- Connect the equipment into an outlet on a circuit different from that to which the receiver is connected.
- -Consult the dealer or an experienced radio/TV technician for help. The device has been evaluated to meet

general RF exposure requirement.

The device can be used in portable exposure condition without restriction.

Warning

- **Operating frequency:** 2402MHz- 2480MHz
- **Maximum EIRP Power:** 5dBm

Declaration of Conformity

GODOX Photo Equipment Co.,Ltd. hereby declares that this equipment are in compliance with the essential requirements and other relevant provisions of Directive 2014/53/EU. In accordance with Article 10(2) and Article 10(10), this product is allowed to be used in all EU member states. For more information of Doc, Please click this web link <https://www.godox.com/eu-declaration-of-conformity/> The device complies with RF specifications when the device is used at 0mm from your body.

Warranty

Dear customers, as this warranty card is an important certificate to apply for our maintenance service, please fill in the following form in coordination with the seller and safe keep it. **Thank you!**

Model	TimoLink TRX
Input Parameter	5V---280mA
Colors of Signal Indicator	8 types
Power Supply Port	USB-C
Compatible Devices	DMX512 Controller/DMX240 Controller/Fixture with DMX functionality/"Godox KNOWLED "App
DMX Plug Rotatable Angle	270°
CRMX Transmission Distance	Max. 200m (In an open environment)
BT Transmission Distance	Max. 30m (In an open environment)
Working Environment Temperature	-20~45°C
Dimension	5.55" × 3.78" × 1.02"
Net Weight≈	90g

Note: This form shall be sealed by the seller.

Applicable Products

The document applies to the products listed on the Product Maintenance Information (see below for further information). Other products or accessories (e.g. promotional items, giveaways and additional accessories attached, etc.) are not included in this warranty scope.

Warranty Period

The warranty period of products and accessories is implemented according to the relevant Product Maintenance Information. The warranty period is calculated from the day(purchase date) when the product is bought for the first time, And the purchase date is considered as the date registered on the warranty card when buying the product.

How to Get the Maintenance Service

If maintenance service is needed, you can directly contact the product distributor or authorized service institutions. You can also contact the Godox after-sale service call and we will offer you service. When applying for maintenance service, you should provide valid warranty card. If you cannot provide valid warranty card, we may offer you maintenance service once confirmed that the product or accessory is involved in the maintenance scope, but that shall not be considered as our obligation.

Inapplicable Cases

The guarantee and service offered by this document are not applicable in the following cases:

1. The product or accessory has expired its warranty period;
2. Breakage or damage caused by inappropriate usage, maintenance or preservation, such as improper packing, improper usage, improper plugging in/out external equipment, falling off or squeezing by external force, contacting or exposing to the improper temperature, solvent, acid, base, flooding and damp environments, etc;
3. Breakage or damage caused by non-authorized institution or staff in the process of installation, maintenance, alternation, addition and detachment;
4. The original identifying information of product or accessory is modified, alternated, or removed;
5. No valid warranty card;
6. Breakage or damage caused by using illegally authorized, nonstandard or non-public released software;
7. Breakage or damage caused by force majeure or accident;
8. Breakage or damage that could not be attributed to the product itself.

Once met these situations above, you should seek solutions from the related responsible parties and Godox assumes no responsibility. The damage caused by parts, accessories and software that beyond the warranty period or scope is not included in our maintenance scope. The normal discoloration, abrasion and consumption are not the breakage within the maintenance scope.

Maintenance and Service Support Information

The warranty period and service types of products are implemented according to the following Product Maintenance Information:

Product Type	Name	Maintenance Period (month)	Warranty Service Type
Parts	Circuit Board	12	Customer sends the product to designated site
	Battery	3	Customer sends the product to designated site
	Electrical parts e.g.battery charger, etc.	12	Customer sends the product to designated site
Other Items	lamp body, lamp cover, lockingdevice, package, etc.	No	Without warranty

Godox After-sale Service Call 0755-29609320-8062

Documents / Resources

	Godox TimoLink TRX Wireless DMX Transceiver [pdf] Instruction Manual TimoLink TRX Wireless DMX Transceiver, TimoLink, TRX Wireless DMX Transceiver, Wireless DMX Transceiver, DMX Transceiver, Transceiver
---	---

References

- [User Manual](#)

[Manuals+](#), [Privacy Policy](#)

This website is an independent publication and is neither affiliated with nor endorsed by any of the trademark owners. The "Bluetooth®" word mark and logos are registered trademarks owned by Bluetooth SIG, Inc. The "Wi-Fi®" word mark and logos are registered trademarks owned by the Wi-Fi Alliance. Any use of these marks on this website does not imply any affiliation with or endorsement.