



Godox Cube-C RX Receiver Instruction Manual

[Home](#) » [Godox](#) » Godox Cube-C RX Receiver Instruction Manual 

Godox Cube-C RX Receiver Instruction Manual



Contents

- 1 Foreword
- 2 Main Feature
- 3 Warning
- 4 Name of Parts
- 5 What's Inside
- 6 Power Switch
- 7 Pairing
- 8 Denoise
- 9 Charging
- 10 Mode Switch
- 11 Output Volume Adjustment
- 12 Instructions for Connection
- 13 Technical Data
- 14 Maintenance
- 15 Warning
- 16 Declaration of Conformity
- 17 FCC Statement
- 18 Marking Information
- 19 Warranty
- 20 Maintenance and Service Support Information
- 21 Documents / Resources
 - 21.1 References
- 22 Related Posts

Foreword

Thank you for purchasing!

Godox is proud to introduce the latest receiver of the wireless microphone system Cube-C RX. With the characteristics of compact and portable, plug and play, 2.4GHz wireless transmission, as well as compatibility with various smartphones and cameras, it's quite suitable for live streaming, interview, short video recording, outdoor shooting, etc.

Please read this manual carefully before using to make sure the correct operation and exert the optimum function.

Main Feature

- Globally universal 2.4GHz wireless transmission technology.
- The maximum wireless transmission distance up to 300m (sight distance) after paired with transmitter.
- Supports computer UAC function, also use and charge at the same time.
- Switchable mono, stereo and safety modes.
- One key noise reduction function, plug and play.
- Compatible with various smartphones and cameras.

Note: The transmitter is sold separately.

Warning

- This product is high-precision instrument, please avoid falling, collision or pounding.
- Do not disassemble. Should repairs become necessary, this product must be sent to our Company or an authorized maintenance center.

- Always keep this product dry. Do not use in rain or damp conditions.
- Do not leave or store this product in the environment of direct sunlight, near heating devices, or in hot, humid or dusty.
- Keep out of reach of children.
- Do not use in flammable and explosive environments. Pay attention to the relevant warning signs.
- Do not leave or store the product if the ambient temperature reads over 50°C.
- Please read carefully and follow the warnings or instructions provided by the manufacturer.

Name of Parts

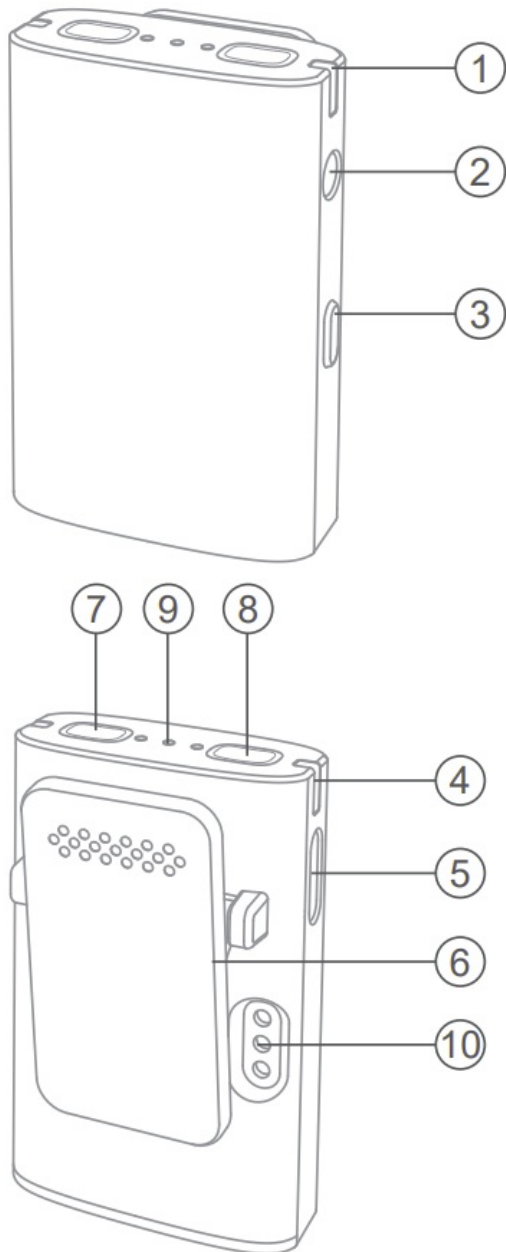

1. TX1 Indicator
2. 3.5mm Audio Output Port
3. Power Switch/Pairing/ Denoise Button
4. TX2 Indicator
5. USB-C Por
6. Back Clip

7. Mode/Volume – Button
8. Safety/ Volume + Button
9. Volume/ Safety/Mode Indicator
10. Charging Points

Note:

Due to continuous updates and upgrades of the products, there may be differences between the actual products and the pictures. Therefore, the pictures are for reference only, products to prevail in kind.

What's Inside

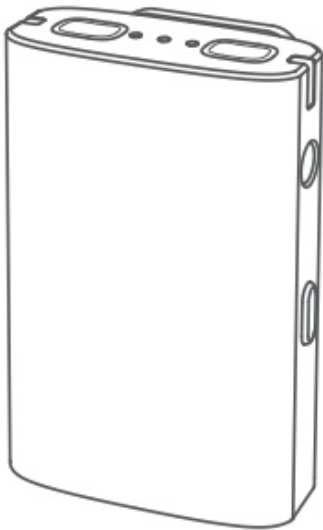

Receiver ×1

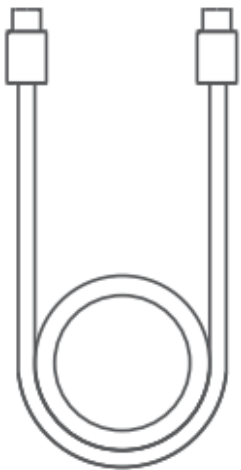

USB-C Charging Cable ×1



Instruction Manual ×1

Power Switch

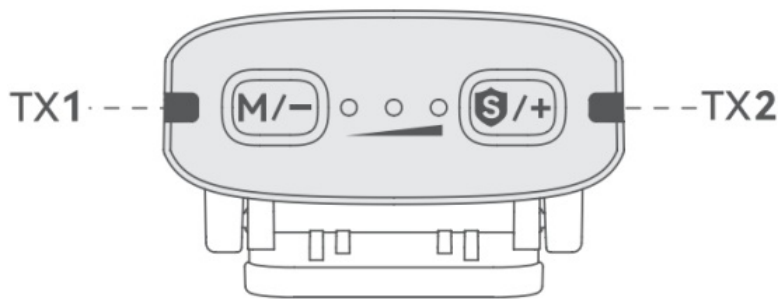

Long press the power switch button <  > for 2s to turn on or off the receiver.

 **Flash green → Unpaired after powered on**

Note: The receiver will be turned off if it stays unpaired in 5min after powered on.

Pairing

Short press twice the pairing button <  > to pair it with the transmitter. It will exit pairing status once paired, while exit after 10s if unpaired.

 **Flash green rapidly → Pairing status**

 **Constant on green → Paired**

Denoise

Short press the denoise button <  > to turn on or off the denoise function.

 →  **Constant on orange → Denoise function is on**

Charging

The receiver can be charged after connecting to power source through the USB-C charging cable. TX1 and TX2 indicators of receiver can show the battery levels of both the transmitters and receivers.

 TX1 and TX2 indicators are **constant on red** → **Battery level of receiver is low**, please charge it or switch to DC power supply

 TX1 indicator or TX2 indicator **flashes red** → **Battery level** of TX1 or TX2 transmitter is **low**

 **Indicator breathes blue** → **Charging**

 **Indicator is constant on blue** → **Fully Charged**

Mode Switch

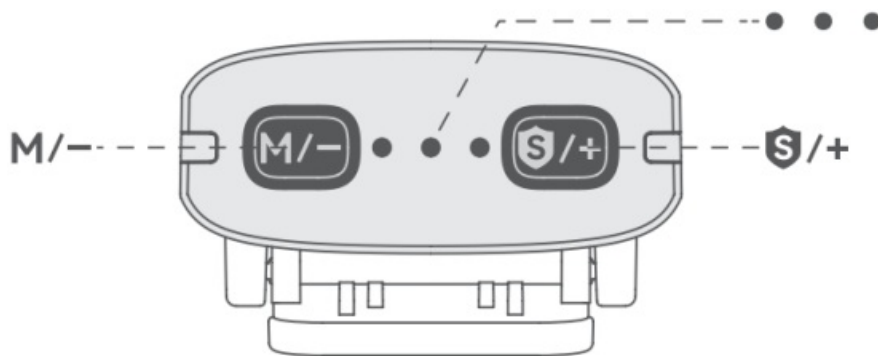

The sound track mode of receiver is **mono** by default, long press the mode/volume – button < **M/-** > for 2s can switch to **stereo** track mode, long press again can switch back to mono track mode.

The **safety** mode is also available, which can be turned on in mono track by default, and the right channel will record the audio with -6dB gain.

Long press the safety/volume + button < **S/+** > for 2s can turn on or off the **safety** mode.

< ● ● ● > **Constant on green** → **Mono mode**

< ● ● ● > **Constant on blue** → **Stereo mode**

< ● ● ● > **Breathes green** → **Safety mode**

Note: The stereo and safety modes are only available when connecting the receiver with a camera by 3.5mm TRS cable.

Output Volume Adjustment

Short press the safety/volume + button < **S/+** > or mode/volume – button < **M/-** > to enter volume adjustment status, then short press the volume + button or volume – button in 3s can adjust the output volume in 3 levels. The volume is the middle level by default after first boot.

< ● > **One** indicator is on → **Lowest** volume level

< ● ● > **Two** indicators are on → **Medium** volume level

< ● ● ● > **Three** indicators are on → **Highest** volume level

Instructions for Connection

1. Install onto Cameras

Clip the receiver to the camera with its back clip, then connect the 3.5mm audio output port of receiver to the 3.5mm audio input port of camera with the 3.5mm TRS-TRS audio cable.

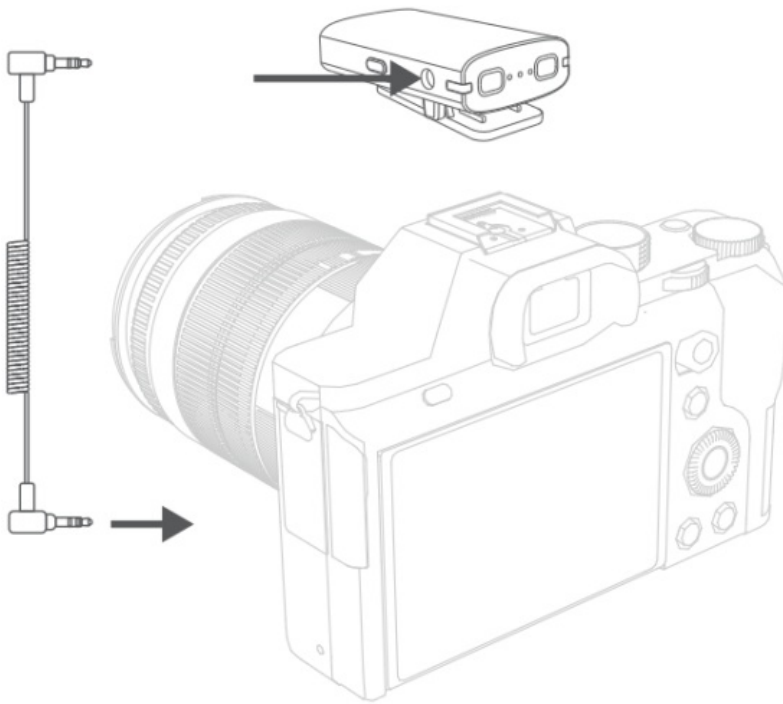

Note: the 3.5mm TRS-TRS audio cable is sold separately.

2. Install onto Smartphones Smartphones with USB-C port (iPhone15 and thereafter or Androids)

1. Connect the 3.5mm audio output port of receiver to the USB-C port of smartphone with the USB type-C to 3.5mm TRS adapter cable GAC-IC9.

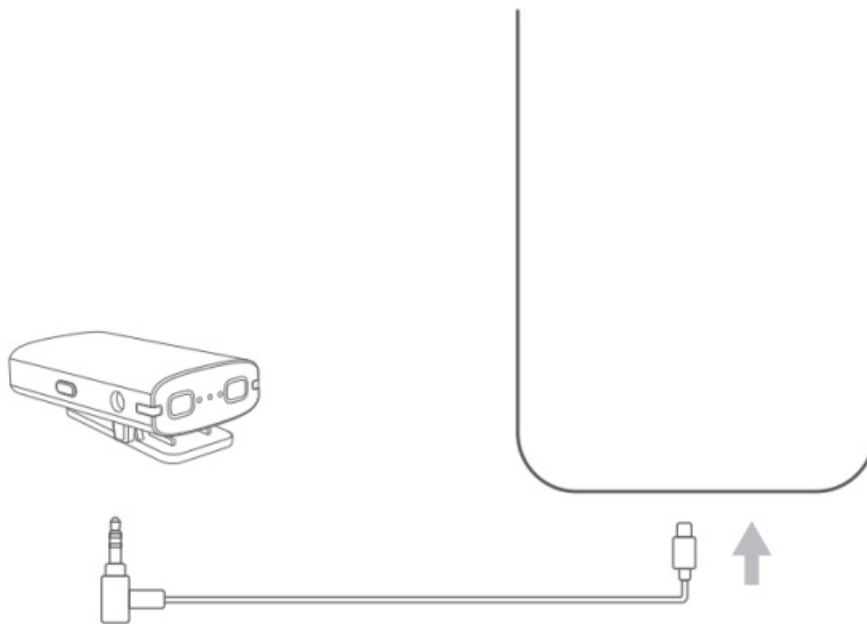

2. Connect the USB-C port of receiver to the USB-C port of smartphone with the USB-C to USB-C data cable.

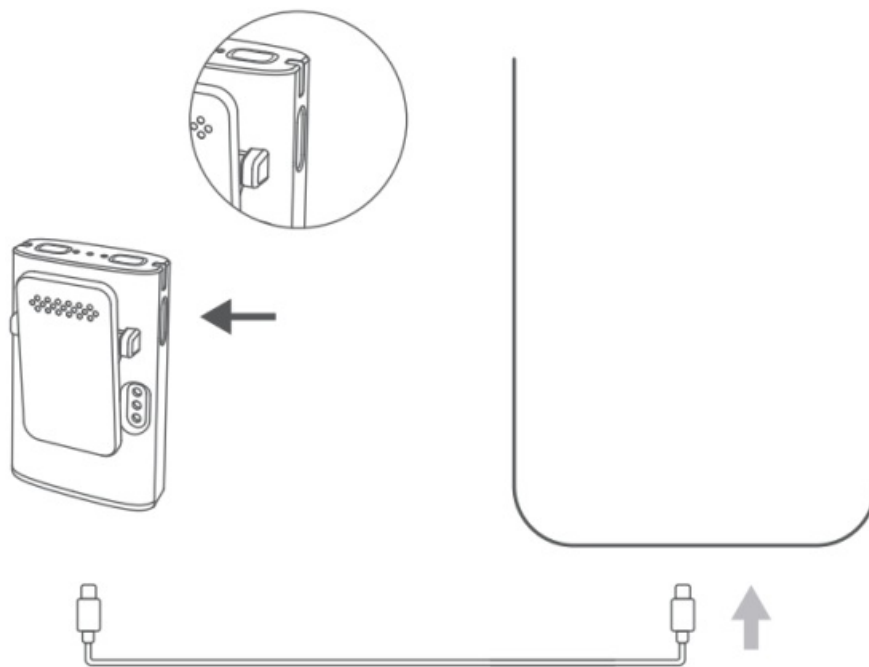

Note: the USB-C to USB-C data cable is sold separately.

Smartphones with Lightning port (iPhone14 and therebefore)

1. Connect the 3.5mm audio output port of receiver to the Lightning port of smartphone with the Lightning to 3.5mm TRS adapter cable GAC-IC10.

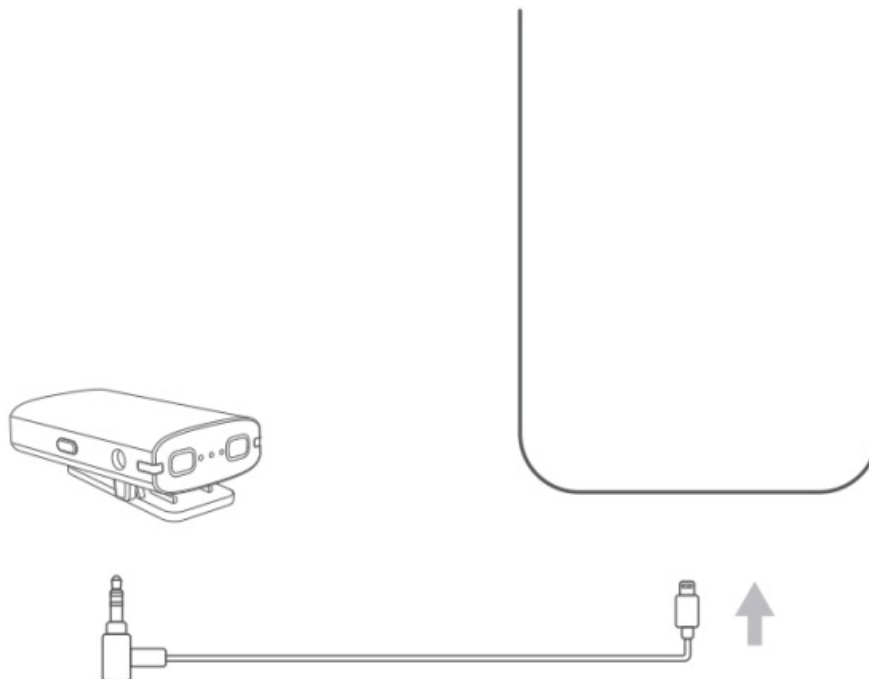

Note: GAC-IC10 is sold separately.

2. Connect the USB-C port of receiver to the Lightning port of smartphone with the USB-C to Lightning data cable.

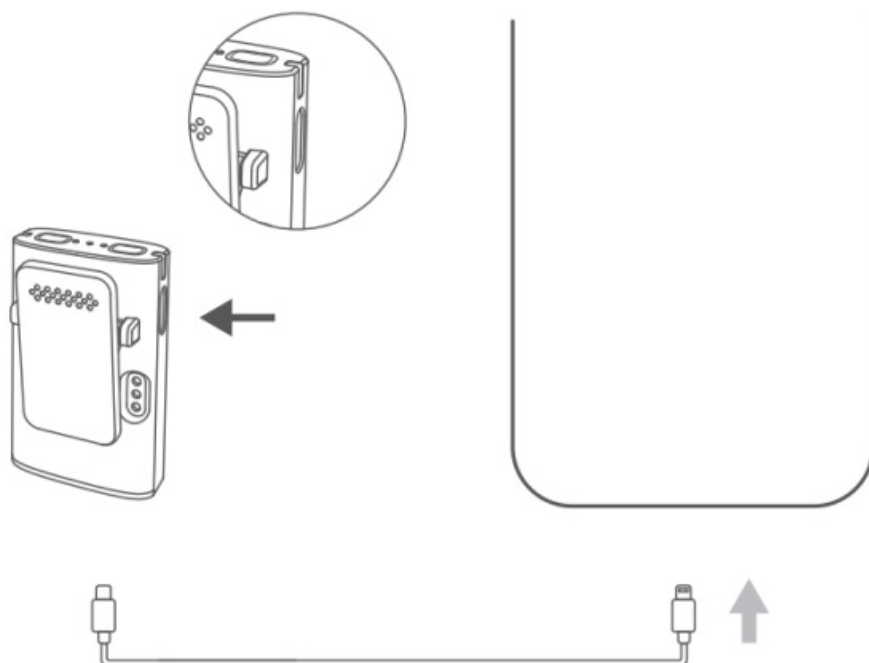

Note: USB-C to Lightning data cable is sold separately.

Technical Data

Name	Receiver
Model	Cube-C RX
Transmission Type	2.4GHz Frequency Hopping System
Max. Wireless Distance	300m (sight distance)
Input Parameters	5V  200mA
Lithium Battery Parameters	3.8V, 200mAh, 0.76Wh
Working Time	Approx. 10h (denoise off)
Charging Time	Approx. 1h20min
Working Environment Temperature	-10~50°C
Dimension	1.81 “×1.14 “×0.71 “
Net Weight	≈16g

Specifications and data may subject to changes without notice.

Maintenance

Avoid falling. Strong collision or vibration may malfunction the device.

Keep dry. This product is not water-proof. Malfunction, rust, and corrosion may occur and go beyond repair if soaked in water or exposed to high humidity.

Avoid sudden temperature changes. Condensation happens in sudden temperature changes such as the circumstance when taking the product out of a building with higher temperature to outside in winter.

Please put the product in a handbag or plastic bag beforehand.

Keep away from strong magnetic field. The strong static or magnetic field produced by devices such as radio transmitters leads to malfunction.

Specifications and data may subject to changes without notice.

Warning

Operating frequency:2402MHz – 2480MHz

Maximum EIRP Power: 5dBm

Declaration of Conformity

GODOX Photo Equipment Co.,Ltd. hereby declares that this equipment are in compliance with the essential requirements and other relevant provisions of Directive 2014/53/EU. In accordance with Article 10(2) and Article 10(10), this product is allowed to be used in all EU member states.

For more information of DoC, Please click this web link:

<https://www.godox.com/eu-declaration-of-conformity/>

The device complies with RF specifications when the device used at 0mm from your body.

FCC Statement

This device complies with part 15 of the FCC Rules. Operation is subject to the following two conditions:

1. This device may not cause harmful interference, and
2. this device must accept any interference received, including interference that may cause undesired operation.

Any Changes or modifications not expressly approved by the party responsible for compliance could void the user's authority to operate the equipment.

Note: This equipment has been tested and found to comply with the limits for a Class B digital device, pursuant to part 15 of the FCC Rules.

These limits are designed to provide reasonable protection against harmful interference in a residential installation. This equipment generates uses and can radiate radio frequency energy and, if not installed and used in accordance with the instructions, may cause harmful interference to radio communications. However, there is no guarantee that interference will not occur in a particular installation. If this equipment does cause harmful interference to radio or television reception, which can be determined by turning the equipment off and on, the user is encouraged to try to correct the interference by one or more of the following measures:

- Reorient or relocate the receiving antenna.
- Increase the separation between the equipment and receiver.
- Connect the equipment into an outlet on a circuit different from that to which the receiver is connected.
- Consult the dealer or an experienced radio/TV technician for help.

The device has been evaluated to meet general RF exposure requirement. The device can be used in portable exposure condition without restriction.

Marking Information

Model: Cube-C RX

Input: 5 V  200mA(Max.)

Li-ion Battery:3.8V , 200mAh,0.76Wh

Made in China



IC: 20034-132 FCC ID: 2ABYN132 CAN ICES-003(B)/NMB-003(B)



219-247155



Warranty

Dear customers, as this warranty card is an important certificate to apply for our maintenance service, please fill in the following form in coordination with the seller and safe-keep it. Thank you!

Product Information	Model	Product Code Number
Customer Information	Name	Contact Number
	Address	
Seller Information	Name	
	Contact Number	
	Address	
	Date of Sale	
Note		

Note: This form shall be sealed by the seller.

Applicable Products

The document applies to the products listed on the Product Maintenance information (see below for further information). Other products or accessories (e.g. promotional items, giveaways and additional accessories attached,etc.) are not included in this warranty scope.

Warranty Period

The warranty period of products and accessories is implemented according to the relevant Product Maintenance Information. The warranty period is calculated from the day(purchase date) when the product is bought for the first time, and the purchase date is considered as the date registered on the warranty card when buying the product.

How to Get the Maintenance Service

If maintenance service is needed, you can directly contact the product distributor or authorized service institutions. You can also contact the Godox after-sale service call and we will offer you service. When applying for maintenance service, you should provide valid warranty card. If you cannot provide valid warranty card, we may offer you maintenance service once confirmed that the product or accessory is involved in the maintenance scope, but that shall not be considered as our obligation.

Inapplicable Cases

The guarantee and service offered by this document are not applicable in the following cases: ①. The product or accessory has expired its warranty period; ②. Breakage or damage caused by inappropriate usage, maintenance or preservation, such as improper packing, improper usage, improper plugging in/out external equipment, falling off or squeezing by external force, contacting or exposing to the improper temperature, solvent, acid, base, flooding and damp environments, etc; ③. Breakage or damage caused by non-authorized institution or staff in the process of installation, maintenance, alternation, addition and detachment; ④. The original identifying information of product or accessory is modified, alternated, or removed; ⑤. No valid warranty card; ⑥. Breakage or damage caused by using illegally authorized, nonstandard or non-public released software; ⑦. Breakage or damage caused by force majeure or accident; ⑧. Breakage or damage that could not be attributed to the product itself. Once met these situations above, you should seek solutions from the related responsible parties and Godox assumes no responsibility. The damage caused by parts, accessories and software that beyond the warranty period or scope is not included in our maintenance scope. The normal discoloration, abrasion and consumption are not the breakage within the maintenance scope.

Maintenance and Service Support Information

The warranty period and service types of products are implemented according to the following Product Maintenance Information:

Product Type	Name	Maintenance Period(month)	Warranty Service Type
Pafis	Product Main Body	12	Customer sends the product to designated site
	Battery	3	Customer sends the product to designated site
	Charger, Electrical Pafis etc.	12	Customer sends the product to designated site
Other Items	Battery Case, Windscreen Foam, Wind Cap, Locking Device, Lanyard, Tie, Velcro Tape, Clip, Bag, Package etc.	No	Without warranty

Godox After-sale Service Call 0755-29609320-8062

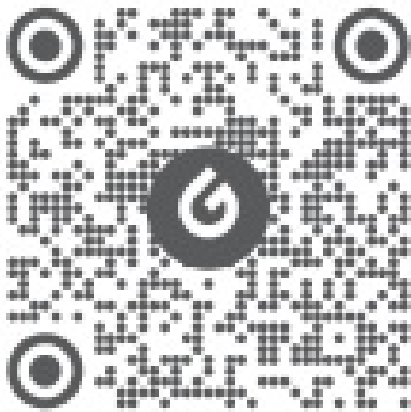

Godox Audio Wechat Official Account



Overseas Official Accounts & Updates

Symbols



0755-29609320(8062)

0755-25723423

godox@godox.com

www.godox.com

Made in China

705-CBCRX0-00

GODOX Photo Equipment Co., Ltd.

Add.: Building 2, Yaochuan Industrial Zone, Community, Street, District,
Shenzhen 518103, China

Tel: +86-755-29609320(8062)

Fax: +86-755-25723423

E-mail: godox@godox.com

Godox

Documents / Resources

	Godox Cube-C RX Receiver [pdf] Instruction Manual 2ABYN132, 705-CBCRX0-00, Cube-C RX Receiver, Cube-C RX, Receiver
---	---

References

-  [GODOX Photo Equipment Co.,Ltd.](#)
- [User Manual](#)

[Manuals+](#), [Privacy Policy](#)

This website is an independent publication and is neither affiliated with nor endorsed by any of the trademark owners. The "Bluetooth®" word mark and logos are registered trademarks owned by Bluetooth SIG, Inc. The "Wi-Fi®" word mark and logos are registered trademarks owned by the Wi-Fi Alliance. Any use of these marks on this website does not imply any affiliation with or endorsement.