



65380 FLUSH MOUNT  
CEILING LIGHT



## Globe 65380 Flush Mount Ceiling Light Instruction Manual

[Home](#) » [Support](#) » [Globe 65380 Flush Mount Ceiling Light Instruction Manual](#) 

### Contents

- [1 Globe 65380 Flush Mount Ceiling Light](#)
- [2 INTRODUCTION](#)
- [3 SPECIFICATIONS](#)
- [4 WHAT'S IN THE BOX](#)
- [5 PRODUCT INSTRUCTIONS](#)
- [6 ELECTRICAL INSTALLATION](#)
- [7 TROUBLESHOOTING](#)
- [8 PROS & CONS](#)
- [9 WARRANTY](#)
- [10 FREQUENTLY ASKED QUESTIONS](#)
- [11 References](#)



**Globe 65380 Flush Mount Ceiling Light**



## INTRODUCTION

Modern and contemporary environments can be enhanced with the elegant and energy-efficient Globe 65380 Flush Mount Ceiling Light. With its elegant A19 design and sturdy E26 bulb base, this ceiling light uses only 60 watts of power to produce 800 lumens of brightness. Users can effortlessly change settings for a flawless lighting experience with the use of smartphone control features. Produced by Globe Electric, a respectable company renowned for its creative lighting solutions, this fixture was initially offered for sale on February 16, 2016. With a stylish flush mount design and long-lasting lighting, the Globe 65380, which retails for \$43.68, is a great deal. Compact yet strong, this lighting option weighs 2.35 pounds and measures 8.86 x 9.86 x 10.24 inches. This ceiling light is a necessary addition to every area because it guarantees both efficiency and aesthetic appeal, whether it is used at home or in an office.

## SPECIFICATIONS

<b>Brand</b>	Globe Electric
<b>Price</b>	\$43.68
<b>Control Method</b>	App
<b>Voltage</b>	120 Volts
<b>Shape</b>	A19
<b>Warranty</b>	1 Year
<b>Bulb Base</b>	E26
<b>Controller Type</b>	Push Button
<b>Brightness</b>	800 Lumens
<b>Wattage</b>	60 Watts
<b>Incandescent Equivalent</b>	35 Watts
<b>Product Dimensions</b>	8.86 x 9.86 x 10.24 inches
<b>Weight</b>	2.35 Pounds
<b>Item Model Number</b>	65380
<b>Date First Available</b>	February 16, 2016
<b>Manufacturer</b>	Globe Electric



**WHAT'S IN THE BOX**

- Flush Mount Ceiling Light
- Manual

## PRODUCT INSTRUCTIONS

Thank you for selecting Globe as your home's lighting choice. With proper care, this product will provide years of pleasure and enjoyment. Carefully follow the instructions in order to ensure that this product functions safely and properly for years to come.

### FLUSH MOUNT

#### FOR YOUR SAFETY:



Most electrical accidents are caused by carelessness or ignorance. If you combine a basic knowledge of electricity, a healthy respect for it, and a dose of common sense, you can safely tackle many household electrical repairs. Here are some basic guidelines for working with electricity:

- Before working on a circuit, go to the main service panel and remove the fuse or trip the breaker that controls that circuit. Tape a sign to the panel warning others to leave the circuit alone while you work.
- Before touching any wire, use a voltage tester to make sure it's not live.
- Whenever you check for voltage in a receptacle, check both outlets – each may be controlled by a separate wiring circuit.
- When replacing fuses, turn off the main power first. Make sure your hands and feet are dry, and place one hand behind your back to prevent electricity from making a complete circuit through your chest. Touch a plug fuse only by its insulated rim. Remove cartridge fuses with a fuse puller.
- Use tools with insulated handles and ladders made of wood or fibreglass.
- To protect children, place safety covers over any unused outlets.
- When unplugging a power tool or appliance, pull on the plug, not on the power cord.
- Improperly used extension cords are a leading cause of electrical fires. They are for temporary use only – do not use them to extend a circuit permanently.
- Keep dry-chemical fire extinguishers in the kitchen, basement, and workshop.
- Never disable grounding devices. Make sure that all appliances requiring grounding are properly grounded, and that the electrical system itself is properly grounded.
- Meet or exceed all electrical code requirements that cover the work you are doing.
- Always work with enough light to see what you are doing; it's easy to make mistakes when you're working in dim light.
- When in doubt about the safety of any electrical repair or test, call in a professional.

CONSULT A QUALIFIED ELECTRICIAN TO ENSURE THE CORRECT BRANCH CIRCUIT CONDUCTOR.

Since 1932, Globe has taken pride in offering products of the highest quality, and a level of service unparalleled in the industry. Should you encounter any difficulties, have any questions or simply wish to offer us your valuable feedback, you may contact us in the following ways:

**Toll Free Telephone:** 1-[888-543-1388](tel:888-543-1388) (North America Only)

**Toll Free Fax:** 1-[800-668-4562](tel:8006684562) (North America Only)

**E-Mail:** [info@globe-electric.com](mailto:info@globe-electric.com)

**Mail:** Globe Electric Customer Service Department 150 Oneida, Montreal, Quebec, Canada H9R 1A8 Please visit our website to discover other quality Globe products: <http://www.globe-electric.com>

## ELECTRICAL INSTALLATION

- **FIG. 1.** Place the wall switch in the “OFF” position. Depending on which type of fuse box you have in your home:
- **FIG. 2.** Place either the main (Master) switch in the “Off” position, cutting off power to your entire home OR turn to the individual switch that provides power to where the mixture will be installed. OR
- **FIG. 3.** Place either the main (Master) switch in the “OFF” position, cutting off power to the entire home OR unscrew the fuse that provides power to where the fixture will be installed.

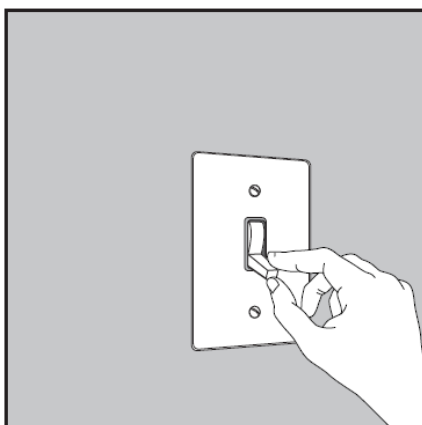

FIG. 1  
WALL SWITCH

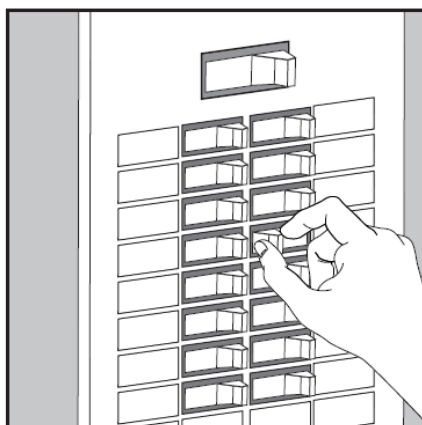

FIG. 2  
BREAKER PANEL

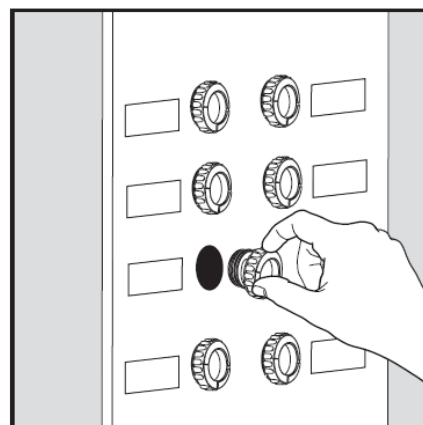
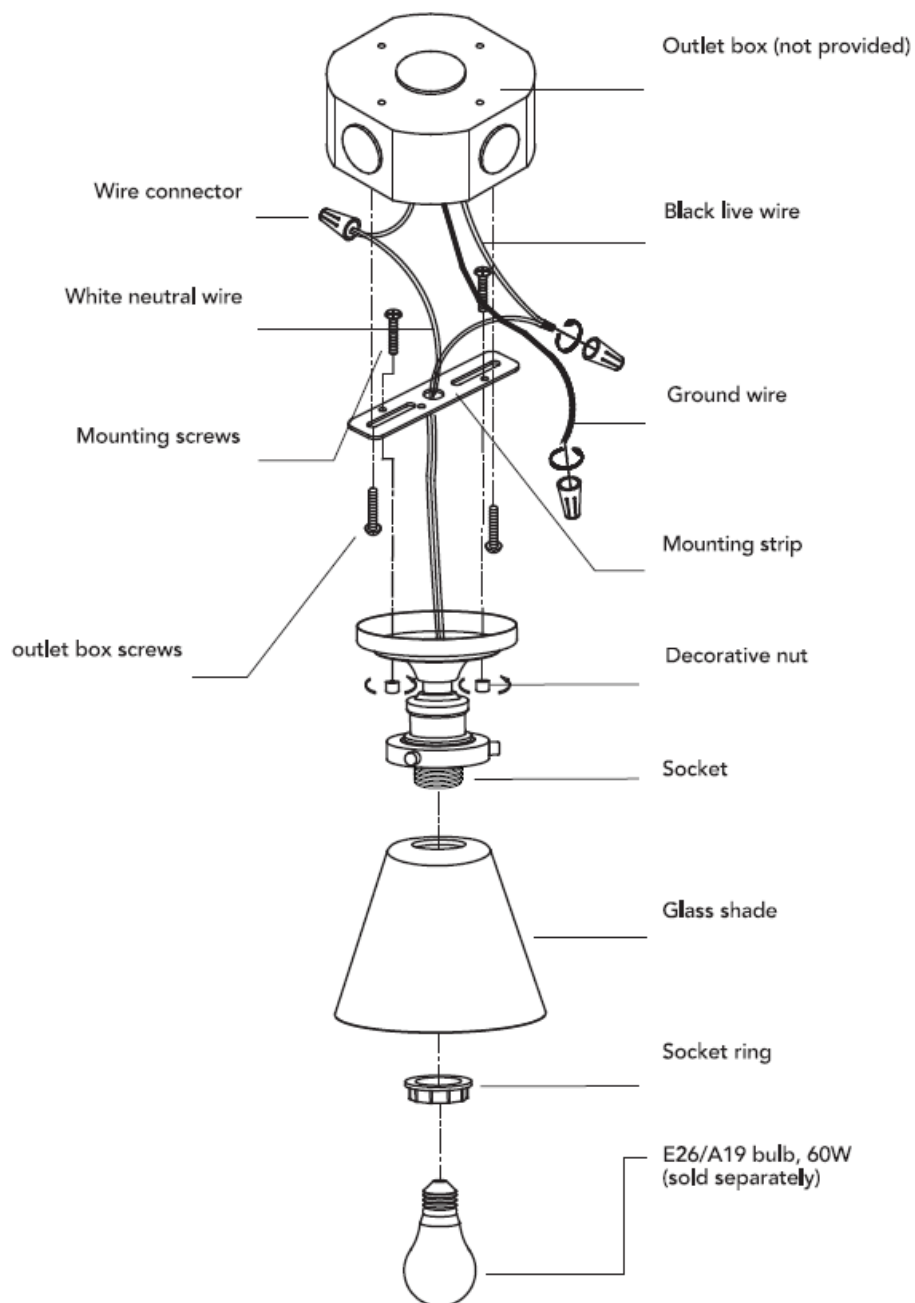

FIG. 3  
FUSE BOX

**Cleaning:** Before cleaning your lamp, turn off the switch or power source. Wipe the lamp with a soft, damp cloth.



**FLUSH MOUNT** requires 1 x medium screw base (E26), 60W max bulb, (sold separately)

## TROUBLESHOOTING

Issue	Possible Cause	Solution
Light does not turn on	Loose or faulty bulb	Ensure the bulb is properly screwed in or replace it.
Flickering light	Voltage fluctuations	Check your electrical wiring or use a voltage stabilizer.
App control not responding	Connectivity issue	Reconnect the device to the app and ensure Bluetooth/Wi-Fi is active.
Dim light output	Incorrect bulb wattage	Use a 60W equivalent LED bulb for optimal brightness.
Light turns off unexpectedly	Power surge	Check the circuit breaker and reset if necessary.
Buzzing sound from fixture	Loose wiring	Turn off power and inspect for loose connections.
Overheating of light	Poor ventilation	Ensure proper airflow around the fixture.
Light does not change brightness	Not compatible with dimmers	Use a standard on/off switch instead of a dimmer.
Bulb burns out too quickly	High voltage supply	Use a surge protector to regulate voltage.
Fixture not secure on ceiling	Loose mounting screws	Tighten screws to properly secure the fixture.

PROS & CONS

PROS	CONS
Sleek and modern design fits any décor.	Not compatible with dimmer switches.
Easy to install with standard E26 bulb base.	Lacks built-in smart home integration.
App control for convenient operation.	The bulb is not included in the package.
Energy-efficient with 60W power consumption.	May not be bright enough for large rooms.
Affordable pricing for high-quality lighting.	Limited to <b>one-year warranty</b> only.

WARRANTY

The Globe 65380 Flush Mount Ceiling Light comes with a one-year manufacturer’s warranty, covering defects in materials and workmanship under normal use. If you experience any issues within this period, Globe Electric offers repair, replacement, or refund options as per their warranty policy. Proof of purchase is required for warranty claims.

FREQUENTLY ASKED QUESTIONS

What is the power source for the Globe Electric 65380 Flush Mount Ceiling Light?

This ceiling light operates on 120 volts and requires a corded electric connection for reliable performance.

How bright is the Globe Electric 65380 Flush Mount Ceiling Light?

The Globe Electric 65380 provides 800 lumens of brightness, making it ideal for general indoor lighting.

What type of bulb does the Globe Electric 65380 Flush Mount Ceiling Light use?

This model is compatible with E26 base bulbs, including LED, incandescent, and CFL options.

What is the wattage of the Globe Electric 65380 Flush Mount Ceiling Light?

This fixture supports a 60-watt bulb, while its incandescent equivalent is 35 watts, ensuring energy efficiency.

How is the Globe Electric 65380 Flush Mount Ceiling Light controlled?

The light can be controlled via a push-button switch and is also app-controlled for remote operation.

What are the dimensions of the Globe Electric 65380 Flush Mount Ceiling Light?

The dimensions are 8.86 inches (L) x 9.86 inches (W) x 10.24 inches (H), making it a compact and space-saving lighting solution.

Why is my Globe Electric 65380 Flush Mount Ceiling Light not turning on?

Ensure the power is connected, the bulb is properly installed, and the app control settings are correctly configured.

What should I do if my Globe Electric 65380 Flush Mount Ceiling Light flickers?

Flickering may be caused by loose wiring, voltage fluctuations, or an incompatible bulb. Check the wiring and ensure you are using a compatible E26 bulb.



**DOWNLOAD THE PDF LINK:** [Globe 65380 Flush Mount Ceiling Light Instruction Manual](#)

## References

- [User Manual](#)

### Manuals+. [Privacy Policy](#)

This website is an independent publication and is neither affiliated with nor endorsed by any of the trademark owners. The "Bluetooth®" word mark and logos are registered trademarks owned by Bluetooth SIG, Inc. The "Wi-Fi®" word mark and logos are registered trademarks owned by the Wi-Fi Alliance. Any use of these marks on this website does not imply any affiliation with or endorsement.