



**GE50839 Beacon
Indoor Smart Timer
Plug**



globe GE50839 Beacon Indoor Smart Timer Plug Instruction Manual

[Home](#) » [globe](#) » globe GE50839 Beacon Indoor Smart Timer Plug Instruction Manual 

Contents

- [1 globe GE50839 Beacon Indoor Smart Timer Plug](#)
- [2 BEACON INDOOR SMART TIMER PLUG](#)
- [3 CONNECTING INSTRUCTIONS](#)
- [4 CONTROLLING THROUGH THE APP](#)
- [5 BASIC CONTROL](#)
- [6 HARDWARE SETTINGS](#)
- [7 ROUTINES](#)
- [8 FCC STATEMENT](#)
- [9 Documents / Resources](#)
 - [9.1 References](#)



globe GE50839 Beacon Indoor Smart Timer Plug



BEACON INDOOR SMART TIMER PLUG



“B” IS FOR BEACON

Unlike Wi-Fi products, your Beacon smart products connect to your phone using Bluetooth. Here are a couple of tips to help you get the most out of them:

- **Proximity:** Beacon allows for full local control from up to 65 feet (20 meters) away.
- **Automation:** Beacon is great for home automation! Schedules and Timers will continue to run even when your phone is not connected.
- **Group Control:** Group your products and control them together. Beacon products can only be grouped with other Beacon products of the same type.

CONNECTING INSTRUCTIONS

Download the Globe Suite™ app from the iOS or Android store.

- Create an account and log in. Ensure your mobile device is running iOS 9.0/Android™ 4.4 or higher.

Set your Smart Plug in pairing mode.

- Insert your smart plug into the desired outlet.
- The blue indicator light should be blinking rapidly.
- If not, hold down the power button for 5 seconds.

Ensure all requested permissions are enabled on your mobile device: Bluetooth, Location Services.

- On the app's home screen, select the  icon in the top-right corner and select “Add a device”.
- If your plug's indicator light is flashing rapidly, the app will detect it within a few seconds. When discovered,

select the plug icon, and select “Next.”

Set up and enjoy!

- Name your plug and choose which room to place it in. You can now control it directly from the app.

Need help?

- Select the “How do I set the device into pairing mode?” link on the “Scan” page and follow the in-app instructions.

Routines must be created within a 20-meter range of the plug. When your phone is not in range, it will continue running but cannot be modified.

CONTROLLING THROUGH THE APP

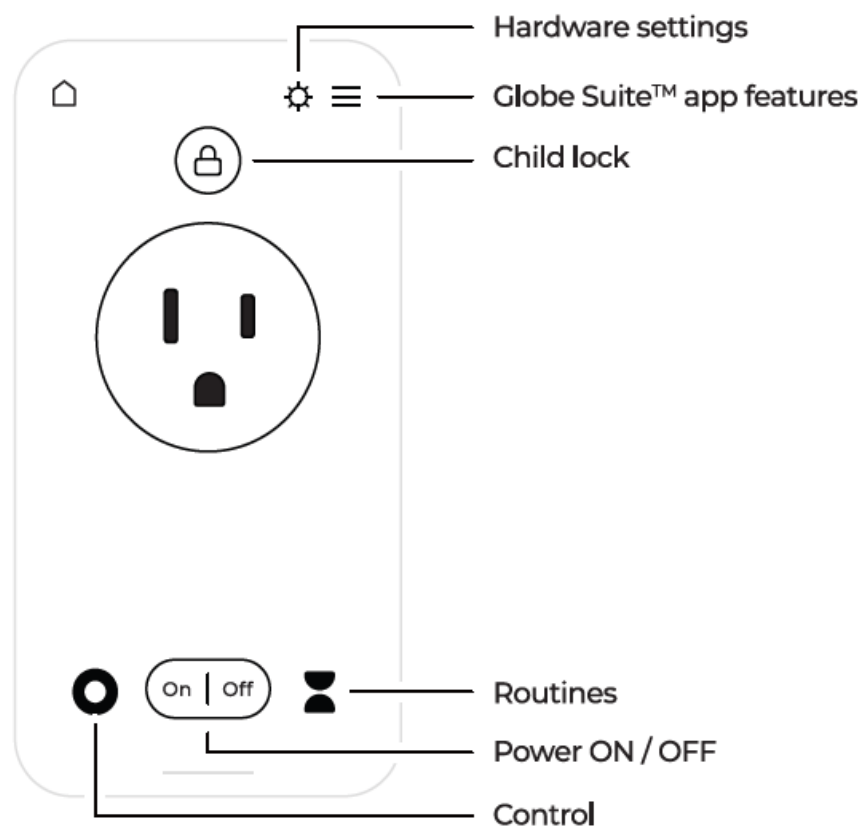

BASIC CONTROL

Power

- Turn your smart plug on or off directly.

Child lock status

- View if the child lock is enabled or disabled.

HARDWARE SETTINGS

Restart status

- Set the default state of the plug when reconnected to a power source. Choose from OFF, ON, or Last status.

Light mode

- Turn the blue indicator light on the physical device ON or OFF.

Child lock

- Disable the physical power button.

ROUTINES

Timer

- Set a countdown for your plug to turn ON or OFF once the timer runs out.

Add a new schedule

- Set a time and date for your plug to either turn ON or OFF to create additional routines that fit your specific needs.

APP FEATURES

Device sharing

- Share access to your connected devices with another Globe Suite™ app user from the same home or account.

Device grouping

- Group multiple same-type Beacon devices together to control them simultaneously, rather than individually.

Create a Smart Scene

- Automate your plug to turn ON or OFF based on factors such as climate, time, and other device status.

CAUTION: This plug has a 1-year manufacturer warranty from the date of purchase. If the plug fails within that time, please contact our customer care team, or visit our website to submit a warranty request. This warranty is void if the product is misused in any way. This replacement is the only option available and liability for incidental or consequential damages are expressly excluded. Please see the remaining CAUTION text for proper use. For use only in 120V/60HZ circuits. Risk of electrical shock. Do not open, no user-serviceable parts inside. This device is not intended for use with emergency exit fixtures or emergency exit lights, photocells, and electronic timers. This device is intended for indoor use or weather-protected fixtures. Do not use where directly exposed to water. Minimum operating temperature is 0° C (32°F).

USER MANUAL NOTICE FOR LICENSE-EXEMPT RADIO APPARATUS.

This device contains license-exempt transmitters/receivers that comply with Innovation, Science, and Economic Development Canada's licence-exempt RSS(s). Operation is subject to the following two conditions.

1. This device may not cause interference.
2. This device must accept any interference, including interference that may cause undesired operation of the device.

FCC STATEMENT

RADIATION EXPOSURE STATEMENT

This equipment complies with ISSED radiation exposure limits set forth for an uncontrolled environment. This equipment should be installed and operated with a minimum distance of 20cm between the radiator and your body.

This device complies with part 15 of the FCC Rules. Operation is subject to the following two conditions:

1. This device may not cause harmful interference, and
2. this device must accept any interference received, including interference that may cause undesired operation.

WARNING: Changes or modifications not expressly approved by the party responsible for compliance could void the user's authority to operate the equipment.

NOTE: This equipment has been tested and found to comply with the limits for a Class B digital device, under Part 15 of the FCC Rules.

These limits are designed to provide reasonable protection against harmful interference in a residential installation. This equipment generates uses and can radiate radio frequency energy and, if not installed and used under the instructions, may cause harmful interference to radio communications. However, there is no guarantee that interference will not occur in a particular installation. If this equipment does cause harmful interference to radio or television reception, which can be determined by turning the equipment off and on, the user is encouraged to try to correct the interference by one or more of the following measures:

- Reorient or relocate the receiving antenna.
- Increase the separation between the equipment and the receiver.
- Connect the equipment to an outlet on a circuit different from that to which the receiver is connected.
- Consult the dealer or an experienced radio/TV technician for help.

The equipment complies with FCC radiation exposure limits set forth for an uncontrolled environment. This device should be installed and operated with a minimum distance of 20 cm between the radiator & your body.

SAFETY WARNING: Make sure to use this product together with the 15A circuit breaker in the upstream.

Documents / Resources

	globe GE50839 Beacon Indoor Smart Timer Plug [pdf] Instruction Manual GE50839, GE50839 Beacon Indoor Smart Timer Plug, Beacon Indoor Smart Timer Plug, Indoor Smart Timer Plug, Smart Timer Plug, Timer Plug, Plug
---	---

References

- [User Manual](#)

[Manuals+](#), [Privacy Policy](#)

This website is an independent publication and is neither affiliated with nor endorsed by any of the trademark owners. The "Bluetooth®" word mark and logos are registered trademarks owned by Bluetooth SIG, Inc. The "Wi-Fi®" word mark and logos are registered trademarks owned by the Wi-Fi Alliance. Any use of these marks on this website does not imply any affiliation with or endorsement.