

globalpayments T650P Global Payments Terminal



# globalpayments T650P Global Payments Terminal User Guide

[Home](#) » [globalpayments](#) » globalpayments T650P Global Payments Terminal User Guide 

## Contents

- 1 [globalpayments T650P Global Payments Terminal](#)
- 2 [Product Usage Instructions](#)
- 3 [Get started](#)
- 4 [Network communication](#)
- 5 [Documents / Resources](#)
  - 5.1 [References](#)

**globalpayments**

## globalpayments T650P Global Payments Terminal



## Specifications

- Model: T650C / T650P
- Power Source: DC power connector (T650C), USB charging (T650P)
- Connectivity: Wi-Fi and Ethernet (T650C), Wi-Fi and 4G wireless (T650P)
- Manager Password: 7-12 characters or digits

## Product Usage Instructions

### Terminal ON/OFF

- **Countertop–T650C:** Plug the DC power connector for power supply.
- **Wireless–T650P:** Charge using the provided USB cable. Press and hold the power button to turn on/off the device.

### Manager Password

Contact Global Payments Customer Care Centre at 1-[888-682-3309](tel:888-682-3309) to set up a 7-12 character/digit manager password.

### Network Communication

- **Wi-Fi set-up:** Connect to a Wi-Fi network by swiping down from the home screen, tapping Wi-Fi icon, selecting network, and entering password.
- **Ethernet set-up (T650C):** Insert Ethernet cable into the device and connect to ETH port.
- **4G set-up (T650P):** Device comes with pre-installed and pre-programmed network SIM card for immediate use.

### Performing a Sale Transaction

1. Tap [SALE] on the Payments app home screen.
2. Enter transaction amount and confirm.
3. Cardholder completes payment method entry following on-screen prompts.
4. Transaction complete.

### Additional Resources

Visit Global Payments Help Centre at [help.globalpay.com](https://help.globalpay.com) or scan provided QR code for support materials.

### FAQ

- **Q: How do I charge the T650P terminal?**  
**A:** To charge the T650P, insert the USB cable into the device and connect the other end to a power supply.
- **Q: Can I connect the T650C terminal to a Wi-Fi network?**  
**A:** No, the T650C model supports Ethernet connectivity only.
- **Q: What should I do if I forget my manager password?**  
**A:** Contact Global Payments Customer Care Centre to reset your manager password.





### Get started

Welcome to the Global Payments Terminal Quick Start Guide! It's your go-to resource for quickly and easily setting up and using your new payments terminal. This guide covers everything from the initial setup to processing payments, ensuring you have all the essential information at your fingertips. We'll also provide you with helpful links to additional resources to maximize the potential of your new payment solution. Let's get started!

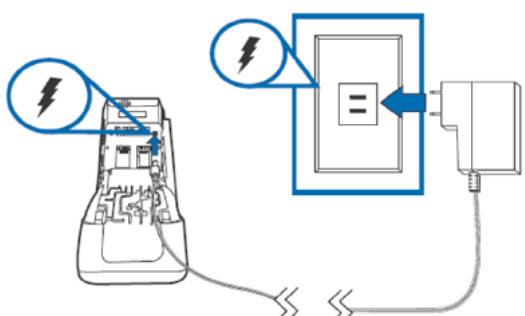
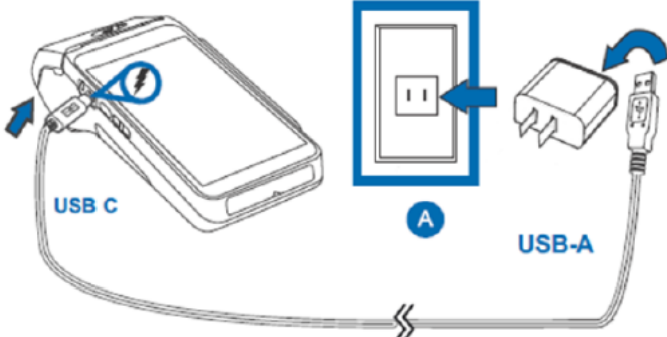
## Terminal ON/OFF

The terminal power configuration differs across devices; view the table below to see the power connectivity method for your device(s):

Countertop—T650C	Wireless—T650P
<p>The <b>T650C</b> features a dedicated DC power connector for easy and convenient power supply.</p> 	<p>The <b>T650P</b> comes pre charged, but we advise you to charge the terminal to ensure it maintains a battery life above 15% for seamless transaction processing. Inside the box, you will find the power cable. To charge the device, insert the USB port into the T650P and connect the other end to the power supply.</p> 

- Power On: Press and hold the power button [  ] to turn on the device.
- Power Off: Press and hold the power button [  ] to wake the device up. After it is turned on, press and hold the power button [  ] until the “User Menu” displays on the screen. Tap [  Power off] to turn off the device.

## Manager password

To set up your personalized manager password, kindly reach out to Global Payments Customer Care Centre at 1-[888-682-3309](tel:888-682-3309). Please note that the password should consist of 7-12 characters or digits.

## Network communication

Device name	Countertop—T650C	Wireless—T650P
Available connectivity mode	Wi-Fi and Ethernet	Wi-Fi and 4G wireless

Network configuration differs across devices; view the table below to see the available connectivity method for your device(s):

To set up your device connectivity, follow the steps based on the communication mode configuration that you ordered.

### For a Wi-Fi set-up

1. Swipe down from the top of the home screen. When you see the status bar, swipe down again.
2. Tap the Wi-Fi icon to toggle “Wi-Fi On”
3. Tap the arrow at the bottom of the Wi-Fi icon to display available networks
4. Tap the SSID name of the Wi-Fi network that you want to connect to from the list.
5. Enter the Wi-Fi password, and then tap [CONNECT].

### For an ethernet set-up (Countertop—T650C only)

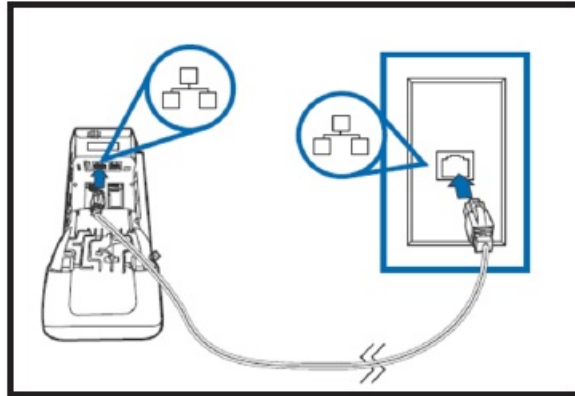

1. Insert the Ethernet cable into the T650C device.
2. Connect the other end of the cable to the ETH port, as illustrated on the right.

### For a 4G set-up (Wireless—T650P only)

If you have selected a 4G configuration for your terminal, rest assured that it will arrive with a pre-installed and pre-programmed network SIM card, fully prepared for immediate use.

### Performing a sale transaction

1. Tap the [SALE] transaction icon on the Payments app home screen.
2. Key in the transaction amount and tap [✓].
3. The cardholder taps/inserts/swipes their payment method and follows the prompts on the screen for each card entry.
4. Transaction complete

### Additional resources



- Visit the Global Payments Help Centre at [help.globalpay.com](https://help.globalpay.com) or scan the QR code on the side for additional support materials for your device(s).
- Should you have any questions or require additional instructions, please contact the Global Payments Customer Care Centre at 1-[888-682-3309](tel:888-682-3309).

© 2023 Global Payments Inc. All Rights Reserved.  
SM-232614-v1.0

---

## Documents / Resources

	<a href="#">globalpayments T650P Global Payments Terminal</a> [pdf] User Guide T650C, T650P, T650P Global Payments Terminal, T650P, Global Payments Terminal, Payments Terminal
---	--

## References

- [User Manual](#)

### [Manuals+](#), [Privacy Policy](#)

This website is an independent publication and is neither affiliated with nor endorsed by any of the trademark owners. The "Bluetooth®" word mark and logos are registered trademarks owned by Bluetooth SIG, Inc. The "Wi-Fi®" word mark and logos are registered trademarks owned by the Wi-Fi Alliance. Any use of these marks on this website does not imply any affiliation with or endorsement.