



GLOBALO 602 Built-In Range Hood Instruction Manual

[Home](#) » [GLOBALO](#) » GLOBALO 602 Built-In Range Hood Instruction Manual 

Contents

- 1 GLOBALO 602 Built-In Range Hood
- 2 Product Usage Instructions
- 3 GENERAL INFORMATION ON SAFETY AND INSTALLATION
- 4 ENVIRONMENTAL PROTECTION
- 5 TECHNICAL SPECIFICATION
- 6 INSTALLATION AND OPERATION
- 7 PREPARATION BEFORE HOOD INSTALLATION
- 8 HOOD INSTALLATION
- 9 POWER SUPPLY CONNECTION
- 10 CLEANING AND MAINTENANCE
- 11 SETTINGS
- 12 IN CASE OF PROBLEMS
- 13 ENERGY LABEL
- 14 REDUCING THE IMPACT OF COOKING ON THE ENVIRONMENT
- 15 TROUBLESHOOTING
- 16 LED STRIP REPLACEMENT
- 17 WARRANTY
 - 17.1 Company Headquarters
- 18 Documents / Resources
 - 18.1 References
- 19 Related Posts



GLOBALO 602 Built-In Range Hood



Product Usage Instructions

Pre-Installation Preparations

- Ensure the minimum distance between the surface of the cooking appliance (gas or electric stove) and the lowest part of the range hood is at least 45 cm for electric stoves and at least 65 cm for gas stoves.
- If the cooking appliance's user manual specifies a greater distance, follow those instructions.
- **Electric Stoves:** MIN. 45 CM
- Gas **Stoves:** MIN. 65 CM

Installation:

1. Mount the range hood according to the provided instructions, ensuring the use of proper screws and mounting elements to avoid electrical shock risks.
2. Remove the grease filter.
3. Choose the appropriate installation method:
 - **a)** Mounting to the cabinet's underside.
 - **b)** Mounting to the side of the cabinet.
4. Install the grease filter.

Electrical Connection

Follow the electrical connection instructions provided in the user manual to connect the range hood to the power supply.

Cleaning and Maintenance

1. Clean and maintain the range hood regularly according to the instructions provided in the user manual.
2. The range hood may be equipped with a carbon filter. Use it only when the range hood is not connected to a ventilation duct. Place the filter on the turbine housing as shown in Fig. 13. Replace the carbon filter every 3-6 months.

3. Do not wash or regenerate the carbon filter.

Operating the Range Hood:

Use the provided controls to operate the range hood according to your needs. Refer to Fig. 14 for control symbols:

- Off
- Low Speed
- Medium Speed
- High Speed
- Lighting

Troubleshooting:

If you encounter any issues with the operation or functionality of the purchased appliance, please contact our service centre for assistance.

FAQ (Frequently Asked Questions):

Q: How often should I clean the grease filter?

- **A:** The grease filter should be cleaned regularly, depending on usage, to ensure optimal performance. We recommend cleaning it every 2-4 weeks.

Q: Can I wash the carbon filter?

- **A:** No, the carbon filter should not be washed or regenerated. It should be replaced every 3-6 months.

Q: What should I do if the range hood is not functioning properly?

- **A:** If the range hood's performance is insufficient or it is operating louder than usual, please refer to the troubleshooting section in the user manual or contact our service centre for assistance.

Dear Customers,

- Thank you for choosing our brand. We hope that you will be satisfied with our product. Every product that leaves our production plant is carefully inspected for quality and safety.
- Before installation and use of the hood, you are kindly requested to read this manual carefully and follow the safety instructions.
- We also recommend that you keep the manual in an easily accessible place so that you can consult it at any time.
- In order to ensure the maximum safety of the device, the most important information has been marked with the following symbol:
- THE CAUTION SYMBOL INDICATES POSSIBLE DANGERS WHEN USING THE HOOD. FOR YOUR OWN SAFETY, CAREFULLY FOLLOW THE INSTRUCTIONS INDICATED BY THIS SYMBOL!

GENERAL INFORMATION ON SAFETY AND INSTALLATION

- Keep the manual in an easily accessible place so that you can consult it at any time.
- This manual contains detailed information on the installation and maintenance of the range hood.
- The product may slightly differ from the range hood presented in this manual, but the recommendations regarding operation, maintenance and installation apply to the same extent.
- Do not introduce any changes to the electrical installation or physical structure of the hood.
- Do not connect the device to the power supply before completing the installation process.
- Use protective gloves for all installation and maintenance operations.
- Do not use the hood without a properly installed anti-grease filter.
- Installation not in accordance with these instructions poses a risk of electric shock.
- Do not use sources of open fire underneath the hood.
- Keep a close eye during deep frying – overheated fat can easily ignite.
- The air sucked in by the hood must not be discharged into a flue pipe used for exhaust fumes from appliances burning gas or other fuels (this does not apply to recirculation hoods).
- If you have other non-electric appliances in the house (e.g. liquid fuel cookers, flow-through heaters, water heaters) make sure that there is sufficient air supply in the room.
- Do not pull on the power cord to disconnect the plug from the socket.
- The power cord must not be in contact with any hot surfaces.
- Do not switch on the device if the power cord is damaged.
- A damaged power cord may only be replaced by the manufacturer, repair centre or a qualified specialist.
- The hood should be cleaned both inside and outside. at least once a month or every 35 hours of operation. Each time before cleaning the hood, disconnect the power supply (unplug the power cord or pull out the fuses).
- Children at least 8 years old, persons with physical or mental disabilities and persons with lack of knowledge or experience in using the device may use it only under supervision or after being properly instructed in terms of safe operation.
- Children should not be allowed to play with the device.
- Children are not allowed to clean the device without supervision.

CAUTION!

- EASILY ACCESSIBLE PARTS MAY BECOME HOT WHEN THE COOKER IS USED. USING SCREWS OR FASTENERS OTHER THAN APPROVED IN THE MANUAL MAY RESULT IN ELECTRIC SHOCK.

ENVIRONMENTAL PROTECTION

- The product is made of high quality recyclable materials.
- The symbol of a crossed-out wheelie bin on the product (Fig. 1) indicates that the end users should segregate the product from other waste at end-of-life, in accordance with the provisions of Directive 2012/19/EU of the European Parliament and of the
- Council. If the symbol shown in Fig. 2 is used, it means that the product contains batteries, which the end users should segregate from other waste at end-of-life, in accordance with the provisions of Directive 2006/66/EU of the European Parliament and of the Council.

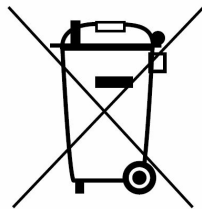

Fig. 1



Li-FeS2
Fig. 2

- The mentioned marking means that end-of-life electrical and electronic equipment and batteries (if any) must not be disposed of with other household waste. The user is obliged to return used electrical and electronic equipment and batteries (if any) to special collection points for such items. Operators of collection facilities, including local collection points, shops and municipal units must have in place an appropriate system enabling the users to return such equipment and batteries.
- Proper disposal of waste equipment and batteries prevents the harmful impact of hazardous components of these items on human health and the environment, resulting from improper storage and handling of such equipment and batteries. Individual households play an important role in ensuring reuse and recovery, including recycling, waste equipment, and helping to preserve a clean environment, which is our common good. It is also households that are the largest consumer of small appliances, hence rational management of waste improves the efficiency of secondary raw materials recovery. Improper disposal of this product may result in penalties, imposed in accordance with national legislation.

TECHNICAL SPECIFICATION

The technical specification presented in this manual and on the labels placed on the product is based on measurements and calculations in accordance with the requirements of EU Regulation 65/2014 and 66/2014.

- Supply Voltage: 220 – 240V~50 Hz
- Frequency: ~50 Hz
- Motor power: 115 W
- Number of speed levels: 3
- Lighting power: 5 W
- Total power: 120 W
- Security class: II
- Outlet diameter: Ø12 cm

INSTALLATION AND OPERATION

The range hood is designed for fume and smoke extraction during food preparation.

CAUTION!

- USE THE SHORTEST POSSIBLE EXHAUST DUCT.
- USE AN EXHAUST DUCT WITH A SMOOTH INTERNAL SURFACE (SPIRO DUCTS ARE NOT RECOMMENDED).
- ANY BENDING OF THE DUCT SHOULD BE LIMITED TO MINIMUM (THE ANGLES SHOULD NOT EXCEED 90°).
- COMBINING DUCTS WITH DIFFERENT CROSS-SECTIONS IS NOT RECOMMENDED (E.G. Ø15 CM WITH

Ø12 CM).

- ENSURE THAT THE SIZE OF THE SUCTION OPENING IS AT LEAST AS BIG AS THE SIZE OF THE AIR EXHAUST. THIS WILL PREVENT NEGATIVE PRESSURE AND ENSURE PROPER FUNCTIONING OF THE HOOD.
- IF THERE ARE ANY OPEN-FLAME APPLIANCES IN THE ROOM (E.G.: SOLID AND LIQUID FUEL COOKERS, FIREPLACES, HEATERS, ETC.). MAKE SURE THERE IS AN ADEQUATE SUPPLY OF FRESH AIR.

CAUTION!

- USE SCREWS AND FASTENERS APPROVED IN THE MANUAL TO AVOID THE RISK OF ELECTRIC SHOCK.
- The minimum distance between the surface of the cooker and the lowest part of the range hood (see figure below) must be at least 45 cm for electric cookers and 65 cm for gas cookers.
- If the cooker manual indicates a greater distance than specified above, follow the instructions in the cooker manual.

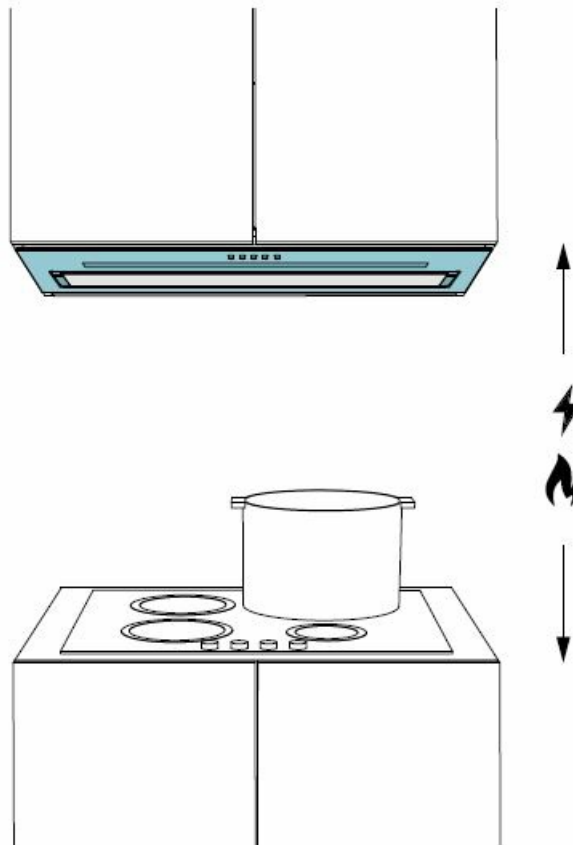

- **ELECTRIC COOKERS MIN. 45**
 - **CM GAS COOKERS MIN. 65 CM**
- Installation of the product is shown in Figures 5 – 12. During installation, follow the general regulations concerning air extraction.

PREPARATION BEFORE HOOD INSTALLATION

- Check whether the dimensions of the purchased product are suitable for the selected place of installation.
- Disconnect and remove (if possible) any appliances in the installation space to facilitate access to the ceiling

or wall where the hood will be installed. If this is not possible, secure these elements.

- Check whether there is a socket near the hood installation space and whether it is possible to connect the hood to a ventilation duct for fume extraction.
- Make sure there are no lines of electric and plumbing installations in places where holes will be drilled.
- Prepare the following tools: tape measure, pencil, drill/driver, Ø3 mm drill bit, screwdriver, level.
- **CAUTION!** TAKE CARE NOT TO SCRATCH THE HOOD.

BENIKOR 60

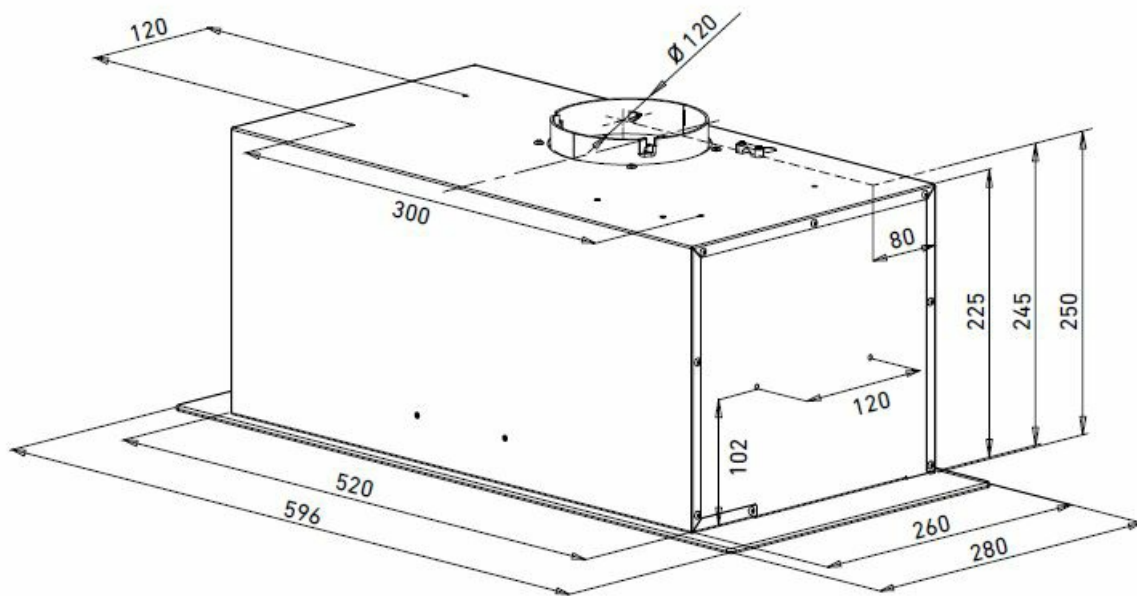

Fig. 4

HOOD INSTALLATION

1. Prepare the cabinet where the hood is to be installed by cutting a hole in the bottom of the cabinet as shown in the figure.

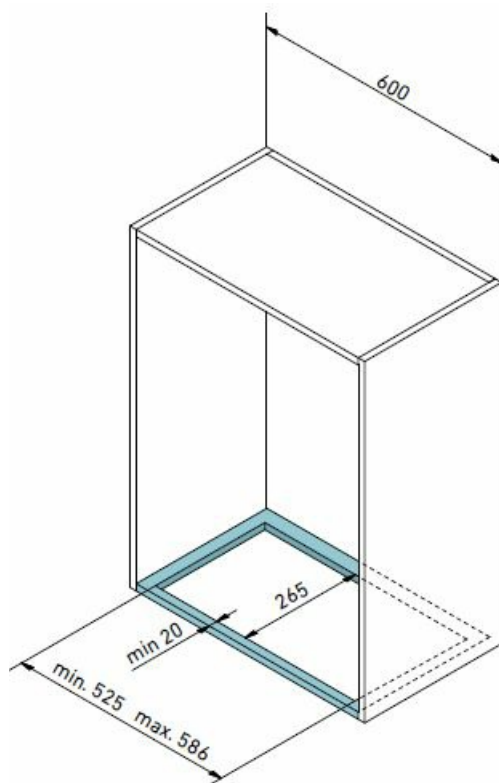

Fig. 5

2. Remove the aluminium anti-grease filter.

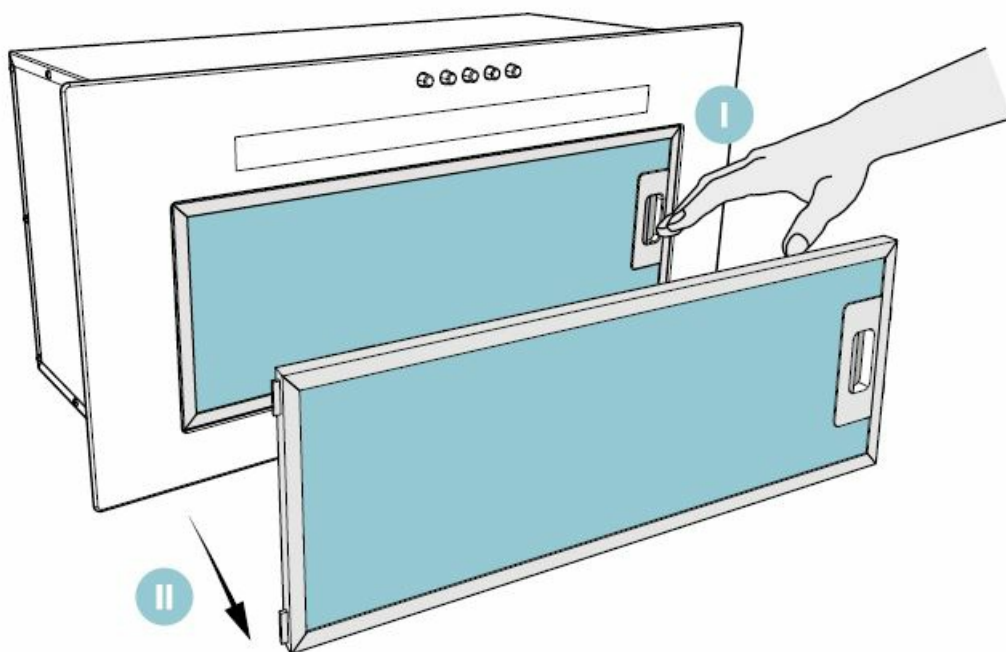
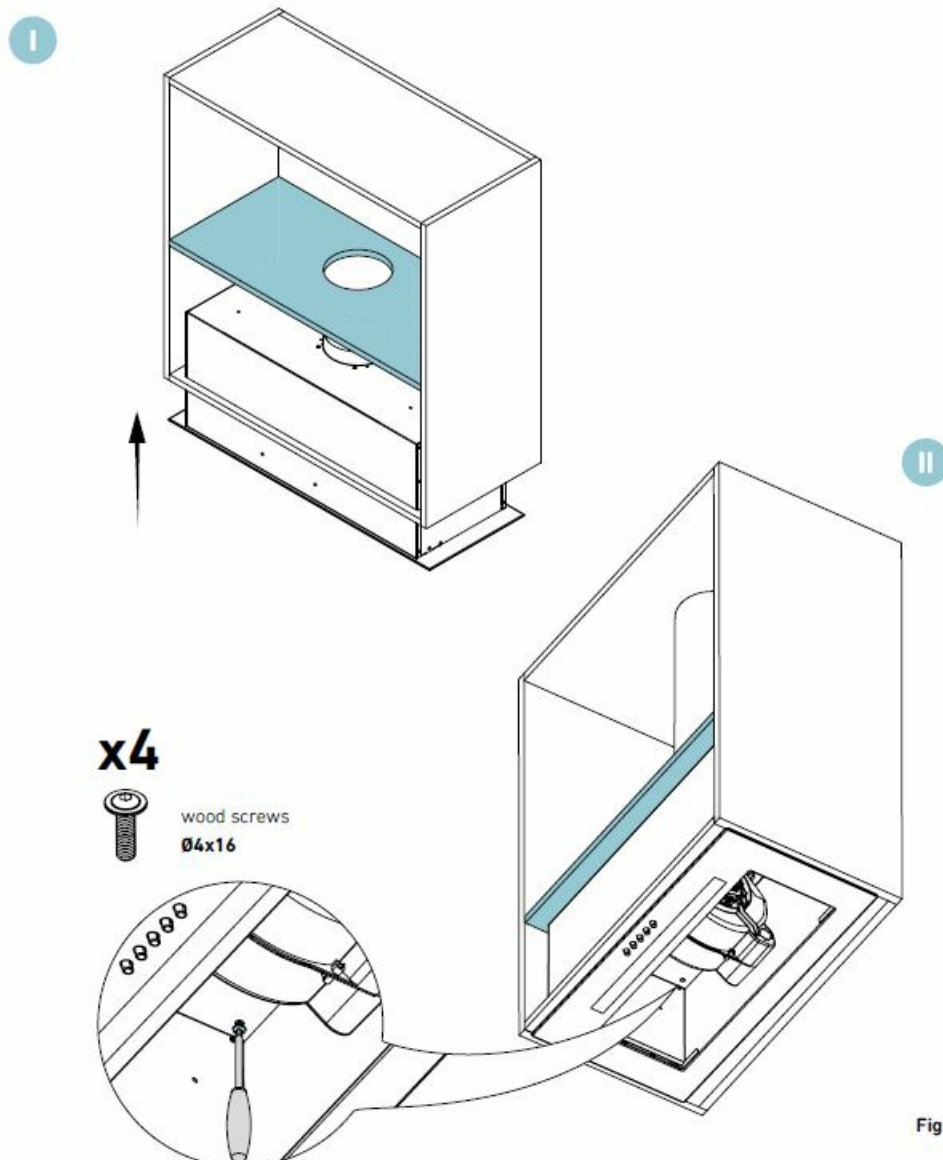

Fig. 6

3. Insert the exhaust hood into the pre-cut hole holding the bottom of the exhaust hood with one hand or ask for help. Fix the exhaust hood by choosing one of the mounting options:

- **a)** fixing to the shelf of a kitchen cupboard



- **b)** fixing to the side of a kitchen cupboard
- Side boards are not part of the set. They must be selected according to the size of the kitchen cupboard. Their thickness can be calculated using the formula: $g=(D-550)/2$ [mm]
- where D is the internal width of the kitchen cupboard and g is the thickness of the board

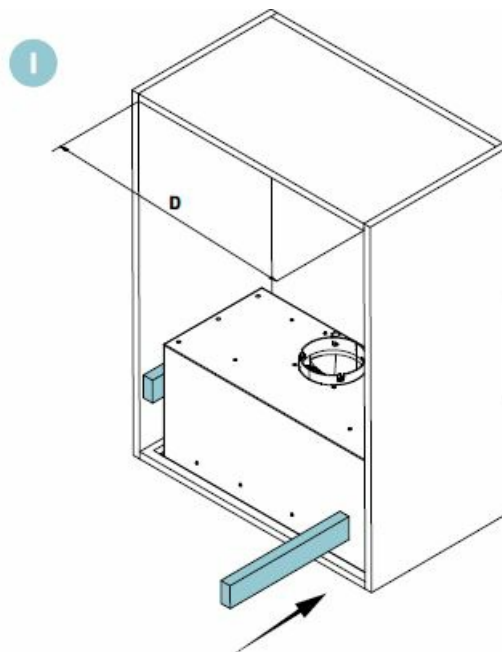
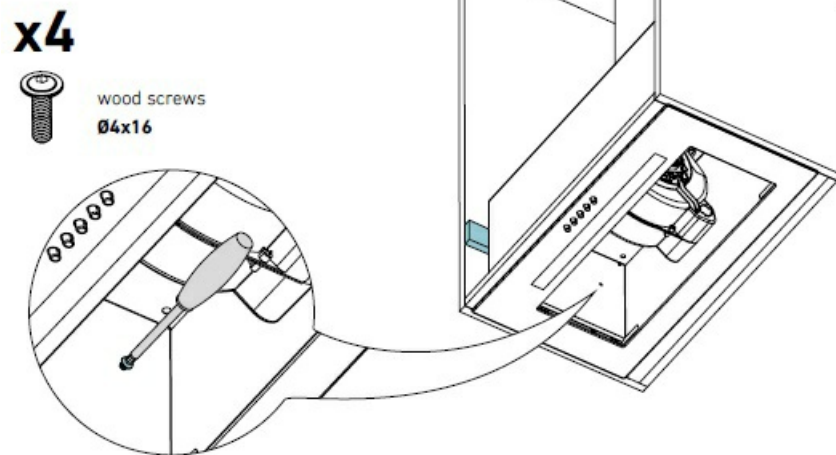

Fig. 8



4. Install the grease filter.

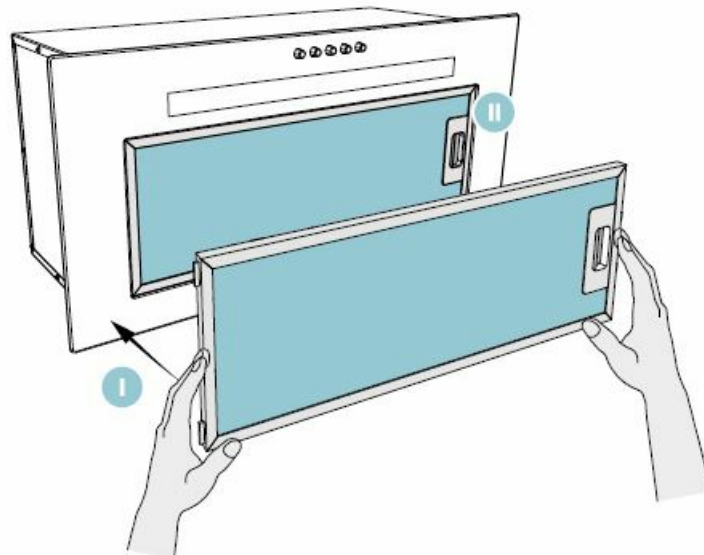

Fig. 9

5. Connect the duct to the motor connection.

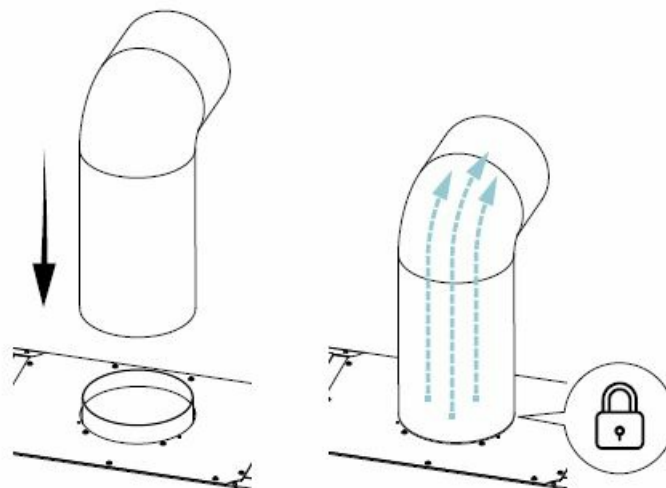

Fig. 10

POWER SUPPLY CONNECTION

- The supply voltage must correspond to the voltage indicated on the identification plate placed inside the hood. If the hood is equipped with a plug, insert it in an accessible socket compliant with the applicable regulations. If the hood is not equipped with a plug, the installation should be carried out by a certified specialist (e.g. an electrician).

CLEANING AND MAINTENANCE

- Before performing any maintenance operations, unplug the device from the socket. Use mild detergent for cleaning. Do not use abrasive cleaning products.
- The hood should be cleaned at least once a month or every 35 hours of operation. **DO NOT USE ALCOHOL-BASED CLEANING AGENTS.** Inox parts should be cleaned with a special product (e.g. BERNER).

CARBON FILTER

- The hood may be equipped with a carbon filter. Use the filter only when the hood is not connected to the ventilation duct. Place the filter on the turbine housing as shown in Fig. 13. The filter should be replaced every 3-6 months.

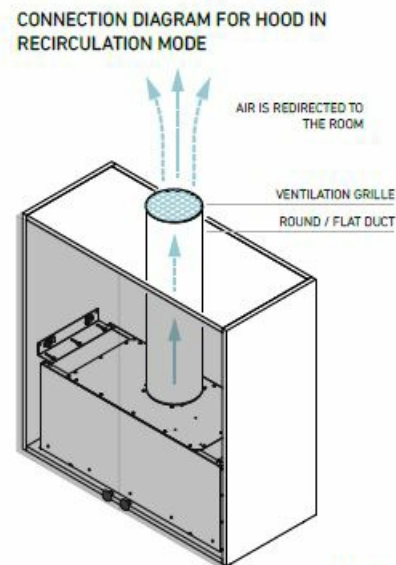
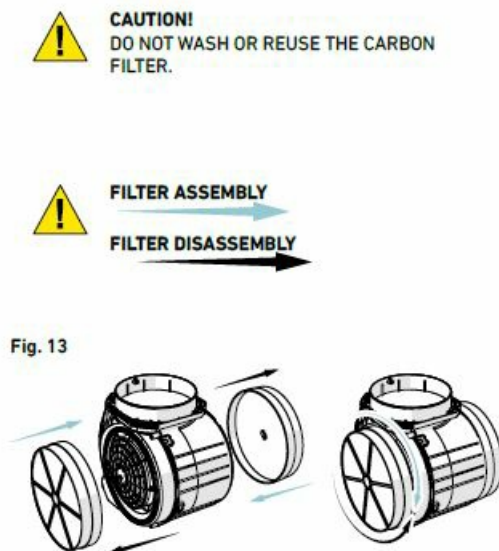

ANTI-GREASE FILTER

- The hood is equipped with an aluminium filter which partially traps grease particles. You can wash the filter manually by immersing it for 15 minutes in 40-50°C water with dishwashing liquid. After 15 minutes, wash and rinse the filter thoroughly. Dry well before placing it back in the hood. You can also wash it in a dishwasher. After cleaning, you may notice a slight discolouration of the filter, which does not affect its properties.
- A regularly cleaned filter will help to maintain the efficiency of the hood and prevent the risk of fire.

SETTINGS

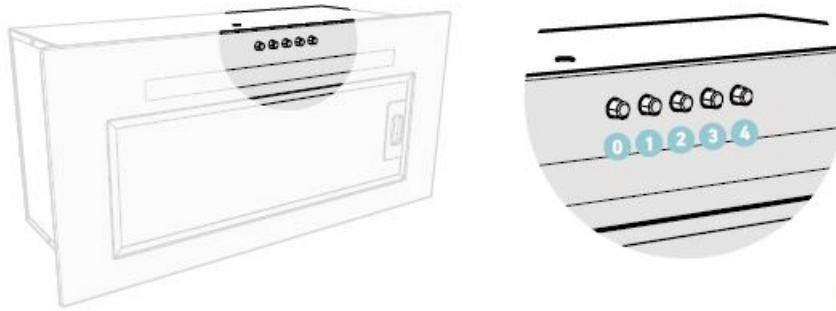

Fig. 14

- pressing the button turns the hood turbine off
- pressing the button turns the hood turbine on at a minimum speed
- pressing the button turns the hood turbine on at medium speed
- pressing the button turns the hood turbine on at maximum speed
- pressing the button turns the lighting on. Pressing the button again turns the lighting off.

IN CASE OF PROBLEMS

The range hood does not function at all:

- Check whether the fuse in the domestic installation is not pulled out.
- Check if the thermal cutout of the motor has not been activated due to high temperature. If this is the case, switch off the device and wait for about 20 – 30 minutes until the temperature returns to normal; then switch the hood on again.
- Make sure that the plug is inserted in the socket.
- Remove the plug to restart the device. Wait for about 15 – 20 seconds and then plug it back in.
- Alternatively, you can also pull out the fuse for that time and then put it back in.

Insufficient efficiency / noisy operation:

- Check whether the cross-section of the ventilation duct is sufficient and whether it does not have too many bends and sharp angles.
- Check if the return flap (if optionally installed) is not jammed in the ventilation duct.
- If the ventilation duct is equipped with a swinging grille, remove it.
- Make sure that the metal filters are clean.
- Replace the active carbon filter if it is older than 6 months (only in recirculation mode).
- Check whether the amount of air extracted from the kitchen is balanced by sufficient fresh air supply (to prevent negative pressure).
- Check whether the ventilation chimney is not obstructed.
- Excessively low atmospheric pressure may reduce the performance of the hood. Verify the functioning of the hood again on another day.

ENERGY LABEL

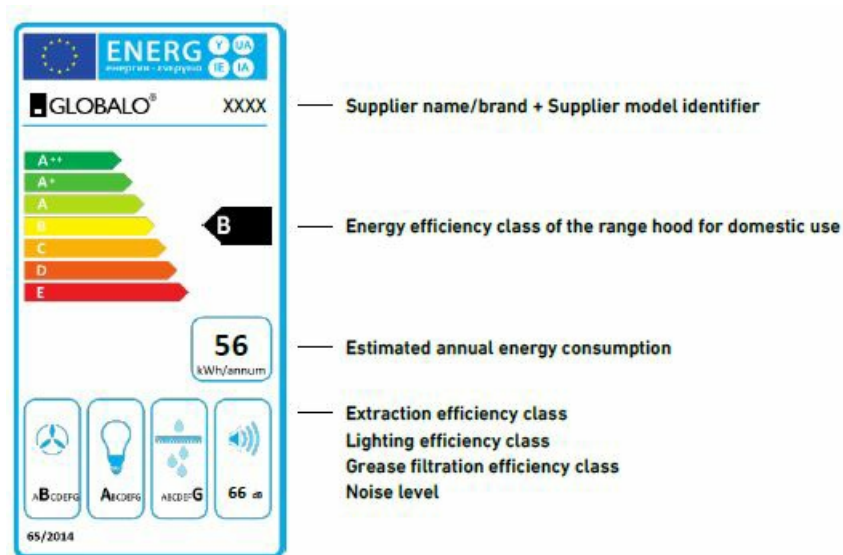

- The above energy label is only an example. The actual data can deviate from that specified above in any other model.



REDUCING THE IMPACT OF COOKING ON THE ENVIRONMENT

- In order to reduce energy consumption, cover pots and pans with lids while cooking.
- Keep the aluminium filters clean (the recommended cleaning schedule for the filter is at least once every 35 hours).
- Keep the ventilation ducts unobstructed.
- Always set the turbine speed during cooking to the minimum required level, allowing for fume extraction at the current cooking intensity.

SERVICE AND MAINTENANCE

- If, despite our strict quality control, you find any irregularities in the operation and functioning of the purchased device, please contact our service department to receive professional assistance of our team.
- The service support is available Monday to Friday from 9.00 am to 5.00 pm at: +48 13 49 27 560 extension: 3 and +48 609 055 660 or by email at: serwis@globalo.pl.
- Before connecting the service, please take down the following details of your device:
- **Type:** _____
- **Seria-Nr:** _____
- You can find this information on the identification plate. The plate is located inside the hood and is visible after removing the metal filters.



Type	BENIKOR 60
Engine Power	115 W
Lighting power	5 W
Total power	120 W
Supply Voltage / frequency	220-240V/50Hz
Outlet diameter	Ø12 cm
Seria-Nr	7350001
GLOBALO MAX Ul. Maków 10 38-500 Sanok	 

- The identification plate shown in the figure above is only an example. The data may differ for other models.
- To request a hood repair, you can use the form available at <https://globalo.pl/serwis/>.

TROUBLESHOOTING

Problem	Possible reason	Solution
When the hood is operating, a flashing „F” appears on the display*.	After 35 hours of operation, the display indicates that the anti-grease filter needs to be cleaned or replaced.	Press and hold down for approx. 6s the „-” button on the panel. Clean the filter or replace it with a new one.
The display only shows the „-.” sign (minus and dot in the lower right corner), the hood does not start when switched on*.	The touch panel is locked (this is a function used to facilitate cleaning of the hood).	To deactivate the lock, press and hold the on/off sign for approx. 10s.
No sign appears on the display, the hood does not respond to the buttons*.	The control panel may be frozen.	Disconnect the hood from the power supply for approx. 15 seconds and then switch it on again.

<p>The display shows the sign of one of the speed levels and the hood does not react to the buttons*.</p> <p>The hood turbine switches off after 15 minutes. of operation and the display blinks with, for instance, „1“ (the number of the current speed level and a dot in the lower right corner of the display*.</p>	<p>The control panel may be frozen.</p> <p>The automatic timer of the control panel has been activated.</p>	<p>Disconnect the hood from the power supply for approx. 15 seconds and then switch it on again.</p> <p>To deactivate the timer, press the plus sign for about 10 seconds or switch off the device.</p>
<p>Number „4“ on the display is blinking, and after 5 min. the speed level changes to 3*.</p>	<p>The hood is equipped with a turbo mode, which automatically changes to level 3 after 5 minutes of operation to save energy.</p>	<p>The turbo mode should only be used for intensive cooking.</p>
<p>The hood can only be operated using the control panel, it does not react to the remote control*.</p>	<p>The battery in the remote control is flat or the remote is too far from the device.</p>	<p>Replace the battery.</p>
<p>Low suction efficiency.</p> <p>One or more light bulbs are not lit.</p>	<p>The filters may be dirty.</p> <p>Burnt halogen or LED bulb.</p>	<p>Wash or replace the anti-grease filter. Replace the carbon filter (if any).</p> <p>Replace the bulb in accordance with the user manual.</p>
<p>The hood generates excessive noise and vibration.</p>	<p>The reason may be the incorrect installation of the hood to the wall or kitchen cabinet. Not all of the screws required were screwed in, or the screws were not tightened enough, leaving clearance.</p>	<p>The hood must be fixed to the wall or cabinet using the number of screws indicated by the manufacturer. After adjusting the position of the hood vertically and horizontally, tighten all the mounting screws.</p>

- applies to range hoods with touch control
- If after following the above-mentioned guidelines the problem is still not solved, contact an authorised household appliance repair service.
- Do not try to repair the hood yourself. A list of authorised repair centres is provided on the warranty card and on the website.

LED STRIP REPLACEMENT

- The installation must be carried out by qualified personnel.



WARRANTY

- Within the period of 2 years from the date of purchase of the product, GLOBALO undertakes to cover all repair costs for faults that are obviously caused by manufacturing defects. The warranty does not cover burnt bulbs, fuses and filters, as well as any damage due to faulty installation and ventilation system.

In addition, the warranty does not apply in the following cases:

- Application in the catering industry.
- Application for any other purposes than household use.
- Use of the device not in accordance with the operating instructions and its intended purpose.
- Circumstances beyond the control of the manufacturer, including, without limitation: uncontrolled power surges, flooding, and obstruction of the ventilation duct.
- Apparent mechanical damage after the installation of the device.

CAUTION!

- ANY PRODUCT WITH MECHANICAL DAMAGE, WHICH HAS NONETHELESS BEEN INSTALLED, WILL NOT BE REPLACED! BEFORE INSTALLATION OF THE DEVICE, UNPACK IT AND CAREFULLY INSPECT IT FOR ANY MISSING COMPONENTS OR DAMAGE. ANY VISIBLE EXTERNAL DAMAGE CLAIMED AFTER INSTALLATION IS EXCLUDED FROM THE WARRANTY.
- GLOBALS MAX SHALL NOT BE HELD LIABLE FOR DAMAGE CAUSED DIRECTLY OR INDIRECTLY BY PERSONS, ANIMALS OR OTHER OBJECTS AS A RESULT OF NON-COMPLIANCE WITH THE INSTRUCTIONS IN THIS MANUAL, IN PARTICULAR THOSE CONCERNING INSTALLATION, OPERATION AND MAINTENANCE OF THE DEVICE!

Centrala Firmy / Company Headquarters / Hauptsitz der Firma:

- **GLOBALO**
- **ul. Maków 10**
- **38-500 Sanok**
- **Polska / Poland / Polen**
- **Tel.: +48 13 49 27 560**
- **<https://globalo.pl>**
- **e-mail: biuro@globalo.pl**
- **Serwis / Service / Kundendienst: Tel.: +48 13 49 27 560 wew. 3 Kom.: +48 609 055 660**
- **e-mail: serwis@globalo.pl <https://globalo.pl/serwis/>**
- **Ver. 1 / Copyright ©**

Company Headquarters

Service:

- **Phone:** +48 13 49 27 560 extension 3
- **Mobile phone.:** +48 609 055 660
- **e-mail: serwis@globalo.pl**

- <https://globalo.pl/serwis/>

Documents / Resources

 <p>GLOBALO</p> <p>Benikor</p>	<p>GLOBALO 602 Built-In Range Hood [pdf] Instruction Manual</p> <p>602 Built-In Range Hood, 602, Built-In Range Hood, Range Hood, Hood</p>
---	---

References

- [Ciche i wydajne Okapy Kuchenne | GLOBALO](#)
- [Serwis GLOBALO](#)
- [User Manual](#)