



## global sources T92 Car Bluetooth FM Transmitter User Manual

[Home](#) » [global sources](#) » global sources T92 Car Bluetooth FM Transmitter User Manual 

# global sources

User Manual  
T92 Car Bluetooth FM Transmitter



## Contents

- 1 Product Diagram
- 2 Adjust FM Frequency
- 3 Specifications
- 4 Bluetooth Operation Instruction
- 5 Troubleshooting
- 6 Correct Disposal Of This Product
- 7 Documents / Resources
- 7.1 References

## Product Diagram

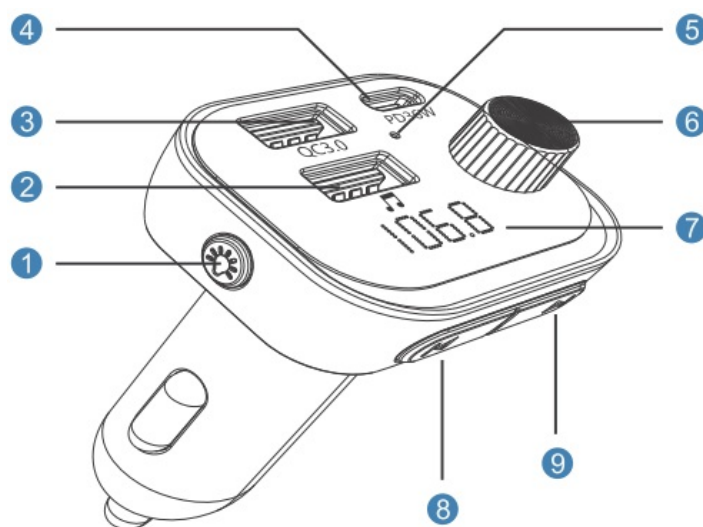

- 1. Lighting Control/Play Mode Control
- 2. Music US8 Port
- 3. QC 3.0
- 4. PD36W
- 5. Microphone
- 6. Multifunction Button(MFB)
- 7. Display Screen
- 8. Previous
- 9. Next

## Adjust FM Frequency

Press the MFB for about 2 seconds, the display flashes means it entered FM frequency adjust mode Rotate the MFB to increase or reduce frequency

## Features

- 1. Transmit the music/navigation of your Bluetooth-enabled smart device to car stereo via FM signal.
- 2. Unique display screen, display car voltage when plugged in.
- 3. Answer phone calls during driving.
- 4. Type-C 36W & OC 3.0 for charging dual device faster.

## Specifications

Bluetooth Frequency: 2.402 ~ 2.480GHz

Effective Bluetooth Range: 5 meters

FM Frequency: 88.1-107.9Mhz

QC 3.0 Output: 5V/3A 9V/2A 12V/1.5A

PD 36W Output: 5V/3A 9V/3A 12V/3.0A PPS 3.3-11V 3A

## Adjust Volume

Rotate the MFB to increase or reduce volume

## Bluetooth Operation Instruction

1. Plug the transmitter into the car cigarette socket
2. The transmitter will power on after you plugged it in, the display flashes means it is in pairing mode
3. Turn on the Bluetooth function of your smart device Search for Bluetooth devices and select "T92"
4. If pairing is successful, the display will stop flashing and show the FM frequency
5. Tune the car FM radio to a blank FM station
6. Tune the FM transmitter to the same frequency as the car FM radio
7. Open the music player/navigation of your smart device, now it can transmit phone calls, music, or navigation to the car stereo system

## Remark

1. It will connect to the last paired device automatically when turned on next time (Turn on the Bluetooth of your smart device first, and then turn on the product)
2. For the best audio quality, please turn the volume of your smart device and FM transmitter to the max level.
3. The signal of any FM transmitter sometimes can be interfered with by the surrounding radio or a similar frequency signal thus causing noise, this is normal
4. If the noise is too loud, please try another blank FM station.

## Make/Answer a Call

The transmitter can make or answer a call after successfully connecting to your phone via Bluetooth

1. Redial the last number: Double-click the MFB
2. Reject a call: Long press the MFB for about 2 seconds
3. Answer a call: Press the MFB once
4. Hang up a call: Press the MF B once

## Music Play/Pause

1. Play/Pause: Press the MFB once
2. Next song: Press the Next" button
3. Previous song: Press the Previous" button

## Switch Between Bluetooth Mode/USB Mode

Long press the side light control button to switch BT mode/USB mode to play music.

## Music Source

The product plays music from the last connected device and will memorize it next time.

## Troubleshooting

### 1. About noise

- Turn down the volume of the car speaker to its 1/3 level and prioritize turning up the volume of the FM transmitter or smart devices.
- Signal interference: Change your car radio into another any unused and empty one ( 88.1-107.9MHz). Then adjust the FM transmitter to the same frequency.

### 2. Cannot hear the person you called

- Select T92 to answer the call via car speaker.
- Turn up the volume of your phone or FM transmitter.
- The volume on the other end of the calls is too low.  
Ask the other side of the phone to speak up.
- Broken Mic. Contact the seller.

### 3. No charging

- Check whether the product is in good contact with the cigarette port and whether the cigarette holder is not rusted.
- Unplug and retry again.
- Check if the cigarette holder is powered normally.

### 4. Can't play

Please make sure the volume is not set to 0.

### 5. The audio of the car can't receive sound.

- Make sure that the product FM launch has been turned on.
- Is the transmission frequency of the product the same as the reception frequency of the car's?

## Correct Disposal Of This Product



■ (Waste Electrical & Electronic Equipment)

- This marking shown in the product or its literature, indicates that it should not be disposed of with other household wastes at the end of its working life.
- To prevent possible harm to the environment or human health from uncontrolled waste disposal, please separate this from other types of waste and recycle it responsibly to promote the sustainable reuse of material resources.
- Household users should contact either the retailer where they purchased this product or their local government office for details of where and how they can take this item for environmentally safe recycling.
- Business users should contact their suppliers and check the terms and conditions of the purchase contract. This product should not be mixed with other commercial wastes for disposal.

**NOTE:** This equipment has been tested and found to comply with the limits for a Class B digital device, pursuant to part 15 of the FCC Rules. These limits are designed to provide reasonable protection against harmful

interference in a residential installation. This equipment generates, uses and can radiate radio frequency energy and, if not installed and used in accordance with the instructions, may cause harmful interference to radio communications. However, there is no guarantee that interference will not occur in a particular installation. If this equipment does cause harmful interference to radio or television reception, which can be determined by turning the equipment off and on, the user is encouraged to try to correct the interference by one or more of the following measures:

- Reorient or relocate the receiving antenna.
- Increase the separation between the equipment and receiver.
- Connect the equipment into an outlet on a circuit different from that to which the receiver is connected.
- Consult the dealer or an experienced radio/TV technician for help.

Changes or modifications not expressly approved by the party responsible for compliance could void the user's authority to operate the equipment.

This device complies with Part 15 of the FCC Rules. Operation is subject to the following two conditions:

1. this device may not cause harmful interference, and
2. this device must accept any interference received, including interference that may cause undesired operation.



---

## Documents / Resources

	<a href="#">global sources T92 Car Bluetooth FM Transmitter</a> [pdf] User Manual T92, T92 Car Bluetooth FM Transmitter, Car Bluetooth FM Transmitter, Bluetooth FM Transmitter, FM Transmitter, Transmitter
---	---

## References

- [User Manual](#)

[Manuals+](#), [Privacy Policy](#)

This website is an independent publication and is neither affiliated with nor endorsed by any of the trademark owners. The "Bluetooth®" word mark and logos are registered trademarks owned by Bluetooth SIG, Inc. The "Wi-Fi®" word mark and logos are registered trademarks owned by the Wi-Fi Alliance. Any use of these marks on this website does not imply any affiliation with or endorsement.