



global sources Smart Series Biological Microscope Instructions

[Home](#) » [global sources](#) » global sources Smart Series Biological Microscope Instructions 



Contents

- [1 global sources Smart Series Biological Microscope](#)
- [2 Introduction](#)
- [3 SMART Series Biological Microscope Outfits](#)
- [4 SMART-e320/500 Digital Microscope Characteristics](#)
- [5 SMART-e Digital Microscope Outfits](#)
- [6 Dimension](#)
- [7 Documents / Resources](#)
- [8 Related Posts](#)

global sources Smart Series Biological Microscope



Introduction

- Excellent OTICS infinity optical system, outstanding resolution and definition.
- Original integrated stand for excellent stability.



- Unique aspheric illumination system, provide bright and comfortable lighting.
- Various colorful matching looking can provide lively environment and happy mood.



Rackless(Integrated) stage

- Various accessories for upgrading.
- Back handle and observing hole convenient for carry and operation.
- Alternative color for main body.

- Wire winding device convenient for carry and storage (optional)

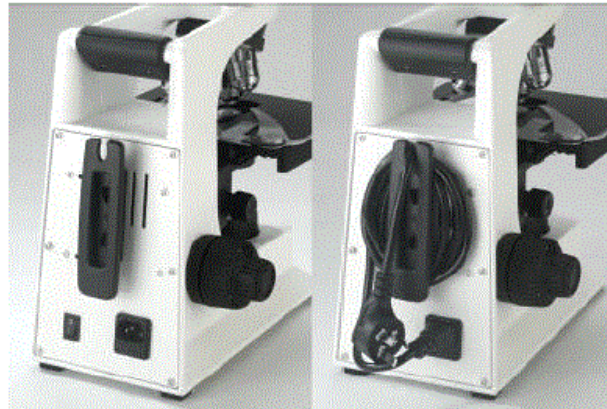

- Phase contrast unit, Independent phase contrast unit (apply to infinity optical system)



- Polarizer, analyzer for simple polarizing unit.

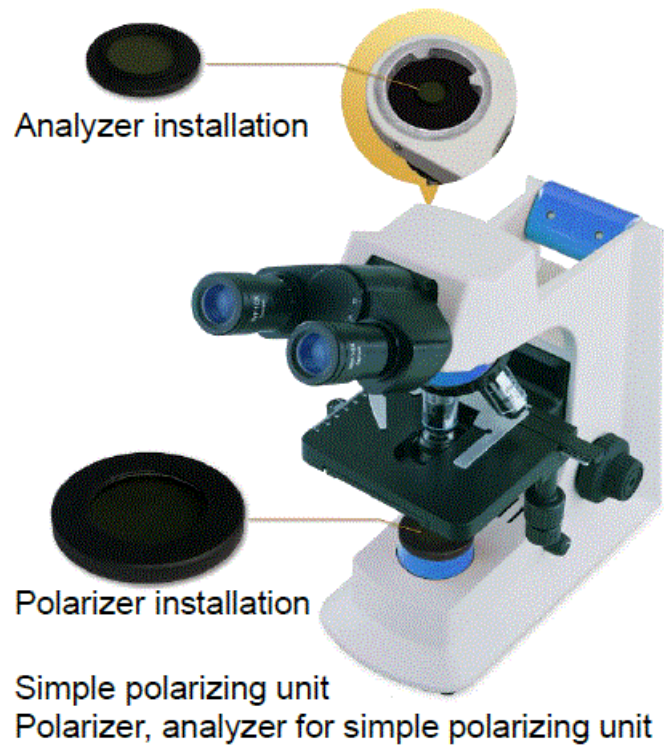

- Dry Dark Field Condenser



- Mirror



SMART Series Biological Microscope Outfits

Items	Specification	SMART -1	SMART -2	SMART -3	SMART -4
Eyepiece	WF 10X-18mm	●●			
	WF 10X- 20mm		●●	●●	●●
	4X	●			
Finity Achromatic Objective	10X	●			
	40X(S)	●			
	100X/1.25 (Oil) (S)	●			
	4X		●		
Finity Plan Objective	10X		●		
	40X/0.65 (S)		●		
	100X/1.25 (Oil) (S)		●		
	4X			●	
Infinity E-Plan Objectives	10X			●	
	40X (S)			●	
	100X (Oil) (S)			●	
Infinity Plan Objectives	4X				●
	10X				●
	40X (S)				●

	100X (Oil) (S)				●
	Plan 20X			○	○
	Plan 60X (S)			○	○

Seidentopf Binocular Head	Inclined 30°,Rotatable 360°, Interpupillary Distance 48-75mm	●	●	●	●
Seidentopf Trinocular Head	Inclined 30°,Rotatable 360°, Interpupillary Distance 48-75mm, Light Distribution 20:80	○	○	○	○
Nosepiece	Quadplex , Quintuple (Optional)	●	●	●	●
	Stage Size: 145 mm×140mm Travel: 76mm X52mm, Scale: 0.1mm Coaxial Coarse and Fine Focusing Knobs Travel Range: 26mm, Scale: 2um	●	●	●	●
Mechanical Stage	Two Slide Holder				
	Rackless(Integrated) stage, size: 140×135mm,Travel range: 75×35mm, Two-slide holder	○	○	○	○
Condenser	Abbe N.A. 1.25(Iris Diaphragm)	●	●	●	●
	3W-LED Illumination Systems	●	●	●	●
Illumination	12V/20W Halogen Lamp	○	○	○	○
	6V/30W Halogen Lamp	○	○	○	○
Field Diaphragm		○	○	○	○
Dark Field Condenser	Dry, apply to 4X – 40X objective	○	○	○	○
	Wet, apply to 100× objective	○	○	○	○

Polarizing Attachment	Analyzer/Polarizer	○	○	○	○
Independent phase contrast unit	10X /20X /40X /100X			○	○
	Epi fluorescence unit (six-hole disc media which can be fixed with Uv /V/B/G and another filters) ,100W mercury lamp.			○	○
Fluorescence Attachment					
	Epi fluorescence unit (six-hole disc media which can be fixed Uv /V/B/G), 5W-LED fluorescence lamp.			○	○
	Blue	○	○	○	○
Filter	Green	○	○	○	○
	Yellow	○	○	○	○
C-Mount	0.5X/0.75X Focus adjustable	○	○	○	○
	1X Focus adjustable	○	○	○	○
Mirror		○	○	○	○
Wire winding device		○	○	○	○

Note: “●”In Table Is Standard outfits, “○” Is Optional Accessories.

Packing Size: 390mm×280mm×450mm

Gross Weight: 7.5 kgs

Net Weight: 6.5 kgs

SMART-e320/500 Digital Microscope Characteristics



- Dustproof, moisture-proof, built-in chip.
- Light distribution 20:80, eyepiece observation synchronized with digital imaging without switching.
- Built-in 3MP/5MP digital camera system, 1/2" CMOS color sequential scanning.
- USB2.0 connection without external power supply.
- Available for WINDOWS system.

SMART-e Digital Microscope Outfits

Items	Specification	SMART-e320	SMART-e500
Eyepiece	WF 10X-20mm	●●	●●
	4X	●	●
Infinity EPlan Objective	10X	●	●
	40X/0.65 (S)	●	●
	100X/1.25 (Oil) (S)	●	●

Seidentopf Binocular Head	Inclined 30°,Rotatable 360°,Interpupillary Distance: 50-75mm	●	●
Nosepiece	Quadplex	●	●
Mechanical Stage	Stage Size: 145mm×140mm Travel: 76mm×52mm, Scale: 0.1mm,Two Slide Holder	●	●
Condenser	Abbe N.A. 1.25(Iris Diaphragm)	●	●
	LED Illumination Systems	●	●
Illumination	6V/20W Halogen Lamp	○	○
	6V/30W Halogen Lamp	○	○
Image Systems		3.2MP Pixel	5 MP Pixel

Note: “●”In Table Is Standard outfits, “○” Is Optional Accessories.

Packing Size: 570mm×275mm×450mm

Gross Weight: 8 kgs

Net Weight: 7 kgs

Dimension

SMART Biological Microscope Size(mm)

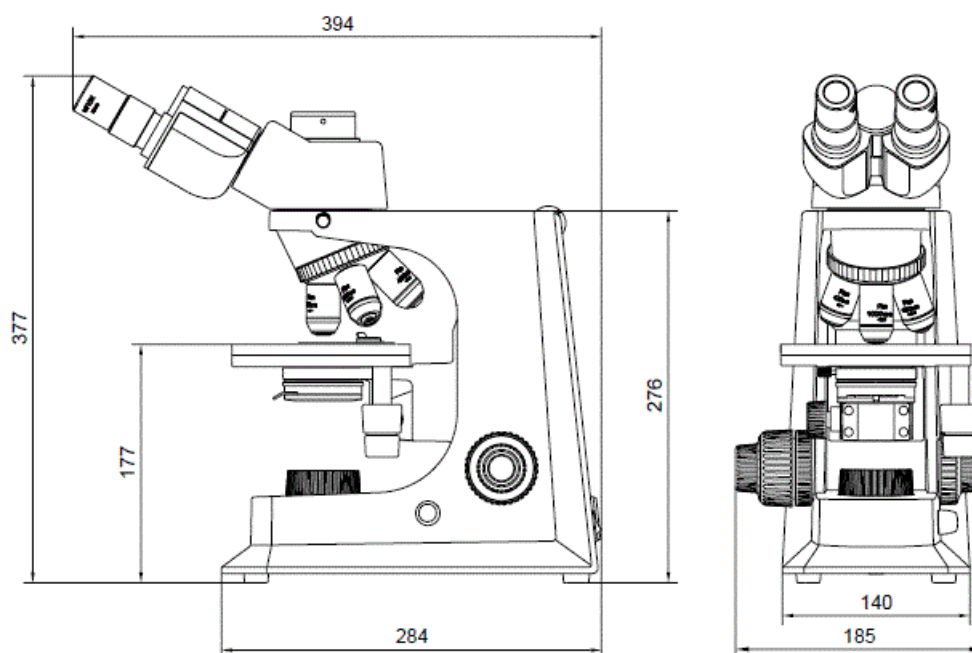

SMART-FL Fluorescence Microscope Size(mm)

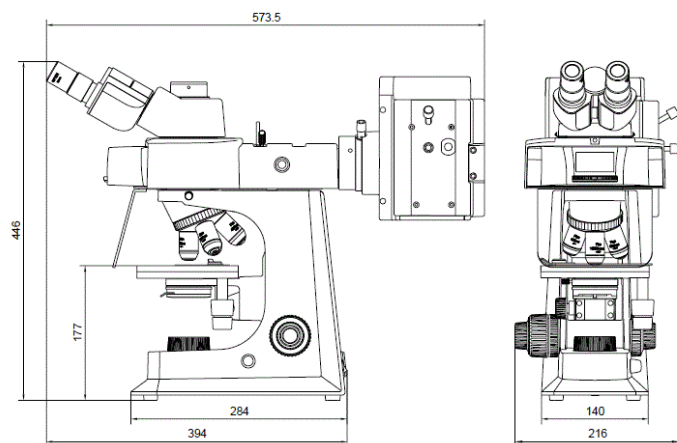

SMART-E320/500 Digital Microscope Size(mm)

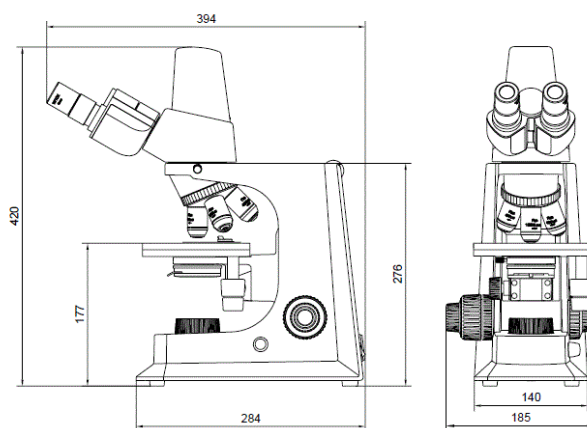

Documents / Resources

 <p>SMART Series Biological Microscope</p> <ul style="list-style-type: none"> 1. SMART Series Biological Microscope 2. SMART Series Biological Microscope 3. SMART Series Biological Microscope 4. SMART Series Biological Microscope 5. SMART Series Biological Microscope 6. SMART Series Biological Microscope 7. SMART Series Biological Microscope 8. SMART Series Biological Microscope 9. SMART Series Biological Microscope 10. SMART Series Biological Microscope 	<p>global sources Smart Series Biological Microscope [pdf] Instructions</p> <p>Smart Series Biological Microscope, Smart Series, Biological Microscope, SZ760</p>
---	---