

GLEDOPTO GL-C-004P Zigbee Pro 12V LED Strip Kit Three Button Controller Instruction Manual

[Home](#) » [GLEDOPTO](#) » GLEDOPTO GL-C-004P Zigbee Pro 12V LED Strip Kit Three Button Controller Instruction Manual 

Contents

- [1 GLEDOPTO GL-C-004P Zigbee Pro 12V LED Strip Kit Three Button Controller](#)
- [2 POWER STRUCTURE DIAGRAM](#)
- [3 INSTALLATION](#)
- [4 INSTRUCTIONS FOR USE](#)
- [5 BATTERY INSTALLATION](#)
- [6 MODE DESCRIPTION](#)
- [7 PHILIPS HUE CONNECTION STEPS](#)
- [8 Documents / Resources](#)
- [9 Related Posts](#)



GLEDOPTO GL-C-004P Zigbee Pro 12V LED Strip Kit Three Button Controller

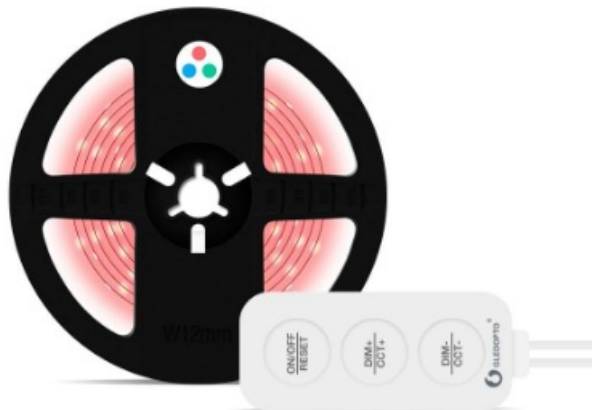

THREE-BUTTON CONTROLLER

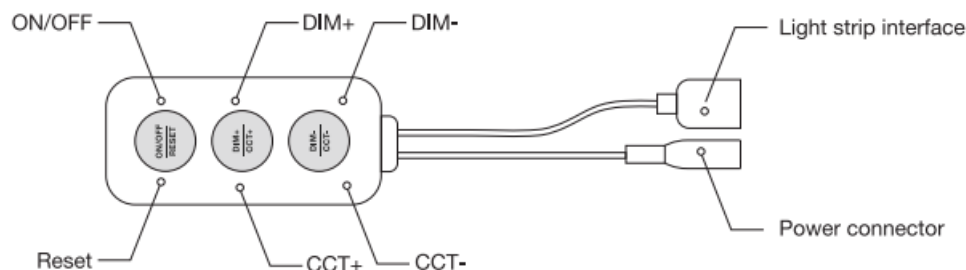

FUNCTION KEY INTRODUCTION/PRODUCT PARAMETER

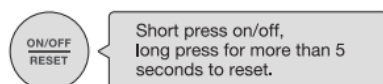

Short press on/off,
long press for more than 5
seconds to reset.

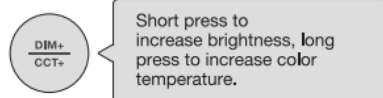

Short press to
increase brightness, long
press to increase color
temperature.



Short press to
decrease brightness, long
press to decrease color
temperature.

PRODUCT NAME: LED Strip Light Kit

MODEL: GL-C-004P

INPUT VOLTAGE: DC12V

COLOR: RGB+CCT

STRIP LENGTH: 2m

STRIP WIDTH: 12mm

LEDS/METER: 90LEDs/m

POWER/M: 18W/m

LED TYPE: SMD5050+2835

CONTROLLER STRUCTURE DIAGRAM

1. The device will enter 'touch link' mode by default after power off and restart, and the mode will be turned off after 160s. If the device has been connected to the network, it will enter "find and binding" mode, and the mode will be turned off after 180s.

2. Repeat power off and on times to go into the 'Power On Behavior' mode (the device will 'save the state before power off').

Which means:

- If this lighting is on, after electricity drop and back, the lighting still on.
- If this lighting is off, after electricity drop and back, the lighting still off.
- Power cycle 3times to turn off the 'Power On Behavior' mode. And device will back to 'default lighting ON' state.

3. **RESET:** repeat power off and on for 5times.

LIGHT STRIP STRUCTURE DIAGRAM

LIGHT STRIP STRUCTURE DIAGRAM

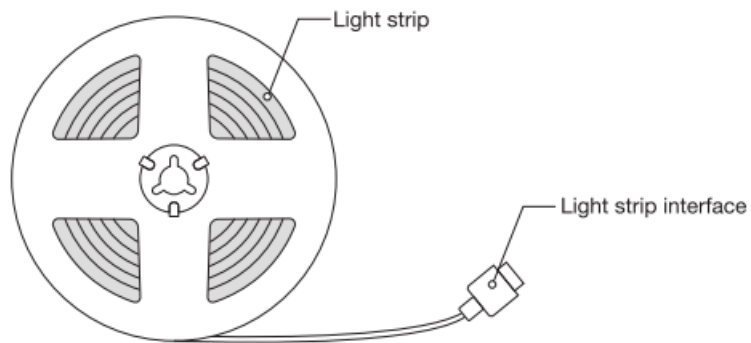

POWER STRUCTURE DIAGRAM

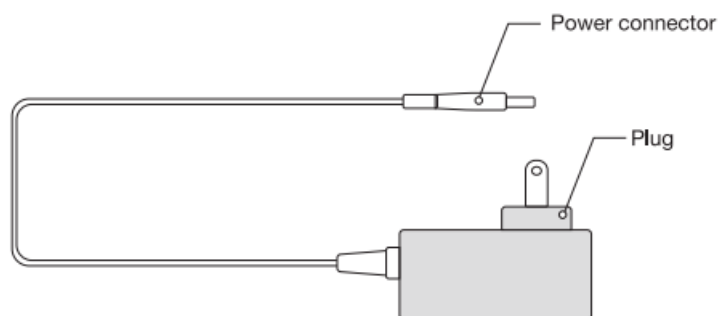

INSTALLATION

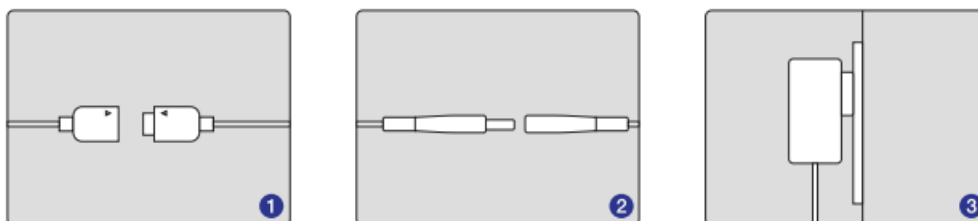

- Connect light strip interface
- Connect the power connector
- Insert the power plug into the socket

INSTRUCTIONS FOR USE

FEATURES

- Gledopto zigbee products directly work with: HUE, Amazon echo plus, SmartThings, Home etc. via
- Hue gateway, can work with google home, all other alexa devices.

APP WORK WIHT HUE GATEWAY

- Hue, hue essential, hueparty, hue Disco, iConnectHue, Hue Widget, Light DJ, etc
 - **WORK WITH HOME ASSISTANT** <http://bitly.ws/dELh>

- **WORK WITH HOMEKIT:** <http://bitly.ws/eiZY>

- **SYNC EFFECT WITH SCREENBLOOM**

Sync your lights with movies, music, and games, Enjoy the lighting effect which synchronizes with the plot of the picture immediately, and experience the more delicate atmosphere lighting effect.

HOW TO SYNC

- Please follow this website: <http://www.screenbloom.com/>
- Sync show Demo: https://youtube/zZjtJMy_774
- Q&A or mor info, please go to: www.gledopto.com or email to sales@gledopto.com, or <http://www.reddit.com/r/Gledopto/> (Not officail)

LED-TRADING Toblas Ebert

EC/REP: Schoeneicher Str.42, Schoeneiche b. Berlin, Germany, 15566, 0049 30 641 689 17 info@led-trading.de

RGB+CCT REMOTE CONTROL (GL-RC-006Z)

This manual describes GB+CCT remote control used for our GB+CCT products. Rmote control can control the LED lights up to six different Zones, change the color, dim/brighten the lights, warm/cool white, different programs. In this manual, you will learn.

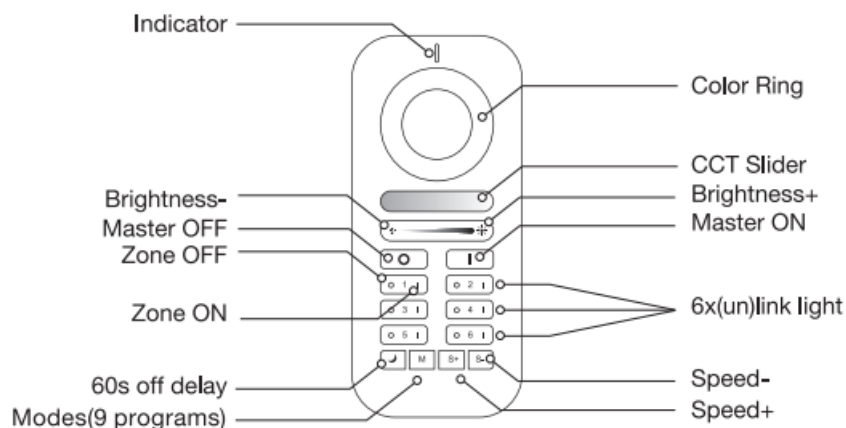

BATTERY INSTALLATION

Please take the remote control and carefully press the battery cover and push it away in a downward motion. Install two AAA batteries, exactly match the negative(-) pole of each battery to the largest spring. Don't touch the color ring when you install the batteries. Place the battery cover back and insatll tightly.

HOW TO LINK & USE REMOTE CONTROL

- Within 3 seconds after the light power on, click the “on” button in the group to perform code matching. The LED light turns green means successful code matching.
- Long prees the “off” button of the remote control to enter the night mode, and the brightness and color can still be adjusted at this time.
- Long prees the small moon key to enter the 60 seconds delay shutdown state.
- Click the “M” key to enter automatic mode.

HOW TO UNLINK

- G Within 4s of powering on the light, press the “main on” button 5 times continuously, and the light flashes, indicating that the light is unpaired from all the remote controls that have been coded, and will not be controlled by any remote control.
- Within 4s of powering on the light, press the paired “group on” button 5 times continuously, and the light flashes, indicating that the light is unpaired from the remote control and will not be controlled by the remote control. Other paired remote controls can still be controlled.

MODE DESCRIPTION

MODE DESCRIPTION

- **MODE1** Static warm light (warm light alone)
- **MODE2** Static white light (cold light and warm light are equally bright)
- **MODE3** Static cold light (cold light alone)
- **MODE4** Static red light
- **MODE5** Static green light
- **MODE6** Static blue light
- **MODE** RGB fade out (Color fade in fade out from red to green, the to blue, the to red, and so on, speed adjustable)
- **MODE5** GB flash (Color flash from red to green, then to blue, the to red, and so on, speed adjustable.)
- **MODE9** Color breathing (In this mode, brightness of current color will cycle from 100%~0%, the from 0%~100%. At the same time, you can switch the color and have a cycle repeatedly. Pressing switch/mode button to exit this mode.)

HOW TO LINK & USE WITH ZIGBEE HUB

These devices works with many ZigBee light link/ZigBee 3.0 Gateways like Philips Hue, Amazon Echo Plus, Terncy Home Center or SmartThings.

CONNECTION WITH GATEWAY

- Start the device searching on the ZigBee light link/ZigBee 3.0 Gateway, it could take some time. If the Gateway does not find the device, plug power off/on or make a reset.
- After finding te device, the light will turn green and flash 3 times, then you can save it to the rooms/groups.
- Now you can use the device.

RESET

1. Switch on your device.
2. Now turns off in less than 2 seconds, wait longer than 2 seconds and then turns it on again.
3. Repeat off/on five times.
4. Reset is done when the device is switched on in the fifth time, and the LED lights are flashing 4 times and then turn into white light. (if remote control are not paired, it will turn to white light, other wise the light will keep the

original color)

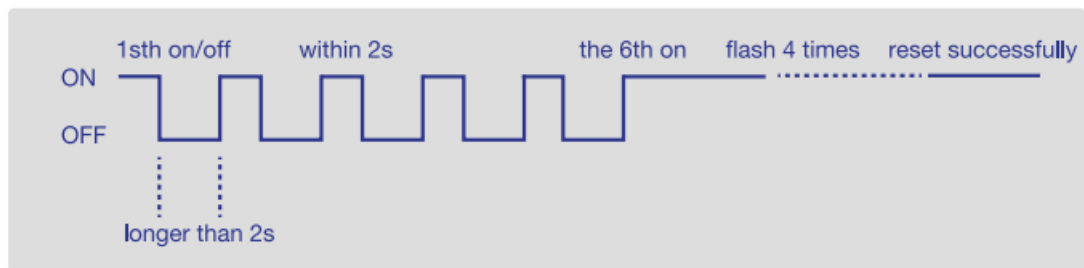

PHILIPS HUE CONNECTION STEPS

HUE ZIGBEE CONNECTION

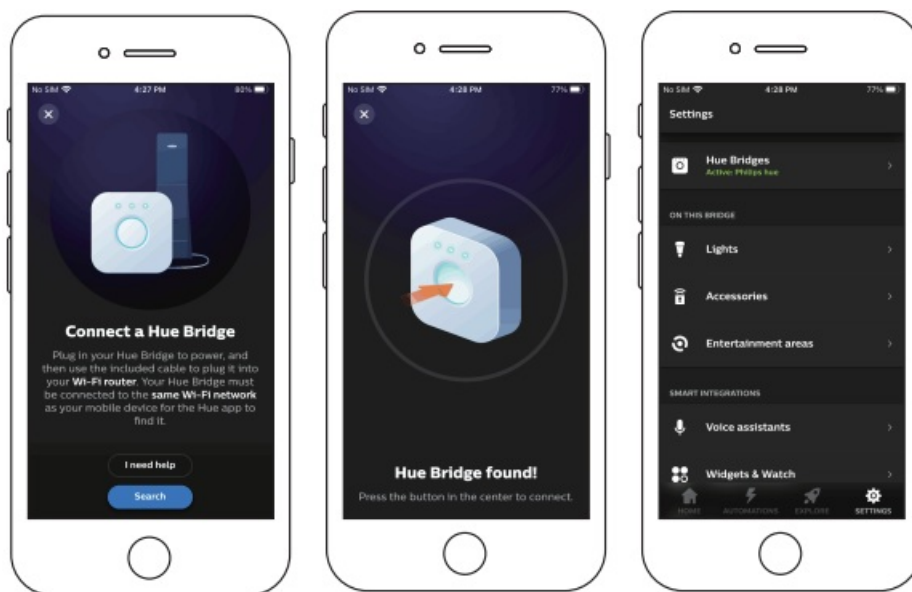

1. Open “HUE” APP and wait to search for gateway.
2. Click “set up” after searching successfully.
3. Go to “Settings” to see if the connection is successful.

HUE ZIGBEE CONNECTION

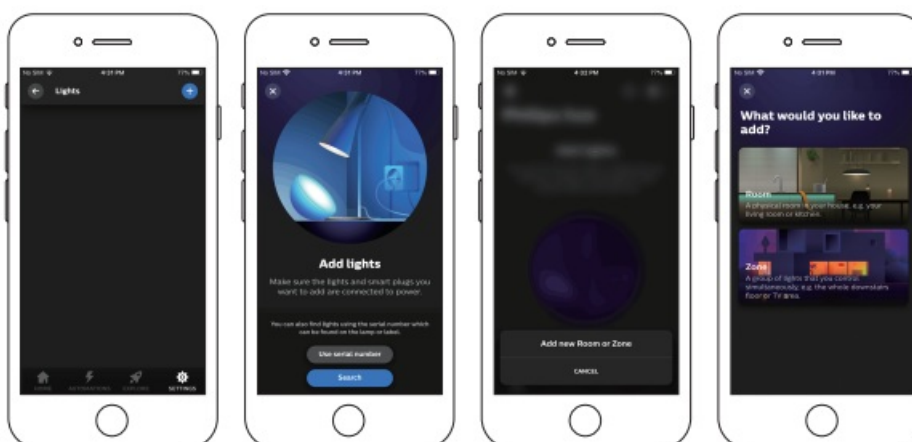

- Enter “Lights” and click “+” in the menu to add fixtures according to the prompts.
- Click the “+” in the upper right corner of the homepage to enter the settings and follow the prompts to add a room.

HUE ZIGBEE CONNECTION

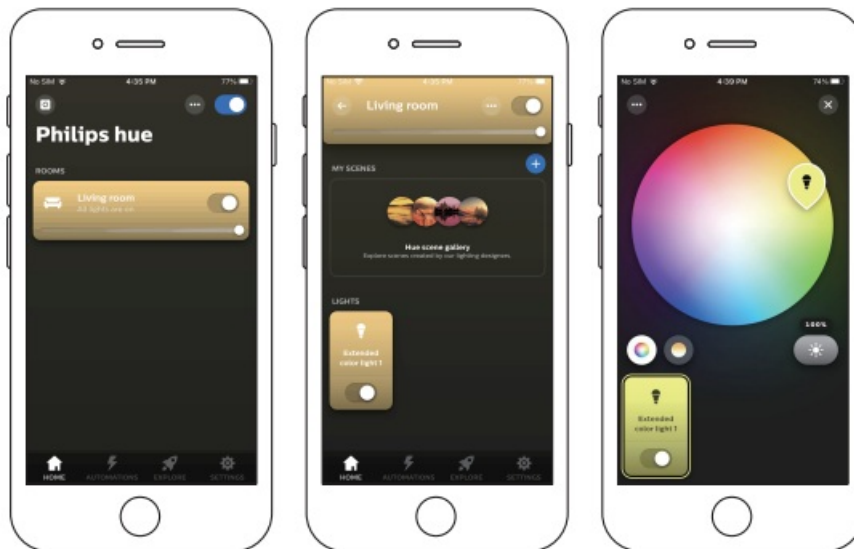

- Click “Home” to find the previously set group, click to enter to see the fixtures added in the group.
- Tap the card to set the light.

Documents / Resources

	<p>GLEDOPTO GL-C-004P Zigbee Pro 12V LED Strip Kit Three Button Controller [pdf] Instruction Manual</p> <p>GL-C-004P Zigbee Pro 12V LED Strip Kit Three Button Controller, GL-C-004P, GL-C-004P Zigbee Pro 12V LED Strip Kit Three Button Controller, Strip Kit Three Button Controller, Three Button Controller</p>
---	--