



GL iNET GL-AP1300LTEC4 AC1300 Wireless Access Point User Guide

[Home](#) » [GL iNet](#) » GL iNET GL-AP1300LTEC4 AC1300 Wireless Access Point User Guide 

Contents

- [1 GL iNET GL-AP1300LTEC4 AC1300 Wireless Access Point](#)
- [2 SETTING UP](#)
- [3 Set up Router](#)
- [4 POWER SUPPLY OPTIONS](#)
- [5 SUPPORT](#)
- [6 Technical Support](#)
- [7 WITH 4G MODULE](#)
- [8 WARRANTY](#)
- [9 HONG KONG Office](#)
- [10 Shenzhen Office](#)
- [11 Documents / Resources](#)
- [12 Related Posts](#)



GL iNET GL-AP1300LTEC4 AC1300 Wireless Access Point



SETTING UP

Power on

When powered up, your GL-AP1300 will broadcast two Wi-Fi signals with the SSID: GL-AP1300-xxx and GL-AP1300-xxx-56. The PoE injector should be compatible with the active or passive 48V 802.3at standard.

Connect to the Wi-Fi

Connect to the 2GHz Wi-Fi called GL-AP1300-XIIIIC, and input the default Wi-Fi password good/life, which is also printed on the bottom of the router.



- Search the SSID and connect to it



- The default password is Goodlife

Set up Router

- Visit <http://1192.168.8.1> in your browser to set up your router; start by choosing your preferred language.

or

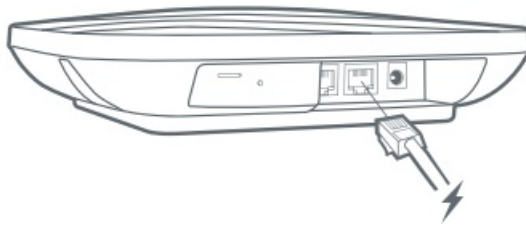

- Plug in the Ethernet cable with PoE power

Connect via LAN

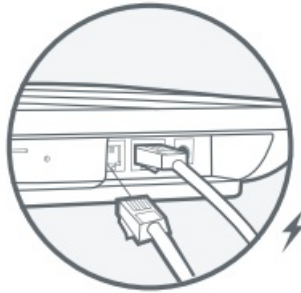

or

- Plug the cable connecting to your computer into the LAN port



POWER SUPPLY OPTIONS

PoE (Power over Ethernet)

- The PoE injector should be compatible with the 48V 802.3at standard. PoE only works on the WAN port.

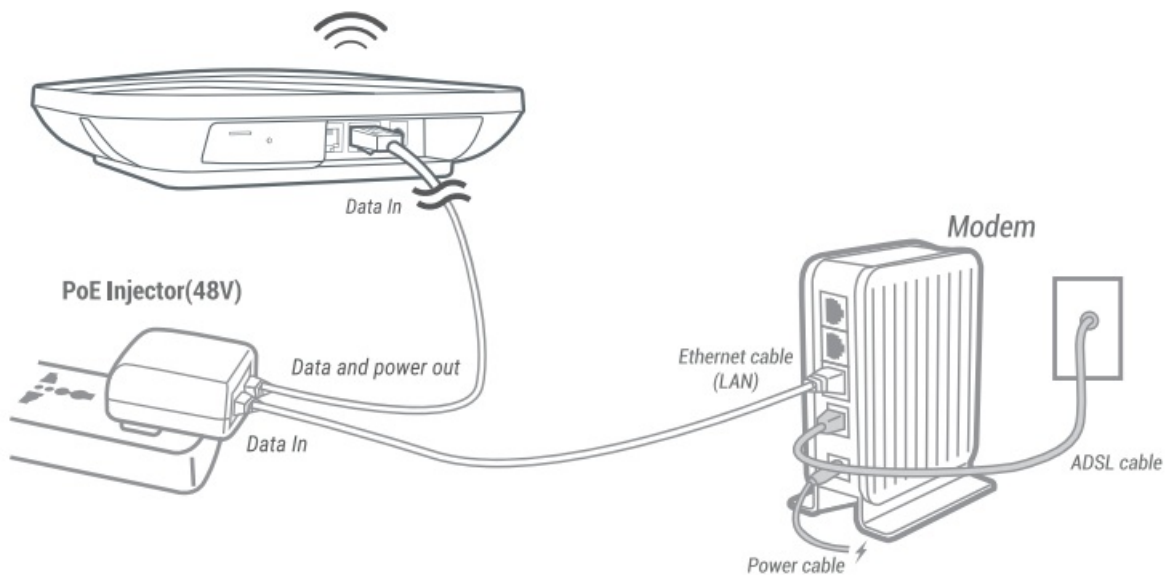

- (D This router does NOT work with 24V PoE injectors.

Power cable

- Please use a power cable (12V/2A DC).

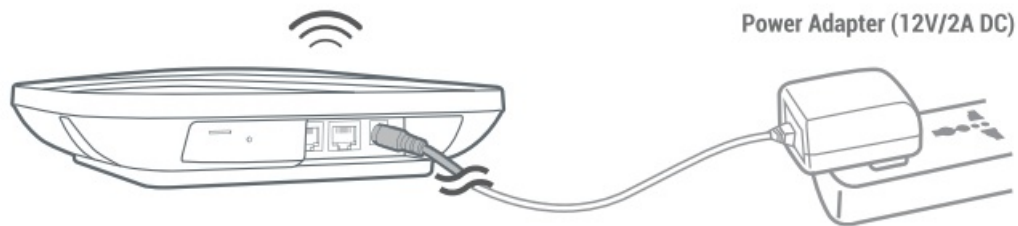

SUPPORT

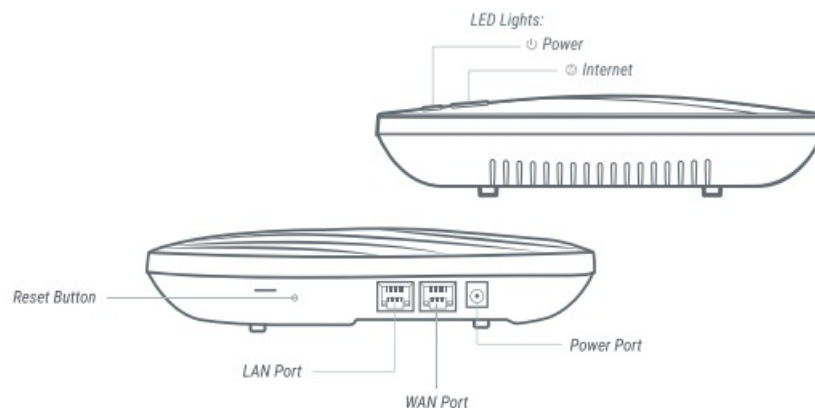

Repair/ Reset

If you cannot access the web-based setup page or cannot connect to the router, you can press the Reset button:

- Press and hold for 3 seconds, and then release to repair your network.
- Press and hold for 10 seconds, and then release to reset the router to factory settings. All user data will be cleared.

Technical Support

- For more detailed and updated instructions, please visit our website docs.gt-inet.com
- For further questions, you can get help in the following ways:
- **Email to support@gl-inet.com**
- Message us on our Facebook: facebook.com/gl.inet.wifi
- **Post questions in our forum: forum.gl-inet.com**
- Ask professionals in other forums e.g. OpenWrt, LEDE, or other professional websites.

WITH 4G MODULE

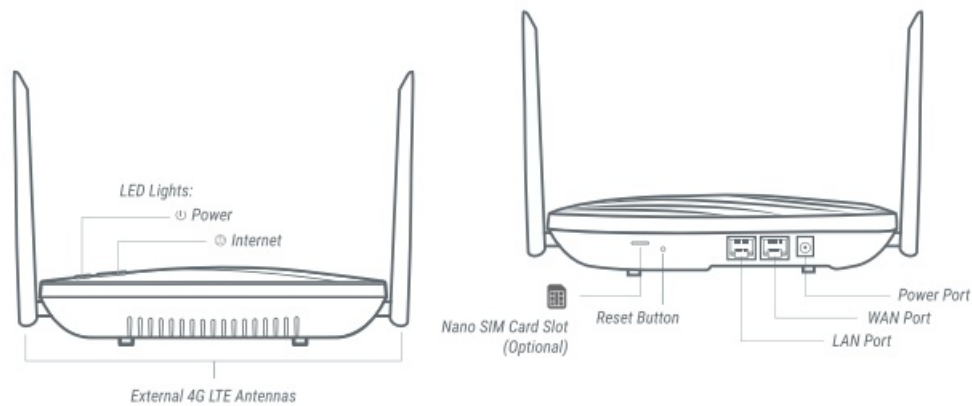

Insert Nano SIM Card & Attach the External Antennas

- Insert Nano SIM Card and attach the antennas before connecting to a power supply.

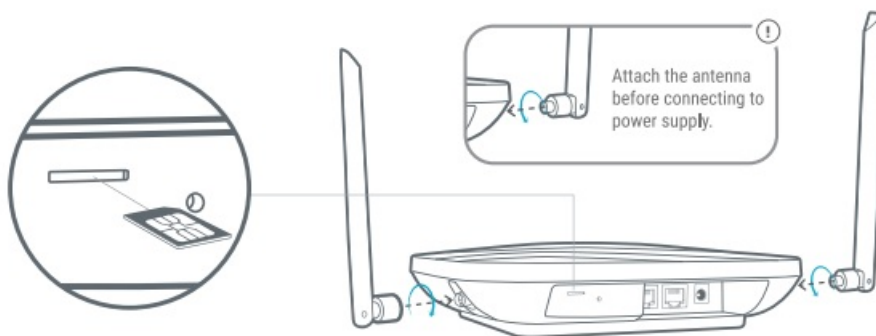

- Hot-plug for the nano-SIM card is not supported for this router.

WARRANTY

- We provide a one-year limited warranty for routers and a 3-month limited warranty for accessories. Extra warranty may apply according to the local law in which the product purchase took place.
- Highly recommend using the included 12V/2A power adapter.
- Any damage to the router caused by not following the instructions will render this warranty null and void.
- Any damage to the router caused by modifying the PCBA, components, or case will render this warranty null and void.
- Issues caused by the use of third-party firmware may not get official support from us.
- Any damage to the router caused by inappropriate use, e.g. inappropriate voltage input, high temperature, dropping in the water, or on the ground will render this warranty null and void.
- Pictures on the instructions are only for reference. We reserve the right to change or modify these materials without further notice.

FCC ID: 2AFIW-AP1300C4

This device complies with Part 15 of the FCC Rules. Operation is subject to the following two conditions:

1. This device may not cause harmful interference, and
 2. This device must accept any interference received, including interference that may cause undesired operation.
- Changes or modifications not expressly approved by the party responsible for compliance could void the user's

authority operate the equipment.

3. **NOTE:** This equipment has been tested and found to comply with the limits for a Class B digital device, pursuant to part 15 of the FCC Rules.

These limits are designed to provide reasonable protection against harmful interference in a residential installation. This equipment generates uses and can radiate radio frequency energy and, if not installed and used in accordance with the instructions, may cause harmful interference to radio communications. However, there is no guarantee that interference will not occur in a particular installation. If this equipment does cause harmful interference to radio or television reception, which can be determined by turning the equipment off and on, the user is encouraged to try to correct the interference by one or more of the following measures:

- Reorient or relocate the receiving antenna.
- Increase the separation between the equipment and the receiver.
- Connect the equipment into an outlet on a circuit different from that to which the receiver is connected.
- Consult the dealer or an experienced radio/TV technician for help.

FCC Radiation Exposure Statement

This equipment complies with FCC radiation exposure limits set forth for an uncontrolled environment, and accessories. This equipment should be installed and operated with a minimum distance of 20 cm between the transmitter and your body. This transmitter must not be co-located or operate in conjunction with any other antenna or transmitters.

The Equipment named above is confirmed to comply with the requirements set out in the European Council Directive on the Approximation of the Laws of the Member States relating to RED (2014/53/EU). The equipment passed the tests which were performed according to the following European standards:

- EN 301 489-1 V2.1.1; EN 301 489-17 V3.1.1; EN 301 489-52 V 1.1.0
- EN 300 328
- EN 301 893 V2.1.1
- EN 62311:2018
- EN 62368-1:2014+A11:2017

Caution

- The device operation in the band 5150-5250 MHz is only for indoor use to reduce the potential for harmful interference to co-channel mobile satellite systems;
- This product uses WIFI 2.4GHz Operating Frequency is 2400-2483.5MHz; 5GHz Operating Frequency is 5150 – 5250MHz and 5725 – 5850MHz;
- The Product complies with Directive 2011/65/EU and its amendment Directive 2015/863/EU (RoHS 2.0)

HONG KONG Office

- GL Technologies (Hong Kong) Limited
- Unit 203, 2/F, Building 19W, 19 Science Park West Avenue, Hong Kong
- Science Park, Pak Shek Kok, N.T., Hong Kong

Shenzhen Office

- Shenzhen Guanglianzhi Technology Co., Ltd.
- Room 305 – 306, Skyworth Digital Building, Shiyan Street,
- Baoan District, Shenzhen, China, 518000 (+86-0755-86606126)

Documents / Resources

	<p>GL iNET GL-AP1300LTEC4 AC1300 Wireless Access Point [pdf] User Guide AP1300C4, 2AFIW-AP1300C4, 2AFIWAP1300C4, GL-AP1300LTEC4 AC1300 Wireless Access Point, GL-AP1300LTEC4, AC1300 Wireless Access Point</p>
---	--

[Manuals+](#)