

# GHT-S7415H2 HDMI KVM Switch User Manual

[Home](#) » [GHT](#) » GHT-S7415H2 HDMI KVM Switch User Manual 



**HDMI 4\*1 KVM SWITCH**  
**Model:GHT-S7415H2**  
**USER MANUAL**

## Contents

- [1 GHT-S7415H2 HDMI KVM Switch](#)
- [2 Description](#)
- [3 Features](#)
- [4 Package list](#)
- [5 Specifications](#)
- [6 Port Description](#)
- [7 Diagram](#)
- [8 Connection steps](#)
- [9 Warranty](#)
- [10 Documents / Resources](#)
  - [10.1 References](#)

## GHT-S7415H2 HDMI KVM Switch

Any issues,like tech-support,please feel free to contact us,we will try our best to help you solve the problem.

### Warm Tips

1. Please keep this manual in a safe and conspicuous place for easy reference when needed.
2. If you encounter any problems when using the product, please contact us so that we can provide you with

friendly after-sales support.

## Description

The HDMI 4\*1 KVM switcher can freely switch four sets of high definition audio and video signal sources and USB signals. It supports EDID adaptive function that can adapt to a variety of complex application environments. The device has excellent image processing and transmission capabilities, making the output signal more smooth and stable. It is a reliable, high-performance and efficient switching device.

## Features

- Support free switching between four high definition audio and video signal sources and USB signals;
- Support HDMI 2.0, HDCP 2.2 standard and USB 3.0 protocol;
- Support resolution up to 3840\*2160@60Hz, backward compatibility;
- Support HDMI dual display (this function is only used on the host that supports dual display or multi display);
- Support maximum data transfer rate 5 Gbps for USB 3.0;
- Automatic adaptation of EDID, adapt to a variety of complex application environments;
- Automatically identify and configure various display modes;
- Built-in automatic equalization system, making the picture smoother, clearer and more stable;
- Simple and easy to install, plug and play, no need any drivers.

## Package list

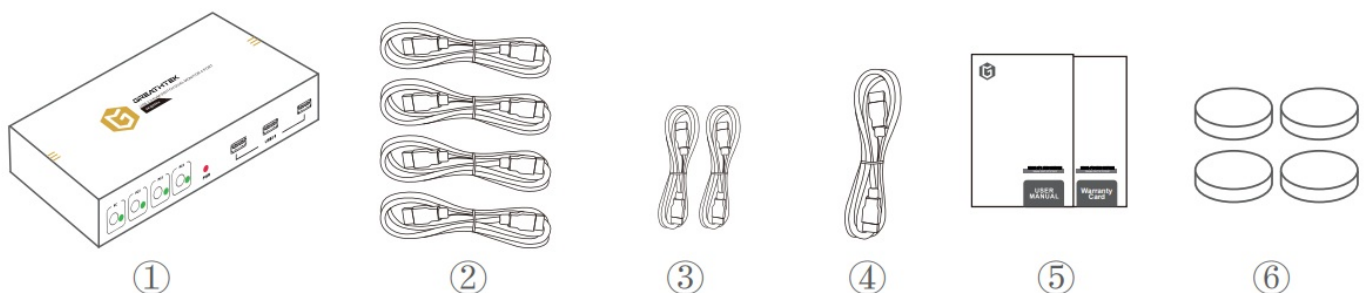

(1) HDMI 4*1 KVM Switcher Host	1 Pcs
(2) USB-A to USB-A USB 3.0 Cable	4 Pcs
(3) HDMI2.0 Cable	2 Pcs
(4) USB-A to USB-C Power Cable	1 Pcs
(5) User Manual+Warranty Card	1 Set
(6) Foot Pad	4 Pcs

## Specifications

	Parameter	Description
Video	Standards	HDMI 2.0, HDCP 2.2
	Maximum Pixel Clock	600 MHz
	Maximum Data Rate	18 Gbps
	Maximum Resolution	3840*2160@60Hz,Backward compatibility
	Connector	HDMI-A Interface
	Impedance	1000
	HDMI Cable Range	<5M( Resolution: 1920*1080@60Hz)
USB	Interface Protocols	USB 3.0
	Maximum Data Transfer Rate	5 Gbps
	PC Input Interface Type	USB-A
	Output Interface Type	USB-A
Other	Power Supply	5V power supply
	Power Dissipation	MAX 3W
	Temperature	Operating: -5°C – +70°C
	Humidity	Operating: 5% – 90%
	Dimension	202*76*33mm
	The Warranty	1 year free warranty

## Port Description

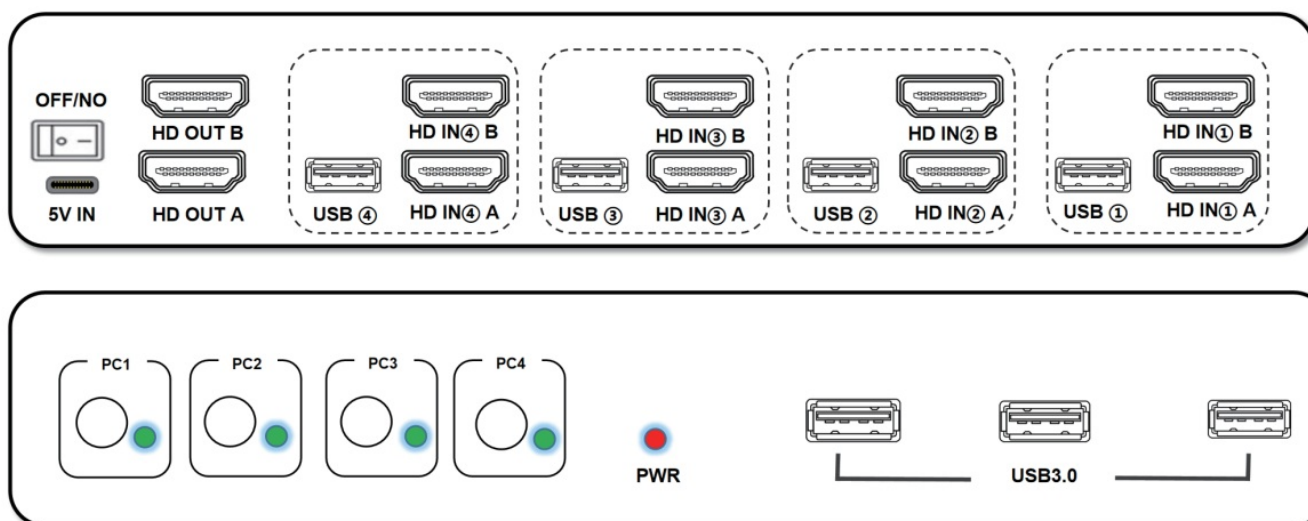

Port name	Description
OFF/ON	Power switch
5V IN	5V power input interface
HD OUT A	HDMI signal output interface for group A
HD OUT B	HDMI signal output interface for group B
HD IN①A/HD IN①B/USB①	HDMI A, HDMI B and USB signal input interface for group 1 PC1
HD IN②A/HD IN②B/USB②	HDMI A, HDMI B and USB signal input interface for group 2 PC2
HD IN③A/HD IN③B/USB③	HDMI A, HDMI B and USB signal input interface for group 3 PC3
HD IN④A/HD IN④B/USB④	HDMI A, HDMI B and USB signal input interface for group 4 PC4
PC1/PC2/PC3/PC4	PC1, PC2, PC3, PC4 signal groups switch buttons and selected indicators
PWR	Power input indicator
USB 3.0	USB3.0 device input interface

## Diagram

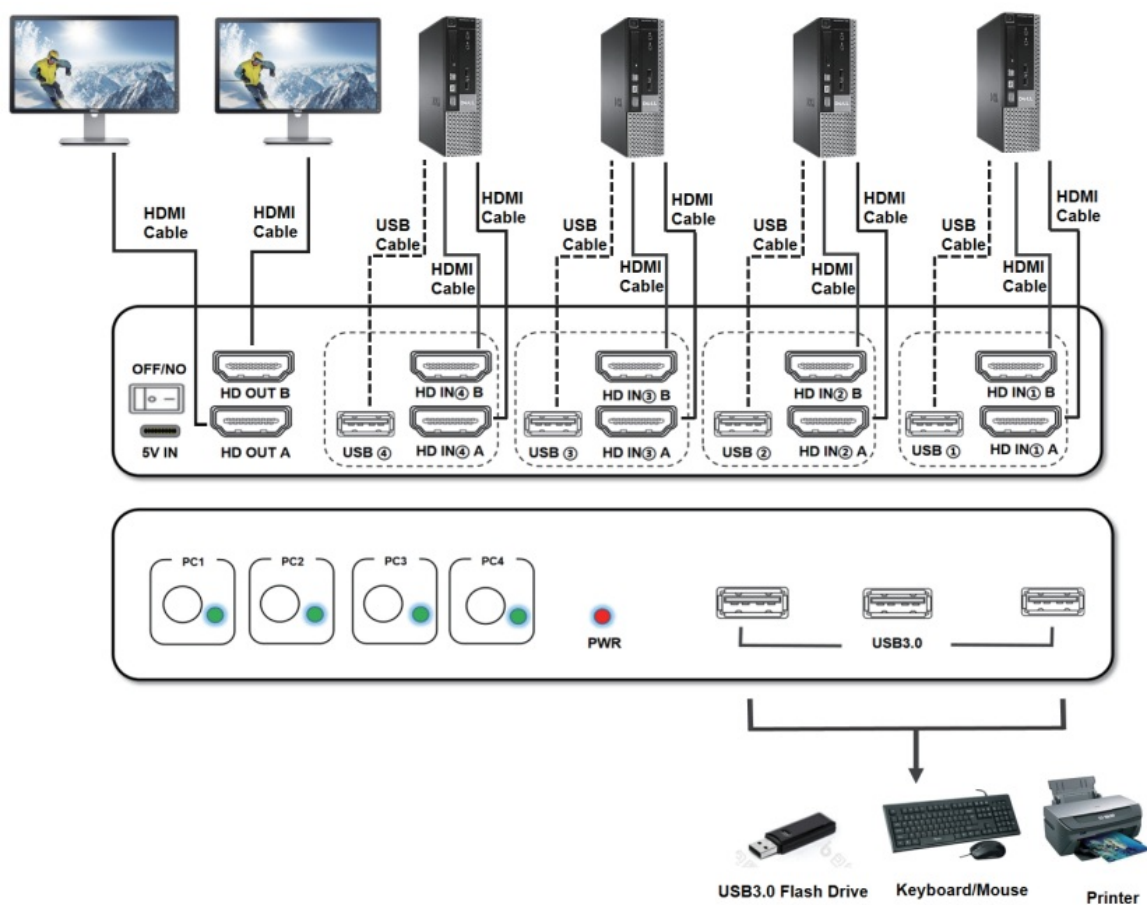

## Connection steps

1. Use 1 HDMI cable to connect the “HD IN①A” input interface and PC1 HDMI A output interface,  
Use 1 HDMI cable to connect the “HD IN①B” input interface and PC1 HDMI B output interface.
2. Use 1 “USB-A to USB-A” USB3.0 cable to connect the “USB①” input interface and PC1 USB interface.

3. Use 1 HDMI cable to connect the “HD IN②A” input interface and PC2 HDMI A output interface,  
Use 1 HDMI cable to connect the “HD IN②B” input interface and PC2 HDMI B output interface.
4. Use 1 “USB-A to USB-A” USB3.0 cable to connect the “USB②” input interface and PC2 USB interface.
5. Use 1 HDMI cable to connect the “HD IN③A” input interface and PC3 HDMI A output interface,  
Use 1 HDMI cable to connect the “HD IN③B” input interface and PC3 HDMI B output interface.
6. Use 1 “USB-A to USB-A” USB3.0 cable to connect the “USB③” input interface and PC3 USB interface.
7. Use 1 HDMI cable to connect the “HD IN④A” input interface and PC4 HDMI A output interface,  
Use 1 HDMI cable to connect the “HD IN④B” input interface and PC4 HDMI B output interface.
8. Use 1 “USB-A to USB-A” USB3.0 cable to connect the “USB④” input interface and PC4 USB interface.
9. Use 2 HDMI cables to connect the “HD OUTA” “HD OUTB” output interface and 2 monitors.
10. Connect the USB3.0 device to the “USB3.0” interface.
11. Use 1 “USB-A to USB-C” USB power cable connect the “5V IN” interface and power source.
12. Turn on the “OFF/ON” power switch, when the “PWR”, “PC1”, “PC2”, “PC3” or “PC4” indicator lights up normally, the system is running normally.

## Warranty

Thank you for using this product. In order to protect your rights, please read the following rotation terms carefully: We provide 1 year warranty and lifetime maintenance after-sales service for this product. Within the warranty period of one year from the time of purchase, we provide free maintenance services due to hardware failures caused by the quality of the product itself. customers with Please keep the user manual in a safe and easily accessible place for immediate reading when necessary.



## Safety Instruction

- Please do not disassemble this product by yourself because it doesn't including DIY function.
- Please keep the product away from water in case damaged, because it is not waterproof design.
- Please use dry cloth when clean the product surface.
- Please do not use this product in environments that are too humid or too hot.
- Please avoid contact with corrosive substances.
- When there is damage or other physical damage to the product, please stop using and contact customer service to get support.

# GHT



## [GHT GHT-S7415H2 HDMI KVM Switch](#) [pdf] User Manual

GHT-S7415H2 HDMI KVM Switch, GHT-S7415H2, HDMI KVM Switch, KVM Switch, Switch

## References

- [User Manual](#)