



GEONFINO G2 Gateway Smart Wi-Fi Hub User Manual

[Home](#) » [GEONFINO](#) » **GEONFINO G2 Gateway Smart Wi-Fi Hub User Manual** 

Contents

- [1 GEONFINO G2 Gateway Smart Wi-Fi Hub](#)
- [2 Light Status](#)
- [3 Pair the Gateway with TTLock App](#)
- [4 Pair your Alexa](#)
- [5 Add TTLOCK Skill](#)
- [6 Warranty](#)
- [7 Documents / Resources](#)
 - [7.1 References](#)

GEONFINO

GEONFINO G2 Gateway Smart Wi-Fi Hub



- Model: G2
- Dimensions: 2.76X2.76X1.02 inches
- Network: WiFi 2.4G
- IEEE standard: 802.11 b/g/n
- Power interface: Type-C USB
- Power input: 5V/500mA

Light Status

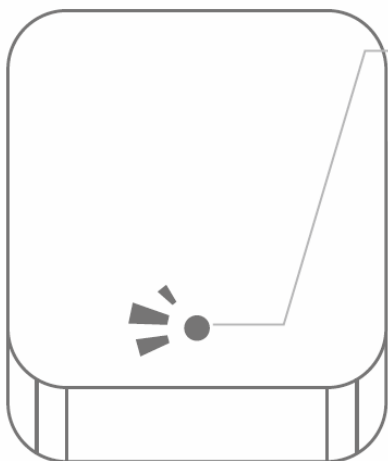

When the Gateway is powered on:

- ↔ ● Flashing Red/Blue lights:
Stand-by mode - Ready to pair
- Blue light: Normal mode
- Red light: Network failure

Pair the Gateway with TLock App

1. Open the TLock app.
2. Touch the " = " icon on the top left of the screen.
3. Select [Gateway].

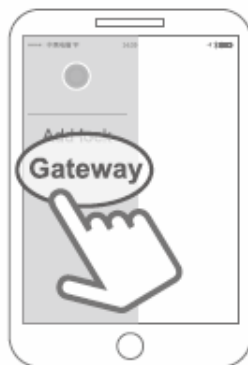
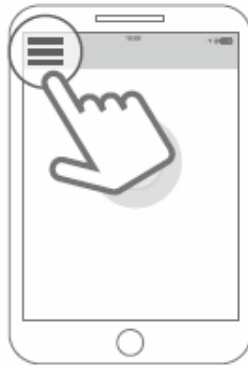

4. Press "+" in the upper right corner.
5. Select [G2].

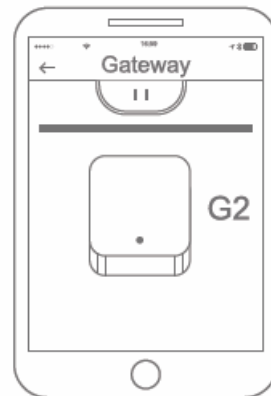

6. Plug in the Gateway and power it on.

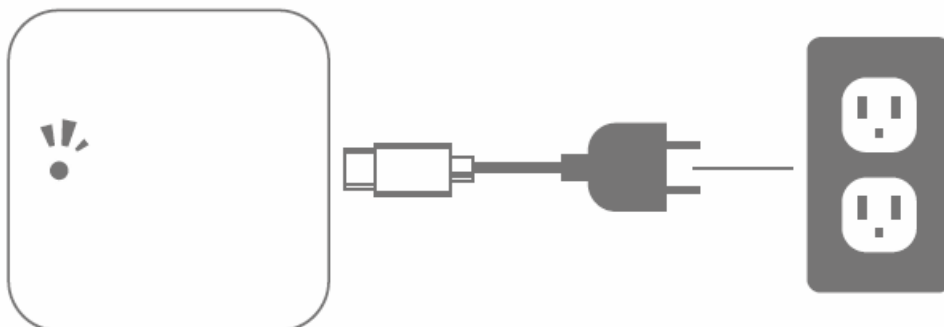

7. While the light is flashing alternately in red and blue, press” + “sign.

8. Add Gateway.

9. Select the network and input your WiFi password.



Notice: If the above process times out, please power off and try again.

Pair your Alexa

Enable remote unlock function in TTlock before you use the voice control.

1. Select the "Setting" option.
2. Select the "Remote Unlock" option.
3. Click the "fomoo".

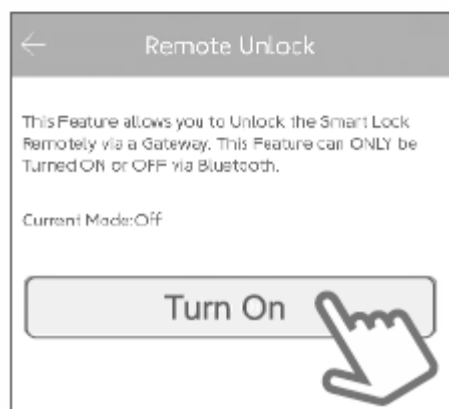
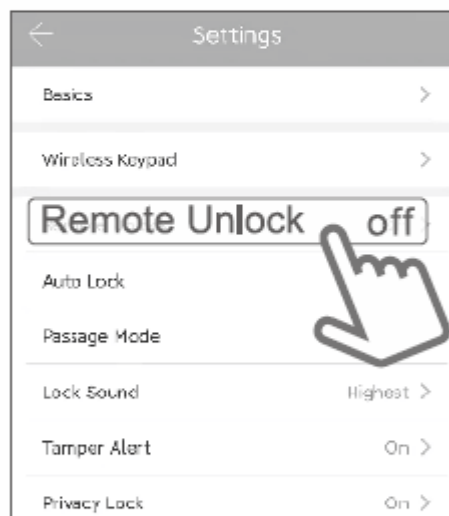
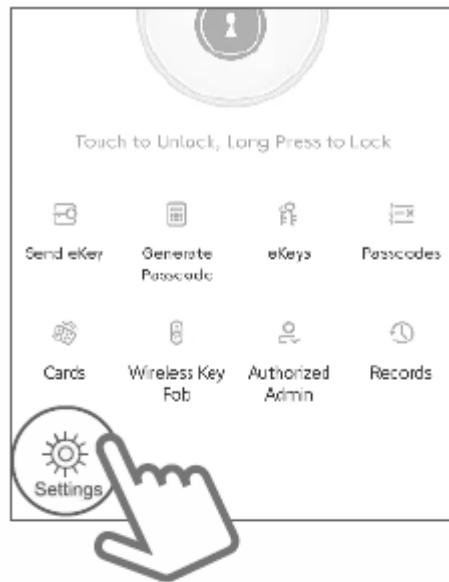

Login Alexa App

Input the Amazon account and password to login Alexa app.

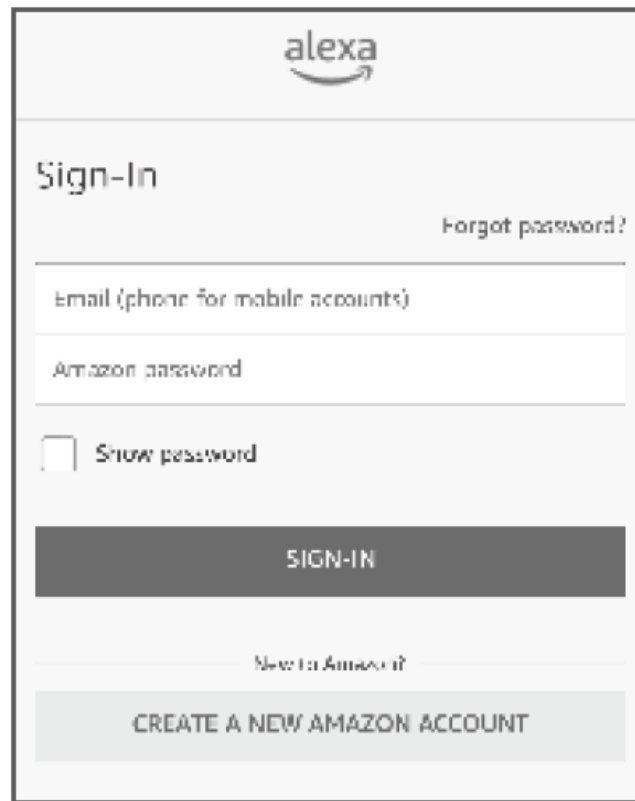
The image shows the Amazon Alexa mobile app's sign-in screen. At the top is the Alexa logo. Below it, the text "Sign-In" is on the left, and "Forgot password?" is on the right. There are two input fields: "Email (phone for mobile accounts)" and "Amazon password". Below the password field is a checkbox labeled "Show password". A dark grey "SIGN-IN" button is centered below the inputs. At the bottom, there is a link "New to Amazon?" and a light grey button labeled "CREATE A NEW AMAZON ACCOUNT".

alex

Sign-In

[Forgot password?](#)

Email (phone for mobile accounts)

Amazon password

☐ Show password

SIGN-IN

[New to Amazon?](#)

CREATE A NEW AMAZON ACCOUNT

Add TTLOCK Skill

1. Press the "more" sign.
2. Select "Skill & Games" option.

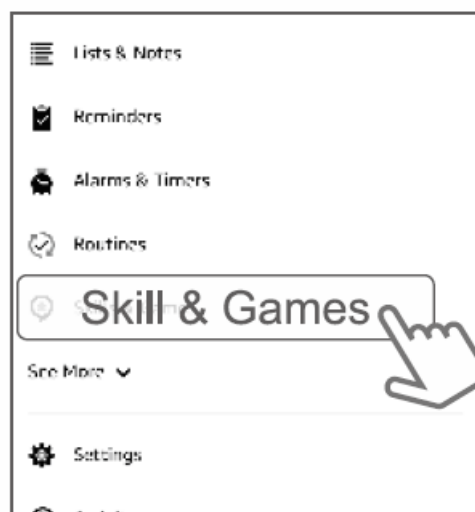

3. Press the sign and input "TTLOCK" in the search bar.

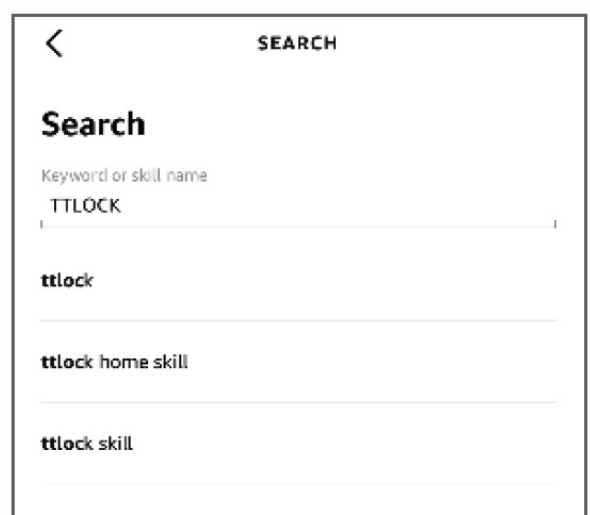
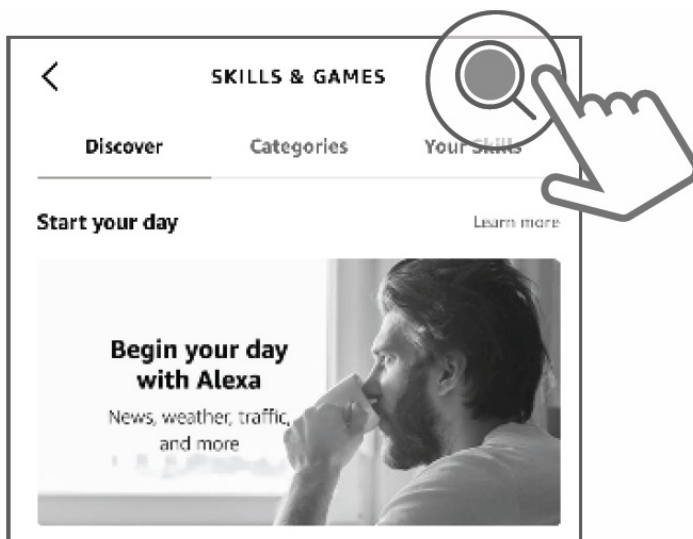

4. Click the "ENABLE TO USE". Input TTLOCK account and password to finish the authorization.

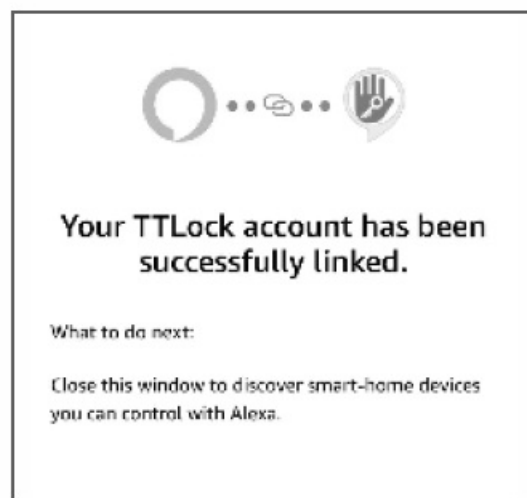
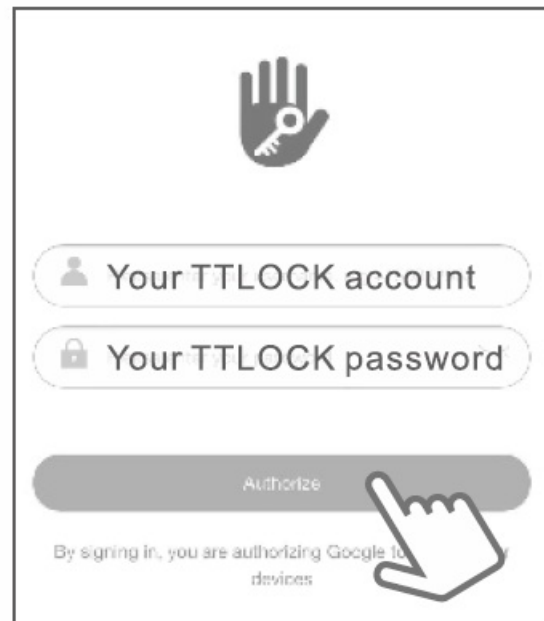

Pair Your Alexa

1. Click on the "DISCOVER DEVICES" option.
2. Click the "+" icon in the upper right corner.
3. Select the "Add Device".

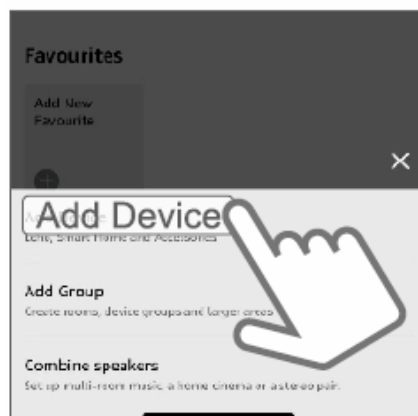
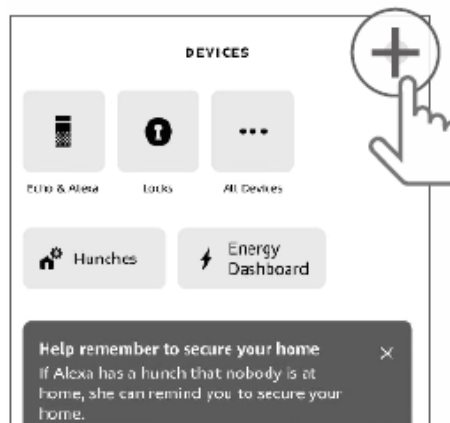

4. Select the "Amazon Echo".
5. Select the "Echo, Echo Dot, Echo Plus and more".

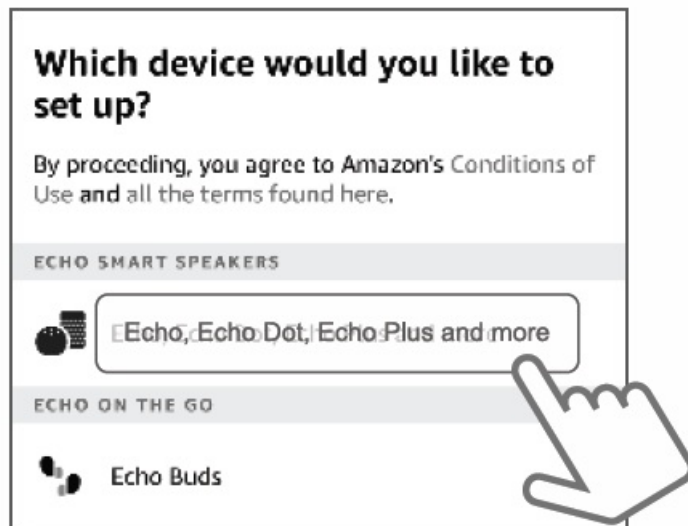
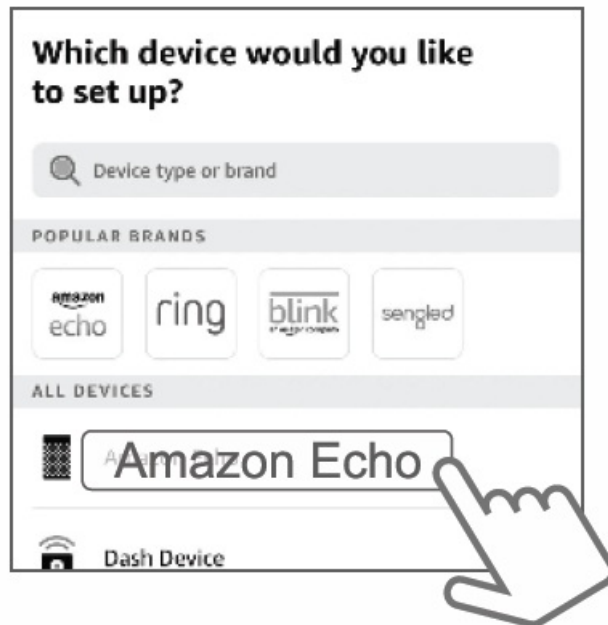

6. Press and hold the round button of Alexa until the orange light appears, select your wifi network and connect it.

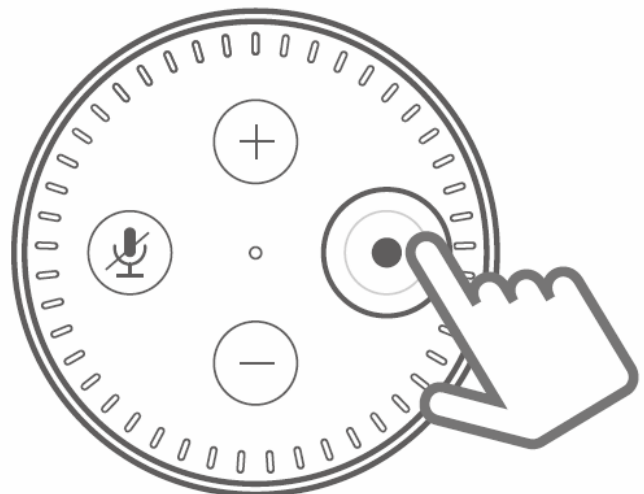



Searching for device...

Make sure your device is nearby, plugged in and in Setup mode.

Searching for Wi-Fi

Make sure device is nearby, plugged in and in Pairing mode.

Connecting to your saved Wi-Fi TP-LINK_1423

Make sure your device is nearby, plugged in and in Pairing mode.



Your Echo Dot is now connected.

7. Press locks option, and choose the lock you paired.

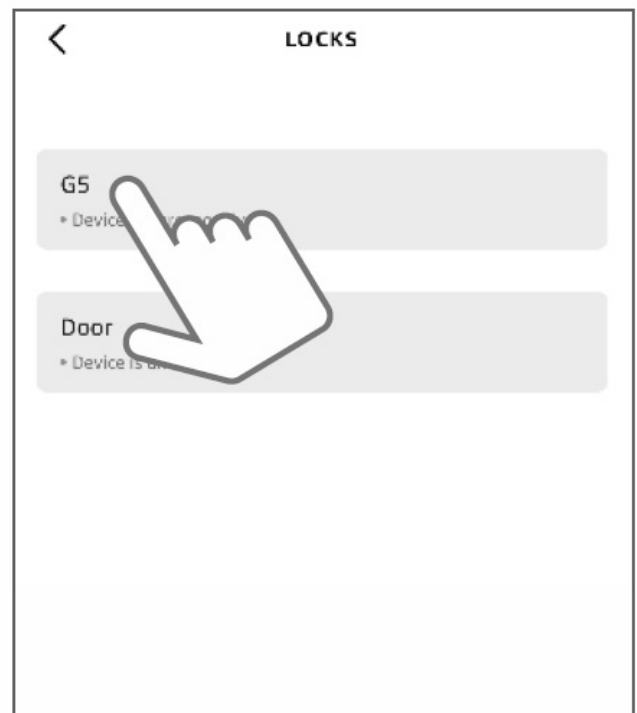
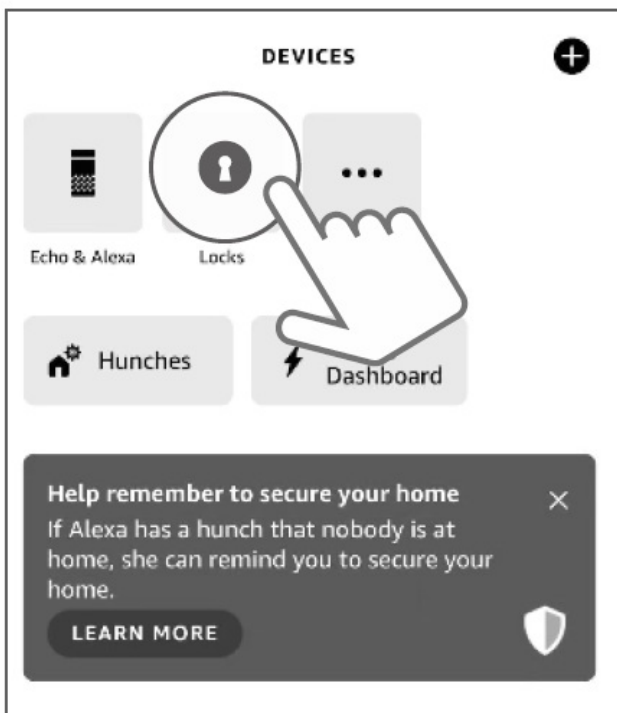

8. Open the icon in the upper right corner and slide the next icon button to keep unlock by voice.

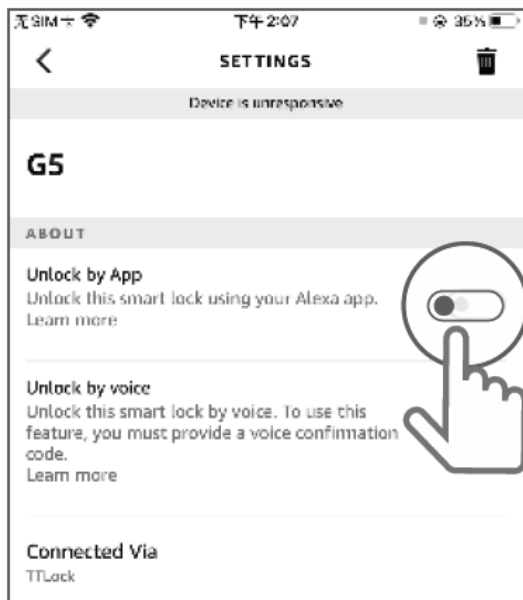

Open "Unlock by App"

9. Create your voice code.

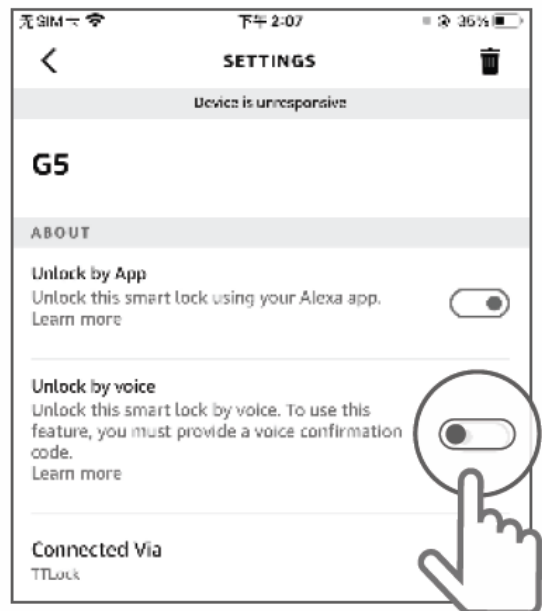

Open "Unlock by voice"

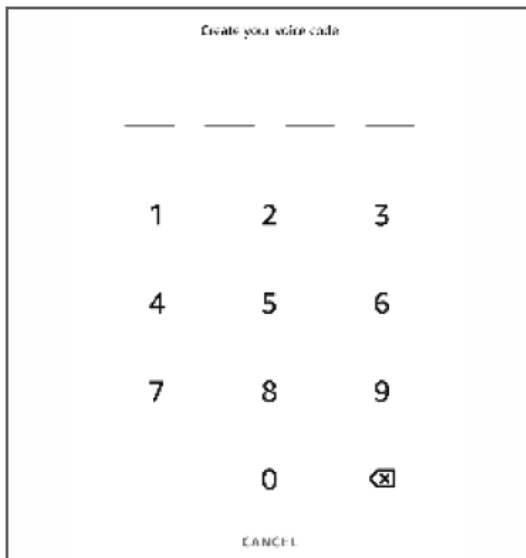

Create your voice code

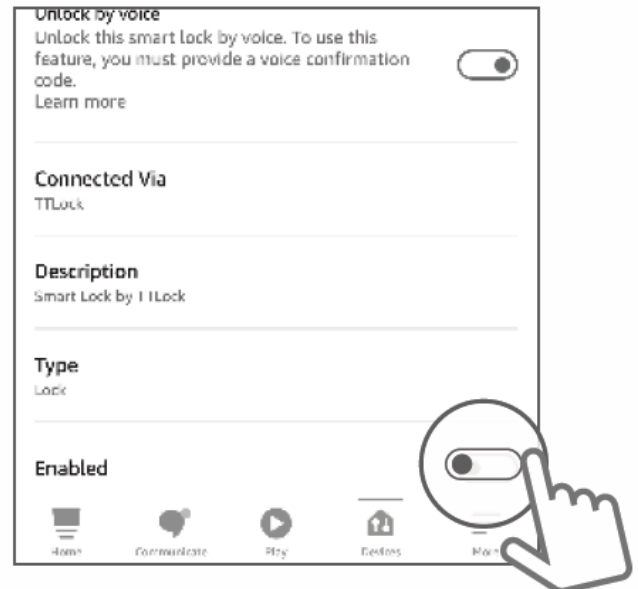

Open "Enabled"

Dear customer,

Greetings!

Thank you very much for your purchasing! We are so honored to have you as our customer, and we have great confidence to provide you with premium products and friendly service.

About GEONFINO

As an innovative and high technology corporation, GEONFINO is dedicated to R&D, designing, producing and marketing of smart lock products. Our top-guns in the smart lock field have constantly developed a series of products with features like fashion, human care, energy efficiency, and environment protection. And we highly value concepts of "People Oriented, Practical and Innovative." A professional seller in the smart lock field will always be a nice company to your life!

Warranty

GEONFINO not only provides a 1-year warranty for all our products but also offers high-level after-sales

service. Please kindly contact us immediately and we will supply a replacement or refund if you encounter any of the followings:

1. Receiving defective items;
2. Short packaging;
3. Parts are broken in transit;
4. Item stops working within warranty;
5. Wrong order.

Importance

Valuable Customers, if you like our products and service, please share your wonderful experience with us and other customers, we will be very grateful. If you're dissatisfied with what you get, before writing negative feedback, please contact us, we will try our best to solve the issue to your satisfaction. Thanks for your vote of confidence again! Wish you a very happy life!

Customer Service E-mail: geonfino@afterservice.vip

Scan here to contact us [24Hrs Online]



<https://geonfino.afterservice.vip>

Documents / Resources

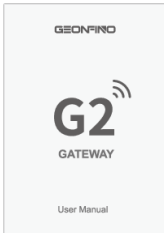
	<p>GEONFINO G2 Gateway Smart Wi-Fi Hub [pdf] User Manual</p> <p>G2 Gateway Smart Wi-Fi Hub, G2, Gateway Smart Wi-Fi Hub, Smart Wi-Fi Hub, Wi-Fi Hub, Hub</p>
---	--

References

- [User Manual](#)