



GEOMETRIC FUTURE 2501 High Performance with Controller Instruction Manual

[Home](#) » [GEOMETRIC FUTURE](#) » [GEOMETRIC FUTURE 2501 High Performance with Controller Instruction Manual](#) 

Contents

[1 GEOMETRIC FUTURE 2501 High Performance with Controller Instruction Manual](#)

- [1.1 2501B SINGLE PACK](#)
- [1.2 2501B TRIPLE PACK](#)
- [1.3 2501W SINGLE PACK](#)
- [1.4 2501W TRIPLE PACK](#)
- [1.5 Fans/ARGB Cable Connecting to the motherboard](#)
- [1.6 WARRANTY, SUPPORT](#)
 - [1.6.1 Troubleshooting](#)
 - [1.6.2 Notices](#)
 - [1.6.3 Manufacturer Name And Address](#)
 - [1.6.4 EU Recycling Information \(WEEE\)](#)
- [2 Documents / Resources](#)
 - [2.1 References](#)
- [3 Related Posts](#)

GEOMETRIC FUTURE 2501 High Performance with Controller Instruction Manual

GEOMETRIC FUTURE
SIMPLIFY YOUR FUTURE

2501 Squama

2501B, 2501W

2501B SINGLE PACK

A



×1

B



×1

C



PWM extension cable×1

D



ARGB extension cable×1

E



×4

2501B TRIPLE PACK

A



×1

B



×3

C



PWM extension cable×3

D



ARGB extension cable×3

E



×12

2501W SINGLE PACK

A



x1

B



x1

C



PWM extension cable x1

D



ARGB extension cable x1

E



x4

2501W TRIPLE PACK

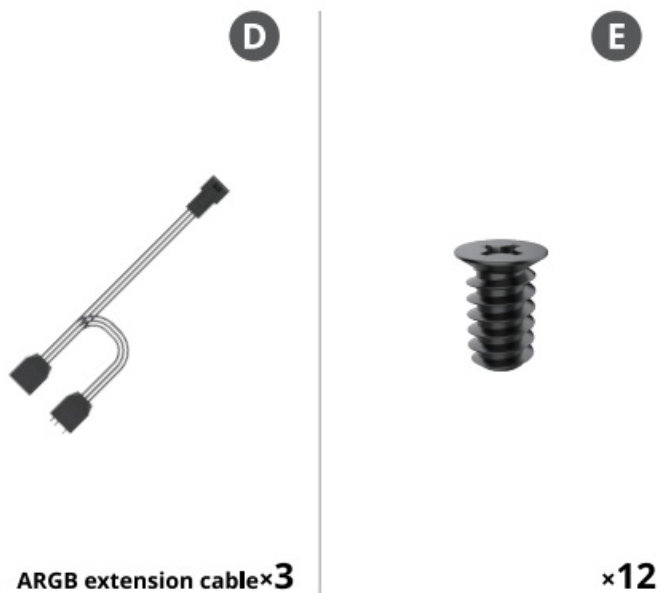
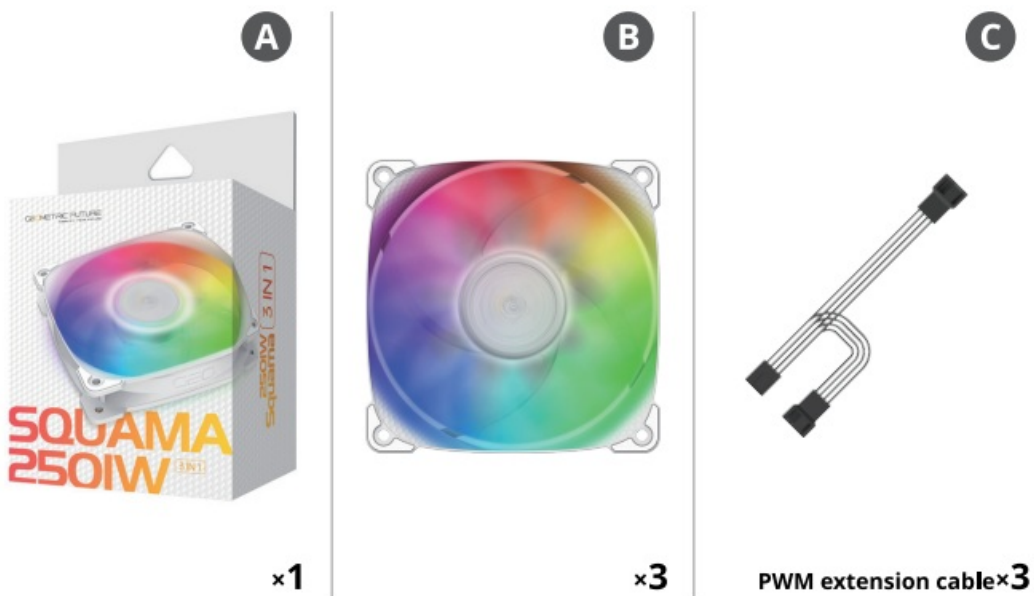

Fans/ARGB Cable Connecting to the motherboard

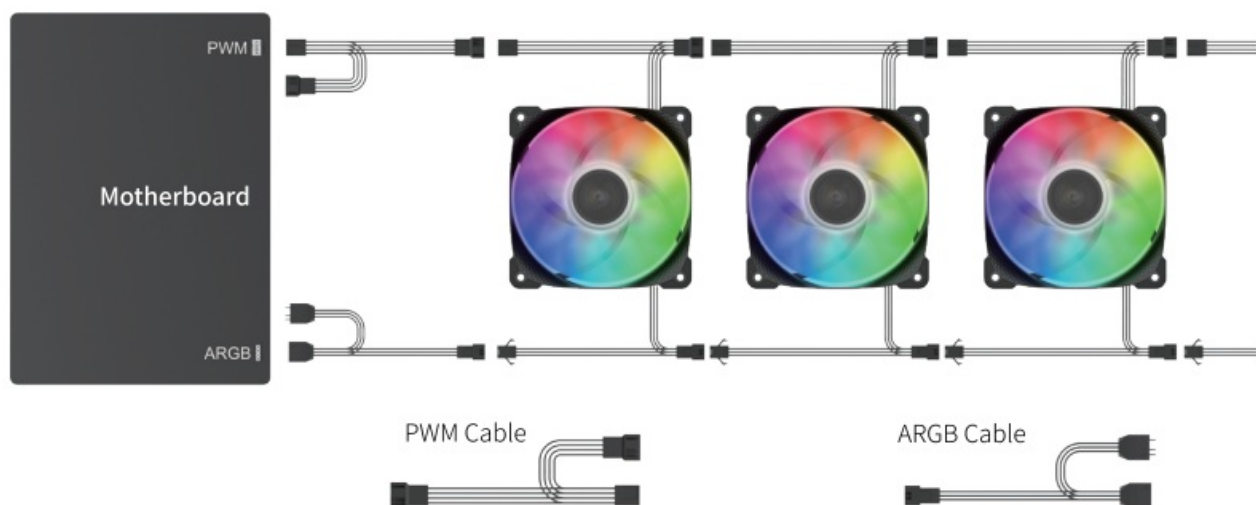

WARRANTY, SUPPORT

Troubleshooting

If your product does not operate properly, please follow the instructions below:

- 1. Please check your system's power.
- 2. Please make sure all the connectors are connected properly.

Notices

- 1. Install in accordance with the user manual's instructions and safety warnings. Incorrect installation may burnout the motherboard and other system components.
- 2. Keep this product away from areas with high temperatures such as: heat dissipation machines, air conditioners or other machines which may generate high temperatures.
- 3. Please do not put anything in the impeller.
- 4. Do not modify the cables and/or connectors included with this product.
- 5. Please do not put your hands or other objects into the fan blades when the fan is in operation.
And please make sure to keep away from children and pets.
- 6. Please only use this product in a computer case.
- 7. Please keep this product away from any liquids.
- 8. Please use only this product's exclusively supplied cables. Other cables may not be compatible and could cause serious damage to your system and power supply.

Manufacturer Name And Adress

Suzhou Geometric Future Technology Co., LTD
Room 701, Building 1, Xingdonghuan Business Building, No.1508 Donghuan Road, Suzhou Industrial Park of China

EU Recycling Information (WEEE)

in accordance with European union's directive (2012/19/EU) on the waste of electrical and electronic equipment (WEEE), this symbol on the product or on its packaging indicates that this product must not be disposed of with your other household waste, instead, it is your responsibility to dispose of your waste equipment by handing it over to a designated collection point for the recycling of waste electrical and electronic equipment. The separate collection and recycling of your waste equipment at the time of disposal will help to conserve natural resources and ensure that it is recycled in manner that protects human health and the environment. For more information about where you can drop off waste equipment for recycling, please contact your local city office, your household waste disposaservice, or the shop where you purchased the product.

Documents / Resources

	GEOMETRIC FUTURE 2501 High Performance with Controller [pdf] Instruction Manual 2501 High Performance with Controller, 2501, High Performance with Controller, Performance with Controller, Controller
---	---

References

- [User Manual](#)

[Manuals+](#), [Privacy Policy](#)

This website is an independent publication and is neither affiliated with nor endorsed by any of the trademark owners. The "Bluetooth®" word mark and logos are registered trademarks owned by Bluetooth SIG, Inc. The "Wi-Fi®" word mark and logos are registered trademarks owned by the Wi-Fi Alliance. Any use of these marks on this website does not imply any affiliation with or endorsement.