



## Genmitsu 4040-PRO Offline Controller User Manual

[Home](#) » [Genmitsu](#) » Genmitsu 4040-PRO Offline Controller User Manual 

# GENMITSU

### 4040-PRO Offline Controller User Manual

#### Contents

- 1 Package List
- 2 Optional Accessories (Not Included)
- 3 Function Introduction
- 4 Set Desired Language
- 5 Z Probe Parameters Setup
- 6 Manual Operation
- 7 Start the Project
- 8 Limit Trigger Reset
- 9 Status Bar Tips and Status Comparison Chart
- 10 Documents / Resources
  - 10.1 References

#### Package List



1 4040 Offline Controller



2 500mm Offline Controller Cable



3 SD Card



4 Card Reader

### Optional Accessories (Not Included)

Consider following optional upgrades or accessories to make your CNC experience better!

			
65/ 69mm Aluminum Spindle Mount for 4040-PRO	42mm Diameter Dust Shoe for 4040-PRO	Metal Dust Baffles	WC04A 1/4" Shank Wood Carving Router Bits
			
<a href="https://qr.shopify.com/8sb8l7Fm">https://qr.shopify.com/8sb8l7Fm</a>	<a href="https://qr.shopify.com/P_fdnRYS">https://qr.shopify.com/P_fdnRYS</a>	<a href="https://qr.shopify.com/-1tjvn5v">https://qr.shopify.com/-1tjvn5v</a>	<a href="https://qr.shopify.com/W16_x96b">https://qr.shopify.com/W16_x96b</a>

You can find them on [www.sainsmart.com](http://www.sainsmart.com).

### Function Introduction

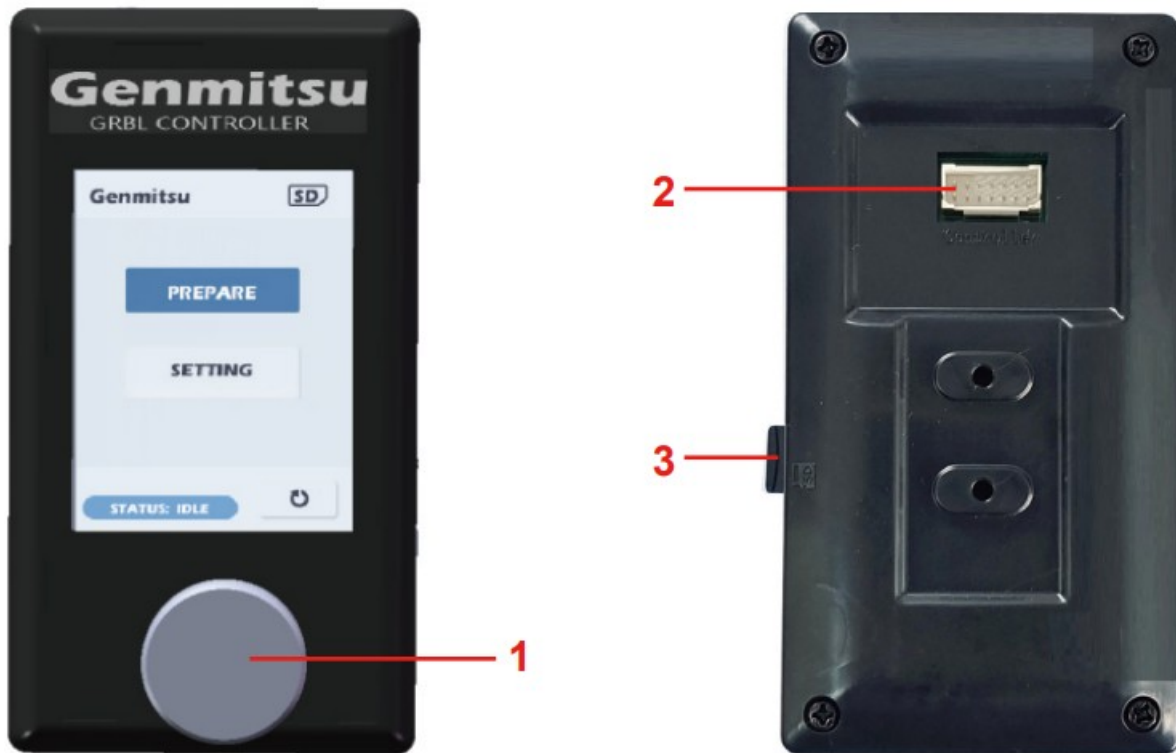

1. Dial: Turn the Dial left and right to move the cursor to select the operation targets. Press the Dial down to confirm.
2. Offline Controller Plug-in Port: Plug offline controller cable.
3. SD Card Slot: Insert SD card and read files.

Tip: This offline controller is designed for Genmitsu machines only and is not compatible with other manufacturers' control boards, consult our customer service team if you have any questions or concerns.

## Set Desired Language

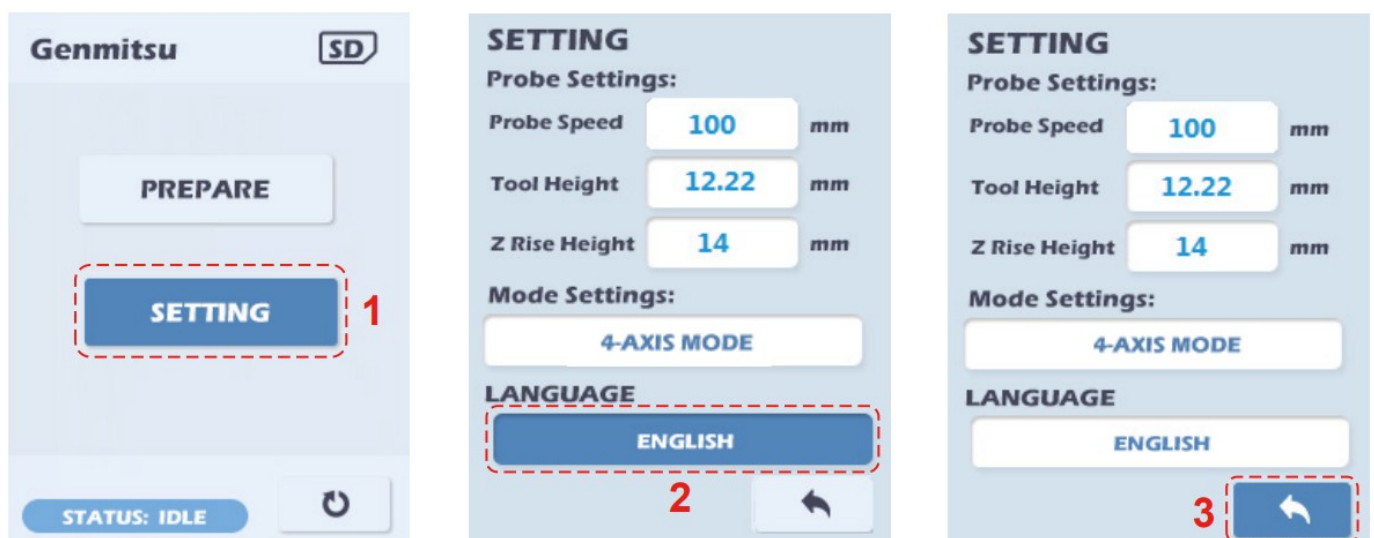

1. Turn the dial to select SETTING, press the dial to enter the SETTING interface, move the cursor to ENGLISH.
2. Press the dial to switch the desired language.
3. Rotate the dial to the Back icon, press the dial to return to the home interface, then the language has been set.

## Z Probe Parameters Setup

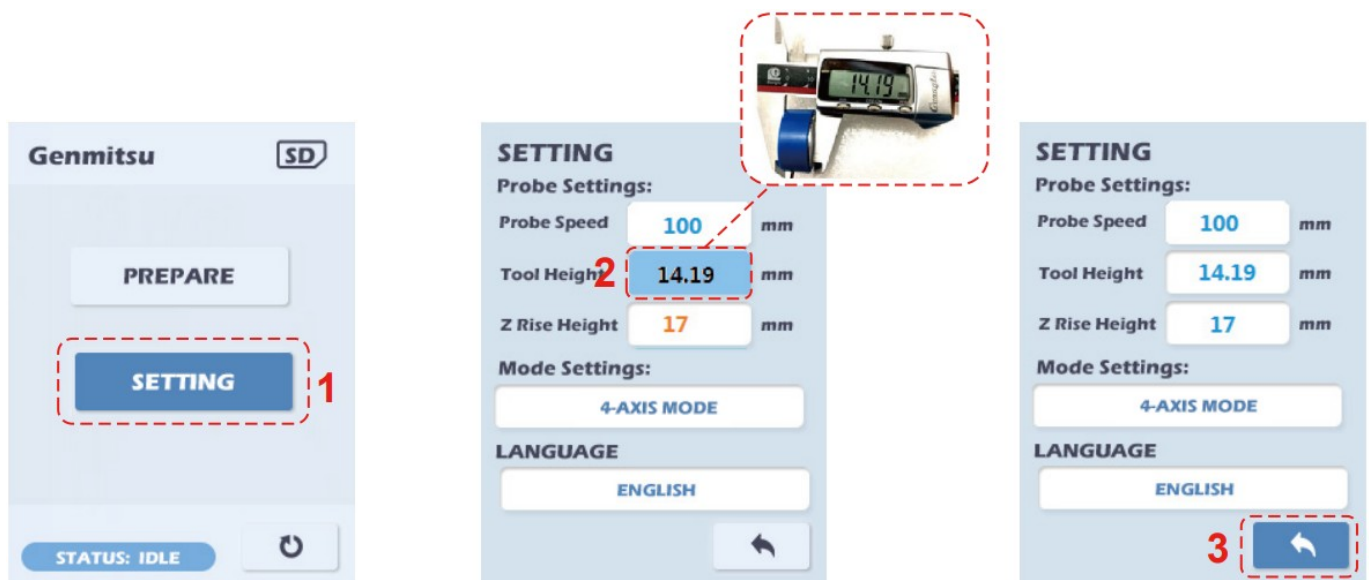

(\*Please measure and record the height of the tool setting block in advance.)

1. Select SETTING and press the dial.
2. Select Tool Height, press the dial, and turn the dial to fill the recorded height to the red mark.
3. After setting the parameters, press the dial to confirm. Then move the cursor to the Back icon to the previous screen.

## Manual Operation

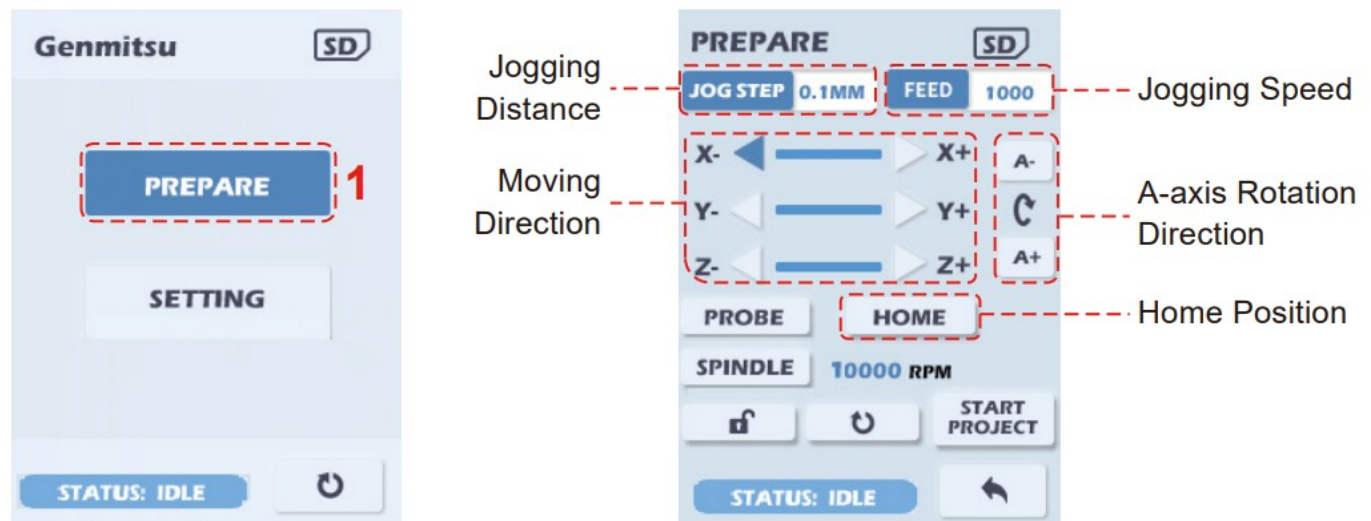

1. Move the cursor to PREPARE, press the dial to enter the home interface.
2. Select the JOG STEP, jogging distance setting bar, press the dial to change the jogging distance: setting bar 0.1MM represents each jogging distance of 0.1MM.
3. Select FEED, jogging speed setting bar, press and rotate the dial to change the jogging speed: setting bar 1000 represents the speed of 1000mm/min when moving.
4. Move the cursor to the direction arrows of X, Y and Z. Press the dial to move the corresponding axis.
5. Move the cursor to A- or A+ and press the dial to rotate the A-axis.
6. Move the cursor to HOME and press the dial to return the machine to the home position.

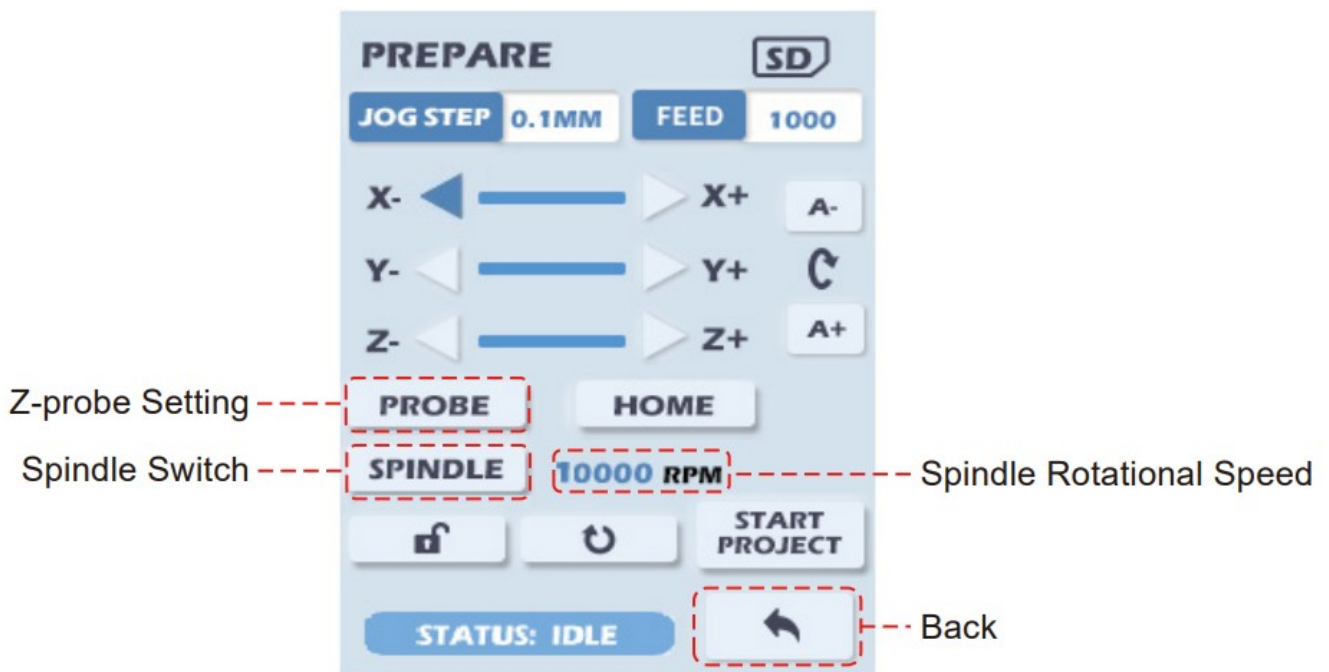

7. After connecting the tool setting block, move the cursor to PROBE and press the dial for Z-probe setting operation.
8. Move the cursor to SPINDLE and press the dial to turn the spindle on or off.
9. Move the cursor to the selection bar of RPM, press and turn the dial to adjust the spindle rotational speed, and press the dial again to exit.
10. Move the cursor to the Black icon Back icon and press the dial to return to the home interface.

## Start the Project

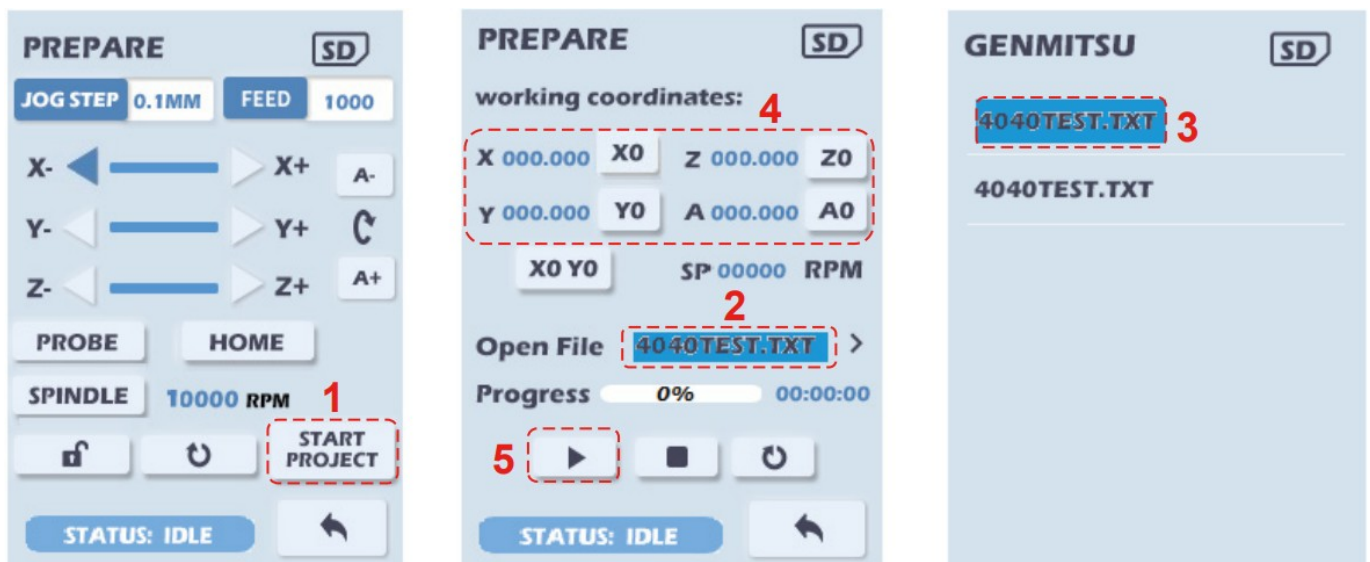

1. Move the cursor to START PROJECT and press the dial.
2. Move the cursor to the Open File selection bar and press the dial to select the project to open.
3. Move the cursor to the project you want to open and press the dial.
4. After confirming the coordinate position, move the cursor to the Start button and press the dial to start machining.

## Limit Trigger Reset



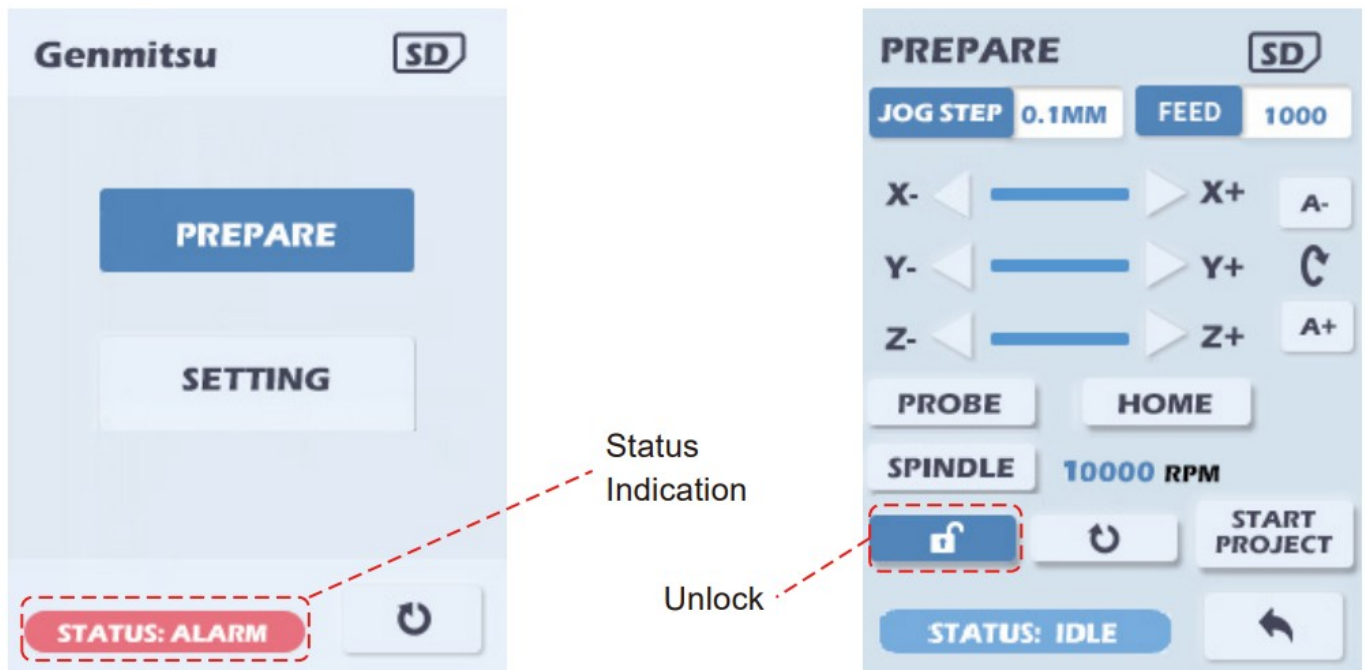

1. If the limit switch is hit during the engraving process, the offline controller will return to the power-on interface, and the status bar in the lower left corner will show the ALARM.
2. Select PREPARE with the cursor, then press the dial.
3. Move the cursor to the Unlock icon and press the dial to unlock.

### Status Bar Tips and Status Comparison Chart

Status Bar	Status Comparison
<b>STATUS: IDLE</b>	Idle Status
<b>STATUS: HOMING</b>	Homing Status
<b>STATUS: JOG</b>	Jogging Status
<b>STATUS: HOLD</b>	Holding Status
<b>STATUS: WORKING</b>	Working Status
<b>STATUS: SLEEP</b>	Sleeping Status
<b>STATUS: CHECK</b>	Checking Status
<b>Status: Alarm</b>	Alarm Status
<b>STATUS: DOOR</b>	Safety Door Status



Genmitsu  
Desktop CNC & Laser

✉ Email: [support@sainsmart.com](mailto:support@sainsmart.com)

Facebook messenger: <https://m.me/SainSmart>

Help and support is also available from our Facebook Group  
Vestment LLC, 5892 Loose Rd Ste. 132, N. Las Vegas, NV 89081



Facebook Group

<https://www.facebook.com/groups/SainSmart.GenmitsuCNC/>

## Documents / Resources

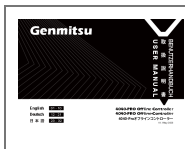

[Genmitsu 4040-PRO Offline Controller](#) [pdf] User Manual

4040-PRO Offline Controller, 4040-PRO, Offline Controller, 4040-PRO Controller, Controller

## References

- [SainSmart | Desktop CNC, 3D Printing & DIY Tools | Power to the Makers – SainSmart.com](#)

[Manuals+](#)