

GENESIS G70 Digital Key Touch



GENESIS G70 Digital Key Touch User Guide

[Home](#) » [Genesis](#) » GENESIS G70 Digital Key Touch User Guide 

Contents

- 1 GENESIS G70 Digital Key Touch
- 2 Product Information
- 3 Product Usage Instructions
- 4 SECTION A
- 5 DIGITAL KEY TOUCH USER GUIDE
- 6 LET'S PAIR YOUR DIGITAL KEY TO YOUR VEHICLE
- 7 HOW TO SHARE YOUR DIGITAL KEY
- 8 KEY PERMISSIONS
- 9 VERIFICATION
- 10 ACTIVATION CODE
- 11 DEACTIVATION
- 12 REMOVE DIGITAL KEY
- 13 USING THE GENESIS DIGITAL KEY.
- 14 Documents / Resources
 - 14.1 References
- 15 Related Posts



GENESIS G70 Digital Key Touch



Product Information

Specifications:

- Feature: Genesis Digital Key
- Compatibility: Genesis Intelligent Assistant app with Genesis Connected Services
- Functions: Lock, unlock, start/stop the vehicle, share digital keys remotely
- Additional: Compatible with select smartwatches

Product Usage Instructions

Activating and Creating Owner Digital Key:

1. Bring your smartphone and at least one key fob to the Genesis vehicle.
2. Turn on the vehicle and log into the Genesis Intelligent Assistant app.
3. Select the vehicle you want to activate if you have more than one registered.
4. Click on Digital Key from the menu and review how it works.
5. Set up the Digital Key and validate device compatibility.
6. Follow on-screen instructions to pair your smartphone with the vehicle.
7. Place your smartphone on the wireless charging pad and continue setup.

Pairing Digital Key to Your Vehicle:

1. In the vehicle's infotainment system, navigate to Digital Key section.
2. Select [Setup] > [Vehicle] > [Digital Key] > [Smartphone Key] > [My Smartphone Key].
3. Tap [Save] to pair your Digital Key with the vehicle.

Frequently Asked Questions (FAQ)

- **Q: Do I need a key fob in the car to use the Digital Key feature?**
A: Yes, at least one key fob must be present in the vehicle when activating the Digital Key.
- **Q: Can I share my Digital Key with family and friends?**
A: Yes, you can share digital keys remotely with family and friends while controlling their access level.

- **Q: Is the Digital Key compatible with smartwatches?**

A: The Digital Key is compatible with select smartwatches for added convenience.

DIGITAL KEY TOUCH USER GUIDE

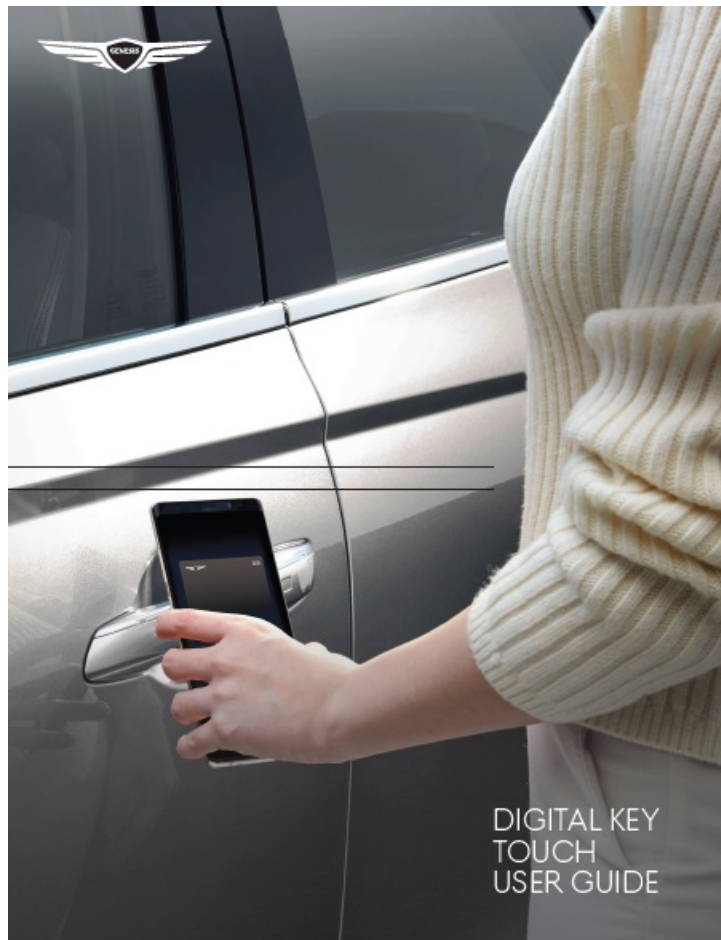

SECTION A

- IF YOU MISPLACED YOUR PASSCODE FOR REGISTRATION OR DID NOT REGISTER DIGITAL KEY VIA THE DISTRIBUTOR.
- After logging in to genesiscconnect.ca, the screen will prompt you to select which vehicle you would like to activate.
- After you press Digital Key, a prompt on the screen will ask you to register your Digital Key. Click “register” and you will receive a “Digital Key – welcome” email.

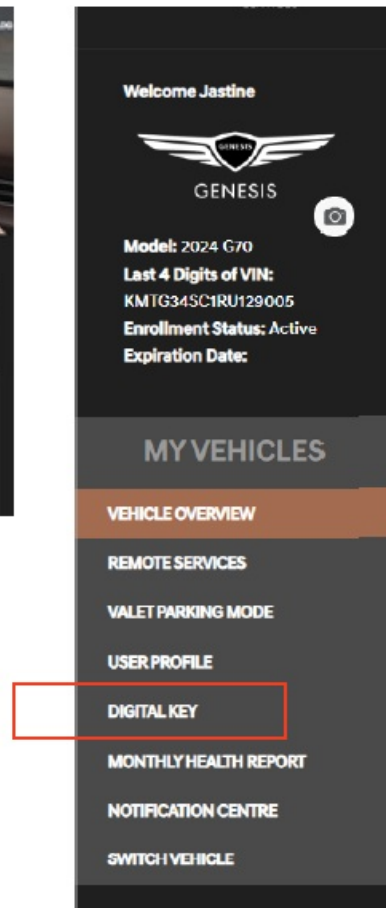
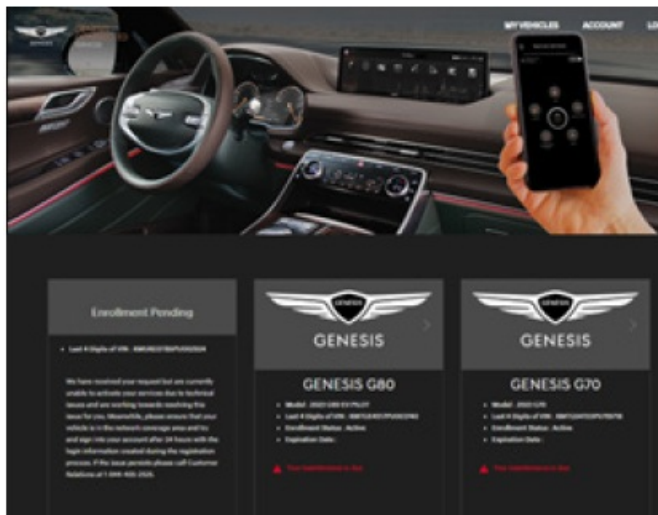

DIGITAL KEY TOUCH USER GUIDE

GENESIS DIGITAL KEY

- Genesis Digital Key is a convenience feature available on Genesis Intelligent Assistant app with Genesis Connected Services that allows you to use your mobile device as a key. The
- Digital Key can be used to lock, unlock, start/stop the vehicle and share digital keys remotely with family and friends while still controlling the level of access.
- The Digital Key is also compatible with select smartwatches.
- **IMPORTANT:** When activating Genesis Digital Key to the vehicle, at least one key fob must be in the car to properly pair with your smart device.

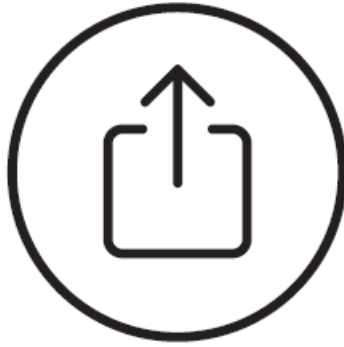

SMARTPHONE:

- ACTIVATE AND CREATE OWNER DIGITAL KEY IN GENESIS INTELLIGENT ASSISTANT APP
- Take your smartphone and at least one of your key fobs to your Genesis and turn the vehicle on.
- After logging into the Genesis Intelligent Assistant app*, the screen will prompt you to select which vehicle you want to activate. It will only prompt you to choose a vehicle if you have more than one vehicle registered.
- * **Remember:** if you did not enroll via a dealer, see steps in Section A.

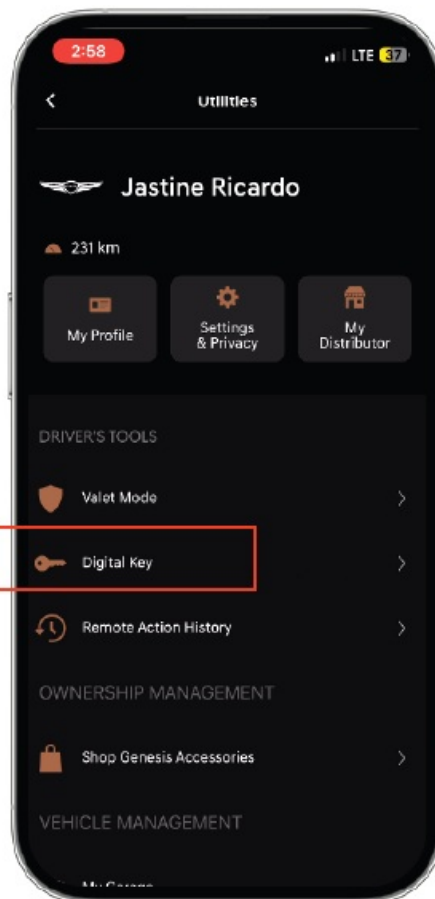
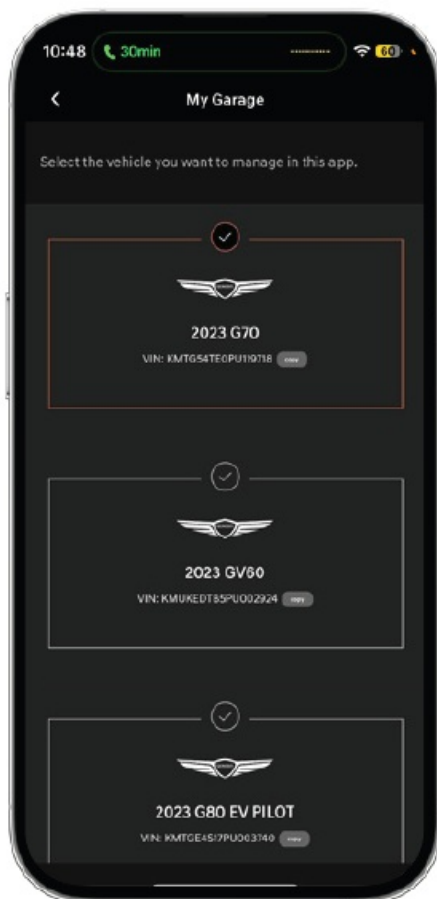

- Once you select the Digital Key equipped vehicle, you will be able to see “Digital Key” on the menu.
- Click the Digital Key from the menu — you will see an overview on how the Digital Key works.

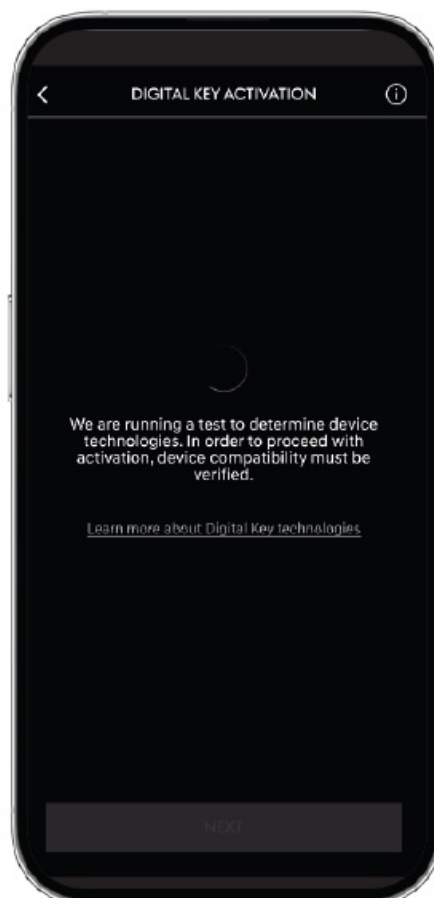

- Once you have reviewed — click on set up Digital Key — a confirmation screen will appear showing you that the system is validating the compatibility of your device.
- Once the validation is complete a screen will show you if your device is compatible or not.

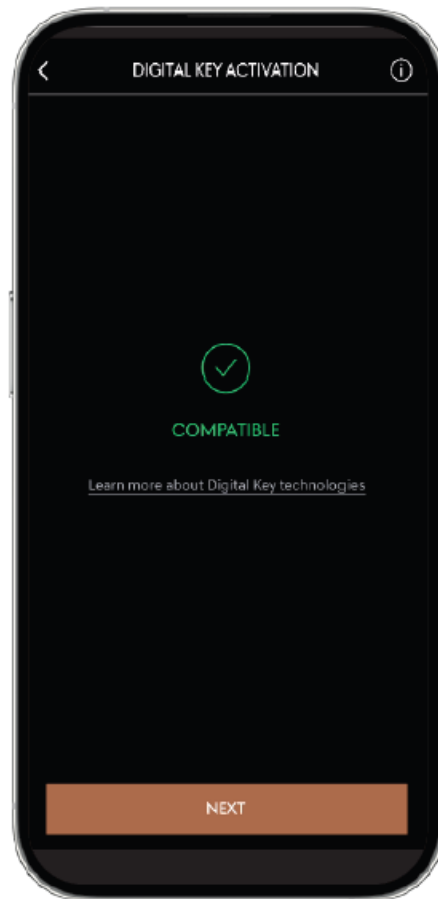

< Activate and Create Owner Digital Key continued

- A Digital Key activation screen will appear — read through the copy and take a screenshot of the set-up steps so you don't forget. A guideline on how to pair the smartphone to the vehicle will be displayed.
- **Check the box that says:**
 - I have screenshot or written down the above sequence of commands.
 - Place your smartphone on the wireless charging pad.

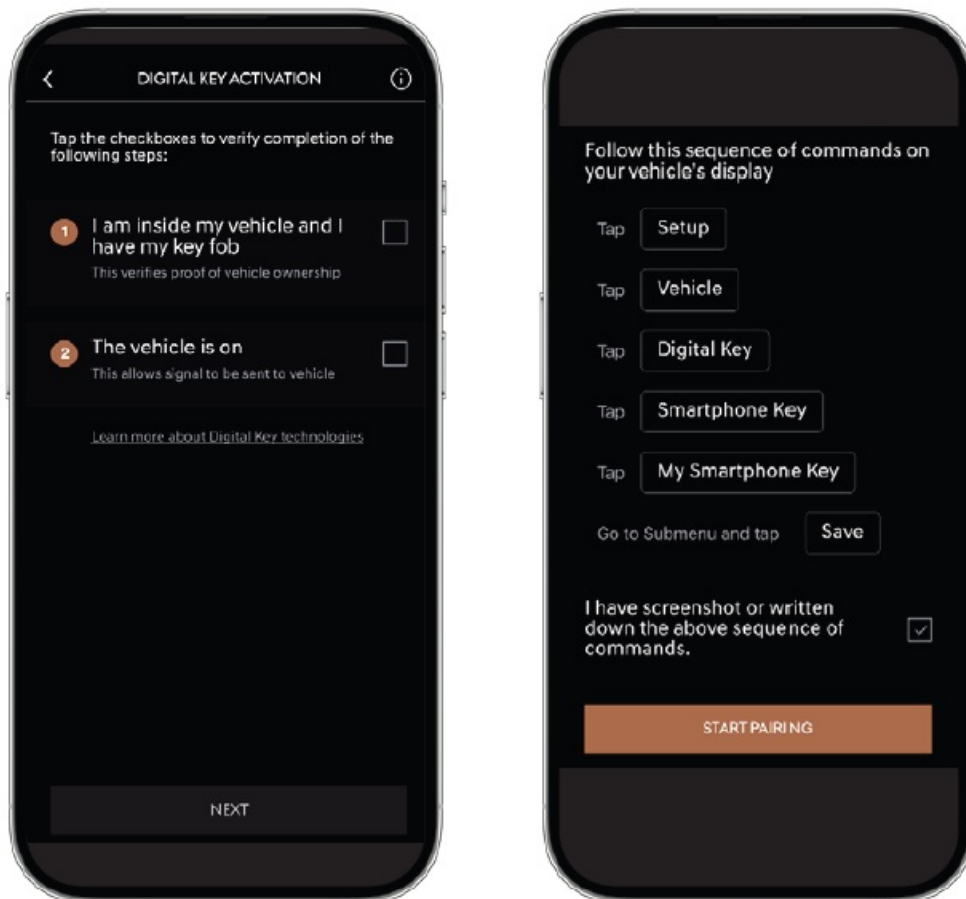

- Once your smartphone is on the wireless charging pad, a set-up screen will appear — press “Continue.” Be sure to leave your smartphone on the wireless charging pad*.



LET'S PAIR YOUR DIGITAL KEY TO YOUR VEHICLE

On the vehicle's infotainment system, navigate to the Digital Key section from the Main Home Screen by selecting

[Setup] > [Vehicle] > [Digital Key] > [Smartphone Key]> [My Smartphone Key]. Tap [Save].



1. Press Setup (located on menu bar)
2. Press Vehicle (located on screen)
3. Press Digital Key (located on screen)

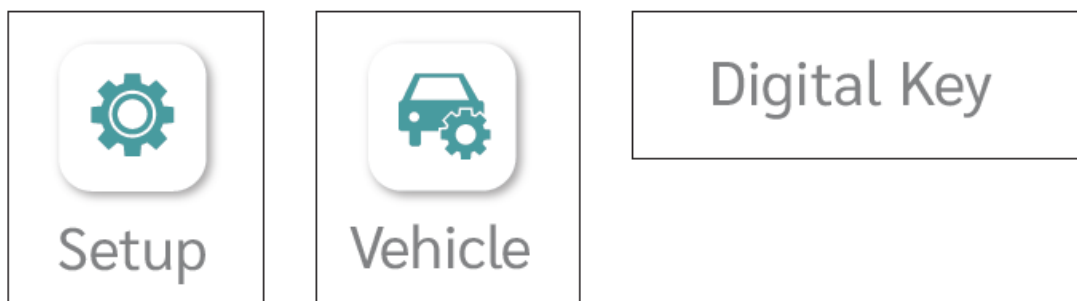

Three options will appear next.

1. Smartphone Key
2. Card Key
3. Digital Key Information

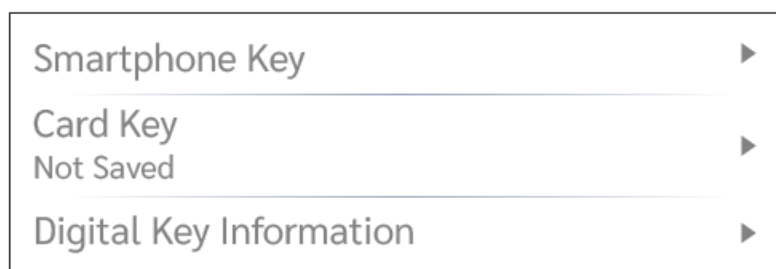

- Click “Smartphone Key” to register your device to your vehicle.

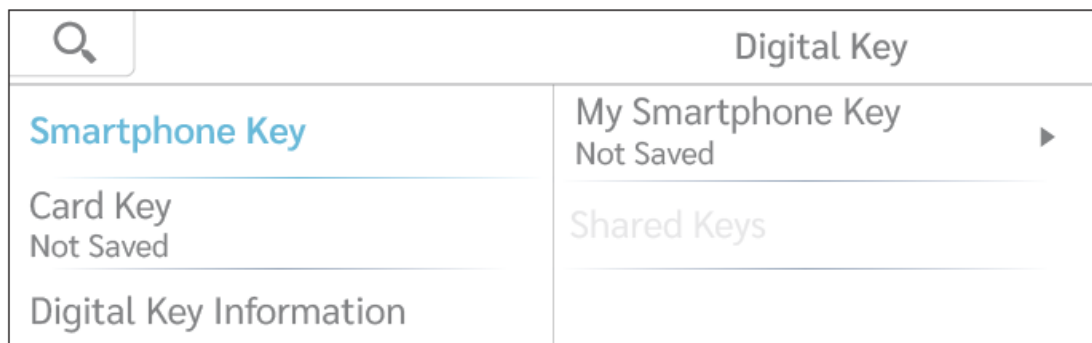

- *You can also view your shared keys here and add or delete shared keys.
- Make sure your smartphone is always on the wireless charging pad during registration.
- Once the smartphone is on the wireless charging pad, press “Save” on the screen.

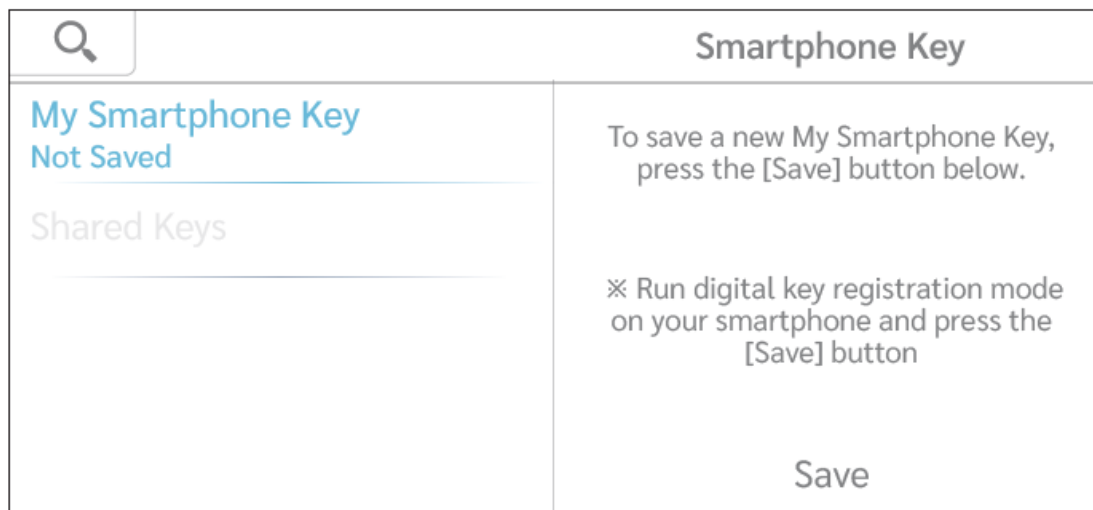

- A confirmation will appear on the screen indicating that the smartphone key has been saved.
- The smartphone key button will say “saved” once the pairing is successful.
- *Buttons may vary by model. Note: at this point, you may link your Digital Key to a Driver Profile on the vehicle’s infotainment system if you wish. The Setup button may be located in a different place depending on the vehicle you have.

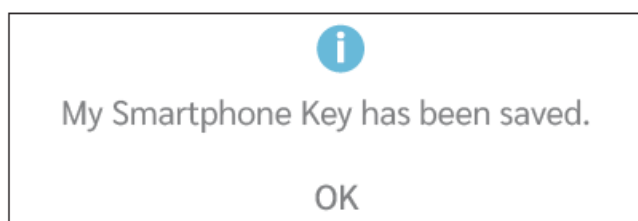

HOW TO SHARE YOUR DIGITAL KEY

- Sometimes you just need to share your vehicle with a friend or family. It is easy with the Genesis Digital Key.
- The key is accessible on your smartphone in the wallet section (screen may vary per device).

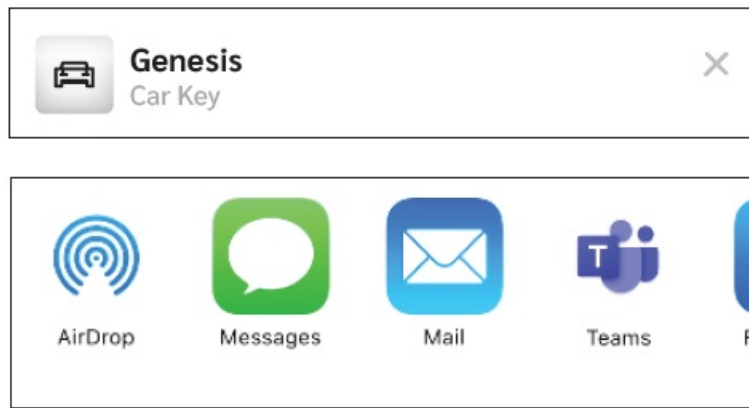

1. Select the share icon — it is a box with an arrow pointing up.
2. A pop-up will appear on your smartphone with methods to share your key. Select how you would like to share the Digital Key.
3. Choose any of the available methods — a pre-populated message will appear.
4. Add in the name of the person you want to share with— if you have their name in your address book it will pull from there.
5. And you click “Send.”

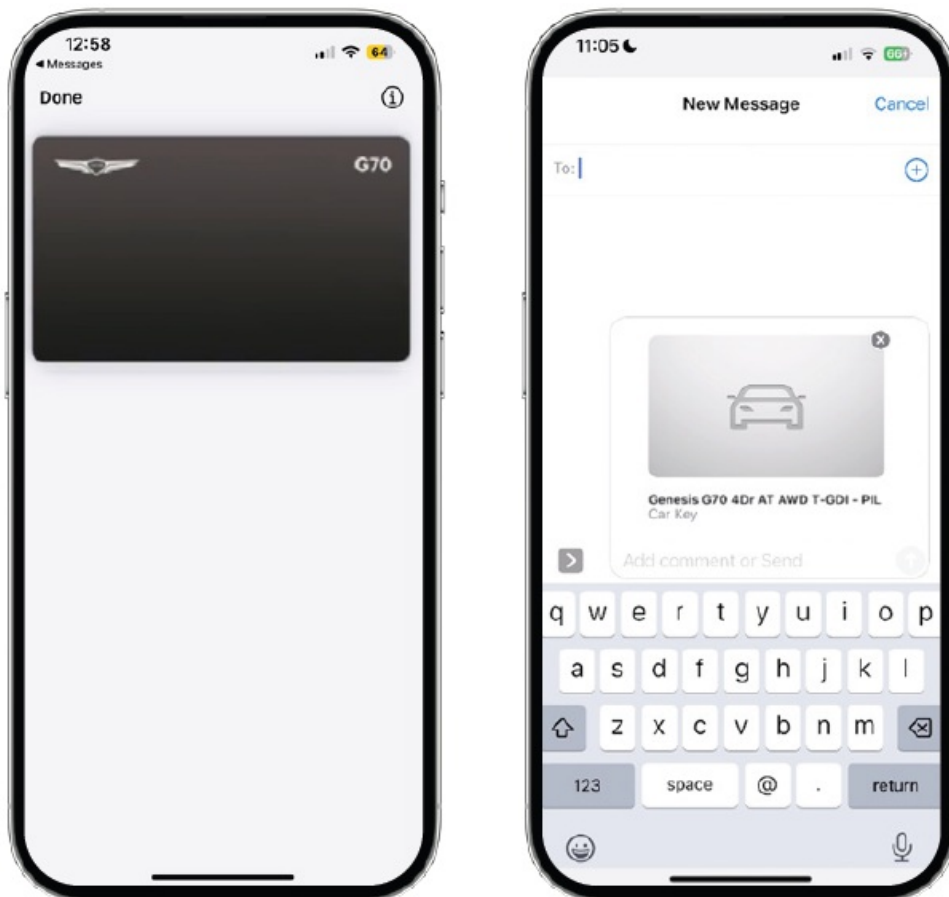

*Friends and family must have a WiFi/cellular connection in order to accept and use the Digital Key.

KEY PERMISSIONS

You are almost done sharing your Digital Key. Now, you can choose how the Digital Key is used. From unlocking the doors to having full access, the key holder can start and drive your vehicle.

1. Click on the Access Level section and check the key use.
2. Once levels are chosen the screen will automatically go back to the main screen.

Once you are happy with the Key Permissions — hit “Continue” in the top right.

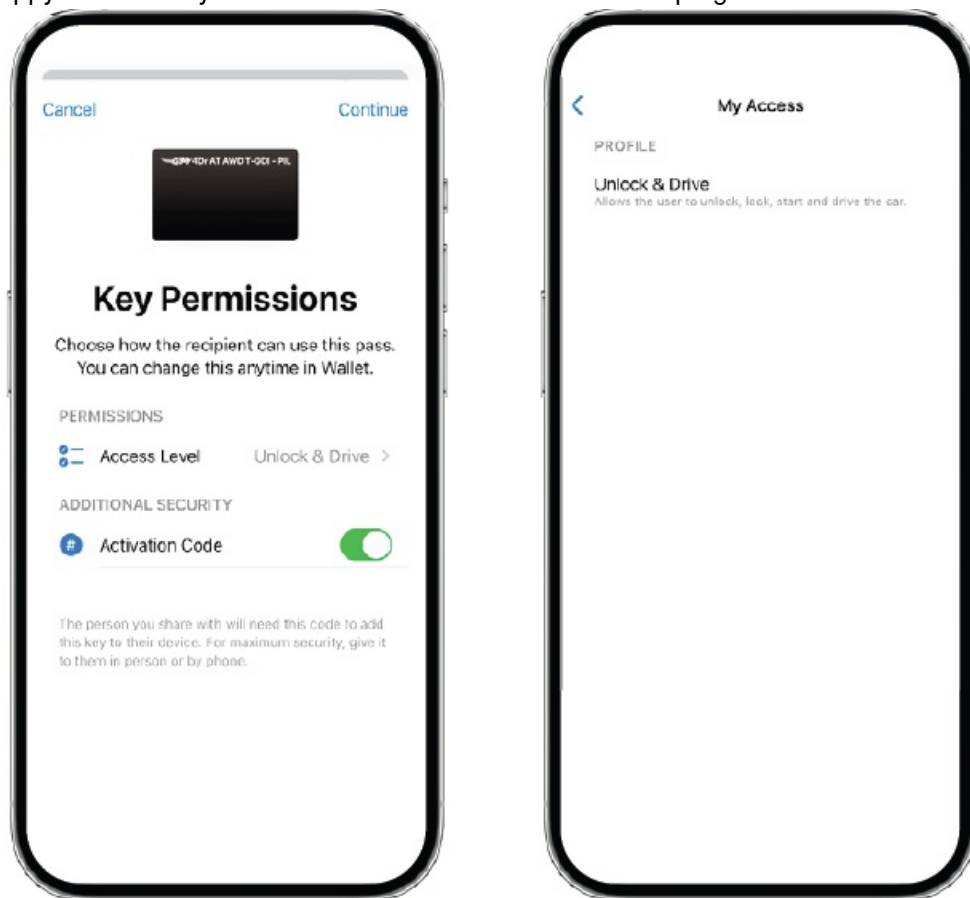

*Key Permissions will also show on the screen once a share method is selected.

VERIFICATION

- You are almost there — now the Digital Key wants to make sure you are the owner and sharing your vehicle key. Go through all steps you would if you were downloading an app — with a double click or biometric — depending on how your smartphone is set up.
- Here, you can see who the recipient of the key is and what their permissions are.
- Confirmation will appear.

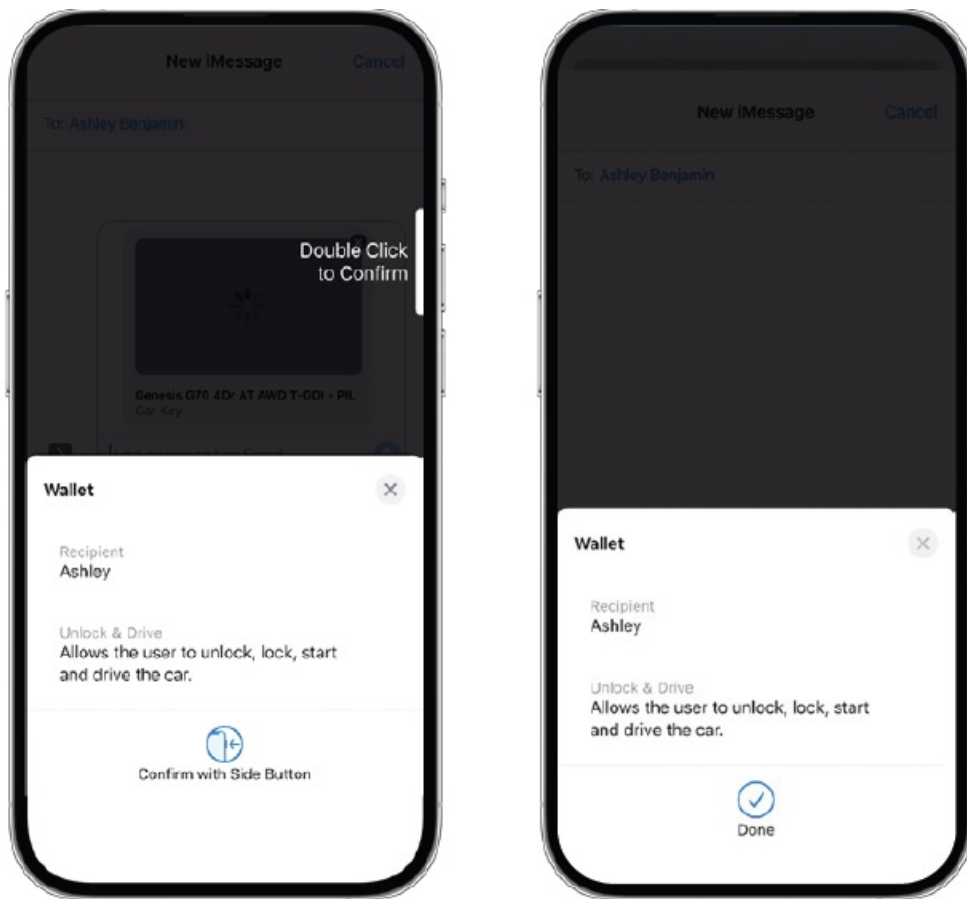

*This information can also be accessed through Genesis Intelligent Assistant app and will be redirected to your wallet.

ACTIVATION CODE

- You can also choose to share your Digital Key with an activation code — this allows you to share the key at the time you want. Just toggle on the button.
- If you choose an activation code, it will redirect you to your wallet screen and ask how you would like to share

the code.

- This is the screen if you are sending an activation code. You can copy or use the share button.

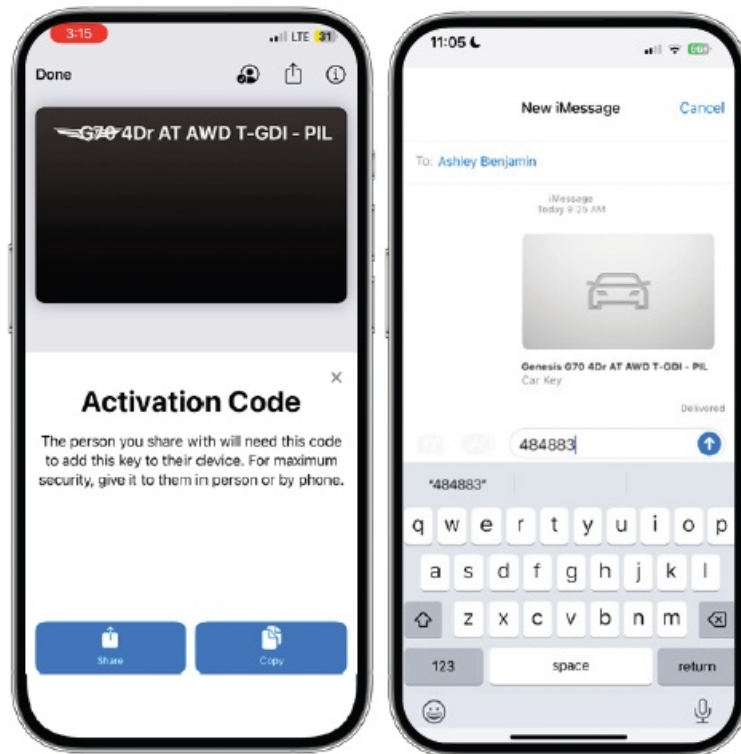

- The circle icon with the check mark and silhouette indicates that your key is being shared. Click on the icon to see who has your key and their access level.
- On this screen you can also add more people or stop sharing.

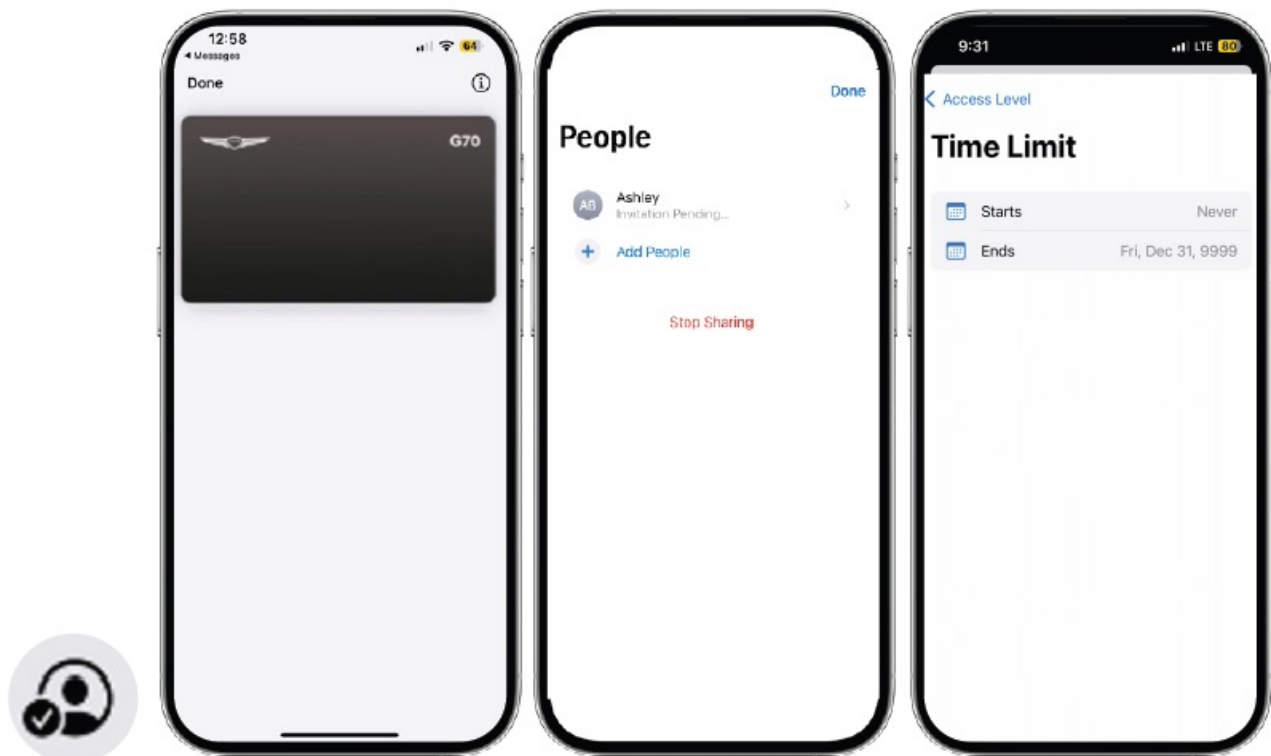

- This information can also be accessed through the Genesis Intelligent Assistant app and will will redirect you to your wallet.

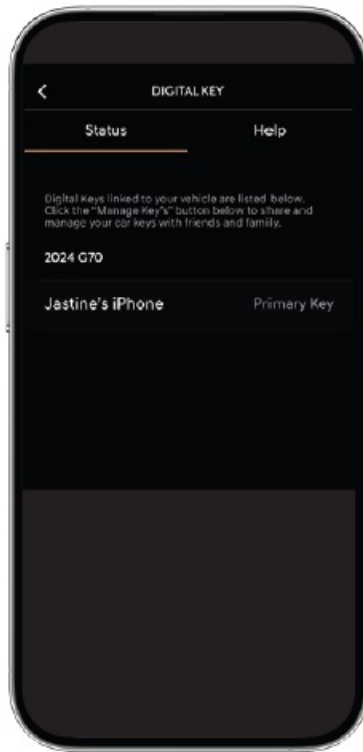

DEACTIVATION

If you don't want to share your Digital Key anymore it is easy.

1. To deactivate, go back to your wallet and click on the people icon.
2. Click on the contact you wish to deactivate or "Everyone."
3. Click "Stop Sharing" — you will see the words revoking access by the person's name.

On your contact's wallet they will be notified that they have been removed from the vehicle and the Digital Key will no longer be available.

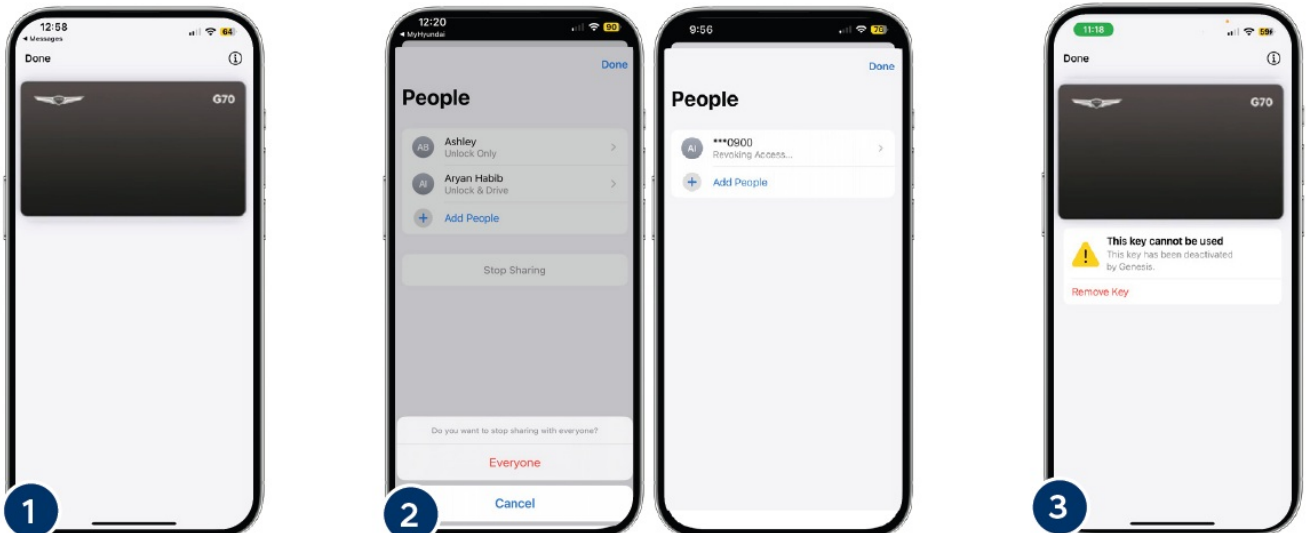

REMOVE DIGITAL KEY

You bought a new Genesis or a new smartphone and no longer want the Digital Key to be active.

1. Go to your wallet and select the "i" button in the top right corner.

2. Scroll down to the bottom of the page and select “Remove Car Key.”
3. Confirm that you want to remove your Digital Key. Once completed, the key will be deleted from your wallet.
4. Don't forget you have to deactivate from your vehicle as well.

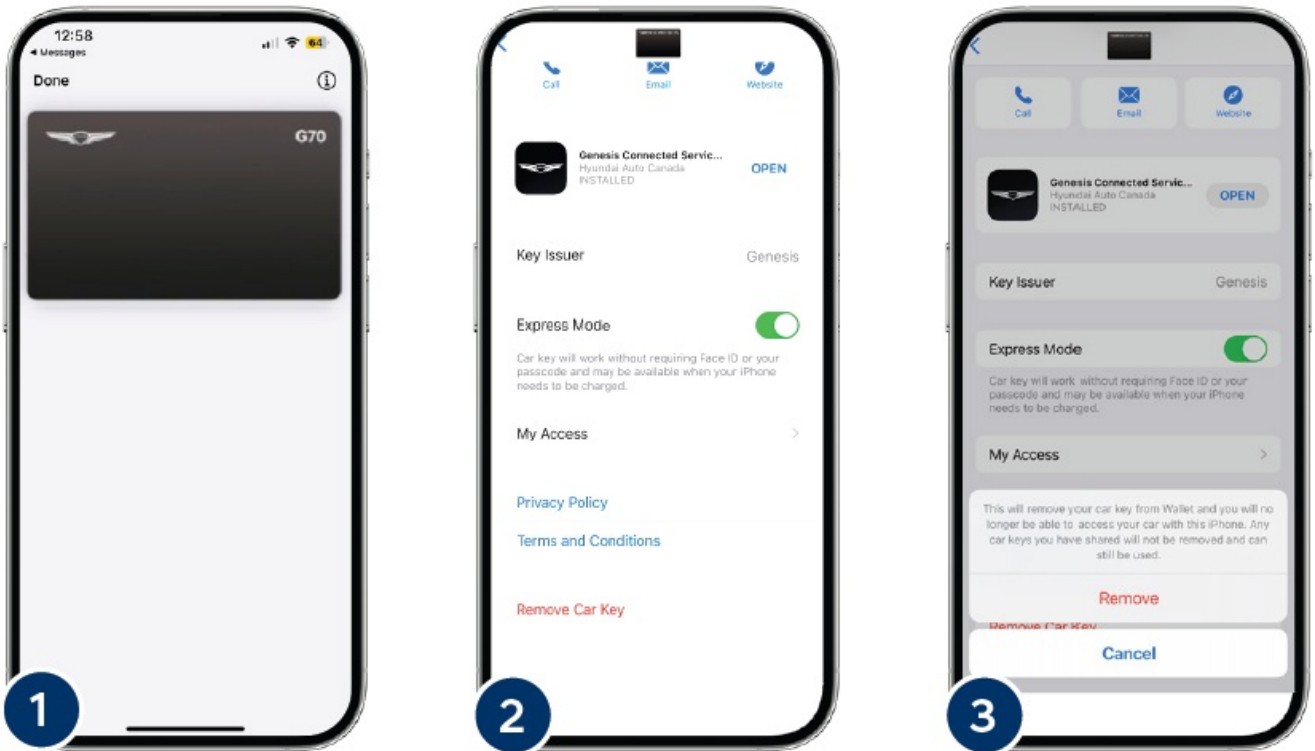

< How to remove Digital Key continued

To deactivate from your vehicle, complete the following steps from the digital touch-screen:

1. Press “Setup”
2. Press “Vehicles”
3. Press “Digital Key”
4. Press “My Smartphone Key”
5. Press “Delete”

- A screen will ask to confirm your request.
- Once you press “Yes,” a confirmation will appear on the screen that the smartphone key has been deleted.
- You will receive an email confirmation that the Digital Key has been deactivated.

Smartphone Key

TIIN

To delete My Smartphone Key, press the [Delete] button shown.

Shared keys will not be deleted.

Delete

?

Delete My Smartphone Key?

Yes No

i

My Smartphone Key has been deleted.

OK

USING THE GENESIS DIGITAL KEY.

- Unlock/Lock by hovering the back of your phone near the driver's door handle.
- Start the vehicle by placing your smartphone on the wireless charging pad. Then press the brakes while pressing the engine start button.
- Once the engine starts, you do not need to keep your smartphone on the wireless charging pad.



- Under Digital Key support, it will show the FAQ on Digital Key and how to contact Genesis Connected Service support. To return to the screen, select the back arrow.
- **Note:** Once you have completed the Digital Key activation, you may use the Digital Key to lock, unlock and drive the vehicle. To activate, tap the smartphone or smartwatch to the door or place the phone on the NFC Pad to start the vehicle.

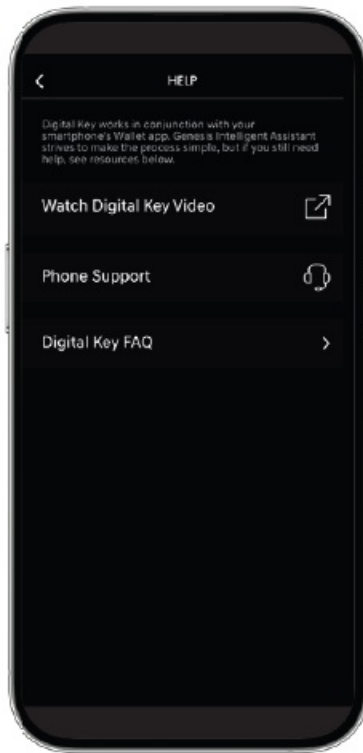

Genesis Motors Canada [Genesis.ca](https://www.genesis.ca)



The Genesis names, logos, product names, feature names, images and slogans are trademarks owned or licensed by Genesis Motors Canada, a division of Hyundai Auto Canada Corp. All other trademarks and trade names are those of their respective owners.

Documents / Resources



[GENESIS G70 Digital Key Touch](#) [pdf] User Guide
G70 Digital Key Touch, G70, Digital Key Touch, Key Touch, Touch

References

- [Genesis Motors Canada | Luxury Sedans & SUVs](https://www.genesis.ca)
- [User Manual](#)

Manuals+. Privacy Policy

This website is an independent publication and is neither affiliated with nor endorsed by any of the trademark owners. The "Bluetooth®" word mark and logos are registered trademarks owned by Bluetooth SIG, Inc. The "Wi-Fi®" word mark and logos are registered trademarks owned by the Wi-Fi Alliance. Any use of these marks on this website does not imply any affiliation with or endorsement.