

Generic
EV02
Aone GPS
Wired
GPS
Tracker



Generic EV02 Aone GPS Wired GPS Tracker User Manual

[Home](#) » [Generic](#) » Generic EV02 Aone GPS Wired GPS Tracker User Manual 

Contents

- 1 Generic EV02 Aone GPS Wired GPS Tracker
- 2 Appearance
- 3 Product Features
- 4 Wire connection
- 5 Installation
- 6 Precautions
- 7 Working Description
- 8 Troubleshooting
- 9 Access to Platform
- 10 Documents / Resources
 - 10.1 References
- 11 Related Posts

Generic

Generic EV02 Aone GPS Wired GPS Tracker



Appearance

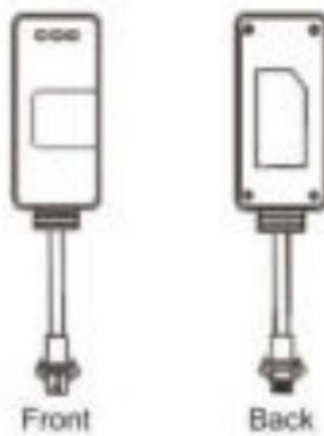

Product Features



Wire connection

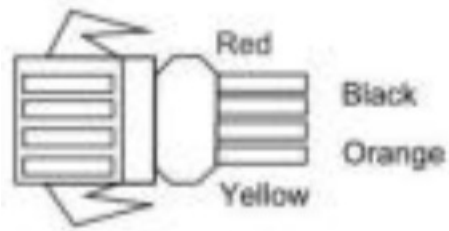

Terminal Description

Status	Meaning
Red	Positive(9-90v)
Black	Negative
Orange	Acc line
Yellow	Relay

Red LED light (Power Supply Status)

Status	Meaning
Slow Blink	Normal(Internal battery supply)
Long Bright	Normal(Internal battery supply)
Off	Broken or Sleeping

Yellow LED light (GSM Status)

Status	Meaning
Quick Blink	Searching GSM Signal
Slow Blink	Normal Working
Off	GSM Searching Failed or Sleeping

Blue LED light (GPS Status)

Status	Meaning
Quick Blink	Searching GPS Signal
Slow Blink	Normal Working
Off	GPS Searching Failed or Sleeping

Installation

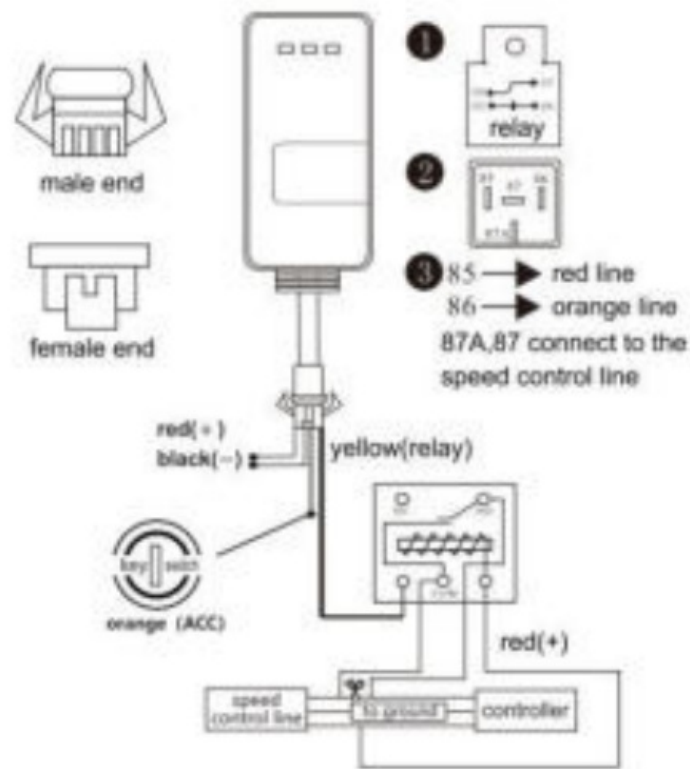

1. Red line connect battery positive pole(+) black line connect battery negative pole(-)
2. The orange line connects the ACC line.
3. Wiring for Cut-off oil function:
 1. Find the 'Speed control line'
 2. Detect the voltage of the 'Speed control line' by a millimeter.
 3. Cut the 'Speed control line' into two lines
 4. Connect "Speed control lines" with the relay's two green lines

Note:

1. Please use the correct relay, normally, car suit 12V relay. truck suit for 24V relay.
2. Open the SIM card cover, insert the SIM card, and turn on the battery supply
3. SIM cards must have GPRS data and SMS service.
4. Please make sure the LED lights up and no steel matter covers the device.
5. Please fix it by cable or tape.

Installation

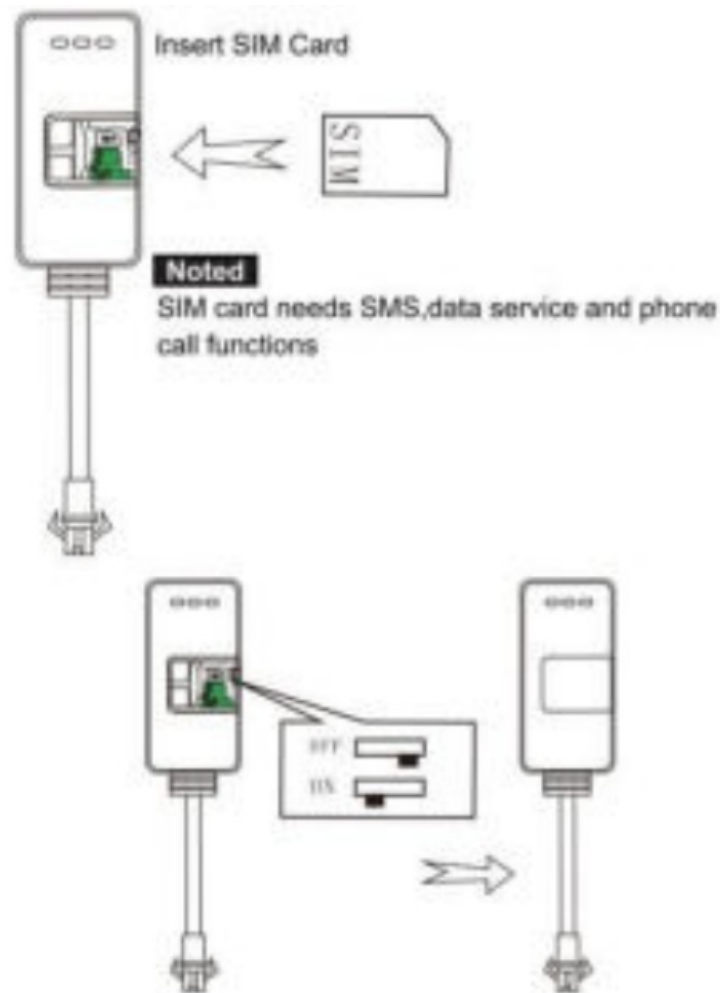

Product Installation

Please find some who are experienced in GPS tracker installation

Installation Precautions

1. The device should be Installed in somewhere waterproof and easily hidden.
2. Please turn on the device battery switch before using it.
3. Ensure the device light in the front and there is no shield before installing
4. Secure with a cable tie or sponge double-sided tape



Precautions

GPS Tracker should be installed covertly, please contact the supplier for professional installation advice.

1. Hidden installation, avoid water.
2. Ensure the LED side facing the sky and no metal cover
3. Use cable or 3m tape to fix the device.

Working Description

1. After being connected to the vehicle battery, the device will be turned on automatically and the power indicator light (red) will be long bright.
2. If the device is using its backup battery, the power indicator light (red) will slowly blink after being turned on manually.
3. GSM signal light (yellow) and GPS signal light(blue) start fast-blinking
4. A few seconds later both the GSM light and GPS light will be steady and start slowly blinking: the device enters into normal working status.

Troubleshooting

Problem	Description	Solution
Failed to connect the internet	SIM card not installed	Check the sim card
	Simcard not installed properly	Install again
	No GSM network	Move the device in gsm network area
	Weak GSM network	Move the device in strong GSM network area
Location failed	SIM card has no gprs functions	Contact Sim card supplier to activate the gprs function
	Always reply "Failed to get location"	Contact the supplier
No GPS location	Some poor signal areas like basement, tunnels are not able to acquire GPS signals.	Move the device to open sky areas.

Access to Platform

1. Platform (www.wanwaygps.com)
2. Android and IOS APP(Scan the QR code to Download the app)



There are two methods to log in to the platform or app.

1. Login by IMEI number(the 15 digits in the back of the device), password: the last 6 digits of IMEI number.
2. Contact the supplier to create an account for you

Please read the installation instruction manual carefully before installation and use.

Documents / Resources

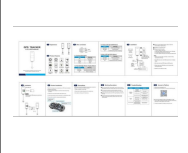
	<p>Generic EV02 Aone GPS Wired GPS Tracker [pdf] User Manual EV02 Aone GPS Wired GPS Tracker, EV02, Aone GPS Wired GPS Tracker, GPS Wired GPS Tracker, GPS Tracker, Tracker</p>
---	---

References

- [User Manual](#)

Manuals+ Privacy Policy

This website is an independent publication and is neither affiliated with nor endorsed by any of the trademark owners. The "Bluetooth®" word mark and logos are registered trademarks owned by Bluetooth SIG, Inc. The "Wi-Fi®" word mark and logos are registered trademarks owned by the Wi-Fi Alliance. Any use of these marks on this website does not imply any affiliation with or endorsement.