

Contents [[hide](#)]

- [1 GEEKOM A Series Max Mini PC](#)
- [2 Power Information](#)
- [3 Connecting to a Network](#)
- [4 M.2 SSD](#)
- [5 Safety and Caution Information](#)
- [6 FCC Caution](#)
- [7 Connect to a Network:](#)
- [8 Documents / Resources](#)
 - [8.1 References](#)

GEEKOM

GEEKOM A Series Max Mini PC

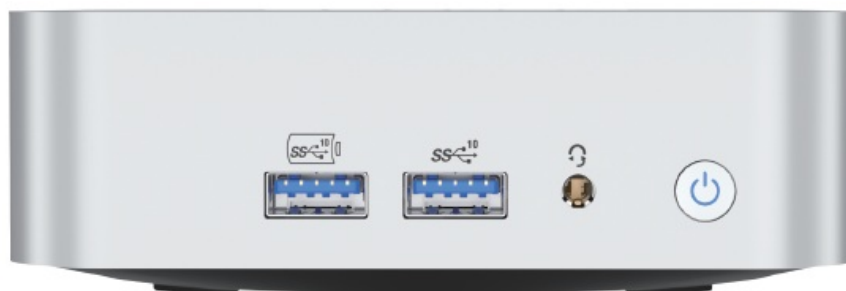

Power Information

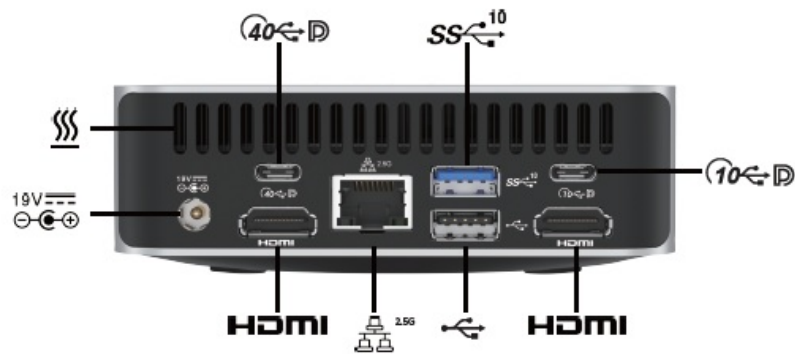
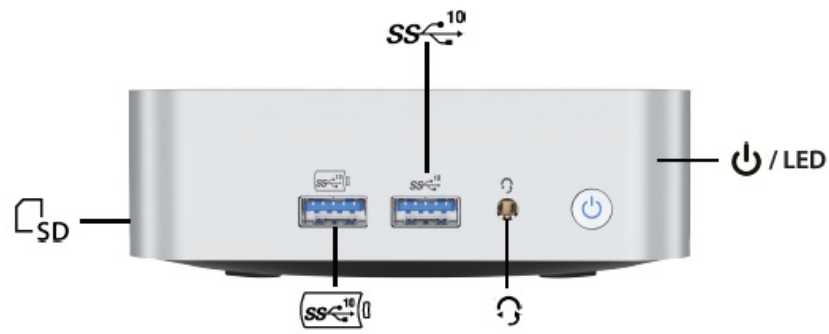

USB 3.2 Gen2 Port



Speaker/Headset



Power Button/LED



USB 4+DP Port



USB3.2 Gen2 Type C



HDMI Port



SD Reader



Ethernet Port



Electric Power Inlet



USB 2.0 Port



USB 3.2 Gen2+PD Port

Connecting to a Network

1. Click on the network icon in the Windows notification area. A list of available wireless networks will be displayed.
2. Select your desired network, enter any required information if prompted. Note: When connecting to a secured wireless network, you will need to enter the Wi-Fi password when prompted.

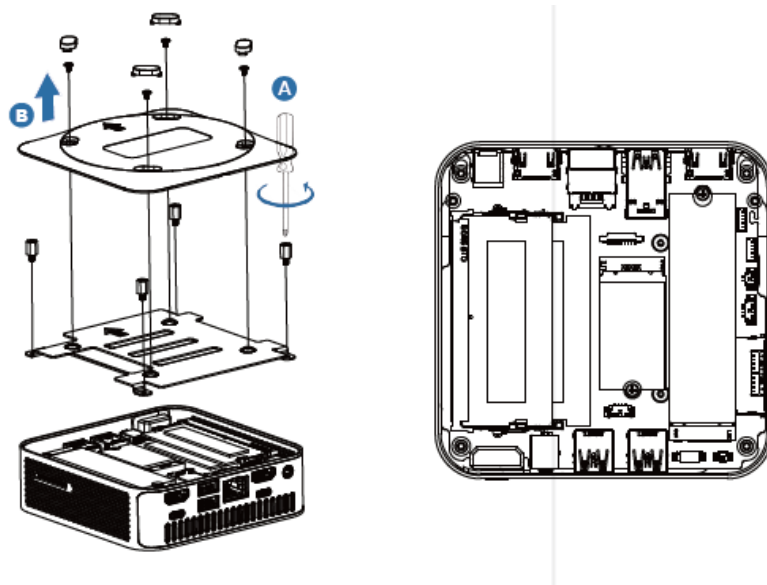

M.2 SSD

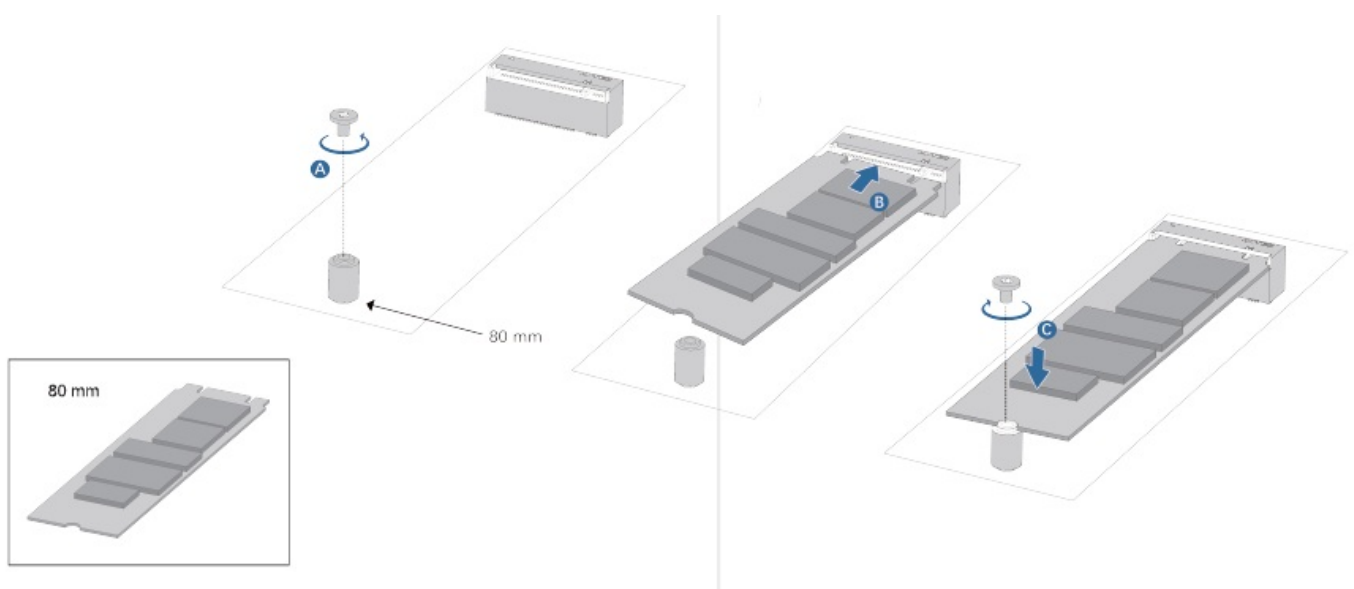

V DDR5

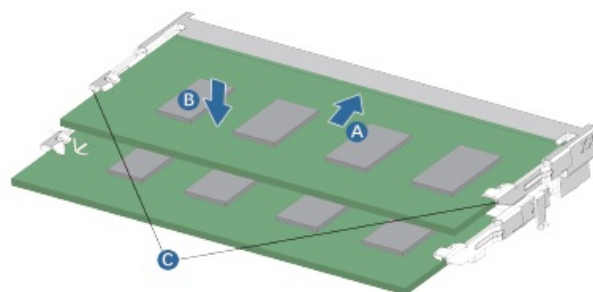

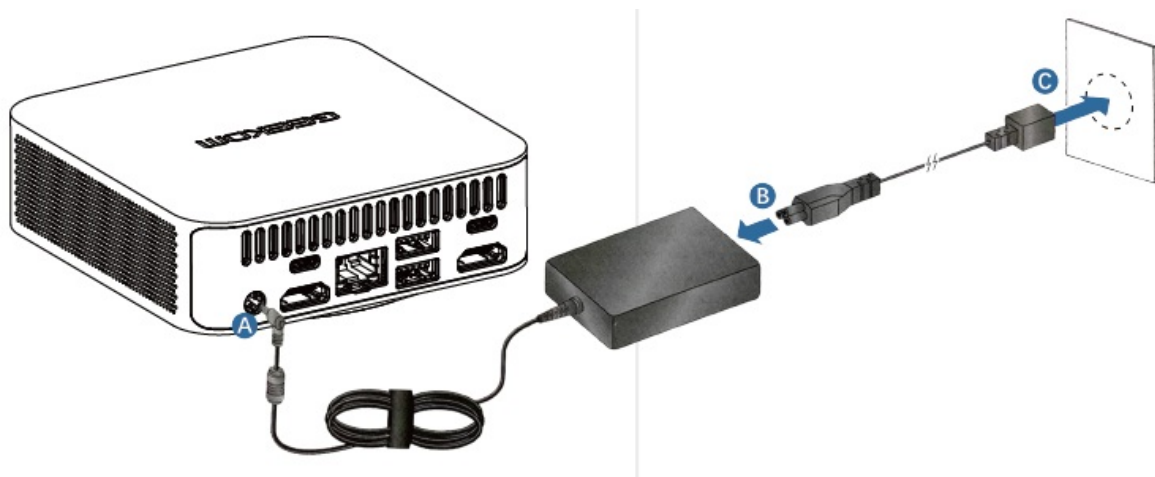

Safety and Caution Information

- AC Power Adapter: Risk of electric shock, fire, or burn if using an AC adapter other than the one provided with this device. Indoor use only and in dry locations. Device must only be repaired by a professional. Do not open enclosure. The adapter is rated for use between C and 35 oc (32 OF and 95 OF). Connect only to a properly wired and grounded outlet.
- Risk of explosion if the battery is replaced with an incorrect type. Batteries should be recycled where possible. Disposal of used batteries must be in accordance with local environmental regulations.
- Failure to use the included power adapter shall violate regulatory compliance requirements and may expose the user to safety hazards.
- Temperature: This device is intended for use in ambient temperatures between OOC and 35 oc (32 OF and 950 F). Avoid using or storing next to heat sources, in direct sunlight, or outside the intended temperature ranges.
- Medical: This device may interfere with the operation of some pacemakers, hearing aids or other medical devices. To reduce the risk, maintain a separation distance of 20 cm (8 inches) between the device and the medical device. Refer to the medical device for additional information.
- Modify: Modification of the wireless solution, thermal solution, device components or enclosure shall violate regulatory compliance requirements and may induce safety hazards.

FCC Caution

Any Changes or modifications not expressly approved by the party responsible for compliance could void the user's authority to operate the equipment.

This device complies with part 15 of the FCC Rules. Operation is subject to the following two conditions:

1. This device may not cause harmful interference, and
2. This device must accept any interference received, including interference that may cause undesired operation.

NOTE: This equipment has been tested and found to comply with the limits for a Class B digital device, pursuant to part 15 of the FCC Rules. These limits are designed to provide reasonable protection against harmful interference in a residential installation. This equipment generates, uses and can radiate radio frequency energy and, if not installed and used in accordance with the instructions, may cause harmful interference to radio communications. However, there is no guarantee that interference will not occur in a particular installation. If this equipment does cause harmful interference to radio or television reception, which can be determined by turning the equipment off and on, the user is encouraged to try to correct the interference by one or more of the following measures:

- Reorient or relocate the receiving antenna.
- Increase the separation between the equipment and receiver.
- Connect the equipment into an outlet on a circuit different from that to which the receiver is connected.
- Consult the dealer or an experienced radio/TV technician for help.

FCC Radiation Exposure Statement

This equipment complies with FCC radiation exposure limits set forth for an uncontrolled environment . This equipment should be installed and operated with minimum distance 20cm between the radiator& your body.

Connect to a Network:

1. Click the network icon in the notification area in Windows. A list of available wireless networks will be shown,

2. Select the desired network, input the information (if needed).

Note: when connecting to a secured wireless network, enter your Wi-Fi password when prompted,



Customer Support: support@geekompc.com
www.geekompc.com

Documents / Resources

	GEEKOM A Series Max Mini PC [pdf] Installation Guide A Series Max Mini PC, A Series, Max Mini PC, Mini PC
---	--

References

- [User Manual](#)

 A Series Max Mini PC, A-Series, GEEKOM, MAX Mini PC, Mini
 GEEKOM PC

Leave a comment

Your email address will not be published. Required fields are marked *

Comment *

Name

Email

Website

☐ Save my name, email, and website in this browser for the next time I comment.

Post Comment

Search:

e.g. whirlpool wrf535swhz

Search

[Manuals+](#) | [Upload](#) | [Deep Search](#) | [Privacy Policy](#) | [@manuals.plus](#) | [YouTube](#)

This website is an independent publication and is neither affiliated with nor endorsed by any of the trademark owners. The "Bluetooth®" word mark and logos are registered trademarks owned by Bluetooth SIG, Inc. The "Wi-Fi®" word mark and logos are registered trademarks owned by the Wi-Fi Alliance. Any use of these marks on this website does not imply any affiliation with or endorsement.