



[Home](#) » [GEBERIT](#) » **GEBERIT Monolith Plus Sanitary Module Instruction Manual** 

Contents [[hide](#)]

- [1 GEBERIT Monolith Plus Sanitary Module](#)
- [2 Safety](#)
- [3 Product description](#)
- [4 Technical data](#)
- [5 Odour extraction function](#)
- [6 Operation](#)
- [7 Maintenance](#)
- [8 Disposal](#)
- [9 Documents / Resources](#)
 - [9.1 References](#)



GEBERIT Monolith Plus Sanitary Module

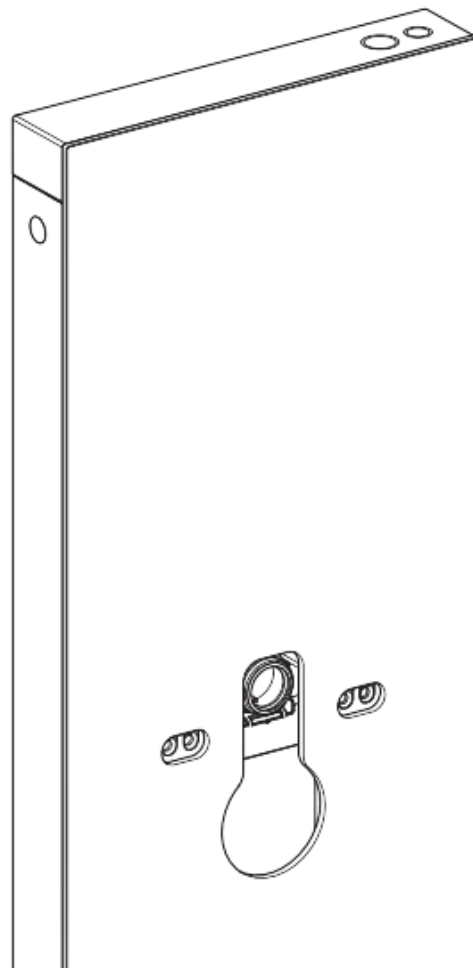

Safety

Target group

Maintenance and repair work on this product may only be performed by skilled persons. A skilled person is a person who, due to their specialist education, training and/or experience, is able to recognise risks and avoid hazards that may arise when using the product.

Intended use

The Geberit Monolith Plus sanitary module is designed to flush out WC ceramic appliances. Using it for any other purpose is deemed improper. Geberit accepts no liability for the consequences of improper use.

Safety notes

Incorrect maintenance work or repairs can result in damage or malfunctions. The following points must be taken into consideration:

- Only use original spare parts when making repairs.
- Do not modify the product or carry out additional installations.
- If the mains cable is damaged, it must be replaced by a skilled person.

Product description

Structure

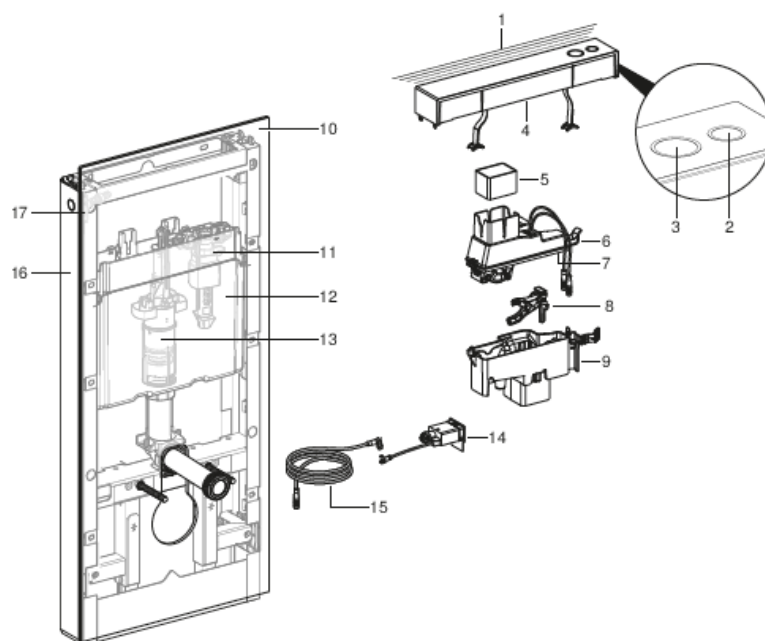

1. Orientation light
2. Small flush volume> button
3. Large flush volume> button
4. Cistern lid
5. Ceramic honeycomb filter
6. Upper part of the odour extraction unit
7. Servo lever
8. Actuator lever
9. Lower part of the odour extraction unit
10. Front panel
11. Fill valve
12. Cistern
13. Flush valve

14. Power supply unit
15. Connection cable
16. Side part
17. Angle stop valve

Technical data

Nominal voltage	100–240 V AC
Mains frequency	50–60 Hz
Operating voltage	12 V DC
Power consumption	15 W
Power consumption in standby mode	< 0.5 W
Electrical connection	Direct connection via system plug with flexible three- wire sheathed cable
Flow pressure range	0.1–10 bar 10–1,000 kPa
Flush volume, factory setting	6 and 3 l
Odour extraction unit run-on time factory setting	2 min
Wireless technology radar	Short-range radar sensor
Frequency range	5.75–5.85 GHz
Maximum output power	≤ 7 dBm EIRP
Bluetooth® wireless technology ¹⁾	Bluetooth Low Energy
Frequency range	2400–2483.5 MHz

Maximum output power	4 dBm
Energy efficiency class light source	D

1. The Bluetooth® brand and its logos are the property of Bluetooth SIG, Inc. and are used under licence by Geberit.

System description

The sanitary module is equipped with user detection, an odour extraction unit and an orientation light. Soft-touch buttons are integrated into the cistern lid and can be used to actuate a large or small flush. The integrated odour extraction unit neutralises unpleasant odours in the WC ceramic appliance.

Odour extraction function

The air is drawn into the odour extraction unit by the fan. It is guided out of the WC ceramic through the flush valve and then through the filter out of the sanitary module.

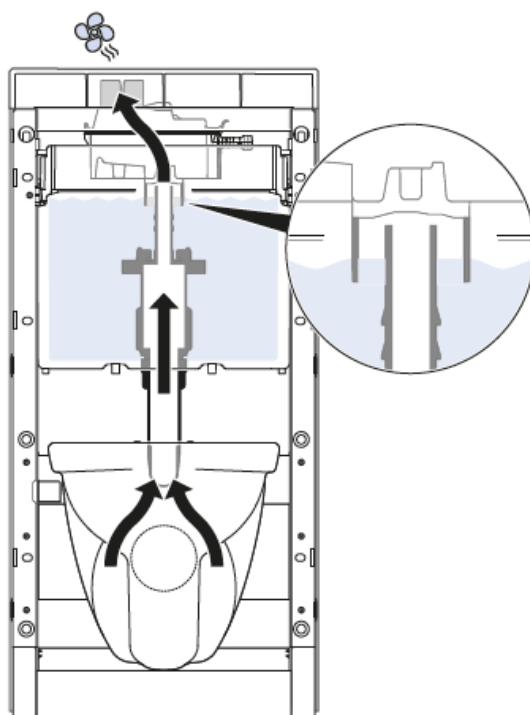

Operation

Troubleshooting

Malfunction	Cause	Remedy
No function. Display in the Geberit Home app: <ul style="list-style-type: none"> • [Malfunction: Cistern lid not connected] • [Malfunction: Power supply unit defective] • [Malfunction: Cistern lid defective] 	Plug connection between power supply unit and cistern lid is not inserted.	<ul style="list-style-type: none"> ► Restore the plug connection. ► Replace the power supply unit. ► Replace the cistern lid.
	Power supply unit is defective.	► Replace the power supply unit.
	Cistern lid (control unit) is defective.	► Replace the cistern lid.

Malfunction	Cause	Remedy
The device does not work at all or partly incorrectly.	Device failure	► Read the message in the Geberit Home app.
No flush after flushing process is actuated. Display in the Geberit Home app: <ul style="list-style-type: none"> • [Malfunction: Cistern lid defective] 	Actuator lever missing or not hooked in.	► Hook in actuator lever.
	Servo lever is positioned incorrectly.	► Position the servo lever.
	Control unit is defective.	► Replace the cistern lid.
Odour extraction unit not functioning. Display in the Geberit Home app: <ul style="list-style-type: none"> • [Malfunction: Fan not connected or blocked] • [Malfunction: Fan defective] • [Malfunction: Cistern lid defective] 	Odour extraction unit setting is at <OFF>.	<ul style="list-style-type: none"> ► Change settings in the Geberit Home app. ► Replace upper part of the odour extraction unit. ► Replace the cistern lid.
	Fan is not connected or blocked.	<ul style="list-style-type: none"> ► Restore the plug connection. ► Ensure the rotation of the fan.
	Fan is defective (flush actuation works).	► Replace upper part of the odour extraction unit.
	Control unit is defective.	► Replace the cistern lid.
Odour extraction is weak or inefficient.	Incorrect setting	► Adjust odour extraction setting in the Geberit Home app.
	Filter is not inserted.	<ul style="list-style-type: none"> ► Insert filter (see user manual or Geberit Home app). ► Replace filter (see user manual or Geberit Home app). ► Set water level via the fill valve.
	Filter is used.	► Replace filter (see user manual or Geberit Home app).
Orientation light does not light up. Display in the Geberit Home app: <ul style="list-style-type: none"> • [Malfunction: Cistern lid defective] 	Orientation light setting is at <OFF>.	► Change orientation light settings in the Geberit Home app.
	Cistern lid (control unit) is defective.	► Replace the cistern lid.
Flush volume is too low.	Full flush is set too low.	► Change flush volume setting in the Geberit Home app.
	Water level in cistern is too low.	► Set water level via the fill valve.
	Servo lever is not in the basic position.	► Re-referencing the position of the servo lever.

Maintenance

Maintenance performed by the operator

The operator may perform the following maintenance work. → See user manual.

Replace the filter

Maintenance performed by skilled persons

The maintenance work described in the following chapters may only be performed by skilled persons.

Replacing the power supply unit

Prerequisite

The spare part is on hand.

1.

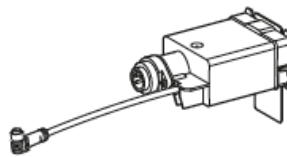

Hold the cistern lid with both hands, lift it up and fold it towards the front.

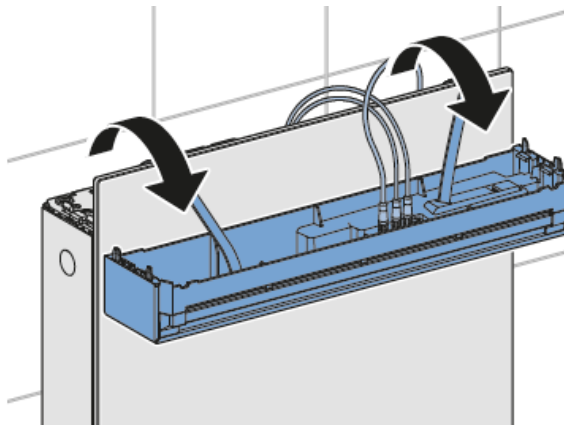

2. Demount side cladding.

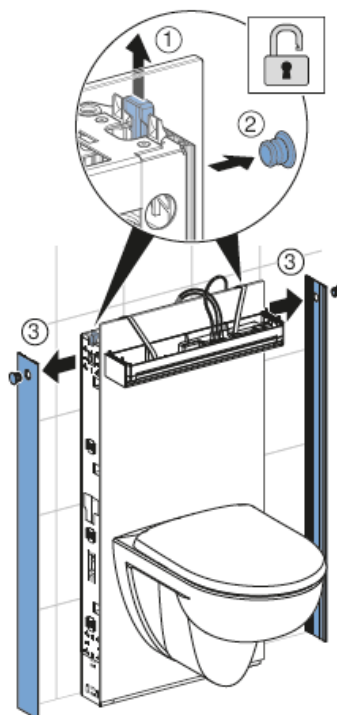

The power supply unit will either be on the right- or left-hand side, depending on the installation situation.

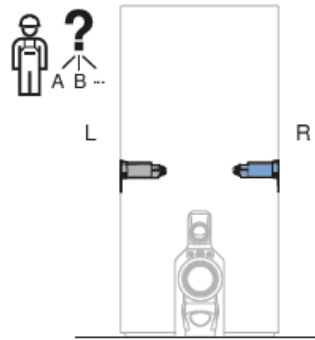

3. Demount power supply and disconnect the cable.

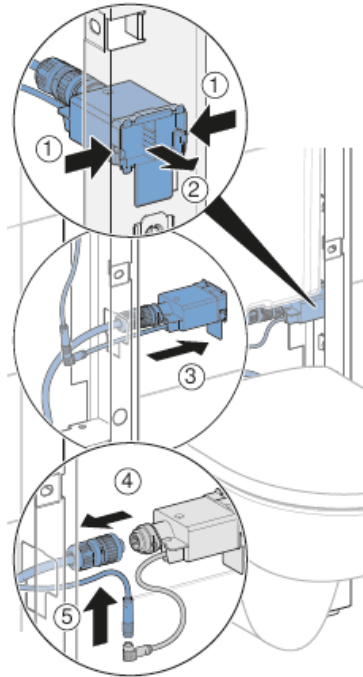

4. Unpack the new power supply unit

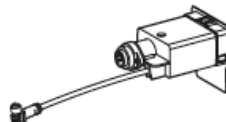
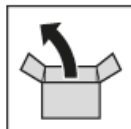

5. Replace the power supply unit.

Replacing the cistern lid

Prerequisite

The spare part is on hand.

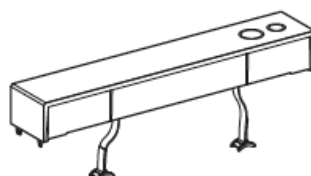

1. Hold the cistern lid with both hands, lift it up and fold it towards the front.
2. Disconnect the plug connections.

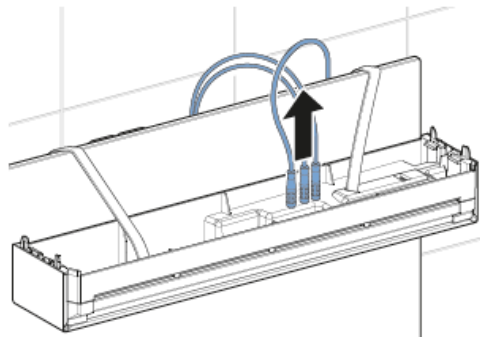
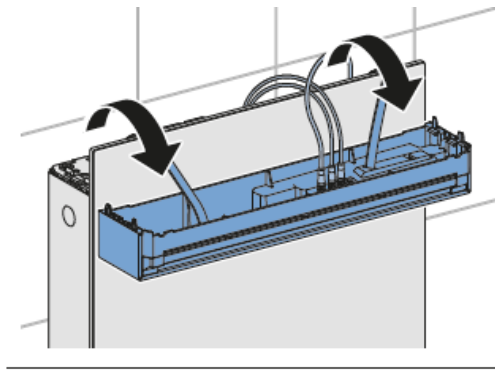

3. Unhook the lid retainer and remove the lid.

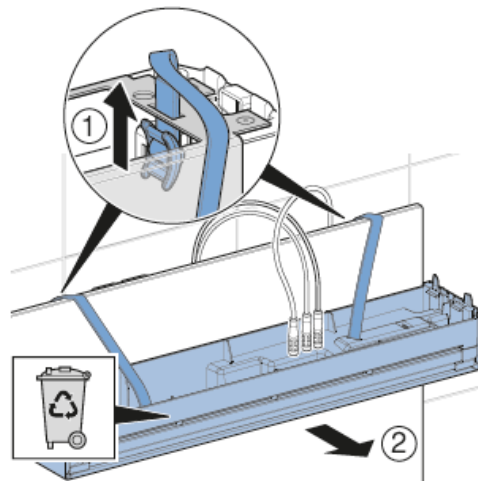

4. Unpack the new cistern lid.

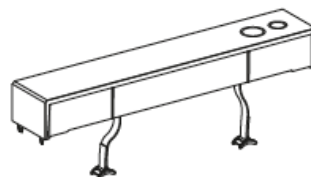
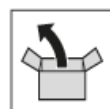

5. Replace the cistern lid.

Positioning the servo lever

1. Hold the cistern lid with both hands, lift it up and fold it towards the front.

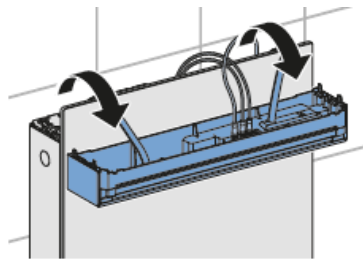

2. Remove the upper part of the odour extraction unit

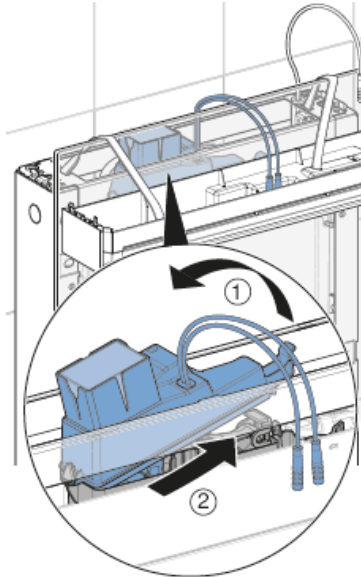

3. Move the servo lever to the basic position.

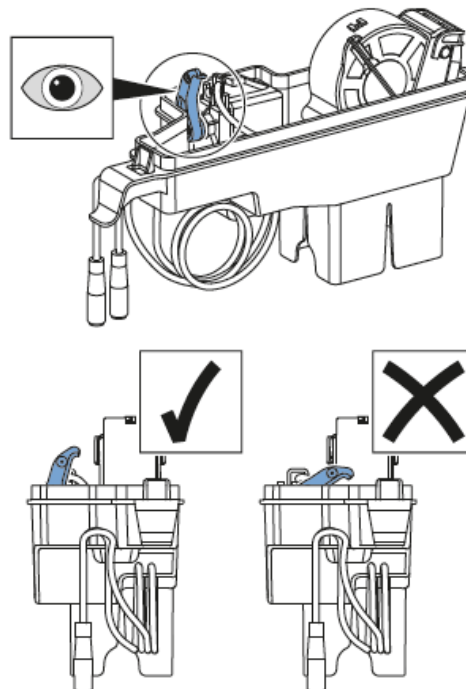

Re-referencing the position of the servo lever

1. Hold the cistern lid with both hands, lift it up and fold it towards the front.
2. Disconnect the plug connections

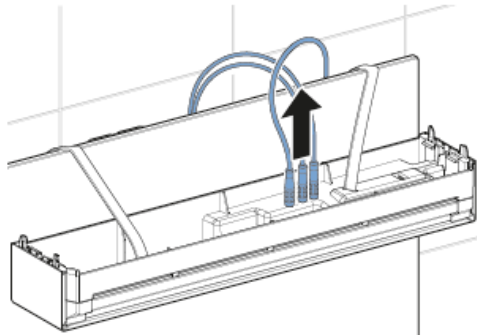
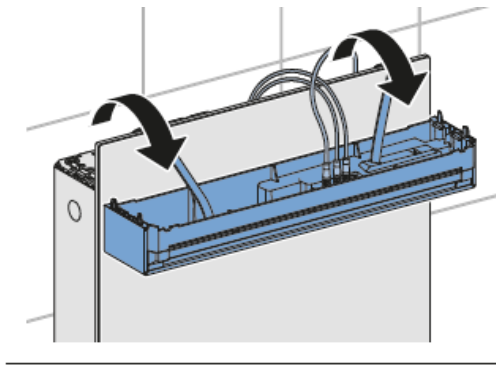

3. Wait at least 3 minutes.



Re-establish the plug connections.

4. Close the cistern lid.
5. Press the <Large flush volume> button.

Result

A large flush is actuated and the position of the servo lever is re-referenced in the process.

Replacing the upper part of the odour extraction

Prerequisite

The spare part is on hand.

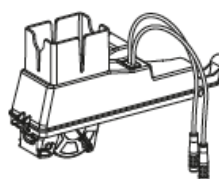

1. Hold the cistern lid with both hands, lift it up and fold it towards the front.
2. Disconnect the plug connections.

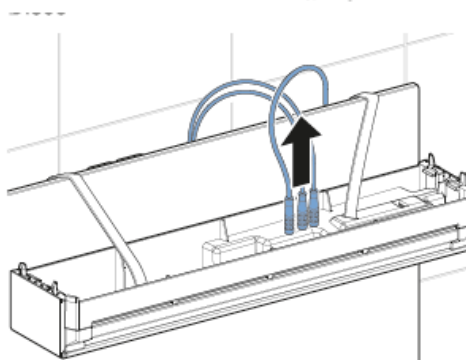
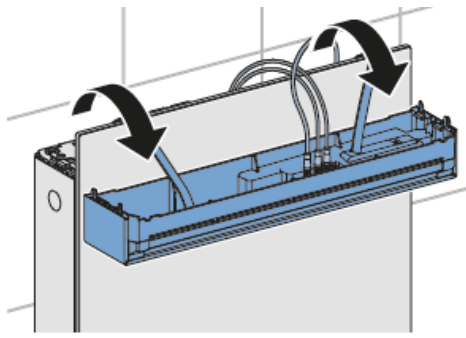

3. Remove the upper part of the odour extraction unit

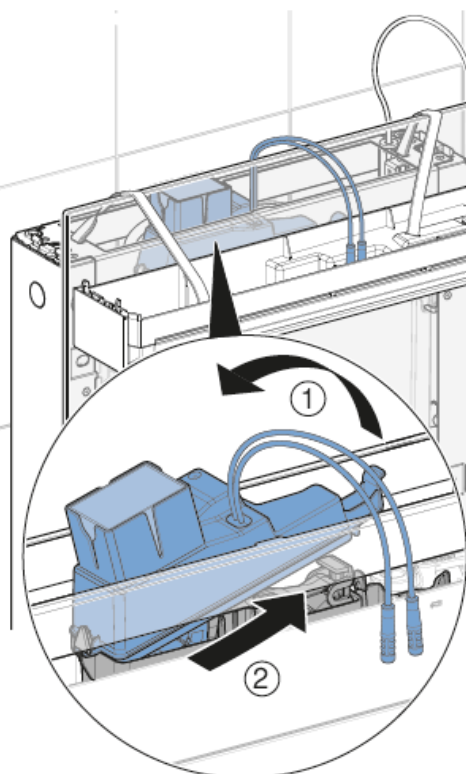

4. Unpack the upper part of the odour extraction.

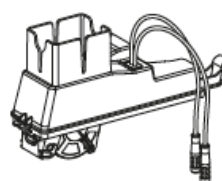

5. Mount the upper part of the odour extraction.

Replacing the lower part of the odour extraction

Prerequisite

The spare part is on hand.

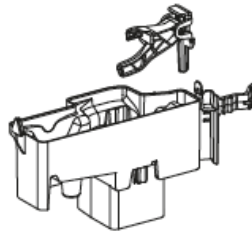

1. Hold the cistern lid with both hands, lift it up and fold it towards the front.
2. Disconnect the plug connections.

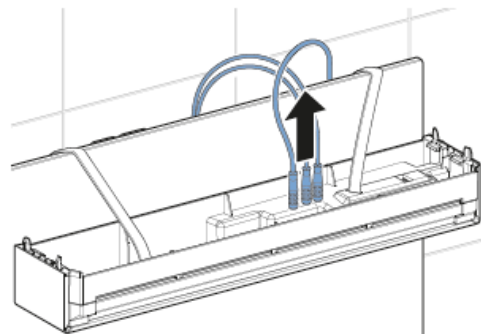
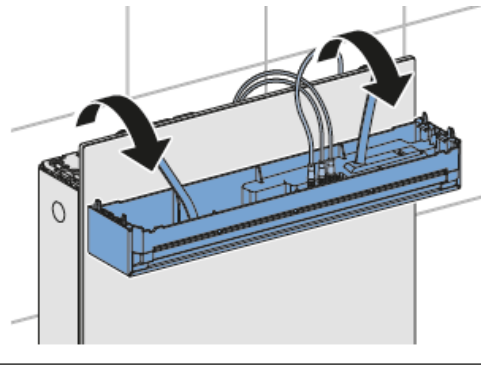

3. Remove the upper part of the odourextraction unit
4. Remove the actuator lever

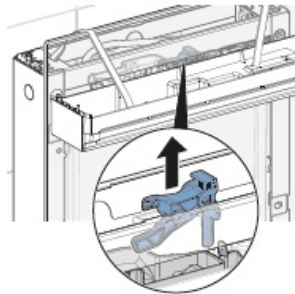
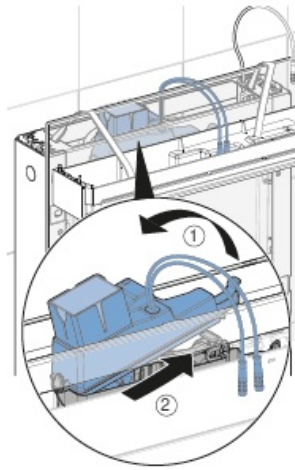

5. Loosen and remove the lower part of the odour extraction unit together with the fill valve.
6. Loosen the reinforced braided hose.

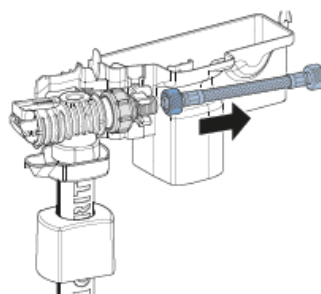
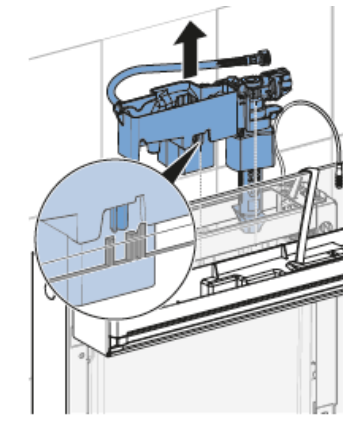

7. Loosen the fill valve.
8. Unpack the lower part of the odour extraction.

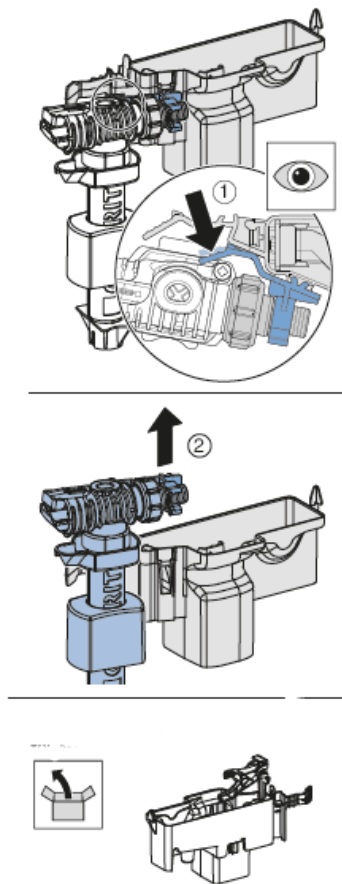

9. Hook in the fill valve on the lower part of the odour extraction unit.
10. Insert the lower part of the odour extraction unit together with the fill valve.

Replacing the flush valve

Prerequisite

The spare part is on hand.



1. Hold the cistern lid with both hands, lift it up and fold it towards the front.
2. Disconnect the plug connections.

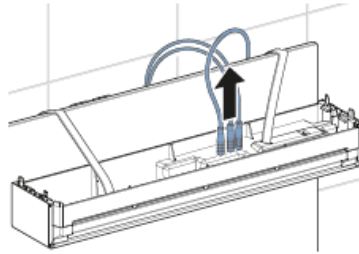
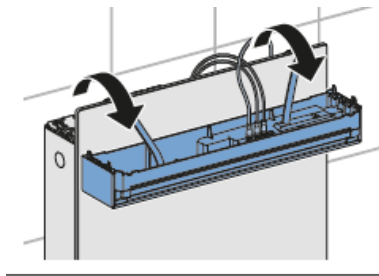

3. Remove the upper part of the odour extraction unit
4. Remove the actuator lever

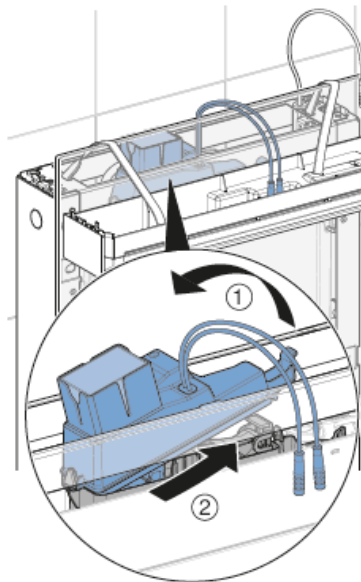

Remove the actuator lever.

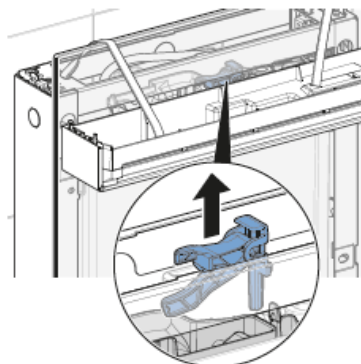

5. Loosen and remove the lower part of the odour extraction unit together with the fill valve.
6. Remove the flush valve

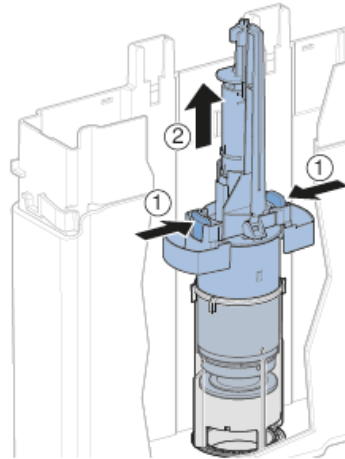
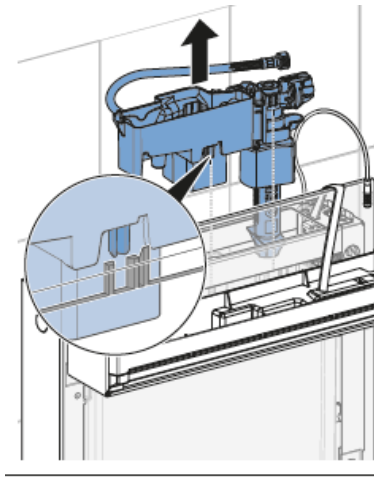

7. Remove the basket.

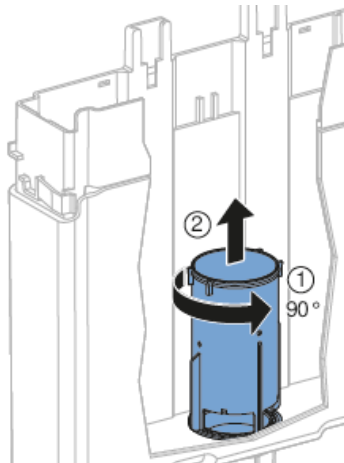

8. Unpack the new flush valve

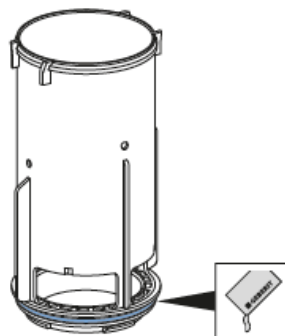

9. Lubricate the section seal for basket.

10. Replace the flush valve.

Replacing the flat gasket for flush valve

Prerequisite

The spare part is on hand.



The flat gasket has been removed.

Remove and replace the old flat gasket for flush valve.

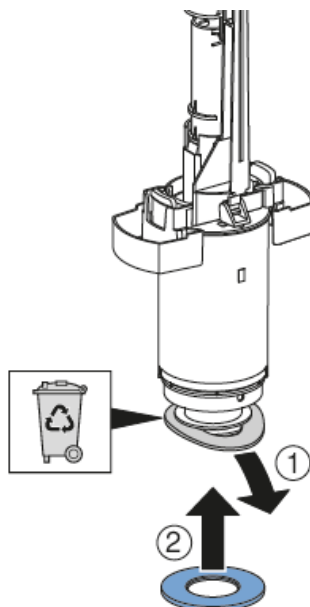

Replacing the fill valve

Prerequisite

The spare part is on hand (article number according to spare parts catalogue).



1. Hold the cistern lid with both hands, lift it up and fold it towards the front.

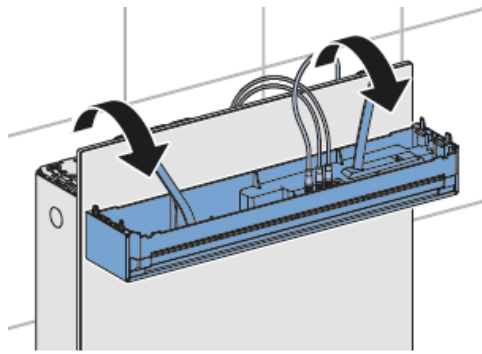

2. Disconnect the plug connections.

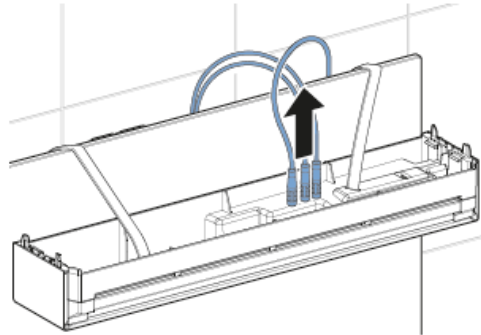

3. Remove the upper part of the odour extraction unit

4. Remove the actuator lever.

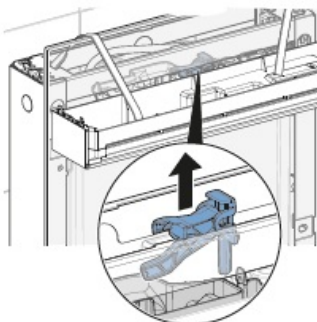
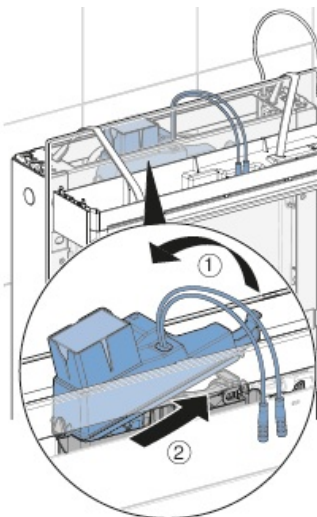

5. Loosen and remove the lower part of the odour extraction unit together with the fill valve

6. Loosen the reinforced braided hose

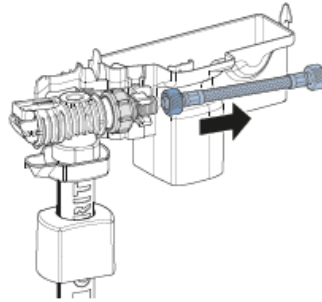
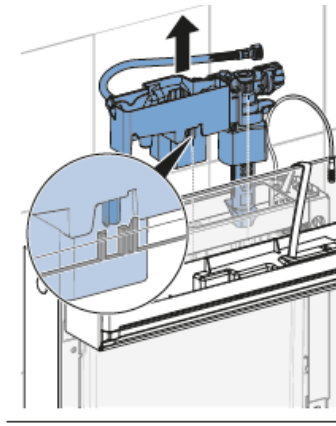

7. Loosen the fill valve.

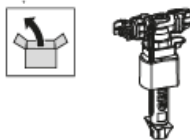
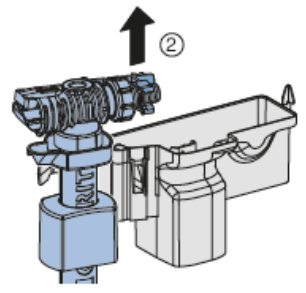
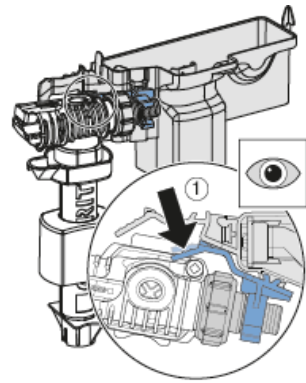

8. Unpack the new fill valve

9. Adjust the fill valve for the correct water level.

10. Hook in the fill valve on the lower part of the odour extraction unit.

11. Connect the reinforced braided hose to the fill valve.

12. Insert the lower part of the odour extraction unit together with the fill valve.

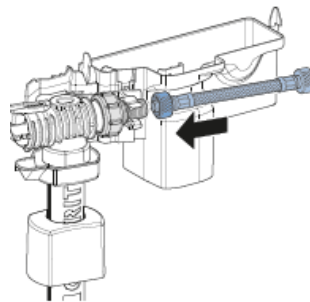
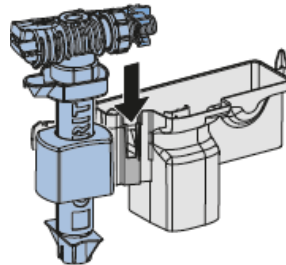
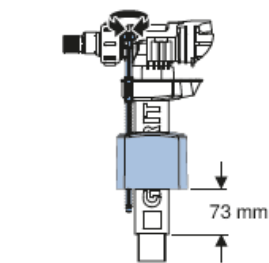

Disposal



Disposal of waste electrical and electronic equipment

The symbol of the crossed-out wheeled bin means that waste electrical and electronic equipment (WEEE) must be disposed of separately and not with other non-recyclable waste. End users are legally obliged to return old equipment to public waste disposal authorities, distributors, or Geberit for proper disposal. Many distributors of electrical and electronic equipment are obliged to take back WEEE free of charge. Contact the responsible sales or service company to return the WEEE to Geberit.

Used batteries and accumulators that are not enclosed within the old equipment, as well as lamps that can be removed from the old equipment in a non-destructive manner, must be separated from the old equipment before being handed over to a disposal point.

If personal data is stored on the old equipment, end users themselves are responsible for deleting it before handing it over to a disposal point.

Documents / Resources

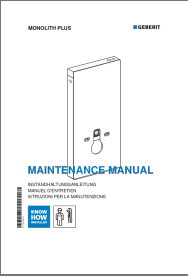
	<p>GEBERIT Monolith Plus Sanitary Module [pdf] Instruction Manual</p> <p>Monolith Plus Sanitary Module, Plus Sanitary Module, Sanitary Module, Module</p>
---	---

References

- [User Manual](#)

 GEBERIT, Module, Monolith Plus Sanitary Module, Plus Sanitary Module, Sanitary
 GEBERIT Module

Leave a comment

Your email address will not be published. Required fields are marked *

Comment *

Name

Email

Website

☐ Save my name, email, and website in this browser for the next time I comment.

Post Comment

Search:

e.g. whirlpool wrf535swhz

Search

[Manuals+](#) | [Upload](#) | [Deep Search](#) | [Privacy Policy](#) | [@manuals.plus](#) | [YouTube](#)

This website is an independent publication and is neither affiliated with nor endorsed by any of the trademark owners. The "Bluetooth®" word mark and logos are registered trademarks owned by Bluetooth SIG, Inc. The "Wi-Fi®" word mark and logos are registered trademarks owned by the Wi-Fi Alliance. Any use of these marks on this website does not imply any affiliation with or endorsement.