



# GEARELEC GX10 Bluetooth Intercom System User Manual

[Home](#) » [GEARELEC](#) » GEARELEC GX10 Bluetooth Intercom System User Manual

## Contents [ [hide](#) ]

- [1 GEARELEC GX10 Bluetooth Intercom System](#)
- [2 One-key-networking of Multiple GX10s](#)
- [3 Music Sharing {between 2 GX10 Units}](#)
- [4 Installation \(2 Methods\)](#)
- [5 GX10 Parts & Accessories](#)
- [6 Charging instructions](#)
- [7 Parameter](#)
- [8 Precaution](#)
- [9 FCC Caution](#)
- [10 Documents / Resources](#)
- [11 Related Posts](#)



## GEARELEC GX10 Bluetooth Intercom System



## One-key-networking of Multiple GX10s

### Automatic pairing steps (take 6 GX10 units for instance)

1. Power on all the 6 GX10 intercoms (123456), hold the M buttons to activate passive pairing mode and the red and blue lights will flash quickly and alternatively;
2. Press the Multifunction button of any unit (No.1 unit), the red and blue lights will flash slowly and alternatively and then No.1 unit will enter automatic pairing mode along with a 'pairing' voice prompt;
3. After pairing is successful, there will be a 'Device Connected' voice prompt.

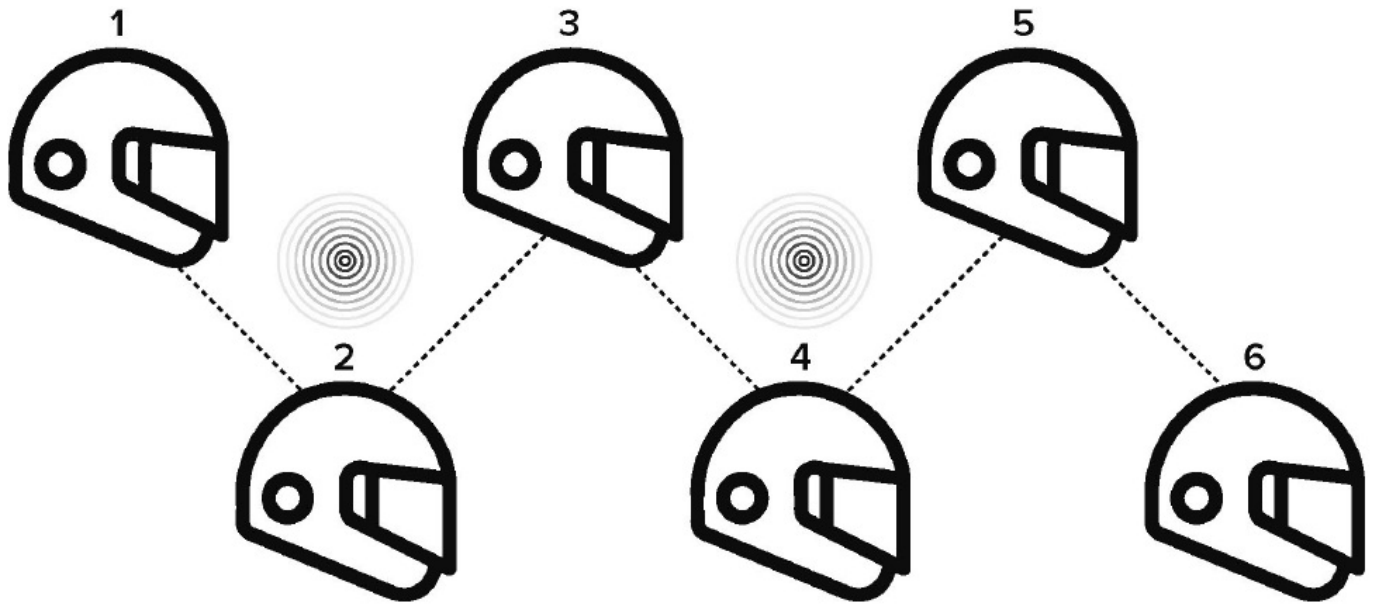

### Notice

Due to various use environment, large external interference, and many environmental interference factors, it is recommended to communicate with multiple riders within 1000 meters. Longer the range, more interference there will be, affecting the riding experiences.

### Music Sharing {between 2 GX10 Units}

#### How to turn on

With both GX10 in power on state, music can only be shared in one direction. For example, if you want to share music from GX10 A to GX10 B, then the instructions are as follows:

1. Connect A to your phone via Bluetooth (Open a music player and keep music in pause state);
2. Pair and connect A to B (Keep both in non-intercom mode);
3. After pairing is successful, press and hold the Bluetooth Talk and M buttons of A for 3 seconds to turn on music sharing, and there will be slow flashing blue lights and a 'Start Music Sharing' voice prompt, indicating music is shared successfully.

#### How to turn off

In music sharing state, press and hold the Bluetooth Talk and M buttons of A for 3 seconds to turn off music sharing. There will be a 'Stop Music Sharing' voice prompt.

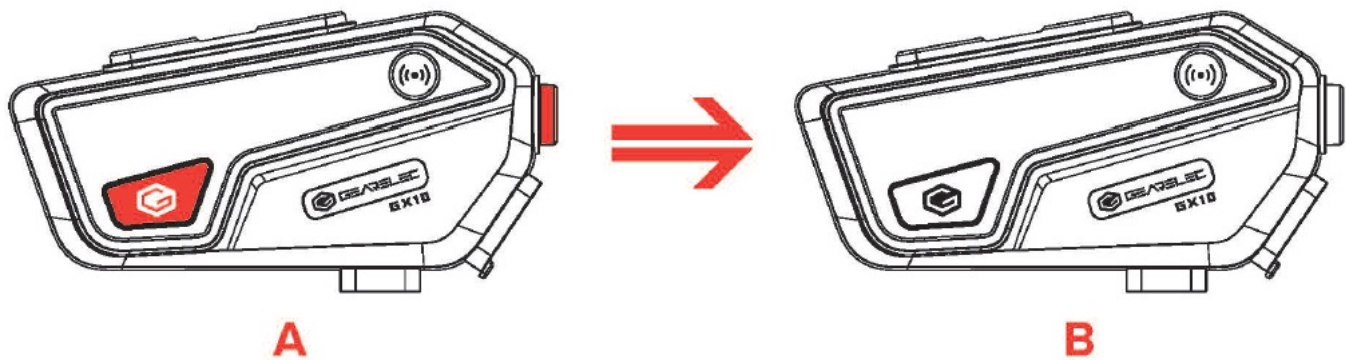

### **EQ Sound Settings**

In music playback state, press the M button to enter EQ setting. Each time you press the M button, it will switch to the next sound effect along with a voice prompt of Middle Range Boost/Treble Boost/Bass Boost.

### **Voice Control**

In standby state, press the M button to enter voice control mode. The blue light will flash slowly.

### **Last Number Redial**

In standby state, press the Multifunction button twice to redial the last number that you called.

### **Factory Reset**

In power on state, hold the Multifunction, Bluetooth Talk, and M buttons for 5 seconds. The red and blue lights will be always-on for 2 seconds.

### **Battery Level Prompt**

In standby state, press the Bluetooth Talk and M buttons and there will be voice prompt of the current battery level. Also, there will be low battery level prompt.

### **Flowing Light Mode**

In Bluetooth standby state, hold the Mand Volume up buttons for 2 seconds. The red flowing light flashes twice when turning on/off flowing light.

### **Colorful Light Mode**

In Bluetooth standby and flowing light on state, press the Mand Volume up buttons to turn on colorful light mode. The color of the light can be switched in order.

### **Notice**

It will automatically shut down after 15 minutes of standby.

## **Installation (2 Methods)**

### **Method 1: Install with the adhesive mount**

1. Mounting Accessories
2. Install the intercom into the mount

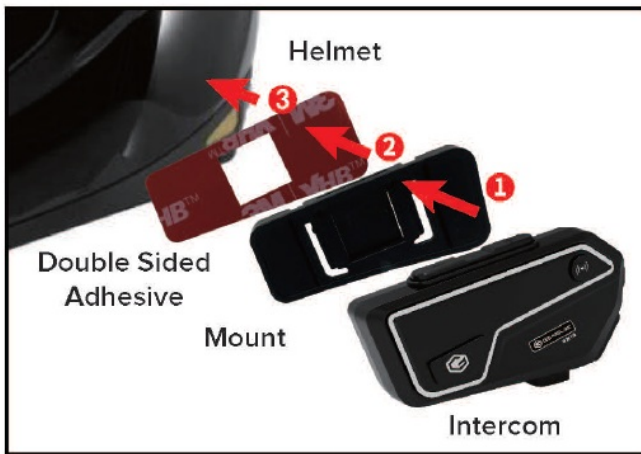

3. Attach the double sided adhesive on the mount
4. Install the intercom with adhesive onto the helmet

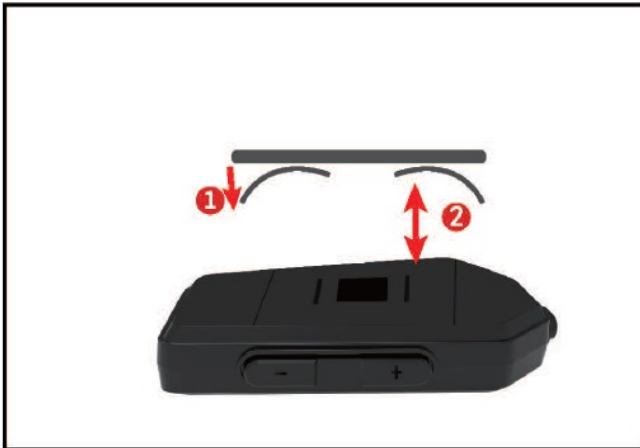

#### Quick removal of the intercom on the helmet

Unplug the headset, hold the intercom with fingers, then push up the intercom, and you can remove the intercom from the helmet.

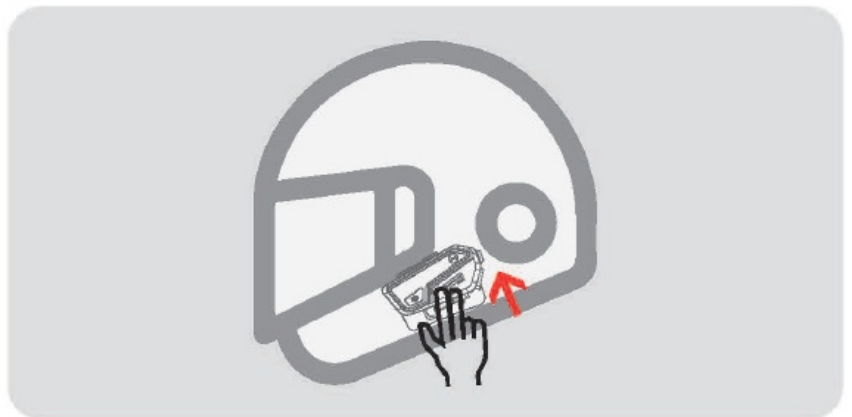
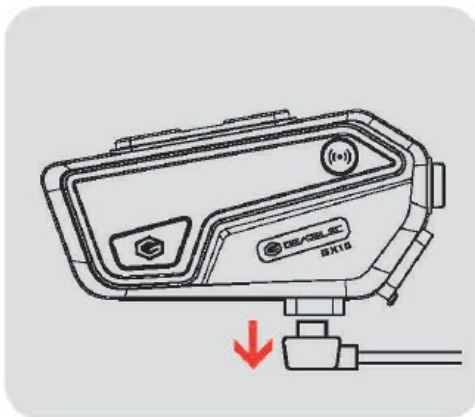

#### Method 2: Install with the clip mount

1. Mounting Accessories
2. Install the metal clip onto the mount

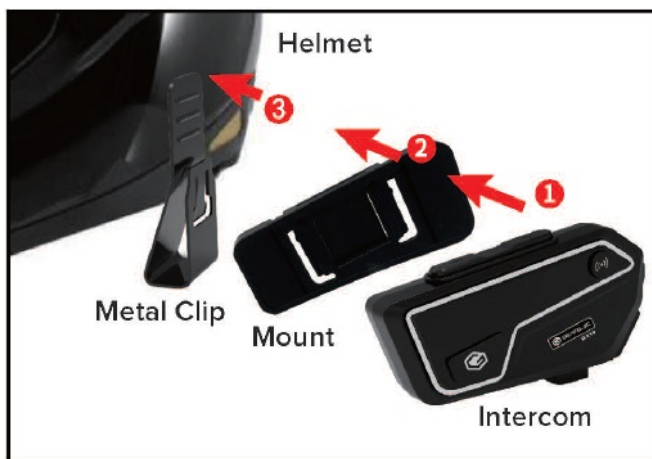

3. Install the intercom onto the mount
4. Clip the mount on the helmet



#### Quick removal of the intercom on the helmet

Unplug the headset, hold the intercom with fingers, then push up the intercom, and you can remove the intercom from the helmet.

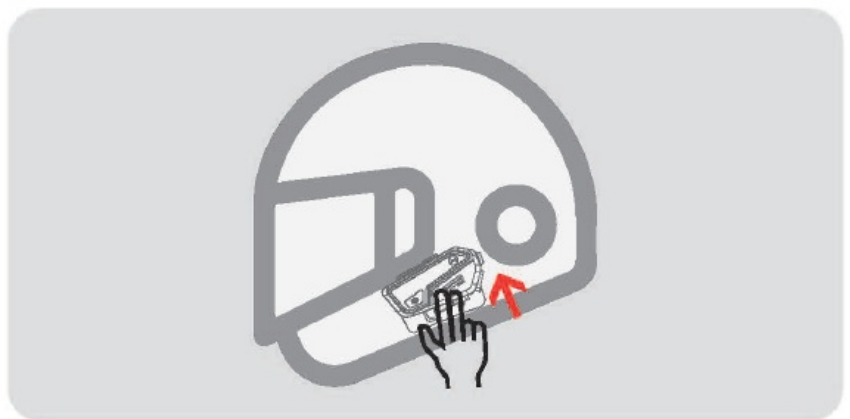
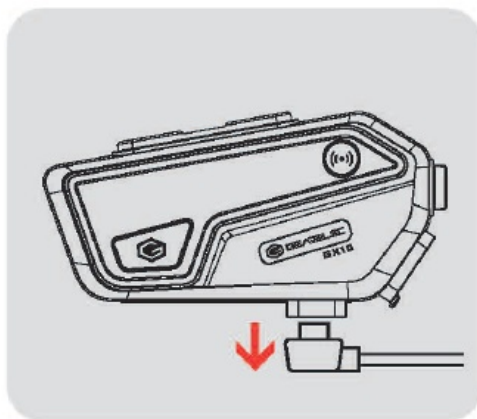

#### GX10 Parts & Accessories

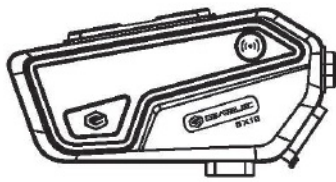

Intercom x1

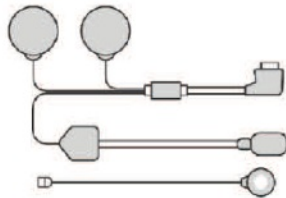

Microphone &  
Speaker Set x1

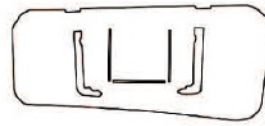

Mount x1

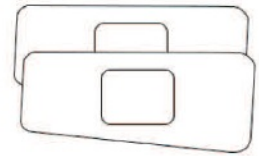

Single/Double  
Sided Adhesives x1



Metal Clip x1

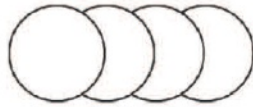

Speaker  
Fasteners x4

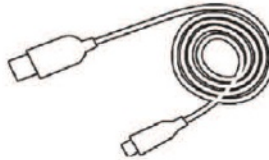

USB Cable x1



Rectangular  
Fasteners x2

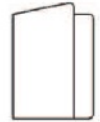

Manual x1

## Charging instructions

1. Before using the Bluetooth intercom, please use the provided charging cable to charge it. Plug the USB Type-C connector into the USB C charging port of the Bluetooth intercom. Connect the USB A connector to a USB A port of the following power supply:
  1. **A.** A USB A port on a PC
  2. **B.** A DC 5V USB output on a power bank
  3. **C.** A DC 5V USB output on a power adapter
2. The indicator is an always-on red light when charging and then goes out when fully charged. It takes about 1.5 hours from a low battery level to a full charge.

## Parameter

- **Communication count:** 2-8 riders
- **Working frequency:** 2.4 GHz
- **Bluetooth version:** Bluetooth 5.2
- **Supported Bluetooth protocol:** HSP/HFP/A2DP/AVRCP
- **Battery type:** 1000 mAh Rechargeable lithium polymer
- **Standby time:** up to 400 hours
- **Talk time:** 35 hours talk time with lights off 25 hours talk time with lights always-on
- **Music time:** up to 40 hours
- **Charging time:** about 15 hours
- **Power adapter:** DC 5V/1A (NOT included)
- **Charging interface:** USB Type-C port
- **Operating temperature:** 41-104 °F (5-40 °C)

## Precaution

- ## Wireless Connects You with Me and Brings Just What Lives Need!

This device complies with part 15 of the FCC Rules. Operation is subject to the following two conditions: (1) This device may not cause harmful interference, and (2) this device must accept any interference received, including interference that may cause undesired operation. Any Changes or modifications not expressly approved by the party responsible for compliance could void the user's authority to operate the equipment.

- Reorient or relocate the receiving antenna.
- Increase the separation between the equipment and receiver.
- Connect the equipment into an outlet on a circuit different from that to which the receiver is connected.
- Consult the dealer or an experienced radio/TV technician for help.

## Documents / Resources

Manuals+, home privacy