



GE Profile CSB9120 Advantium 120V Built-In SpeedCook and 120V Built-In Convection Ovens Instruction Manual

[Home](#) » [GE Profile](#) » GE Profile CSB9120 Advantium 120V Built-In SpeedCook and 120V Built-In Convection Ovens Instruction Manual 



GE APPLIANCES

Installation
Advantium® 120V Built-In Speed Cook and 120V Built
-In Convection Ovens
CSB9120
PSB9120

Contents

- [1 Design Information](#)
- [2 Standard Installation Preparation](#)
- [3 Flush Mount Installation Preparation \(Monogram Only\)](#)
- [4 Installation Preparation](#)
 - [4.1 REMOVE THE PACKAGING AND PARTS](#)
 - [4.2 DOOR TRIM REMOVAL FOR ABOVE 36" INSTALLATION ONLY](#)
 - [4.3 SLIDE THE OVEN INTO THE CUTOUT](#)
 - [4.4 INSTALL BOTTOM TRIM](#)
 - [4.5 INSTALL BOTTOM TRIM WITH ACCESSORY DRAWER](#)
 - [4.6 INSTALL MOUNTING SCREWS](#)
 - [4.7 FINALIZE INSTALLATION](#)
- [5 Notes](#)
 - [5.1 MODELS AVAILABLE](#)
- [6 Documents / Resources](#)
- [7 Related Posts](#)

Design Information

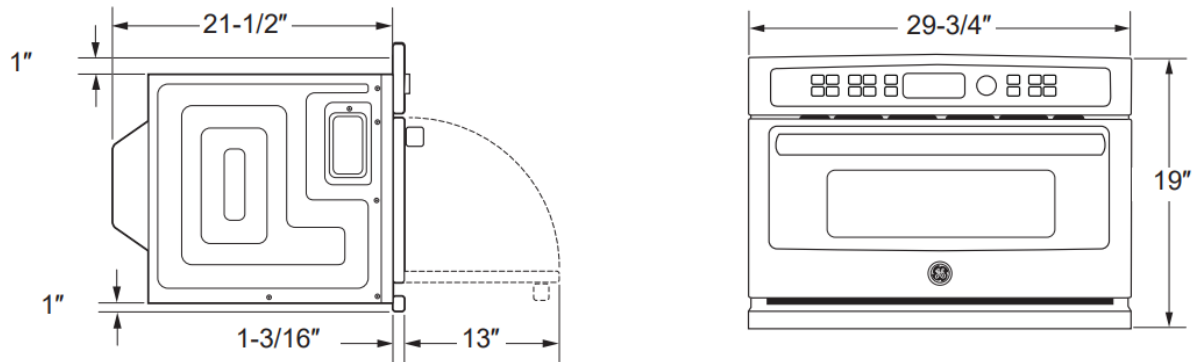

PRODUCT DIMENSIONS AND CLEARANCES **NOTE:** Appearance will vary by model.

TOOLS AND PARTS REQUIRED (NOT SUPPLIED)

- #2 Phillips screwdriver
- Hand-held drill
- High speed drill bit, 3/32 diameter
- 3/8 slot-head screwdriver
- Level
- Saw
- 3/8 min. plywood for floor (if required)
- Wood screws or other hardware for installing runner or shelf to support oven (if required)
- Safety glasses or goggles

FLUSH MOUNT INSTALLATION (Monogram Only)

This installation method allows for the unit face to be inline with the cabinet face.

IMPORTANT: HIGH SKILL LEVEL IN

CARPENTRY IS REQUIRED. Non-standard cabinetry may be required.

Flush installation of the oven will lead to the exposure of the cabinet face frame edges.

Side cleats may be visible and should be a finished surface.

ADVANCE PLANNING

- These ovens may be installed directly into a 30" wide oven cabinet with standard installation.
- Cutout height dimensions are different for installations with an accessory storage drawer. Make sure to use the correct cutout when preparing the opening.
- Allow for clearance to adjacent corners, walls, drawers, etc.
- Cabinets installed adjacent to wall ovens must have an adhesion spec of at least 194°F temperature rating.

The oven must be securely installed in a cabinet that is firmly attached to the house structure. Weight on the oven door could cause the oven to tip and result in injury. Never allow anyone to climb, sit, stand or hang on the oven door.

If installing the drawer accessory, the drawer must be assembled to the oven prior to installation into the cabinet. See the **Accessory Storage Drawer Assembly Instructions**.

ELECTRICAL REQUIREMENTS

Single Advantium/Convection 120 Installation:

This product requires a 120-volt, 60 Hz, 15-amp circuit and draws 1.8 kilowatts. This product must be connected to a supply circuit of the proper voltage and frequency.

- Wire size must conform to the requirements of the National Electrical Code or the prevailing local code for this kilowatt rating.
- The power supply cord and plug should be brought to a separate 15 or 20 ampere branch circuit single grounded receptacle. The outlet box should be located within reach of the 48" power

ELECTRICAL LOCATION

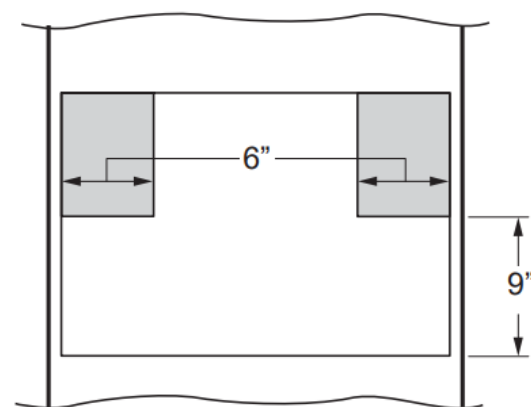

Locate outlet box in the shaded area

Install a recessed electrical outlet in the back wall of the opening within 6" of either side and at least 9" above the cutout floor.

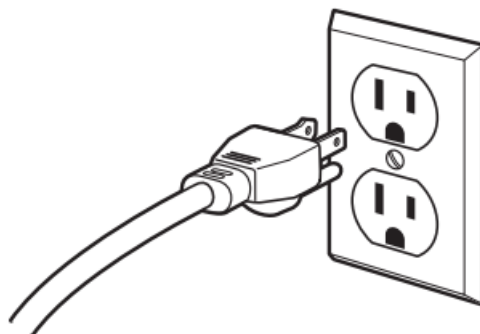

GROUNDING INSTRUCTIONS

This appliance must be grounded. In the event of an electrical short circuit, grounding reduces the risk of electric shock by providing an escape wire for electric current. This appliance is equipped with a cord having a grounding wire with a grounding plug. The plug must be plugged into an outlet that is properly installed and grounded.

WARNING Improper use of the grounding plug can result in a risk of electric shock.
IMPORTANT: (Please read carefully).

The power cord of this appliance is equipped with a three-prong (grounding) plug that mates with a standard three-prong grounding wall receptacle to minimize the possibility of electric shock. Consult a qualified electrician or serviceman if the grounding instructions are not completely understood, or if doubt exists as to whether the appliance is properly grounded.

- Where a standard two-prong wall receptacle is encountered, it is the personal responsibility and obligation of the consumer to have it replaced with a properly grounded three-prong wall receptacle.

Do not, under any circumstances, cut or remove the third (ground) prong from the power cord.

DO NOT USE AN EXTENSION CORD. If the power supply cord is too short, have a qualified electrician or serviceman install an outlet near the appliance.

Standard Installation Preparation

IMPORTANT: Always maintain 36-3/4" minimum height from the floor to the cutout in any single or combined installation unless plastic trim is installed.

PREPARE THE OPENING

The Advantium/Convection 120 can be installed in combination with other Built-In Appliances. Always follow each product's Installation Instructions to complete the installation.

Single Advantium/Convection 120 Installation:

Order a 30" wide single oven cabinet or cut the opening in a wall to the dimensions shown.

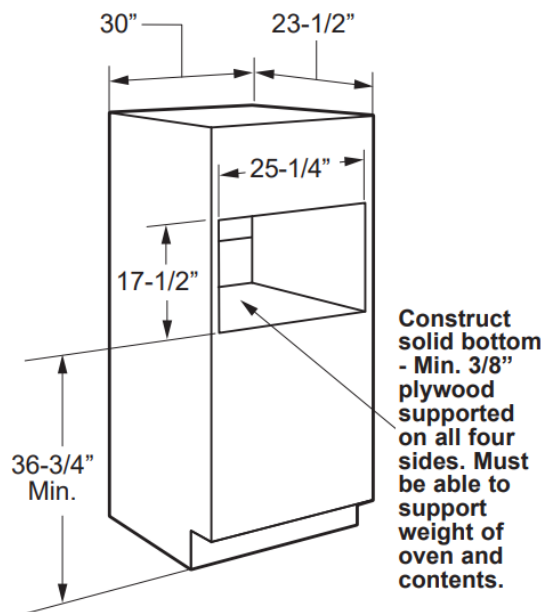

- Allow the following clearances around the cutout on the front surface of the cabinet : 5/8" from the top, 2-3/8" from the side edges, and 1-1/8" from the bottom. (Note: these refer to minimum clearances required for installation and do not reflect actual product dimensions.)
- Oven overlaps will conceal cut edges on all sides of the opening.
When installed over a single oven or a warming drawer, allow at least 2" between the two openings. This separation will provide clearance for bottom overlap of the Advantium/ Convection 120 and the other appliance overlaps.
- The support must be level and rigidly mounted, flush with the bottom edge of the cutout.

Installation over a Warming Drawer:

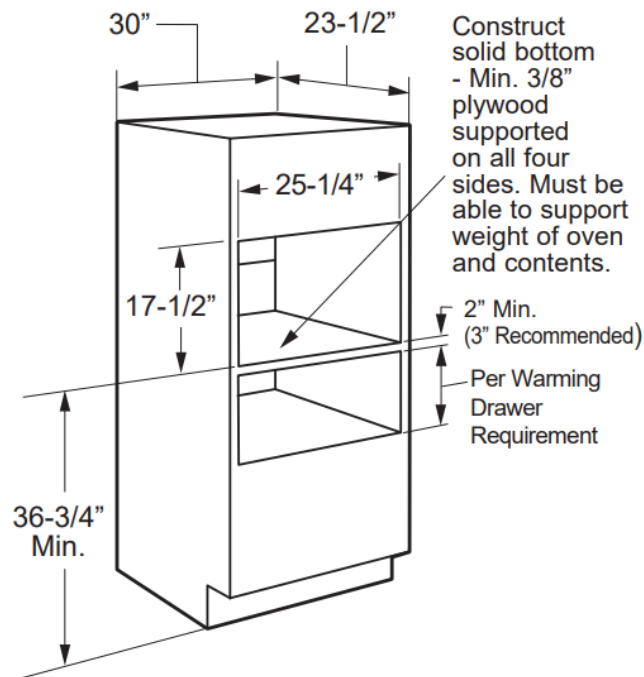

NOTE: Additional clearances between the cutouts may be required. Check to be sure the oven supports above the Warming Drawer location does not obstruct the required interior depth and height. See Warming Drawer installation instructions for details.

IMPORTANT: Always maintain 36-3/4" minimum height from the floor to the cutout in any single or combined installation unless plastic trim is installed.

Installation over a Wall Oven:

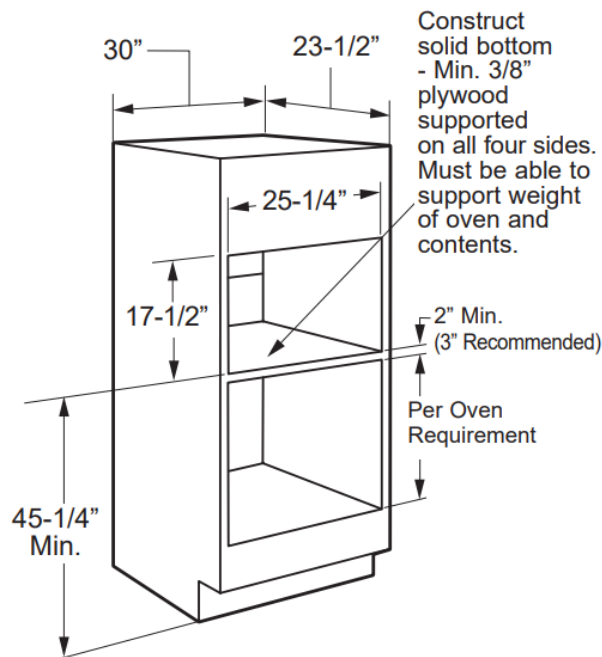

* If you are replacing an electric double oven with the combined installation of an Advantium/ Convection 120 and a single oven, use the dimensions shown. The middle rail separating the two openings may need to be larger than the 2" minimum shown.

Installation over a Wall Oven and Warming Drawer:

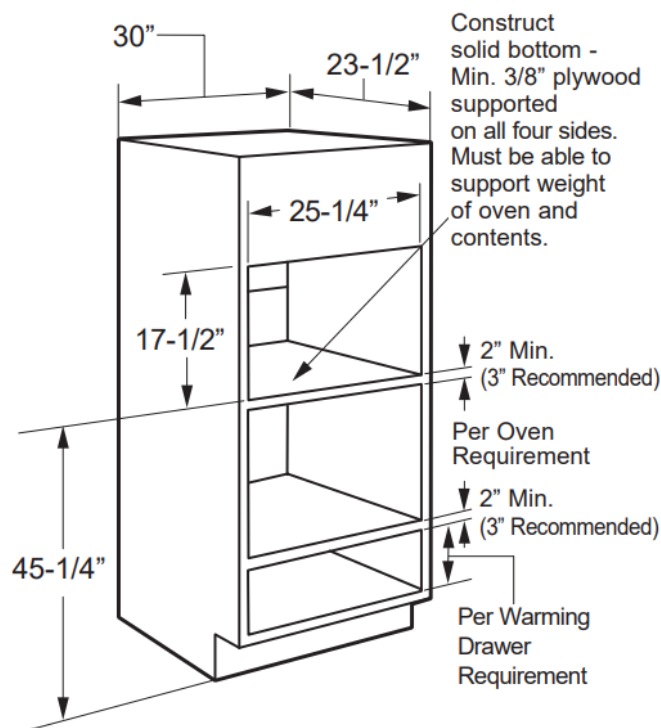

NOTE: Additional clearances between the cutouts may be required. Check to be sure the oven supports above the Warming Drawer location does not obstruct the required interior depth and height. See Warming Drawer installation instructions for details.

CAUTION For personal safety, the mounting surface must be capable of supporting the cabinet load, in addition to the added weight of the oven and drawer, plus additional oven loads.

IMPORTANT: Always maintain 36-3/4" minimum height from the floor to the cutout in any single or combined installation unless plastic trim is installed.

Installation over another Built-In SpeedCook Oven:

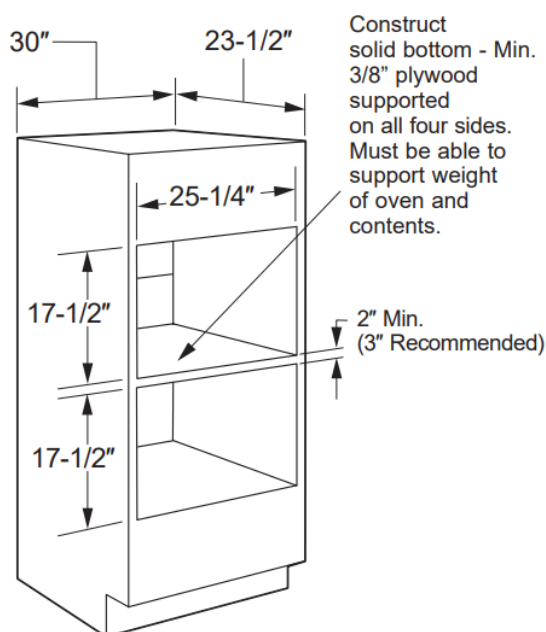

- If you are mounting a Built-In SpeedCook Oven over another, use the dimensions shown. The middle rail separating the two openings may need to be larger than the 2 minimum shown.

Installation under a Microwave Oven and over a Warming Drawer:

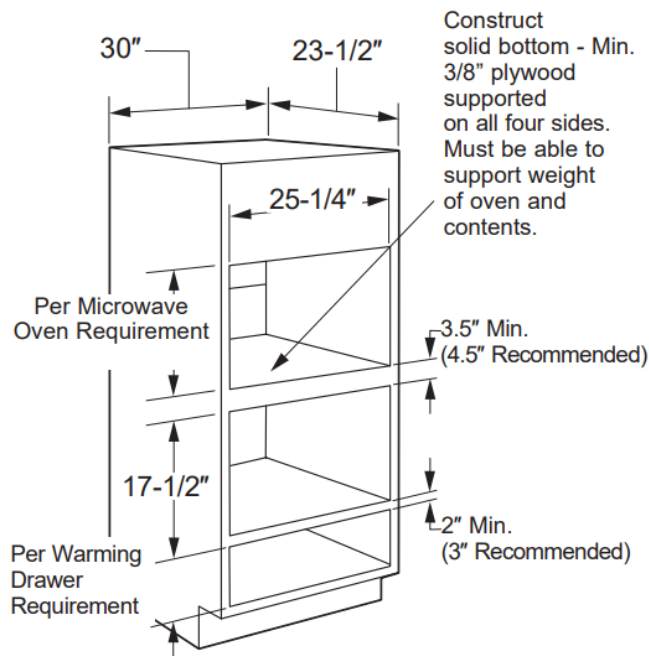

NOTE: Additional clearances between the cutouts may be required. Check to be sure the oven supports above the Warming Drawer location do not obstruct the required interior depth and height. See Warming Drawer installation instructions for details.

CAUTION For personal safety, the mounting surface must be capable of supporting the cabinet load, in addition to the added weight of the oven and drawer, plus additional oven loads.

IMPORTANT: Always maintain 36-3/4" minimum height from the floor to the cutout in any single or combined installation unless plastic trim is installed.

Installation beside another Built-in Speed cook Oven:

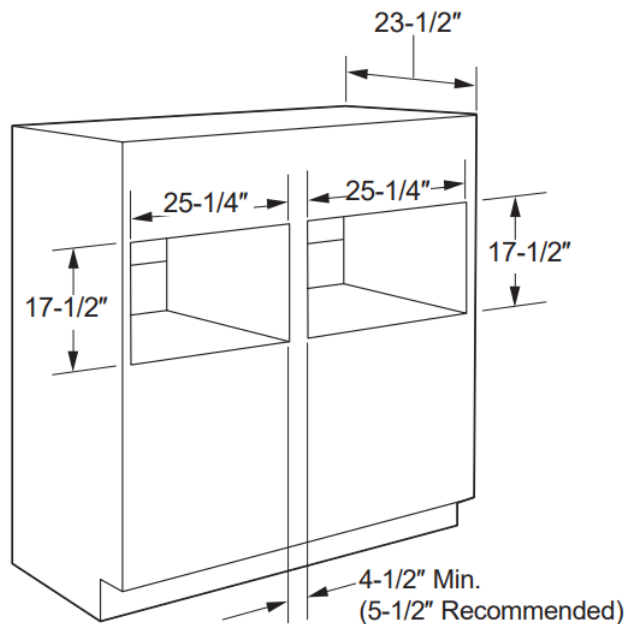

- If you are mounting a Speed Cook Oven beside another, use the dimensions shown. The middle rail separating the two openings may need to be larger than the 4-1/2 minimum shown.

Installation under a 30 or 36 Cooktop or Countertop:

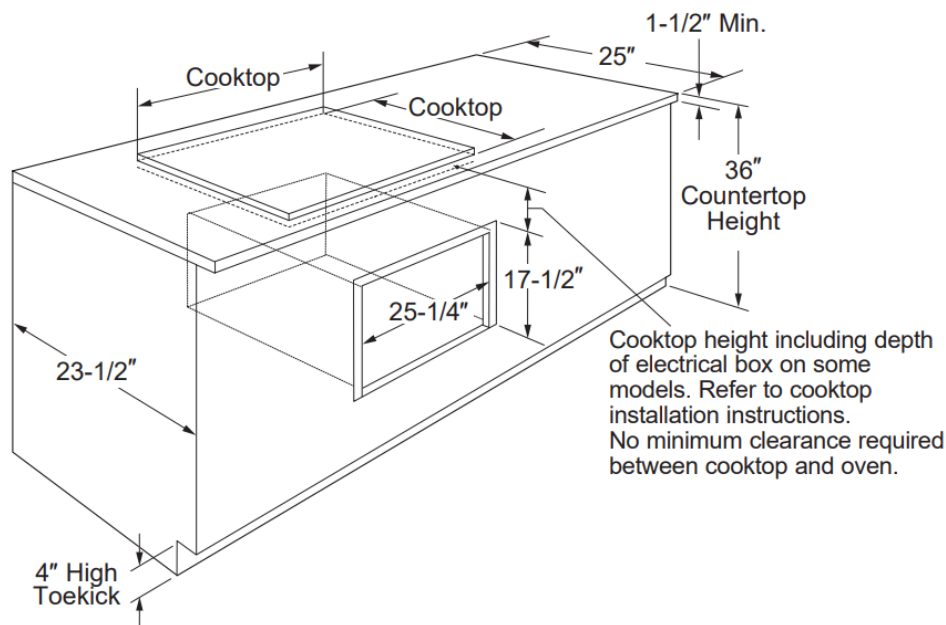

Gas or electric cooktops may be installed over this oven. See cooktop installation instructions for the cutout size. See the label on top of the oven for approved cooktop models. This oven requires a separate, properly grounded 15-Amp, 120-Volt, 60Hz power supply. The cooktop requires a separate power supply. Use a 30 or wider base cabinet.

NOTE: The oven is only approved to be installed under the specific models as labeled on the unit.

Flush Mount Installation Preparation (Monogram Only)

IMPORTANT: Always maintain 36-3/4" minimum height from the floor to the cutout in any single or combined installation unless plastic trim is installed.

PREPARE THE INTERIOR

Cut and install side cleats:

- Cut side wood cleats to height of cabinet opening and approx. 2-1/2" in depth. Install, on each side, Dim. E from the front face of the cabinet.

Cut and install bottom cleat:

- Cut bottom wood cleat to a height of 1-1/8", a depth of the cabinet minus Dim. E and a width of 25-1/4" to fit between side cleats. Install onto the cabinet floor between the side cleats, push it all the way back against cabinet wall and make sure its front face aligns with the front faces of the side cleats (Dim. E gap from the front cabinet face).

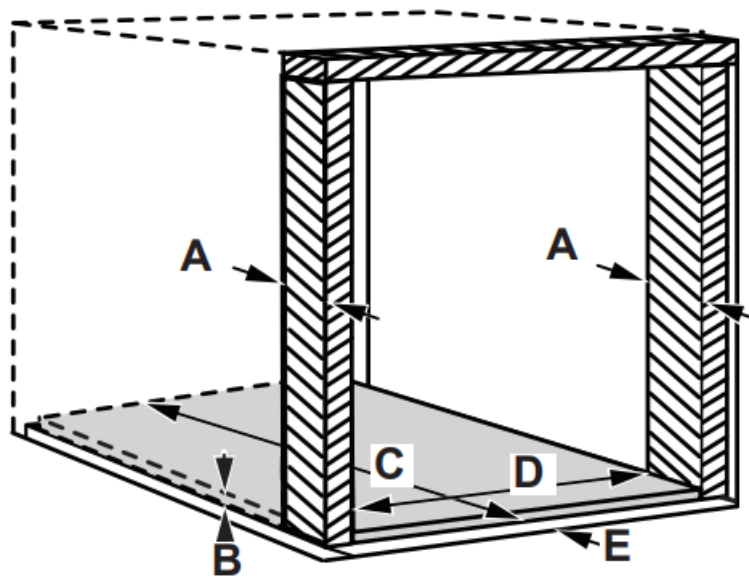

A	Side and top cleats depth	2-1/2" min.
B	Bottom cleat height	1-1/8"
C	Bottom cleat depth	Cabinet depth minus Dim. E "
D	Bottom cleat width	25-1/4"
E	All four cleats inset depth	1 3/16"

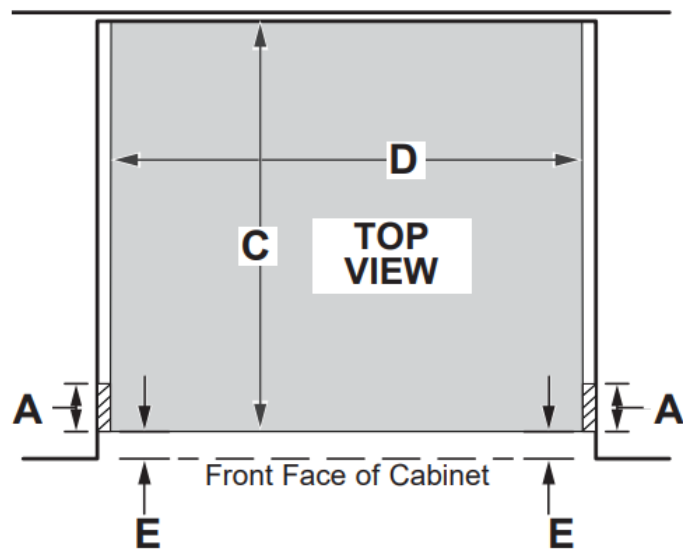

PREPARE THE OPENING

The Advantium 120 can be installed in combination with other Built-In appliances. Always follow each product's Installation Instructions to complete the installation.

Single Advantium 120 Installation:

Cut the opening in a cabinet to the dimensions shown.

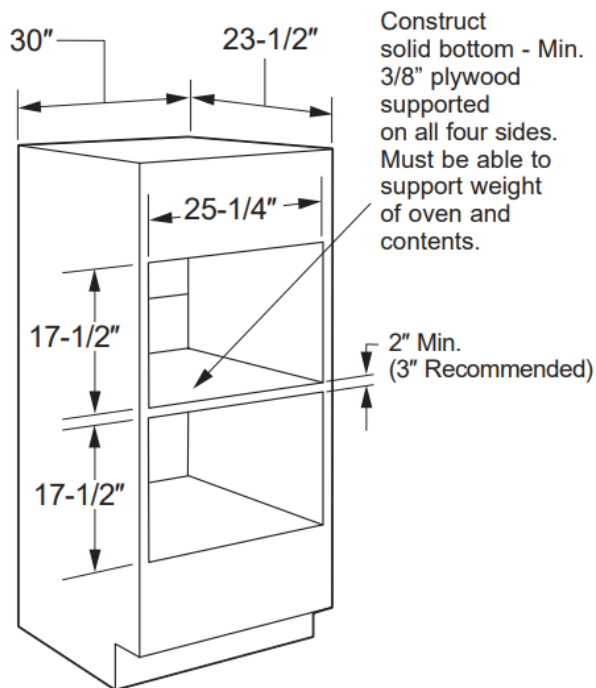

- The support must be level and rigidly mounted, flush with the bottom edge of the cutout.

Approved Flush Installation	Dimension F	
	1/8" Reveal	1/4" Reveal
Single Advantium	30"	30-1/4"
Over Warming Drawer	30"	30-1h"
Over Oven	30"	30-1/4"
Over Oven and Warming Drawer	30"	30-1/4"
Over Built-in Speedcook Oven	30"	30-1/4"
Double Advantium (side by side)	See page 10	
Under Cooktop or Countertop	See page 10	

** Top and bottom reveals are set to 1/8".

IMPORTANT: Always maintain 36-3/4" minimum height from the floor to the cutout in any single or combined installation unless plastic trim is installed.

PREPARE THE OPENING

The Advantium/Convection 120 can be installed beside another Advantium/Convection 120 in a side-by-side combination.

Double Advantium/Convection 120 Installation:

Cut the opening in a cabinet to the dimensions shown.

- Center divider acts as cleat for side of each respective unit. Only one additional side cleat needed per oven cutout.
- The support must be level and rigidly mounted, flush with the bottom edge of the cutout.

Dimension	1/8" Reveal	1/4" Reveal
G	59-7/8"	60-1/4"
H	5-1/8"	5-1/4"
I	27-3/8"	27-1/2"

*See table for desired reveals on sides and between unit.

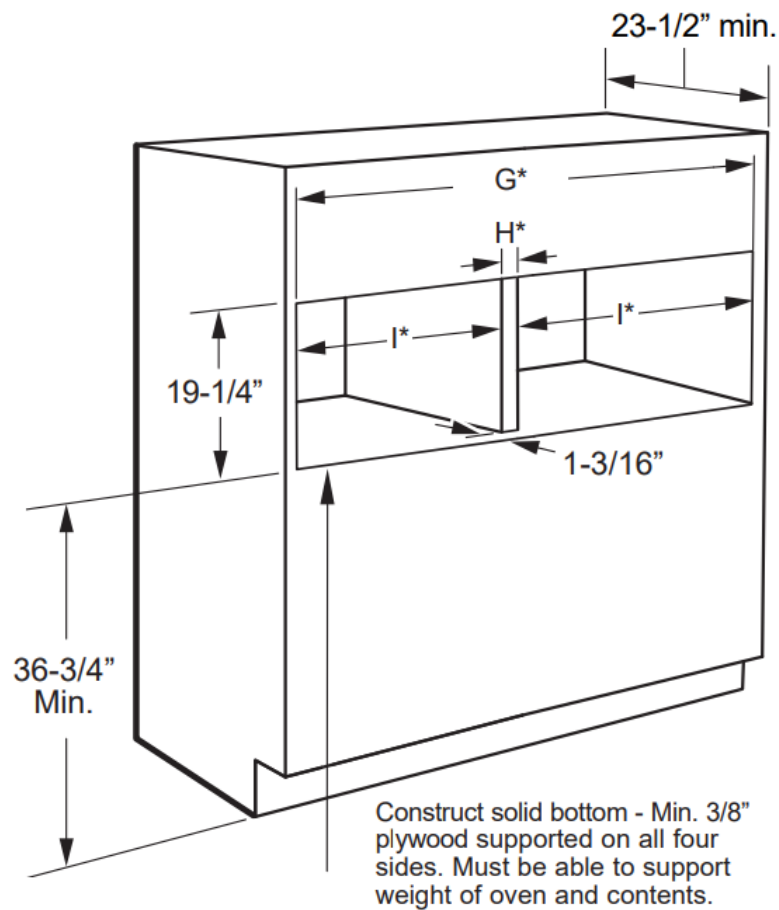

Installation under a 30 or 36 Cooktop or Countertop:

Gas or electric cooktops may be installed over this oven. See cooktop installation instructions for the cutout size. See the label on top of the oven for approved cooktop models. This oven requires a separate from the cooktop, properly grounded 15-Amp, 120-Volt, 60Hz power supply. Use a 30 or wider base cabinet.

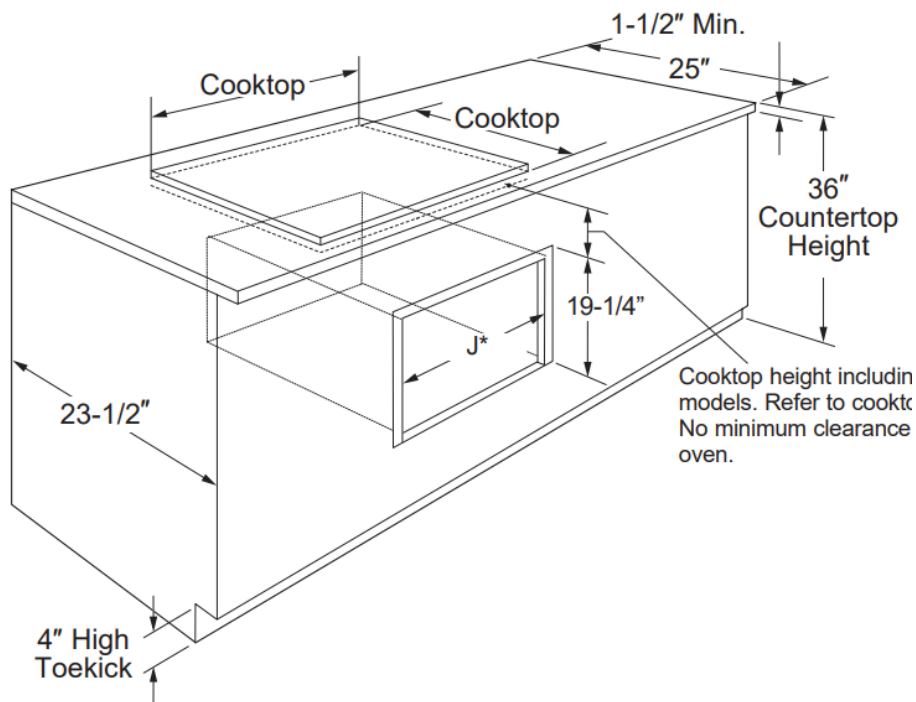

NOTE: The oven is only approved to be installed under the specific models as labeled on the unit.

*See table for desired reveals on sides.

Dimension	1/8" Reveal	1/4" Reveal
J	30"	30-1/4"

Installation Preparation

Preparation WITH an Accessory Storage Drawer

- PSB9120 and PWB7030 are the only approved models to be installed under 36-3/4" height with a storage drawer. CSB9120, ZSC1201, ZSC1202 and CWB7030 are not approved.
- As needed, see the Standard Mount Installation Preparation OR Flush Mount Installation Preparation for configuration details. Note the modified cutout height below.
- Model ZSC1202 cannot be installed with an accessory storage drawer. See installation preparation without an accessory storage drawer for this model.

PREPARE THE OPENING (cont.)

The Advantium/Convection 120V can be installed in combination with other Built-In appliances. Always follow each product's Installation Instructions to complete the installation.

Single Advantium/Convection 120V Installation:

Order a 30 wide single oven cabinet or cut the opening in a wall to the dimensions shown.

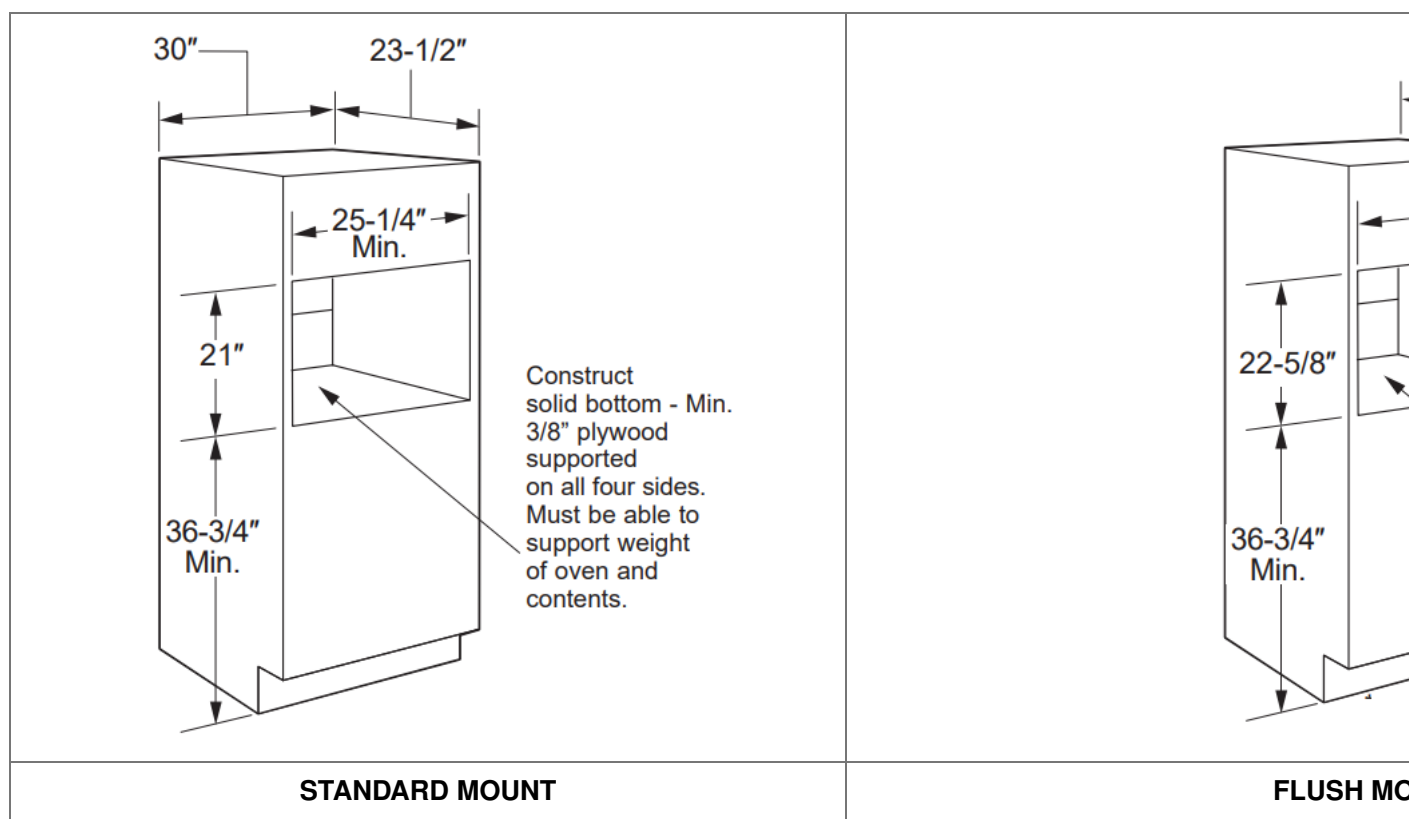

*See table for desired reveals on sides.

Dimension	1/8" Reveal	
K	30"	3

- For flush installation, make the bottom cleat height 3/4" when installed over a storage drawer.
- Allow the following clearances around the cutout on the front surface of the cabinet: 5/8" from the top, 2-3/8" from the side edges, and 3/4" from the bottom. (Note: these refer to minimum clearances required for installation and do not reflect actual product dimensions.)
- Oven overlaps will conceal cut edges on all sides of the opening.
- When installed over a single oven or a warming drawer, allow at least 2" between the two openings. This separation will provide clearance for bottom overlap of the Advantium/Convection 120V and the other appliance overlaps.
- The support must be level and rigidly mounted, flush with the bottom edge of the cutout.

REMOVE THE PACKAGING AND PARTS

- Remove all packing material and tape.
- Locate parts package containing mounting screws.
- Remove the oven from the carton. Do not lift unit by handle or conduit. Two people are required to lift this oven.
- Open the door and remove any packaging in oven.

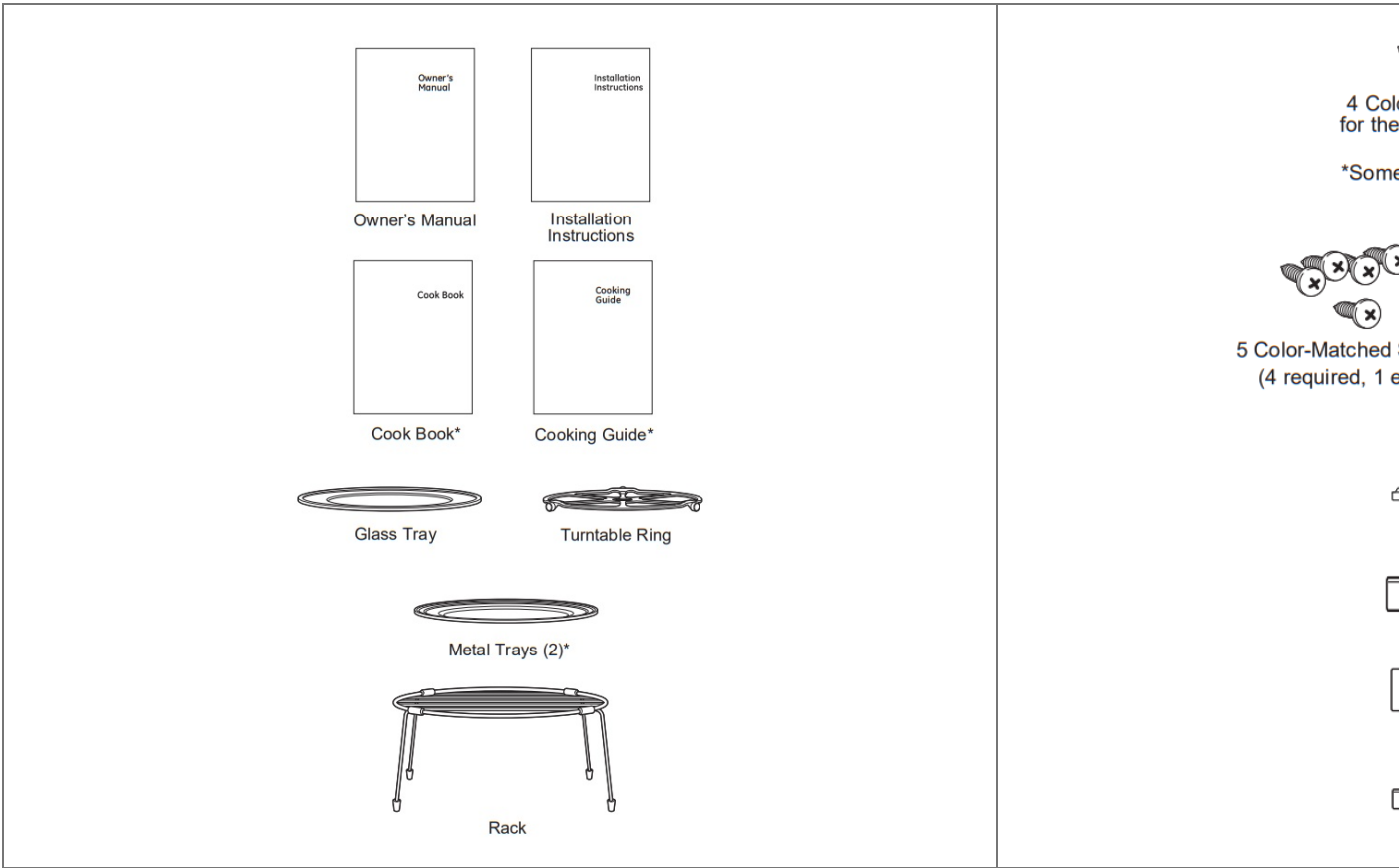

	Profile	Cafe	Monogram
Plastic Door Trim	X	X	X
Bottom Trim – Metal #1	X	X	–
Bottom Trim – Metal #2	–	–	X
Bottom Trim – Plastic	X	X	X

CAUTION If installing the Advantium/ Convection 120V Oven below 36, you must use the plastic bottom trim due to burn risk to children. The plastic trim acts as insulation and will help prevent burns to children from hot surfaces.

IMPORTANT: If installing the Advantium/ Convection 120V Oven with an accessory storage drawer, read the storage drawer assembly instructions to assemble the products together before proceeding to Step 2.

DOOR TRIM REMOVAL FOR ABOVE 36" INSTALLATION ONLY

If installing the Advantium/Convection 120V Oven above 36" from the floor, you may remove the plastic trim from the bottom of the door for esthetic purposes if desired.

CAUTION If installing the Advantium/ Convection 120V Oven below 36, do not remove the plastic door trim due to burn risk to children. The plastic trim acts as insulation and will help prevent burns to children from hot surfaces.

- If installing above 36", remove the 3 screws that secure the plastic trim to the bottom of the door.
- Discard plastic trim. Replace screws.

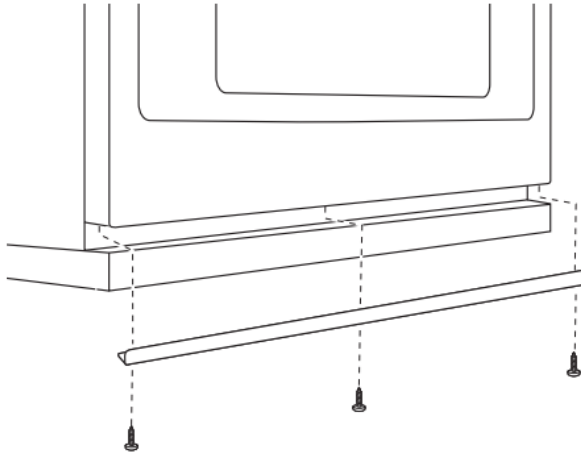

SLIDE THE OVEN INTO THE CUTOUT



CAUTION Two people are required to lift the oven into the opening. Grasp the bottom at front and rear. DO NOT USE THE HANDLE TO LIFT THE OVEN. DAMAGE WILL OCCUR.

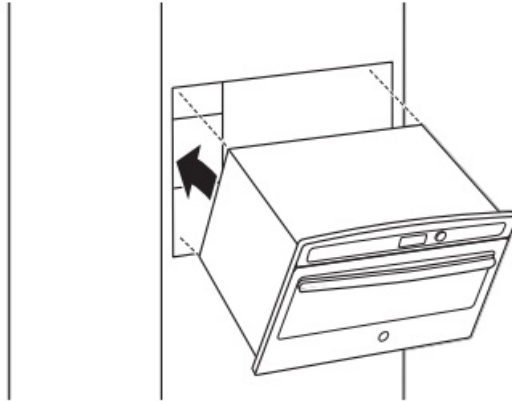

- Lift and hold the oven at the front of the opening. Hold the oven at an angle and plug in the power cord.
- Carefully, slide the oven into the cabinet part way. Leave the oven a few inches forward of the cabinet frame.
- Check to be sure the power cord is not trapped under the oven or along the sides of the oven.

INSTALL BOTTOM TRIM



CAUTION If installing the Advantium/ Convection 120V Oven below 36, you must use the plastic bottom trim due to burn risk to children. The plastic trim acts as insulation and will help prevent burns to children from hot surfaces.

NOTE: If installing the Advantium/Convection 120V Oven with an accessory storage drawer, the bottom trim is not required. Proceed to Step 5.

- Installation Below 36, align trim tabs on the plastic trim to slots in the bottom of the oven.

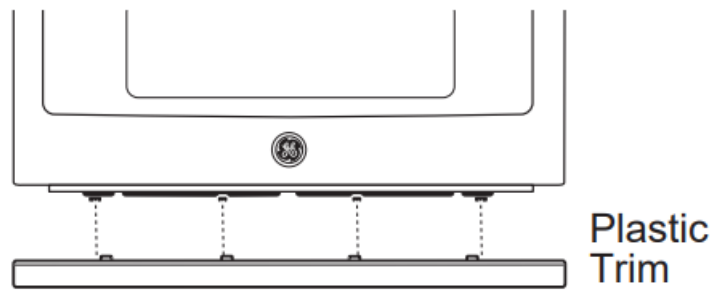

- Installation Above 36, align trim tabs on the plastic or metal trim to slots in the bottom of the oven.

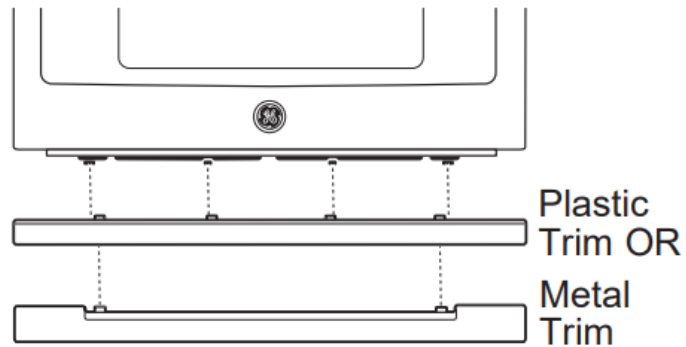

- Secure the bottom trim to the bottom of the oven using 3 screws provided.

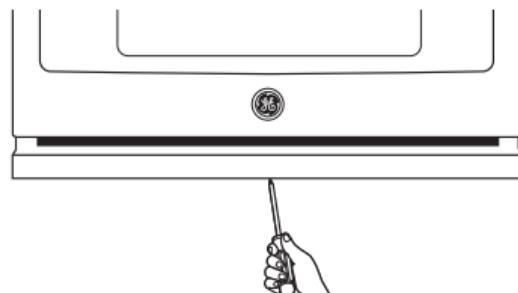

INSTALL BOTTOM TRIM WITH ACCESSORY DRAWER

If installing with an accessory drawer, see installation instructions that come with the accessory drawer.

INSTALL MOUNTING SCREWS

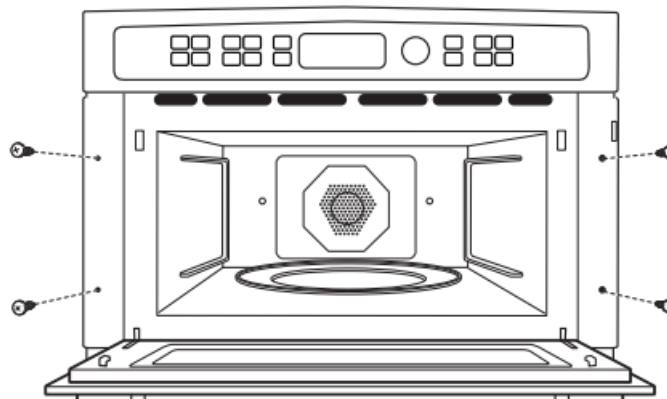

- Slide the oven the remaining way into the opening so that the side flanges and control panel are against the

cabinet frame. Make sure that the oven is centered in the opening.

- Open the door, place a turntable tray in the oven and make sure that the tray in the unit is level.
- Drill pilot holes through the side flanges.
- Drive the color-matched screws into the side flanges. It is recommended that the screws be hand tightened.

If installing oven with an accessory storage drawer:

- Open the drawer.
- Drill pilot holes through the side flanges.
- Drive color-matched screws into the side flanges. It is recommended that the screws be hand tightened.

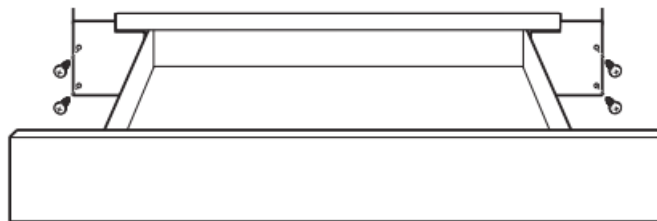

NOTE: If installing the Profile Advantium/ Convection 120V Oven with an accessory storage drawer, you must use the Under-the-Counter (UTC) mounting bracket for the drawer. If installing the Monogram Advantium/Convection integrated model ZSC1201 above 36, the UTC mounting bracket for the accessory storage drawer must be used.

FINALIZE INSTALLATION

- Turn power on at the source. The interior light should come on when the door is opened.
- Refer to Owner's Manual for operating instructions.

Notes

NOTE: While performing installations described in this book, safety glasses or goggles should be worn.

NOTE: Product improvement is a continuing endeavor at GE Appliances. Therefore, materials, appearance and specifications are subject to change without notice.

Printed in China

BEFORE YOU BEGIN

Read these instructions completely and carefully.

IMPORTANT — Save these instructions for local inspector's use.

IMPORTANT — Observe all governing codes and ordinances.

- Note to Installer — Be sure to leave these instructions with the Consumer.
- Note to Consumer — Keep these instructions with your Owner's Manual for future reference.
- Skill Level — Installation of this appliance requires basic mechanical and electrical skills.
- Completion Time — 1 Hour.
- Proper installation is the responsibility of the installer. Product failure due to improper installation is not covered under the warranty. See Owner's Manual for warranty information.

NOTE: This oven is only approved to be installed under the specific models as labeled on this unit.

 **IMPORTANT** — Use this oven only for its intended purpose. Never use the oven for warming or heating a room. Prolonged use of the oven without proper ventilation can be hazardous.

 **CAUTION** For personal safety, remove house fuse or oven circuit breaker before beginning installation to avoid severe or fatal shock injury.

 **CAUTION** For personal safety, the mounting surface must be capable of supporting the cabinet load, in addition to the added weight of the oven and drawer, plus additional oven loads.

 **CAUTION** If installing the Advantium/ Convection 120V Oven below 36, you must use the plastic bottom trim due to burn risk to children. The plastic trim acts as insulation and will help prevent burns to children from hot surfaces.

MODELS AVAILABLE

Profile Models:

PSB9120WW – White*

PSB9120BB – Black

PSB9120SS – Stainless Steel

PSB9120ES – Slate

PWB7030SL – Stainless Steel

PWB7030EL – Slate

PSB9120BL – Black Stainless Steel

Monogram Models:

ZSC1201SS – Stainless Steel

ZSC1202SS – Stainless Steel**

*No color-matched drawer available for this model.

**This unit cannot be installed with an accessory storage drawer.



MFL59060930_00

31-2000001-7
12-21 GEA

GE is a trademark of the General Electric Company. Manufactured under trademark license.
For a Spanish version of this manual, visit our Website at GEAppliances.com.

Documents / Resources

Installation
Instructions

Advantium® 120V
Built-In SpeedCook
and 120V Built-In
Convection Ovens



Model:
CSB9120, PSB9120, ZSC1201, ZSC1202, CWB7030, PWB7030, CWB713

[GE Profile CSB9120 Advantium 120V Built-In SpeedCook and 120V Built-In Convection Ovens](#) [pdf] Instruction Manual

CSB9120, PSB9120, ZSC1201, ZSC1202, CWB7030, PWB7030, CWB713, Advantium 120V Built-In SpeedCook and 120V Built-In Convection Ovens