



GE imagination GU10 Precision Colours Bulb User Guide

[Home](#) » [GE imagination](#) » GE imagination GU10 Precision Colours Bulb User Guide 

Contents

- [1 GE imagination GU10 Precision Colours Bulb](#)
- [2 Seamless Setup](#)
- [3 Control your lights with your voice](#)
- [4 Troubleshooting](#)
- [5 Documents / Resources](#)
- [6 Related Posts](#)



GE imagination GU10 Precision Colours Bulb



Seamless Setup



1. Plug in your Google Nest device (smart speaker)
2. In the same room, fit the bulb and turn on the light. The light will start blinking and waiting to be added in Google Home App.



- Download the Google Home App and follow the prompts to easily set up

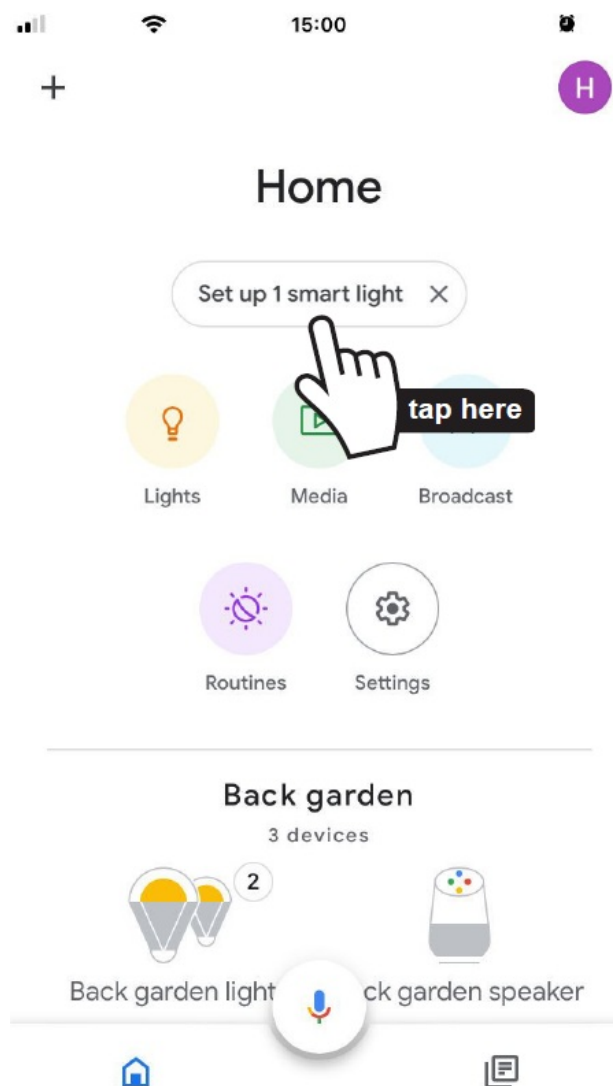

- Set up smart light tap



15:45



Pick a smart light to set up

The smart light that you pick will blink slowly



GE Light GU10 2f07
GE Light GU10



tap here

Light didn't blink

Don't see my light

[Not now](#)

Set Up

- Pick smart light to set up

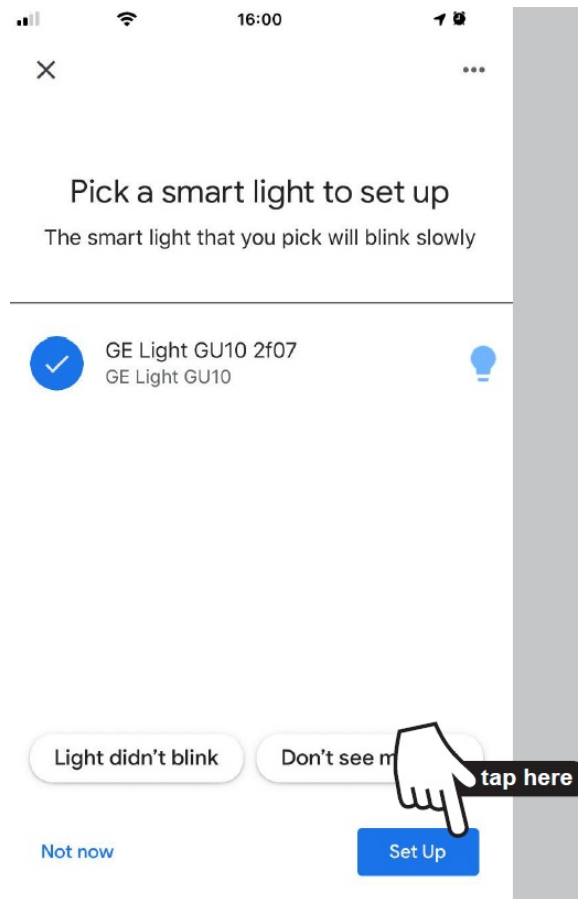

- Select smart light and tap Set up



16:09



Where is this device?

Choose a location for your GE Light GU10.
This will help you organise your devices.

My rooms

Back garden

Back garden 2

Den



Kitchen

Test room



tap here

Next

- Choose room and tap Next

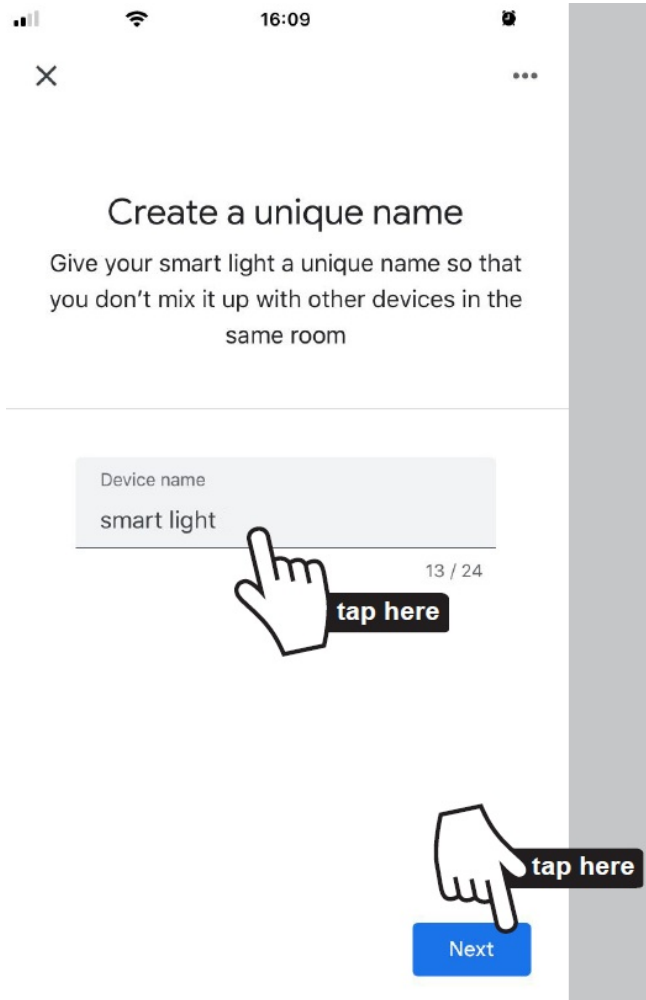

Create a unique name and tap Next



16:14



smart light is ready

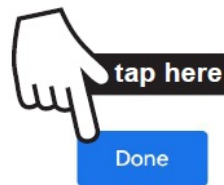

- Your Light is now ready and tap Done

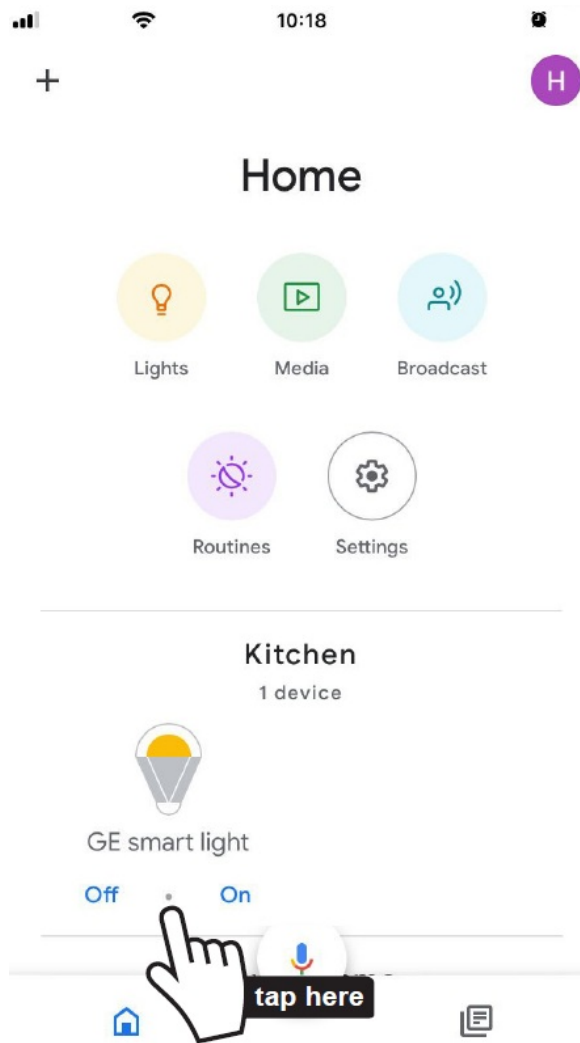

Now your light and room is on App and ready to be controlled

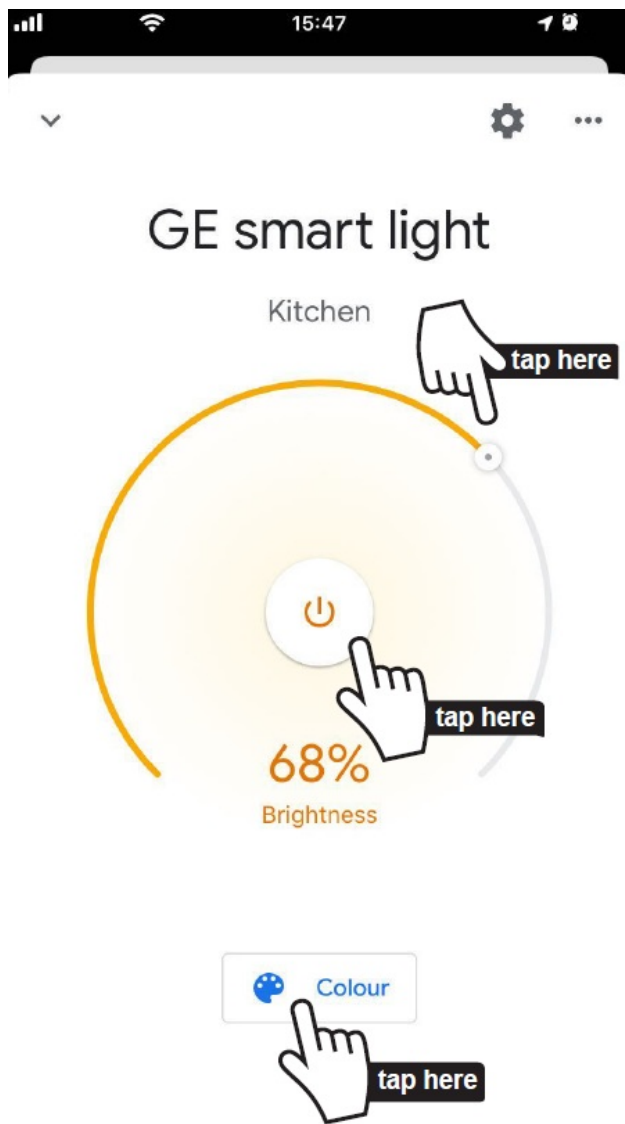

Control your light, power On & Off, dim your light Down & Up, change colors

Control your lights with your voice



- Support your circadian rhythm sleep / wake cycle
- Control your lights with your voice



- Set up Routines for your lights
- Create ambience in your home

- “Hey Google, turn on the light”

Explore Google Home App with Routines

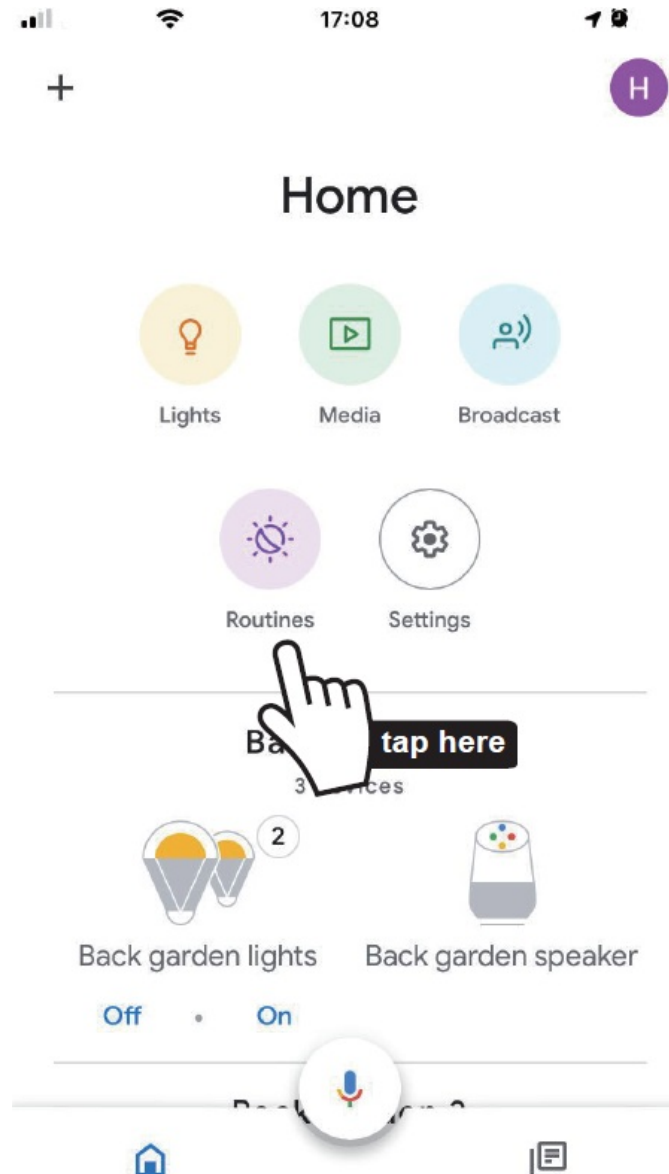

Troubleshooting

- **Problem:** If there's no blinking from the light after powering on.
- **Solution:** Please follow below Factory Reset process.

Turn power On & Off 5 times then leave it on, each time using light switch:

1. On & Off,
2. On & Off,
3. On & Off,
4. On & Off,
5. On & Off, then On again

the light should now start to blink

- After performing the above On & Off-cycle, if the light does not blink, please redo the above On & Off-cycle (factory reset) again.

Confirm the light blinks and go to step

- **Problem:** The light can be added successfully, but cannot be controlled.
- **Solution:** Please follow below to reboot the Google Home.

- Tap the to reboot.

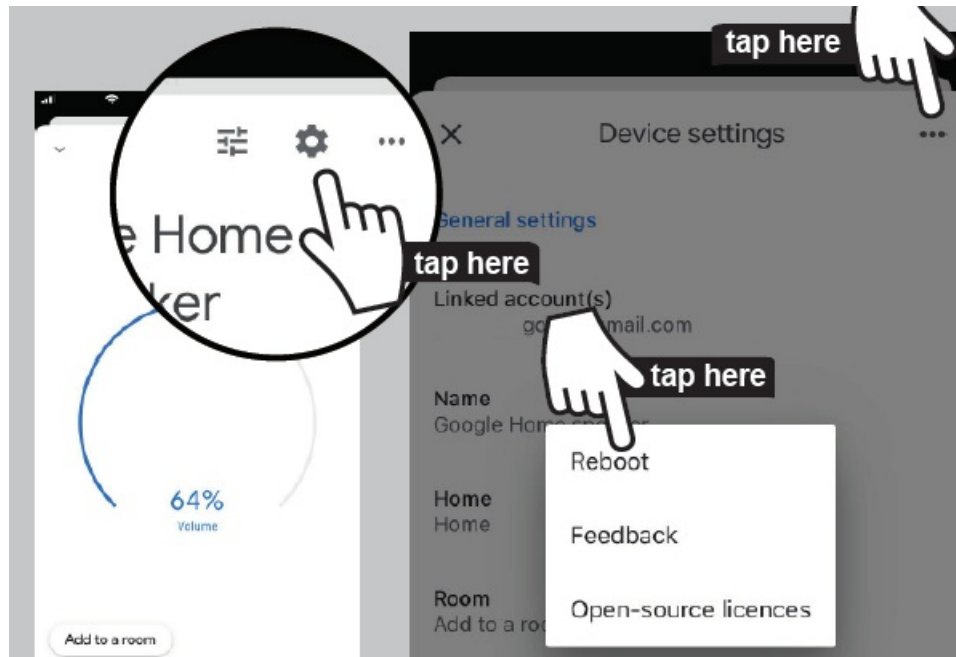



This GE imagine connected smart home LED bulb features and controls are performed via the App or Voice only

- Brightness or dimming controls can only be performed via the App or Voice as outlined in the quick start guide supplied with your bulb.
- **Note:** This smart LED bulb is not compatible with the use of any external dimmer.
- Use in Dry Locations only Australian / New Zealand Regulatory Compliance Mark and Responsible supplier number E6

GE is a trademark of General Electric Company and is under license by Light Source Solutions and Light Source Solutions New Zealand Ltd. of 140 Fulton Drive Derrimut Vic 3026 Australia.

- Thank you for choosing GE to imagine.
- Enjoy your new smart lighting experience

Documents / Resources

  <p>Get started with your new GE imagine Lights</p> 	<p>GE imagination GU10 Precision Colours Bulb [pdf] User Guide GU10 Precision Colours Bulb, GU10, Precision Colours Bulb</p>
-----------------------------------------------------------------------------------------------------------------------------------------------------------------------------------------------------------------------------------------------------------------------------------------------------------------	--------------------------------------------------------------------------------------------------------------------------------------------------

Manuals+