



# GE current IND402 LBR Series Lumination LED Luminaire Installation Guide

[Home](#) » [GE current](#) » GE current IND402 LBR Series Lumination LED Luminaire Installation Guide 

## Contents

- [1 GE current IND402 LBR Series Lumination LED Luminaire](#)
- [2 Specifications](#)
- [3 Wiring Diagrams](#)
- [4 Driver Replacement Steps](#)
- [5 Documents / Resources](#)
  - [5.1 References](#)
- [6 Related Posts](#)

## GE current

### GE current IND402 LBR Series Lumination LED Luminaire



**WARNING**

## **RISK OF ELECTRIC SHOCK**

- Turn power off before inspection, installation or removal.
- Properly ground electrical enclosure.

## **RISK OF FIRE**

- Follow all NEC and local codes
- Use only UL-approved wire for input/output connections. Only use size 18 AWG (0.75mm<sup>2</sup>).

## **Save These Instructions**

Use only in the manner intended by the manufacturer. If you have any questions, contact the manufacturer.

## **Components Supplied**

- Driver of luminaire

## **Tools and Components Required**

- 1/4" hex head screwdriver
- UL listed conduit connections per NEC/CEC for nominal conduit trades sizes 1/2" or 3/4"
- UL-recognized wire connectors

## **Prepare Electrical Wiring**

### **Electrical Requirements**

- The LED luminaire must be connected to the mains supply according to its ratings on the product label.
- Class 1 wiring should be in accordance with NEC.

### **Grounding Instructions**

- The grounding and bonding of the overall system shall be done in accordance to local electric code of the country where the luminaire is installed.

## **Specifications**

## **Wiring Diagrams**

### **1-10V Dimming: Standard Version**

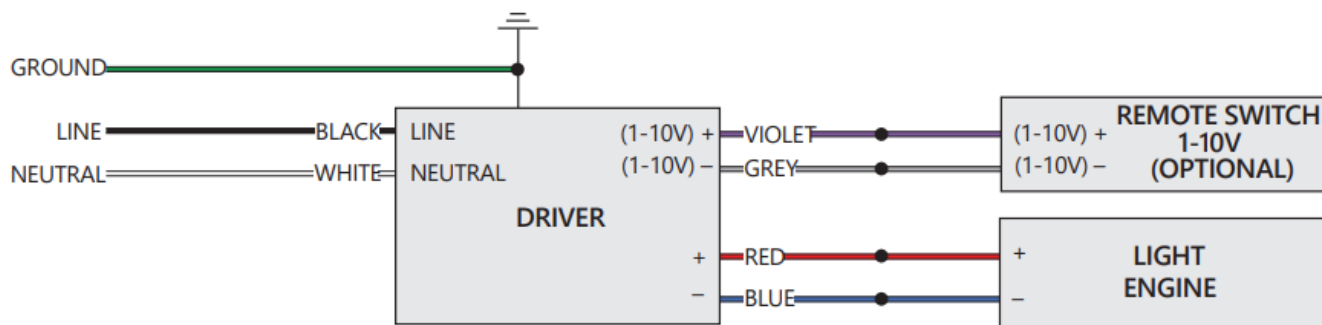

### 1-10V Dimming: 347V Version

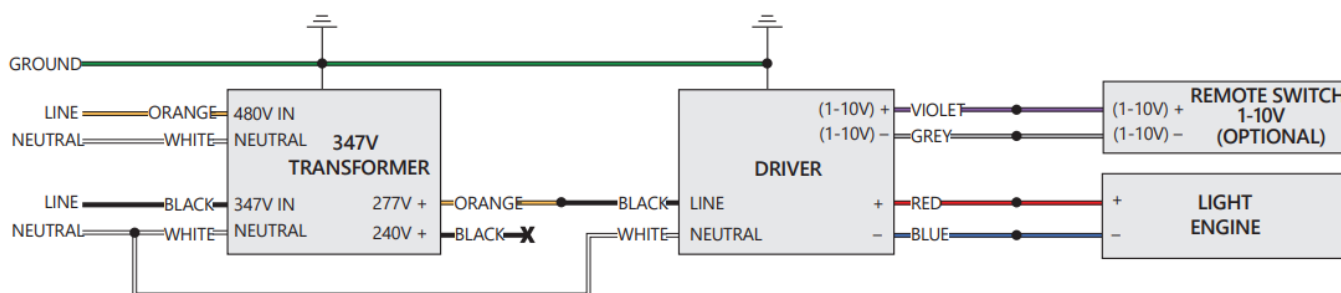

### Driver Replacement Steps

**NOTE:** The following steps depict the 22 Series luminaire. However, the procedure is the same for the 14 and 24 Series fixtures.

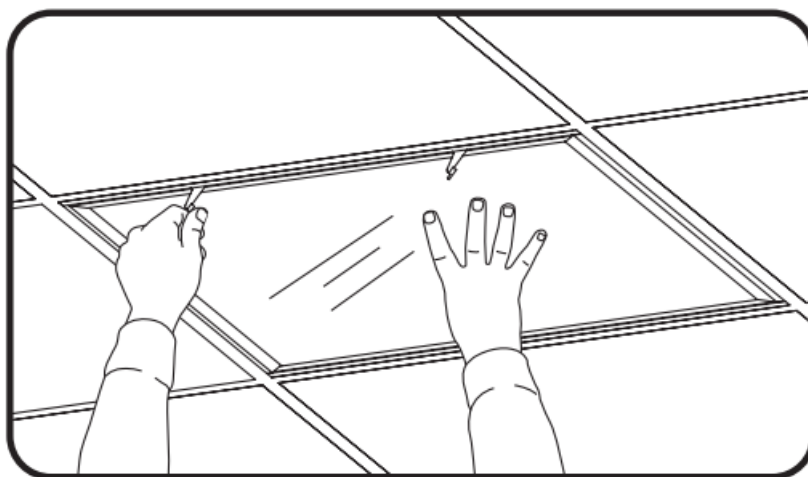

1. Rotate latches to unlock the front bezel.

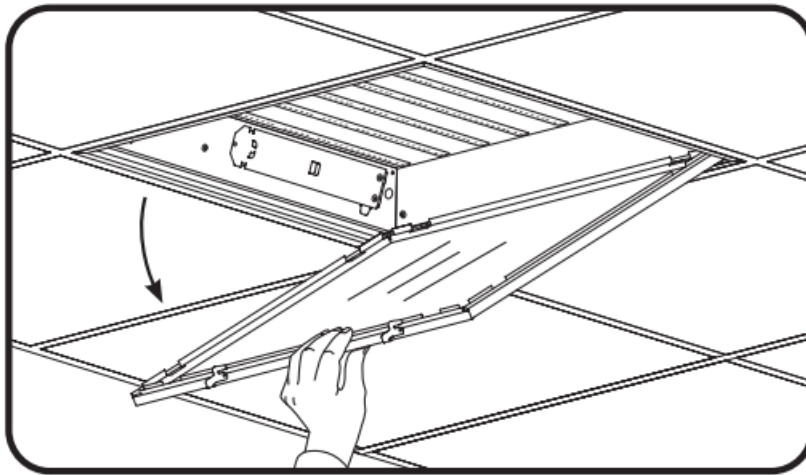

2. Swing down the panel and lift off the front bezel.

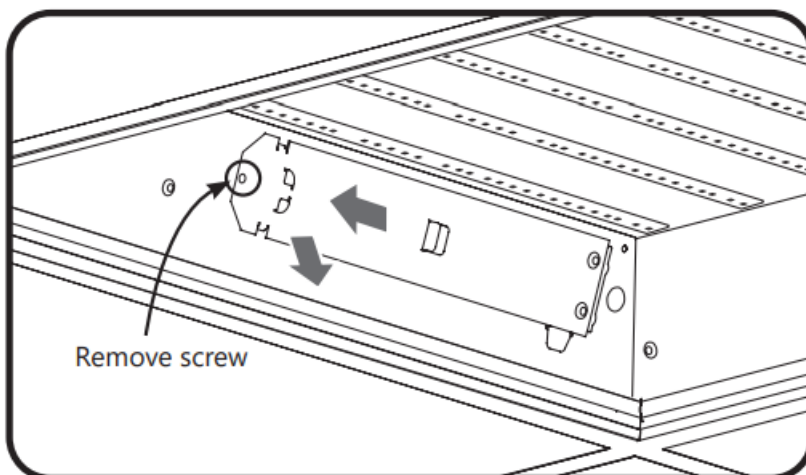

3. The unfastened screw holding driver plate. Grab the tab and shift 3 plates to the left and pull outward.

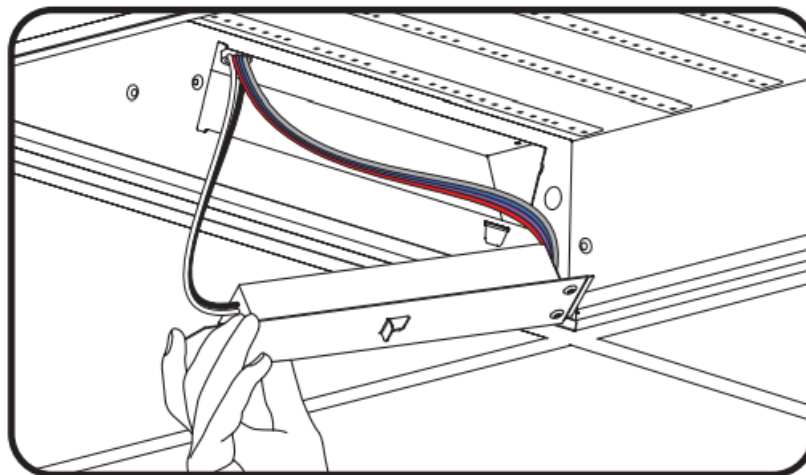

4. Remove driver plate.

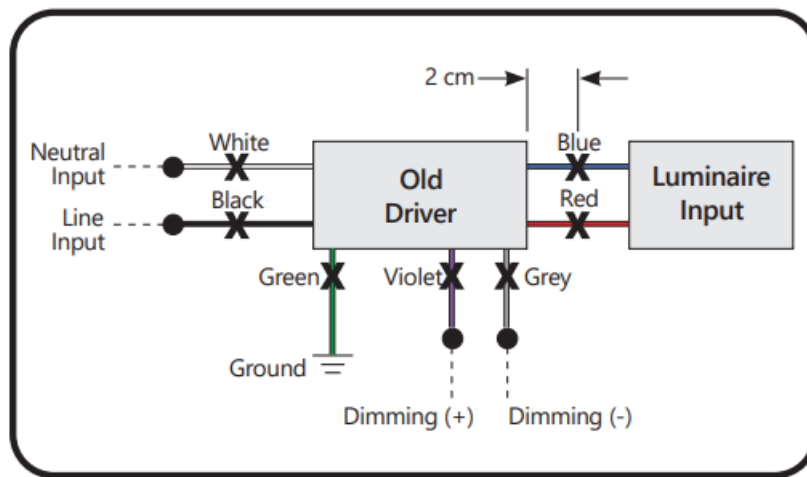

- First, disconnect the driver from the luminaire by cutting the wires at a distance of 2 cm (0.75 in.) from the old driver. Then, unscrew the screws and star washers that attach the driver to the luminaire and remove the old driver.

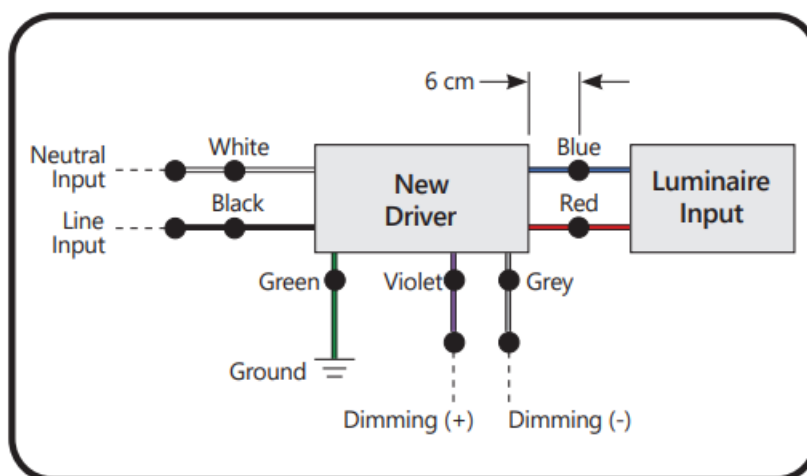

- The length of wires from the new driver should be no less than 6 cm (2.36 in.). Reattach the new driver in the same location as the old driver using star washers and screws. Strip off 10 mm (0.4 in.) from all wires and reconnect the new driver to the luminaire with certified connectors. Wires with the same color should be connected together.

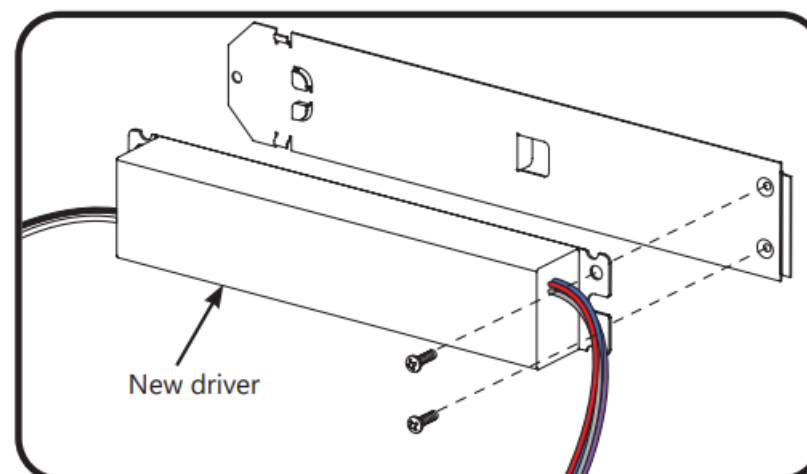

- Reattach new driver to plate.

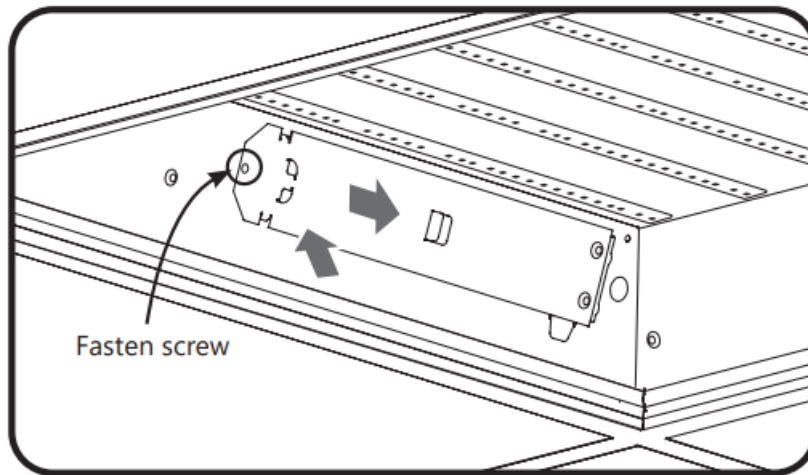

8. Push the plate into the opening and shift to the right. Fasten 8 screws of the driver plate to the housing.

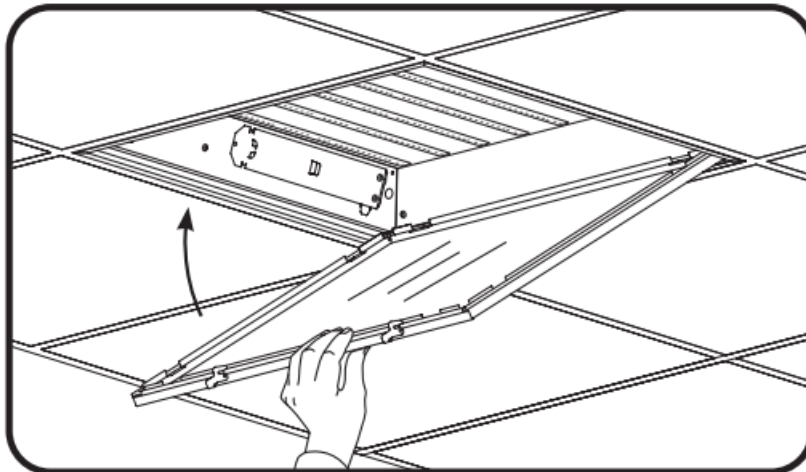

9. Hang the panel on its hinges and swing it up into place.

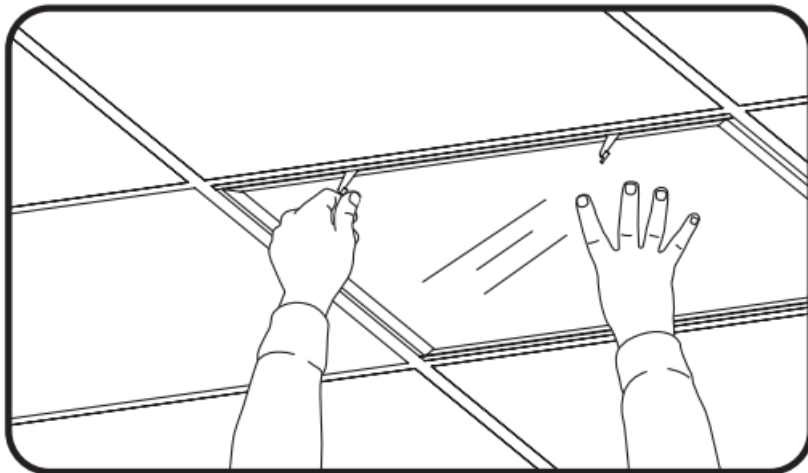

10. Rotate latches to lock the front bezel.

This device complies with Part 15 of the FCC Rules. Operation is subject to the following two conditions:

1. This device may not cause harmful interference, and
2. this device must accept any interference received, including interference that may cause undesired operation.

**CAN ICES-005 (A) / NMB-005 (A).**

**Note:** This equipment has been tested and found to comply with the limits for a Class A digital device, pursuant to part 15 of the FCC Rules. These limits are designed to provide reasonable protection against harmful interference when the equipment is operated in a commercial environment. This equipment generates, uses, and can radiate radio frequency energy and, if not installed and used in accordance with the instruction manual, may cause harmful interference to radio communications. Operation of this equipment in a residential area is likely to cause

harmful interference in which case the user will be required to correct the interference at his own expense.

[www.gecurrent.com](http://www.gecurrent.com)

© 2021 Current Lighting Solutions, LLC. All rights reserved. GE and the GE monogram are trademarks of the General Electric Company and are used under license. Information provided is subject to change without notice. All values are designed or typical values when measured under laboratory conditions. IND402 (Rev 04/02/21)

**Documents / Resources**

	<p><a href="#">GE current IND402 LBR Series Lumination LED Luminaire</a> [pdf] Installation Guide IND402 LBR Series Lumination LED Luminaire, IND402, LBR Series Lumination LED Luminaire, Lumination LED Luminaire, LED Luminaire, Luminaire</p>
---	---

**References**

- [C Commercial Lighting and Lighting Controls | Current - GLI Brands](#)