



GE current HORT171 Arize Factor Horticulture LED Lighting System Installation Guide

[Home](#) » [GE current](#) » GE current HORT171 Arize Factor Horticulture LED Lighting System Installation Guide 



Contents

- 1 [GE current HORT171 Arize Factor Horticulture LED Lighting System Installation Guide](#)
- 2 [Components Provided](#)
- 3 [Lightbar Specifications](#)
- 4 [LED Driver Specifications](#)
- 5 [Accessories](#)
- 6 [Interconnection Cable Specifications](#)
- 7 [Universal Cable Mount](#)
- 8 [Mounting Distance](#)
- 9 [1 Installation of the Lightbar](#)
- 10 [2 Installation of the Driver](#)
- 11 [3 Electrical Connections](#)
- 12 [4 Connecting Wired Dimming \(Optional\)](#)
- 13 [Documents / Resources](#)
 - 13.1 [References](#)
- 14 [Related Posts](#)

GE current HORT171 Arize Factor Horticulture LED Lighting System Installation Guide

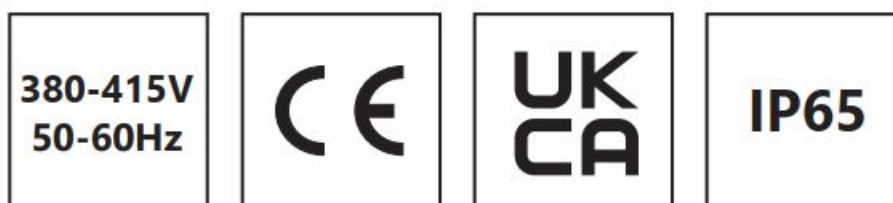



WARNING **RISK OF ELECTRIC SHOCK**

- Turn power off before inspection, installation or removal.
- Properly ground electrical enclosure.

RISK OF FIRE

- Follow all IEC and local building codes.
- Use only IEC approved wire for input/output connections. Minimum size 3G 0.75mm².



The LED luminaire must be connected to the mains supply according to its ratings on the product label.

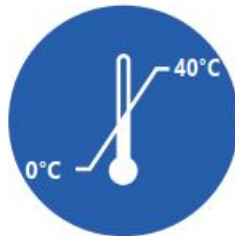

ML300



ML900



CAUTION

- Do not operate the product with damaged parts.
- Turn off power before inspection, installation or removal.
- Luminaire may fall down if not installed properly.
- Wear work gloves to prevent dirt and oil from being transferred to the luminaire.
- Not for direct exposure to the weather.
- To ensure the product warranty is valid, please ensure all installation instructions and environmental conditions for storage and operation are complied with.
- The light source of this luminaire is not replaceable; when the light source reaches its end of life the whole luminaire shall be replaced.
- Use only in the manner intended by the manufacturer. If you have any questions, contact the manufacturer.
- For safe operation, and to maximize the longevity of the luminaire; ensure that the lightbar and driver are clean and free of dirt, dust, oil, or any other debris.
- Do not apply any kind of film on the lens or otherwise cover the driver or light engine in any way.
- The external flexible cable or cord of this luminaire cannot be replaced; if the cord is damaged, the luminaire shall be destroyed.

Components Provided

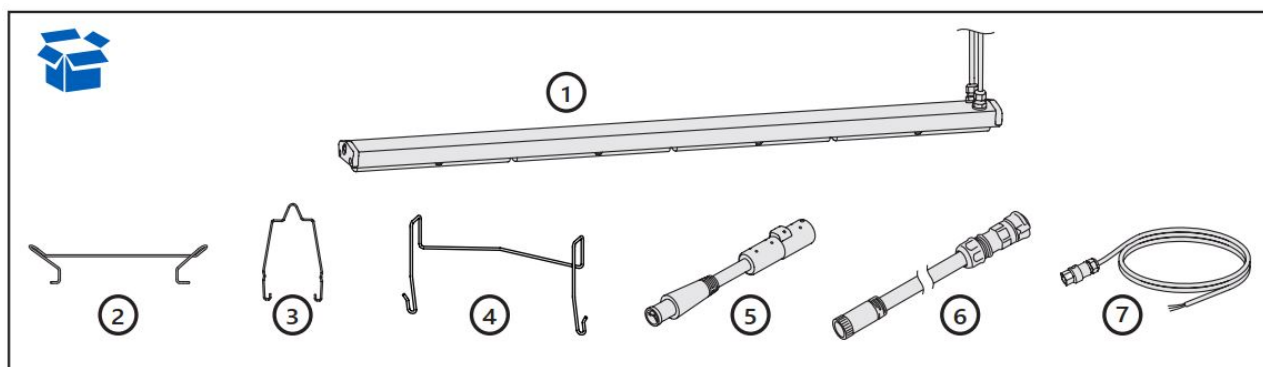

1. ML series lightbar (see Lightbar Specifications below)
2. Driver bracket (93155678)
3. Suspended mount wireform support (93153914)
4. Factor driver hanger (93153268)
5. Shorting cap (95050824)
6. DC adapter cable (93154527)
7. 1 meter AC input leader cable (93149021)

Lightbar Specifications

Product	Detailed Description	Weight	Series Load per Driver	System Watts per Lightbar
GEHF-HPKRW1	ML900, PKR	2.6 kg (5.72 lbs)	2	319W
GEHF-HPKBW1	ML900, PKB	2.6 kg (5.72 lbs)	2	313W
GEHF-HPKFW1	ML900, PKF	2.6 kg (5.72 lbs)	2	313W
GEHF-HBRIW1	ML900, BRI	2.6 kg (5.72 lbs)	2	319W
GEHF-HBRVW1	ML900, BRV	2.6 kg (5.72 lbs)	2	316W
GEHF-MPKRW1	ML300, PKR	2.6 kg (5.72 lbs)	4, 5, or 6	104W
GEHF-MPKBW1	ML300, PKB	2.6 kg (5.72 lbs)	4, 5, or 6	104W
GEHF-MPKFW1	ML300, PKF	2.6 kg (5.72 lbs)	4, 5, or 6	106W
GEHF-MBRIW1	ML300, BRI	2.6 kg (5.72 lbs)	4, 5, or 6	106W
GEHF-MBRVW1	ML300, BRV	2.6 kg (5.72 lbs)	4, 5, or 6	106W
GEHF-EPKBW1	ML200, PKB	2.6 kg (5.72 lbs)	5, 6, 7, or 8	82W

LED Driver Specifications

Product Code	Detailed Description	Weight	Input Ratings
			Voltage
GEPSC210-600G-AGJEU-D1XA1	Lightbar Driver	3.2 kg (7 lbs)	380-415 VAC

Accessories

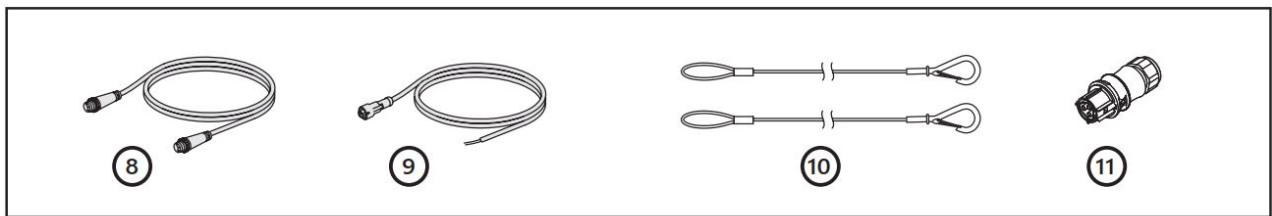

- ⑧ *Optional:* Interconnection cable (see table below)
- ⑨ Dimming cable, 914 mm, UL and CE (93149020)
- ⑩ Universal cable mount (see table below)
- ⑪ Field Installable connector (93153189)

Interconnection Cable Specifications

Product Code	Detailed Description	Weight
93118693	900 mm (36 in) Extension Cable	0.2 kg (0.44 lbs)
93067609	1500mm (60 in) Extension Cable	0.31 kg (0.68 lbs)
93067610	3000mm (118 in) Extension Cable	0.59 kg (1.3 lbs)

Universal Cable Mount

Product Code	Detailed Description	Weight
93153270	457 mm (18 in) universal cable	0.04 kg (0.09 lbs)
93154044	610 mm (24 in) universal cable	0.05 kg (0.11 lbs)
93154043	914 mm (36 in) universal cable	0.06 kg (0.13 lbs)
93153281	1524 mm (60 in) universal cable	0.1 kg (0.22 lbs)

Mounting Distance

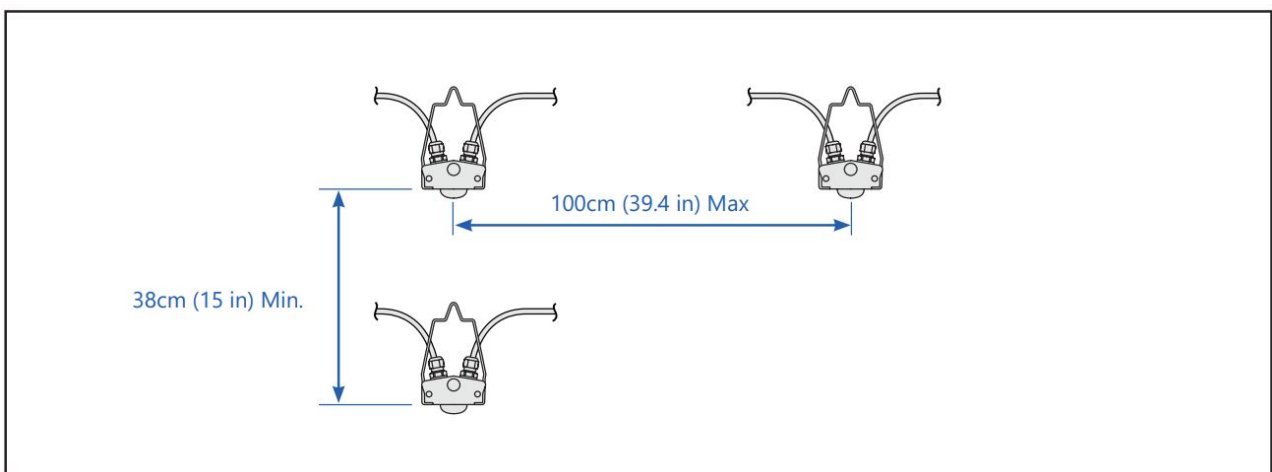

1 Installation of the Lightbar

1.1 Suspended Mount Installation Steps

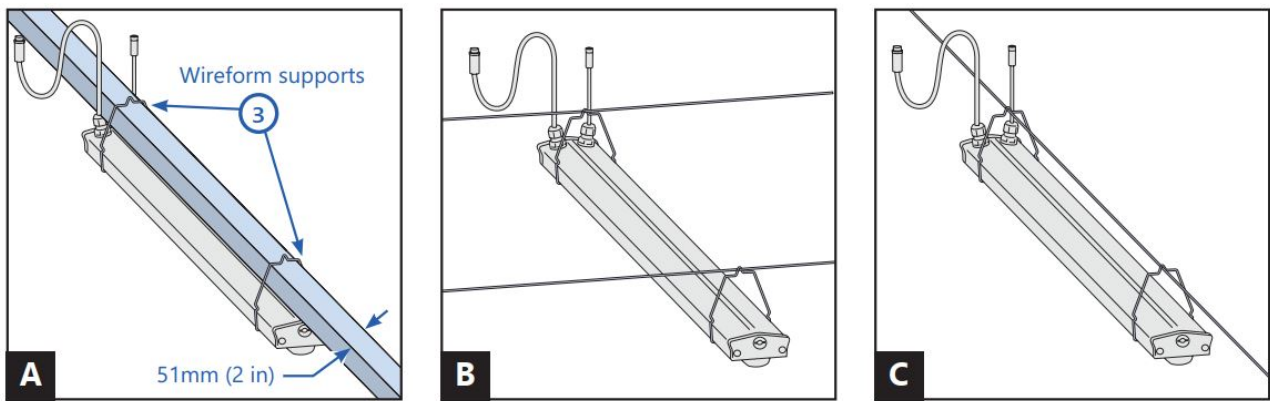

Using two wireform supports (GEMB-BANE), the ML Series lightbar can be suspended on a support structure (A) or on cables as shown above (B and C).

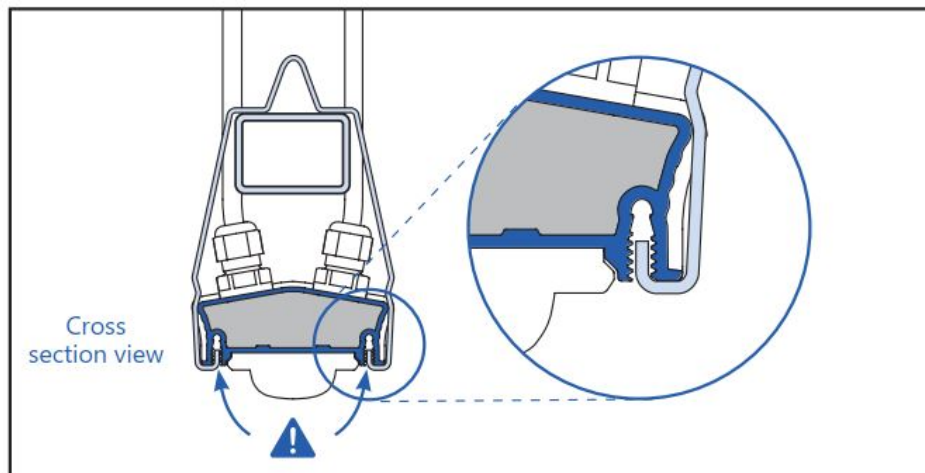

Attach wireform supports by pushing up into the slots on the underside of the lightbar.

2 Installation of the Driver

2.1 Installation of Standard Hanger Bracket

Standard hanger bracket fits over a 41 mm Unistrut. If not preassembled, install bracket onto driver.

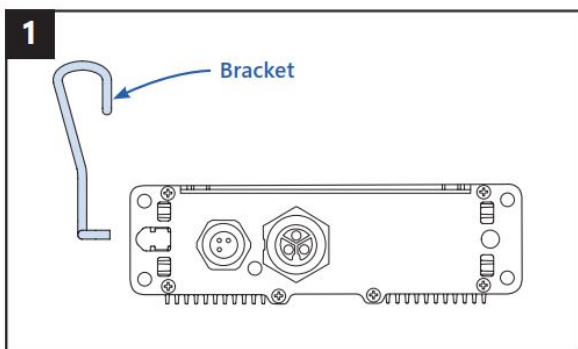

Orient driver perpendicular to the bracket.

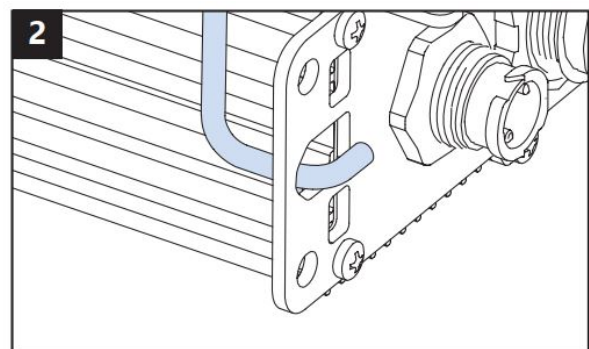

Ensure first end of bracket hook is lined up with oval mounting hole of driver.

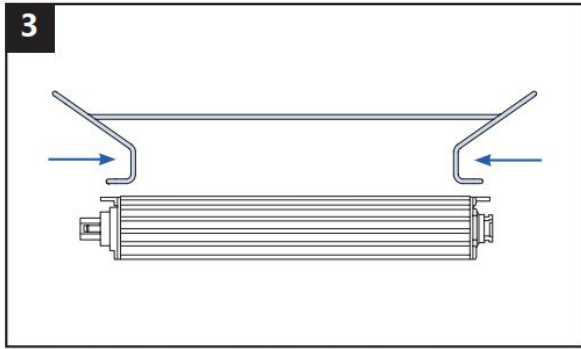

Squeeze bracket arms together & slide hook into first driver mounting hole.

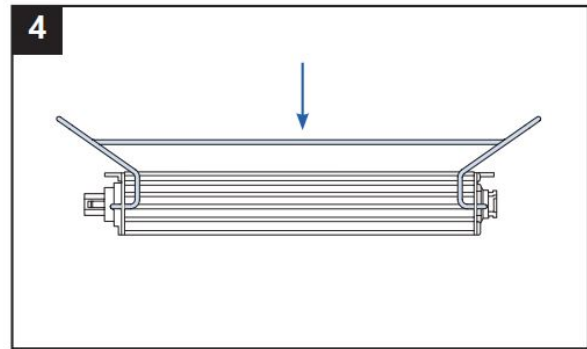

Repeat on opposite driver mounting hole.

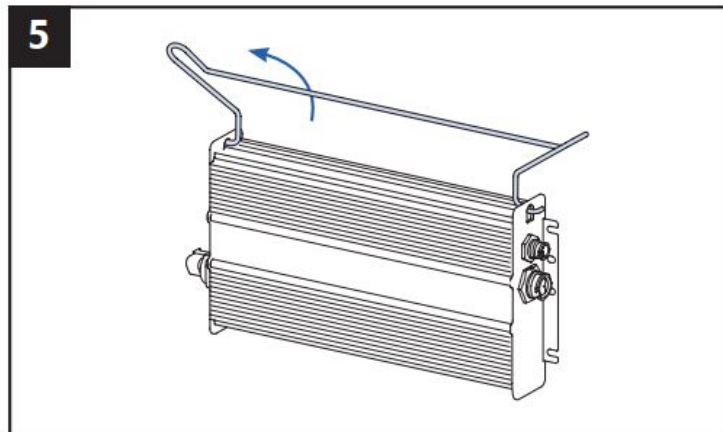

Let driver swing free upright & ensure hooks on both sides are correctly engaged.

2.2 Installation with Offset Hanger

Offset hanger used with the standard hanger bracket to clear the bottom of the 41 mm Unistrut.

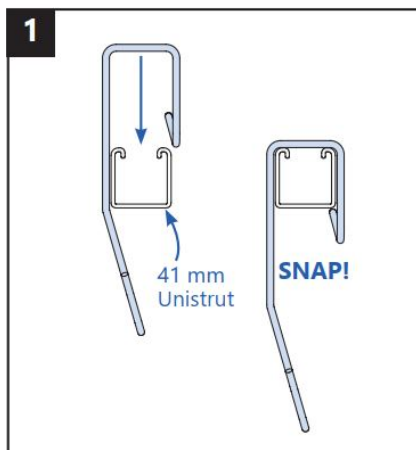

Place offset hanger over Unistrut and push down until it snaps into place.

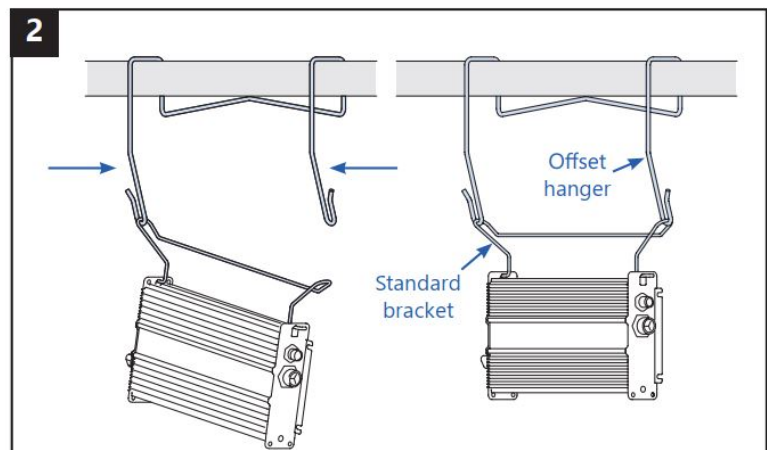

Hang driver bracket from one hook, then hang other driver bracket end by pressing hanger arms together.

2.3 Installation with Universal Cables

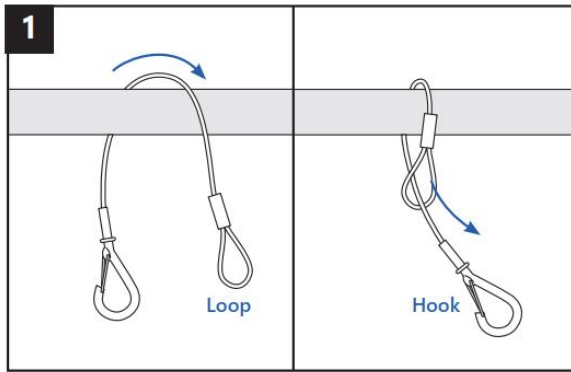

Wrap loop end of cable over structural member.
Insert hook through loop end.

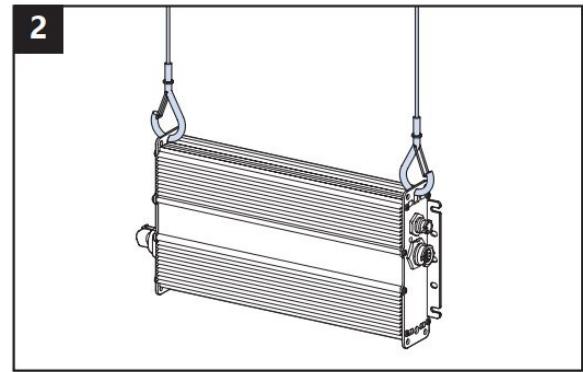

Attach hooks to oval driver mounting holes.
Ensure hook gate is closed.



ATTENTION: Before attempting to install units or maintenance, ensure power is off.

3 Electrical Connections

3.1 Shorting Cap Installation



RISK OF SAFETY AND PRODUCT DAMAGE. DO NOT MAKE OR
BREAK ELECTRICAL CONNECTION WHILE POWER IS APPLIED.

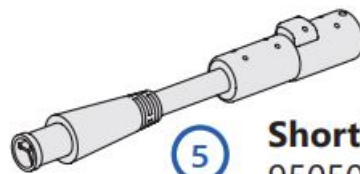

5

Shorting Cap
95050824

ML900 Electrical Connection: 2 Lightbars only

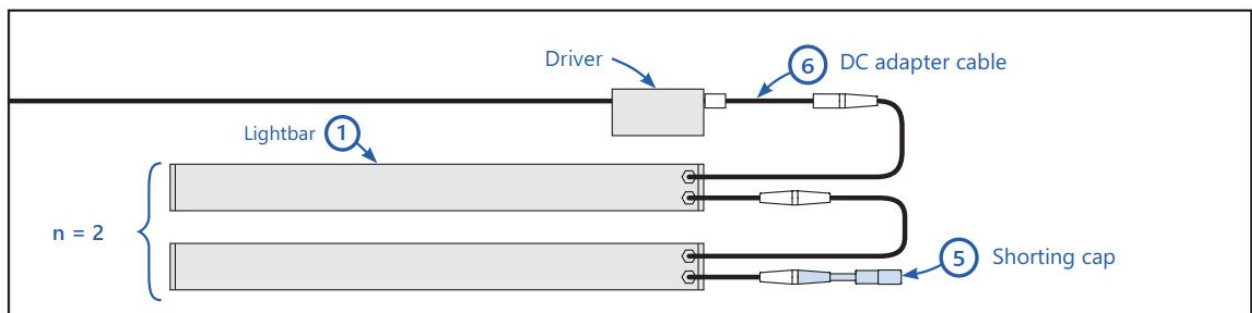

ML 300 Electrical Connection: 4 to 8 Lightbars only

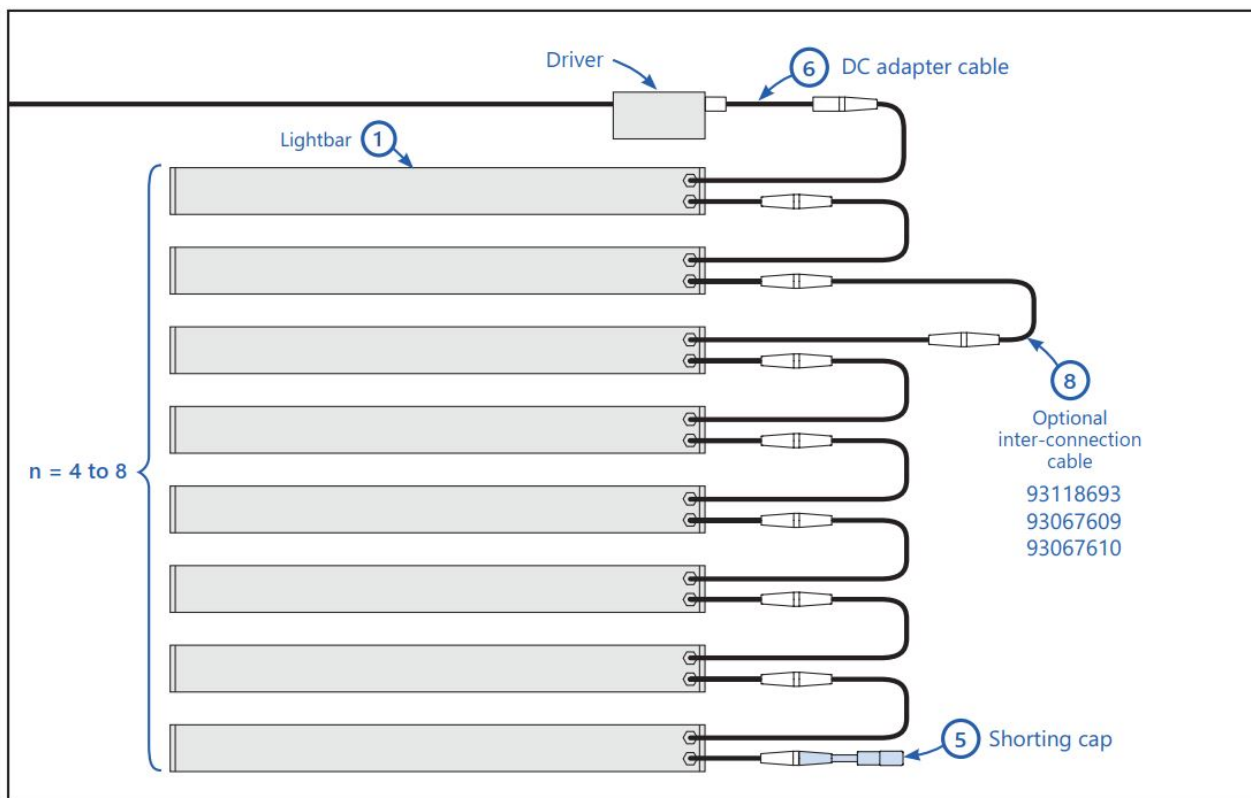

3.2 Connect the Driver Output to Light Module

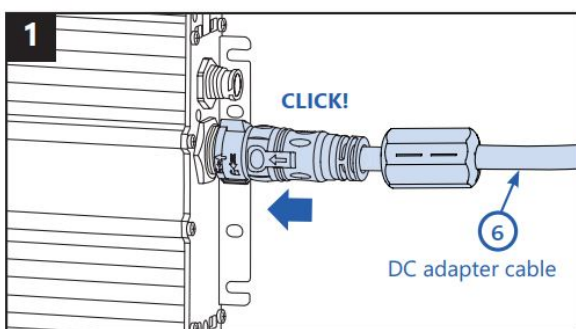
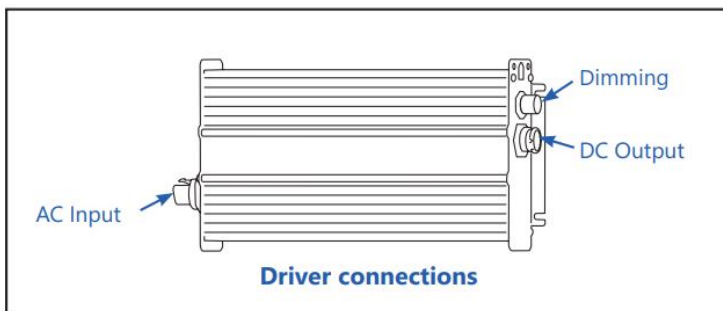

Align keying features of larger output connector on driver with connector on light module cable. Push connectors together until the lock ring has snapped into place and a click is heard.

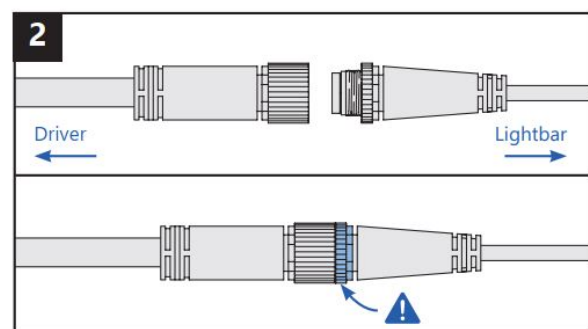

Connect other end of cable to the first lightbar or extension cable.

! Be sure to tighten collar.

NOTE: To disassemble connectors, turn locking ring 1/8 of a turn counter-clockwise and separate connectors.

NOTE: Use 900 mm or 1500 mm extension cables if driver and lightbar are more than 0.6 m apart.

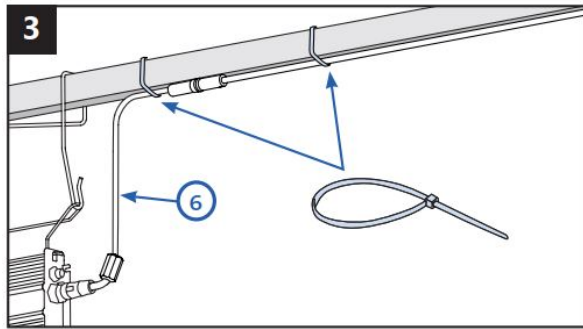

Recommended: secure lightbar cable.

3.3.1 Connect the Driver Input

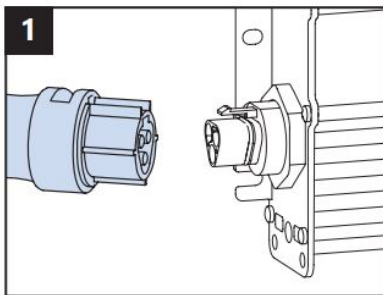

Align keying features on driver with connector on the selected leader cable.

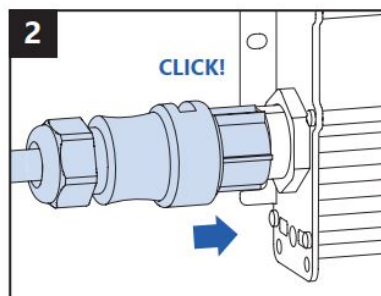

Push connectors together until a click is heard.

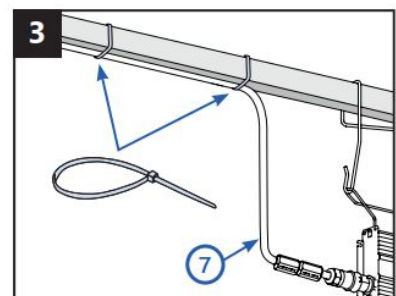

Secure AC input leader cable, away from driver and light module.

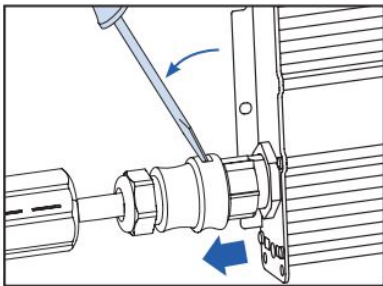

NOTE: To disassemble connectors, insert and twist a small blade screwdriver and then separate connectors.

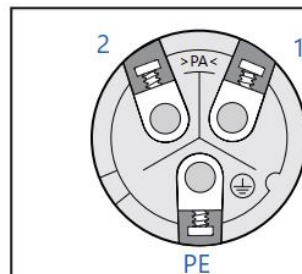

Connector pin-out

Pin	Line-to-Line Voltage			Line-to-Neutral Voltage		
1	L2	L1	L1	L1	L2	L3
2	L3	L2	L3	N	N	N
PE	PE	PE	PE	PE	PE	PE

L=Line / N=Neutral / PE=Protective Earth

3.3.2 Using Custom AC Inputs

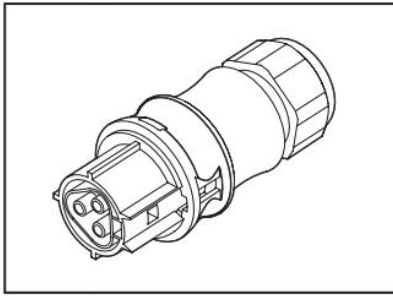

If you choose to use your own custom AC input connection, use a Wieland RST20i3 green connector (96.031.4055.7 OR 96.031.4155.7 OR 96.031.0055.7 OR 96.031.1055.7) and plug into the male AC connector of the driver.

3.3.3 Connect Bead to AC Input Leader Cable

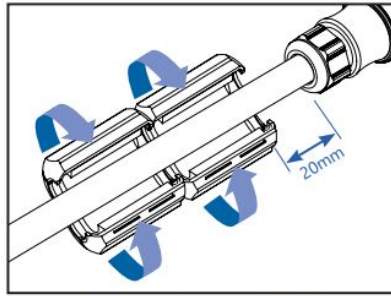

Connect 2 beads provided, the first bead should be no more than 20mm from input connector.

3.3.4 Connecting Driver to AC Line

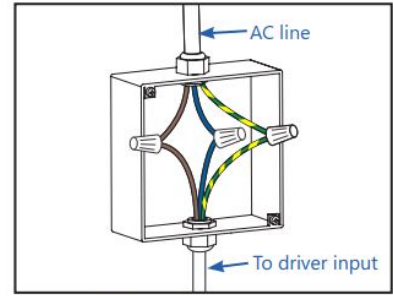

Connect the yellow/green wire to the incoming ground conductor. Connect the brown wire to Line 1 and blue wires to Neutral or Line 2 of the incoming AC line.

3.4 Connection Schematic

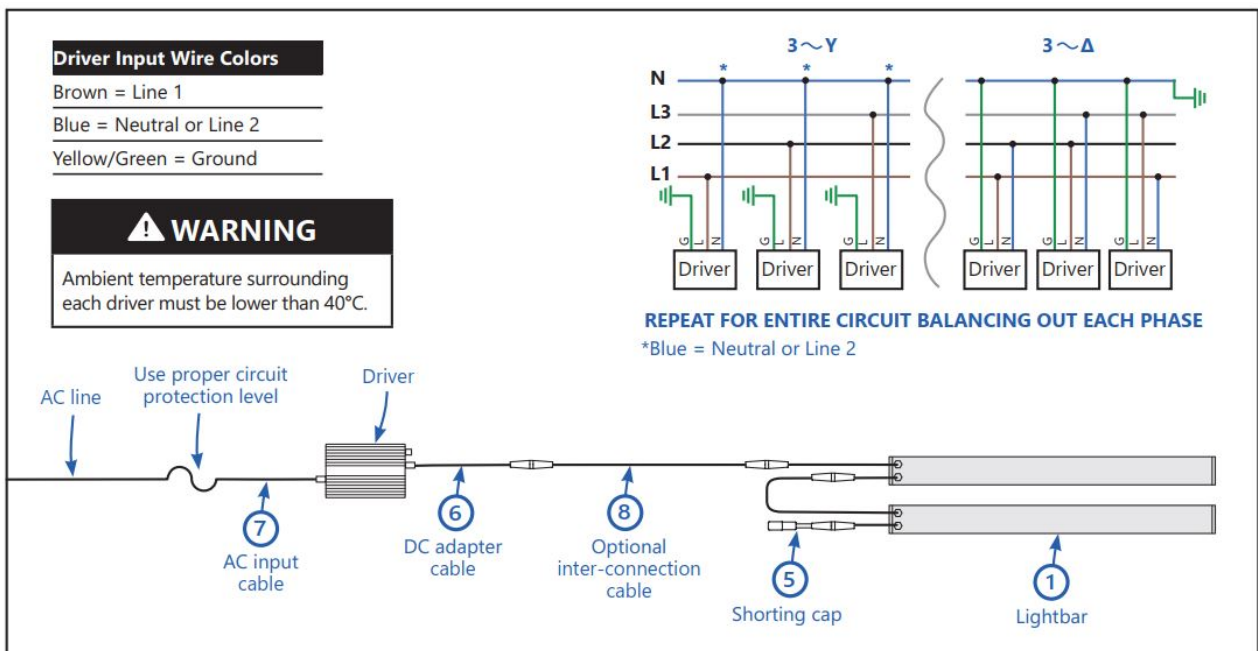

4 Connecting Wired Dimming (Optional)



WARNING

RISK OF ELECTRIC SHOCK

Turn power off before installation, inspection, cleaning or removal. And follow appropriate lock out/tag out safety procedure.

NOTE: Arize Factor dimming allows user to adjust the light output from 0%/10-100%. When set to 0%, the system will enter standby mode, consuming 0.5-1.5W and LEDs may remain very faintly lit. If 0 light is preferred, switch off the unit via the mains (AC line).

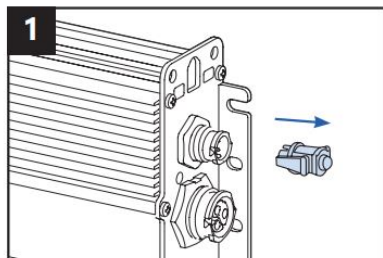

Remove cap from dimming connector.

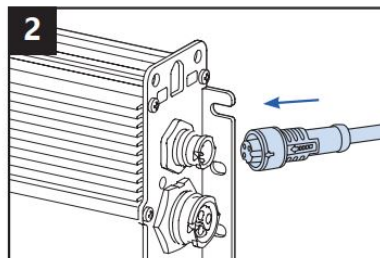

Plug dimming cable: align keying features and push connectors together until lock ring has snapped into place and a click is heard. To remove dimming cable, turn locking ring 1/8 of a turn counter-clockwise and separate connectors.

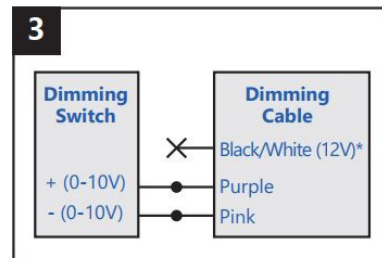

Connect the appropriate wiring to Dim + (0-10V) and Dim – (0-10V) from driver. Insulate the black wire. Follow dimming switch instructions for rest of connection.

**The black/white wire is a 12V auxiliary output that can support up to 250mA of current.*

Save These Instructions

Use only in the manner intended by the manufacturer. If you have any questions, contact the manufacturer.

For the latest install guides for your product go to:

<https://www.gecurrent.com/eu-en/indoor-lighting/horticulture-led-grow-lights>
arize.support@gecurrent.com

UK and EU company information for UKCA and CE procedure:

Current Lighting Limited, 3rd Floor, 1 Ashley Road, Altrincham, UK, WA14 2DT

Current Netherlands B.V., Programmeurstraat 6, 1033MT Amsterdam, Netherlands



Electrical products must not be thrown out with domestic waste. They must be taken to a communal collecting point for environmentally friendly disposal in accordance with local regulations. Contact your local authorities or stockist for advice on recycling. The packaging material is recyclable. Dispose of the packaging in an environmentally friendly manner and make it available for the recyclable material collection-service.



Horticultural lighting. Not suitable for household illumination.

Read More About This Manual & Download PDF:

Documents / Resources

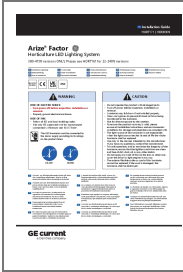

[GE current HORT171 Arize Factor Horticulture LED Lighting System](#) [pdf] Installation Guide
HORT171, Arize Factor Horticulture LED Lighting System

References

- [Commercial Lighting and Lighting Controls | Current - GLI Brands](#)
- [Horticulture | Current](#)