



GE current GEH6075 Evolve LED Security Light Installation Guide

[Home](#) » [GE current](#) » GE current GEH6075 Evolve LED Security Light Installation Guide 

Contents

- [1 GE current GEH6075 Evolve LED Security Light](#)
- [2 Cleaning](#)
- [3 Specifications](#)
- [4 FCC STATEMENT](#)
- [5 Documents / Resources](#)
- [6 Related Posts](#)

GE current

GE current GEH6075 Evolve LED Security Light

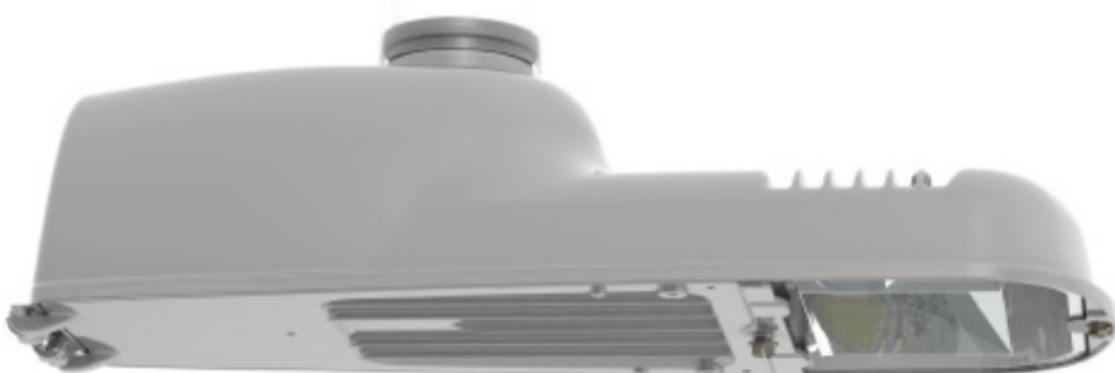

BEFORE YOU BEGIN

Read these instructions and save for future use.

WARNING

RISK OF ELECTRIC SHOCK

Disconnect power before service installation, or maintenance of the product.

RISK OF INJURY OR DAMAGE

Unit will fall if not installed properly. Follow installation instructions

CAUTION

RISK OF INJURY

- The luminaire should be mounted so that prolonged staring into the luminaire at a distance closer than 0.50m is not expected.
- Wear safety glasses and gloves during installation and servicing.

Storage

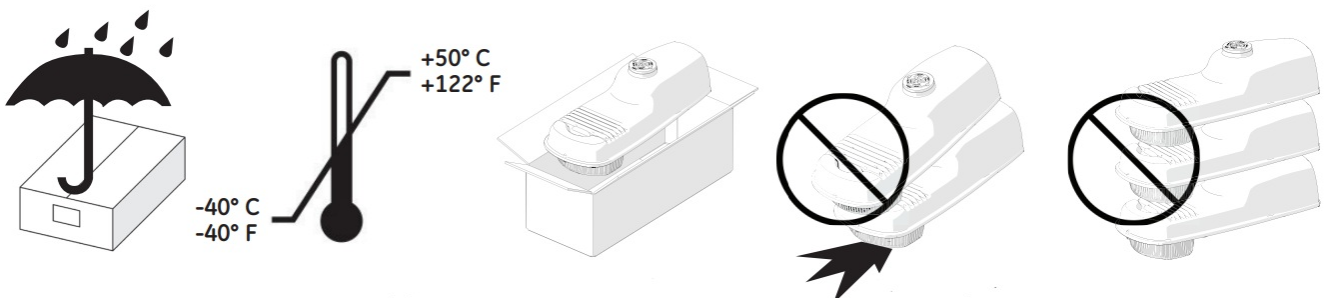

- Store packaged units in a covered dry area
- Check for damage
- Do not impact
- Do not stack

Arm Mounting

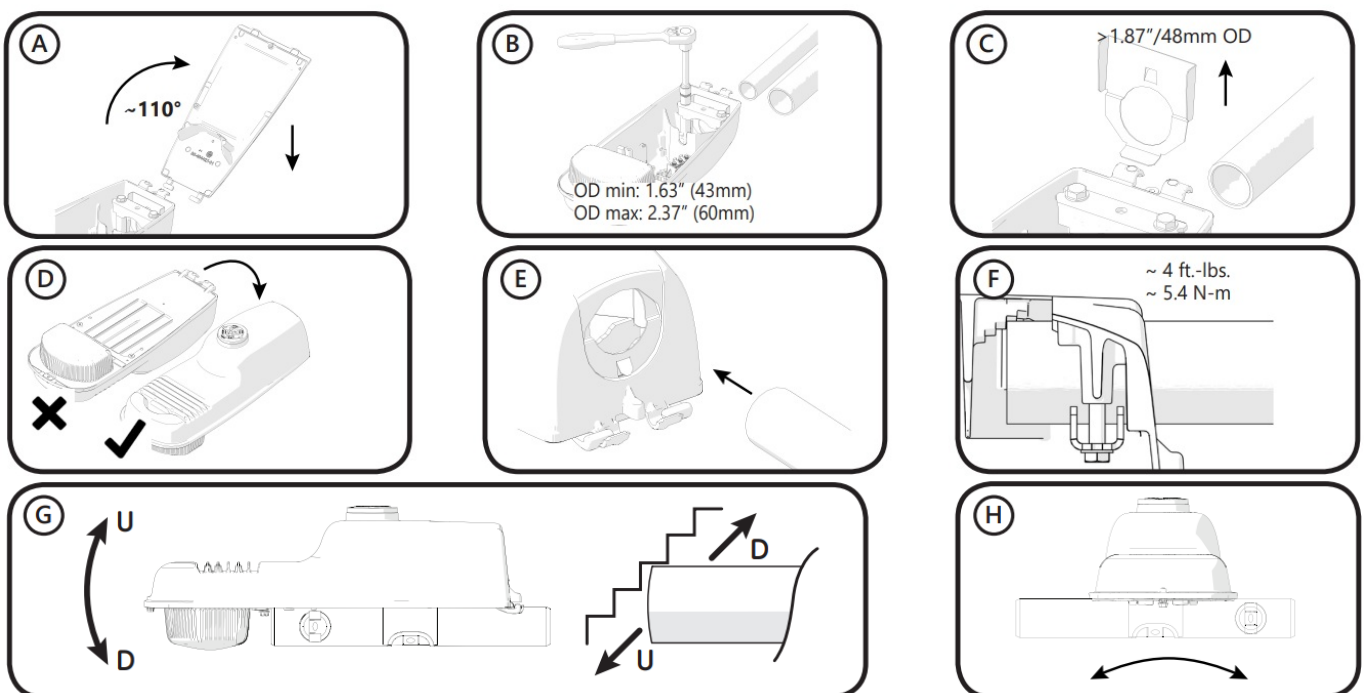

- Drill hole. Insert bolt and apply washer and nut.

- Hook arm upper slot on bolt. Tighten nut.
- Hammer lag bolts in lower holes to 1".
- Tighten with wrench.
- Insert leads in pole bottom. Create Drip loop

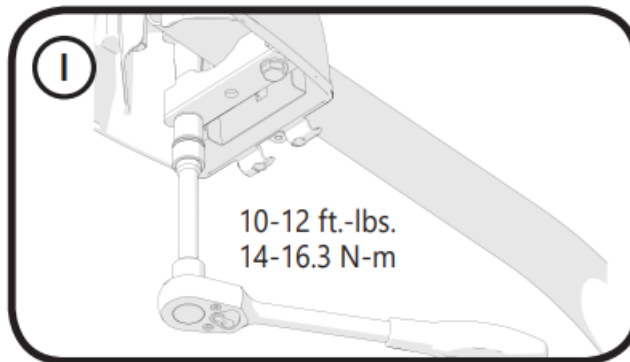

Mounting

- Unless captive, unhinge and remove door.
- Open clamp to pipe OD.
- Remove bird shield for large pipe.
- Install with LEDs facing down.
- Insert pipe thru housing.
- Start pipe on middle step.
- Shift steps to level fixture front-to-back.
- Rotate to level side-to-side

WARNING

RISK OF DAMAGE

Do not torque bolts greater than 12 ft-lbs. Damage may occur.

Once level, tighten bolts evenly.

Wiring

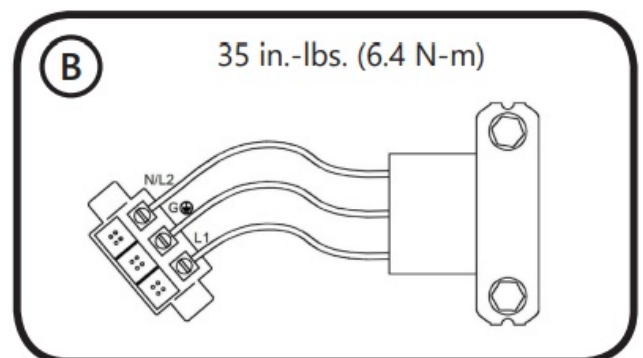
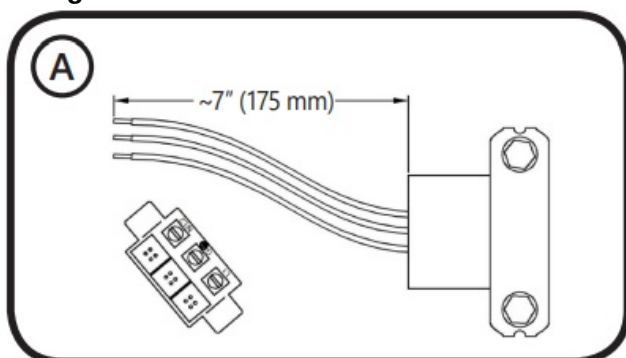

- Extend wires past the pipe
- Extend wires past the pipe

CAUTION

RISK OF SHOCK OR DAMAGE

Follow applicable national and local electrical codes.

RISK OF DAMAGE

Verify supply voltage and wire insulation temperature rating match nameplate requirements.

Photoelectric Control

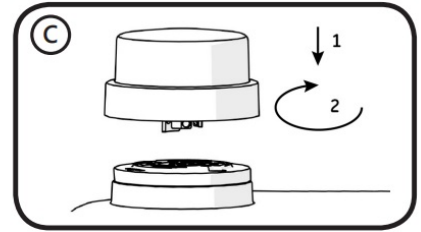
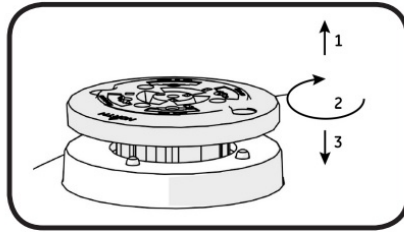
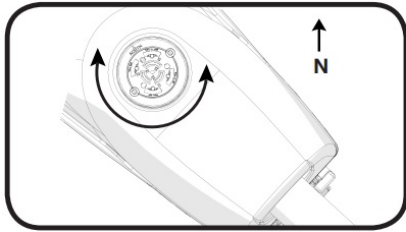

- Rotate the receptacle to aim “N” to North.
- Lift, rotate, release, press to seat
- Insert, twist to lock.

Door Closing

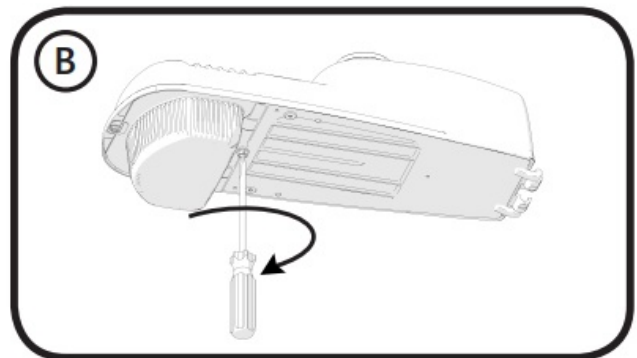
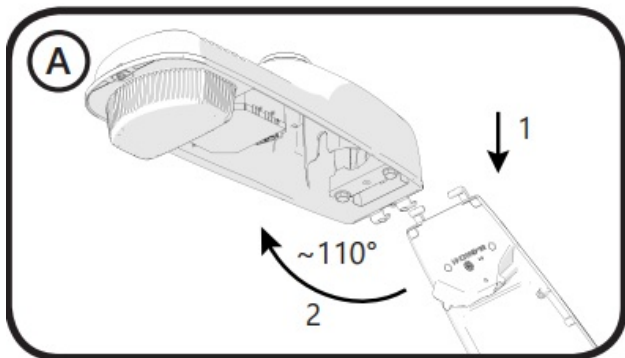

- Hang the door on the hinge, and rotate closed.
- Close and fasten the door.

Cleaning

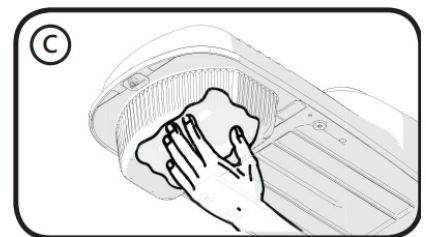
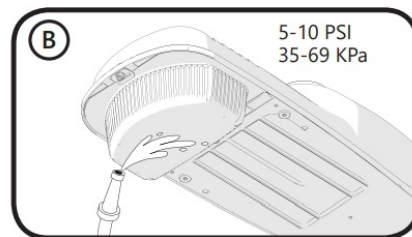
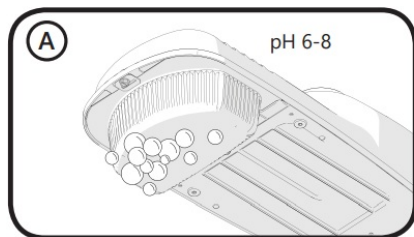

- Use mild soap/detergent.
- Rinse with cool low-pressure water.
- Wipe dry with clean soft cloth.

Specifications

Luminaire	Weight	Dimensions Dimensions	IP Rating Classe IP	Mounting Height	Effective Projected Area Zone	Operating Temp. T
E2SC	8 lbs (3.6 kg)	19.3 x 7.4 x 5.1 in. (490 x 198 x 130 mm)	Optical: Std – IP66 Electrical Enclosure: – UL emplacement humide/	12-40 ft (8.2-12.2 m)	0.4 ft ² (0.038 m ²)	-40° to +40° C

FCC STATEMENT

This device complies with Part 15 of the FCC Rules. Operation is subject to the following two conditions:

1. This device may not cause harmful interference, and
2. this device must accept any interference received, including interference that may cause undesired operation.

This Class [A] RFLD complies with the Canadian standard ICES-005. Ce DEFR de la classe [A] est conforme à la NMB-005 du Canada.

Note: This equipment has been tested and found to comply with the limits for a Class A digital device, pursuant to part 15 of the FCC Rules. These limits are designed to provide reasonable protection against harmful interference when the equipment is operated in a commercial environment. This equipment generates, uses, and can radiate radio frequency energy and, if not installed and used in accordance with the instruction manual, may cause harmful interference to radio communications. Operation of this equipment in a residential area is likely to cause harmful interference in which case the user will be required to correct the interference at his own expense. © 2021 Current Lighting Solutions, LLC. All rights reserved. GE and the GE monogram are trademarks of the General Electric Company and are used under license. Information provided is subject to change without notice. All values are design or typical values when measured under laboratory conditions.

Documents / Resources

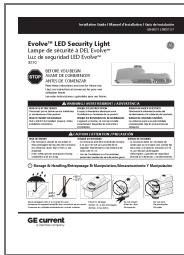

[GE current GEH6075 Evolve LED Security Light](#) [pdf] Installation Guide
GEH6075 Evolve LED Security Light, GEH6075, Evolve LED Security Light, LED Security Light
, Security Light, Light