



# GE current ARCH048 Lumination LED Luminaire Installation Guide

[Home](#) » [GE current](#) » GE current ARCH048 Lumination LED Luminaire Installation Guide 

## Contents

- [1 GE current ARCH048 Lumination LED Luminaire](#)
- [2 LED Driver Features](#)
- [3 Prepare Electrical Wiring](#)
- [4 LED Driver Installation](#)
- [5 Technical Specifications](#)
- [6 Documents / Resources](#)
  - [6.1 References](#)
- [7 Related Posts](#)



**GE current ARCH048 Lumination LED Luminaire**

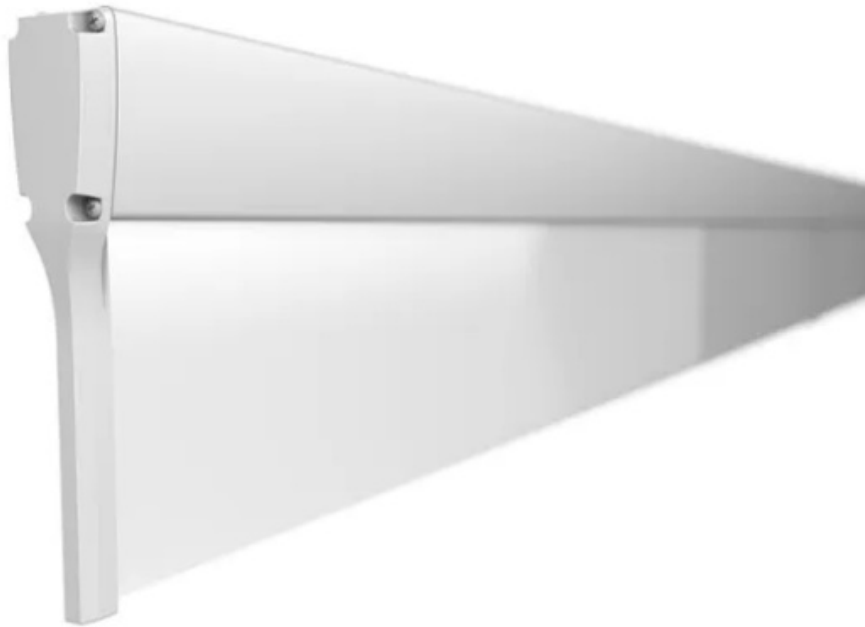

## **BEFORE YOU BEGIN**

Read these instructions completely and carefully.

## **WARNING**

Risk of electrical shock. Disconnect power before servicing or installing the product.

## **LED Driver Features**

- Class 2 wiring per NEC Article 725 (SELV)
- IP54: Dry or damp location rated

## **Prepare Electrical Wiring**

### **Electrical Requirements**

- The LED driver must be supplied with 100-277 VAC, 50/60 Hz and connected to an individual properly grounded branch circuit, protected by a 15 or 20 ampere circuit breaker.

### **Grounding Instructions**

- The grounding and bonding of the overall system shall be done in accordance with National Electric Code (NEC) Article 600 and local codes.

This device complies with Part 15 of the FCC Rules. Operation is subject to the following two conditions: (1) This device may not cause harmful interference, and (2) this device must accept any interference received, including interference that may cause undesired operation. This Class [A] RFLD complies with the Canadian standard ICES-003.

**Note:** This equipment has been tested and found to comply with the limits for a Class A digital device, pursuant to part 15 of the FCC Rules. These limits are designed to provide reasonable protection against harmful interference when the equipment is operated in a commercial environment. This equipment generates, uses, and can radiate

radio frequency energy and, if not installed and used in accordance with the instruction manual, may cause harmful interference to radio communications. Operation of this equipment in a residential area is likely to cause harmful interference in which case the user will be required to correct the interference at his own expense.

## LED Driver Installation

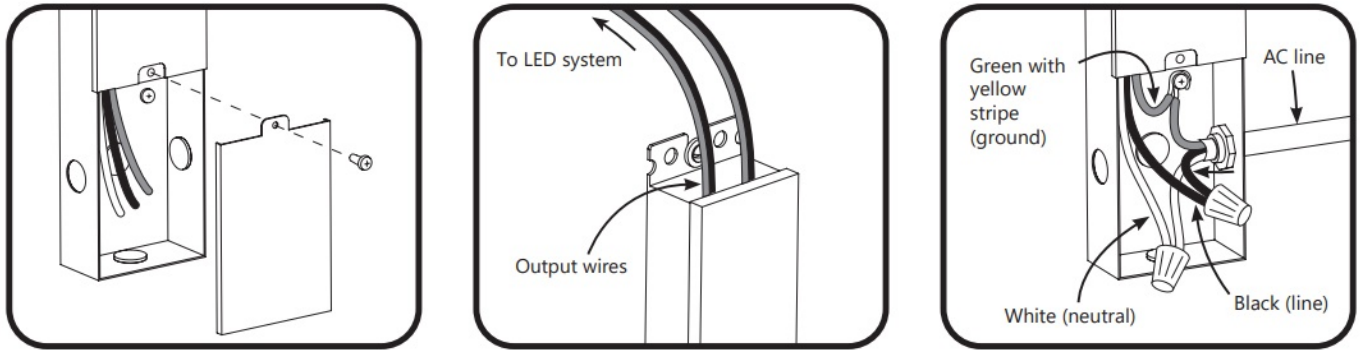

1. Mount the LED driver and remove the junction box cover. Carefully remove knockout for AC line input wires. Install appropriate electrical fittings in the knockout holes for wire protection.
2. Connect the supply wire that is attached to your LED system to the red (+) and black (-) output wires of the LED driver as outlined in the “Electrical Connections” section of your LED system’s Installation Instructions.
3. Connect the AC line to the black (line) and white (neutral) input wires of the LED driver using 18-14 AWG (0.82-2.08 mm<sup>2</sup>) twist-on wire connectors. Ground LED driver by connecting green wire with yellow stripe to the grounding screw. Replace the junction box cover.

## Technical Specifications

	Min	Typical	Max
Input Voltage (VAC)	90	100-277	305
Input Frequency (Hz)	–	50/60	–
Input Current (A)	0.7	–	2.5
Output Voltage (VDC)	23.25	24.0	24.75
Output Current (ADC)	–	–	3.8
Output Power (W)	–	–	180
Environmental Operating Temperature Range	-40°C	+25°C	+60°C
Environmental Humidity (non-condensing)	0%	–	90%
Environmental Storage Temperature Range	-40°C	–	+85°C
Enclosure Specification	IP54: Dry or damp location rated		
Dimensions	15.5 in. x 2.5 in. x 1.6 in. (392 mm x 62 mm x 40 mm )		

**Note:** For remote mounting or loading information refer to the LED System Installation Instructions.

This product is intended to be used as a lamp control gear that is installed after the mains control switch.

Conforms to the following standards:

[www.gecurrent.com](http://www.gecurrent.com)

© 2021 Current Lighting Solutions, LLC. All rights reserved. GE and the GE monogram are trademarks of the General Electric Company and are used under license. Information provided is subject to change without notice. All values are design or typical values when measured under laboratory conditions. ARCH048 (Rev 04/02/2021)

**Documents / Resources**

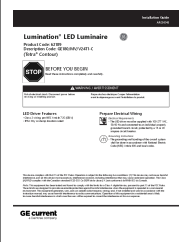
	<p><a href="#">GE current ARCH048 Lumination LED Luminaire</a> [pdf] Installation Guide</p> <p>ARCH048 Lumination LED Luminaire, ARCH048, Lumination LED Luminaire, LED Luminaire, Luminaire</p>
---	--

**References**

- [C Commercial Lighting and Lighting Controls | Current - GLI Brands](#)

[Manuals+](#).