



GE APPLIANCES

**JTD5000SV 30
Inch Smart Built
In Self Clean
Convection
Double Wall Oven**



GE APPLIANCES JTD5000SV 30 Inch Smart Built In Self Clean Convection Double Wall Oven Owner's Manual

[Home](#) » [GE Appliances](#) » GE APPLIANCES JTD5000SV 30 Inch Smart Built In Self Clean Convection Double Wall Oven Owner's Manual 

Contents

- [1 GE APPLIANCES JTD5000SV 30 Inch Smart Built In Self Clean Convection Double Wall Oven](#)
- [2 Specifications](#)
- [3 Dimensions And Installation Information](#)
- [4 Installation Guidelines](#)
- [5 Pedestal Rails Usage](#)
- [6 Attachment Instructions](#)
- [7 Frequently Asked Questions](#)
- [8 Documents / Resources](#)
 - [8.1 References](#)
- [9 Related Posts](#)



GE APPLIANCES

GE APPLIANCES JTD5000SV 30 Inch Smart Built In Self Clean Convection Double Wall Oven



Specifications

- Model: JTD5000DV/EV/SV
- KW Rating: 240V – 8.4, 208V – 6.3
- Breaker Size: 240V – 40 Amps, 208V – 40 Amps
- Cutout Width: 28 1/2" minimum, 28 5/8" maximum
- Cutout Height: 50 1/4" minimum without pedestal, 51 13/16" minimum, 51 15/16" maximum with pedestal
- Cutout Depth: 23 1/2" minimum
- Overall Height with Trim: Refer to installation instructions
- Overall Width: Refer to installation instructions
- Weight Capacity: Up to 400 lbs (181 kg)

Dimensions And Installation Information

Note: Wall coverings, countertops and cabinets surrounding the wall oven must be able to withstand a temperature of up to 200°F (94°C).

Note: If the cabinet in which the wall oven is installed does not have a solid bottom, two braces, or runners must

be installed to support the weight of the oven. The runners and braces must support up to 400 lbs (181 kg).

Note: The door handle protrudes 3" from the door face. Cabinets and drawers on adjacent 45° and 90° walls should be placed to avoid interference with the handle. Attention Installer: Electric wall ovens are NOT approved for installation with a plug and receptacle. They must be hardwired into an approved junction box.

Important: Before installing, consult installation instructions packed with product for current dimensional data.

KW Rating

- 240V 8.4
- 208V 6.3

Breaker Size

- 240V 40 Amps
- 208V 40 Amps

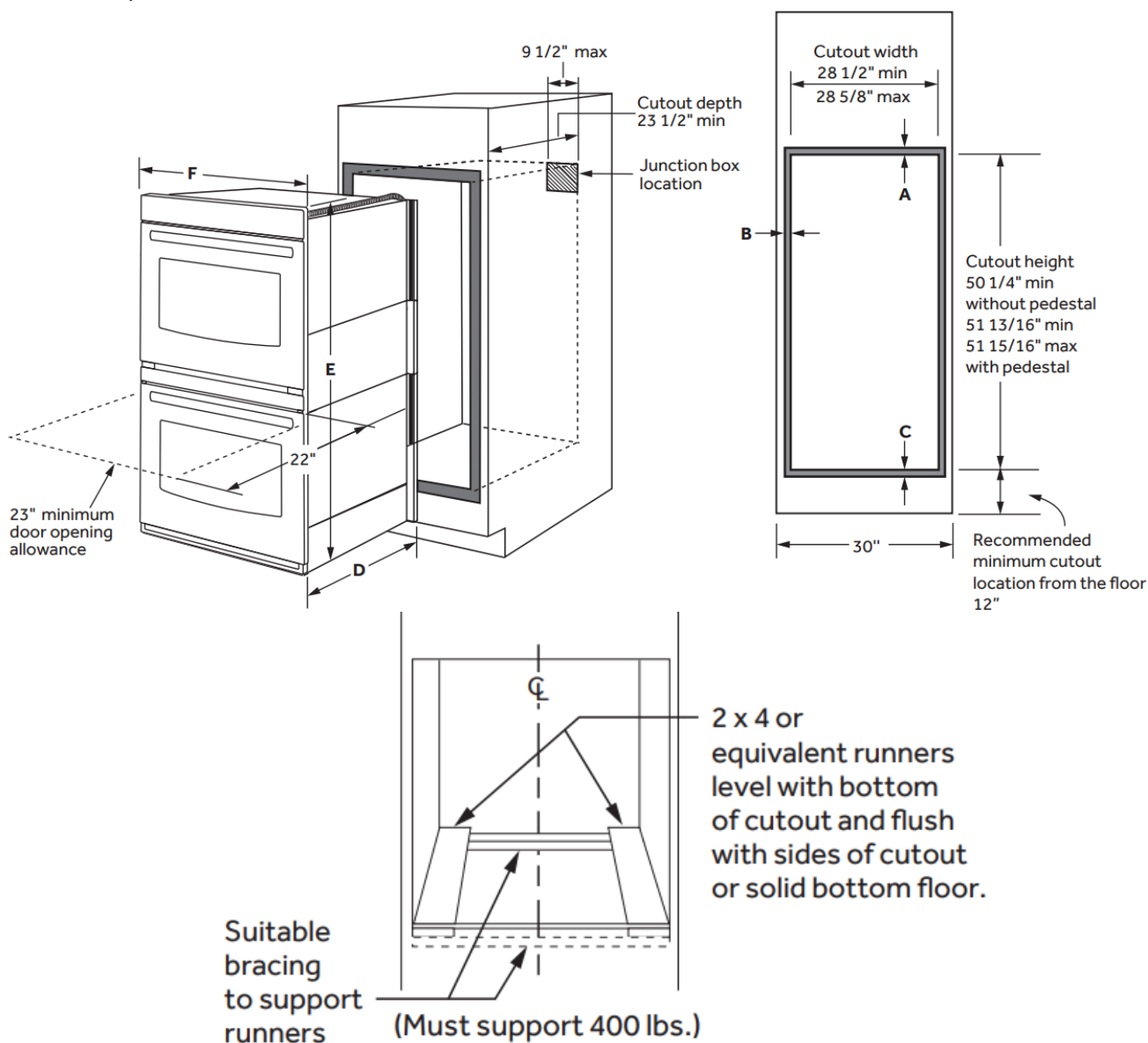

TD5000

Cabinet	30"
A - Overlap of oven at top of cutout	1"
B - Overlap of oven other side of edge of cutout	11/18"
C - Overlap of oven at bottom of cutout	1 1/4"
Oven	
D - Install depth	23 1/2"
E - Overall height with trim	50 1/4" to 51 15/16"
F - Overall width	28 1/2" to 28 5/8"

Dimensions And Installation Information

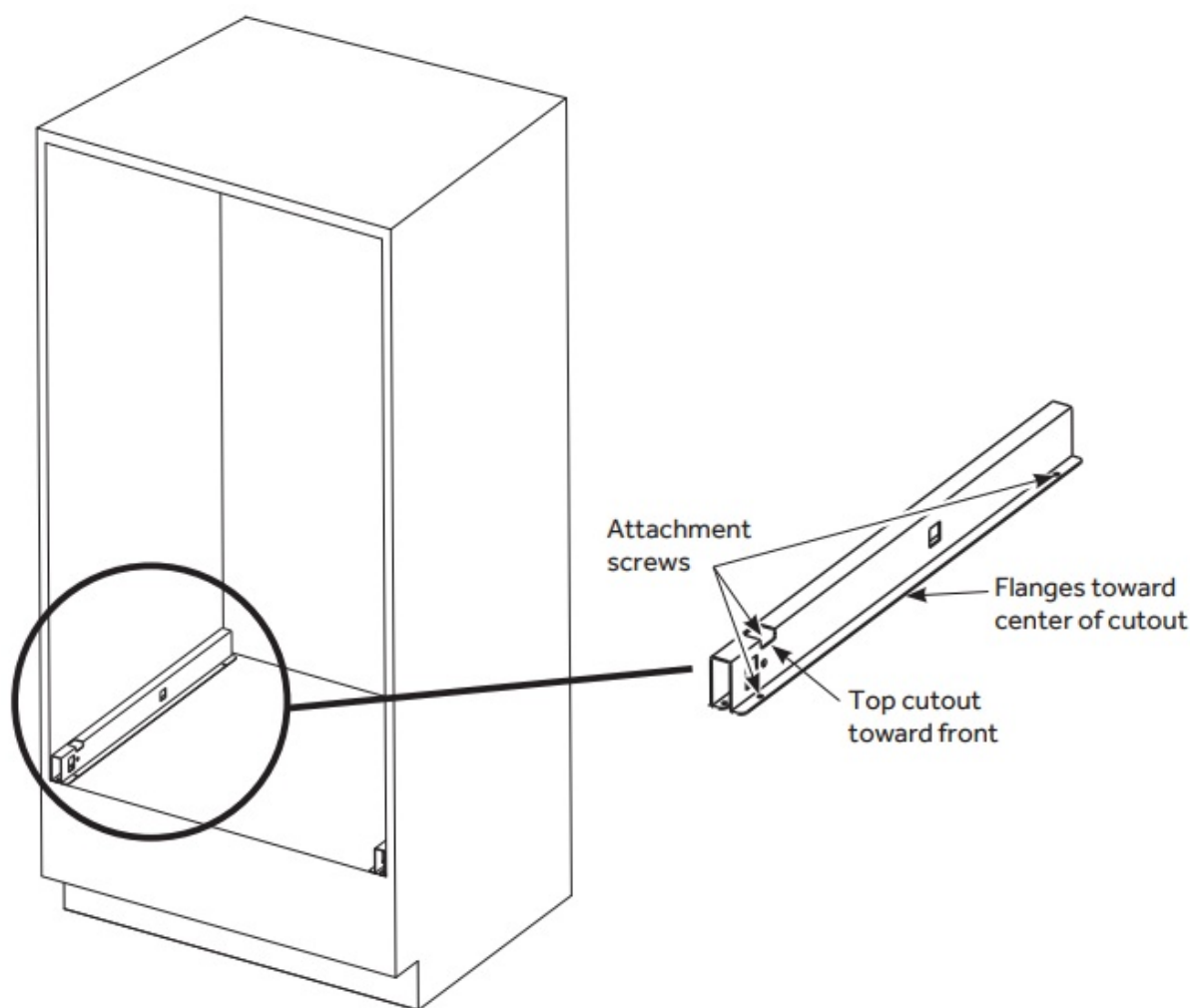

Note: 30" Double electric wall ovens are approved for installation above 27" and 30" warming drawers.

Attention Installer: Electric wall ovens are NOT approved for installation with a plug and receptacle. They must be hardwired into an approved junction box.

Important: Before installing, consult installation instructions packed with ALL products for current dimensional and combination data.

When To Use The Pedestal Rails: When replacing an older GE Appliances 30" double wall oven with a new GE Appliances model: Cutout Height = 51 13/16" to 51 15/16". This is our traditional cutout height. **When Not To Use The Pedestal Rails:** When replacing a 30" double wall oven from another manufacturer (i.e., Whirlpool) with a new GE Appliances model: Cutout height = 50-1/4". You will need to verify that the existing cutout matches the 50-1/4" dimension. If the new GE Appliances 30" double wall oven is being installed into new construction (i.e., not a replacement), then the recommended installation is to use the pedestal rails.

Features And Benefits

No Preheat Air Fry – Cook healthier, crispier versions of your favorite foods in less time, thanks to an air fryer right in your oven that doesn't require preheating. Optional air fry basket sold separately. **True European Convection** – Achieve faster and more even results with a convection fan and third heating element that circulates air for more efficient cooking **Anywhere Control with Remote Notifications** – Save time by conveniently preheating and monitoring your oven from anywhere using the GE Appliances Kitchen app.

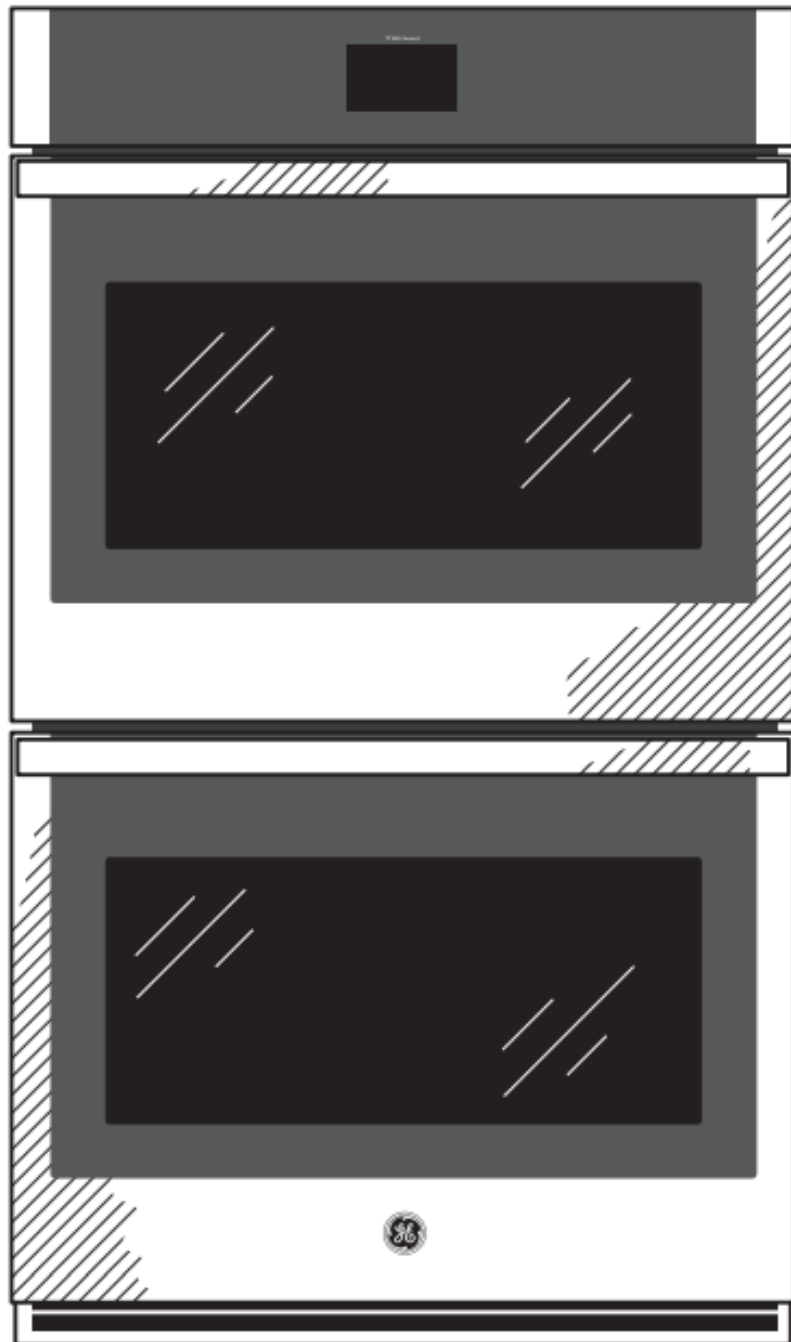

Remote Temperature Probe – The internal probe allows monitoring of roasts and meats to ensure they are thoroughly and accurately cooked without opening the oven door **Self-Clean with Optional Steam Clean** – Cleaning the oven interior has never been easier, with two cleaning options to fit your lifestyle **Hidden Backlit LCD Control** – Easily read and operate a bright display that shows the clock when not in use and illuminates controls when you're ready to cook **10-Pass Hidden Bake Element** – Even baking and quick cleanup are assured, with 10-pass element that heats a large cooking area and is hidden for an easy-to-wipe surface **8-Pass Broil Element** – Get full broil coverage and even browning from edge to edge

- Model JTD5000DVBB – Black
- Model JTD5000EVES – Slate

- Model JTD5000SVSS – Stainless Steel

Installation Guidelines

Before installation, ensure that the cabinet has a solid bottom or install two braces/runners to support the oven's weight.

Electrical Requirements

Electric wall ovens must be hardwired into an approved junction box; do not use a plug and receptacle system.

Cutout and Dimensions

Follow the provided cutout dimensions for width, height, and depth. Ensure suitable bracing supports the oven according to the specified weight capacity.

Pedestal Rails Usage

Use pedestal rails when replacing an older GE Appliances model with a traditional cutout height. Verify cutout height when replacing ovens from other manufacturers.

Attachment Instructions

Secure the oven using attachment screws with flanges towards the center of the cutout and the top cutout towards the front.

Frequently Asked Questions

Q: Can I install the oven above a warming drawer?

A: Yes, the 30 double electric wall ovens are approved for installation above both 27" and 30" warming drawers.

Q: What is the GE Fit Guarantee?

A: If you are replacing a similar wall oven from GE Appliances or another brand, GE wall ovens are guaranteed for an exact fit, and GE Appliances will pay up to \$300 towards modifications. Visit [geappliances.com](https://www.geappliances.com) for more information.

Fit Guarantee

Replacing a similar wall oven from GE Appliances or another brand?

GE wall ovens are guaranteed for an exact fit or GE Appliances will pay up to \$300 toward modifications. Visit [geappliances.com](https://www.geappliances.com) for more info.

Documents / Resources

	<p>GE APPLIANCES JTD5000SV 30 Inch Smart Built In Self Clean Convection Double Wall Oven [pdf] Owner's Manual JTD5000DV, JTD5000EV, JTD5000SV, JTD5000SV 30 Inch Smart Built In Self Clean Convection Double Wall Oven, JTD5000SV, 30 Inch Smart Built In Self Clean Convection Double Wall Oven, Self Clean Convection Double Wall Oven, Convection Double Wall Oven, Double Wall Oven, Wall Oven</p>
---	---

References

- [User Manual](#)

Manuals+, Privacy Policy

This website is an independent publication and is neither affiliated with nor endorsed by any of the trademark owners. The "Bluetooth®" word mark and logos are registered trademarks owned by Bluetooth SIG, Inc. The "Wi-Fi®" word mark and logos are registered trademarks owned by the Wi-Fi Alliance. Any use of these marks on this website does not imply any affiliation with or endorsement.