



GE APPLIANCES

**GFC765W  
Continuous Feed  
Garbage  
Disposer**



## GE APPLIANCES GFC765W Continuous Feed Garbage Disposer Instructions

[Home](#) » [GE Appliances](#) » GE APPLIANCES GFC765W Continuous Feed Garbage Disposer Instructions 

### Contents

- [1 GE APPLIANCES GFC765W Continuous Feed Garbage Disposer](#)
- [2 PRODUCT INFORMATION](#)
- [3 SAFETY INFORMATION](#)
- [4 DIMENSION](#)
- [5 FEATURES AND BENEFITS](#)
- [6 Installation Instructions](#)
- [7 COMPONENTS](#)
- [8 TROUBLESHOOTING TIPS](#)
- [9 LIMITED WARRANTY](#)
- [10 CONSUMER SUPPORT](#)
- [11 FAQs](#)
- [12 Documents / Resources](#)
  - [12.1 References](#)
- [13 Related Posts](#)



GE APPLIANCES

**GE APPLIANCES GFC765W Continuous Feed Garbage Disposer**



## PRODUCT INFORMATION

### THANK YOU FOR MAKING GE APPLIANCES A PART OF YOUR HOME.

Whether you grew up with GE Appliances, or this is your first, we're happy to have you in the family. We take pride in the craftsmanship, innovation and design that goes into every GE Appliances product, and we think you will too. Among other things, registration of your appliance ensures that we can deliver important product information and warranty details when you need them. Register your GE appliance now online. Helpful websites and phone numbers are available in the Consumer Support section of this Owner's Manual. You may also mail in the pre-printed registration card included in the packing material.

## SAFETY INFORMATION

### IMPORTANT SAFETY INFORMATION READ ALL INSTRUCTIONS BEFORE USING THE APPLIANCE

**WARNING** For your safety, the information in this manual must be followed to minimize the risk of fire, explosion, electric shock, and to prevent property damage, personal injury, or death.

**WARNING** WHEN USING YOUR ELECTRICAL APPLIANCES, BASIC SAFETY PRECAUTIONS SHOULD BE FOLLOWED, INCLUDING THE FOLLOWING:

- Use this appliance only for its intended purpose as described in this Owner's Manual.
- Read all the instructions before using the appliance.
- To reduce the risk of injury, close supervision is required when a disposer is used near children.
- Do not put fingers or hands into a waste disposer.
- Turn the power switch to the OFF position before attempting to clear a jam or remove an object from the disposer.

- When attempting to loosen a jam in a waste disposer, use a long wooden object such as a wooden spoon or the wooden handle of a broom or mop.
- When attempting to remove objects from a waste disposer, use long-handled tongs or pliers. If the disposer is magnetically actuated, use only nonmagnetic tools.
- To reduce the risk of injury by materials that may be expelled by a waste disposer, do not put the following into a disposer:
  - a. Clam or oyster shells
  - b. Caustic drain cleaners or similar products
  - c. Glass, china or plastic
  - d. Large whole bones
  - e. Metal, such as bottle caps, tin cans, utensils or aluminum foil
  - f. Hot grease or other hot liquids
  - g. Whole corn husks
- When not operating a disposer, leave the drain stopper in place to reduce the risk of objects falling into the disposer.
- For proper grounding instructions, see the CONNECTING ELECTRICITY portion of this manual.

## CONNECTING ELECTRICITY

If you are not familiar with electrical power and procedures, call a qualified electrician.

**WARNING** Improper connection of the equipment-grounding conductor can result in a risk of electric shock. Check with a qualified electrician or serviceman if you are in doubt as to whether the appliance is properly grounded. Do not modify the plug provided with the appliance if it will not fit the outlet; have a proper outlet installed by a qualified electrician.

### For Models Equipped with a Grounded Cord:

**GROUNDING INSTRUCTIONS:** This disposer must be grounded to reduce the risk of electric shock in the event of a malfunction or breakdown. Grounding provides a path of least resistance for electric current. This disposer is equipped with a cord having an equipment-grounding conductor and a grounding plug. The plug must be plugged into an outlet that is properly installed and grounded in accordance with all local codes and ordinances.

### Proper Disposal of your Appliance

- Dispose of or recycle your appliance in accordance with Federal and Local Regulations. Contact your local authorities for the environmentally safe disposal or recycling of your appliance.
- Consider recycling options for your appliance packaging material.

### Using the Disposer Care and Cleaning

READ ALL SAFETY INSTRUCTIONS BEFORE USING THIS DISPOSER.

This disposer uses anti-jam swivel impellers that make a clicking sound as they swing into place. This indicates normal operation.

- A. Remove the sink stopper and turn on a medium flow of cold water.

- B. Turn the switch to ON.
- C. Scrape in food waste. To speed up food waste disposal, cut or break up large bones, rinds and cobs. Large bones and fibrous husks require considerable grinding time and are more easily thrown away with other trash. Do not be alarmed that the disposer slows down while grinding. The disposer is actually increasing torque (grinding power) and is operating under normal conditions.
- D. Before turning the disposer off, let the water and the disposer run for approximately 25 seconds after shredding stops. This assures that all waste is thoroughly flushed through the trap and drain.
- E. Do not use hot water while running the disposer. Cold water will keep food waste and fats solid so they can be flushed down the drain.<sup>3</sup>

### **Helpful Hints**

- A. Be sure the disposer is empty before using the dishwasher so it can drain properly.
- B. You may want to leave the stopper in the drain when not in use to prevent utensils and foreign objects from falling into the disposer.
- C. The disposer is ruggedly built to give you years and years of trouble-free service. It will handle all normal food wastes – BUT it will not grind and dispose such items as tin cans, bottles and bottle caps, glass, china, leather, cloth, crockery, rubber, string, feathers, or clam or oyster shells. These are waste materials and belong in the trash can or trash compactor.
- D. TO SPEED UP FOOD WASTE DISPOSAL: Cut or break up large bones, melon rinds, grapefruit skins and corn cobs. Items such as large bones, fibrous husks like lima bean pods and corn husks, require considerable cutting time. For this reason, you may prefer to place them in the trash can or trash compactor.

### **Care and Cleaning**

THE MOTOR IS PERMANENTLY LUBRICATED FOR LIFE. DO NOT ATTEMPT TO LUBRICATE YOUR DISPOSER The disposer is self-cleaning and cleans itself with each use

- NEVER put lye or chemical cleaners into the disposer, as they cause serious corrosion of metal parts.
- Your disposer is equipped with a removable splash guard for ease of cleaning or replacement. Remove the splash guard by pulling it out from the top. To replace, insert into the sink flange and push down until it is properly seated.
- If an odor develops, run orange or lemon rinds through the disposer. A dozen ice cubes sprinkled with a little household scouring powder will also work.

### **BEFORE YOU BEGIN**

- Read these instructions completely and carefully.

### **FOR YOUR SAFETY**

Read and observe all WARNINGS and CAUTIONS shown throughout these instructions. While performing installations described in this booklet, gloves and safety glasses or goggles should be worn.

**IMPORTANT** – Observe all governing codes and ordinances.

- Save these instructions for local inspector's use.
- Note to Installer – Be sure to leave these instructions with the consumer.
- Note to Consumer – Keep these instructions for future reference.
- Skill level – Installation of this appliance requires basic mechanical skills.
- Proper installation is the responsibility of the installer.

## **WARNING**

- FOR PERSONAL SAFETY: Remove house fuse or open circuit breaker before beginning installation. Do not use an extension cord or adapter plug with this appliance.
- FOR PERSONAL SAFETY: Do not position your head or body under disposer; unit could fall during removal or installation.
- The improper connection of the equipment grounding conductor can result in a risk of electric shock. Check with a qualified electrician or service representative if you are in doubt that the appliance is properly grounded.
- If house wiring is not 2-wire with ground, a ground must be provided by the installer. When house wiring is aluminum, be sure to use UL-Listed anti-oxidant compound and aluminum-to-copper connectors.
- Product failure due to improper installation is not covered under the Warranty.

## **DIMENSION**

**GFC765W GE® 3/4 Horsepower Continuous-Feed Disposer**

**DISPOSALL® FOOD WASTE DISPOSER DIMENSIONS (IN INCHES)**

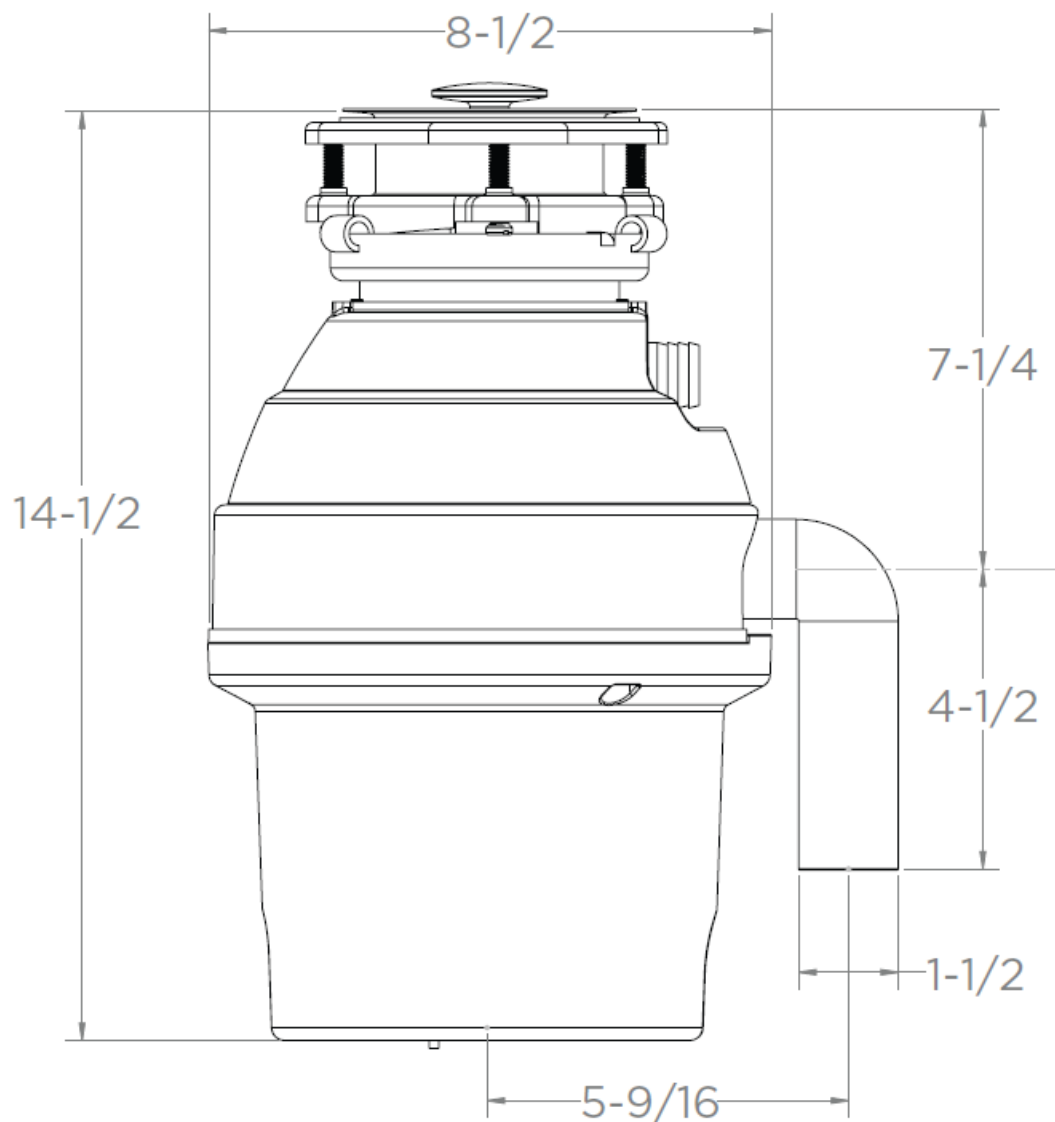

- **INLET/OUTLET DIAMETERS**

- Dishwasher inlet diameter (in.) 1
- Drain outlet diameter (in.) 1-1/2

- **POWER/RATINGS**

- Power Connection Direct Wire
- Volts/Hertz/Amps 120 V/60 Hz/6.0 A

## **FEATURES AND BENEFITS**

- 3/4 Horsepower Motor
- Super-Capacity, Continuous-Feed Disposer
- Over 2,700 RPM Grinding Action\*
- Stainless Steel Jam-Resistant, Dual-Swivel Impellers
- Universal 3-Bolt Installation
- Line Cord Power Connection, length = 35"
- Sound Reduction Technology
- Cold-Rolled Carbon Steel Armature Shaft Material
- SplashGuard
- Wall Switch or Air Switch Compatible

- Sink Stopper Included
- Manual Reset Overload Protector
- Dishwasher Drain Connector
- Stainless Steel Sink Flange
- Stainless Steel Turntable
- Dual Blade System
- Model GFC765W

## Installation Instructions

### DIMENSIONS

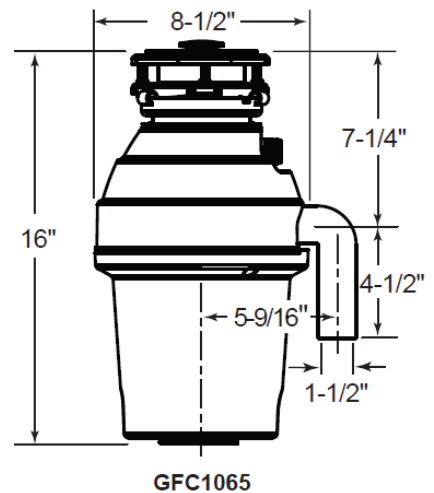
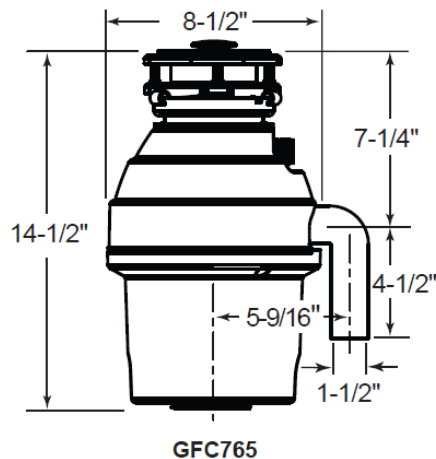
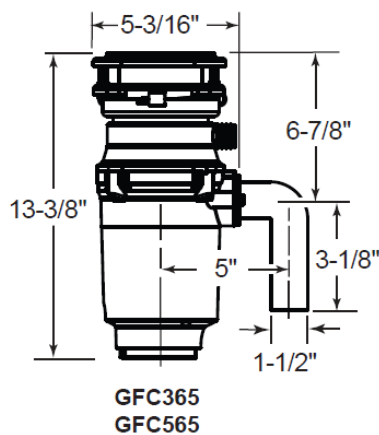

### SOME TYPICAL INSTALLATIONS

SINGLE BOWL

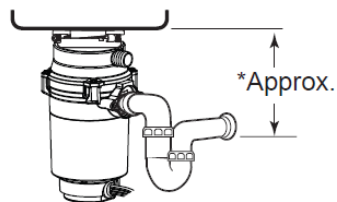

DOUBLE BOWL  
CENTER OUTLET\*\*

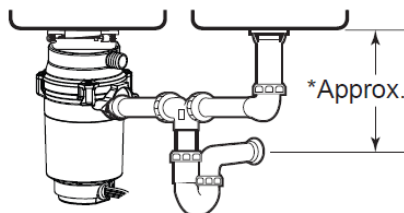

DOUBLE BOWL  
END OUTLET\*\*

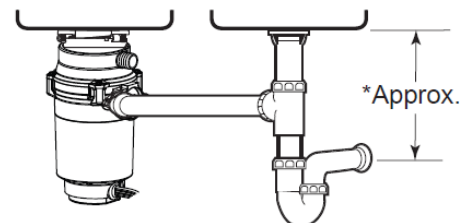

\*It is essential for the proper operation of the disposer that this dimension be 9"-12" to avoid standing water in disposer motor housing.

\*\*Flexible drain pipe may be necessary for this application.

## WHAT YOU WILL NEED



- Phillips and flat blade screwdrivers



- Channel lock pliers, slip joint



- Hacksaw



- Flashlight



- Hammer



- Nut Driver

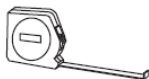

- Tape Measure



- Liquid soap (or petroleum jelly)



- Putty Knife



- Plumbers Putty



- Safety Glasses



- Gloves

Only needed if connecting to a dishwasher:



- Hose clamp(s)



- Flexible Drain Hose



- Wooden dowel or steel punch

## COMPONENTS

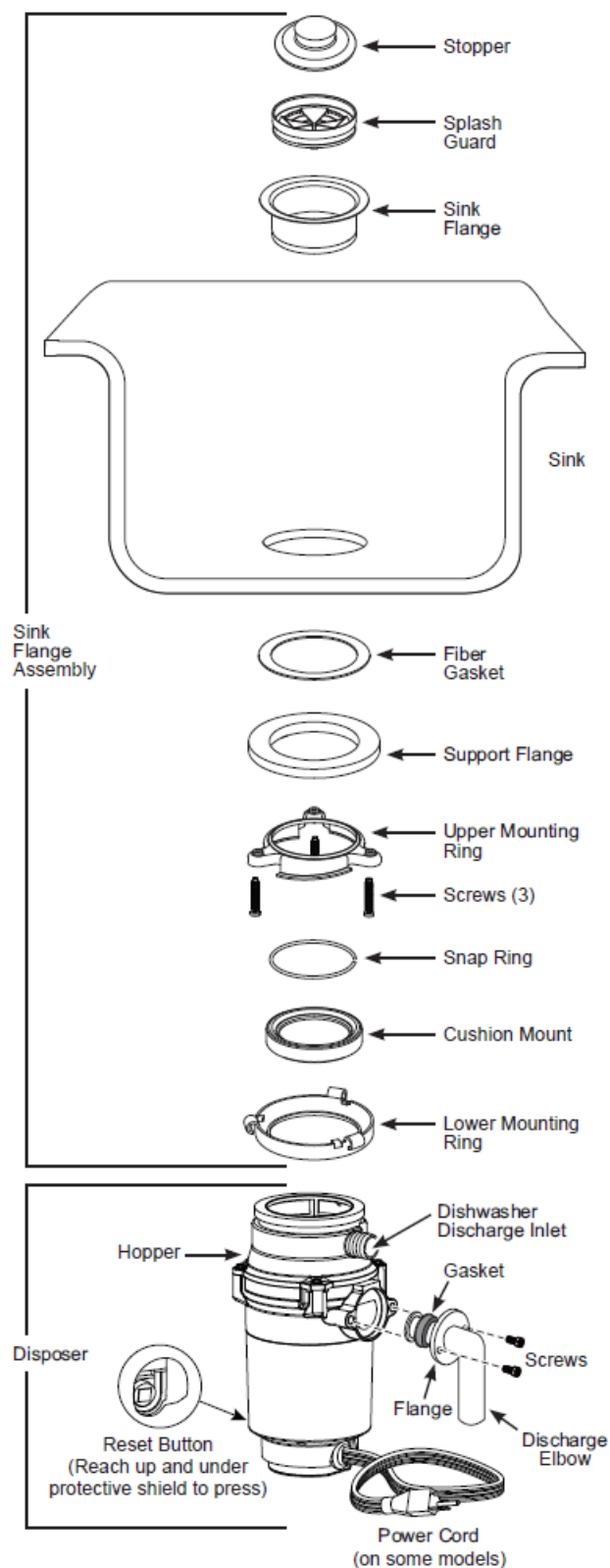

## PREPARATION

## PREPARATION

1. Disconnect electrical power supply to disposer.
2. Remove old disposer or sink flange assembly.
3. Inspect drain line. If it is heavily coated with hardened grease and accumulations, rout out with a plumber's snake.
4. Remove old sealing materials and gasketing from sink opening, both top and bottom.

- **NOTE:** Top and bottom of sink surfaces must be clean, dry and free of any residue to prevent leaks.

## DISASSEMBLE TO INSTALL

1. Turn the lower mounting ring clockwise until it releases and lift the entire hardware assembly from the disposer.

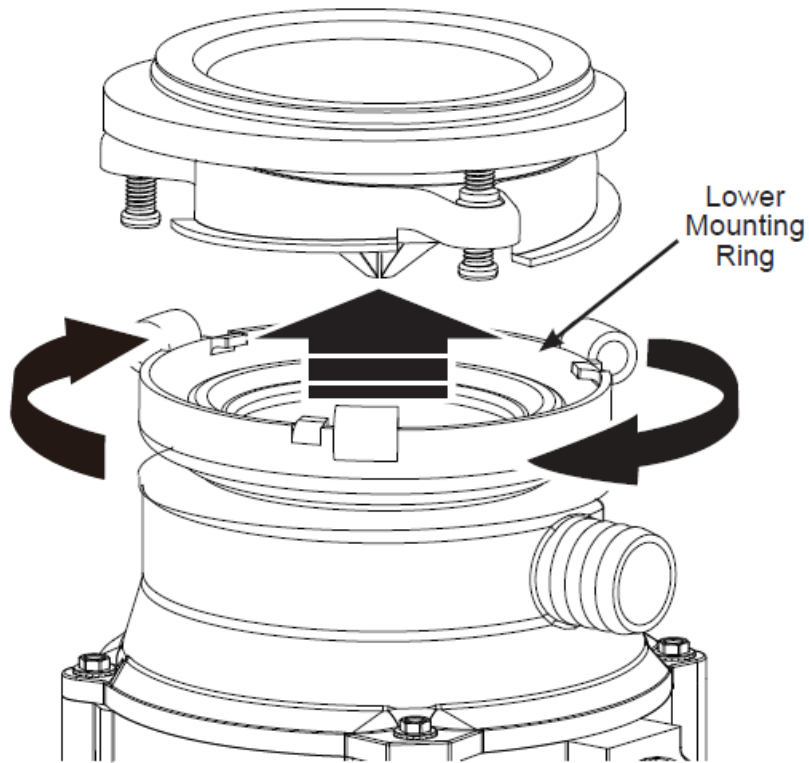

2. Loosen the three screws from the upper mounting ring and slide it toward the support flange.

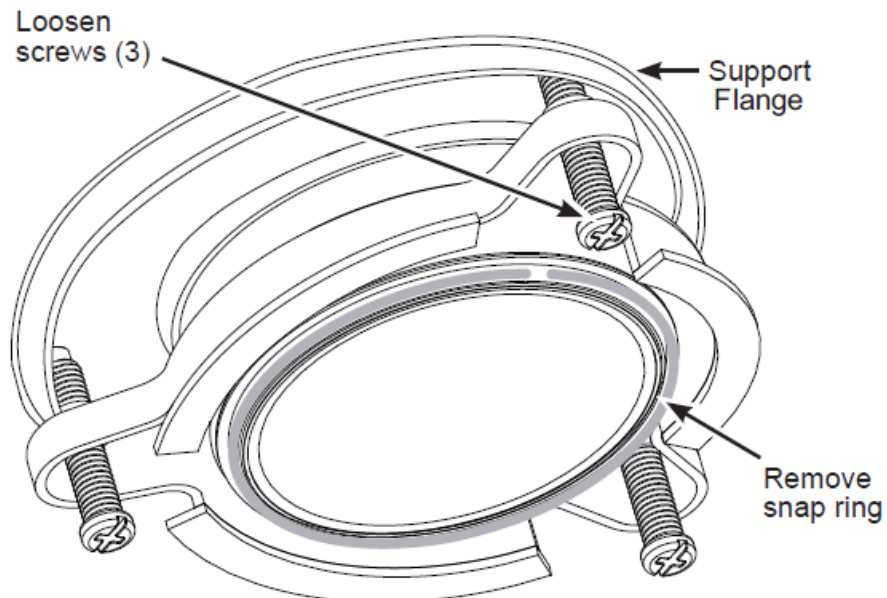

3. Insert a flat blade screwdriver under the snap ring and remove it.
4. Separate the upper mounting ring and support flange from the sink flange.

## INSTALL THE SINK FLANGE

1. Roll plumbers putty in a 3/8" thick rope, turn the sink flange up-side-down and apply around the bottom of the flange.

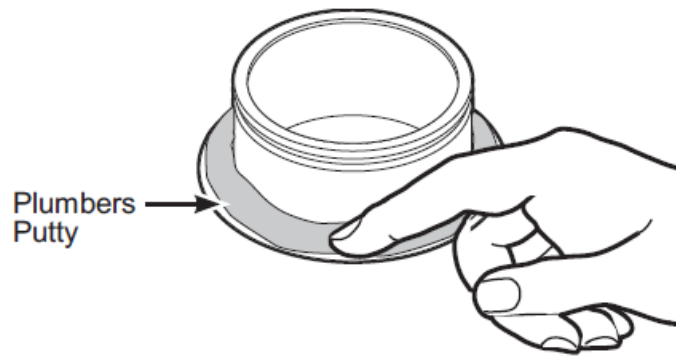

2. Install the sink flange into the sink opening by pressing it in firmly and removing excess plumbers putty.

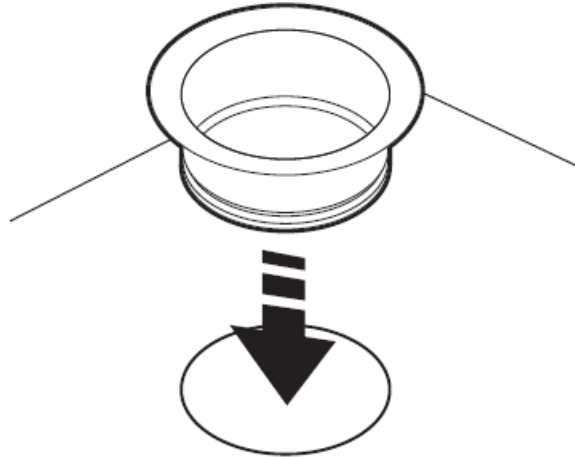

3. Place a towel over the sink bottom and flange, and weight the flange down to hold it in place while you add the other mounting components.

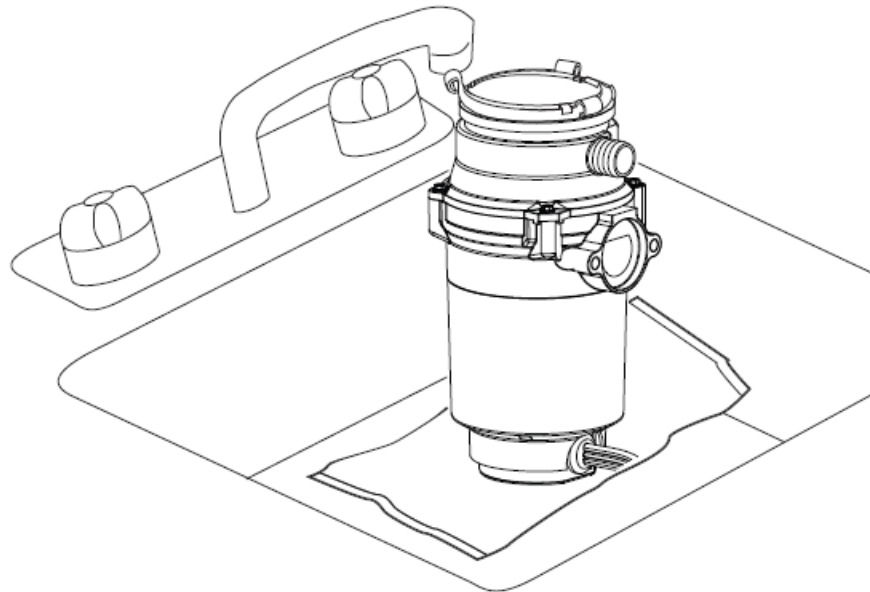

## **INSTALL THE UNDER SINK MOUNTING HARDWARE**

1. Assemble together the fiber gasket, support flange and upper mounting ring onto the lower sink flange.

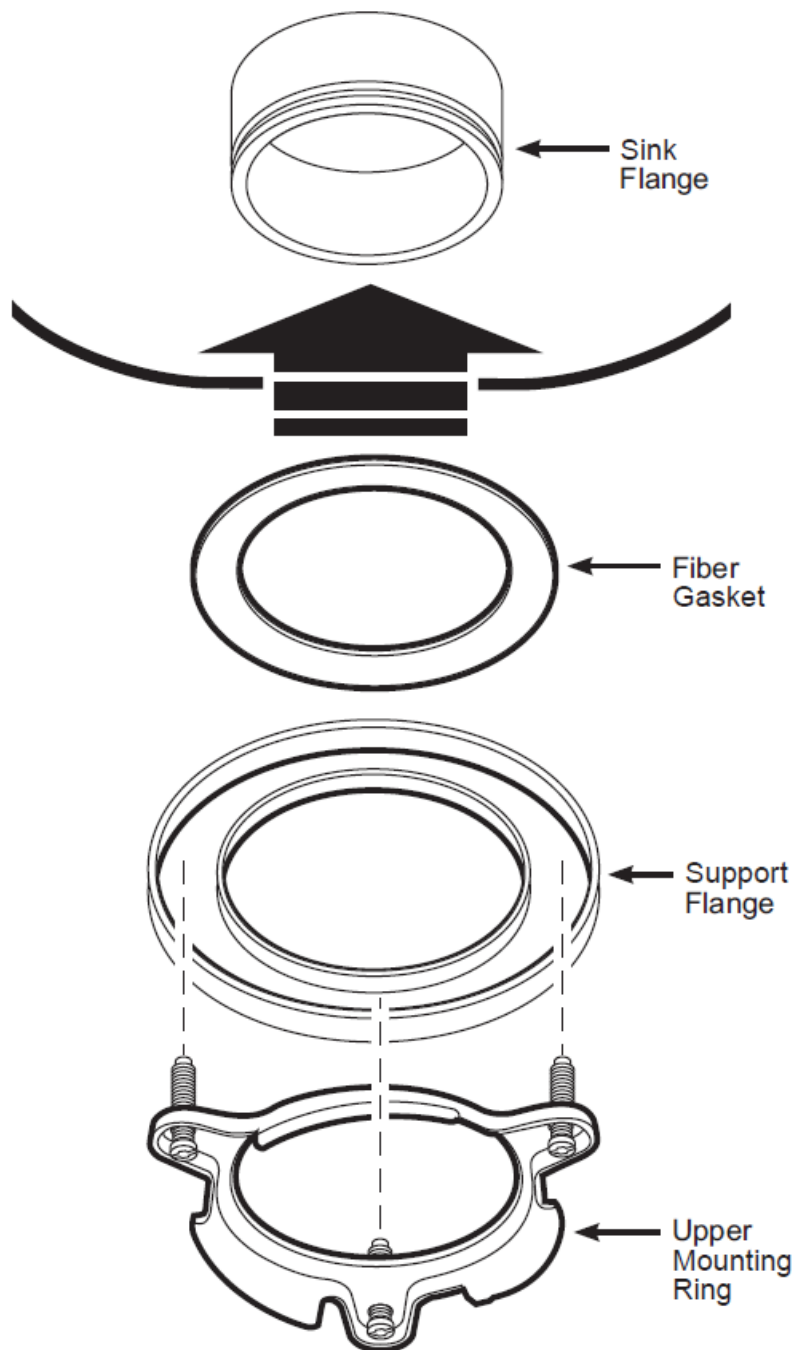

- Secure the assembly in place on the sink flange by inserting the snap ring into the sink flange snap groove.

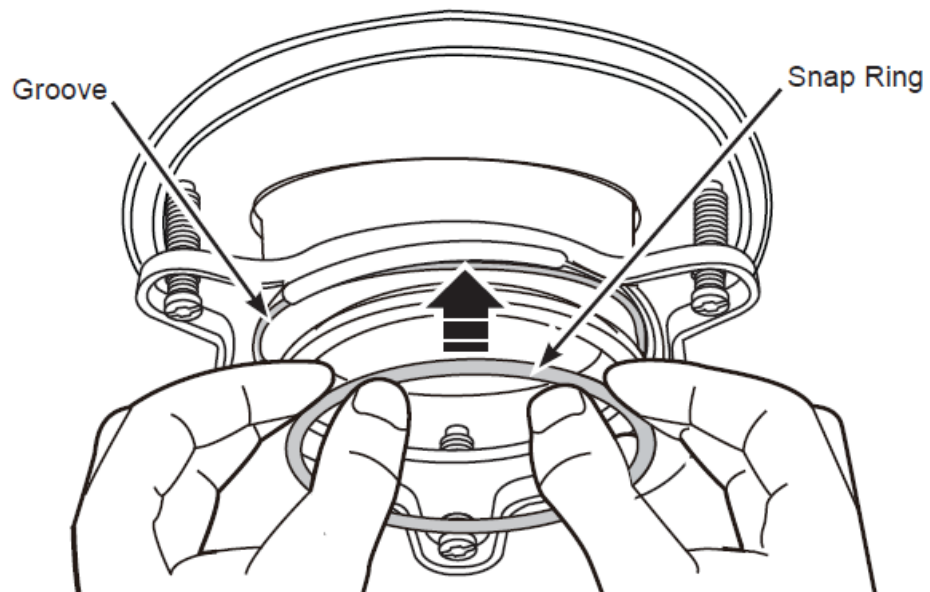

- **IMPORTANT:** Make sure the snap ring is secured into place in the snap groove. If the snap ring is not secured in the snap groove, trapping the assembled parts in place, then the disposer cannot be properly installed.

2. Tighten the three upper mounting ring screws into the support flange.

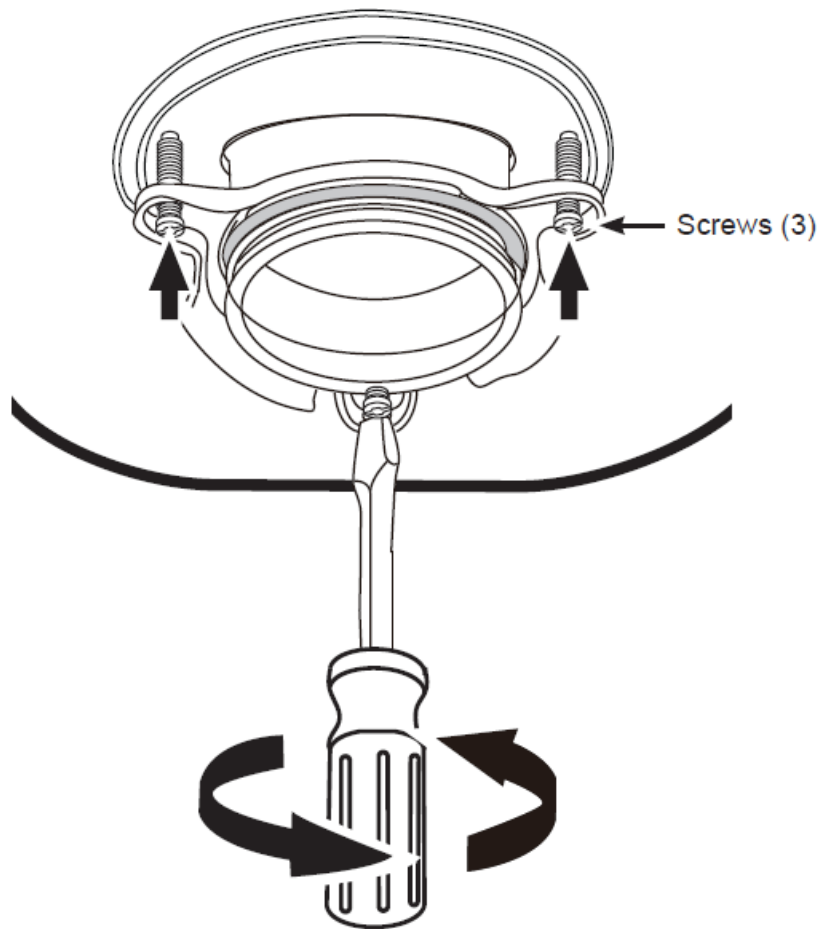

### IF CONNECTING TO A DISHWASHER

If you are connecting to a dishwasher, complete this step. If a dishwasher is not to be connected, skip to ATTACH THE DISCHARGE ELBOW section and continue.

- Set the disposer on the floor. Place it on its side on a protected surface. Use a blunt instrument (steel punch or wooden dowel), to knock out the entire dishwasher discharge plug. Do not use a screwdriver or sharp instrument. When knockout plug falls into disposer, you may remove it or simply grind it up when the disposer is used. This will not damage the disposer in any way, but may take some time to grind, over the course of several uses.

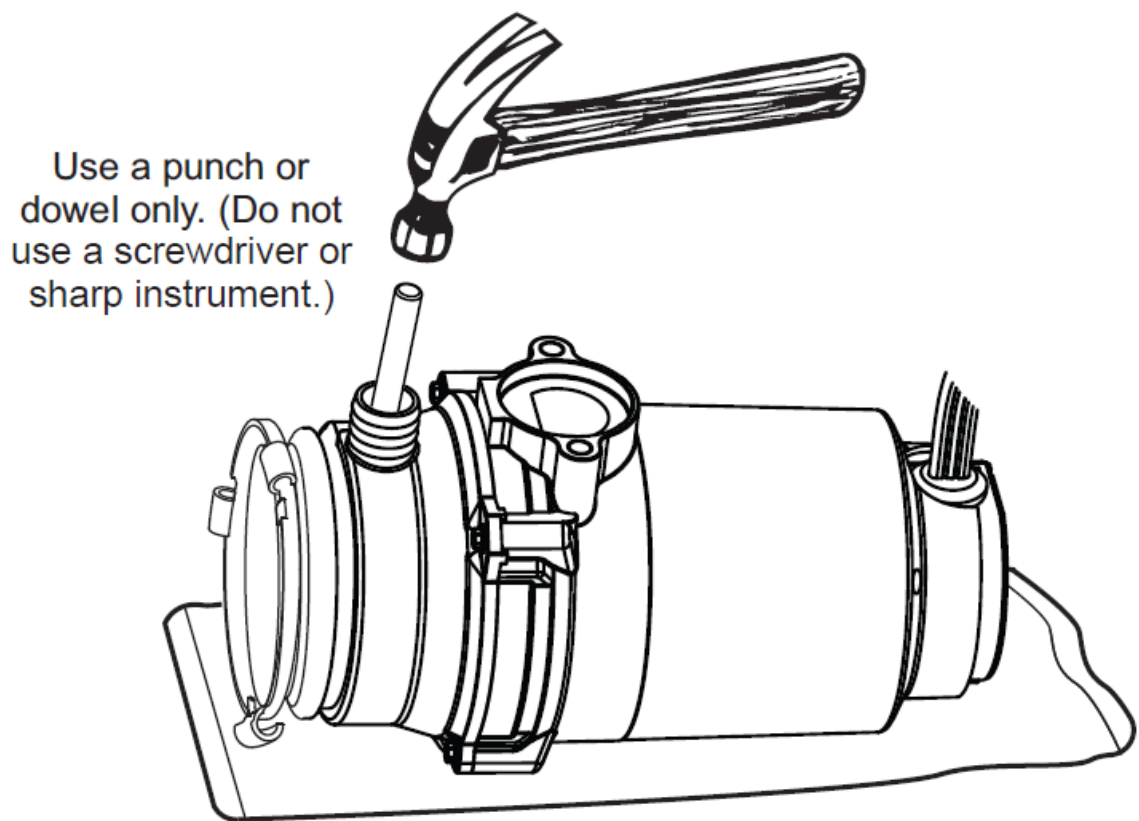

#### ATTACH THE DISCHARGE ELBOW

- Slide the discharge flange and then the discharge gasket onto the discharge elbow. Insert the discharge elbow and gasket into the disposer discharge outlet and attach the flange assembly to the disposer with the two screws.

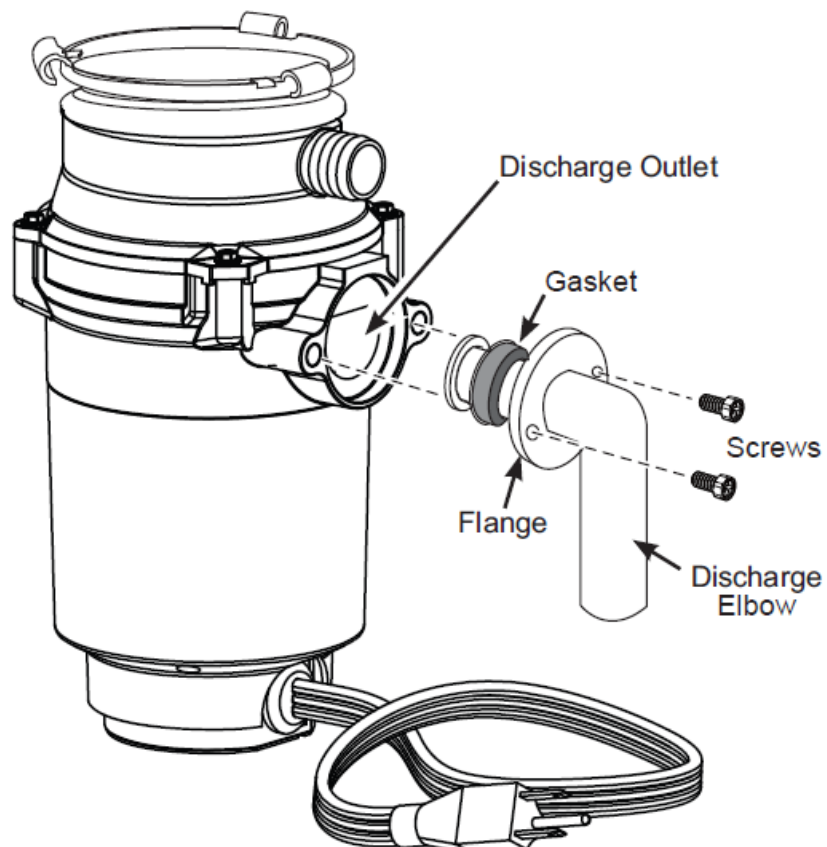

**NOTE:** Some installations may require a straight pipe or flexible drain pipe connection. Consult a licensed plumber as needed.

## MOUNT THE DISPOSER

**IMPORTANT:** Before performing this step, read it completely to understand how the disposer is mounted.

1. Apply a small amount of liquid soap (or petroleum jelly) onto the bottom of the cushion mount and to the bottom of the lower mounting ring to aid its sliding and rotation onto the upper mounting ring.

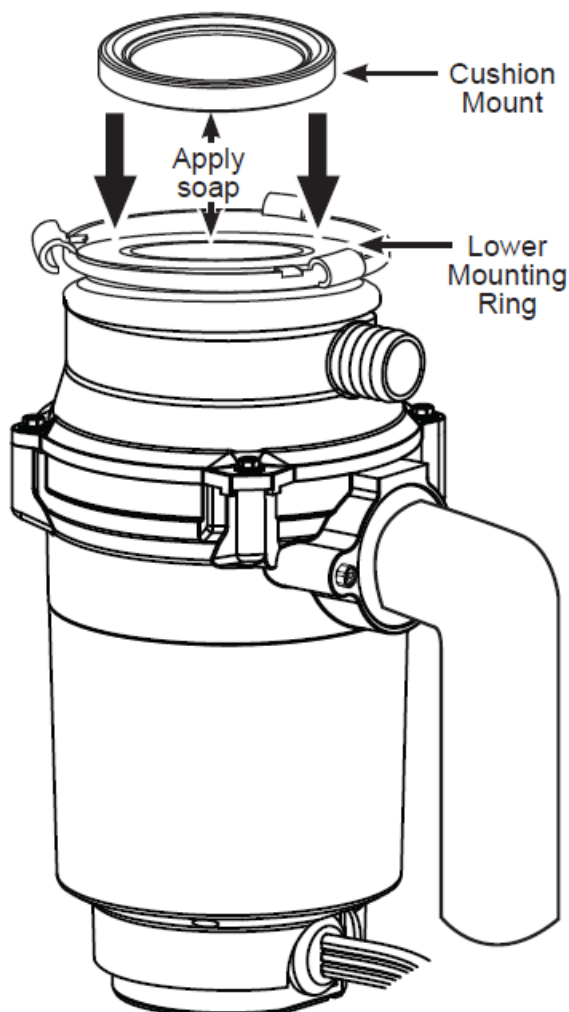

2. Seat the cushion mount onto the top ring of the disposer.

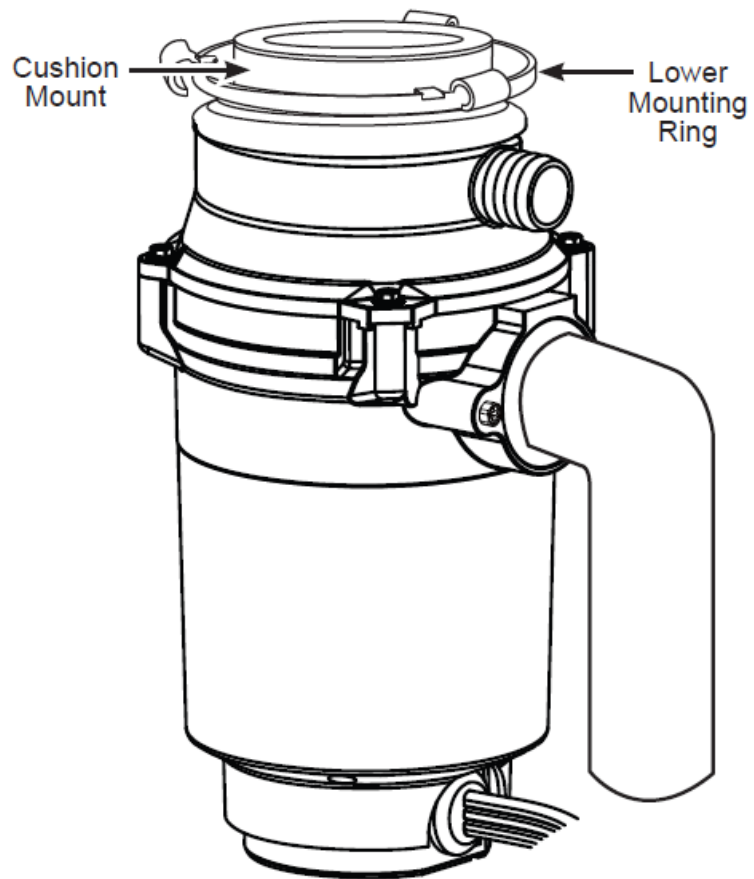

3. Lift and prop the disposer into place on the upper mounting ring. Mount it by turning the lower mounting ring until its tabs engage onto the slide ramps of the upper mounting ring.

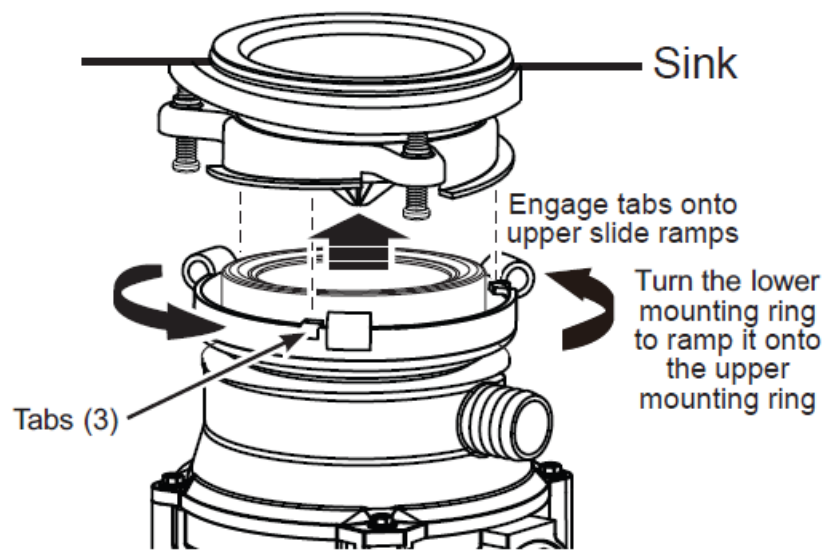

Insert a screwdriver into a lower hook and leverage it counterclockwise into place.

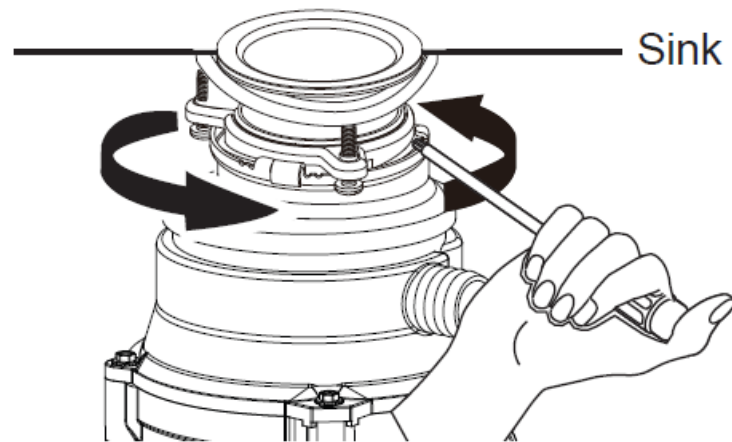

Use channel lock pliers to fully lock the lower mounting ring tabs onto the upper slide ramps

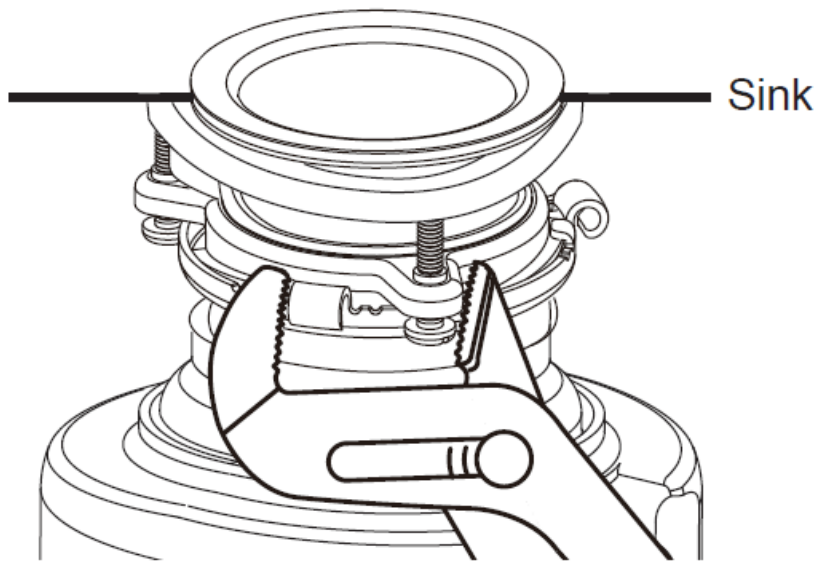

Shown fully locked:

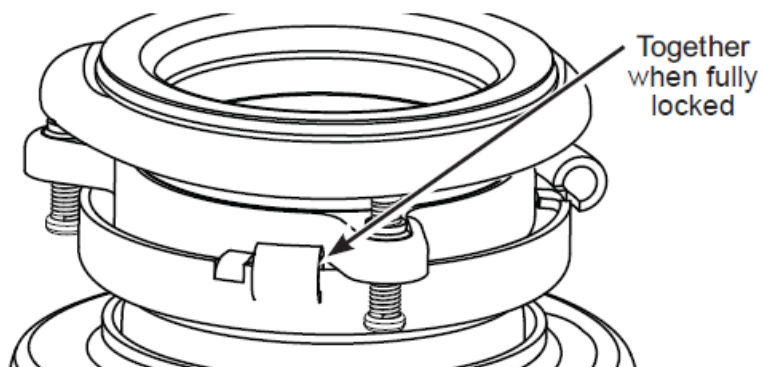

## CONNECT PLUMBING

1. Turn the disposer until the disposer discharge elbow lines up with the outlet drain pipe.

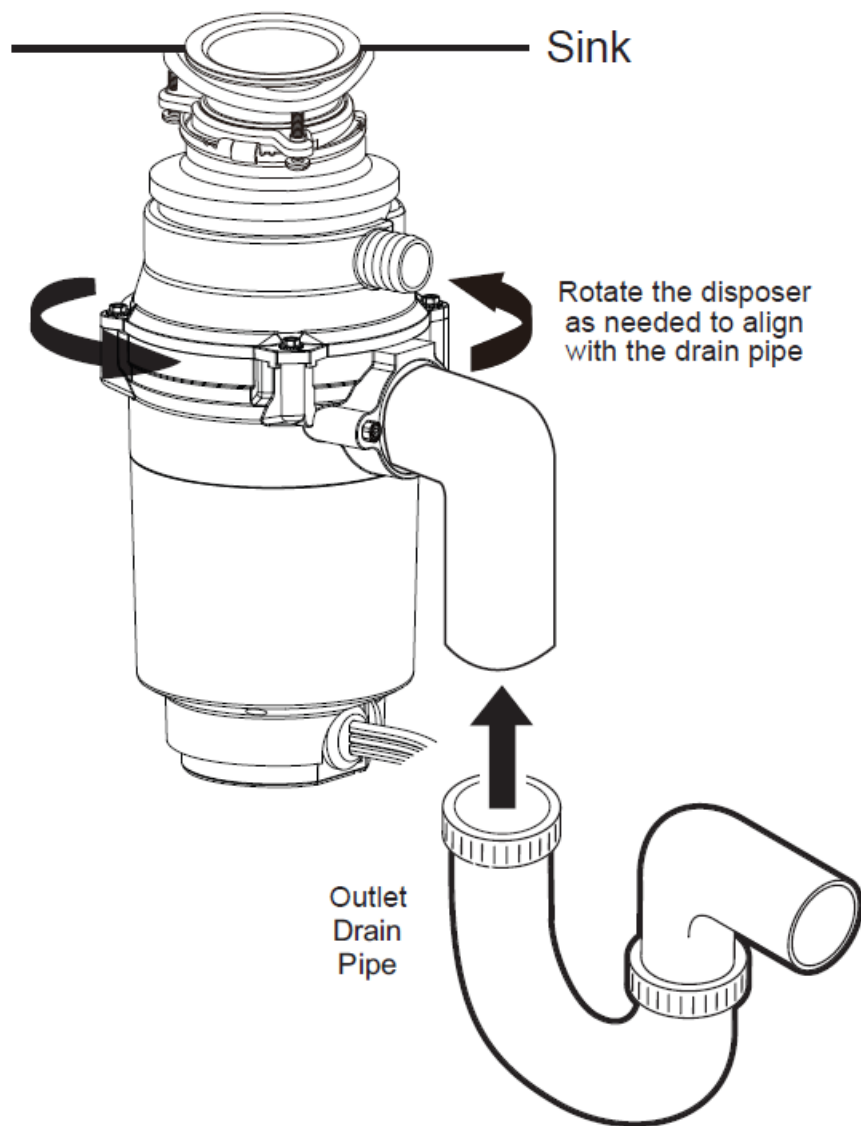

2. Securely connect all plumbing, including the drain pipe and the dishwasher drain (if used), observing all codes and ordinances.

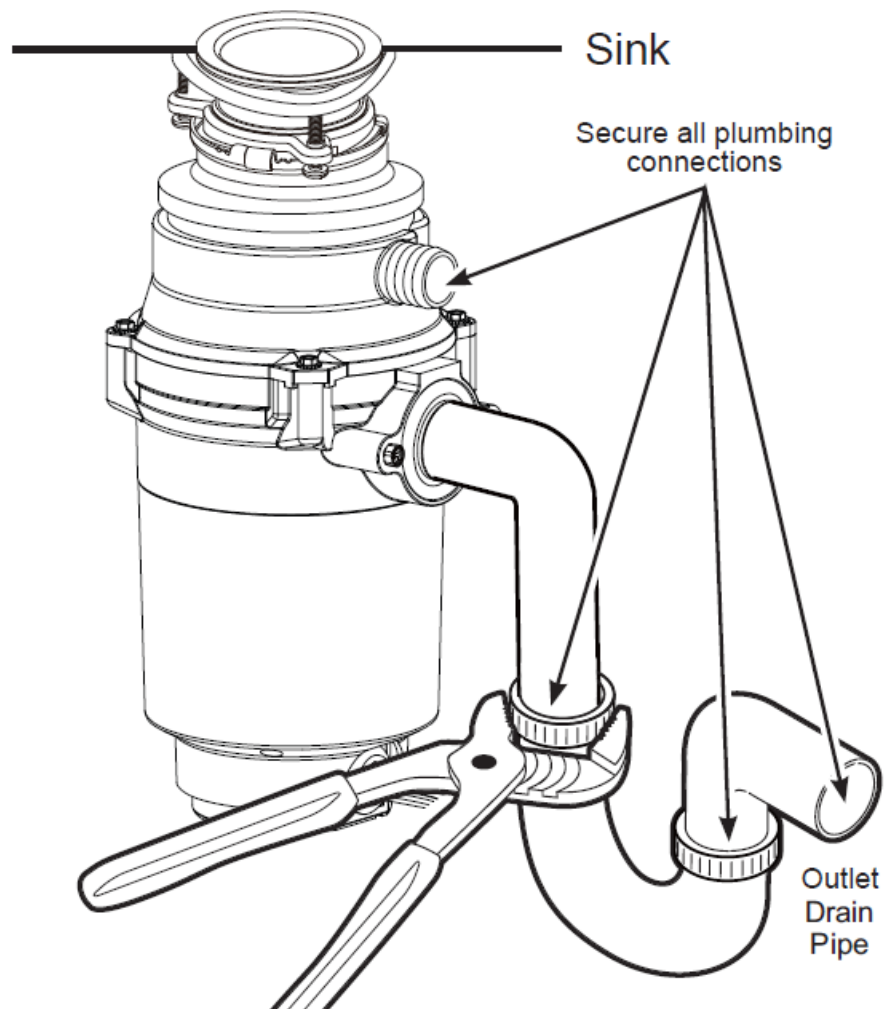

#### IF CONNECTING TO A DISHWASHER

- Connect the flexible drain hose to the dishwasher discharge using a hose clamp. If the hose size is different, you will need a stepped rubber adapter.

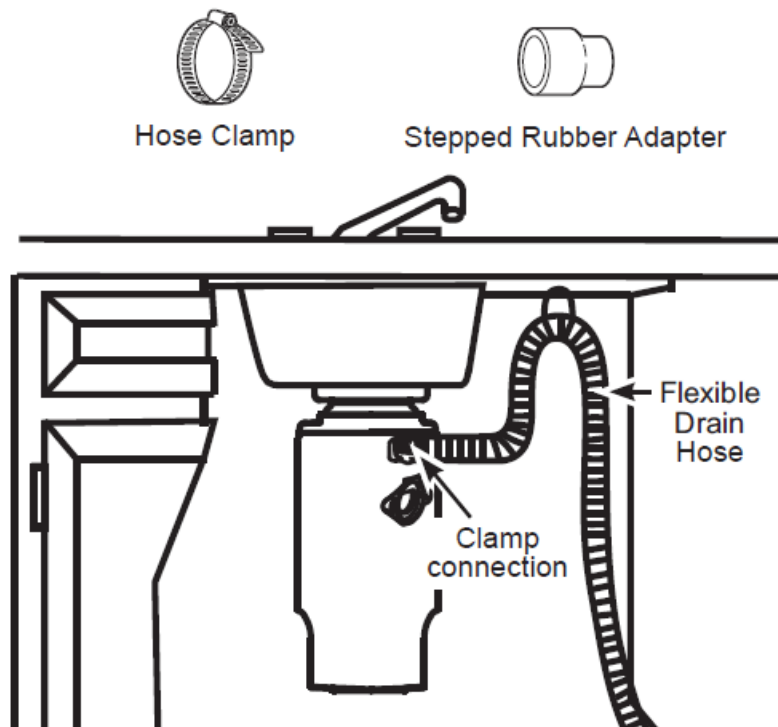

See the Installation Instructions that came with your dishwasher for details.

## INSTALL SPLASH GUARD AND STOPPER

- Press the splash guard into place in the sink flange. Insert the stopper over the splash guard.

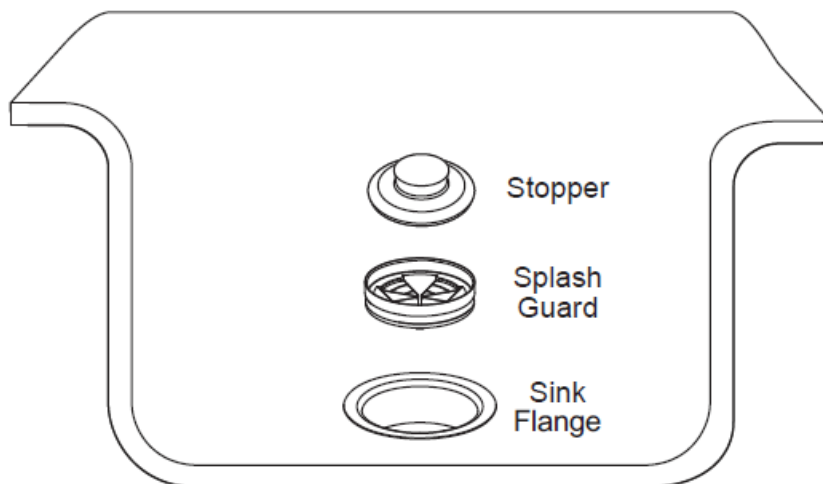

**NOTE:** Both the splash guard and stopper may be removed and cleaned as needed.

## CONNECT POWER AND TEST FOR LEAKS

- Plug the disposer into an outlet that is properly installed and grounded in accordance with all local codes and ordinances.
- Run water to check the disposer for leaks 24 hours after installation and first operation.
- Keep and refer to this Owner's Manual for proper use and care of this disposer.

## TROUBLESHOOTING TIPS

**SAFETY NOTE:** Before investigating, you must disconnect the power supply.

### WARNING

Before resetting, disconnect the power supply-please see SAFETY NOTE above. The overload control prevents the motor from operating should overloading occur. This feature protects your house wiring and your disposer. When overloaded, the motor will stop automatically.

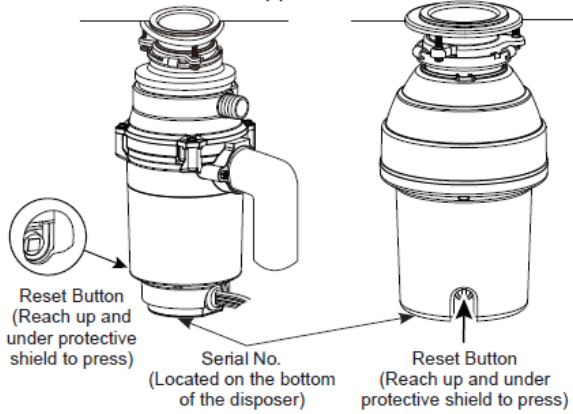
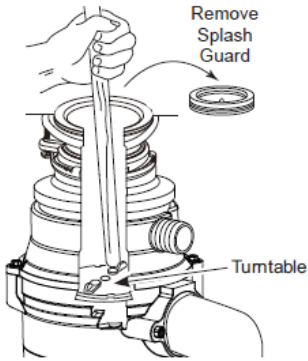
Problem	Possible Cause	What To Do
Loud noises (other than those during grinding of bones and fruit pits)	Silverware, bottle cap or other foreign object has fallen into the disposer	Remove the splash guard and remove the object with long-handled tongs. Replace the splash guard.
Disposer does not start	Reset button has been tripped  <p>Reset Button (Reach up and under protective shield to press)</p> <p>Serial No. (Located on the bottom of the disposer)</p> <p>Reset Button (Reach up and under protective shield to press)</p>	With the splash guard removed, check to see if the turntable will move freely using a broom handle. If the turntable moves freely, replace the splash guard and check the reset button to see if it has been tripped. The reset button is red, located opposite the discharge elbow, near the bottom of the disposer behind its protective shield. Reach up and under the protective shield and push the button in until it clicks and remains depressed. If the reset button has not been tripped, check for a shorted or broken wire connecting to the disposer. Check the electrical power switch, fuse box or circuit breaker. If wiring and electrical components are intact, the unit may have internal problems that require service or replacement.
	Turntable cannot rotate.  <p>Remove Splash Guard</p> <p>Turntable</p>	If the turntable does not turn freely, check for an object lodged between the turntable and the grind ring. Dislodge the object by moving the turntable with a broom handle. Then remove the object.  If no foreign object is present, there may be internal problems.
Disposer leaks	If the leak is at the top, it may be caused by: 1. Improper seating of sink flange (gasket choice, putty, or tightening). 2. Support ring not tightened properly. 3. Defective cushion mount. If the leak is at the discharge elbow, leak may be caused by improper tightening of elbow flange screws.	

## LIMITED WARRANTY

### GE Appliances Disposer Limited Warranty

(For customers in the United States) [GEAppliances.com](http://GEAppliances.com)

All warranty service is provided by our Factory Service Centers, or an authorized Customer Care® technician. To schedule service online, visit us at [GEAppliances.com/service](http://GEAppliances.com/service), or call GE Appliances at 833-4BODEWELL (833-426-3393). Please have your serial number and your model number available when calling for service

#### Warranty for GFC365 and GFC565 models only:

For the period of	GE Appliances will choose to repair or replace
Seven Years From the date of the original purchase	The product which fails due to a defect in materials or workmanship. The exchange unit is warranted for the remainder of your product's original seven-year warranty period. GE Appliances is not responsible for installation charges relating to the replacement product.

#### Warranty for GFC765 and GFC1065 models only:

For the period of	GE Appliances will choose to repair or replace
Ten Years From the date of the original purchase	The product which fails due to a defect in materials or workmanship. The exchange unit is warranted for the remainder of your product's original ten-year warranty period. GE Appliances is not responsible for installation charges relating to the replacement product.

Staple your receipt here. Proof of the original purchase date is needed to obtain service under the warranty.

#### **What is not covered:**

- Service trips to your home to teach you how to use the product.
- Improper installation, delivery or maintenance.
- Failure of the product if it is abused, misused, or used for other than the intended purpose or used commercially.
- Replacement of house fuses or resetting of circuit breakers.
- Products which are not defective or broken, or which are working as described in the Owner's Manual.
- Damage to the product caused by accident, fire, floods or acts of God.
- Incidental or consequential damage caused by possible defects with this appliance.
- Defects or damage due to operation in freezing temperatures.
- Damage caused after delivery.
- Product not accessible to provide required service.

#### **EXCLUSION OF IMPLIED WARRANTIES**

Your sole and exclusive remedy is product repair as provided in this Limited Warranty. Any implied warranties, including the implied warranties of merchantability or fitness for a particular purpose, are limited to one year or the shortest period allowed by law.

This limited warranty is extended to the original purchaser and any succeeding owner for products purchased for home use within the USA. If the product is located in an area where service by a GE Appliances Authorized Servicer is not available, you may be responsible for a trip charge or you may be required to bring the product to an Authorized GE Appliances Service location for service. In Alaska, the limited warranty excludes the cost of shipping or service calls to your home. Some states do not allow the exclusion or limitation of incidental or consequential damages. This limited warranty gives you specific legal rights, and you may also have other rights which vary from state to state. To know what your legal rights are, consult your local or state consumer affairs office or your state's Attorney General.

**Warrantor:** GE Appliances. a Haier Company. Louisville, KY 40225

**(For customers in Canada)**

[GEAppliances.ca](http://GEAppliances.ca)

Warranty service is provided by our Factory Service Centers, or an authorized Customer Care® technician. To schedule service online, visit us at [GEAppliances.ca/after-sales-support](http://GEAppliances.ca/after-sales-support), or call GE Appliances at 800.561.3344. Please have your serial number and your model number available when calling for service.

##### **Warranty for GFC365 and GFC565 models only:**

For the period of	GE Appliances will choose to repair or replace
Seven Years From the date of the original purchase	The product which fails due to a defect in materials or workmanship. The exchange unit is warranted for the remainder of your product's original seven-year warranty period. GE Appliances is not responsible for installation charges relating to the replacement product.

##### **Warranty for GFC765 and GFC1065 models only:**

For the period of	GE Appliances will choose to repair or replace
Ten Years From the date of the original purchase	The product which fails due to a defect in materials or workmanship. The exchange unit is warranted for the remainder of your product's original ten-year warranty period. GE Appliances is not responsible for installation charges relating to the replacement product.

**What is not covered:**

- Service trips to your home to teach you how to use the product.
- Improper installation, delivery or maintenance.
- Failure of the product if it is abused, misused, or used for other than the intended purpose or used commercially.
- Replacement of house fuses or resetting of circuit breakers.
- Products which are not defective or broken, or which are working as described in the Owner's Manual.
- Damage to the product caused by accident, fire, floods or acts of God.
- Incidental or consequential damage caused by possible defects with this appliance.
- Defects or damage due to operation in freezing temperatures.
- Damage caused after delivery. Product not accessible to provide required service.

**EXCLUSION OF IMPLIED WARRANTIES**

Your sole and exclusive remedy is product repair as provided in this Limited Warranty. Any implied warranties, including the implied warranties of merchantability or fitness for a particular purpose, are limited to one year or the shortest period allowed by law.

**GE Appliances Service location.**

This limited warranty is extended to the original purchaser and any succeeding owner for products purchased in Canada for home use within Canada. If the product is located in an area where service by a GE Appliances Authorized Servicer is not available, you may be responsible for a trip charge or you may be required to bring the product to an Authorized Service location. Some provinces do not allow the exclusion or limitation of incidental or consequential damages. This limited warranty gives you specific legal rights, and you may also have other rights that vary from province to province. To know what your legal rights are, consult your local or provincial consumer affairs office. Warrantor: MC Commercial Inc., Burlington, ON, L7R 5B6

**CONSUMER SUPPORT****GE Appliances Website**

Have a question or need assistance with your appliance? Try the GE Appliances Website 24 hours a day, any day of the year! You can also shop for more great GE Appliances products and take advantage of all our on-line support services designed for your convenience. In the US: [GEAppliances.com](http://GEAppliances.com)

In Canada: [GEAppliances.ca](http://GEAppliances.ca)

**Register Your Appliance**

Register your new appliance on-line at your convenience! Timely product registration will allow for enhanced communication and prompt service under the terms of your warranty, should the need arise. You may also mail in the pre-printed registration card included in the packing material. In the US: [GEAppliances.com/register](http://GEAppliances.com/register)

In Canada: [GEAppliances.ca/after-sales-support](http://GEAppliances.ca/after-sales-support)

**Schedule Service**

Expert GE Appliances repair service is only one step away from your door. Get on-line and schedule your service at your convenience any day of the year. In the US: [GEAppliances.com/service](https://GEAppliances.com/service) or call 833-4BODEWELL ([833-426-3393](tel:833-426-3393)) during normal business hours.

In Canada: [GEAppliances.ca/after-sales-support](https://GEAppliances.ca/after-sales-support) or call 800.561.3344.

## Extended Warranties

Purchase a GE Appliances extended warranty and learn about special discounts that are available while your warranty is still in effect. You can purchase it online anytime. GE Appliances Services will still be there after your warranty expires. In the US: [GEAppliances.com/extended-warranty](https://GEAppliances.com/extended-warranty) or call 800.626.2224 during normal business hours.

In Canada: [GEAppliances.ca/purchase-extended-warranty](https://GEAppliances.ca/purchase-extended-warranty) or call 866.277.9842.

## Parts and Accessories

- Individuals qualified to service their own appliances can have parts or accessories sent directly to their homes (VISA, MasterCard and Discover cards are accepted). Order on-line today 24 hours every day.
- **In the US:** [GEApplianceparts.com](https://GEApplianceparts.com) or by phone at 877.959.8688 during normal business hours.
- **In Canada:** [GEAppliances.ca/parts-filters-accessories](https://GEAppliances.ca/parts-filters-accessories) or call 800.661.1616.
- Instructions contained in this manual cover procedures to be performed by any user. Other servicing generally should be referred to qualified service personnel. Caution must be exercised, since improper servicing may cause unsafe operation.

## Contact Us

- If you are not satisfied with the service you receive from GE Appliances, contact us on our Website with all the details including your phone number, or write to:
- In the US: General Manager, Customer Relations | GE Appliances, Appliance Park | Louisville, KY 40225  
[GEAppliances.com/contact](https://GEAppliances.com/contact) or call 800.626.2000
- In Canada: Director, Customer Relations | MC Commercial Inc. | Suite 300, 5420 North Service Road | Burlington, ON L7L 6C7 [GEAppliances.ca/contact-us](https://GEAppliances.ca/contact-us) or call 877.994.5366
- For answers to your Monogram, Café™, GE Profile™ or GE Appliances product questions, visit our website at [geappliances.com](https://geappliances.com) or call GE Answer Center® Service, at 800.626.2000.

## FAQs

- **What is not covered under the warranty?**
  - Service visits for product usage education, improper installation or maintenance, commercial use, house fuses, circuit breakers, natural disasters, and consequential damages are not covered.
- **What does the warranty cover?**
  - The warranty covers replacement and labor charges for the disposer within the specified time frames based on the original purchase date.

## Documents / Resources

	<b><a href="#">GE APPLIANCES GFC765W Continuous Feed Garbage Disposer</a> [pdf] Instructions</b> GFC765W, GFC565W, GFC765W Continuous Feed Garbage Disposer, GFC765W, Continuous Feed Garbage Disposer, Feed Garbage Disposer, Garbage Disposer
--	--

References

- [800.ge | حسین عطار جان نثار نویری ، کار افرین و صنعتگر در صنعت نساجی ایران](#)
- [GE Appliances Service and Support by Product Line](#)
- [User Manual](#)

[Manuals+](#), [Privacy Policy](#)

This website is an independent publication and is neither affiliated with nor endorsed by any of the trademark owners. The "Bluetooth®" word mark and logos are registered trademarks owned by Bluetooth SIG, Inc. The "Wi-Fi®" word mark and logos are registered trademarks owned by the Wi-Fi Alliance. Any use of these marks on this website does not imply any affiliation with or endorsement.