



GE APPLIANCES GFC365 Continuous Feed Garbage Disposer Corded User Guide

[Home](#) » [GE Appliances](#) » [GE APPLIANCES GFC365 Continuous Feed Garbage Disposer Corded User Guide](#) 

Contents

- [1 GE APPLIANCES GFC365 Continuous Feed Garbage Disposer Corded](#)
- [2 IMPORTANT SAFETY INFORMATION](#)
- [3 CONNECTING ELECTRICITY](#)
- [4 Care and Cleaning](#)
- [5 Installation Instructions](#)
- [6 DIMENSIONS](#)
- [7 WHAT YOU WILL NEED](#)
- [8 COMPONENTS](#)
- [9 PREPARATION](#)
- [10 DISASSEMBLE TO INSTALL](#)
- [11 Documents / Resources](#)
 - [11.1 References](#)
- [12 Related Posts](#)



GE APPLIANCES

GE APPLIANCES GFC365 Continuous Feed Garbage Disposer Corded



Safety Information

It is important to read and follow all instructions before using the appliance to minimize the risk of fire, explosion, electric shock, and to prevent property damage, personal injury, or death.

When using your electrical appliances, please follow these basic safety precautions:

- Only use the disposer for its intended purpose as described in the Owner's Manual.
- Ensure that all safety precautions are followed when operating the disposer.
- Keep the disposer out of reach of children.
- Avoid using any metal objects that may cause damage or injury.
- Avoid putting certain items into the disposer, such as clam or oyster shells, caustic drain cleaners, glass, china or plastic, large whole bones, metal objects, hot grease or other hot liquids, and whole corn husks.
- Do not put hands or any foreign objects into the disposer while it is in operation.
- Refer to the "Connecting Electricity" section for proper electrical connection.

Using the Disposer

Follow these steps to use the disposer:

1. Ensure that the disposer is properly installed and connected to electricity.
2. Turn on the water and run it into the sink.
3. Turn on the disposer by flipping the switch or pressing the button.
4. Slowly feed small amounts of food waste into the disposer.
5. Continue running water for a few seconds after turning off the disposer to ensure all waste is flushed away.

Care and Cleaning

To care for and clean the disposer:

1. Avoid using harsh chemicals or cleaners on the disposer.
2. Regularly clean the disposer by grinding ice cubes or citrus peels.
3. Flush the disposer with water after each use.
4. Refer to the Owner's Manual for specific cleaning instructions.

Installation Instructions

Please follow these instructions for proper installation of the disposer:

1. Refer to the Owner's Manual for detailed installation instructions specific to your model.
2. If you are not familiar with electrical power and procedures, it is recommended to call a qualified electrician for assistance.
3. Ensure proper grounding of the appliance by checking with a qualified electrician or serviceman.
4. If the provided plug does not fit the outlet, have a qualified electrician install a proper outlet.

Troubleshooting

If you encounter any issues with the disposer, please refer to the Troubleshooting section in the Owner's Manual or contact Consumer Support for assistance.

Limited Warranty

Refer to the Limited Warranty section in the Owner's Manual for details on the warranty coverage for your disposer.

Consumer Support

For any questions or support regarding your disposer, refer to the Consumer Support section in the Owner's Manual for helpful websites and phone numbers. You can also register your appliance online or mail in the pre-printed registration card included in the packing material.

FAQ

- **Q: What should I do if the disposer does not turn on?**
 - A: Check that the disposer is properly connected to electricity and ensure that the switch or button is in the "on" position. If the issue persists, refer to the Troubleshooting section in the Owner's Manual or contact Consumer Support.
- **Q: Can I put glass or metal objects into the disposer?**
 - A: No, it is recommended to avoid putting glass, china, plastic, metal objects, or any non-food waste into the disposer as it may cause damage or clog the system. Refer to the usage instructions for a list of items to avoid putting into the disposer.
- **Q: How often should I clean the disposer?**
 - A: It is recommended to clean the disposer regularly by grinding ice cubes or citrus peels. Refer to the

Care and Cleaning section in the Owner's Manual for more detailed instructions.

THANK YOU FOR MAKING GE APPLIANCES A PART OF YOUR HOME.

Whether you grew up with GE Appliances, or this is your first, we're happy to have you in the family.

We take pride in the craftsmanship, innovation, and design that goes into every GE Appliances product, and we think you will too. Among other things, registration of your appliance ensures that we can deliver important product information and warranty details when you need them.

Register your GE appliance now online. Helpful websites and phone numbers are available in the Consumer Support section of this Owner's Manual. You may also mail in the pre-printed registration card included in the packing material.

IMPORTANT SAFETY INFORMATION

READ ALL INSTRUCTIONS BEFORE USING THE APPLIANCE

WARNING For your safety, the information in this manual must be followed to minimize the risk of fire, explosion, electric shock, and to prevent property damage, personal injury, or death.

WARNING WHEN USING YOUR ELECTRICAL APPLIANCES, BASIC SAFETY PRECAUTIONS SHOULD BE FOLLOWED, INCLUDING THE FOLLOWING:

- Use this appliance only for its intended purpose as described in this Owner's Manual.
- Read all the instructions before using the appliance
- To reduce the risk of injury, close supervision is required when a disposer is used near children.
- Do not put fingers or hands into a waste disposer.
- Turn the power switch to the OFF position before attempting to clear a jam or remove an object from the disposer.
- When attempting to loosen a jam in a waste disposer, use a long wooden object such as a wooden spoon or the wooden handle of a broom or mop.
- When attempting to remove objects from a waste disposer, use long-handled tongs or pliers. If the disposer is magnetically actuated, use only nonmagnetic tools.
- To reduce the risk of injury by materials that may be expelled by a waste disposer, do not put the following into a disposer:
 - **a.** Clam or oyster shells
 - **b.** Caustic drain cleaners or similar products
 - **c.** Glass, china or plastic
 - **d.** Large whole bones
 - **e.** Metal, such as bottle caps, tin cans, utensils or aluminum foil
 - **f.** Hot grease or other hot liquids
 - **g.** Whole corn husks
- When not operating a disposer, leave the drain stopper in place to reduce the risk of objects falling into the disposer.
- For proper grounding instructions, see the CONNECTING ELECTRICITY portion of this manual.

CONNECTING ELECTRICITY

If you are not familiar with electrical power and procedures, call a qualified electrician.

WARNING Improper connection of the equipment-grounding conductor can result in a risk of electric shock. Check with a qualified electrician or serviceman if you are in doubt as to whether the appliance is properly grounded. Do not modify the plug provided with the appliance if it will not fit the outlet; have a proper outlet installed by a qualified electrician.

For Models Equipped with a Grounded Cord:

GROUNDING INSTRUCTIONS: This disposer must be grounded to reduce the risk of electric shock in the event of a malfunction or breakdown. Grounding provides a path of least resistance for electric current. This disposer is equipped with a cord having an equipment-grounding conductor and a grounding plug. The plug must be plugged into an outlet that is properly installed and grounded in accordance with all local codes and ordinances.

Proper Disposal of your Appliance

- Dispose of or recycle your appliance in accordance with Federal and Local Regulations. Contact your local authorities for the environmentally safe disposal or recycling of your appliance.
- Consider recycling options for your appliance packaging material.

READ AND SAVE THESE INSTRUCTIONS

Using the Disposer / Care and Cleaning

READ ALL SAFETY INSTRUCTIONS BEFORE USING THIS DISPOSER.

- **A.** Remove the sink stopper and turn on a medium flow D. Before turning the disposer off, let the water and of cold water.
- **B.** Turn the switch to ON.
- **C.** Scrape in food waste. To speed up food waste disposal, cut or break up large bones, rinds and cobs. Large bones and fibrous husks require considerable grinding time and are more easily thrown away with other trash. Do not be alarmed that the disposer slows down while grinding. The disposer is actually increasing torque (grinding power) and is operating under normal conditions. the disposer run for approximately 25 seconds after shredding stops. This assures that all waste is thoroughly flushed through the trap and drain.
- **E.** Do not use hot water while running the disposer. Cold water will keep food waste and fats solid so they can be flushed down the drain.

Helpful Hints

- **A.** Be sure the disposer is empty before using the dishwasher so it can drain properly.
- **B.** You may want to leave the stopper in the drain when not in use to prevent utensils and foreign objects from falling into the disposer.
- **C.** The disposer is ruggedly built to give you years and years of trouble-free service. It will handle all normal food wastes – BUT it will not grind and dispose of such items as tin cans, bottles and bottle caps, glass, china,

leather, cloth, crockery, rubber, string, feathers, or clam or oyster shells. These are waste materials and belong in the trash can or trash compactor.

- **D. TO SPEED UP FOOD WASTE DISPOSAL:** Cut or break up large bones, melon rinds, grapefruit skins, and corn cobs. Items such as large bones, and fibrous husks like lima bean pods and corn husks, require considerable cutting time. For this reason, you may prefer to place them in the trash can or trash compactor.

Care and Cleaning

THE MOTOR IS PERMANENTLY LUBRICATED FOR LIFE. DO NOT ATTEMPT TO LUBRICATE YOUR DISPOSER.

The disposer is self-cleaning and scours itself with each use.

- NEVER put lye or chemical cleaners into the disposer, through the disposer. A dozen ice cubes sprinkled with
- Your disposer is equipped with a removable splash guard. A little household scouring powder will also work. Guard for ease of cleaning or replacement. Remove the splash guard by pulling it out from the top. To replace it, insert it into the sink flange and push it down until it is properly seated.
- If an odor develops, run orange or lemon rinds as they cause serious corrosion of metal parts.

Installation Instructions

If you have any questions, call GE Appliances at 800.GE.CARES (800.432.2737) or visit our Website at:

GEAppliances.com

In Canada, call 800.561.3344 or visit www.GEAppliances.ca

BEFORE YOU BEGIN

Read these instructions completely and carefully.

FOR YOUR SAFETY

Read and observe all WARNINGS and CAUTIONS shown throughout these instructions. While performing installations described in this booklet, gloves, and safety glasses or goggles should be worn.

- **IMPORTANT** – Observe all governing codes and ordinances.
- Save these instructions for the local inspector's use.
- Note to Installer – Be sure to leave these instructions with the consumer.
- Note to Consumer – Keep these instructions for future reference.
- Skill level – Installation of this appliance requires basic mechanical skills.
- Proper installation is the responsibility of the installer.

A WARNING

- **FOR PERSONAL SAFETY:** Remove the house fuse or open circuit breaker before beginning installation. Do not use an extension cord or adapter plug with this appliance
- **FOR PERSONAL SAFETY:** Do not position your head or body under the disposer; the unit could fall during removal or installation.

- The improper connection of the equipment grounding conductor can result in a risk of electric shock. Check with a qualified electrician or service representative if you are in doubt that the appliance is properly grounded.
- If house wiring is not 2-wire with ground, a ground must be provided by the installer. When house wiring is aluminum, be sure to use UL-listed anti-oxidant compound and aluminum-to-copper connectors.
- Product failure due to improper installation is not covered under the Warranty.

DIMENSIONS

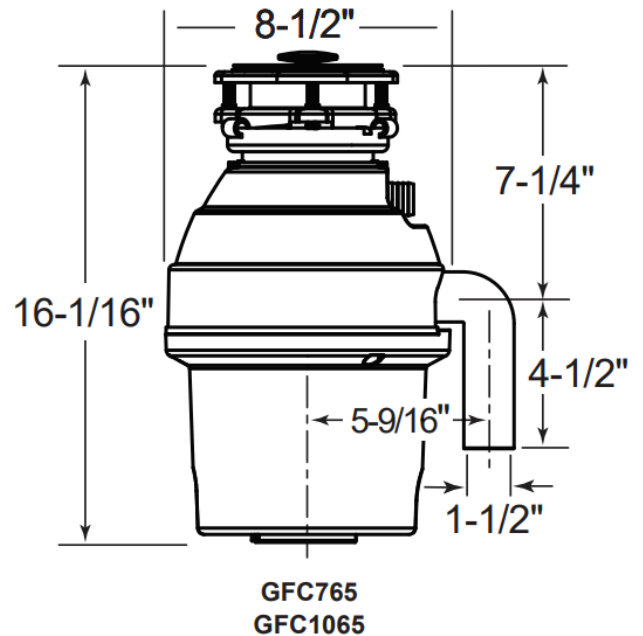
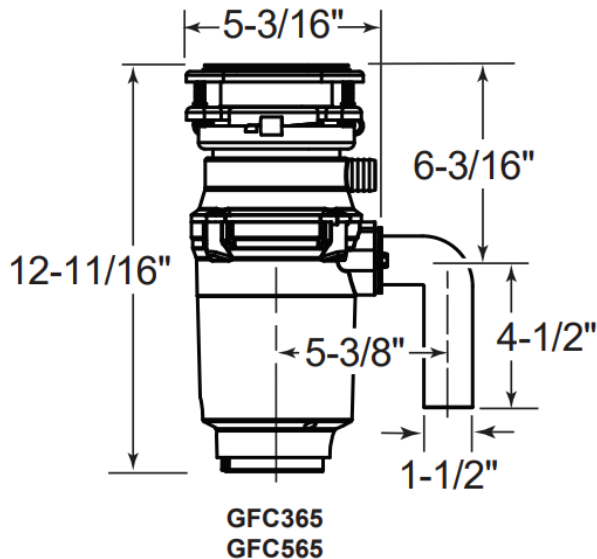

SOME TYPICAL INSTALLATIONS

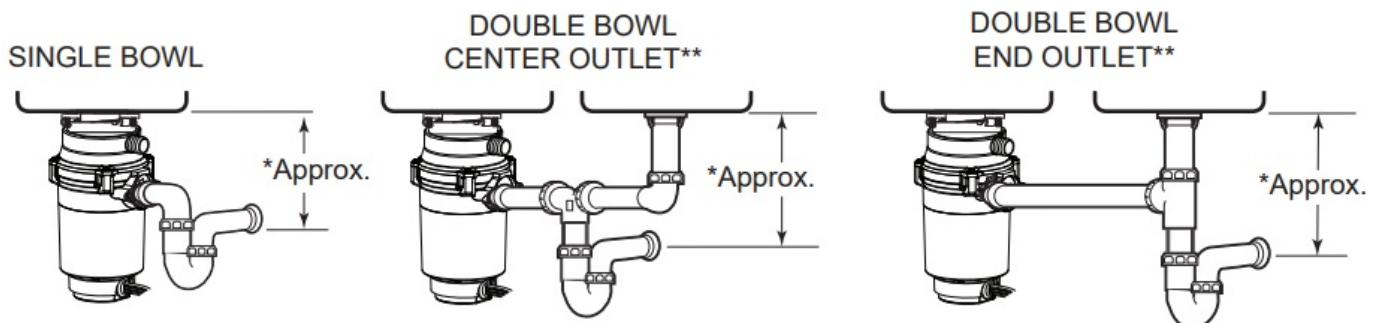

- It is essential for the proper operation of the disposer that this dimension be 9"-12" to avoid standing water in the disposer motor housing.
- Elovibro drain nine may be necessary for this application

WHAT YOU WILL NEED



- Phillips and flat blade screwdrivers



- Channel lock pliers, slip joint

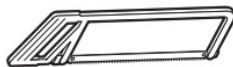

- Hacksaw



- Flashlight



- Hammer



- Nut Driver

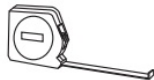

- Tape Measure



- Liquid soap (or petroleum jelly)



- Putty Knife



- Plumbers Putty



- Safety Glasses



- Gloves

Only needed if connecting to a dishwasher:



- Hose clamp(s)



- Flexible Drain Hose



- Wooden dowel or steel punch

COMPONENTS

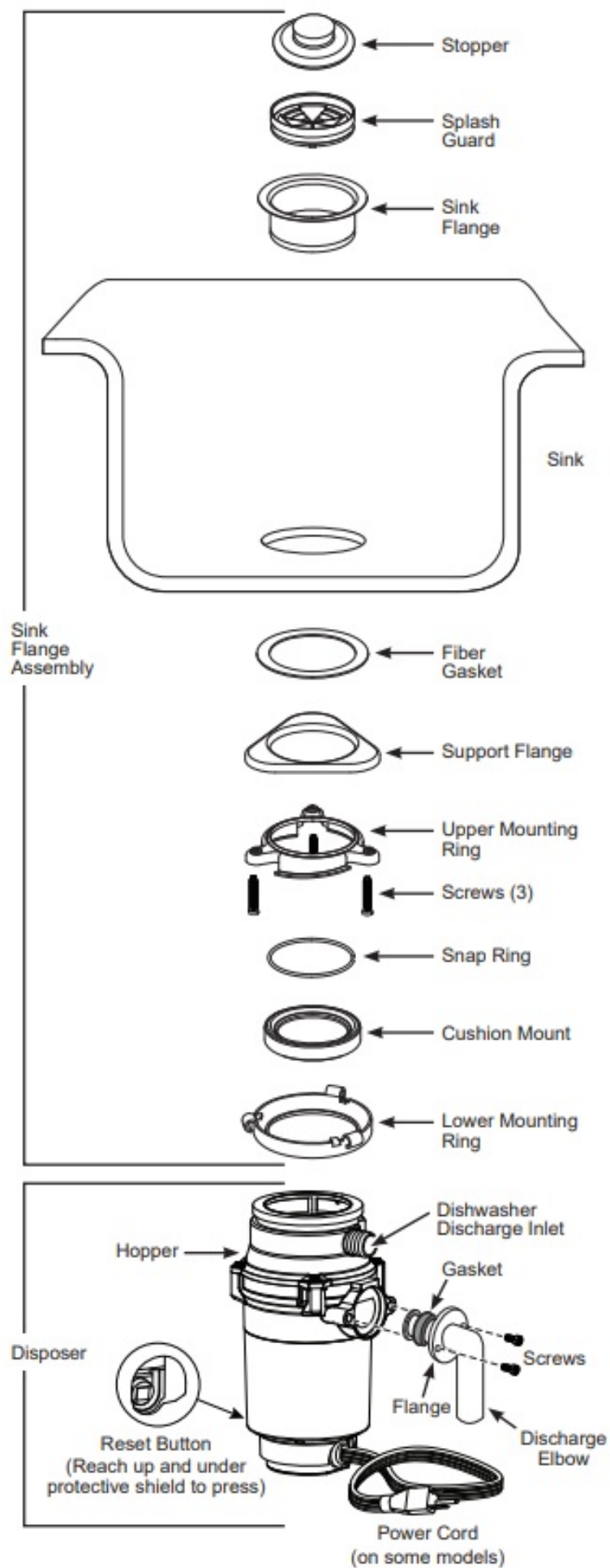

PREPARATION

1. Disconnect the electrical power supply to the disposer.
2. Remove the old disposer or sink flange assembly.
3. Inspect the drain line. If it is heavily coated with hardened grease and accumulations, rout out with a plumber's snake.
4. Remove old sealing materials and gaskets from sink openings, both top and bottom.
 - **NOTE:** The top and bottom of sink surfaces must be clean, dry, and free of any residue to prevent leaks.

DISASSEMBLE TO INSTALL

1. Turn the lower mounting ring clockwise until it releases and lift the entire hardware assembly from the dinner

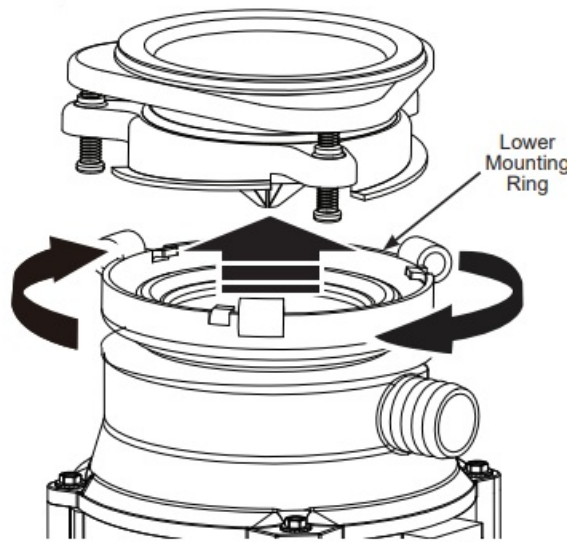

2. Loosen the three screws from the upper mounting ring and slide it toward the support flange.

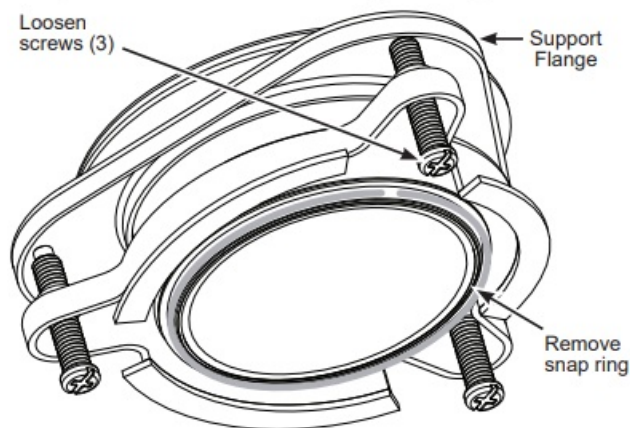

3. Insert a flat-blade screwdriver under the snap ring and remove it.
4. Separate the upper mounting ring and support flange from the sink flange.

INSTALL THE SINK FLANGE

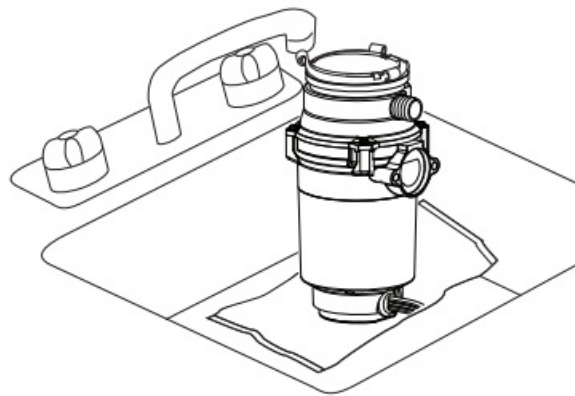
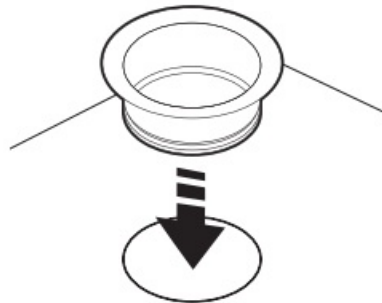
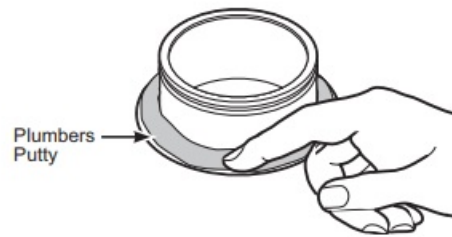

1. Roll plumber putty in a 3/8" thick rope, turn the sink flange up-side-down, and apply around the bottom of the flange
2. Install the sink flange into the sink opening by pressing it in firmly and removing excess plumber putty.
3. Place a towel over the sink bottom and flange, and weigh the flange down to hold it in place while you add the other mounting components.

INSTALL THE UNDER-SINK MOUNTING HARDWARE

and upper mounting ring onto the lower sink flange.

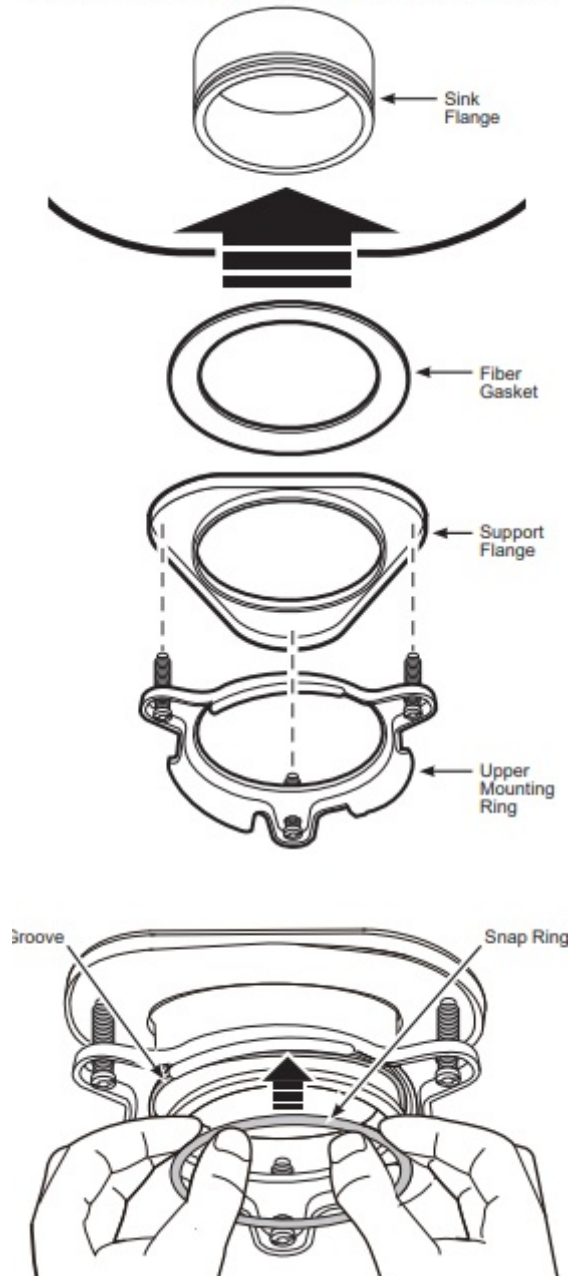

1. Assemble together the fiber gasket, support flange, and upper mounting ring onto the lower sink flange. Secure the assembly in place on the sink flange by inserting the snap ring into the sink flange snap groove.
 - **IMPORTANT:** Make sure the snap ring is secured into place in the snap groove. If the snap ring is not secured in the snap groove, trapping the assembled parts in place, then the disposer cannot be properly installed.

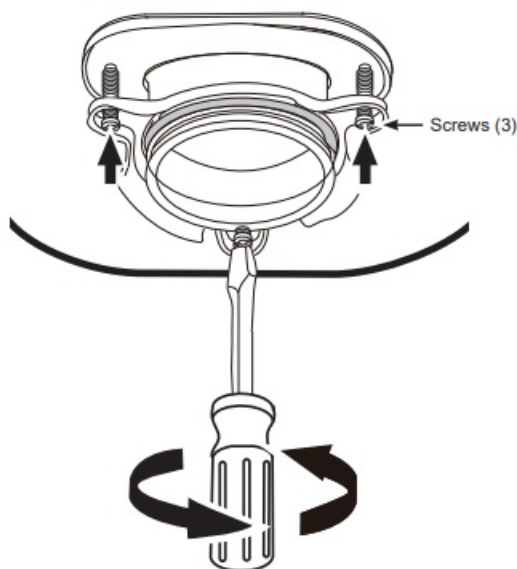

2. Tighten the three upper mounting ring screws into the support flange.

IF CONNECTING TO A DISHWASHER

If you are connecting to a dishwasher, complete this step. If a dishwasher is not to be connected, skip to ATTACH THE DISCHARGE ELBOW section and continue.

- Set the disposer on the floor. Place it on its side on a protected surface. Use a blunt instrument (steel punch or wooden dowel), to knock out the entire dishwasher discharge plug. Do not use a screwdriver or sharp instrument. When knockout plug falls into disposer, you may remove it or simply grind it up when the disposer is used. This will not damage the disposer in any way, but may take some time to grind, over the course of several uses.

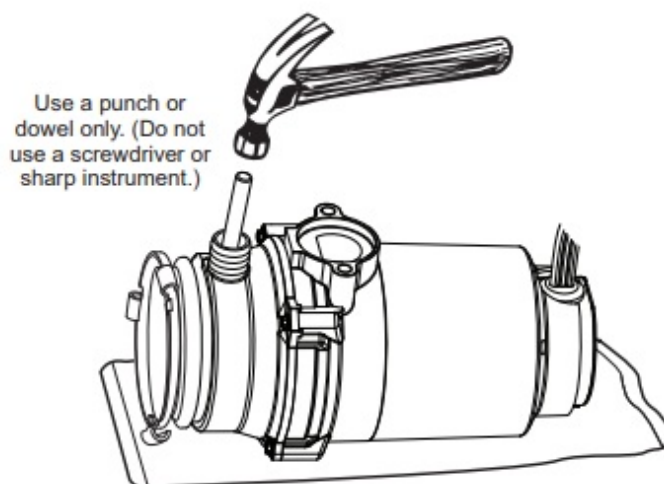

ATTACH THE DISCHARGE ELBOW

- Slide the discharge flange and then the discharge gasket onto the discharge elbow. Insert the discharge elbow and gasket into the disposer discharge outlet and attach the flange assembly to the disposer with the two screws.

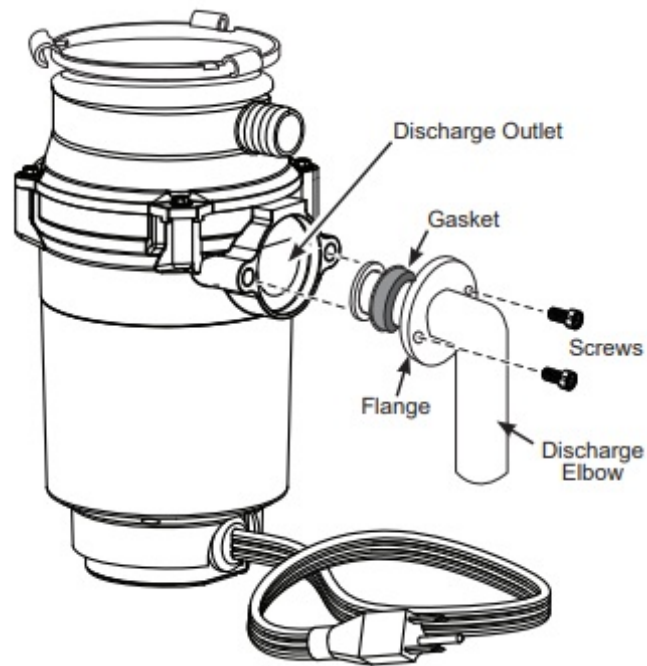

NOTE: Some installations may require a straight pipe or flexible drain pipe connection. Consult a licensed plumber as needed.

MOUNT THE DISPOSER

IMPORTANT: Before performing this step, read it completely to understand how the disposer is mounted.

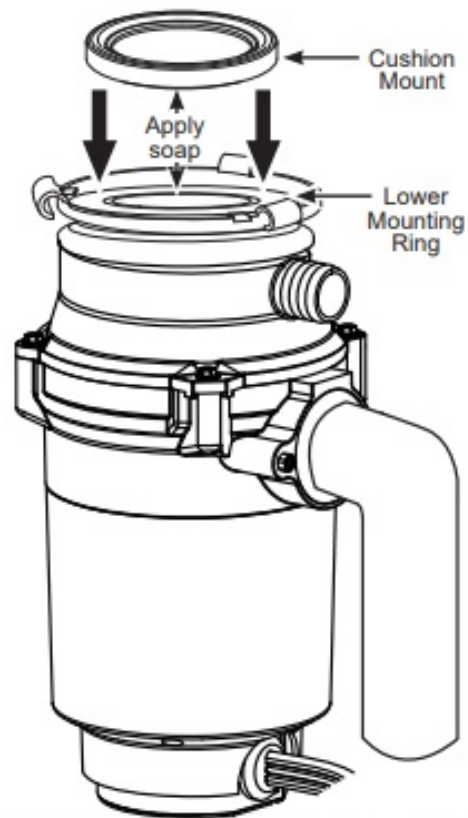

Seal the cushion mount onto the top ring of the disposer.

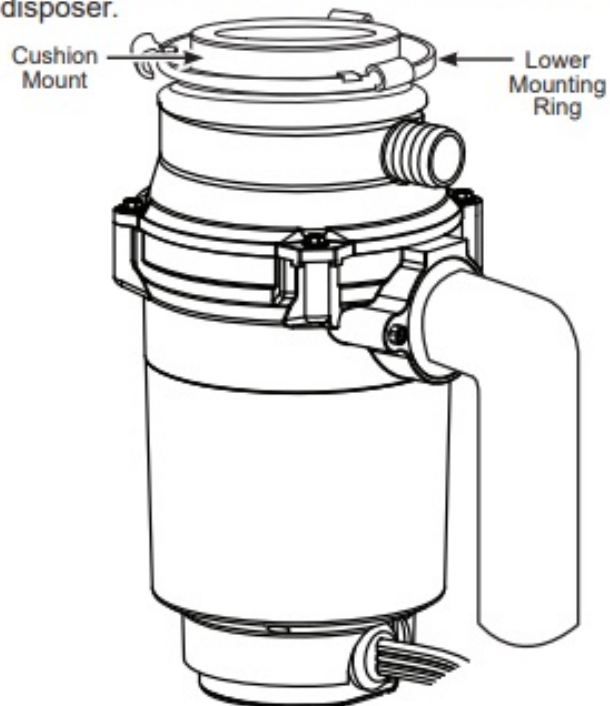

1. Apply a small amount of liquid soap (or petroleum jelly) onto the bottom of the cushion mount and to the bottom of the the lower mounting ring to aid its sliding and rotation onto the upper mounting ring.
2. Seal the cushion mount onto the top ring of the disposer.

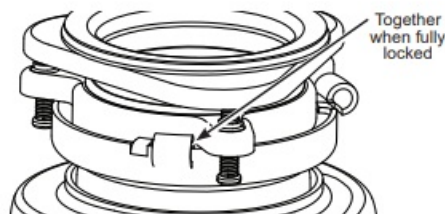
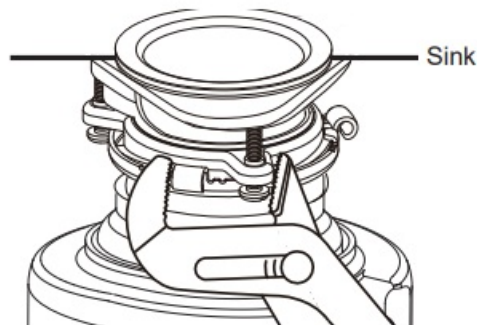
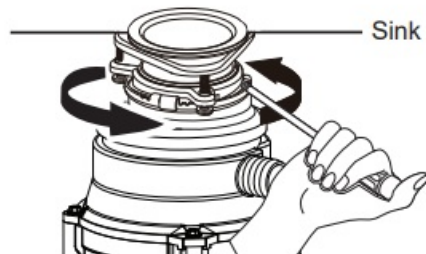
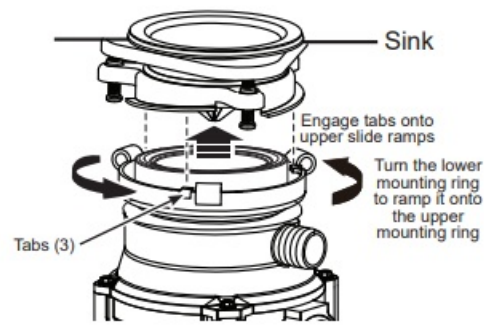

3. Lift and prop the disposer into place on the upper mounting ring. Mount it by turning the lower mounting ring until its tabs engage onto the slide ramps of the inner mounting ring

CONNECT PLUMBING

1. Turn the disposer until the disposer discharge elbow lines up with the outlet drain pipe.
2. Securely connect all plumbing, including the drain pipe and the dishwasher drain (if used), observing all codes and ordinances

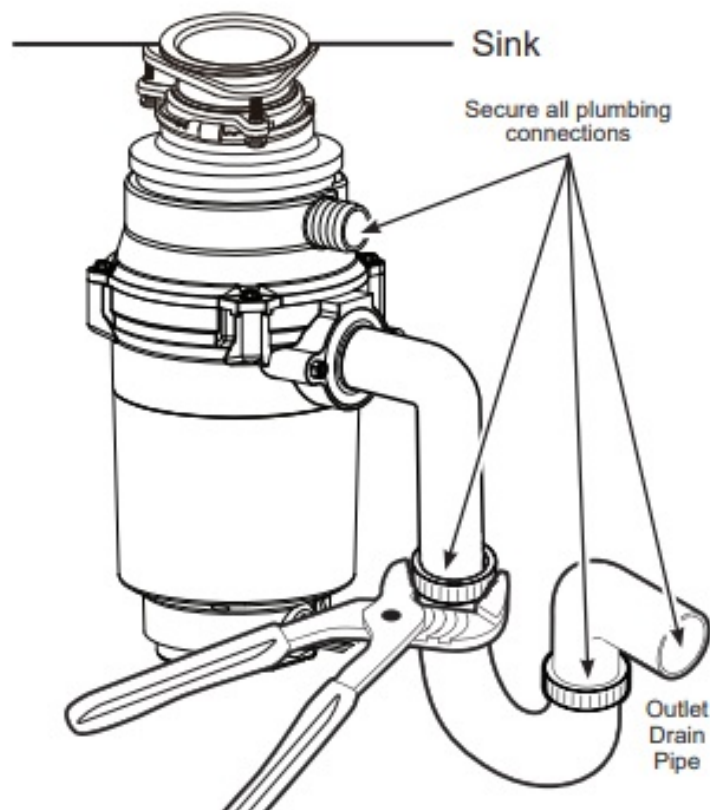
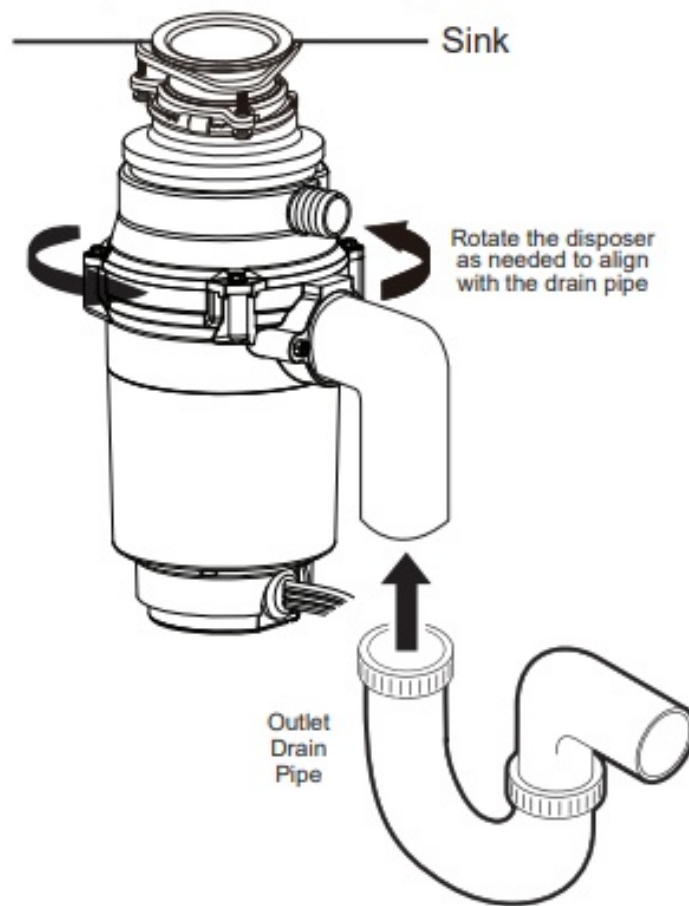

IF CONNECTING TO A DISHWASHER

- Connect the flexible drain hose to the dishwasher discharge using a hose clamp. If the hose size is different you will need a stunned rubber adapter.

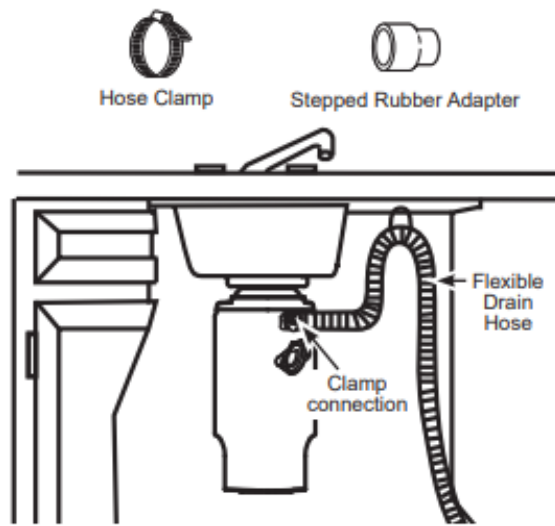

See the Installation Instructions that came with your dishwasher for details.

INSTALL SPLASH GUARD AND STOPPER

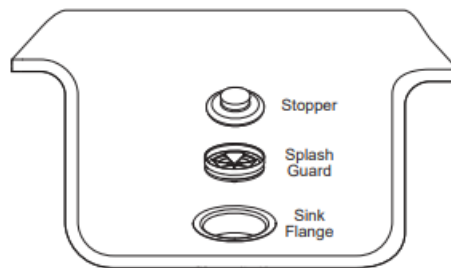

- Press the splash guard into place in the sink flange. Insert the stopper over the splash guard.
- **NOTE:** Both the splash guard and stopper may be removed and cleaned as needed.

CONNECT POWER AND TEST FOR LEAKS

- Plug the disposer into an outlet that is properly installed and grounded in accordance with all local codes and ordinances.
- Run water to check the disposer for leaks 24 hours after installation and first operation.
- Keep and refer to this Owner's Manual for proper use and care of this disposer.

Troubleshooting Tips... Before you call for service

SAFETY NOTE: Before investigating, you must disconnect the power supply.

WARNING Before resetting, disconnect the power supply see SAFETY NOTE above. The overload control prevents the motor from operating should overloading occur. This feature protects your house wiring and your disposer. When overloaded, the motor will stop automatically.

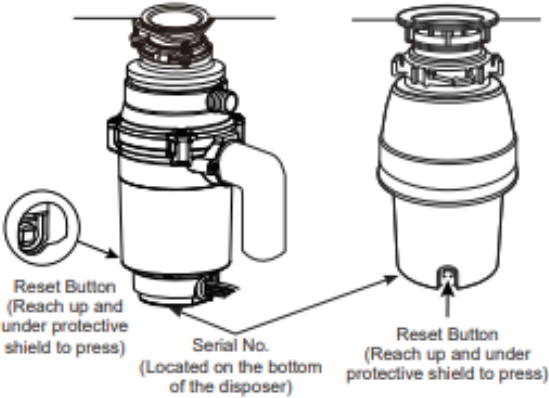
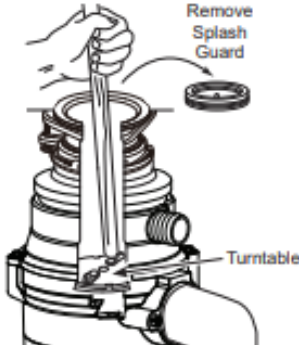
Problem	Possible Cause	What To Do
Loud noises (other than those during grinding of bones and fruit pits)	Silverware, bottle cap or other foreign object has fallen into the disposer	Remove the splash guard and remove the object with long-handled tongs. Replace the splash guard.
Disposer does not start	Reset button has been tripped 	With the splash guard removed, check to see if the turntable will move freely using a broom handle. If the turntable moves freely, replace the splash guard and check the reset button to see if it has been tripped. The reset button is red, located opposite the discharge elbow, near the bottom of the disposer behind its protective shield. Reach up and under the protective shield and push the button in until it clicks and remains depressed. If the reset button has not been tripped, check for a shorted or broken wire connecting to the disposer. Check the electrical power switch, fuse box or circuit breaker. If wiring and electrical components are intact, the unit may have internal problems that require service or replacement.
	Turntable cannot rotate. 	If the turntable does not turn freely, check for an object lodged between the turntable and the grind ring. Dislodge the object by moving the turntable with a broom handle. Then remove the object. If no foreign object is present, there may be internal problems.
Disposer leaks	If the leak is at the top, it may be caused by: 1. Improper seating of sink flange (gasket choice, putty, or tightening). 2. Support ring not tightened properly. 3. Defective cushion mount. If the leak is at the discharge elbow, leak may be caused by improper tightening of elbow flange screws.	

GE Appliances Limited Warranty (For customers in the United States)

GEAppliances.com

For the period of	GE Appliances will replace
One Year From the date of the original purchase	The entire disposer if there is a defect in materials or workmanship relating to functional parts only (appearance parts are excluded). During this limited one-year warranty , GE Appliances will also provide, free of charge , all labor charges related to replacing the original disposer along with the replacement disposer within the first year.
Additional One Year From the date of the original purchase	Models GFC565: If there is a defect in materials or workmanship relating to functional parts only (appearance parts are excluded). During the one-year extended limited warranty period, you will be responsible for all installation charges relating to the replacement disposer.
Additional Four Years From the date of the original purchase	Models GFC765: If there is a defect in materials or workmanship relating to functional parts only (appearance parts are excluded). During this four-year extended limited warranty period, you will be responsible for all installation charges relating to the replacement disposer.
Additional Six Years From the date of the original purchase	Model GFC1065: If there is a defect in materials or workmanship relating to functional parts only (appearance parts are excluded). During this six-year extended limited warranty period, you will be responsible for all installation charges relating to the replacement disposer.

What is not covered:

- Service trips to your home to teach you how to use the product.
- Improper installation, delivery or maintenance.
- Failure of the product if it is abused, misused, or used for other than the intended purpose or used commercially.
- Replacement of house fuses or resetting of circuit breakers.
- Products which are not defective or broken, or which are working as described in the Owner's Manual.
- Damage to the product caused by accident, fire, floods or acts of God. Incidental or consequential damage caused by possible defects with this appliance.
- Defects or damage due to operation in freezing temperatures.
- Damage caused after delivery. Product not accessible to provide required service.

EXCLUSION OF IMPLIED WARRANTIES

Your sole and exclusive remedy is product repair as provided in this Limited Warranty. Any implied warranties, including the implied warranties of merchantability or fitness for a particular purpose, are limited to one year or the character snoring linked hu total

This limited warranty is extended to the original purchaser and any succeeding owner for products purchased for home use within the USA. If the product is located in an area where service by a GE Appliances Authorized Servicer is not available, you may be responsible for a trip charge or you may be required to bring the product to an Authorized GE Appliances Service location for service. In Alaska, the limited warranty excludes the cost of shipping or service calls to your home.

Some states do not allow the exclusion or limitation of incidental or consequential damages. This limited warranty gives you specific legal rights, and you may also have other rights that vary from state to state. To know what your legal rights are, consult your local or state consumer affairs office or your state's Attorney General.

Warrantor: GE Appliances, a Haier Company, Louisville, KY 40225

GE Appliances Limited Warranty (For customers in Canada)

For the period of	GE Appliances will replace
One Year From the date of the original purchase	The entire disposer if there is a defect in materials or workmanship relating to functional parts only (appearance parts are excluded). During this limited one-year warranty , GE Appliances will also provide, free of charge , all labor charges related to replacing the original disposer along with the replacement disposer within the first year.
Additional One Year From the date of the original purchase	Models GFC565: If there is a defect in materials or workmanship relating to functional parts only (appearance parts are excluded). During the one-year extended limited warranty period, you will be responsible for all installation charges relating to the replacement disposer.
Additional Four Years From the date of the original purchase	Models GFC765: If there is a defect in materials or workmanship relating to functional parts only (appearance parts are excluded). During this four-year extended limited warranty period, you will be responsible for all installation charges relating to the replacement disposer.
Additional Six Years From the date of the original purchase	Model GFC1065: If there is a defect in materials or workmanship relating to functional parts only (appearance parts are excluded). During this six-year extended limited warranty period, you will be responsible for all installation charges relating to the replacement disposer.

GEAppliances.ca

All warranty service is provided by our Factory Service Centers or an authorized Customer Care® technician. To schedule service online, visit us at GEAppliances.ca/after-sales-support, or call GE Appliances at 800.561.3344.

Please have your serial number and your model number available when calling for service.

What is not covered:

- Service trips to your home to teach you how to use
- Damage to the product caused by accident, fire, the product. floods or acts of God.
- Improper installation, delivery or maintenance.
- Incidental or consequential damage caused by Failure of the product if it is abused, misused, or used for possible defects with this appliance. other than the intended purpose or used commercially. • Defects or damage due to operation in freezing
- Replacement of house fuses or resetting of circuit temperatures. breakers.
- Damage caused after delivery.
- Products which are not defective or broken, or which
- Product not accessible to provide required service. are working as described in the Owner's manual

EXCLUSION OF IMPLIED WARRANTIES

Your sole and exclusive remedy is product repair as provided in this Limited Warranty. Any implied warranties, including the implied warranties of merchantability or fitness for a particular purpose, are limited to one year or the shortest period allowed by law.

This limited warranty is extended to the original purchaser and any succeeding owner for products purchased in Canada for home use within Canada. If the product is located in an area where service by a GE Appliances Authorized Servicer is not available, you may be responsible for a trip charge or you may be required to bring the product to an Authorized GE Appliances Service location.

Some provinces do not allow the exclusion or limitation of incidental or consequential damages. This limited warranty gives you specific legal rights, and you may also have other rights that vary from province to province. To know what your legal rights are, consult your local or provincial consumer affairs office.

Warrantor: MC Commercial Inc., Burlington, ON, L7R 5B6

Consumer Support

GE Appliances Website

Have a question or need assistance with your appliance? Try the GE Appliances Website 24 hours a day, any day of the year! You can also shop for more great GE Appliances products and take advantage of all our on-line support services designed for your convenience.

- In the US: GEAppliances.com
- In Canada: GEAppliances.ca

Register Your Appliance

Register your new appliance online at your convenience! Timely product registration will allow for enhanced communication and prompt service under the terms of your warranty, should the need arise. You may also mail in the pre-printed registration card included in the packing material.

- In the US: GEAppliances.com/register

- In Canada: GEAppliances.ca/after-sales-support

Schedule Service

Expert GE Appliances repair service is only one step away from your door. Get online and schedule your service at your convenience any day of the year.

- In the US: GEAppliances.com/service or call 800.432.2737 during normal business hours.
- In Canada: GEAppliances.ca/after-sales-support or call 800.561.3344.

Extended Warranties

Purchase a GE Appliances extended warranty and learn about special discounts that are available while your warranty is still in effect. You can purchase it online anytime. GE Appliances Services will still be there after your warranty expires.

- In the US: GEAppliances.com/extended-warranty or call 800.626.2224 during normal business hours.
- In Canada: GEAppliances.ca/purchase-extended-warranty or call 866.277.9842.

Remote Connectivity

For assistance with wireless network connectivity (for models with remote enable), in the US visit our website at GEAppliances.com/connect or call 800.220.6899.

In Canada: GEAppliances.ca/connected-appliances or call 800.220.6899

Parts and Accessories

Individuals qualified to service their own appliances can have parts or accessories sent directly to their homes (VISA, MasterCard and Discover cards are accepted). Order on-line today 24 hours every day.

- In the US: GEApplianceparts.com or by phone at 877.959.8688 during normal business hours.
- In Canada: GEAppliances.ca/parts-filters-accessories or call 800.661.1616.

Instructions contained in this manual cover procedures to be performed by any user. Other servicing generally should be referred to qualified service personnel. Caution must be exercised, since improper servicing may cause unsafe operation.

Contact Us

If you are not satisfied with the service you receive from GE Appliances, contact us on our Website with all the details including your phone number, or write to:

- Appliances.com/contact or call 800.626.2000 GE Appliances, Appliance Park | Louisville, KY 40225
- In Canada: Director, Customer Relations | MC Commercial Inc. | Suite 300, 5420 North Service Road | Burlington, ON L7L 6C7
- GEAppliances.ca/contact-us or call 877.994.5366

Documents / Resources

	<p>GE APPLIANCES GFC365 Continuous Feed Garbage Disposer Corded [pdf] User Guide GFC365 Continuous Feed Garbage Disposer Corded, GFC365, Continuous Feed Garbage Disposer Corded, Feed Garbage Disposer Corded, Garbage Disposer Corded, Disposer Corded, Corded</p>
---	---

References

- [GE Magasin GE Canada | Homepage](#)
- [GE Magasin GE Canada | Homepage](#)
- [GE Magasin GE Canada | Homepage](#)
- [GE Magasin GE Canada | Homepage](#)
- [GE Magasin GE Canada | Homepage](#)
- [GE Magasin GE Canada | Homepage](#)
- [GE Magasin GE Canada | Homepage](#)
- [Appliance Parts, Accessories & Water Filters | GE Appliances](#)
- [GE GE Appliances Canada | Homepage](#)
- [GE Connected Appliances | GE Appliances Canada](#)
- [GE Appliances: Shop for Home, Kitchen, & Laundry Appliances](#)
- [Connect Your Smart Appliances](#)
- [Contact Us or Get Help with Questions | GE Appliances](#)
- [Bodewell Care Protection Plans](#)
- [GEAppliances.com/register](#)
- [Appliance Repair Service and Support | GE Appliances](#)
- [GE Magasin GE Canada | Homepage](#)
- [GE GE Appliances Canada | Homepage](#)
- [User Manual](#)

[Manuals+](#), [Privacy Policy](#)

This website is an independent publication and is neither affiliated with nor endorsed by any of the trademark owners. The "Bluetooth®" word mark and logos are registered trademarks owned by Bluetooth SIG, Inc. The "Wi-Fi®" word mark and logos are registered trademarks owned by the Wi-Fi Alliance. Any use of these marks on this website does not imply any affiliation with or endorsement.