

GARNET SeeLevel-RV-2.0 Mobile Application User Guide

GARNET SeeLevel-RV-2.0 Mobile Application

Contents

- [1 ABOUT THE APPLICATION](#)
- [2 GETTING STARTED](#)
- [3 HOME SCREEN](#)
- [4 FIND MY TANKS SCREEN](#)
- [5 Documents / Resources](#)
- [6 Related Posts](#)

ABOUT THE APPLICATION

The See Level RV 2.0 app offers a wide range of powerful features to enhance your RV monitoring experience. With seamless compatibility for Apple iOS devices, this app allows you to effortlessly connect and monitor your tank levels and battery voltage right from your mobile device. The app provides real-time updates on up to four holding tanks, including fresh, grey, black, and LPG tanks. You can customize tank and device names, choose graphical tank fluid colors, and set personalized tank level alarms for timely notifications (see note below). The intuitive interface and Auto Connect feature ensure easy access to vital information directly from the Home Screen. With the See Level RV App, managing your resources and maintaining peace of mind while on the road has never been easier.



NOTE:

The iOS alarm feature is currently in Beta and has the following limitations:

- The alarm will not function while the app is closed or in the background.
- The alarm can only stay active for a few minutes (15 minutes or less)

These limitations will be addressed in a future update. expands on information for any procedures.



GETTING STARTED

Download and Install App

For Apple iOS devices go to the Apple App Store and search "[SeeLevel RV 2.0](#)". Download and install the application.



NOTE: DON'T MISS OUT ON UPDATES

The app will be updated periodically. To avoid missing out on these updates, make sure to enable auto-update in your app store or manually check for updates.



Ensure Bluetooth® is Enabled

Once you have completed the installation, check that Bluetooth® is enabled in your device settings.

Permission Requests

When you launch the SeeLevel RV App for the first time, there are a few permissions and settings that you need to allow to ensure optimal functionality. Notifications, Device Positioning. Here are some examples of these screens.

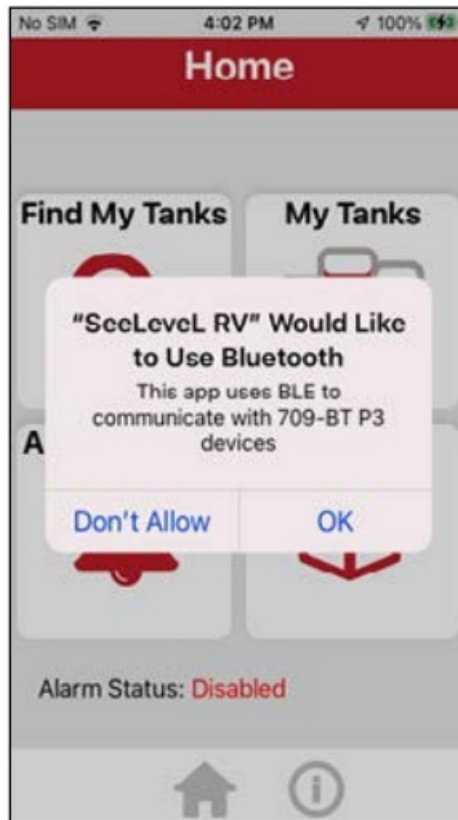

HOME SCREEN

From the home screen, you can select the following button options:

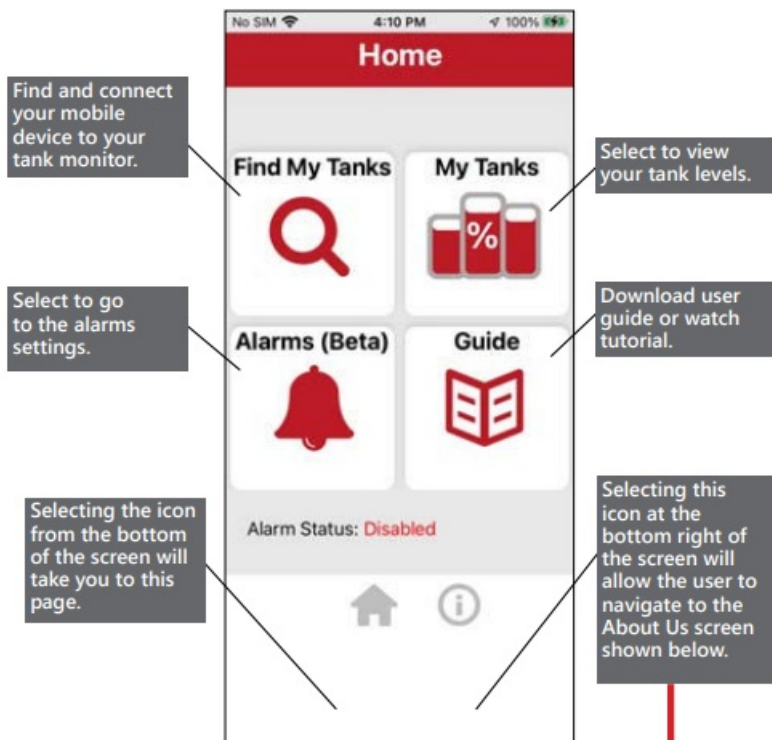

The bottom of some screens have these options.

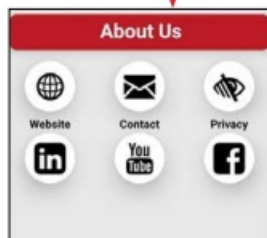

FIND MY TANKS SCREEN

Connect your Device

1. After launching the SeeLevel RV App on your mobile device, locate and select the “Find My Tanks” button.

This will take you to the “Find My Tanks” screen. On the this screen, you should see a “find”  icon, near the bottom of the screen.

2. Tap on  to start the scanning process. The app will begin scanning for available SeeLevel tank monitor devices within range. Wait for a moment as the app searches for and detects the available devices.
3. Once the scanning process is complete, the app will display a list of detected SeeLevel tank monitor devices on the screen, and you can select one of them. Comparing the app tank levels to the levels shown on the tank monitor will ensure that you selected the correct device.

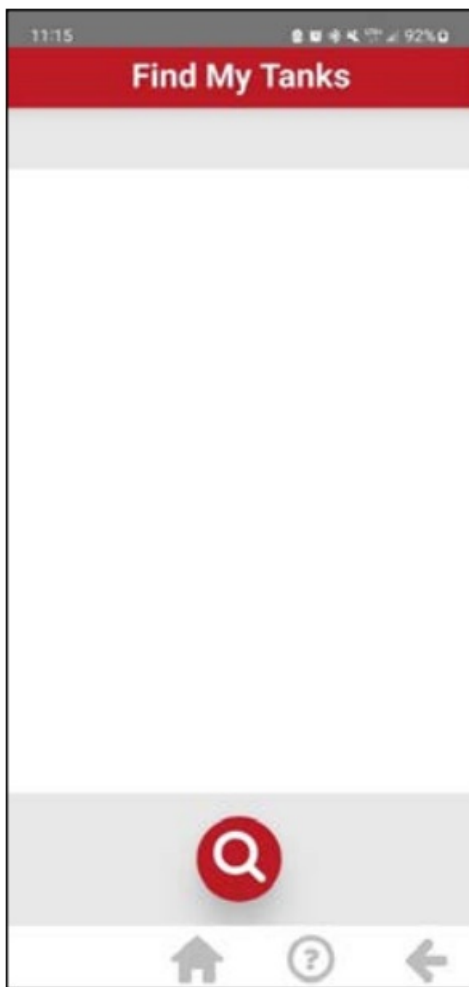

Tap icon to scan.

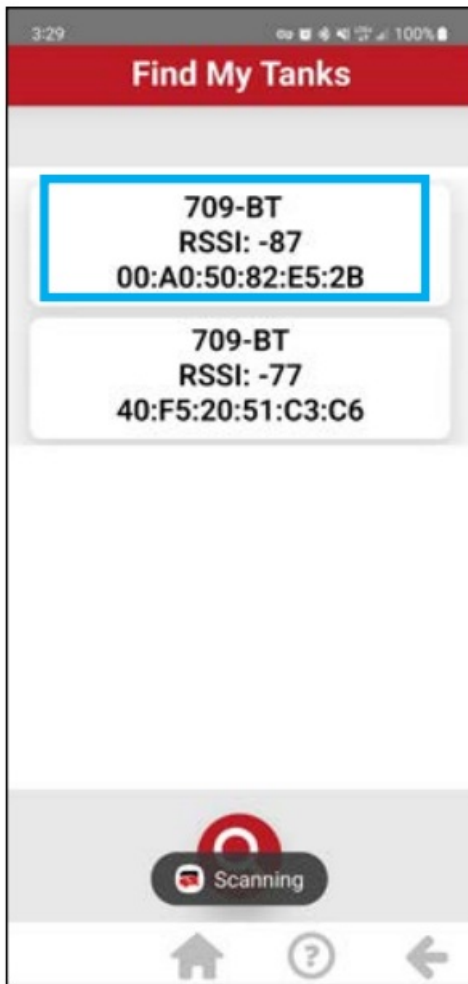

Select the correct device.

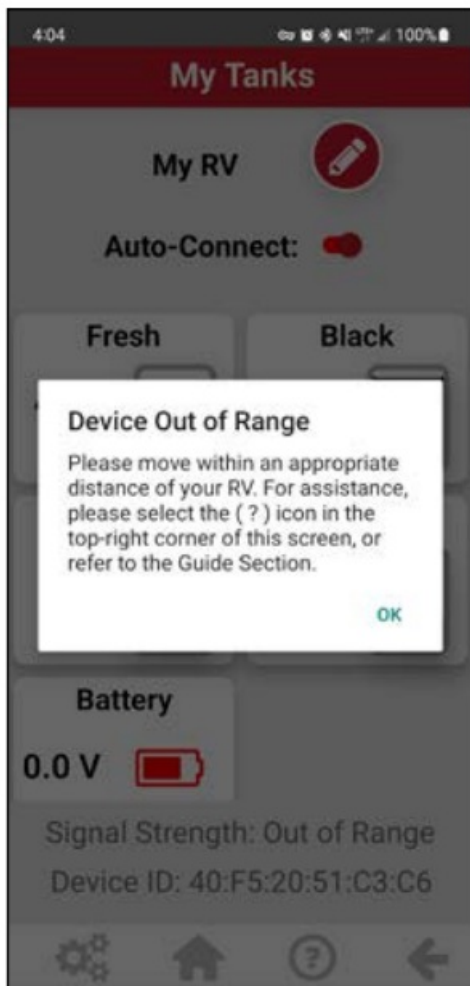

Device not connected.



Documents / Resources

	<p>GARNET SeeLevel-RV-2.0 Mobile Application [pdf] User Guide</p> <p>SeeLevel-RV-2.0 Mobile Application, SeeLevel-RV-2.0, Mobile Application, Application</p>
---	---