

GARMIN.

GARMIN
Tread 2
Handlebar
Controller



GARMIN Tread 2 Handlebar Controller Instruction Manual

[Home](#) » [Garmin](#) » GARMIN Tread 2 Handlebar Controller Instruction Manual 

Contents

- [1 GARMIN Tread 2 Handlebar Controller](#)
- [2 Product Usage Instructions](#)
- [3 INSTALLATION INSTRUCTIONS](#)
- [4 Important Safety Information](#)
- [5 Connecting the Controller](#)
- [6 Configuring the Buttons](#)
- [7 Specifications](#)
- [8 Documents / Resources](#)
 - [8.1 References](#)
- [9 Related Posts](#)

GARMIN®

GARMIN Tread 2 Handlebar Controller



Product Usage Instructions

Handlebar Controller Installation

1. Place the bushing on the handlebar at the desired location for the controller.
2. Mount the handlebar controller clamp over the bushing, ensuring proper alignment.
3. Use the provided hex wrench to secure the screw into place.

Connecting the Controller

1. Route the handlebar controller cable to the accessory connector on the device power cable.
2. Secure the cable along the handlebar using the included cable ties.
3. Connect the handlebar controller connector to the accessory connector on the device power cable.
4. If using a Group Ride Radio, connect its cable to the spare accessory connector on the handlebar controller cable.
5. Tighten the locking rings on all connectors for a secure connection.

Configuring the Buttons

To configure button actions, navigate to the settings menu and select Handlebar Controller. Here, you can assign different functions to each button on the controller.

FAQ

• Q: What should I do if I encounter issues with button functionality?

A: If you experience problems with button actions, try resetting the controller by disconnecting and reconnecting it. Ensure all connections are secure and cables are properly routed.

• Q: Can I use the handlebar controller in extreme weather conditions?

A: The product is designed with water and dust resistance (IEC 60529 IP67), making it suitable for various weather conditions. However, avoid exposing it to extreme temperatures outside the specified operating range.

INSTALLATION INSTRUCTIONS

Important Safety Information

WARNING

See the Important Safety and Product Information guide in the product box for product warnings and other important information.

Installing the Controller on the Handlebar

The handlebar controller is packaged with three bushings, designed for 22 mm (7/8 in.), 25 mm (1 in.), and 32 mm (1 1/4 in.) diameter handlebars. We recommend installing the handlebar controller close to the left handle of your vehicle, within reach of your thumb.

1. Place the bushing 1 on the handlebar, in the mounting location for the controller.

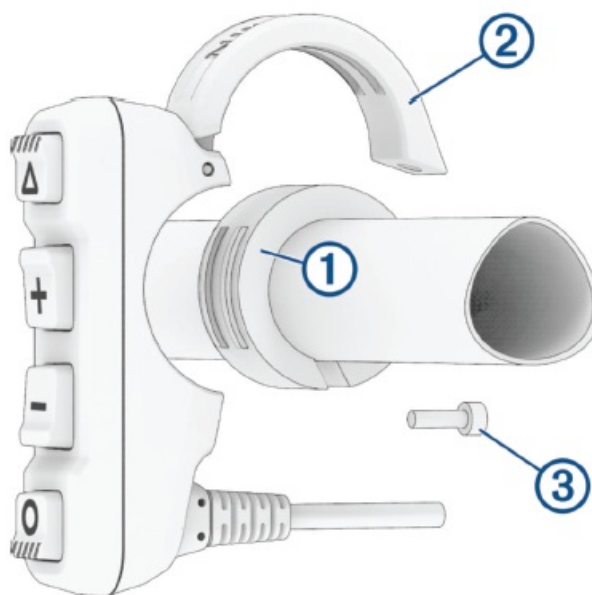

2. Place the handlebar controller mounting clamp 2 over the bushing, making sure the ridges on the bushing match up with the grooves in the mounting clamp. match up with the grooves in the mounting clamp3.

Connecting the Controller

To connect the Handlebar Controller to your device, you must have a power cable with an accessory connector. If your device was not packaged with such a cable, you can purchase the Handlebar Controller Y-adapter cable for 8 in. or 10 in. Tread devices (part number 010-13087-18) or the Group Ride Radio Y-adapter cable for the zūmo XT2 navigator (part number 010-13285-00). You can purchase these accessories from your Garmin dealer or you can go to garmin.com.

1. Route the handlebar controller cable to the accessory connector 1 on the device power cable.

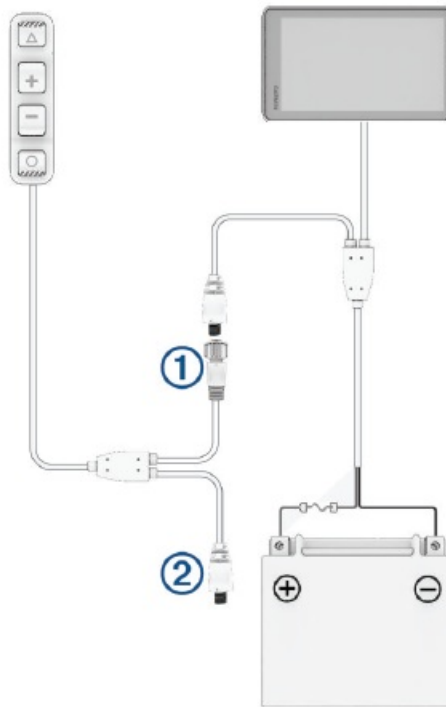

You can use the included cable ties to secure the cable along the handlebar.

2. Connect the handlebar controller connector to the accessory connector on the device power cable.
3. If you have a Group Ride Radio, connect the Group Ride Radio cable to the spare accessory connector 2 built into the handlebar controller cable.
4. Tighten the locking rings on the connectors.

Configuring the Buttons

You can configure each button on the handlebar controller to trigger different actions.



Specifications

Water and dust resistance	IEC 60529 IP671
Operating temperature range	From -20° to 55° C (from -4° to 131° F)

© 2024 Garmin Ltd. or its subsidiaries

Garmin®, the Garmin logo, Tread® and zūmo® are trademarks of Garmin Ltd. or its subsidiaries, registered in the USA and other countries. These trademarks may not be used without the express permission of Garmin.

1. The device is protected against the ingress of dust and withstands incidental exposure to water of up to 1 m for up to 30 min.

support.garmin.com

Documents / Resources

	<p>GARMIN Tread 2 Handlebar Controller [pdf] Instruction Manual</p> <p>Tread 2, 010-13087-18, 010-13285-00, Tread 2 Handlebar Controller, Tread 2, Handlebar Controller, Controller</p>
---	--

References

- ▲ [Garmin Official Site](#)
- ▲ [Garmin Customer Support](#)
- ▲ [Garmin Official Site](#)
- [User Manual](#)

Manuals+. [Privacy Policy](#)

This website is an independent publication and is neither affiliated with nor endorsed by any of the trademark owners. The "Bluetooth®" word mark and logos are registered trademarks owned by Bluetooth SIG, Inc. The "Wi-Fi®" word mark and logos are registered trademarks owned by the Wi-Fi Alliance. Any use of these marks on this website does not imply any affiliation with or endorsement.