

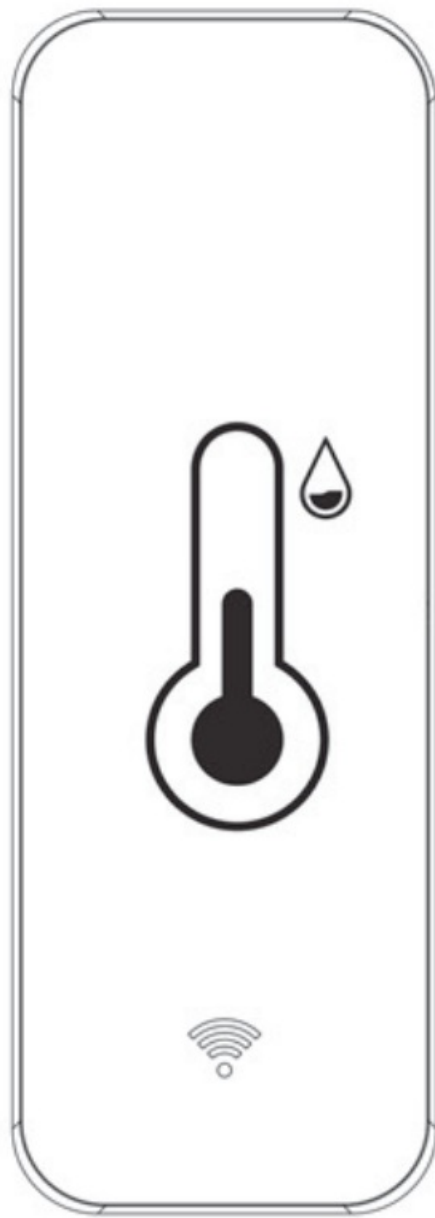

Gaoducash TH01 WiFi Temperature and Humidity Sensor User Manual

[Home](#) » [Gaoducash](#) » Gaoducash TH01 WiFi Temperature and Humidity Sensor User Manual 

Gaoducash TH01 WiFi Temperature and Humidity Sensor



Contents

- [1 Product Presentation](#)
- [2 Specification](#)
- [3 How to use](#)
- [4 How to set up](#)
- [5 Functions](#)
- [6 FAQ](#)
- [7 FCC Statement](#)
- [8 Documents / Resources](#)
 - [8.1 References](#)
- [9 Related Posts](#)

Product Presentation

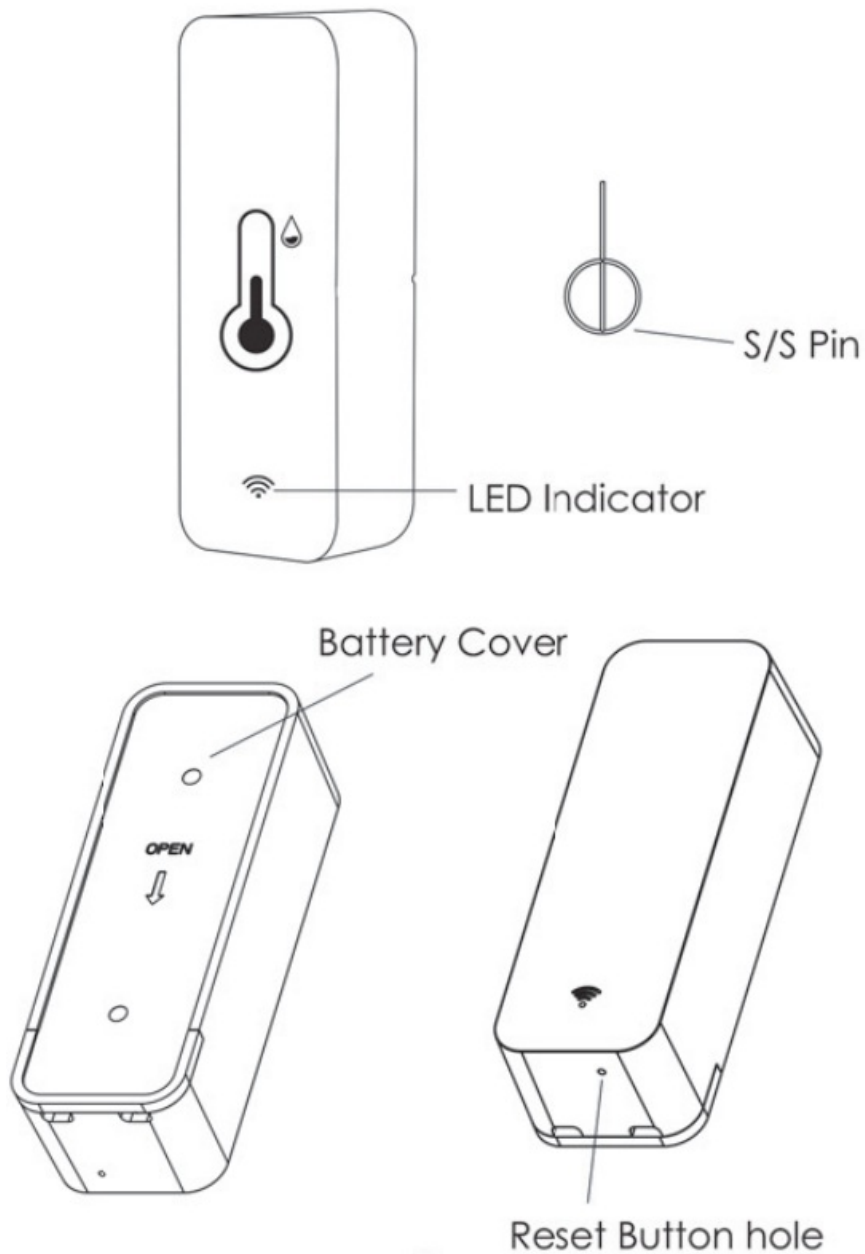

Specification

Size: 71 *25*20mm

Battery: LR03- 1.5V / AAA *2 (Alkaline battery)

Wi-Fi Protocol: 2.4GHz

Wi-Fi Standard: IEEE 802.11 b/g/n

Temperature Measure Range: -20C- 60 C

Temperature Accuracy: + 1 c

Humidity Measure Range: 0% RH~ 100% RH

Humidity Accuracy: ± 5% RH

Checklist before using the device:

- Your smartphone has connected to a 2.4GHz Wi-Fi network.
- You have input the correct Wi-Fi password.
- Your smartphone must be Android 4.4 + or iOS 8.0 +.
- If the numbers of devices connected to Wi-Fi router reach the limit, you can try to disable a device to vacate the channel or try with another Wi-Fi router.

How to use

Slide downwards to open the back cover of the battery compartment, install 2 x AAA new Alkaline batteries in the right direction of electrode, the indicator will blink, then push to close the back cover.

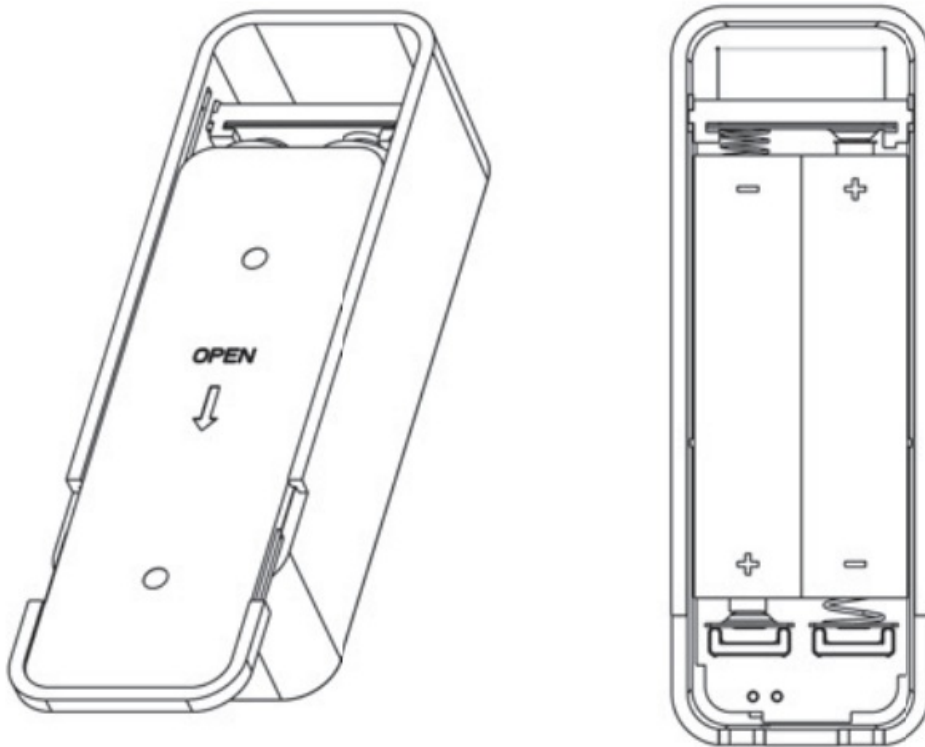

(Notes: when batteries are run out, please choose Alkaline battery instead of Carbon-zinc battery.)

How to set up

1. Use your smartphone to scan QR code, or search “Smart Life” opp in Google Play Store or APP Store to download and install.

 <p>Smart Life</p>	 <p>Qr code</p>
	

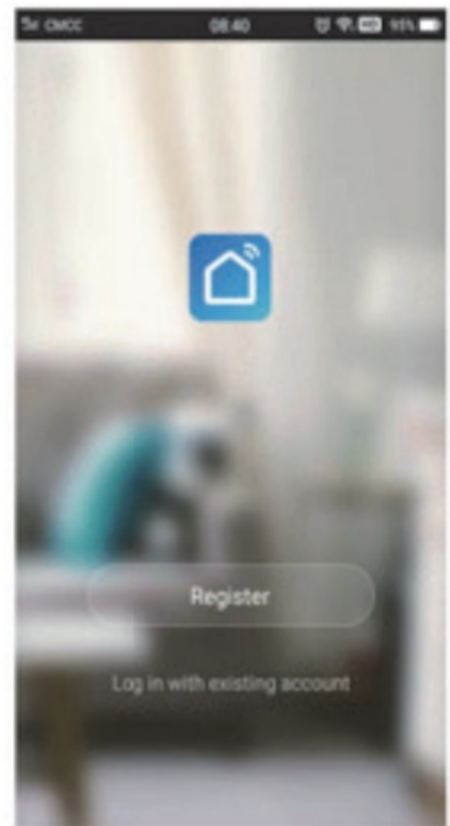

2. Create an account with your mobile number and authentication code.

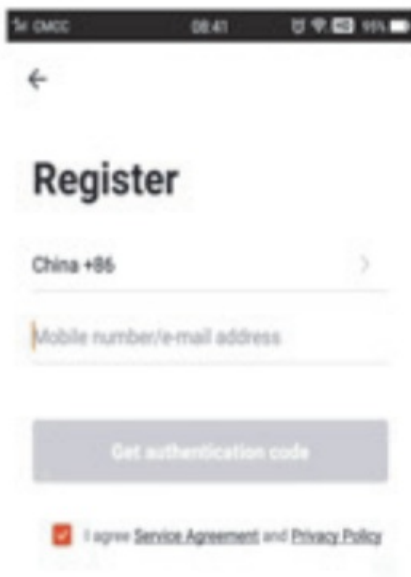
A screenshot of the 'Register' screen in the SmartThings mobile app. At the top, there's a status bar with '5G CMCC', '08:41', and battery level '91%'. Below the status bar is a back arrow icon. The title 'Register' is prominently displayed. Below the title, there's a dropdown menu showing 'China +86'. Underneath that is a text input field with the placeholder 'Mobile number/e-mail address'. Below the input field is a button labeled 'Get authentication code'. At the bottom, there's a checkbox with a red checkmark and the text 'I agree Service Agreement and Privacy Policy'.

3. Connect your mobile to your Wi-Fi router , click “+” at the upper right corner of homepage or click “Add Device” .

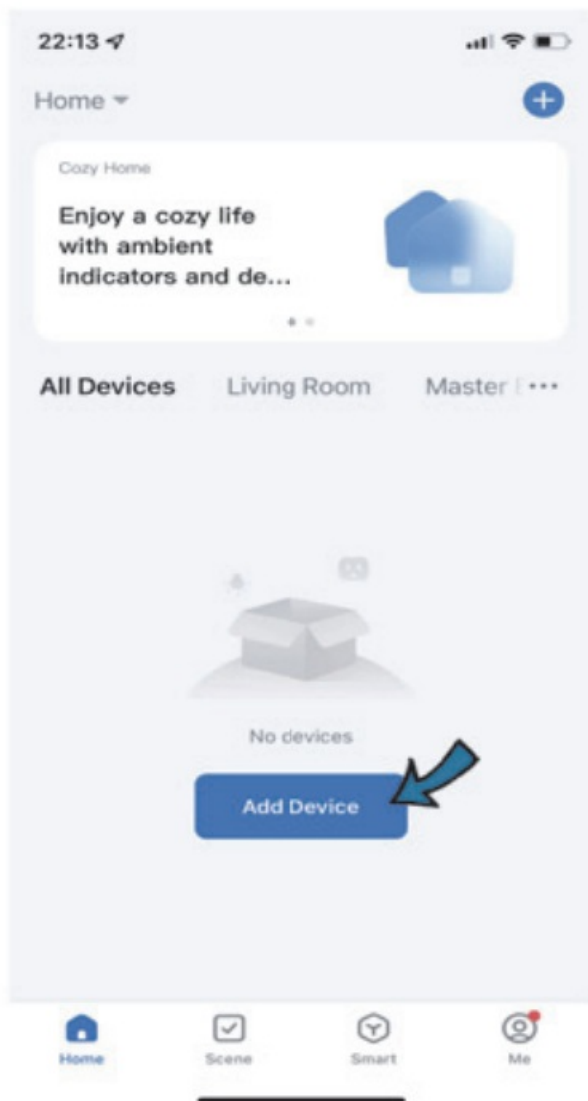

Bluetooth Mode:

The app will advise you to turn on the Bluetooth on your mobile, it will search the device and add automatically.

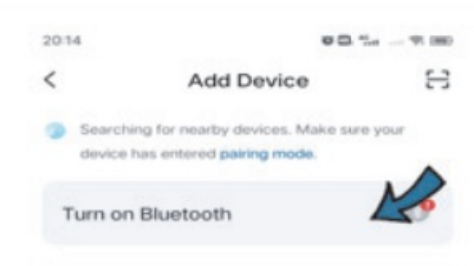

Add Manually

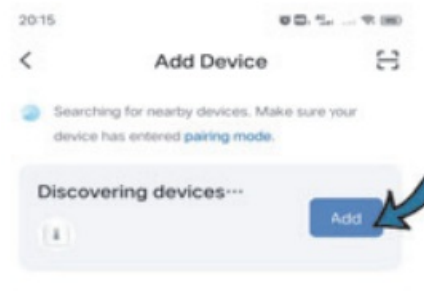

Add Manually



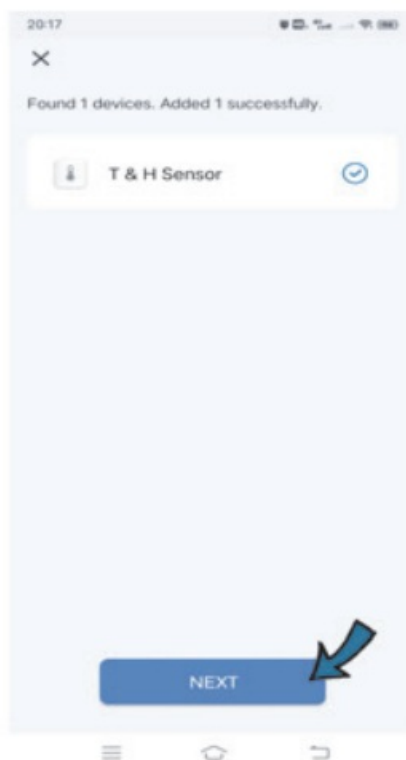
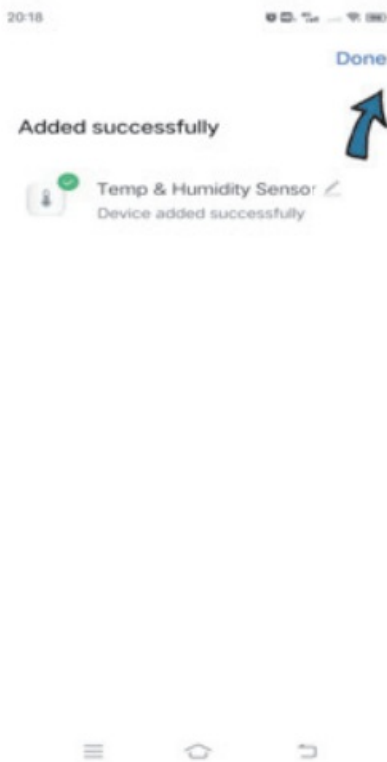

Wi-Fi Mode:

Select "Temperature and Humidity Sensor (BLE + Wi-Fi)" from "Sensors". Select "Blin-k Quickly", make sure the indicator is blinking quickly, if not, use the supplied S/S pin to press the reset button about 5s till indicator is blinking fast.

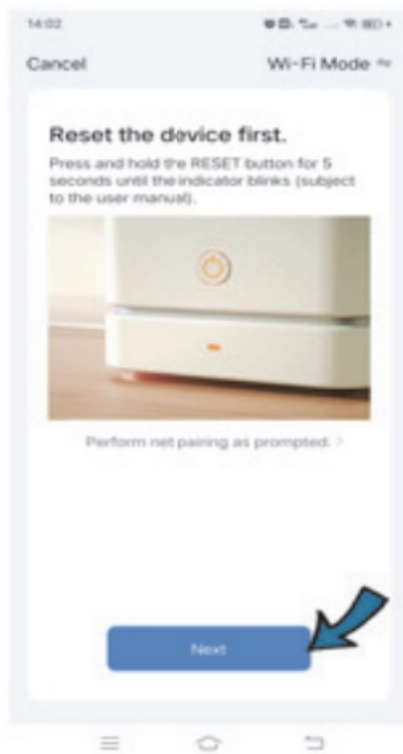

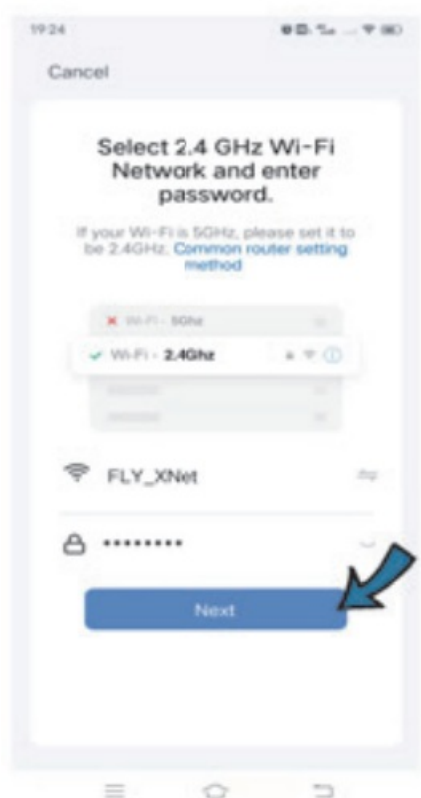
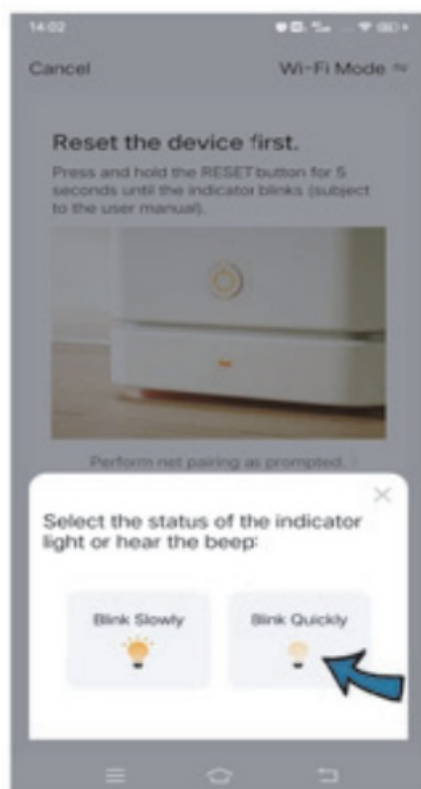

20:29



Cancel

Adding device...

Ensure that the device is powered on.



01:40



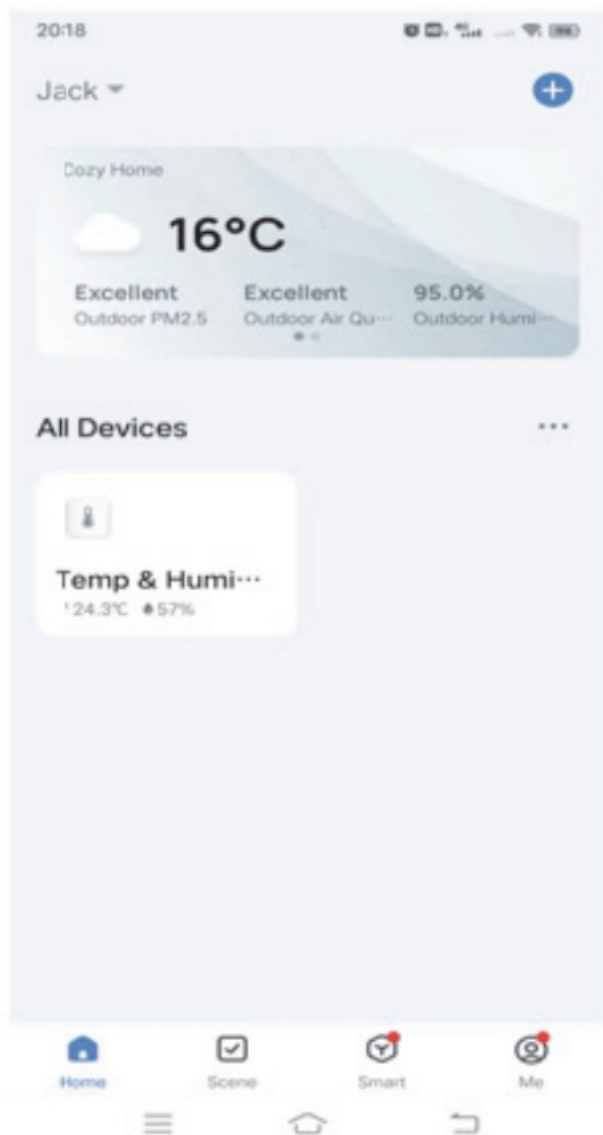

You can also select “Blink Slowly”, make sure the LED indicator is blinking slowly. if not, use the SIS pin to press the reset button for about 5s till the indicator is blinking slowly. Connect your mobile to the device’s hotspot: “Smartlife-XXXX”, then click to return to App interface , it will connect to Wi-Fi automatically, configuration completed.

14:02

Wi-Fi Mode

Cancel

Wi-Fi Mode

Reset the device first.

Press and hold the RESET button for 5 seconds until the indicator blinks (subject to the user manual).



Perform net pairing as prompted. >

Select the status of the indicator light or hear the beep:

Blink Slowly



Blink Quickly





Connect your mobile phone to the device's hotspot

1 Connect your phone to the hotspot shown below:

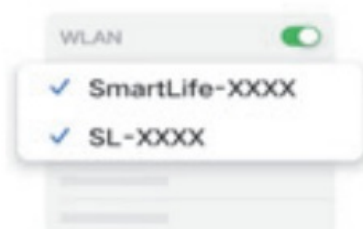

2 Go back and add devices.

Go to Connect



ON



CURRENT NETWORK



SmartLife-5921

Internet may not be available

AVAILABLE NETWORKS



flywifi2.4G



flywifi5G



888



ChinaNet-zYLx



TPLINKD06



SPT1



TP-LINK_4761



FCY



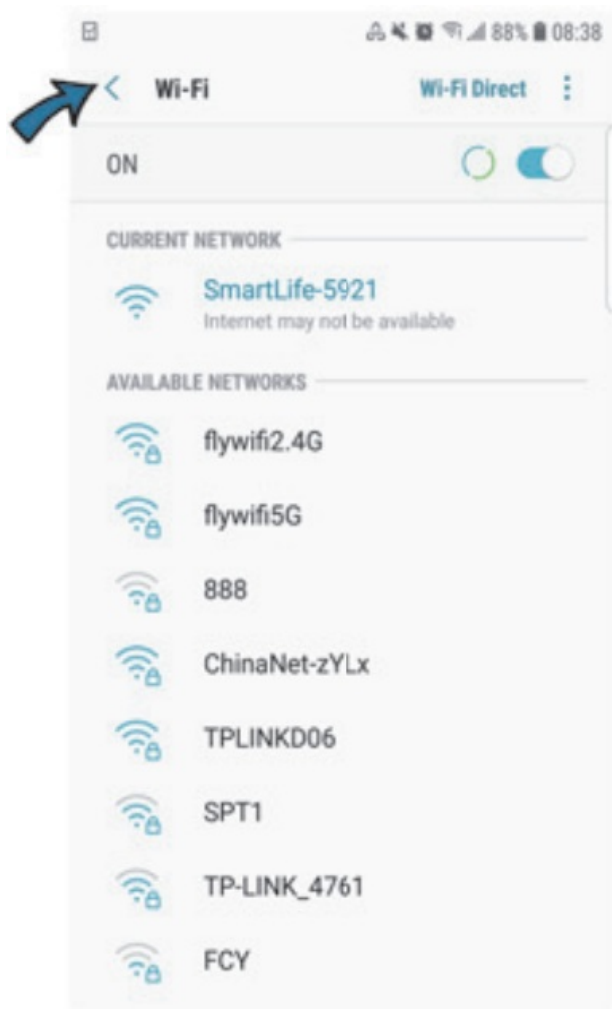

Use a clean and dry towel to clean the area where you want to mount the sensor. Peel off the adhesive tape to stick on the back of sensor, press it hard to fix it well.
(The adhesive tape is for one-time use only.)

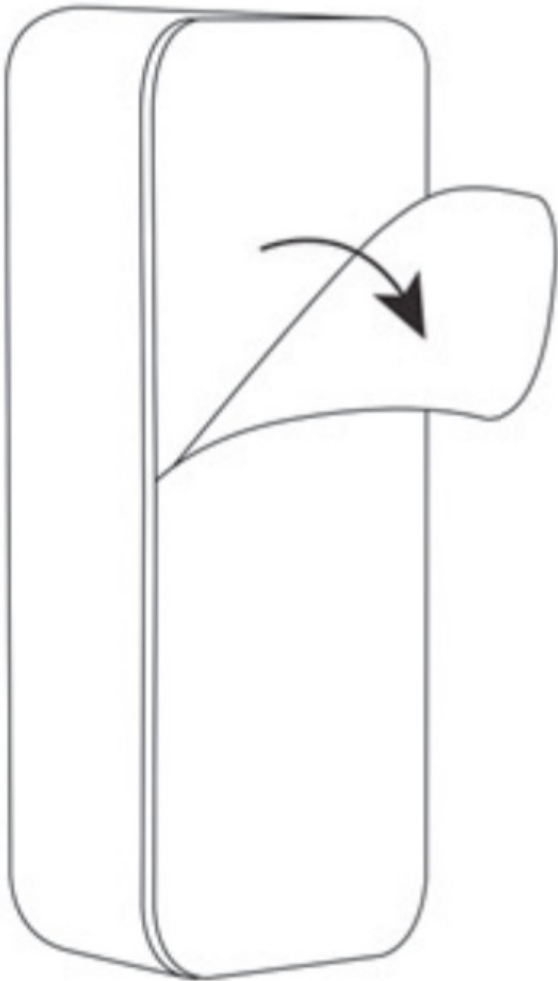

NOTES: The sensor is only used in indoor and not water-proof.

Functions

1. **Accurate Measurement**

About 30 minutes after wifi configuration done, the temperature and humidity is closer to the actual ambient environment, so the readings are more accurate.

2. **Intelligent Linkage**

You can create linkage scene with other Tuya smart devices like Smart IR Remote Controller. For example, when the indoor temperature $> 30^{\circ}\text{C}$, Air conditioner will turn on automatically, or when the humidity is $< 20\%$, the humidifier will spray.

3. **Temp & humidity Alert**

You can preset the range of temperature and humidity in the "Scene", when the temperature and humidity reaches the range, it will push alert message via app.

4. **Temperature Unit Switch**

You can switch temperature unit between Celsius and Fahrenheit in the App, select the temperature unit, then use the supplied S/S pin to press the reset button once, the switch completed.

5. **Temp and humidity records**

You can view the historic data of temperature and humidity stored for 1 year, and export to your email address.

6. **Third-party Voice Control**

You can enquiry about temp and humidity via Amazon alexa, Google assistant smart speaker.

OK Google, what is the <device> humidity ?
OK Google, what is the <device> temperature ?
Alexa, what is the <device> humidity ?
Alexa, what is the temperature of <device name>

FAQ

1. Please use new alkaline battery, don't mix use with used battery.
2. Please configure network connection instantly after the batteries are installed, to avoid power consumption.
3. Please make sure your wifi network works well, if the network is not good, the device will always try to connect wifi, then battery will run out soon.
4. Since it is a low battery-powered device, if there is no information reported within 24 hours, the opp will remind you that it is off line.
5. When the ambient temperature change~ 0.5 C.
or the humidity~ 5%, the temp and humidity will be updated every 2 minutes .
6. When the ambient temperature change< 0.5 C or the humidity change <5%, the temperature and humidity will be updated once an hour.

FCC Statement

This equipment has been tested and found to comply with the limits for a Class B digital device, pursuant to part 15 of the FCC rules. these limits are designed to provide reasonable protection against harmful interference in a residential installation. This equipment generates, uses and can radiate radio frequency energy and , if not installed and used in acor dance with the instructions, may cause harmful interference to radio communications. However, there is no guarantee that interference will not occur in a particular installation. If this equipment does cause harmful interference to radio or television reception, which can be determined by turning the equipment off and on, The user is encouraged to try to correct the interference by one or more of the following measures:

- Reorient or relocate the receiving antenna.
- Increase the separation between the equipment and receiver.
- Connect the equipment into an outlet on a circuit different from that to which the receiver is connected.
- Consult the dealer or an experienced radio/TV technician for help.

To assure continued compliance, any changes or modifications not expressly approved by the party.

Responsible for compliance could void the uer's authority to operate this equipment. (Examplel use only shielded interface cables This equipment complies with Part 15 of the FCC Rules. Operation is subject to the following two conditions:

1. This device may not cause harmful interference ,and
2. This device must accept any interference received, including interference that may cause undesired operation.

FCC Radiation Exposure Statement:

The equipment complies with FCC Radiation exposure limits set forth for uncontrolled environment. This equipm - ent should be installed and operated with mininum distance 20cm between the radiator and your body.

Documents / Resources



[Gaoducash TH01 WiFi Temperature and Humidity Sensor](#) [pdf] User Manual
TH01, TH01 WiFi Temperature and Humidity Sensor, WiFi Temperature and Humidity Sensor, T
emperature and Humidity Sensor, Humidity Sensor, Sensor

References

- [User Manual](#)

[Manuals+](#), [Privacy Policy](#)

This website is an independent publication and is neither affiliated with nor endorsed by any of the trademark owners. The "Bluetooth®" word mark and logos are registered trademarks owned by Bluetooth SIG, Inc. The "Wi-Fi®" word mark and logos are registered trademarks owned by the Wi-Fi Alliance. Any use of these marks on this website does not imply any affiliation with or endorsement.