

gamma+
Absolute Alpha
Clipper



Gamma plus Absolute Alpha Clipper User Manual

[Home](#) » [Gamma Plus](#) » Gamma plus Absolute Alpha Clipper User Manual 

Contents

- [1 Gamma plus Absolute Alpha Clipper](#)
- [2 Specifications](#)
- [3 Product Usage Instructions](#)
- [4 FAQ](#)
- [5 Professional appliance](#)
- [6 GENERAL SAFETY WARNINGS](#)
- [7 ACCESSORIES](#)
- [8 USE](#)
- [9 MAINTENANCE](#)
- [10 WARRANTY](#)
- [11 CONTACT](#)
- [12 Documents / Resources](#)
 - [12.1 References](#)
- [13 Related Posts](#)

gamma+

Gamma plus Absolute Alpha Clipper



Specifications

- **Model:** Tagliacapelli
- Professional hair-cutting device
- Conforms to CE marking directives

Product Usage Instructions

Safety Warnings

Do not use the product with adapters or charging supports other than those provided. Do not use the provided adapter and charging support to recharge other products. If the oil (M) is accidentally ingested, do not induce vomiting, drink plenty of water, and seek medical attention. If the oil comes into contact with the eyes, rinse immediately with running water and seek medical help.

WARNING! DANGER FOR CHILDREN: Packaging materials such as plastic bags, expanded polystyrene, etc., should not be left within reach of children as they can pose potential hazards.

FAQ

- **Q:** Can I use this device with animal hair?
- **A:** No, this device is intended for use only on human hair. Do not use it with animal hair or any other materials.
- **Q:** What should I do if the oil is accidentally ingested?
- **A:** If the oil is ingested, do not induce vomiting, drink plenty of water, and seek medical help immediately.
- **Q:** How should I store the device when not in use?
- **A:** Store the device in a safe place away from children and pets. Keep it in a dry and cool environment.

Professional appliance



- Our products comply with the directives that refer to EC marking



- An appliance is classified as class III when the protection against electrocution is guaranteed by the fact that the appliance does not contain voltages greater than the Safety Extra-Low Voltage (SELV). This appliance is powered either by a battery or a SELV transformer. Class III appliances do not require earthing



- This symbol indicates that the product meets the requirements of the new directives introduced so as to protect the environment and must be disposed of appropriately at the end of its life cycle. Request information from the local Authorities about the areas dedicated to waste disposal



- This symbol, generally together with the description, informs the user that there are important operations and instructions to be read.

All the figures and parts detailed in them are shown on page 3 of this manual; the instructions that follow provide a part reference and the number of the figure, 1 (fig. A).

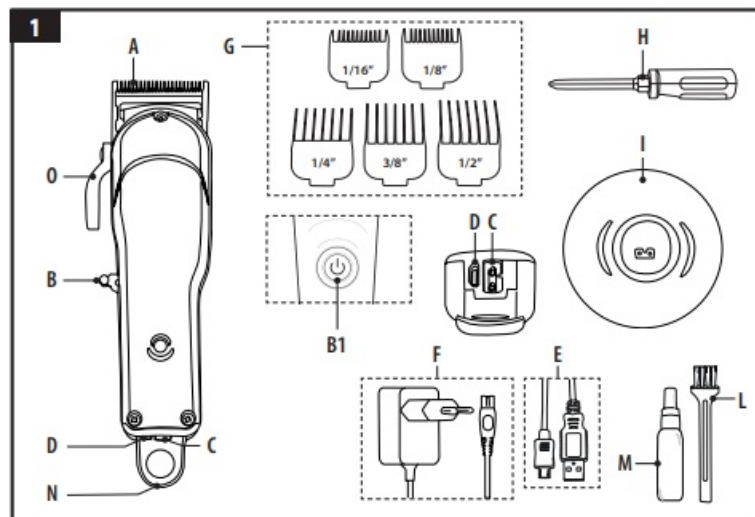

GENERAL SAFETY WARNINGS



- To avoid damage and dangers due to improper use, carefully follow the instructions for use and keep them in a safe place. If the product is handed over to a third party also provide the instruction booklet.



- Do not use the product with adapters or chargers other than those supplied. Furthermore, do not use the AC adapter and support supplied to charge other products.



- If the oil M (fig. 1) is accidentally swallowed, do not induce vomiting, drink plenty of water and contact a physician. In case of oil contact with eyes, immediately wash with running water and contact a physician.



- The rechargeable battery must only be used with this hair clipper. Do not use the battery with other products. Do not charge the battery after it has been removed from the product.
 - Do not throw it in the fire or heat it.

- Do not strike, disassemble, modify or perforate with a nail.
- Do not let the positive and negative contacts of the battery come into contact with each other through metal objects.
- Do not charge, use or leave the battery in places where it is exposed to high temperatures such as direct sunlight or near other heat sources.
- Do not remove the external film.
- Proceed as follows if fluid leaks from the battery. Do not touch the battery with bare hands.
- If it comes into contact with the eyes, the battery liquid can cause blindness. Do not rub your eyes. Wash immediately with clean water and consult a physician.
- If it comes into contact with your skin or clothes, the battery liquid can cause inflammation or injuries. Wash away immediately with clean water and consult a physician.

UNPACKING AND INSPECTING THE PRODUCT

Remove the product from its packaging and make sure it is intact and has no visible signs of damage caused during transport. In case of doubt, do not use the appliance and contact the nearest Technical Assistance Centre (see “Technical assistance centres (IT)” specified in this manual).



ATTENTION! DANGER FOR CHILDREN.

The packaging materials (bags made of plastic, polystyrene foam, etc.) must not be left within reach of children as they are potential sources of danger.

ELECTRICAL SAFETY PRECAUTIONS

Using electrical appliances requires compliance with some basic regulations. In particular:

- do not remove the plug from the socket by pulling the power cord or the appliance;
- never place the appliance in water or other liquid! Do not touch the appliance if it has fallen into any liquid.
- do not expose the appliance to the elements (rain, sun, etc.);
- Do not use the product if the cord or other parts are damaged. If the power cord is damaged it must be replaced by the manufacturer or the relevant technical assistance or in any case by a person with similar skills in order to prevent any risk.
- Place the product on a flat, stable surface, away from sources of heat.

GENERAL USE WARNINGS

Refer to the outer packaging and the specifications on the data plate affixed to the product itself for the relevant technical specifications.



- **USE:** The hair trimmer was designed and built for cutting and grooming of human hair and beard.



- **INCORRECT USE:** Use this appliance only for its intended purpose, do not use it with wigs, animal fur or any material other than human hair. The manufacturer declines all liability concerning misuse of the appliance.



- Do not wind the power adapter cable around the adapter to avoid damage and to avoid any risks derived from the damage.



- During charging and use, the appliance may become hot; this is normal.
- Make sure that the mains voltage matches the one shown on the technical data plate on the appliance and on the power adaptor.
- Children must not play with the appliance.
- NOT VALID FOR AUSTRALIA AND NEW ZEALAND – This appliance can be used by children starting from the age of 8 and by people with reduced physical, sensory or mental capabilities, or by people lacking the experience or knowledge, as long as they are properly supervised and instructed on the use of the appliance and are involved in the comprehension of the dangers. Cleaning and maintenance must not be performed by children without supervision. The appliance can be used by children from 3 years of age under supervision.
- ONLY FOR AUSTRALIA AND NEW ZEALAND – This product is not suited for the usage of people (children included) with reduced physical, sensorial, or mental capacity or with insufficient experience and knowledge, unless they are kept under surveillance and have been equipped with instructions related to the usage of the appliance, provided by people responsible for their safety. Children should be supervised to ensure that they do not play with the appliance.
- To guarantee proper and safe functioning, should the device fall or impact violently, have it checked at an authorised customer service centre.
- The power cord must never come into contact with the appliance.
- Always disconnect the appliance after use.
- Use, charge and store the appliance at a temperature between 0 °C and 40 °C.



This appliance is designed for professional use in commercial areas.

DESCRIPTION OF THE APPLIANCE AND ITS

ACCESSORIES

Make sure your appliance is provided with the correct accessories (fig. 1 – 3 – 4 – 5).



- A Cutting head
- B/B1 On-Off switch
- C Power supply socket outlet
- D Mini USB OR USB TYPE-C* socket
- E Mini USB or USB TYPE-C* cable
- F AC/DC power adapter with power cable
- G Guide combs
- H Screwdriver
- I Charging base with LED*
- L Brush
- M Lubrication oil
- N Fixed or removable ring
- O Lever to adjust the cutting height

not present in all models

CHARGING THE APPLIANCE

Ensure that the appliance is completely dry.

Ensure that the appliance is off, or turn it off at the OFF switch B (fig. 1).

-  This appliance can be used on battery power or connected directly to the main power supply.
-  Do not completely discharge the battery in case you wish to use the appliance with the power supply cable inserted.
-  Do not recharge the appliance if the ambient temperature is below 0 °C or above 40 °C.

Recharge the appliance the first time it is used and whenever the LED starts flashing, indicating that the appliance is charging. The appliance can be charged by connecting the adaptor directly to the appliance or by connecting it via the base I (fig. 1) or by using the mini USB cable E (fig. 1).

1. Direct connection: connect adaptor connector F (fig. 1) to the port at the bottom of the appliance C (fig. 1).
2. Connection through base: insert the appliance into base I (fig. 1) and the power adaptor F (fig. 1) into the port at the bottom of the base.
3. In both cases, connect the other end of the power adapter to the main power supply.
4. While charging, the LED will remain on and turn off once the appliance is fully charged. / With switch B1 the LED will flash during charging and will remain steady when fully charged (also HCGPCC).
5. If it is not possible to connect the adapter to a compliant mains socket, the unit can be charged using the supplied mini USB or USB TYPE-C cable E (fig. 1), connected to a suitable power source. The charging time using the mini USB cable will be longer.



Fully charge the appliance at least once a year.

USE

- ATTENTION! Do not use the appliance if the blades of head A (fig.1) are damaged or if the blade block is not working correctly.
- Do not use the appliance on wet hair.

TURNING THE APPLIANCE ON AND OFF Turning on

- Lower switch B (Fig. 1) to position "1". / Press switch B1 (fig. 1). Turning off
- Lift switch B (Fig. 1) to position "0".

USEFUL TIPS FOR CUTTING

- Wash the hair as usual, dry and brush it in the direction of growth to untangle any knots.

- After drying, do not use hairspray, mousse or gel.
- Start with the larger size distance comb G (fig. 1), and gradually reduce the size until you get the desired result.
- For best results, use the appliance against the direction of hair growth.
- If hair starts to clog the adjustable guide comb, remove the comb from the appliance (see par. “Removing the adjustable guide comb”) and clean away the hair (blow and/or brush it out).

USING THE APPLIANCE



Turn off the appliance before changing or inserting any accessories.

Using the distance comb

Check that the appliance is off. Place comb G (fig. 1) on the cutting edge of the head A (fig. 1) and press it until it engages the head itself, by applying force towards the handle (fig. 2).

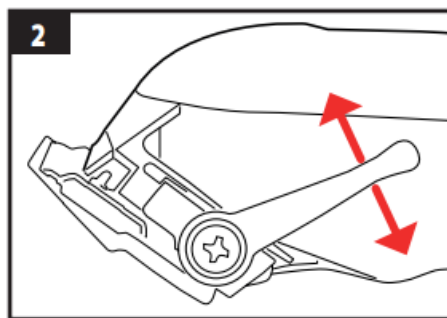

- Turn on the device.
- Cut the hair; for tips see par. “USEFUL CUTTING TIPS”. Removing the distance comb
- Turn off the appliance.
- Unhook the comb from the blade base and slide it off the appliance. Use without the distance comb



When using the appliance without the spacer comb G (fig.1), the blade of the head A (fig.1) will cut the hair very close to the skin.



Do not use the appliance if the blades of head A (fig.1) are damaged or if the blade block is not working correctly.

The appliance can be used without the guide comb G (fig. 1) to cut hair very close to the skin or to redefine the hairline of the neck and around the ears.

Replacing the coloured cover

1. Unhook the upper cover of the device by unscrewing the three/four screws behind the unit.
2. Make sure that not all the screws are removed.
3. Reassemble the cover making sure that all the components are in place.
4. Tighten the screws on the back of the housing.
5. Before using the appliance, check that it is working properly.

MAINTENANCE

In case of malfunction or damage to the appliance or a part of it, the appliance must be analysed by the manufacturer or the relevant technical assistance or in any case by a person with similar skills in order to prevent any risk. The user must not disassemble the device him/herself.

GENERAL CLEANING

It is recommended to clean daily or after every use. Check that the appliance is off and disconnected from the power mains.

- Avoid all risks of electric shock by not cleaning the appliance with water and not immersing it in water.
- Do not use abrasive solutions or concentrated detergents.
- Clean the exterior with a soft cloth or slightly damp cloth.
- After use, make sure that all parts are completely dry. Removing and cleaning the blade block
- Turn off the appliance.
- Remove the hair residues from the head using the brush L (fig. 1).
- Lubricate the head with the special oil (Fig. 5).

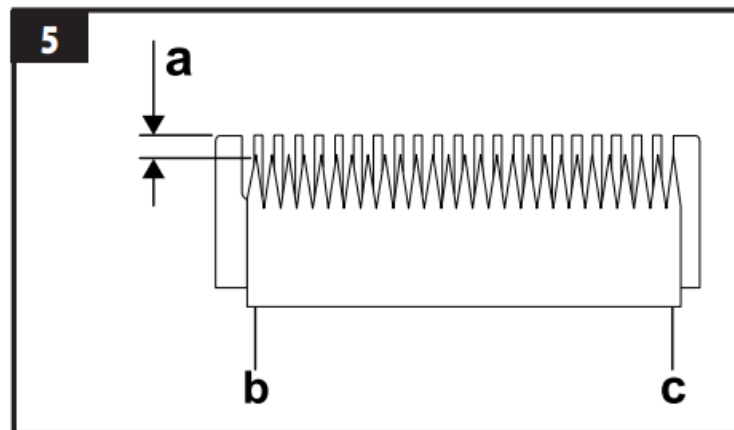

- Turn on the appliance briefly to ensure an even distribution of the oil film. For thorough cleaning, the head must be unscrewed. Maintenance, replacement and adjustment of the head

The head components can be sharp. Take particular care during the whole procedure.

- Unscrew the screws of the head and remove the cutting comb and the blade (Fig. 4)

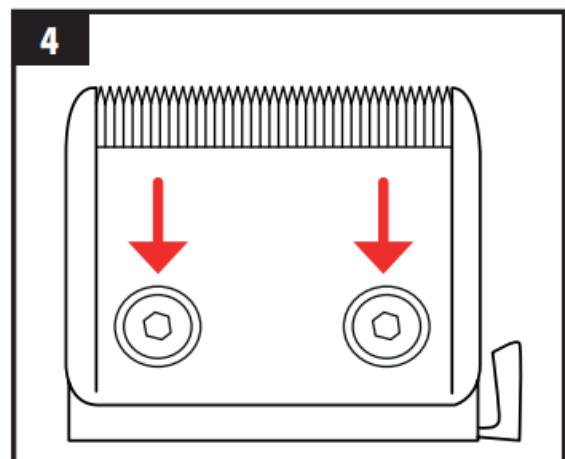
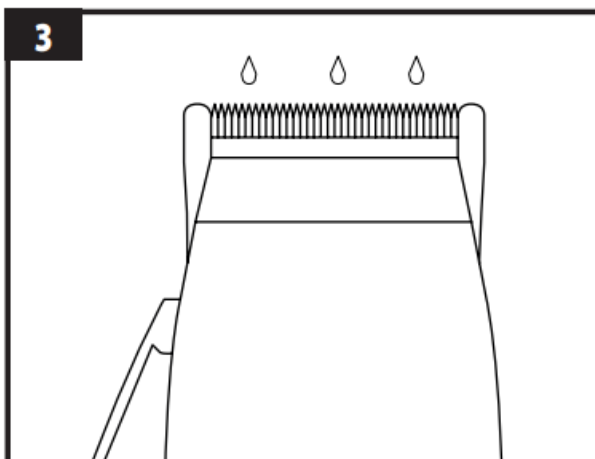

- Clean all the parts from any remaining hair.
- Reassemble by inserting the blade into the plastic feeder.

- Apply the comb and put the two screws back in.
- Before tightening the screws, check that the blade is aligned laterally to the comb (Fig. 5–b/c) and align the comb so that between the front edge of the comb and the front edge of the blade there is an approximate distance of 0.5 mm (Fig. 5-a).
- Tighten the screws.
- Recheck the alignment of the cutting comb again.
- Repeat this procedure if alignment is poor or unsafe.
- Before using the appliance, check that it is working properly.



Incorrect alignment of the blade and the cutting comb can cause injury. Ensure proper adjustment.

Lubrication

It is recommended to lubricate the blade unit daily or after every use. To ensure that the cutting blade remains sharp, the cutting head must be lubricated. It is recommended to regularly apply two to three drops of lubricant M (fig. 1) directly on the blade (fig. 5).



If after a long period of use, and despite constant cleaning and oiling, the cutting performance decreases, the head must be replaced.

Failure to lubricate the appliance is considered as “FAILURE TO COMPLY WITH THE INSTRUCTIONS FOR USE”, therefore, the warranty will be automatically rendered null and void.

DISPOSAL



The product packaging is made of recyclable materials. Separate the parts according to their type and dispose of them in accordance with applicable laws on environmental protection.



INFORMATION TO USERS in accordance with Legislative Decree No.49 of 14 March 2014 “Implementation of Directive 2012/19/EU on waste electrical and electronic equipment (WEEE)”

The crossed bin symbol on the appliance indicates that at the end of its life-span, the product must be collected separately from other waste. The user must deliver the appliance, with the essential components, at the end of its life, to the appropriate separate collection centres for electronic and electrotechnical waste, or return it to the dealer when a new applicable of equivalent type is purchased, at the rate of one to one, or 1 to zero for appliances with longer side of less than 25 mm. Adequate separate collection for the subsequent start of the appliance discharge to recycling, treatment and compatible environmental disposal helps to avoid possible negative effects on the environment and on health and favours the recycling of the appliance materials. Illegal disposal of the product by the user involves the application of administrative sanctions as per Legislative Decree no. Legislative Decree No.49 of 14 March 2014.

Disposing of the battery and power adapter.

- Turn off the appliance.
- Remove the battery from its compartment.



Do not dispose of the batteries and/or power adapter with normal domestic waste.



This appliance contains LI-PO (Lithium) type rechargeable batteries. The end user is responsible for disposing of the batteries at a special waste collection centre.

The batteries and power adapters are collected free of charge at collection points set up by your local council or by any battery retailer. By doing this, you not only comply with the law, but also help protect our environment.



ATTENTION! Do not reconnect the appliance to the power supply once the batteries have been removed.

WARRANTY

- The guarantee is valid under the current terms of law, it starts from the date of purchase and includes repair costs.
- The warranty period is 1 or 2 years depending on the type of purchaser (professional or consumer), according to current regulations.
- The guarantee is valid only with the presence of the coupon with the stamp and signature of the dealer as well as the date of purchase. Proof is the date shown on the receipt/invoice.
- The warranty covers the quality defects of the appliance due to materials or its manufacturing. Gamma Più S.r.l. undertakes to repair or replace free of charge any parts that within the period of warranty may prove in its judgement not to be efficient due to
 - material or manufacturing defects.

ATTENTION! The Warranty is void if on the appliance there are found to be direct interventions of the user or manipulation by unauthorised personnel.

THE WARRANTY DOES NOT COVER

- Damage caused by non-compliant use, improper treatment or breakage during transport.
- Damage caused by non-compliance with the user instructions.
- Damage caused by use of the appliance with incorrect mains voltage.
- Appliances which mount accessories from other manufacturers.
- Defects that do not affect the value of the ability to use the product.
- Parts subject to normal wear (head, batteries etc.)

TECHNICAL SUPPORT

For any repairs, go to www.gammapiu.it, contact your nearest service centre and inform them of the product model.

The manufacturer reserves the right to make changes and/or replace parts at any time and without prior notice if it deems it appropriate in order to always offer a reliable and long-lasting product with advanced technology.

CONTACT

- Gamma Più Srl
- Via Caduti del Lavoro, 22
- 25046 Cazzago S. Martino (BS) Italia
- Tel. +39.030.77.50.207 – 77.50.077
- Fax +39.030.72.54.999 – 77.50.206
- info@gammapiu.it
- www.gammapiu.it

Documents / Resources

	Gamma plus Absolute Alpha Clipper [pdf] User Manual Absolute Alpha Clipper, Alpha Clipper, Clipper
--	---

References

- [G Asciugacapelli, piastre, tagliacapelli professionali per capelli | Gamma+ - Gamma Più S.r.l](#)
- [G Asciugacapelli, piastre, tagliacapelli professionali per capelli | Gamma+ - Gamma Più S.r.l](#)
- [User Manual](#)

[Manuals+](#), [Privacy Policy](#)

This website is an independent publication and is neither affiliated with nor endorsed by any of the trademark owners. The "Bluetooth®" word mark and logos are registered trademarks owned by Bluetooth SIG, Inc. The "Wi-Fi®" word mark and logos are registered trademarks owned by the Wi-Fi Alliance. Any use of these marks on this website does not imply any affiliation with or endorsement.