



GameSir MFi Bluetooth Controller M2 User Manual

[Home](#) » [GameSir](#) » GameSir MFi Bluetooth Controller M2 User Manual 

GameSir MFi Bluetooth Controller M2 User Manual



Contents

- [1 Introduction](#)
- [2 Specifies](#)
- [3 Documents / Resources](#)
 - [3.1 References](#)
- [4 Related Posts](#)

Introduction

MGameSir M2 is an Apple MFi certified Bluetooth gaming controller for iOS devices including iPhone, iPad, iPad, iPod, Apple TV, and Mac. GameSir M2 provides the professional level of control that brings gamers to the next level of mobile gaming.

Specifies

Product Name	GameSir MFi Bluetooth Controller	Model	Gamesir-M2
Working Platforms	iPhone/iPod/iPad/ Mac/Apple TV with iOS 7 or later, or Mac OS v10.6 or later	Working Temperature	5°C~65°C
		Working Humidity	20~80%
Working Mode	MFi	Connection Types	Bluetooth
Charging Voltage	3.7v~5.0v	Charging Time	1~2H
Charging Current	1A~2A	Working Distance	Approx.7m
Gift Box Size	191*130*87mm	Battery Capacity	800mAh
Gamepad Size	155*102*65.5mm	Gross Weight	265g

• Key Functions

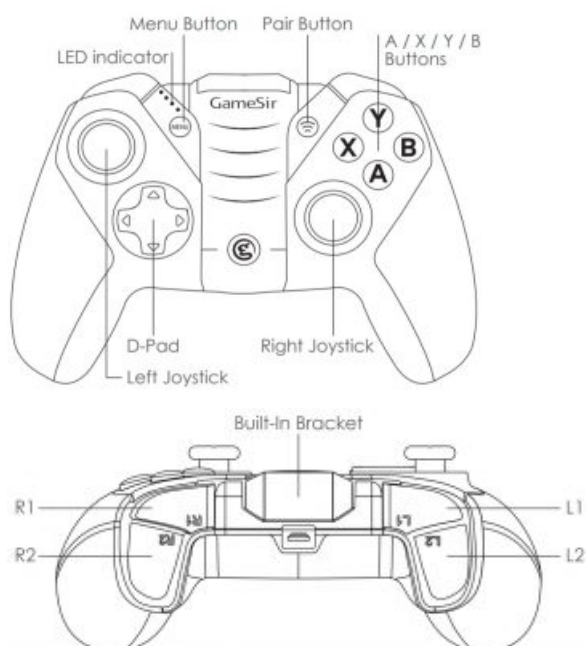

• Power On / Off

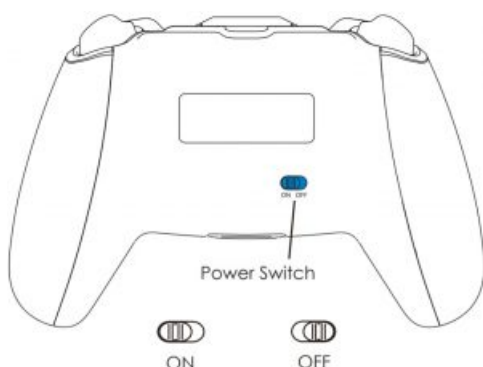

Power on: Slide the Power Switch to “ON” to turn on the controller. Power off: Slide the Power Switch to “OFF”

to turn off the controller.

- **Connecting via Bluetooth**

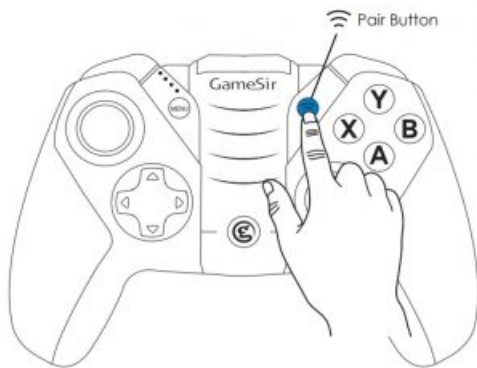

Hold down the pair button for 2s, then all LEDs will blink, It indicates that the controller is searching for the signal of your device to pair with.

- **Connecting to Your Devices**

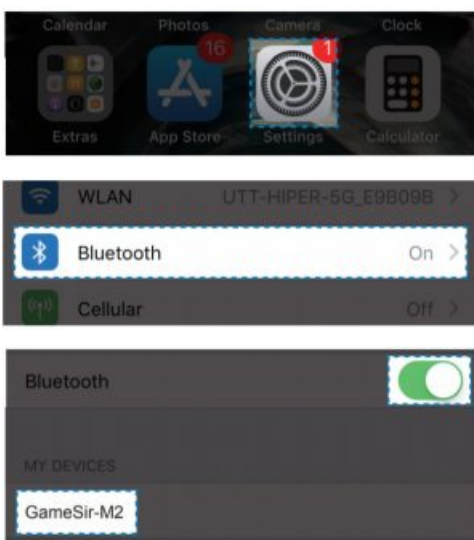

Go to Settings > Bluetooth and turn on the Bluetooth on your iOS device. Wait till “GameSir-M2” is shown on the devices list, then click “GameSir-M2” to connect.

- **Connected, Sleep & Auto-Reconnect**

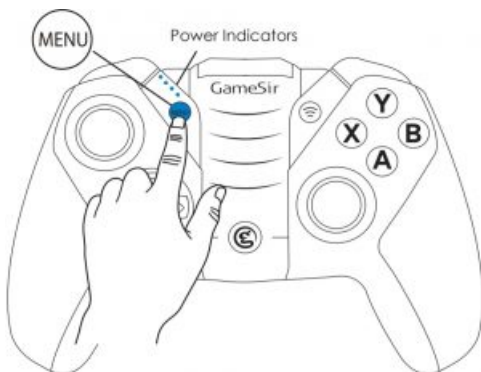

Connected: LED1 is light on while other is off Sleep Mode: Enter sleep status without any actions for 10mins

Reconnect: While in sleep mode, hold down MENU button for 2s to wake up and reconnect your device.

- **Clear Pairings & Connecting to New Devices**

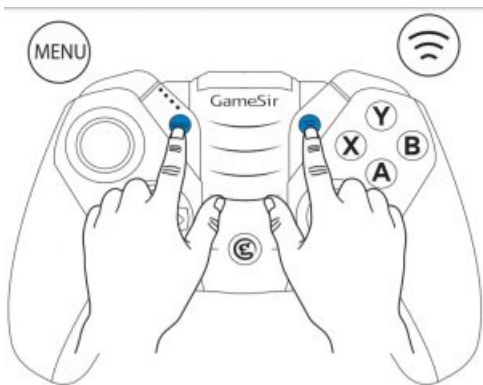

Clear Pairing: Before connecting the controller to other devices, please clear the previous paired device by holding down the Pair Button + MENU at the same time for 5s. **Connect to New Devices:** After clear the previous pairing, follow the step of connecting devices for the first time.

• Power Indicators

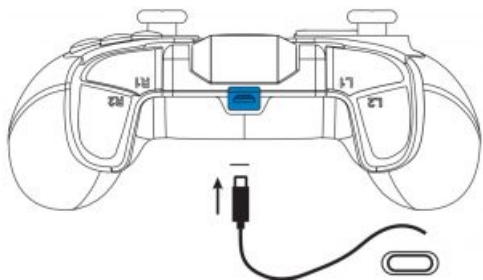
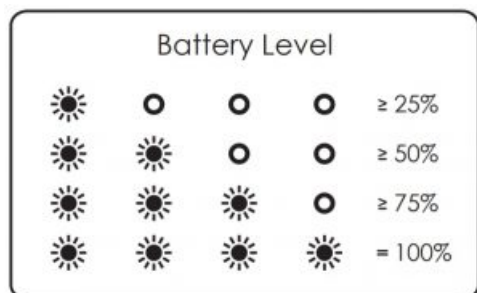

Low battery warning: When the battery remains less than 10%, LED1 will blink when the controller is power on.

Charging your M2: Connect M2 via your lightning cable to

power. When charging your M2, LED1-LED4 will blink in turns. After being full charged, all power indicators will stay on.

• GameSir World



Download GameSir World APP <http://www.xiaoji.com/url/m2help>



<https://apps.apple.com/us/app/gamesir/id1372674215>

Discover a thousand of MFi game recommendations
on GameSir World App

Website: www.gamesir.hk

Facebook: facebook.com/mygamesir

Twitter: twitter.com/mygamesir

Documents / Resources

	GameSir MFi Bluetooth Controller M2 [pdf] User Manual MFi Bluetooth Controller M2
---	--

References

- [Facebook](#)
- twitter.com/mygamesir
- [GameSir | The Global Leading Game Peripheral Brand – GameSir Official Store](#)