

GAMDIAS E4M Micro Tower Case User Guide

[Home](#) » [GAMDIAS](#) » GAMDIAS E4M Micro Tower Case User Guide 

Contents

- [1 GAMDIAS E4M Micro Tower Case](#)
- [2 Case Layout and Parts Identification](#)
- [3 Safety Information](#)
- [4 Package Contents](#)
- [5 Specification](#)
- [6 HDD Installation](#)
- [7 SSD Installation](#)
- [8 Troubleshooting and Maintenance](#)
- [9 GPU Installation](#)
- [10 Documents / Resources](#)
 - [10.1 References](#)



GAMDIAS E4M Micro Tower Case

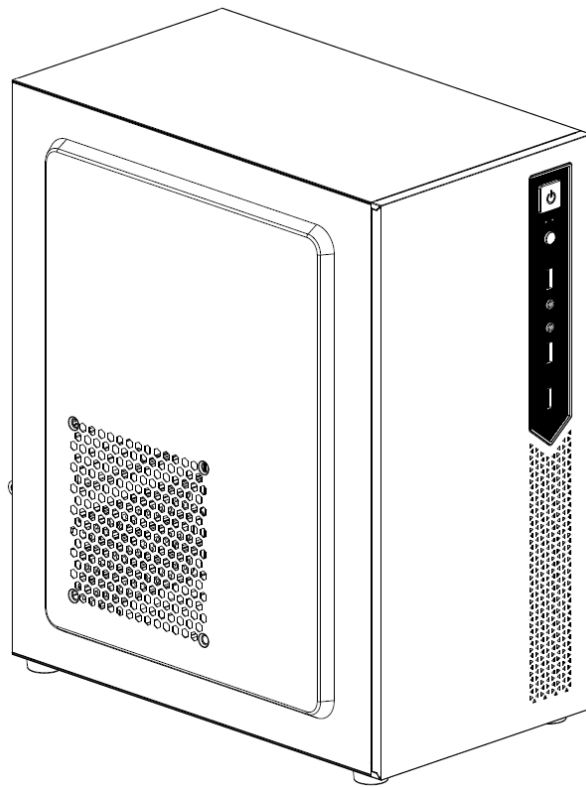

Case Layout and Parts Identification

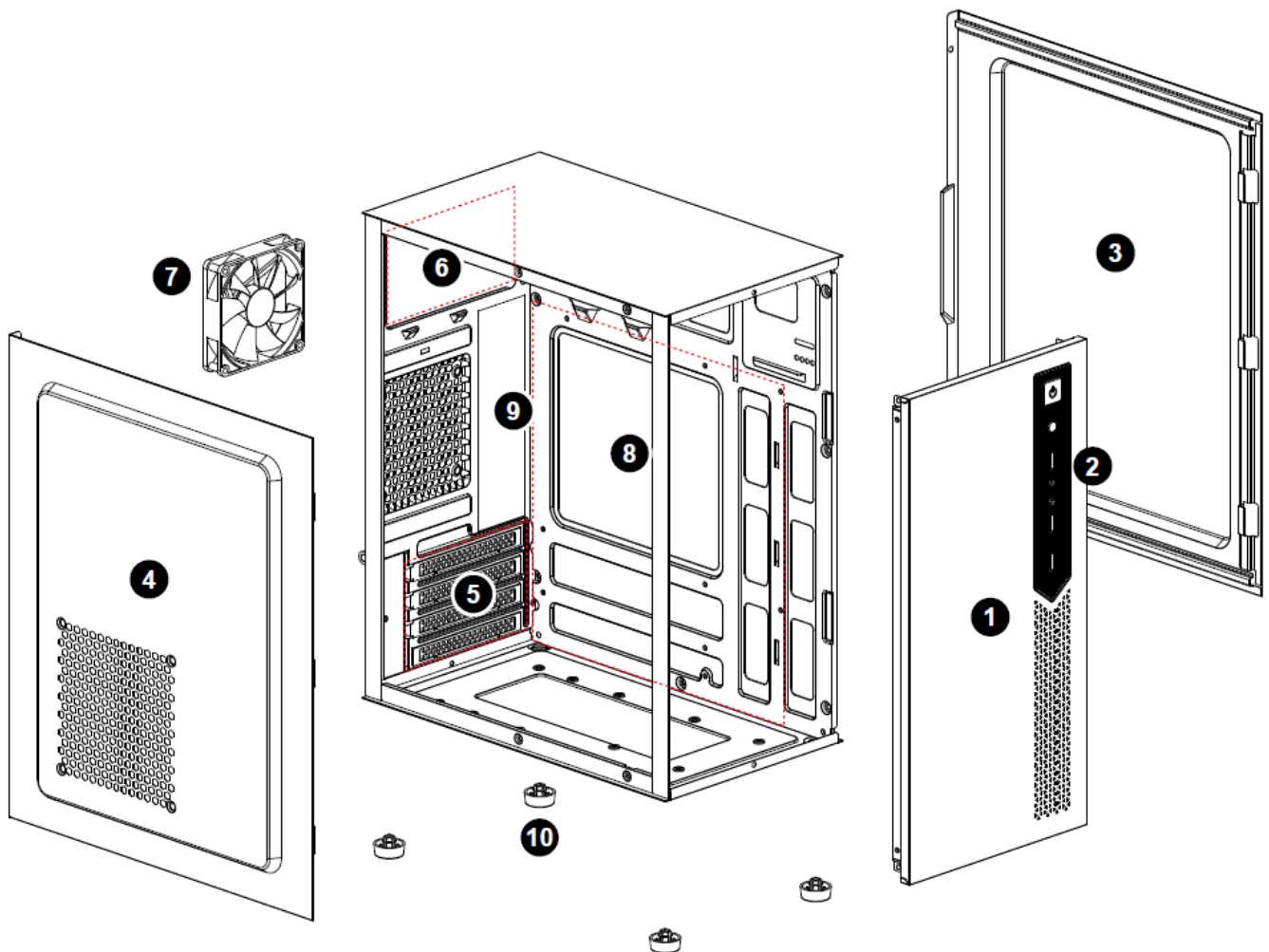

1. Front Panel
2. IO Port Module

3. Right Side Panel
4. Left Side Panel
5. PCIe Slots
6. Power Supply Unit Mounting Hole
7. Rear Fan
8. Motherboard Placement
9. Motherboard Mounting Holes
10. Chassis Pedestals

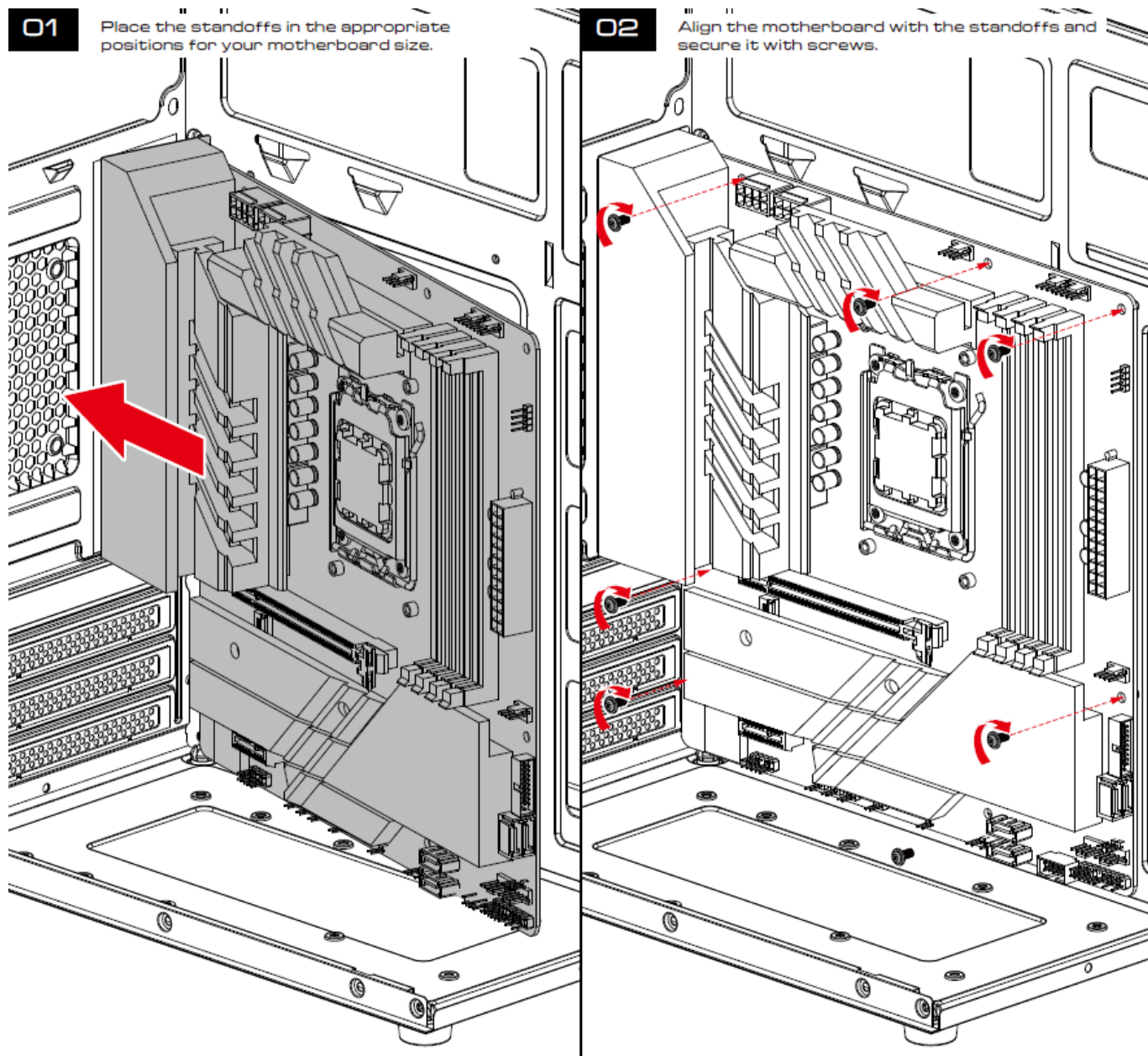

Slide the PSU into the bottom compartment.

01

Secure the PSU with screws and connect the power cables to the motherboard.

02

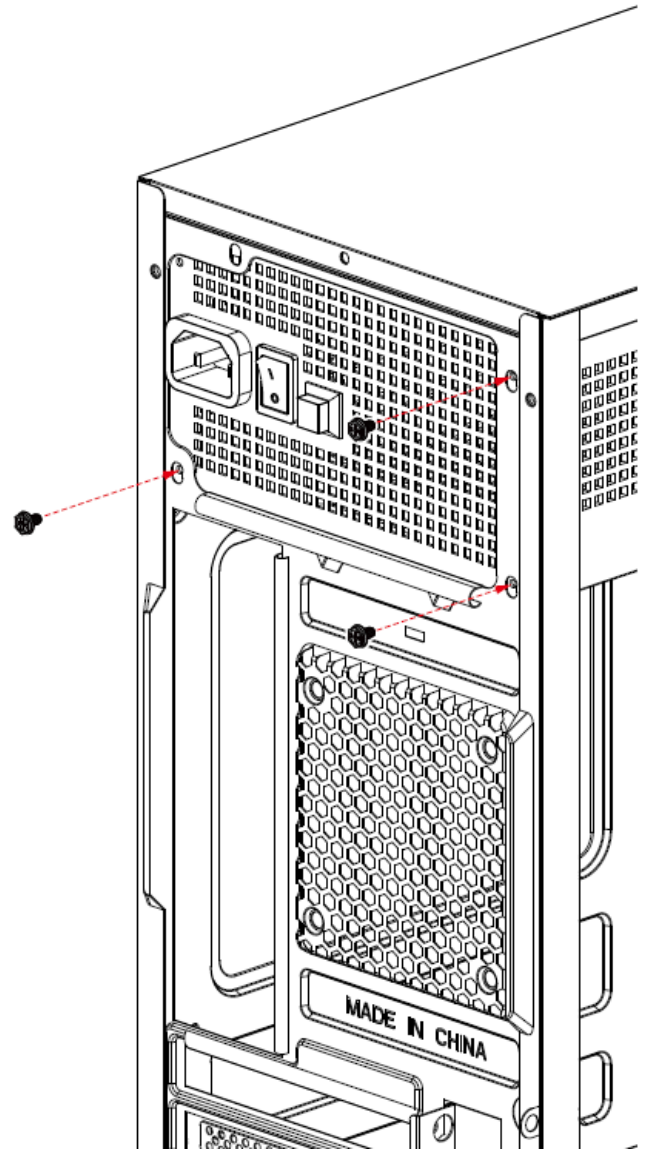
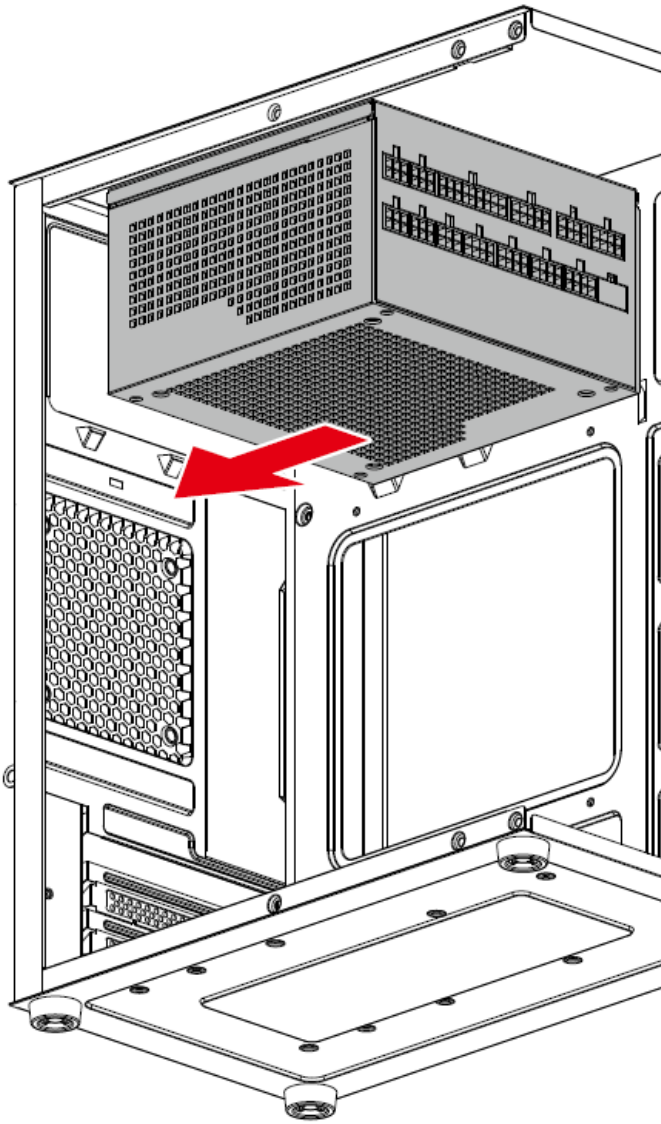

Safety Information

1. General Safety Warnings

Always ensure the computer case is placed on a stable, flat surface to prevent it from tipping over.
Keep the case away from water, moisture, or high humidity environments to avoid electrical hazards.
Do not block or obstruct the ventilation openings to ensure proper airflow and prevent overheating.

2. Electrical Safety

Disconnect the power supply before installing or modifying any internal components.
Avoid touching internal components directly; always ground yourself to prevent static discharge, which can damage sensitive components.
Use only compatible power supplies and cables, ensuring that all connections are secure and free from fraying or damage.

3. Handling Precautions

Handle the computer case with care during transportation to prevent physical damage.
Use appropriate tools when assembling or disassembling components inside the case to avoid injury.
Do not force components into place; ensure they align properly before securing them.

4. Fire Hazard Warnings

Ensure all components are properly ventilated and not overheating, as this can be a potential fire hazard.

Avoid overloading electrical circuits connected to the computer case to prevent overheating and potential fire risks.

Keep flammable materials away from the computer case.

5. Child Safety

Keep the computer case and its components out of reach of children.

Do not allow children to play with or operate the computer case, especially when it is powered on.

6. Cleaning and Maintenance

Unplug the computer case from the power source before cleaning.

Use a dry, soft cloth for cleaning the exterior of the case. Do not use liquid cleaners or aerosols.

Periodically check and clean the ventilation openings to ensure proper airflow.

7. Installation Safety

Ensure that all components are installed correctly and securely before powering on the system.

Double-check connections and screws to prevent potential hazards during operation.

Follow the manufacturer's guidelines for component installation and ensure compatibility with the case.

8. Disposal Instructions

Dispose of the computer case and its components according to local electronic waste regulations.

Package Contents

1. Gaming Case: MARS E4M
2. Chassis Protection: Styrofoam

Specification

1. Case Type: Micro Tower
2. Motherboard Support: Micro-ATX, Mini-ITX
3. Expansion Slots: 4
4. Material: SPCC, ABS
5. Product Dimension: 320 x 170 x 360 mm(12.6 x 6.7 x 12.1 inch)
6. Chassis Dimension: 290 x 170 x 350mm(11.4 x 6.7 x 13.9 inch)
7. Radiator Support: No
8. Fan Support: Rear: 1 x 80mm
9. Motherboard Sync: No
10. Drive Bays: 1 x 2.5" or 1 x 3.5"(Chassis Bottom)
11. Clearance: CPU cooler height limitation: 150mm VGA length limitation: 260mm PSU length limitation: 160mm

HDD Installation

01 Identify the appropriate drive bay in your case for the hard drive.

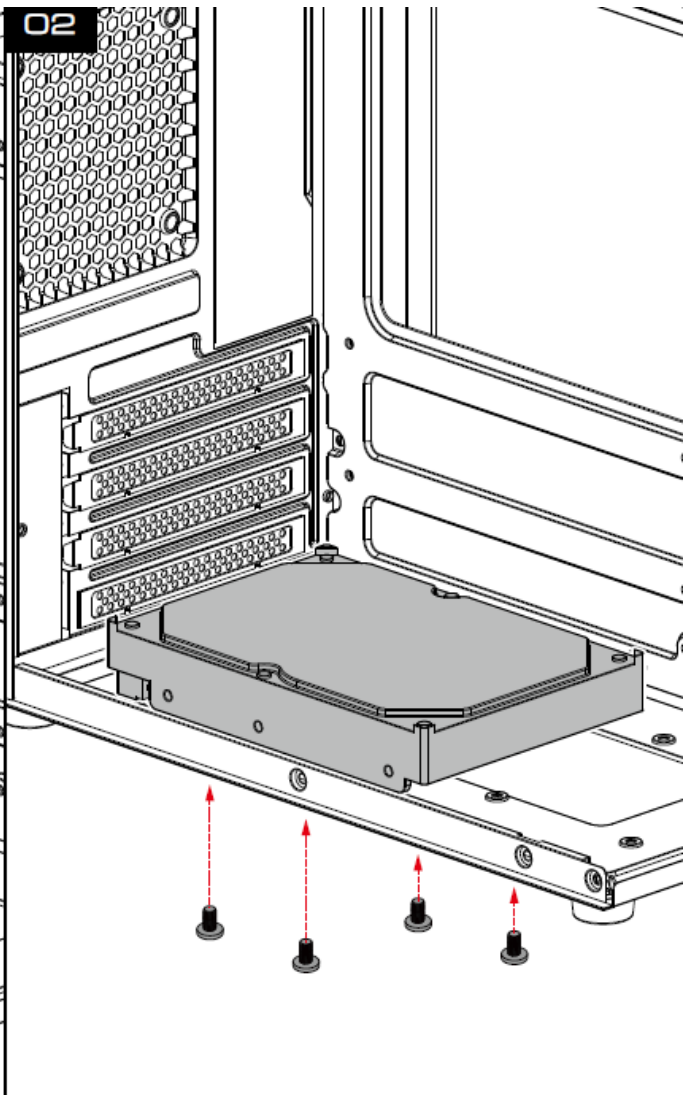
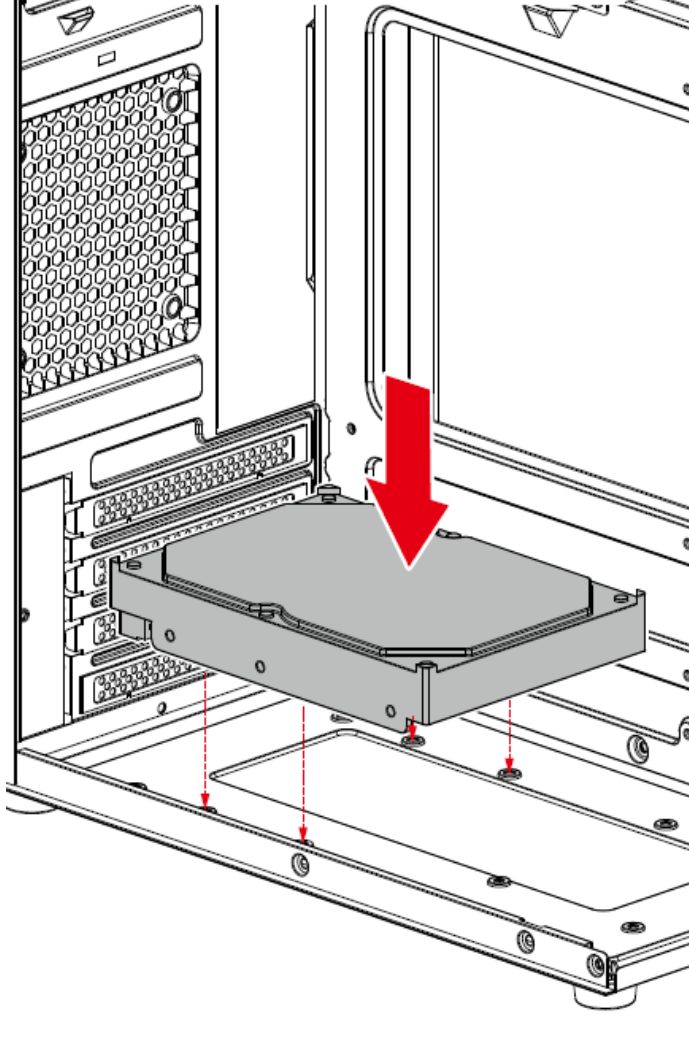

SSD Installation

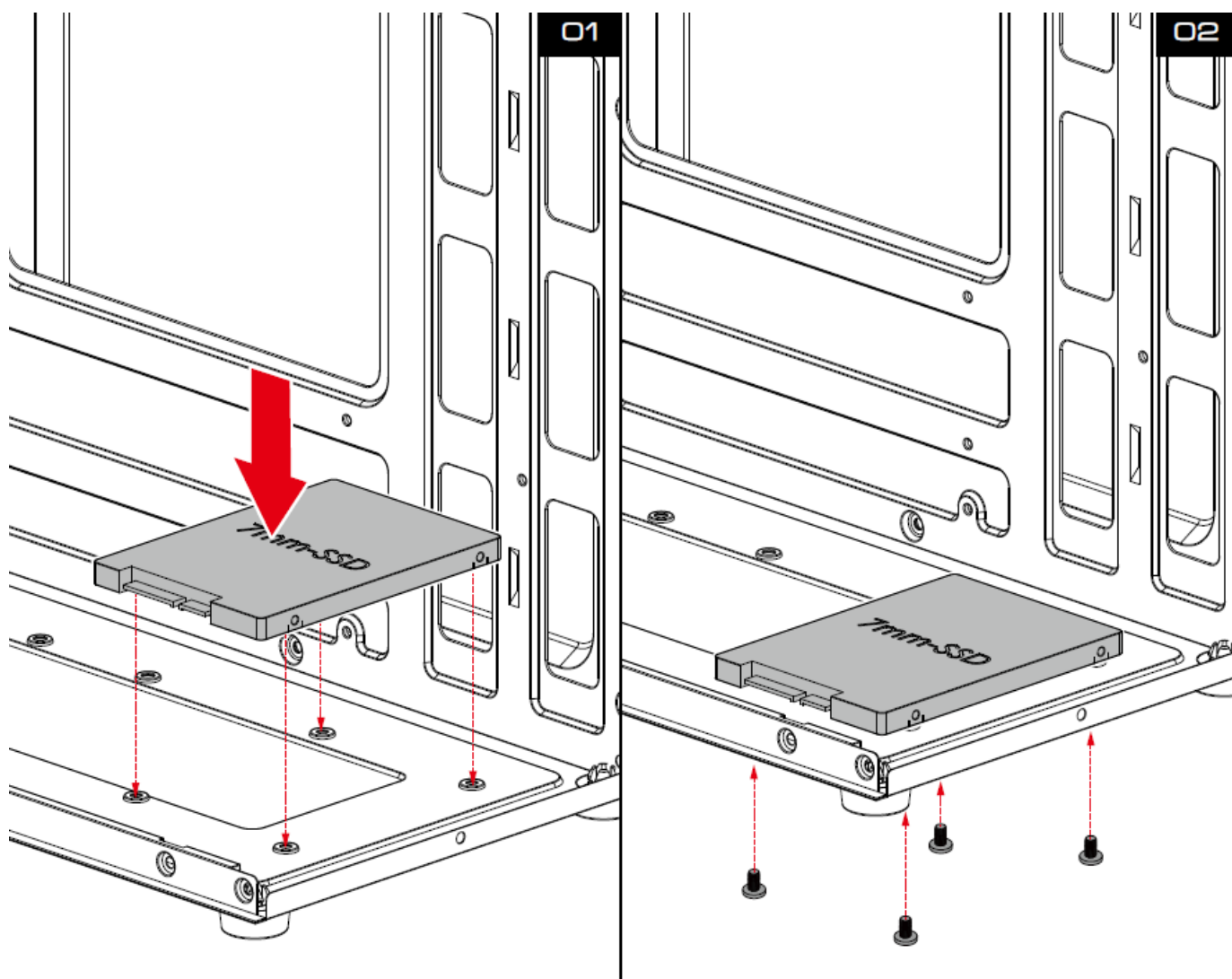

Front I/O cables

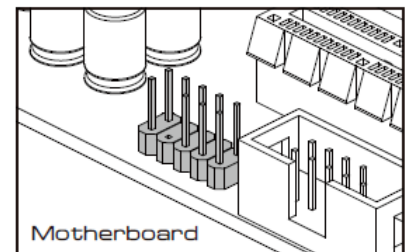
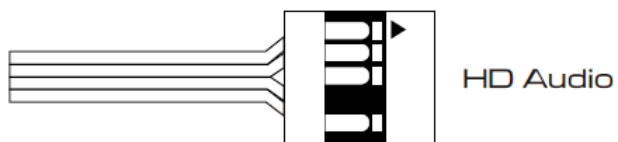
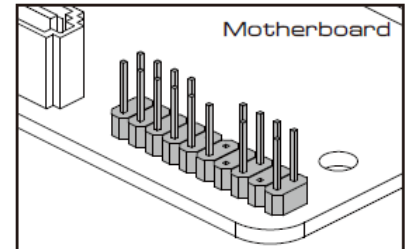
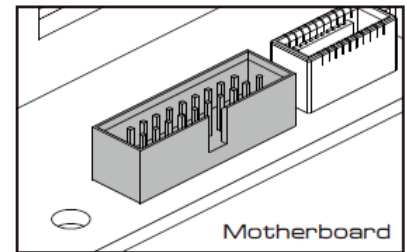
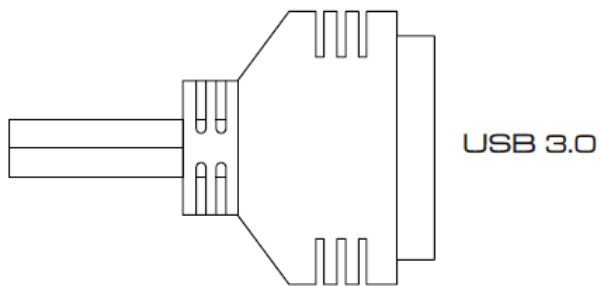

Troubleshooting and Maintenance

- Regularly clean the dust filters and fans to maintain airflow.
- Check all connections if the system is not powering on.

Warranty and Support Information

- Provide details on the warranty period and how to contact support for assistance

GPU Installation

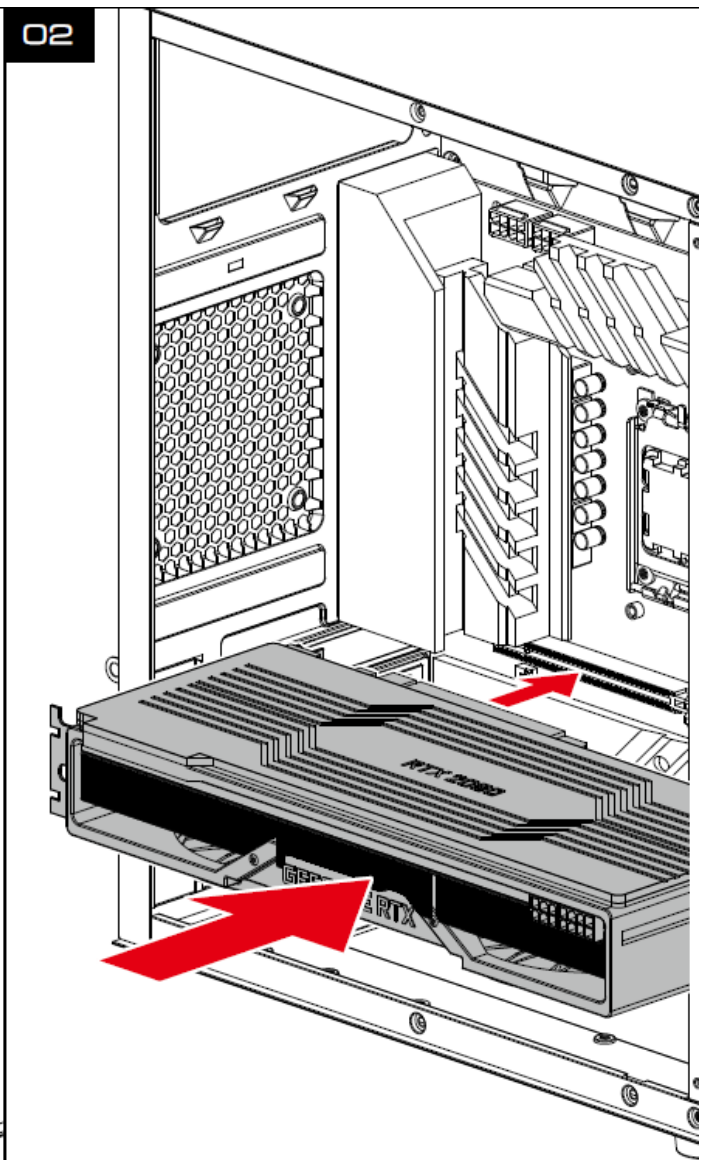
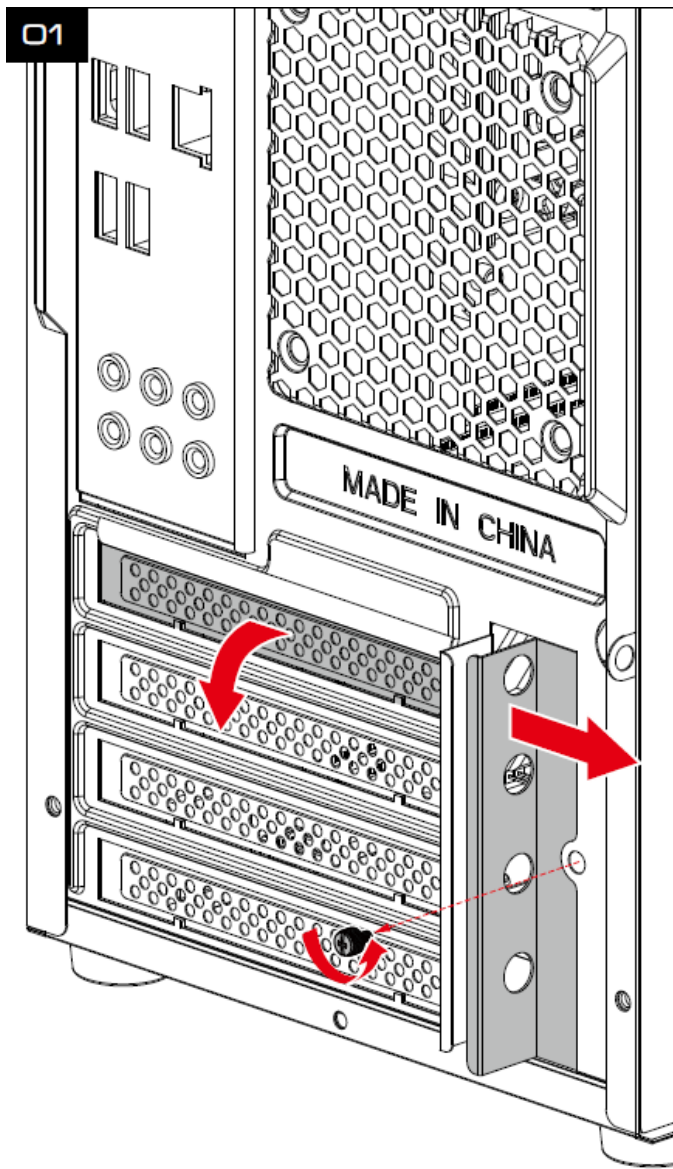

Identify the PCI-E x16 slot on the motherboard, usually the largest slot, closest to the CPU.
Align the graphics card's connector with the PCI-E slot and gently press down until the card is firmly seated in the slot.
Secure the card to the case with screws

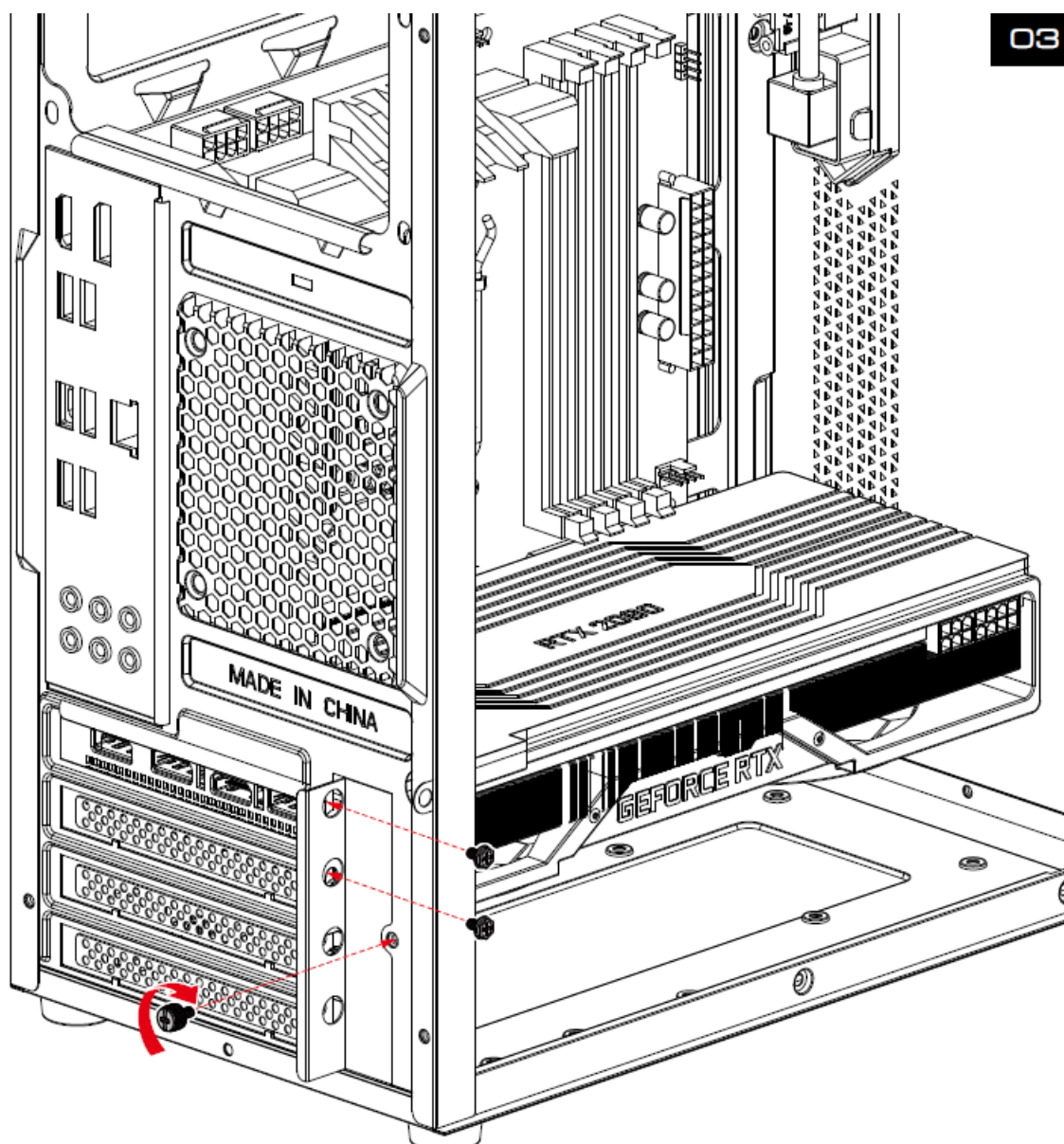

Attach the grouped cables to the case's cable management points. Ensure that the cables are not obstructing any airflow or components

Use additional zip ties or Velcro straps to secure any loose or excess cables. You can also use cable management

Documents / Resources



[GAMDIAS E4M Micro Tower Case](#) [pdf] User Guide

E4M, IE4M, E4M Micro Tower Case, E4M, Micro Tower Case, Tower Case, Tower Case

References

- [User Manual](#)

[Manuals+](#), [Privacy Policy](#)

This website is an independent publication and is neither affiliated with nor endorsed by any of the trademark owners. The "Bluetooth®" word mark and logos are registered trademarks owned by Bluetooth SIG, Inc. The "Wi-Fi®" word mark and logos are registered trademarks owned by the Wi-Fi Alliance. Any use of these marks on this website does not imply any affiliation with or endorsement.