



Gallet VEN 12 Table Fan Instruction Manual

[Home](#) » [Gallet](#) » Gallet VEN 12 Table Fan Instruction Manual 

Gallet VEN 12 Table Fan



Dear customer, thank you for purchasing our product. Please read the operating instructions carefully before putting the appliance into operation and keep the instructions including the warranty, the receipt and, if possible, the box with the internal packing. The electric fan is an appliance ensuring air circulation particularly in summer months but is designed to operate in areas where the ambient temperature does not exceed 40 °C.

Contents

[1 SAFETY WARNING](#)

[2 DESCRIPTION OF THE APPLIANCE](#)

[3 INSTRUCTIONS FOR USE](#)

[4 MAINTENANCE](#)

[5 TECHNICAL SPECIFICATIONS](#)

[6 LEGISLATIVE & ECOLOGY](#)

[7 Documents / Resources](#)

[7.1 References](#)

[8 Related Posts](#)



SAFETY WARNING

- Check whether the data on the type label correspond with the voltage in your socket. The power cord plug has to be connected to the properly connected and grounded socket according to the national standard.
- This appliance can be used by children aged from 8 years and above and persons with reduced physical, sensory or mental capabilities or lack of experience and knowledge if they have been given supervision or instruction concerning use of the appliance in a safe way and understand the hazards involved. Children shall not play with the appliance. Cleaning and user maintenance shall not be made by children without supervision. Children younger than 8 years must be kept out of reach of the appliance and its power cord.
- Before replacing accessories or accessible parts, which move during operation, before assembly and disassembly, before cleaning or maintenance, turn off the appliance and disconnect it from the mains by pulling the power cord from the power socket!
- Always unplug the appliance from power supply if you leave it unattended and before assembly, disassembly or cleaning.
- Never use the appliance if the power cord or power plug are damaged, if it is not functioning correctly or if it has fallen on the floor and been damaged or if it has fallen into water. In such cases take the appliance to a professional service centre to verify its safety and correct function.
- If the power cord of the appliance is corrupted, it has to be replaced by the manufacturer, its service technician or a similarly qualified person so as to prevent dangerous situations.
- The fan must not be immersed into water or other liquids (even partially) and it must not be used in close proximity of bathtubs, showers, wash basins or other water containers, including a swimming pool. If the ventilator falls into water, do not take it out! First of all unplug the power cord from the socket and only then take out the fan. In this case take the appliance to a special service to check its safety and proper function.
- The appliance is intended for home use and similar (in shops, offices and similar workplaces, in hotels, motels and other residential environments, in facilities providing accommodation with breakfast). It is not intended for commercial use!
- Do not fix the fan on a wall or ceiling.
- This appliance is not intended for outdoor use.
- Do not plug the fork of the supply cord into the power outlet and do not unplug the cord with wet hands or by pulling by the supply cord!
- The appliance cannot be used in bathrooms in zones 0, 1 and 2 HD 384.3 S1! It must not be used in close

proximity of bathtubs, a shower or a swimming pool.

- The appliance must not be used in damp or wet environment and in any environment with the danger of fire or explosion (spaces where chemicals, fuels, oils, gases, paints and other flammable or volatile materials are stored).
- Use the appliance in the working position only at places with no risk of turning over and in a sufficient distance from objects (such as curtains, drapes, etc.), heat sources (e.g. fireplace, heater, stove, cooker, radiators, hot air ovens, grills) and wet surfaces (e. g. sinks, wash basins).
- Make sure that impurities do not enter into the appliance (e.g. clouds of dust, hair etc.). If impurities are sucked and settled inside the appliance, clean it (see par. **IV. MAINTENANCE**).
- Do not put the switched on fan on soft surfaces (e.g. on a bed, towels, wipers, carpets).
- Do not switch on the fan if the appliance is not completely assembled or if the blade wheel covers are damaged.
- When handling the appliance, try to prevent injury.
- Please check before every connection of the appliance to power supply whether the switches on the control panel is in the off position and always disconnect the appliance from power supply after use.
- There must not be any device with open flame in the flow of the air coming out from the appliance because of danger of burning process interruption.
- Never let the flow of air blow on you (or animals) for an extended period of time. It may cause health problems.
- Use only original parts designed for this type.
- Holes for air ventilation must not be covered.
- Never put fingers or other objects into inlet and outlet holes of the fan.
- Check the condition of the power cord of the appliance regularly.
- Never put the power cord on hot surfaces or do not let it hang over the edge of a table or a work top. Plugging or pulling the power cord e.g. by children can result in tilting over or drawing the appliance down and serious injury!
- The power cord must not be damaged with sharp or hot objects, open fire, it must not be sunk into water or bent over sharp edges.
- Do not wind the power cord around the appliance, this will extend life of the power cord.
- Use this appliance only for the purpose for which it was designed as specified in this user's manual. Never use the appliance for any other purpose.
- The producer does not guarantee any loss caused by improper handling of the appliance and its accessories (e. g. electrical accident, fire) and its guarantee for the appliance does not apply in the case of non-compliance with the safety instructions above.

DESCRIPTION OF THE APPLIANCE

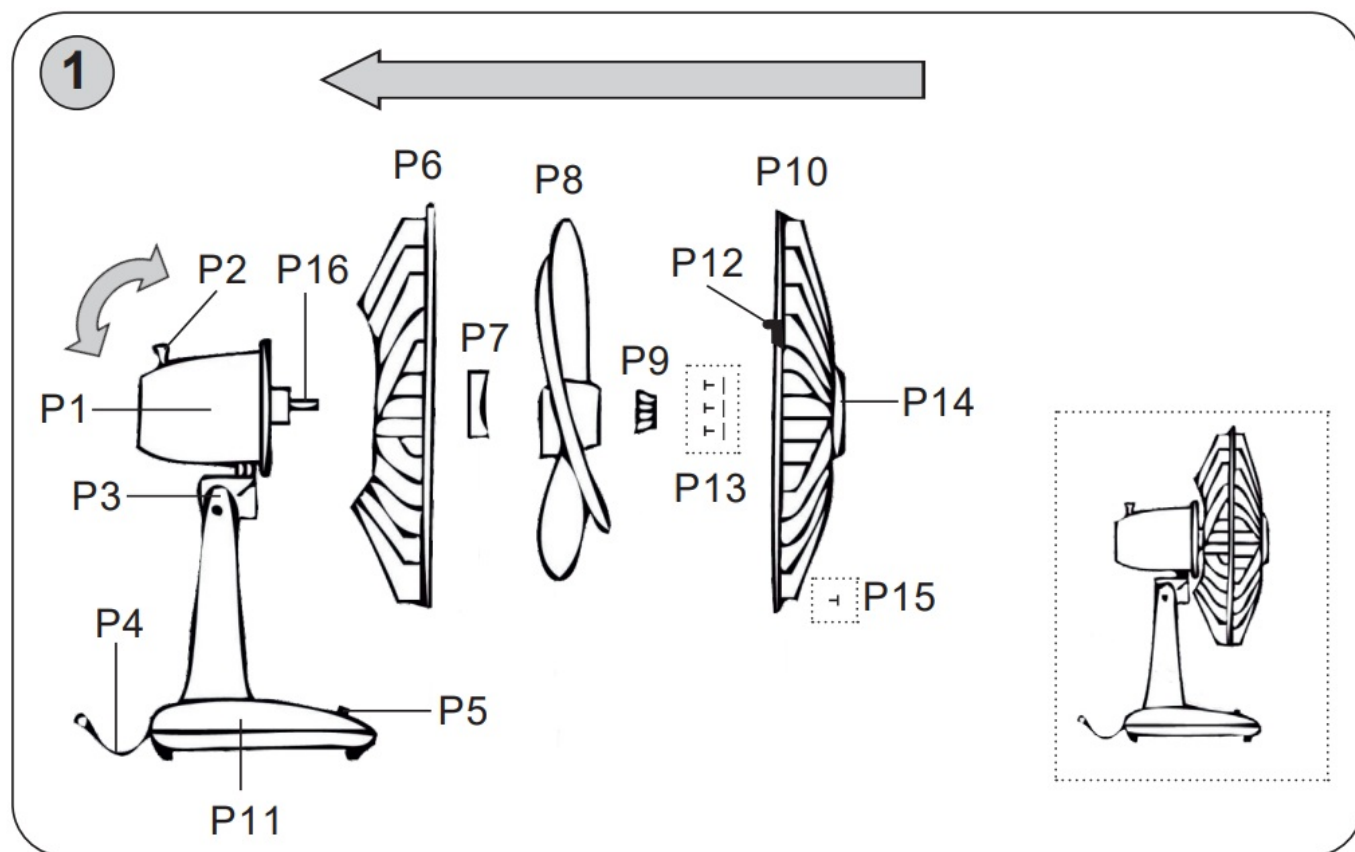

- P1** Motor unit
- P2** Oscillating knob
- P3** Adjustable joint angle
- P4** Power cord
- P5** Speed switch
- P6** Rear grill
- P7** Grill screw
- P8** Blade
- P9** Blade screw
- P10** Front grill
- P11** Base
- P12** Clip
- P13** Screw A
- P14** Vane
- P15** Screw B
- P16** Shaft

INSTRUCTIONS FOR USE

Assembling of unit (see Fig. 1)

Take all parts out of the box and remove all packing material

1. Unscrew the grill screw **P7** and blade screw **P9** from motor unit **P1**.
2. Place the rear grill **P6** onto the motor unit **P1** and screw this part by grill screw **P7**.
3. Place the fan blade **P8** onto the motor shaft **P16**.
4. Screw on the blade by the blade screw **P9** in an anticlockwise direction.
5. Fasten the vane **P14** on the front grill **P10** by swivel adjustment screw **P13** (if not already fitted at the factory).
6. Once finished, put the front protective cover **P10** on the rear protective cover **P6** and secure it with buckles **P12** and screw **P13**.
7. If needed, you can adjust the air flow angle by the joint **P3**.

Note:

Apply reverse procedure to disassemble the unit.

Velocity control and selection

Plug the assembled fan into wall socket.

Turn on the fan by pressing one of the four buttons on the fan base P5.

First button switches the fan off. Description of buttons:

Button (3) – High air flow velocity

Button (2) – Medium air flow velocity

Button (1) – Low air flow velocity

Button (0) – Off

Oscillation

For run the oscillation (rotate from side to side) press the oscillation knob **P2**. To stop oscillation, pull the oscillation knob **P2** out.

MAINTENANCE

Unplug the unit before cleaning or storing. Wipe the unit with an absorbent tissue, paper towel or soft cloth. Never use an abrasive to clean the appliance. Do not immerse the appliance or the cord in water or any other liquid.

TECHNICAL SPECIFICATIONS

- Acoustic noise level of 45 dB(A) re 1pW
- Input 35 W
- Protection class II
- **Size:** 34 x 47 x 25,5 cm
- **Weight (NETTO):** 1.6 kg

Power consumption in off mode is 0.00 W.

Expert service must do the large maintenance or to intervene into inside parts of the appliance! Non-observance of the instructions of the manufacturer cancels the right for guarantee repair! The manufacturer reserves the right to change the technical specifications and accessories for the respective models.

LEGISLATIVE & ECOLOGY

WARNING: DO NOT USE THIS PRODUCT NEAR WATER, IN WET AREAS TO AVOID FIRE OR INJURY OF ELECTRIC CURRENT. ALWAYS TURN OFF THE PRODUCT WHEN YOU DON'T USE IT OR BEFORE A REVISION. THERE AREN'T ANY PARTS IN THIS APPLIANCE WHICH ARE REPARABLE BY CONSUMER. ALWAYS APPEAL TO A QUALIFIED AUTHORIZED SERVICE. THE PRODUCT IS UNDER A DANGEROUS TENTION.

Disposal of old Electrical & Electronic Equipment (Applicable in the European Union and other European countries with separate collection systems).



■ This symbol on the product or on its packaging indicates that this product (or battery/accumulator) shall not be treated as household waste. Instead it shall be handed over to the applicable collection point for the recycling of electrical and electronic equipment. By ensuring this product is disposed of correctly, you will help prevent potential negative consequences for the environment and human health, which could otherwise be caused by inappropriate waste handling of this product. The recycling of materials will help to conserve natural resources. For more detailed information about recycling of this product, please contact your local Civic Office, your household waste disposal service or the shop where you purchased the product.

DO NOT COVER. HOUSEHOLD USE ONLY. DO NOT IMMERSE IN WATER OR OTHER LIQUIDS.



TO AVOID DANGER OF SUFFOCATION, KEEP THIS PLASTIC BAG AWAY FROM BABIES AND CHILDREN. DO NOT USE THIS BAG IN CRIBS, BEDS, CARRIAGES OR PLAYPENS. THIS BAG IS NOT A TOY.

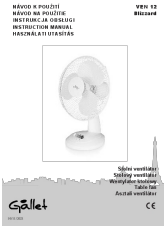

Documents / Resources

	<p>Gallet VEN 12 Table Fan [pdf] Instruction Manual VEN 12 Table Fan, VEN 12, Table Fan</p>
---	---

References

- [Serwis Digison](#)
- [Gallet Česká Republika– Gallet CZ](#)