



## G21-VITALITY Sous Vide G21 Akura User Manual

[Home](#) » [G21-VITALITY](#) » G21-VITALITY Sous Vide G21 Akura User Manual 



**VITALITY**  
**Manual Sous Vide G21 Akura**



**Thank you for your purchase!**

Read the manual before using the appliance to avoid damaging it.

### Contents

- [1 Appliance parts](#)
- [2 Safety first](#)
- [3 Container](#)
- [4 Setup \(temperature, time\)](#)
- [5 Wifi](#)
- [6 Maintenance](#)
- [7 Troubleshooting](#)
- [8 Documents / Resources](#)
- [9 Related Posts](#)

### Appliance parts

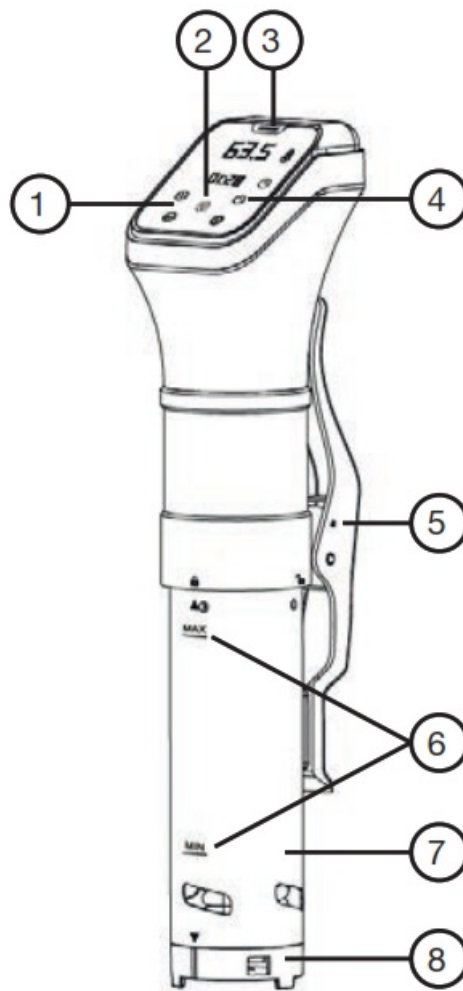

1. +,- button	5. Clamp
2. Wifi	6. Min and Max water level
3. Working illuminator	7. Stainless steel skirt
4. On/Off button	8. Water pump cap

## Safety first

When using electrical appliances, basic safety precautions should always be followed including the following:

- Countertops such as marble and Corian cannot withstand the heat generated by the appliance. Make sure your countertop can withstand the heat or place the cooking container on different surfaces to prevent damage.
- Do not use extension cords. Use properly grounded electrical outlets only.
- Do not immerse the appliance past the top edge mark of the stainless steel skirt.
- Only the stainless steel skirt and the pump housing are dishwasher safe.
- Unplug from outlet when not in use and before the cleaning process.
- Burn hazard – the cooking container, the stainless steel part of the appliance, and the food pouches all get hot when used. Use oven mitts or tongs when handling. Allow the system to cool down before emptying the water bath.
- This appliance is not a toy and is meant to be used indoors only.
- Do not disassemble, check all warning labels, and don't remove them.

- Do not use this appliance for anything other than its intended use. (Like laboratory work or heating water in a bathtub).
- Firmly lock the product by clamping it on the side of your container. Place the container on an even surface to prevent spilling. Do not place the unit in the oven.
- Do not use deionized water.
- Before plugging the appliance into a socket, check whether your voltage corresponds with the rating label of the appliance.
- Don't let children use the appliance.
- Never use a damaged appliance.
- The supply cord cannot be replaced. If the cord is damaged, don't use the appliance. Dispose of the appliance in an environmentally friendly manner or send it back to the manufacturer.
- Don't let excess cord hang over the edge of the table or countertop or touch a hot surface.
- Switch off the appliance and unplug it from the outlet before changing accessories.
- If the appliance falls down into the container with water, firstly unplug it from the outlet, then take it out of the water and dry the appliance. When the appliance is completely dry, it is ready for use. Sous Vide cookers are designed to be used with water only.

## Container

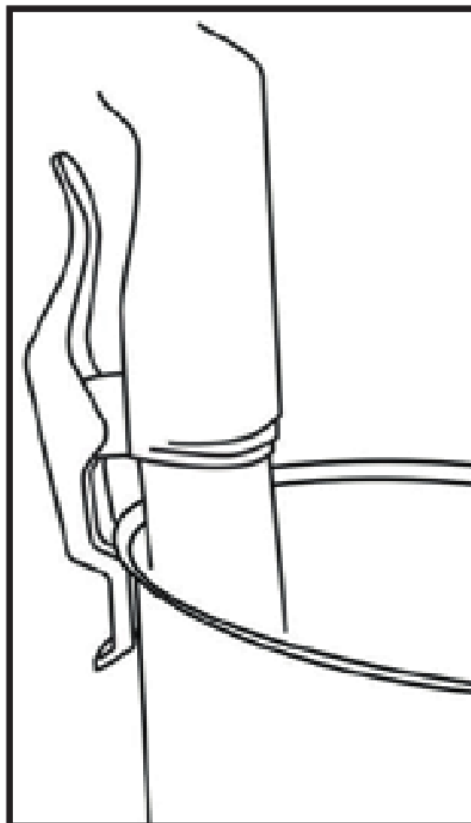

Sous Vide cooker requires a 6–20L container. Firmly lock the appliance by clamping it on the side of your container.





## Setup (temperature, time)

1. Plug it into the outlet. The on/off icon and the working lamp will be on and it will enter standby mode. Press the on/off icon to enter the setting mode. You will hear the sound of a beep with every pressing.

## 2. Temperature setting

Press the  or  adjust button to set the temperature.

## 3. Time setting

Press the  icon to set the time. The timer will flash. Firstly, press the + or – adjust button to set the hour, then press the  icon again to set the minutes. Press the icon to confirm the setting. The timer will start the countdown when the appliance meets the setting temperature.

4. If you want to change the setting, press and hold the icon  for 3 seconds and then repeat the setting as above.

5. Press and hold the  icon for 3 seconds to stop.

The unit will automatically stop working when the time runs out and an „END“ icon will show on the screen.

## Wifi

Press and hold the  wifi icon for 3–5 seconds until you hear the sound of the beep. Go to „add appliance“ in the G21 SmartHome application, choose Sous Vide cooker and follow the instructions in the app.



<https://play.google.com/store/apps/details?id=com.penta.smart&hl=cs>

<https://apps.apple.com>

## Maintenance

- Always turn off the appliance and unplug it from the outlet.
- Make sure you use the appliance at room temperature.

Check for signs of damage including pulled cord or physical damage to the system or heaters. If any signs of physical damage are found, please send it back to the manufacturer.

### Install the stainless steel skirt

Hold and press the clamp so that it does not interfere with the stainless steel skirt. Place the skirt on the upper part of the cooker and twist it to the left to align the arrow and locked symbol.

**Warning:** Be cautious with the stainless steel propeller when it crosses over the hole of the stainless steel skirt.

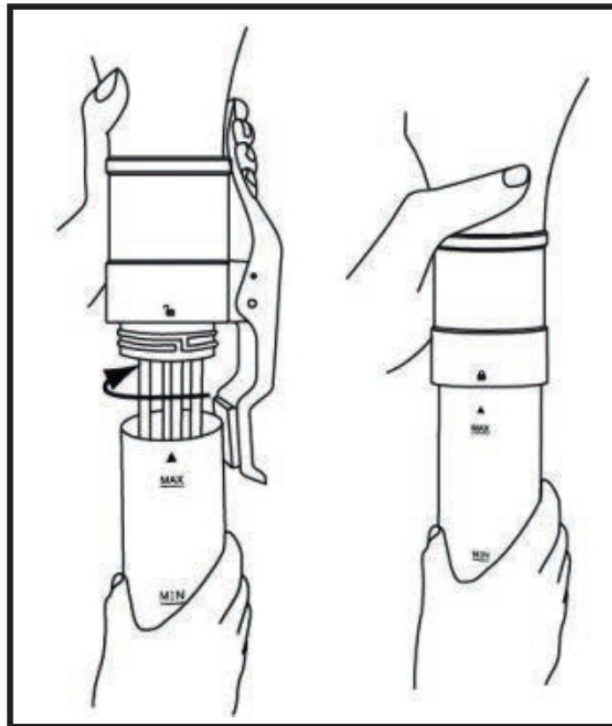

### Uninstall the stainless steel skirt

Hold and press the clamp, twist the stainless steel skirt to the right and carefully take the skirt off. Be cautious with the propeller – it needs to go through the hole in the water pump cap.

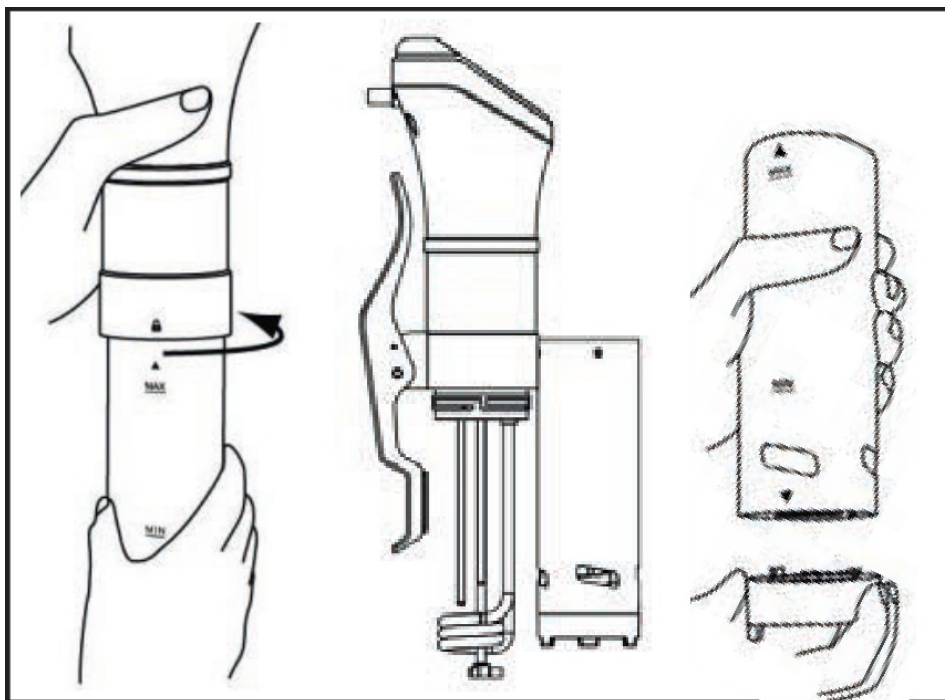

### Maintenance (skirt/pump)

Twist the stainless steel skirt out of the locked position and take it off. The stainless steel skirt and the water pump cap are dishwasher safe.

### Cleaning

For cleaning the heating coil, pump shaft, and sensors, use dish soap, a soft toothbrush, and rinse underwater.

### Troubleshooting

#### Grinding noise

The stainless steel skirt is loose. Push it up into the guide groove and turn to the left until you hear a click. With the

skirt secured, the noise will go away. There also might be a chance the stirring shaft was bent. In that case, unscrew the bottom pump disk and gently push the impeller till it is centered.

#### **Slurping noise**

The pump has formed a water vortex-like when you empty out a sink or bathtub. Add more water or gently disturb the water with a spoon. There is no sure way to eliminate the vortex from forming due to the pump rotation, but it will usually go away on its own.

#### **Gurgling and woosh noise**

The pump is sucking air and you should also see small bubbles in your tank – add more water.

#### **The system will not turn on**

Check the power plug and breakers.

#### **Low water level alarm**

The water level may drop during operation by the pump due to water turbulence – add more water. If the alarm turns on after a few seconds of operating, add more water. Sometimes the waves will cause the water level at the sensors to fluctuate up and down.

**Error code EE1 will appear in the following situation s:**

- no water in the tank
- water below the minimal level



Technical specification:  
Power rate: 220-240V, 50Hz, 1000W  
Temperature range: 0°C-90°C  
Temperature stability:  $\pm 0,1^{\circ}\text{C}$   
Circulation pump: 12 LMP max

The English version of the manual is an exact translation of the original manufacturer's instructions. Images used in this manual are for illustrational purposes only and may differ from the actual product.





[G21-VITALITY Sous Vide G21 Akura](#) [pdf] User Manual  
G21-VITALITY, Sous, Vide G21, Akura