

G-Homa
OT1002
MECHANICAL
OUTLET
TIMER



G-Homa OT1002 Mechanical Outlet Timer Operating Manual

[Home](#) » [G-Homa](#) » G-Homa OT1002 Mechanical Outlet Timer Operating Manual 

Contents

- [1 G-Homa OT1002 Mechanical Outlet Timer](#)
- [2 INTRODUCTION](#)
- [3 SPECIFICATIONS](#)
- [4 WHAT'S IN THE BOX](#)
- [5 PRODUCT OVERVIEW](#)
- [6 FEATURES](#)
- [7 SETUP GUIDE](#)
- [8 CARE & MAINTENANCE](#)
- [9 TROUBLESHOOTING](#)
- [10 PROS & CONS](#)
- [11 WARRANTY](#)
- [12 FREQUENTLY ASKED QUESTIONS](#)
- [13 VIDEO – PRODUCT OVERVIEW](#)
- [14 References](#)

G-Homa

G-Homa OT1002 Mechanical Outlet Timer



INTRODUCTION

The G-Homa OT1002 Mechanical Outlet Timer is an easy-to-use gadget that controls when electrical tools turn on and off, making them work automatically. This simple timer, which costs only \$12.99, can be used to control lights, fans, and other appliances in gardens, homes, and businesses. The G-Homa OT1002 has 48 settings, which gives you a lot of freedom to make different plans. It can handle 125 Volts, 15 Amps, and 1875W Resistive, so it can be used with a lot of different devices. This timer was first released on August 31, 2022. It was made by G-Homa, a well-known name that is known for making high-quality electronics. Its small size (1.5 inches deep, 2.9 inches wide, and 4.7 inches high) makes it easy to fit in any room, and the 1-year manufacturer guarantee gives users peace of mind. This timer is great for any home or office because it lets you decide how much power you use or set it to do everyday tasks automatically.

SPECIFICATIONS

Brand	G-Homa
Price	\$12.99
Product Dimensions	1.5 D x 2.9 W x 4.7 H Inches
Item Weight	0.26 Kilograms (9.1 ounces)
Number of Settings	48
Rating	125 Volts, 15A, 1875W Resistive, 1/2HP
Manufacturer	G-Homa
Item Model Number	OT1002
Warranty Description	1 year manufacturer warranty

WHAT’S IN THE BOX

- Mechanical Outlet Timer
- Manual

PRODUCT OVERVIEW



FEATURES

- **Customizable 24-Hour Control:** The timer is very flexible, so you can set it to work for you at any time of the day or year. The DARK part of the scale shows that it is nighttime, and the WHITE part shows that it is daytime.
- **Heavy Duty:** The timer can handle high-power devices like pool pumps, aerators, waterfalls, and engine block heaters because it can handle up to 1/2HP. This makes it useful for a variety of outdoor uses.
- **48 ON/OFF Settings:** The timer has 48 ON/OFF settings spaced every 30 minutes, so you can make exact schedules that run every day without having to reset.



- **No Hard Programming:** You don't need to do any complicated programming—just put the pins down to set the ON time and pull them up to set the OFF time.
- **Waterproof and Rugged Design:** The timer was made to be used outside, so it has a clear lid and case that are both waterproof and rugged. This means it will work in any weather, including rain, wind, and snow.



WATERPROOF

PLEASE USE OUR TIMER VERTICALLY AT
LEAST 2FT ABOVE THE GROUND

- **Two Grounded Outlets:** The timer has two grounded outlets, so it can stay safe and control multiple devices at once, like outdoor lights and decorations.
- **ETL Listed:** The timer is ETL listed, which means it meets safety standards for use outside and can be trusted to control electrical devices.
- **Rating for 15A and 1875W resistive:** This timer is rated at 125V 60Hz for resistive use and 15A and 1875W for general use. It can handle most outdoor devices.
- **Compatibility with Tungsten Lamps:** It is made to safely handle up to 10A for tungsten lamps, so you can use it to run a wide range of lighting fixtures.
- **Easy-to-Read Dial:** The timer is easy to set because the dial is clear and easy to understand. The color-coded parts (white for day, dark for night) make the schedule easy to see at a glance.
- **Saving energy:** Setting up outdoor lights and tools to work only when they're needed can save you time and energy.
- **Small Size:** Measuring 1.5 x 2.9 x 4.7 inches, it's easy to put in small areas thanks to its small size.
- **Warranty for Life:** The timer has a 1-year warranty from the maker, and customer service in the USA is quick to respond and helpful.
- **Price That Won't Break the Bank:** At \$12.99, this timer is a cheap way to automate and control outdoor lights and appliances.
- **Secure and Reliable:** The timer is made to last, has secure connections, and comes with a maker warranty to make sure it works well for a long time.

SETUP GUIDE

- **Unbox and Check:** First, take the G-Homa OT1002 timer out of the box and check it for any damage or flaws that you can see. Make sure that the timer, the user guide, and all of the parts are included.
- **Plug into an outlet:** Plug the timer into a normal outdoor 3-prong grounded outlet. To make a stable connection, make sure the timer is safely plugged in.
- **Connect Things:** Use the timer's two grounded outlets to connect your outdoor lights, pool pump, aerators, or other things. Make sure that all of the devices are linked correctly.
- **To set the time:** Turn the timer's setting to the right time of day. Make sure you set the time correctly so that your gadgets turn on and off at the right times.

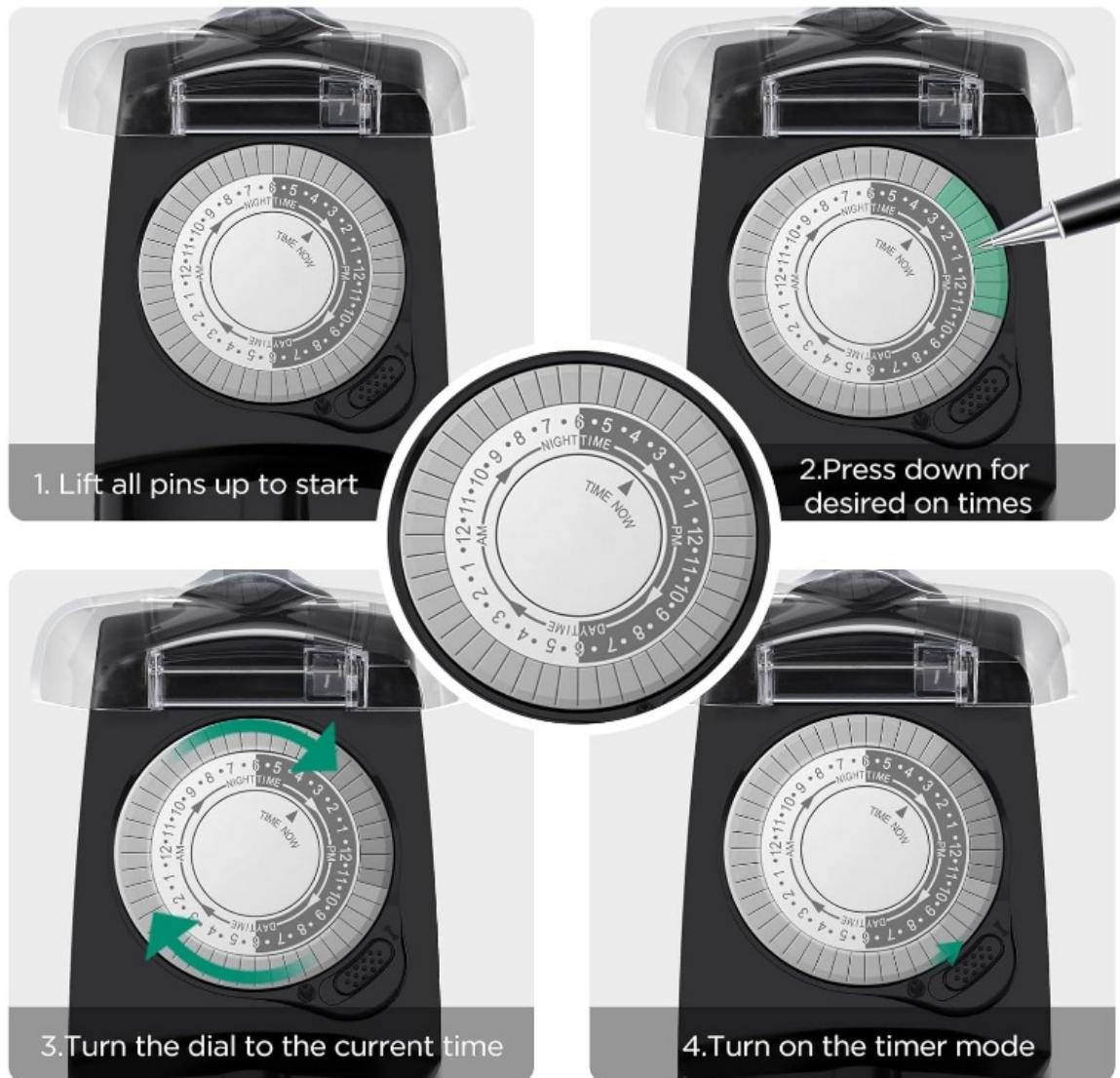

- **Change the Pins:** To turn it off, pull the pins up, to turn it on, push them down. Every pin marks the end of a 30-minute period.
- **Change the plan:** To change the ON/OFF plan, use the dial that you can change. You can set up to 48 different gadgets to do things automatically.
- **If you want to change the settings:** of the timer and keep a device ON or OFF, you can change the pins or use the manual override switch if it's there.
- **Test the Timer:** Once you've set the time and adjusted the pins, manually turn on and off the linked device to make sure everything is working right.

- **Setting the Timer for Outdoor Use:** Stand the timer at least 2 feet above the ground so that it works properly outside and doesn't get wet or dirty.
- **Set the timer to turn on and off every day:** It will do so every day without you having to reset it. This makes it easy to put lights and tools outside.
- **Watch the Power Ratings:** Make sure that the devices you connect don't use more power than the timer can handle (15A for resistive loads and 1875W for tungsten lights).
- **Use in Bad Weather:** The timer is made to be used outside and can handle a range of weather conditions. Make sure it's in a safe place so it doesn't get damaged in the rain or snow.
- **Secure Connections:** Before leaving any devices plugged into the timer unattended, make sure they are all firmly plugged in.
- **Check to Make Sure It Works Right:** Check the timer often by turning devices on and off by hand to make sure it's following the plan you set.
- **Consider Getting More Timers:** If you need to handle more than one outdoor device, you might want to buy more timers and follow the same steps for each one.

CARE & MAINTENANCE

- **Keep Dry:** The timer should always be kept dry and away from water, especially when it's being used outside in the snow or rain.
- **Clean Often:** To clean the timer, use a soft, dry cloth. Do not use rough objects or harsh chemicals that could hurt the surface.
- **Check for Weather Damage:** Look for signs of wear or damage on a regular basis, especially after storms or heavy rain. Make sure the waterproof case is whole and works.
- **Check for Overheating:** If you use a timer with a high-power device, make sure you look for any signs that it is getting too hot. If the timer gets too warm, unplug it.
- **Check the Connections:** Check the power line and plug for damage, fraying, or signs of wear and tear on a regular basis. If you need to, change the timer.
- **Use Correctly:** The timer should only be used within the limits that are written on it (15A for 1875W resistive lights or 10A for tungsten lamps). Do not set the timer too many times.
- **How to Store It:** Keep the timer in a dry, cool place when not in use so it doesn't get exposed to high or low temperatures or humidity.
- **Avoid Impact:** Be careful when handling the timer so that you don't drop it or hit it, which could damage its internal parts or case.
- **Wear Check:** Look at the pins every so often for damage or signs of wear. You might want to get a new timer if the pins don't stay in place or are hard to move.
- **Test Functionality:** Make sure the timer keeps working as it should by testing it often, especially after power outages or long times of not being used.
- **Check for Manual Override:** Make sure the manual override function works by turning the device on and off and seeing if it changes its state.
- **Keep the timer at the right height:** by mounting it at least 2 feet above the ground. This will keep dirt, water, and other things from getting to it.
- **Avoid Extreme Temperatures:** Do not use the timer when the temperature is very high or very low. This could damage its internal parts.
- **Follow the warranty instructions:** If the timer stops working or you notice any other problems, you have one

year to call customer service to get it fixed or replaced.

- **Regularly Reset:** Make sure the timer keeps working right with the current time and schedule by resetting it after big power outages or bad weather.

TROUBLESHOOTING

Issue	Solution
Timer not working at all.	Ensure the timer is plugged in properly and the power is on.
Timer doesn't switch on/off at set time.	Check if the dial is set correctly to the desired time.
Timer settings are incorrect.	Reset the settings and adjust them as needed.
Timer trips the breaker.	Check if the connected device exceeds the timer's wattage limit.
Timer switches devices on too early.	Recheck the set time to ensure it's correctly positioned.
Timer doesn't fit with some plugs.	Ensure you are using appliances with standard plugs.
Timer doesn't maintain time accuracy.	Replace the timer if it consistently loses time.
Timer keeps resetting itself.	Ensure the plug is properly connected to a stable power source.
Timer causes device malfunctions.	Check the device's compatibility with the timer's power rating.
Timer display is faint.	Check for any obstructions blocking the timer's view.
Timer's plug seems loose.	Try another outlet to ensure the plug fits securely.
Timer has a burning smell.	Unplug the timer and check for overheating or short circuits.
Timer switches on/off too frequently.	Adjust the settings to allow for longer on/off periods.
Timer light indicator doesn't work.	Test the timer by connecting it to a different device.
Timer is making a loud noise.	Try gently adjusting the mechanical dial or settings.

PROS & CONS

PROS:

1. Simple and reliable mechanical timer with 48 settings.
2. Affordable at just \$12.99, providing great value.
3. Easy to set up and operate—no complicated installation needed.
4. Durable and sturdy, designed for long-lasting performance.
5. Versatile for various devices like lamps, fans, and other household appliances.

CONS:

1. Lacks advanced features like remote control or smart capabilities.
2. The mechanical design may not suit tech-savvy users.
3. No battery backup in case of power failure.
4. Limited settings may not work for highly specialized appliances.

5. Does not support 24-hour operation without resetting.

WARRANTY

The G-Homa OT1002 Mechanical Outlet Timer comes with a **1-year manufacturer warranty**, ensuring a year of protection against defects in materials or workmanship. This warranty provides peace of mind for consumers, knowing that if any issues arise within the first 12 months, the manufacturer will resolve them.

FREQUENTLY ASKED QUESTIONS

What is the price of the G-Homa OT1002 Mechanical Outlet Timer?

The G-Homa OT1002 Mechanical Outlet Timer is priced at \$12.99, offering an affordable solution for automating your electrical devices.

What are the dimensions of the G-Homa OT1002 Mechanical Outlet Timer?

The G-Homa OT1002 Mechanical Outlet Timer has product dimensions of 1.5 D x 2.9 W x 4.7 H inches, making it compact and easy to fit in various spaces.

What is the weight of the G-Homa OT1002 Mechanical Outlet Timer?

The G-Homa OT1002 Mechanical Outlet Timer weighs 9.1 ounces (0.26 kilograms), making it lightweight and easy to handle during installation.

How many settings does the G-Homa OT1002 Mechanical Outlet Timer have?

The G-Homa OT1002 Mechanical Outlet Timer offers 48 settings, allowing for precise control over the timing of electrical devices.

What is the power rating for the G-Homa OT1002 Mechanical Outlet Timer?

The G-Homa OT1002 Mechanical Outlet Timer has a rating of 125 Volts, 15A, 1875W resistive, and 1/2HP, ensuring it can handle a variety of devices safely.

What is the item model number for the G-Homa OT1002 Mechanical Outlet Timer?

The item model number for the G-Homa OT1002 Mechanical Outlet Timer is OT1002, which helps identify the specific product in the G-Homa line.

What is the warranty for the G-Homa OT1002 Mechanical Outlet Timer?

The G-Homa OT1002 Mechanical Outlet Timer comes with a 1-year manufacturer warranty, providing peace of mind and support if needed.

How easy is it to install the G-Homa OT1002 Mechanical Outlet Timer?

The G-Homa OT1002 Mechanical Outlet Timer is designed for easy installation, requiring no complex setup. Simply plug it into an outlet and set the desired timings.

VIDEO – PRODUCT OVERVIEW



<https://manuals.plus/wp-content/uploads/2024/12/G-Homa-OT1002-Mechanical-Outlet-Timer-Operating-Manual.mp4>

- [User Manual](#)

[Manuals+](#), [Privacy Policy](#)

This website is an independent publication and is neither affiliated with nor endorsed by any of the trademark owners. The "Bluetooth®" word mark and logos are registered trademarks owned by Bluetooth SIG, Inc. The "Wi-Fi®" word mark and logos are registered trademarks owned by the Wi-Fi Alliance. Any use of these marks on this website does not imply any affiliation with or endorsement.