



FXLuminaire DESIGNER / STANDARD Installation Guide

[Home](#) » [FXLuminaire](#) » FXLuminaire DESIGNER / STANDARD Installation Guide 

Contents

- [1 FXLuminaire DESIGNER / STANDARD](#)
- [2 DESIGNER/STANDARD](#)
- [3 Install](#)
- [4 CIRCUITING GUIDELINES](#)
- [5 TRANSFORMERS](#)
- [6 Documents / Resources](#)
- [7 Related Posts](#)

FXLuminaire®

FXLuminaire DESIGNER / STANDARD



DESIGNER/STANDARD

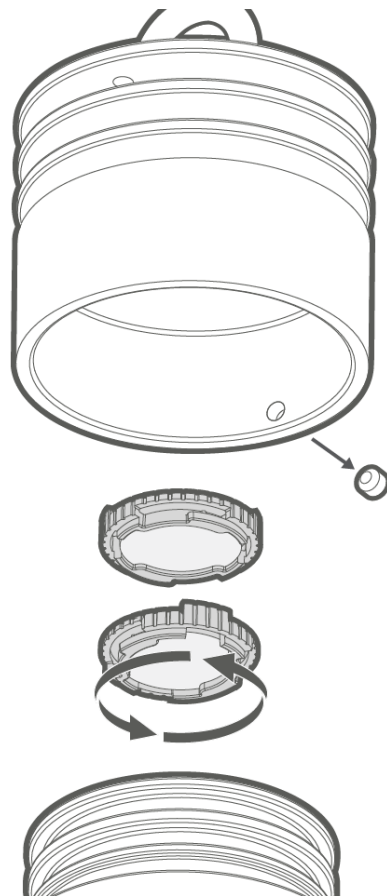

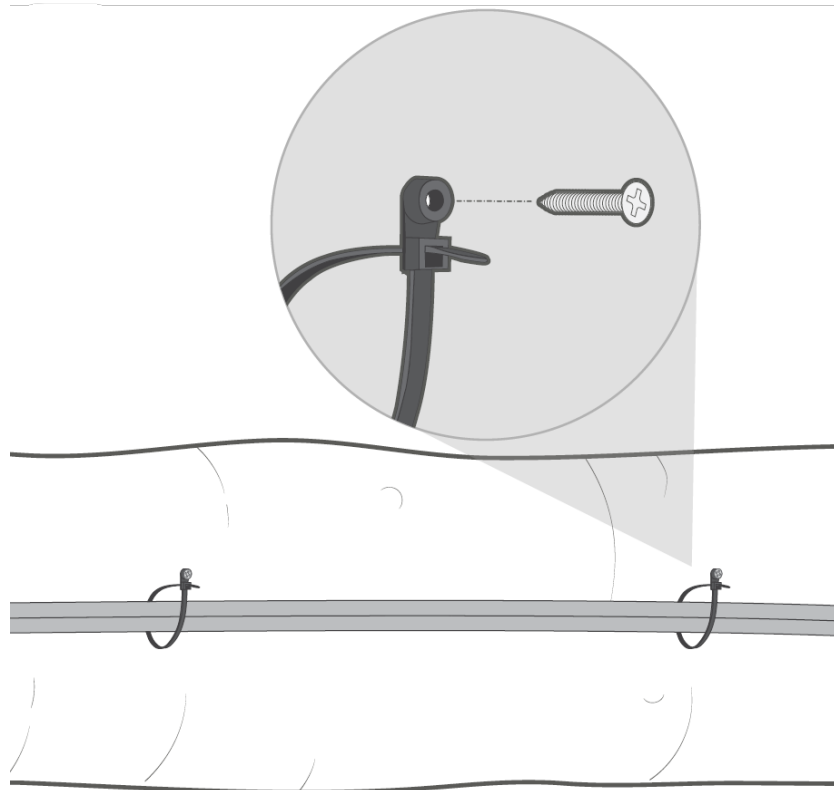
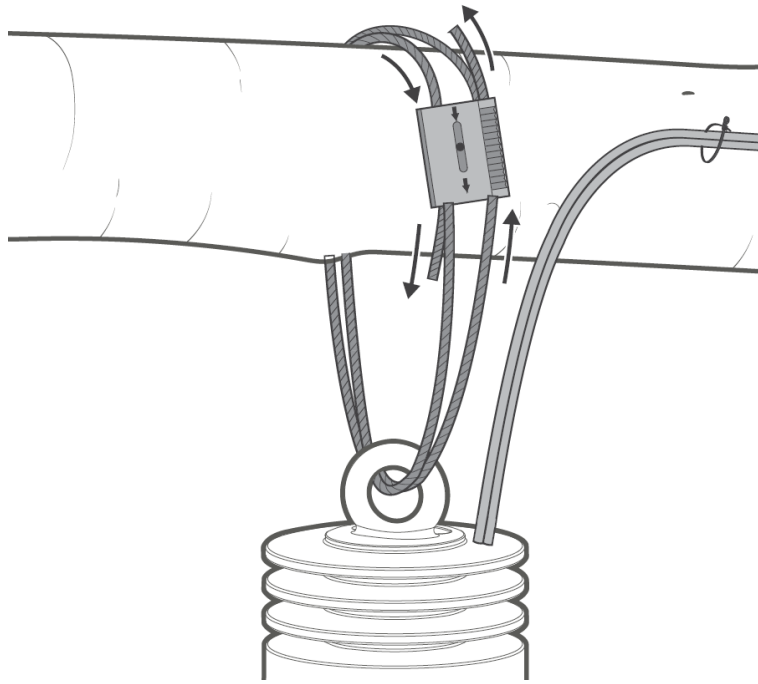

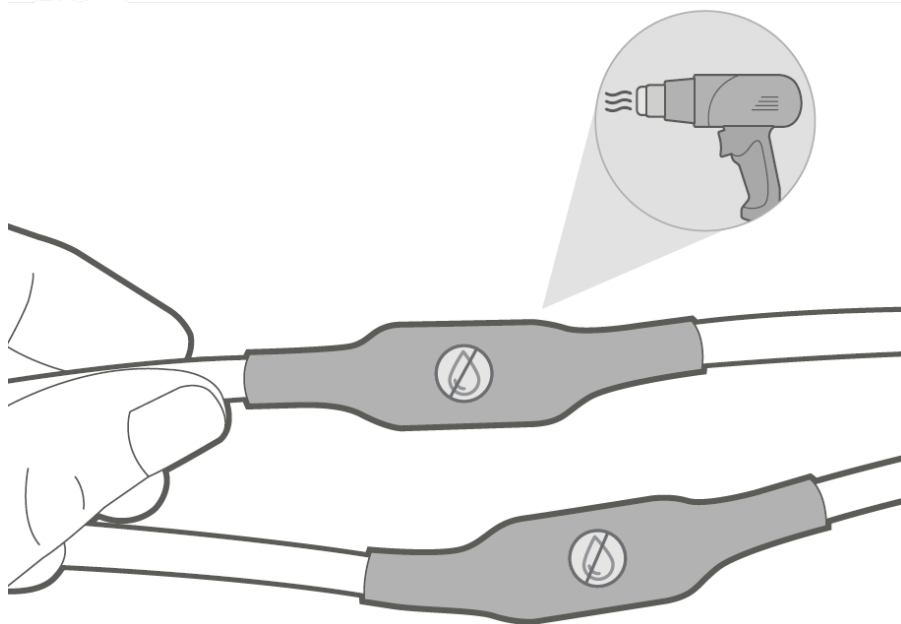
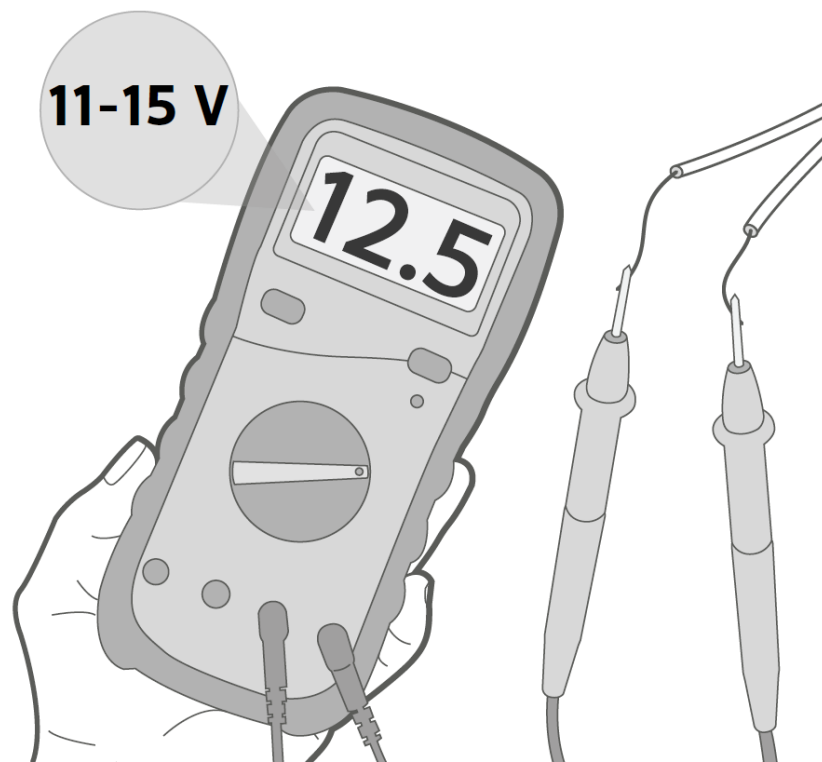

Install

1. Change color filter and beam angle lens by removing and replacing existing components if desired (Designer Series only). Use 5/64" Allen key.
2. Thread cable through fixture loop and around desired mounting surface. Insert both cable ends into lock.
3. Run wire down structure and secure with cable ties.
4. Use voltmeter to ensure 11 to 15 V at fixture.
5. Connect wiring with waterproof connector.

CIRCUITING GUIDELINES

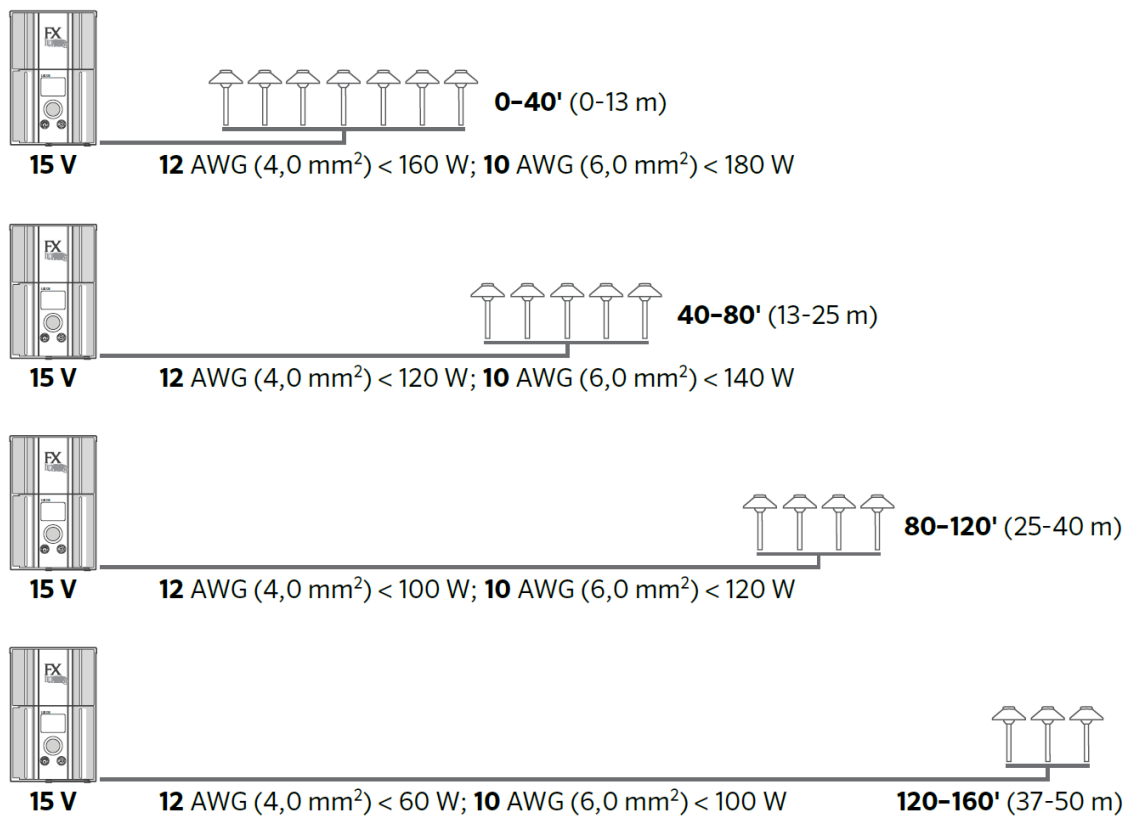

TRANSFORMERS

- **Single Transformer:** When using one transformer, center the transformer on the wattage load. Minimize all cable runs to reduce voltage drop.
- **Multiple Transformers:** When using multiple transformers, spread the load evenly across all transformers. Avoid voltage drop by installing the transformers as close to the fixtures as possible.

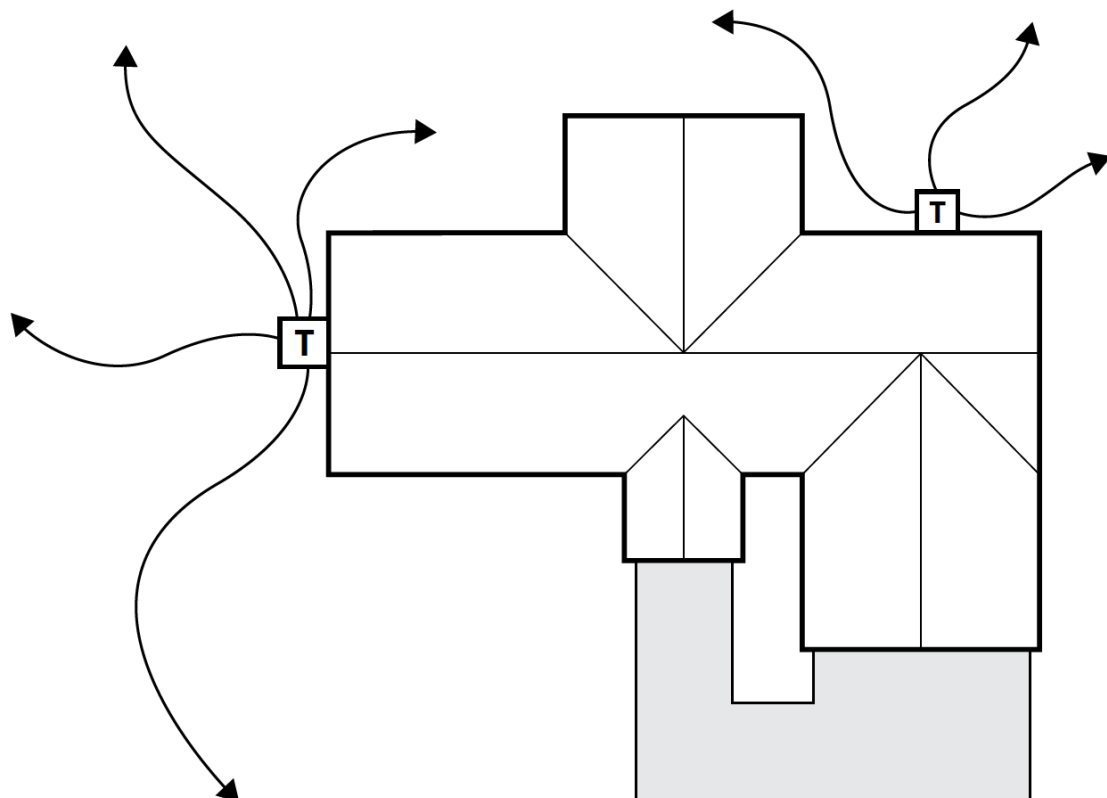

the online support section at <https://www.fxl.com/support>.

WARNING – To reduce the risk of FIRE OR INJURY TO PERSON:

- Turn off/unplug and allow to cool before replacing lamp.
- Lamp gets HOT quickly. Contact only switch/plug when turning on.
- Do not touch hot lens, guard, or enclosure.
- Keep lamp away from materials that may burn.
- Do not touch the lamp at any time. Use a soft cloth. Oil from skin may damage lamp.
- Do not operate the luminaire fitting with a missing or damaged shield.

WARNING – Risk of Electric Shock

- May be installed less than 5' (1.5 m) from a pool, spa, or fountain when used with a UL 379 listed transformer.
- A luminaire shall not use tungsten halogen lamps unless the luminaire is marked for such lamps.
- Supply connection and electrical components are located above ground level, except for secondary cord that is suitable for wet locations.

LOW VOLTAGE CABLE SHALL

- Be protected by routing in close proximity to the luminaire or fitting, or next to a building structure such as a house or deck.
- Not be buried except for a maximum 6" (152 mm) in order to connect to the main low voltage cable.
- Have the length cut off so that it is connected to a connector within 6" (152 mm) from a building structure, a luminaire, or fitting.

Documents / Resources

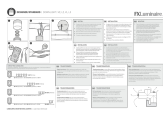
	<p>FXLuminaire DESIGNER / STANDARD [pdf] Installation Guide FXLuminaire, DESIGNER, STANDARD</p>
---	--