



# FX Luminaire 140356 QB LED Up Light Instruction Manual

[Home](#) » [FX Luminaire](#) » FX Luminaire 140356 QB LED Up Light Instruction Manual 

## Contents

- [1 FX Luminaire 140356 QB LED Up Light](#)
- [2 Product Information](#)
- [3 INSTALLATION](#)
- [4 GUIDELINES](#)
- [5 TRANSFORMERS](#)
- [6 PRECAUTION](#)
- [7 Documents / Resources](#)
  - [7.1 References](#)
- [8 Related Posts](#)

FXLuminaire.

**FX Luminaire 140356 QB LED Up Light**



## Product Information

The product is a Designer/Standard Up Light that operates at 11-15 V. It has a wattage of 12.5 and is compatible with the Luxor system. The product comes with circuiting guidelines and is available in various voltage options, including 15 V.

## INSTALLATION

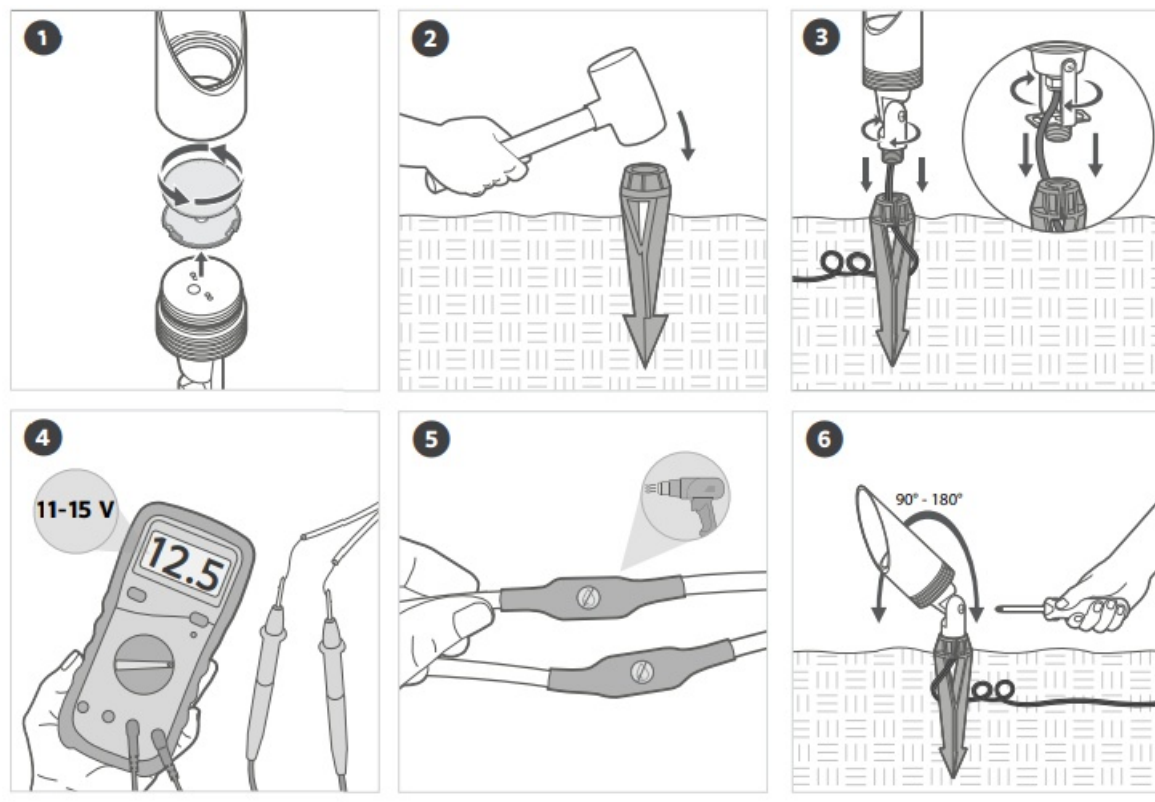

1. Change beam angle lens and color filter by removing and replacing existing components (optional).
2. Pound stake into ground.
3. Thread fixture into stake. Coil extra wire for future servicing.

4. Use voltmeter to ensure 11 to 15 V at fixture.
5. Connect wiring with waterproof connector.
6. Aim fixture as desired.

## GUIDELINES

### CIRCUITING GUIDELINES

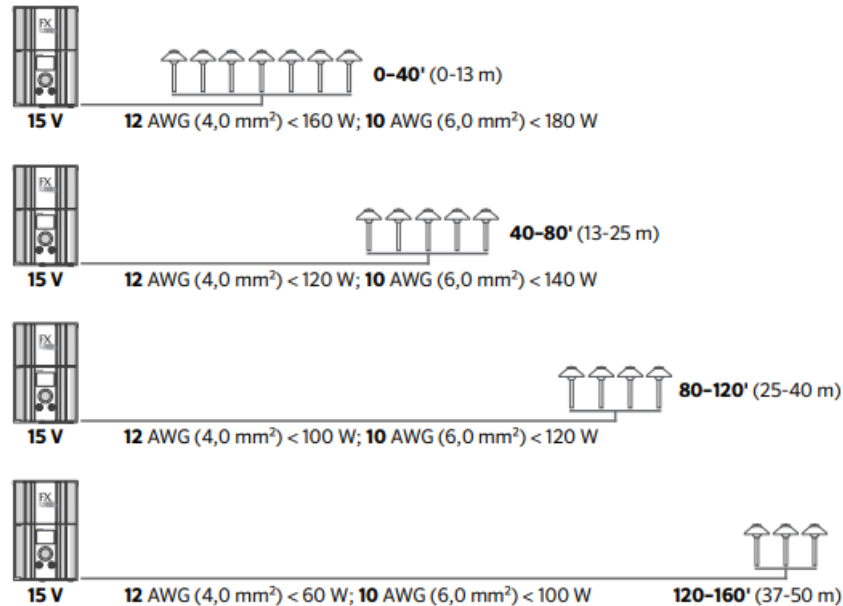

## TRANSFORMERS

- **Single transformer:** When using one transformer, center the transformer on the wattage load. Minimize all cable runs to reduce voltage drop.
- **Multiple transformers:** When using multiple transformers, spread the load evenly across all transformers. Avoid voltage drop by installing the transformers as close to the fixtures as possible.

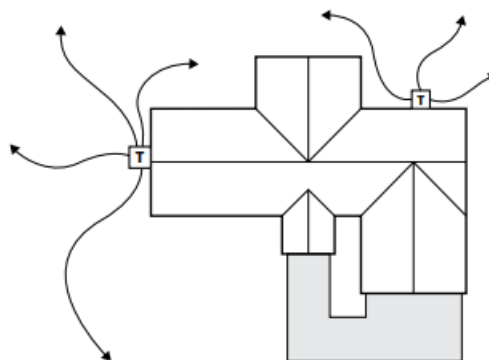

## PRECAUTION

**UP LIGHT:** Please read and keep all safety and use instructions. If you have questions, contact your local distributor or visit the online support section at <https://www.fx1.com/support>.

**WARNING:** To reduce the risk of FIRE OR INJURY TO PERSON:

- Turn off/unplug and allow to cool before replacing lamp.
- Lamp gets HOT quickly. Contact only switch/plug when turning on.
- Do not touch hot lens, guard, or enclosure.
- Keep lamp away from materials that may burn.
- Do not touch the lamp at any time. Use a soft cloth. Oil from skin may damage lamp.
- Do not operate the luminaire fitting with a missing or damaged shield.

**WARNING:** Risk of Electric Shock

- May be installed less than 5' (1.5 m) from a pool, spa, or fountain when used with a UL 379 listed transformer.
- A luminaire shall not use tungsten halogen lamps unless the luminaire is marked for such lamps.
- Supply connection and electrical components are located above ground level, except for secondary cord that is suitable for wet locations.

**LOW VOLTAGE CABLE SHALL**

- Be protected by routing in close proximity to the luminaire or fitting, or next to a building structure \* such as a house or deck.
- Not be buried except for a maximum 6" (152 mm) in order to connect to the main low voltage cable.
- Have the length cut off so that it is connected to a connector within 6" (152 mm) from a building structure, a luminaire, or fitting.

These products contain a light source of energy efficiency class G.  
CE Certified Up Lights: CC, FB, FR, LC, NP, NR, PB, QB, QZ, VS, LO, LR, MU and RS Only  
Non-CE Certified Up Lights: C-UL, C-WW, MP, RL, SI, WS

Learn more. Visit [fxl.com](http://fxl.com)

**Documents / Resources**

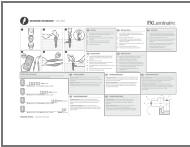
	<a href="#">FX Luminaire 140356 QB LED Up Light</a> [pdf] Instruction Manual NP-3LED-BZ, 140356, 140356 QB LED Up Light, QB LED Up Light, LED Up Light, Up Light, Light
---	--

**References**

- [FX Luminaire | Landscape & Architectural Lighting](#)
- [FX Welcome to FX Luminaire Support | FX Luminaire](#)