

FUVISION 360 Smart Home Security Camera



FUVISION 360 Smart Home Security Camera User Manual

[Home](#) » [FUVISION](#) » FUVISION 360 Smart Home Security Camera User Manual 

Contents

- 1 [FUVISION 360 Smart Home Security Camera](#)
- 2 [Package Content](#)
- 3 [LED Status Introduction](#)
- 4 [Product Installation](#)
- 5 [Camera Setup](#)
- 6 [APP Introduction](#)
- 7 [FAQ](#)
- 8 [Safe Battery Handling And Usage](#)
- 9 [Documents / Resources](#)
 - 9.1 [References](#)

FUVISION®

FUVISION 360 Smart Home Security Camera



The user guide is for reference only. Screenshots displayed in this user's guide of the "Tuya Smart" app may appear differently than those currently featured in your app as frequent updates and improvements.

Package Content

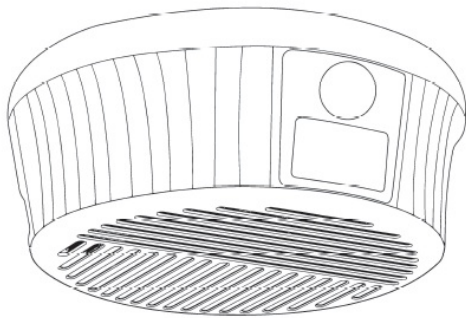

1.1 Main device



1 2. Mount bracket

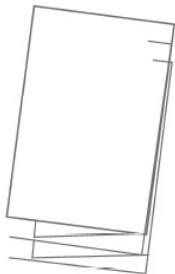

1 4. User manual



1 3.USB-C cable

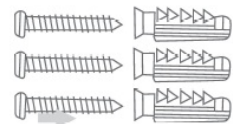

1 5. Mount screws *3
Anchors*3

Product Structure

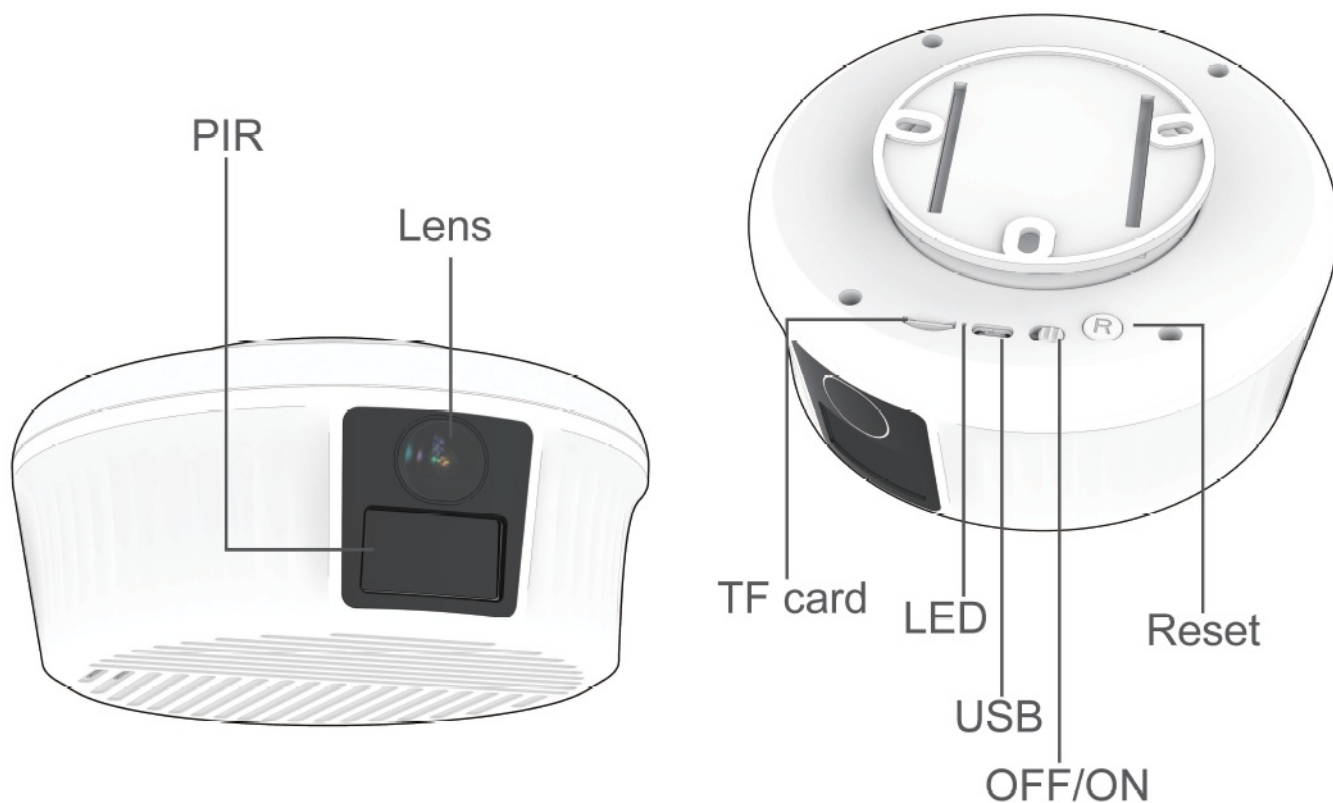

LED Status Introduction

NO.	LED Status	Device Status
1	Solid blue LED	Battery is charging
2	Blue light is flashing slowly	Battery is fully charged
3	Red light blinks slowly and speaker beeps at the same time	Camera is waiting for internet connection
4	Blue LED is flashing fast	Camera is in the process of network connection
5	Solid blue LED	Network connect successful
6	Indicator lights are all off	Standby mode
7	Press and hold the reset button for 3-5 seconds, the indicator returns to the power-on mode and waiting for network connection	Reset successfully

Product Installation



Camera Setup



1. Search and download "Tuya Smart" in major Application markets or scan the QR code below to download the APP.
2. Once you download the APP to your smart phone, you may enter the first page which you can Login with existing account or register.

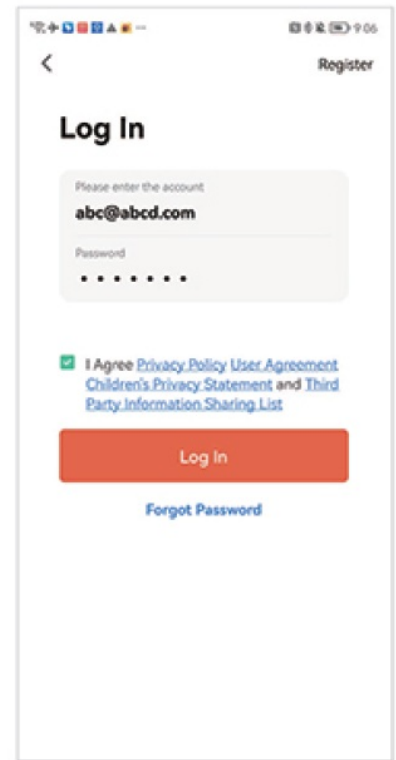
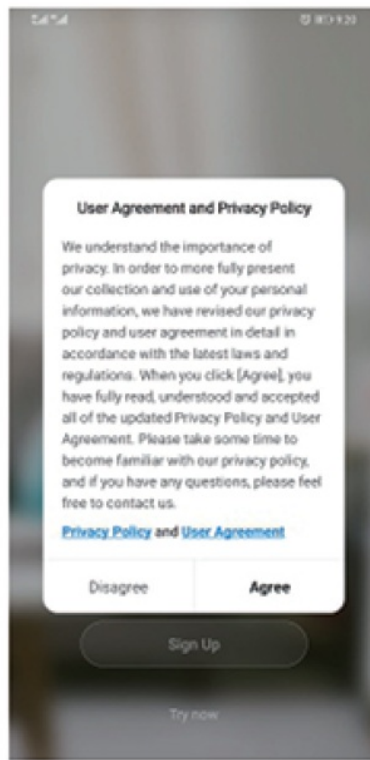
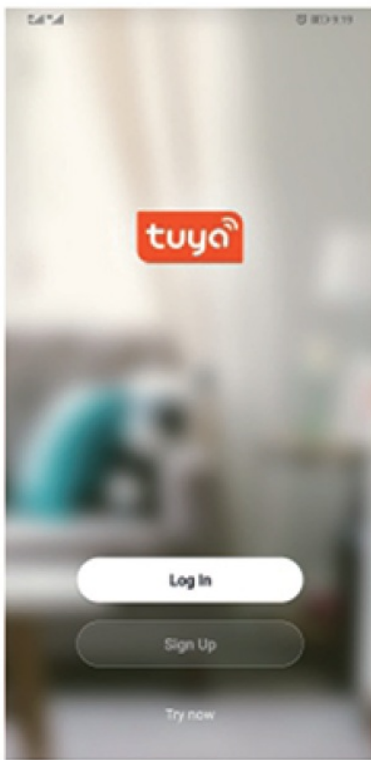

- (If you have the existing account, there are two ways to login, one is with SMS verification Code, the other one is with password. In case you forget the password, you may choose login SMS verification Code or you can choose forgot password to reset it by Entering Verification Code which sent to you mobile via message)

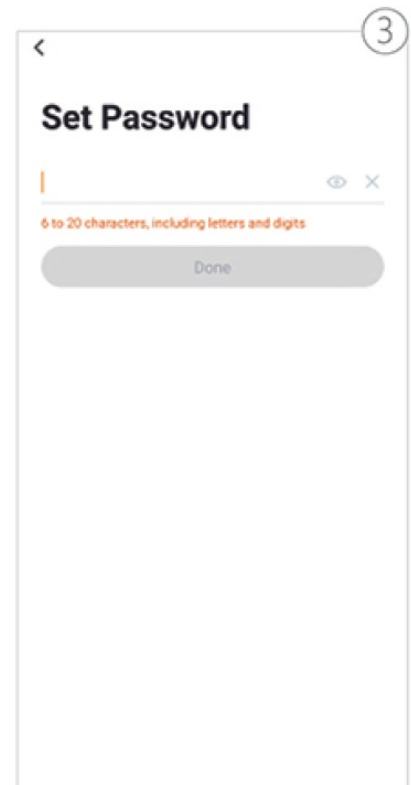
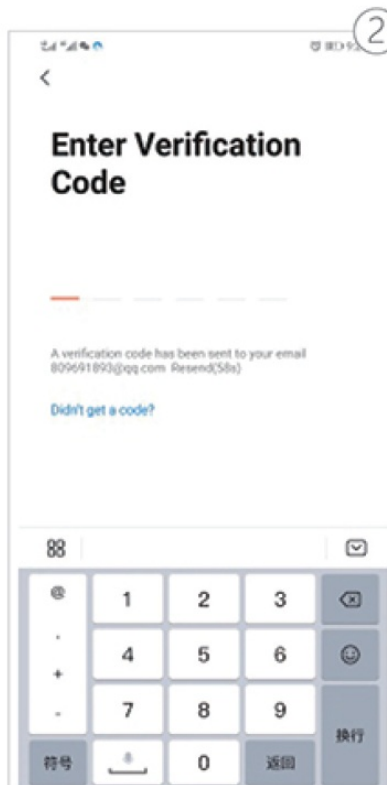
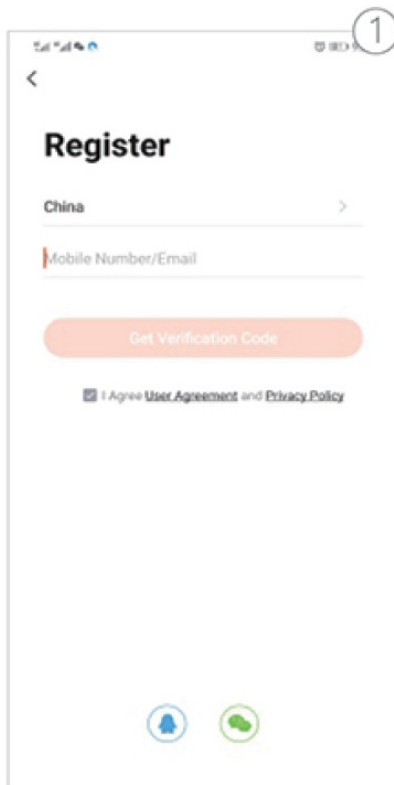

- (If you are the new user of Smart Life and don't have an account, please choose register first and follow the below screenshots to complete the registration.)
3. Once the account has been setup successfully, then you will automatically enter the page of “add device”, kindly follow below steps to add the camera.

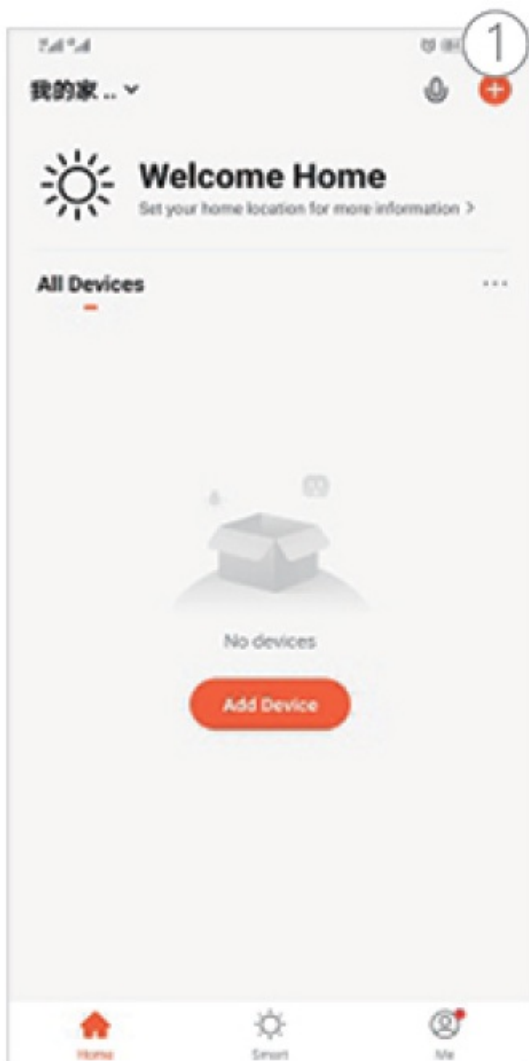

- **Step 1:** Click “Add Device” or click “+” on top of right on this page and then choose “Smart Camera”

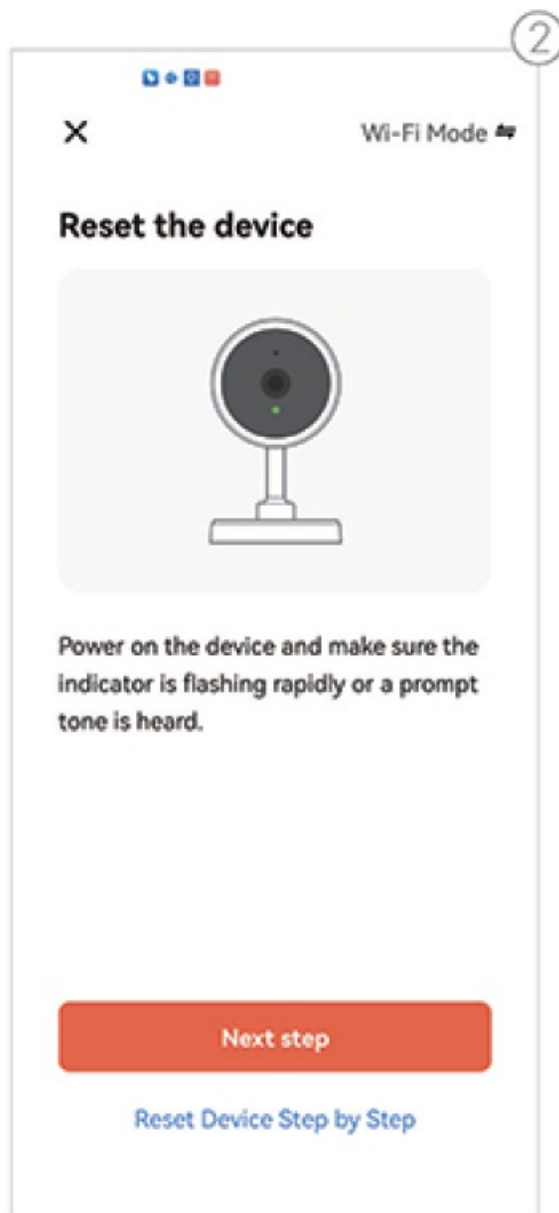
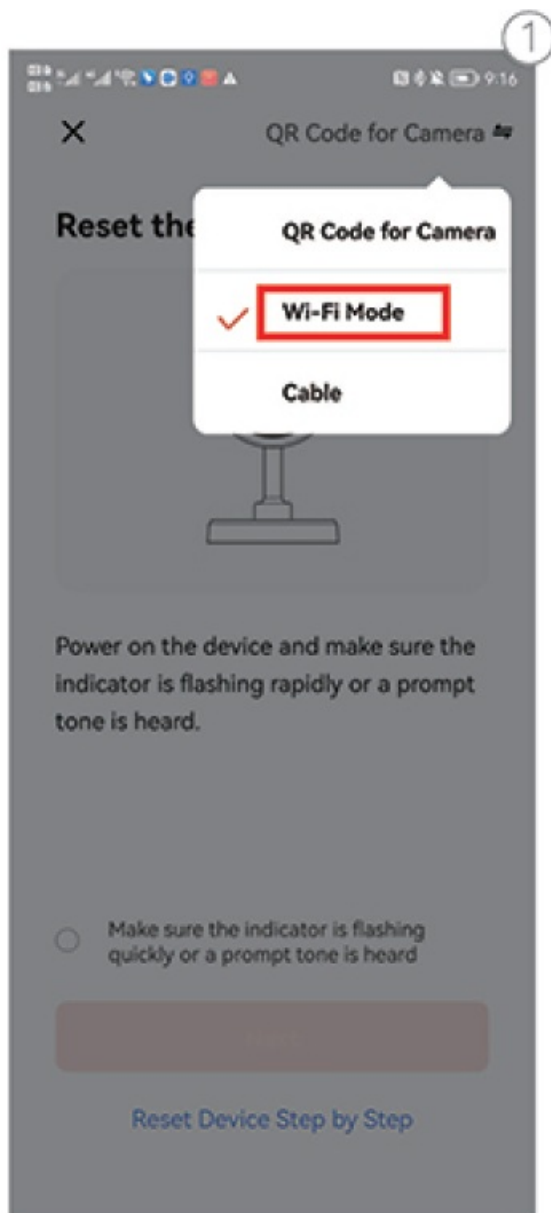

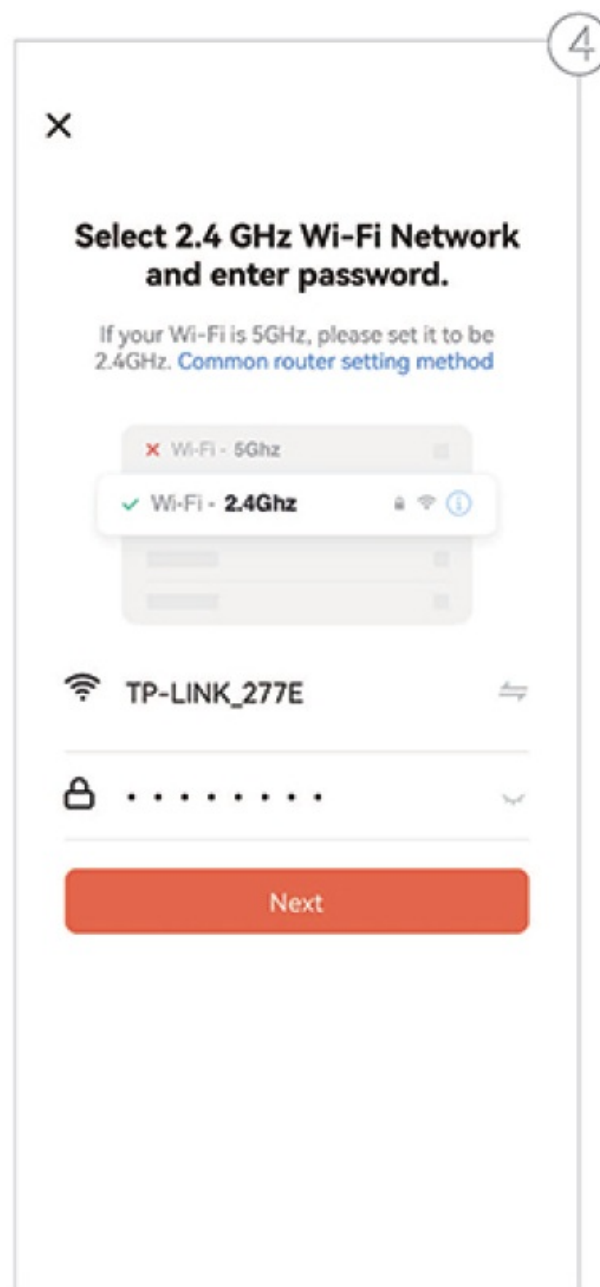
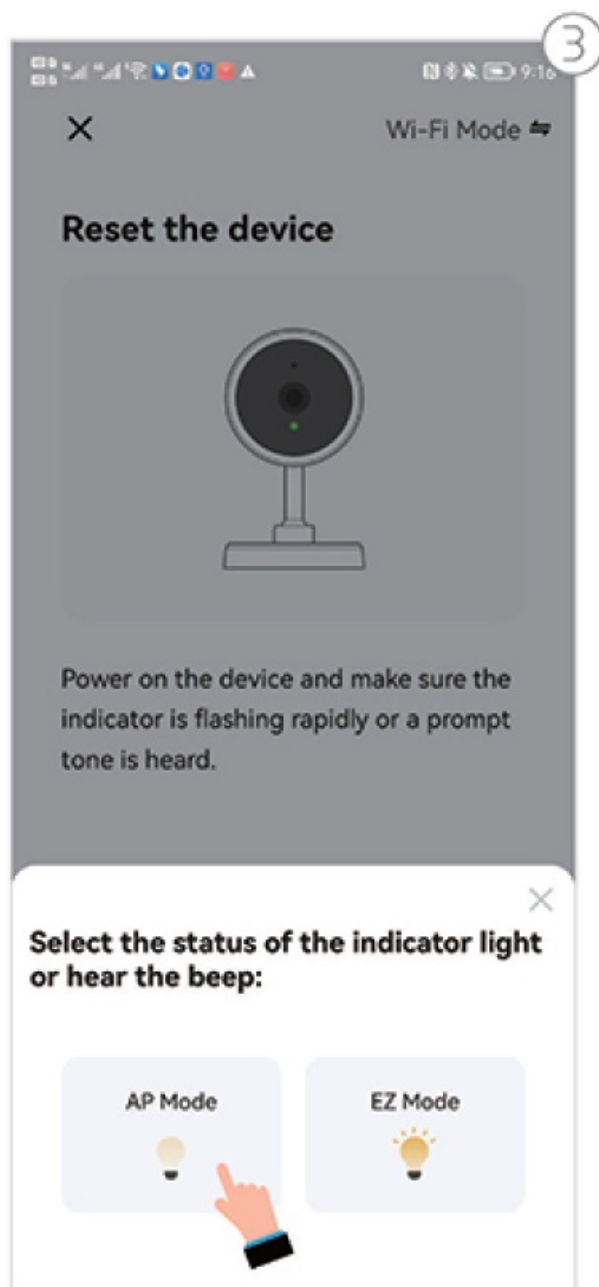

5



Connect your mobile phone to the device's hotspot

① Connect your phone to the hotspot shown below:

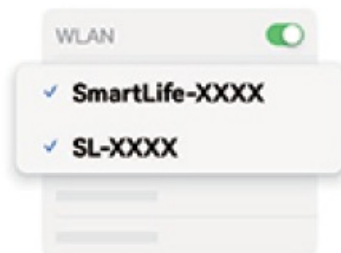

② Go back and add devices.

Go to Connect

6

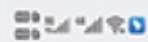

9:29

← WLAN



WLAN

Network acceleration Off >

More settings >

CONNECTED

SmartLife_lkwl8e8889aa78beadac
Connected

AVAILABLE

TP-LINK_277E
Saved, encrypted (available)

ChinaNet-4YzT
Encrypted

HUAWEI-10EK6H
Encrypted

smawatch-dev
Encrypted

TP-LINK_5G_277E
Encrypted

TP-LINK_704C
Encrypted

DIRECT-E3-HP Laser 136nw

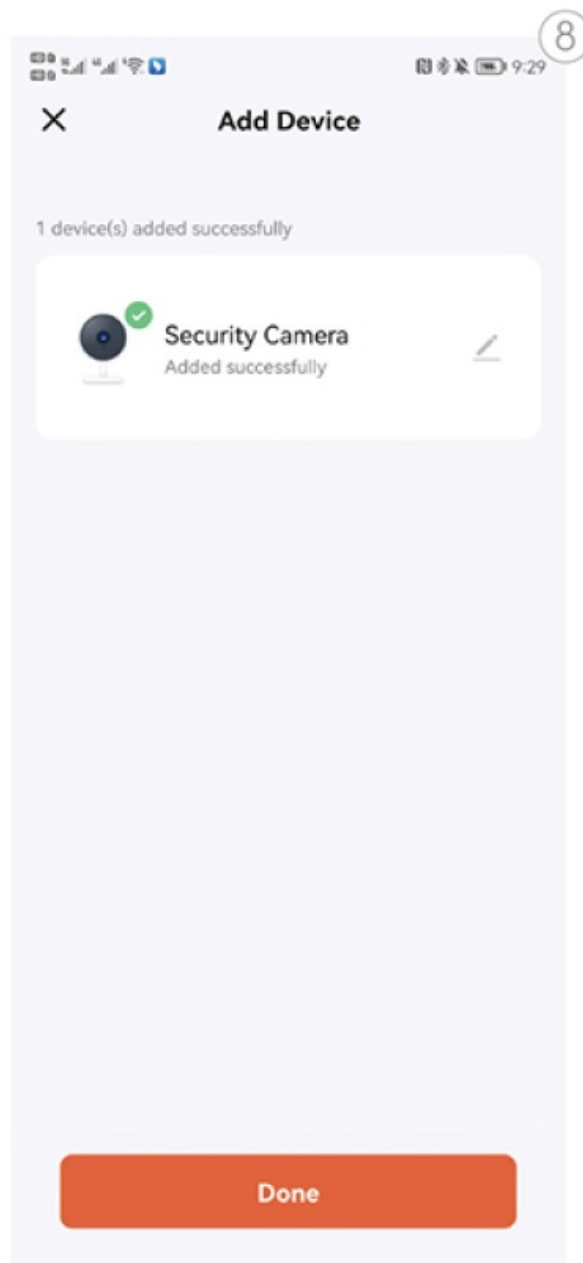
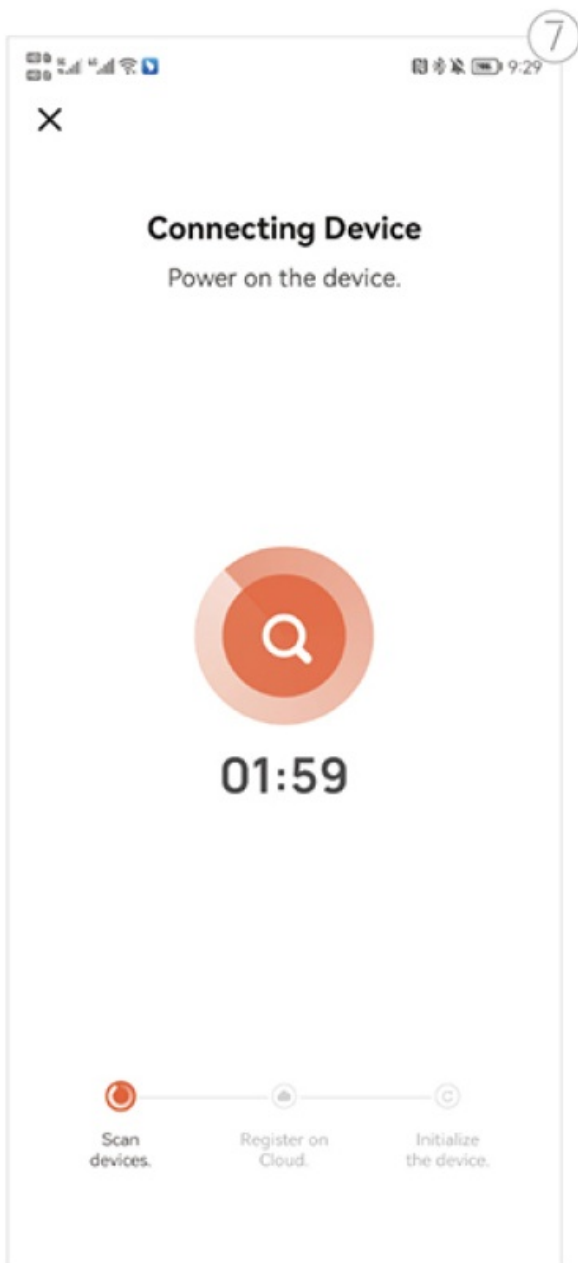

- **Step 2:** You can choose Wi-Fi Mode pairing

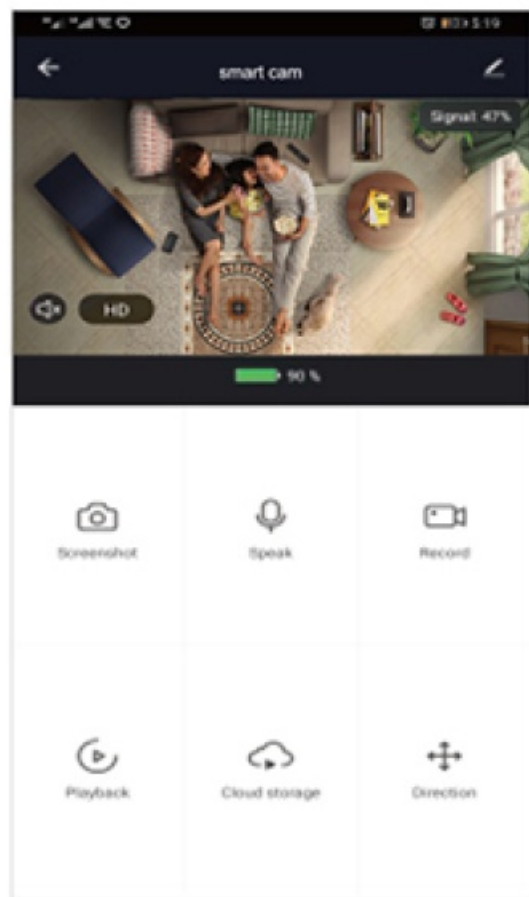
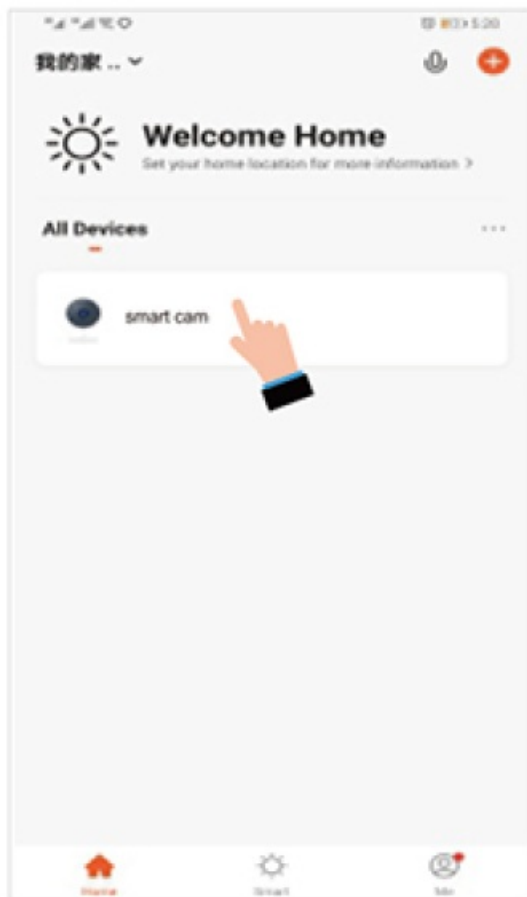

- **Step 3:** Tap the smart cam to start the live view at anytime and anywhere

APP Introduction

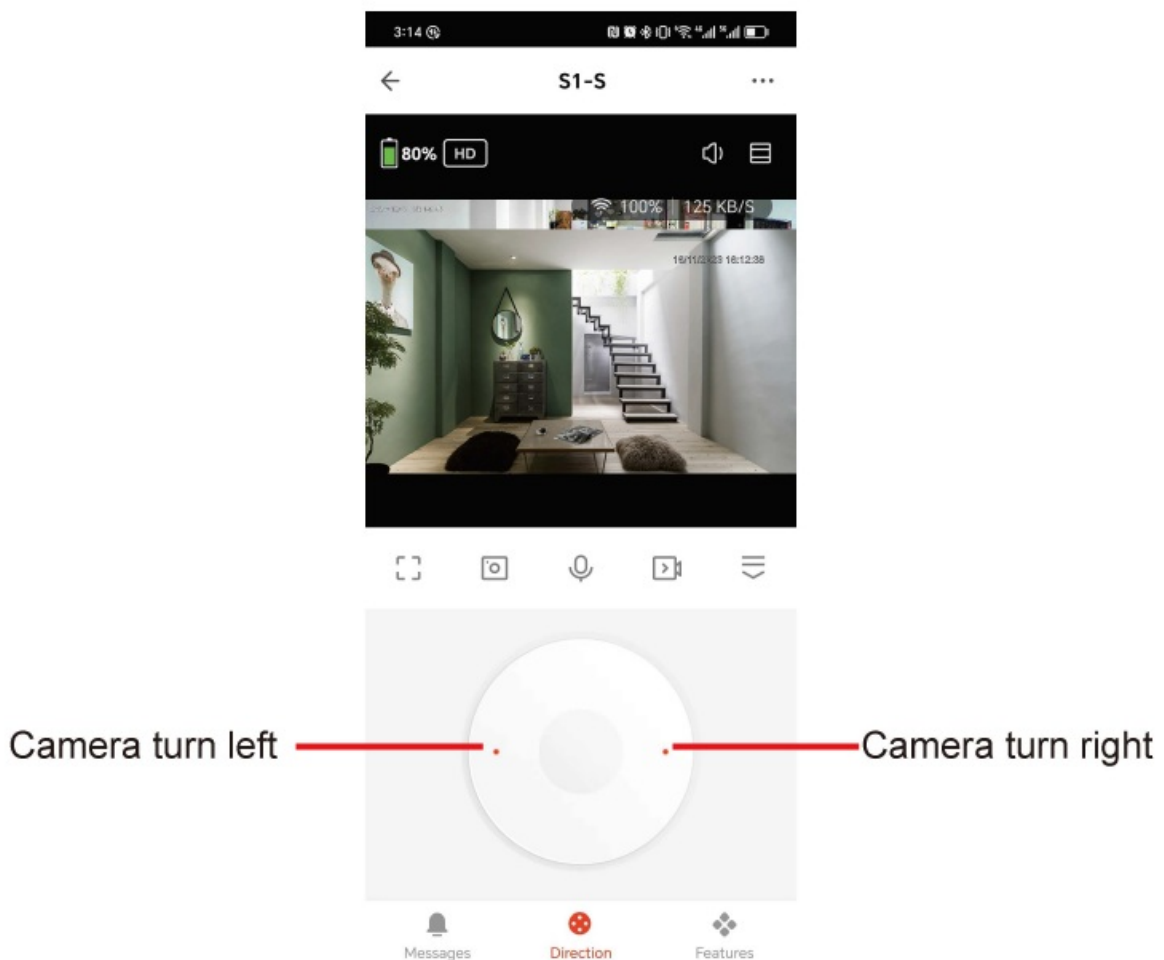
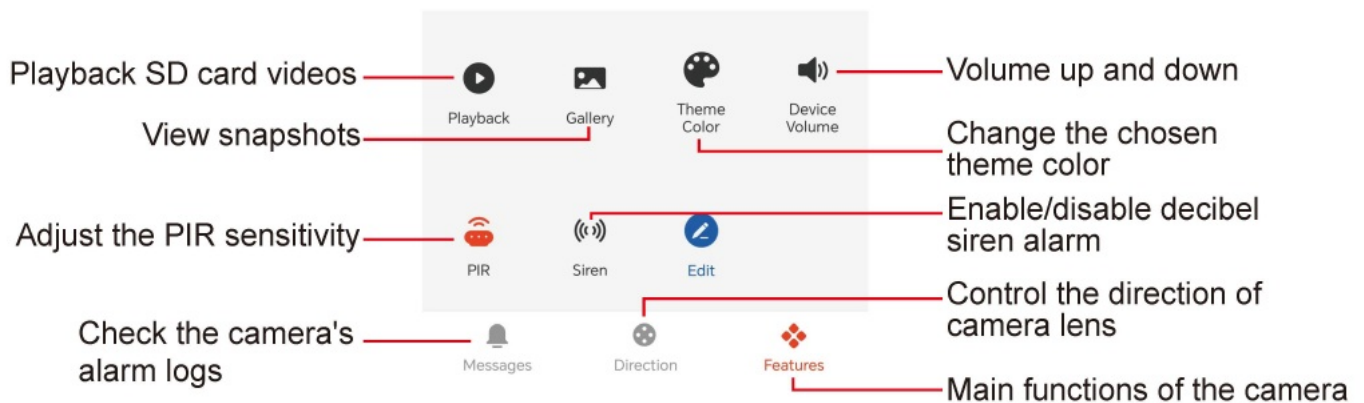
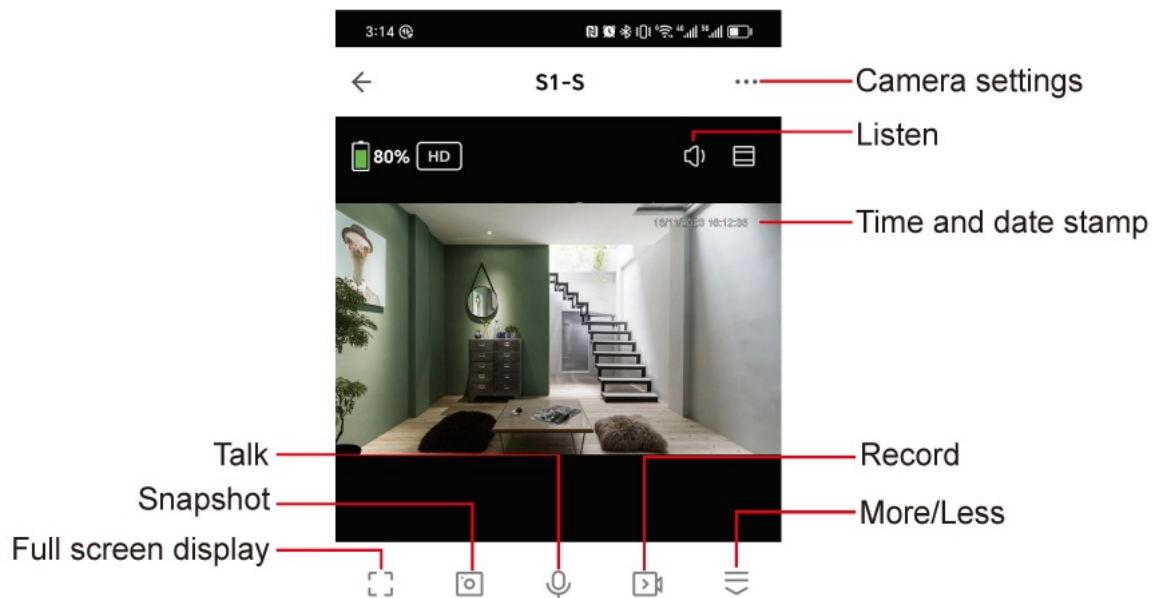

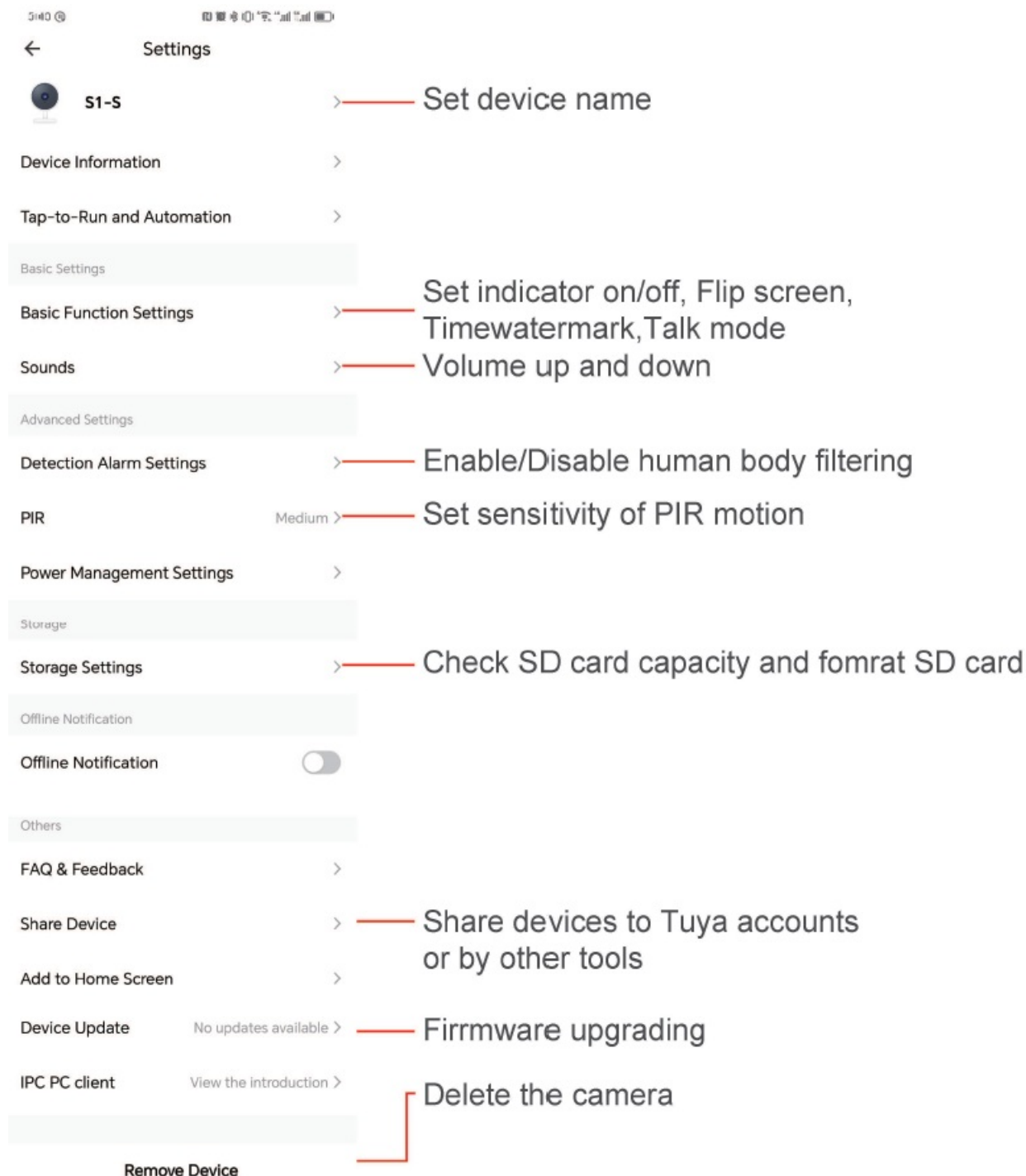

FAQ

Frequently Asked Questions

- Q:** Why videos recorded in SD card can't be read by PC?
 - A:** This is Tuya patent to protect recorded files by encryption format.
 - 2)** If need to check videos in card, enter App> playback: Select video date, record or screenshot needed moments. Then check at App album.
- Q:** What does the device do when Wi-Fi off?
 - A:** Keep searching Wi-Fi signal all the time; If Wi-Fi on, it will be connected to Wi-Fi automatically.
- Q:** Where to get more info about Tuya Smart App?
 - A:** Pls visit developer.tuya.com, then Documentation> App Development> All-in-One App > Smart Life > User Guide

4. **Q:** What can i do if any problems encounter during use?

- **A:** Please go to the “Me” menu and find the FAQ & Feedback” to see if you have the same problem. If not, you can report the problem and if you provide as much information as possible, we will process your question and give you an answer as soon as possible.

Safe Battery Handling And Usage

1. Please charge the battery up to 24 hours for the first time use
2. DO NOT allow the batteries to get wet prior to or during installation while your smart home camera is safe to use indoor, but not outside for weather proof.

Special Remark:

- This product is intended for home monitoring purposes only. Please refrain from any illegal use!

<https://www.ipcamerasolar.com>
fuvision@aliyun.com

Documents / Resources

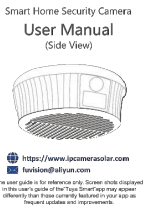
 <p>Smart Home Security Camera User Manual (Side View)</p> <p>https://www.ipcamerasolar.com fuvision@aliyun.com</p> <p><small>The user guide is for reference only. Screen shots displayed in this user's guide of the "Fuvison Smart" app may appear differently from those currently installed on your app as they are updated and improvements. V2.3</small></p>	<p>FUVISION 360 Smart Home Security Camera [pdf] User Manual 360 Smart Home Security Camera, 360, Smart Home Security Camera, Security Camera, Camera</p>
--	--

References

- [User Manual](#)

Manuals+, Privacy Policy

This website is an independent publication and is neither affiliated with nor endorsed by any of the trademark owners. The "Bluetooth®" word mark and logos are registered trademarks owned by Bluetooth SIG, Inc. The "Wi-Fi®" word mark and logos are registered trademarks owned by the Wi-Fi Alliance. Any use of these marks on this website does not imply any affiliation with or endorsement.