



## Futaba T7PX Software Update Method User Guide

[Home](#) » [Futaba](#) » Futaba T7PX Software Update Method User Guide 

1M23Z05402



### T7PX Software Update Method

Whenever improvements and new functions are available, the software of your T7PX radio transmitter can be updated easily via online free of charge. The updated software file will be shown on our website. You can download it and make a copy on your microSD card. Below is the procedure for the software update.

#### Contents

- [1 Procedure for the software update](#)
- [2 How to check the receiver software version](#)
- [3 Connection channel of servo to make wireless setting](#)
- [4 How to use wireless settings](#)
- [5 Other changes and additions](#)
- [6 Update method](#)
- [7 Forced initialization](#)
- [8 Documents / Resources](#)
- [9 Related Posts](#)

### Procedure for the software update

**Caution:** Before you update the software, the battery that is connected to the T7PX should be fully charged.

**Note:** During the software update, the model data that is stored in the T7PX should be kept without any change. (NOT erased and NOT changed.) However, for your safety, making a backup of your model data before the

software update is highly recommended.

1. Download the zip file of the update data from our website.
2. Extract the zip file on your computer.
3. The "FUTABA" folder will be created on your computer.
4. Copy the "FUTABA" folder into your microSD card. Note: If the microSD card has already had "another FUTABA" folder before you make a copy, the "FUTABA" folder is **OVERWRITTEN**.
5. Insert the microSD card with "FUTABA" folder that contained the update software into the SD card slot on your T7PX radio transmitter.

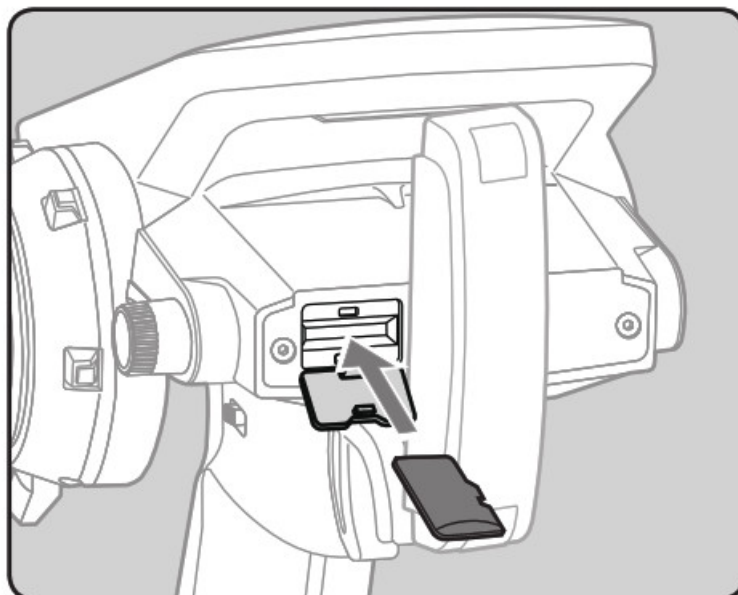

6. Turn on the transmitter power while pressing down the "HOME" button. The update screen appears on the LCD display of your T7PX and the software update is started.

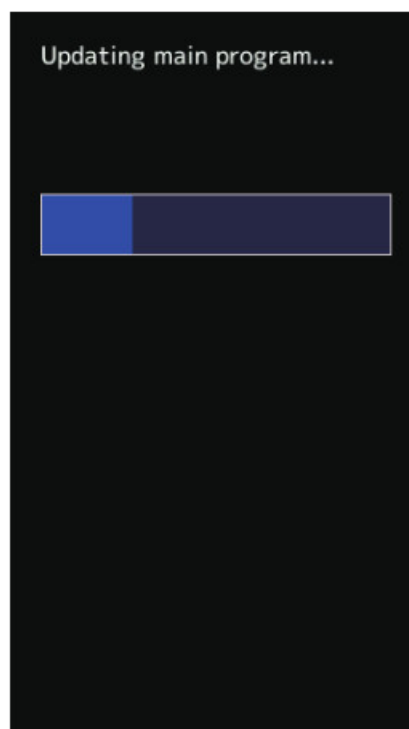
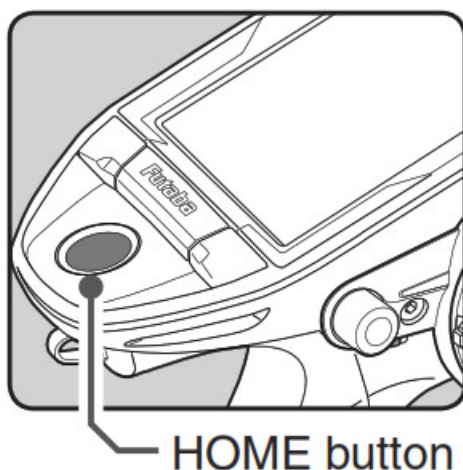

7. When the software update is completed, "Completed" message is shown on the LCD display of your T7PX. (Show below picture.)

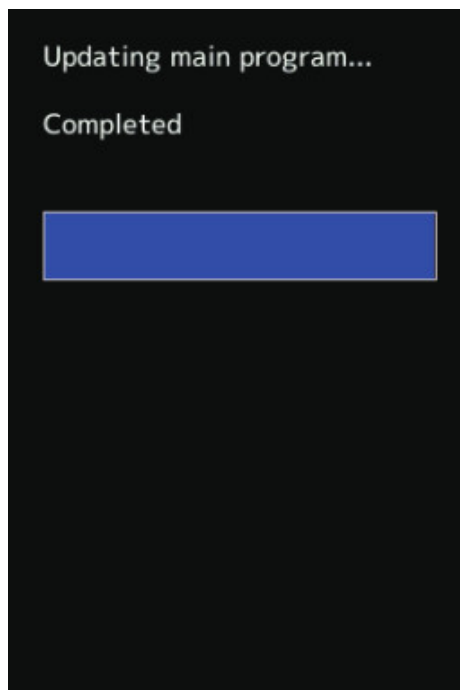

8. Turn off the power switch of your T7PX and remove the microSD card from the card slot.

#### Possible Problems

When one of the error messages shown below appears on the LCD screen your T7PX, the software update will not be completed.

##### **“Low battery.”**

Software update is postponed because of low battery. Retry the software update after the battery is recharged.

##### **“Update file not found.”**

The T7PX cannot find the update file on the microSD card. Check to be sure all the update files have been copied onto the microSD card.

##### **“Broken file.”**

The T7PX detects the update file error. The update file may be broken or for another transmitter.

##### **“Write error.”**

The software update procedure is stopped for an unknown reason. Contact your local service center when this error message appears on the LCD screen of your T7PX.

Futaba S.BUS / S.BUS 2 The “S. BUS servo” function (Instruction manual page 135) that allows you to change the servo parameters can now be set up wirelessly by connecting to the receiver.

\*A receiver compatible with the wireless setting function is required. (As of April 2018, R334SBS / R334SBS-E is compatible with wireless setting, please update the previous receiver to version 2.0 or later.)



#### **WARNING**

❗ In the wireless setting, there is a danger that a car (boat) goes uncontrollably unexpectedly because the servo will temporarily stop working during communication. For safety, in case of electric car (boat), please set with driving wheel (boat propeller) not touching the road surface (water surface). Also, in the case of an internal combustion engine car (boat), be sure to stop the engine before entering wireless set-up mode.

#### **NOTE:**

- For safety reasons, it is not possible to change between normal mode and SR mode with wireless setting. To change the mode, connect the servo to the communication port and switch. However, for servos set to SR mode, SR1 / SR2 / SR3 can be switched by wireless setting.
- Wireless setting can not be used if a device that converts signals such as gyro and FSU (Failsafe Unit) etc. are connected between the receiver and the servo.

#### **How to check the receiver software version**

1. Set the RF type to T-FHSS system type and link transmitter and receiver. (Refer to instruction manual pages

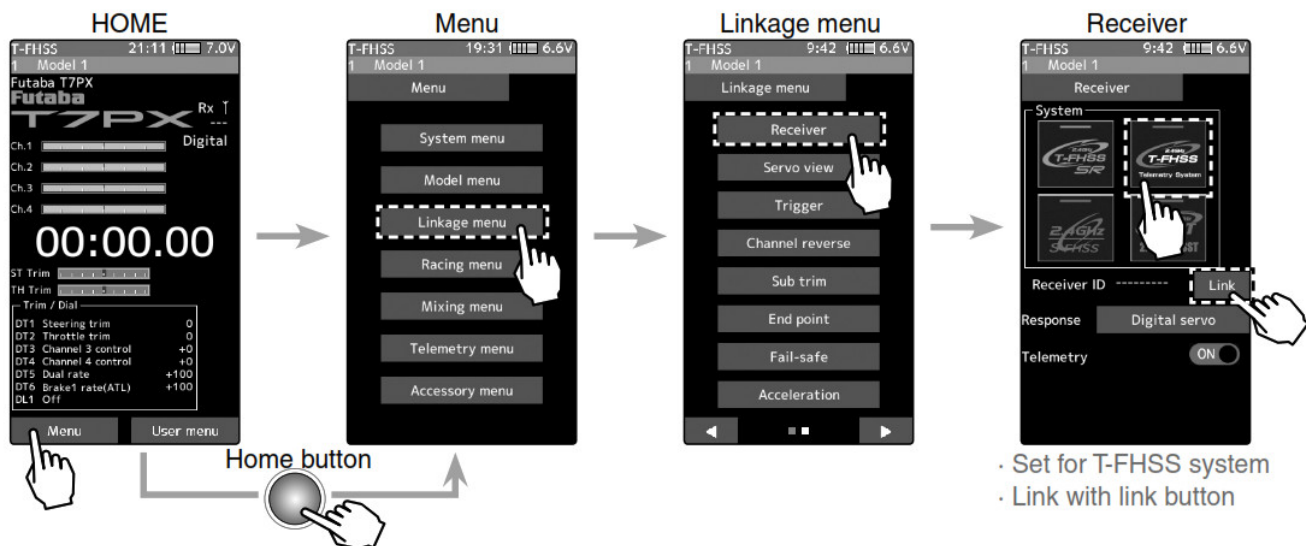

- When the link is completed, power cycle the receiver. You can check the software version on the receiver screen. After confirmation, reconfigure the system to be used as per normal and link again. Please update the receiver to below version 2.0.

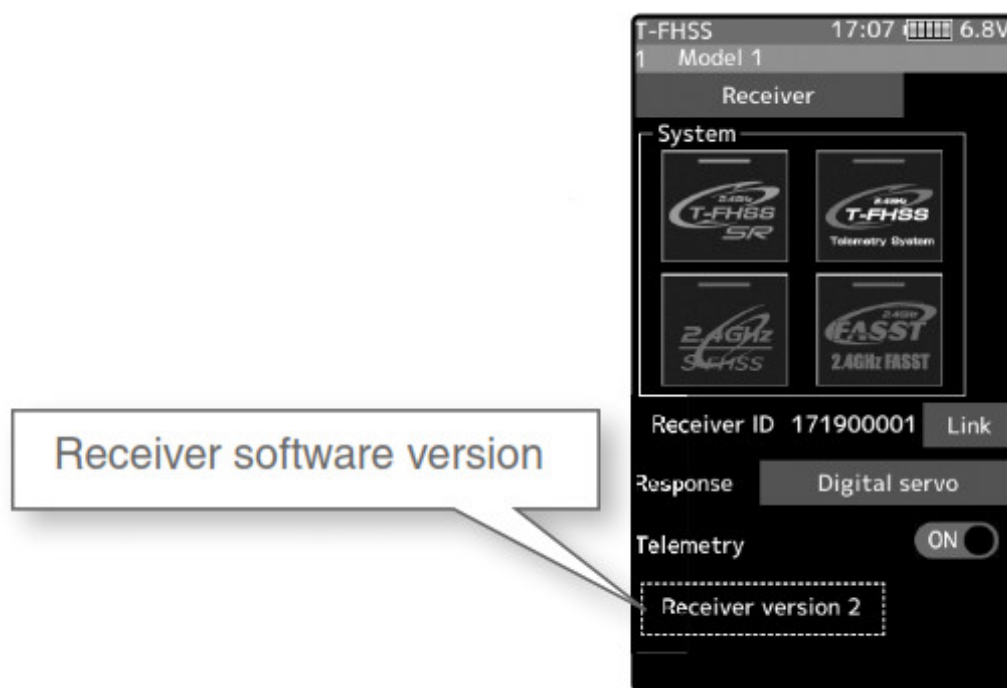

### Connection channel of servo to make wireless setting

Connect the S. BUS / S. BUS 2 servo as shown in the figure and the receiver battery to the channel of the receiver.

– Reference When using “S.BUS / S.BUS2” servo with steering mixing (Instruction manual page 103) with a twin servo specification car such as 1/5 GP car, in the channel setting function (Instruction manual page 75), 1st channel And 2nd channel are set to steering, both servos can be wirelessly set.

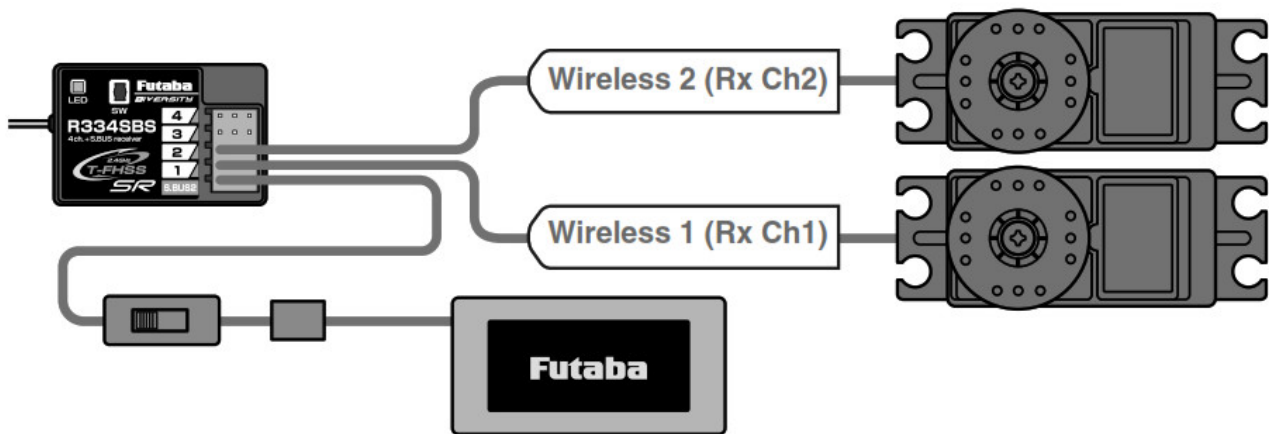

## How to use wireless settings

The transmitter's power switch turns on the PWR side and outputs radio waves. Wireless setting are not be used on the DISP side. Turn on the battery switch of the receiver and confirm that the servos can operating. The S.BUS servo screen is displayed in the following way.

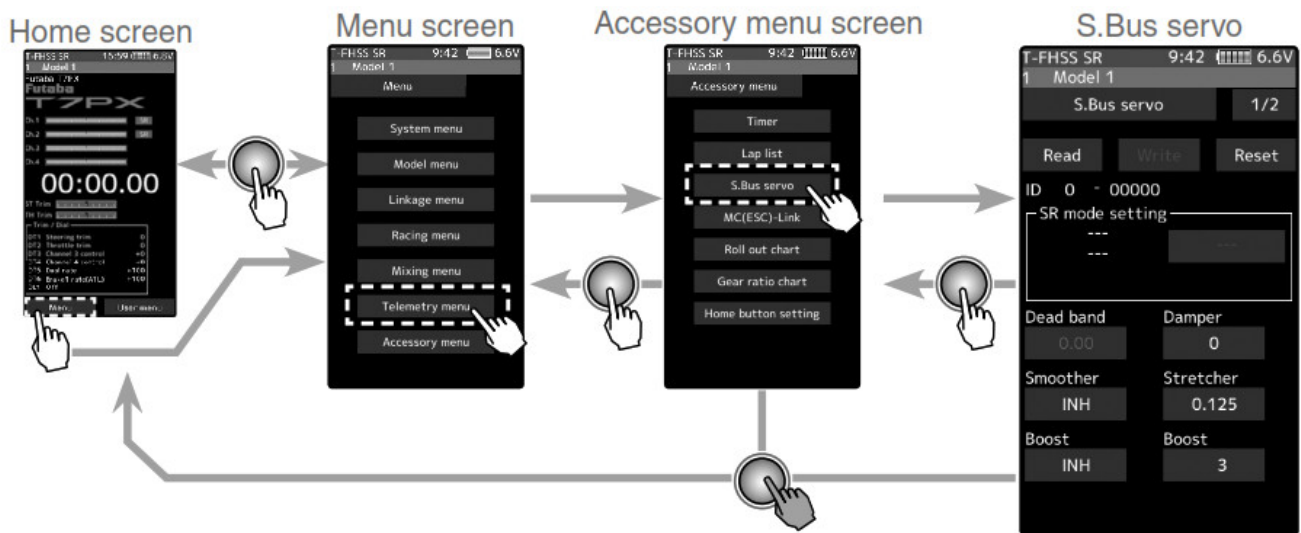

1. Tap the [Read] button. The notes on wireless setting are displayed. Tap the [Close] button. Once this screen is displayed, it will not be displayed again until you turn the power back on.



2. Touch the channel in which the servo to be set is connected to and read the setting data from the servo.

- Communication port
- Wireless 1 (Rx Ch1)
- Wireless 2 (Rx Ch2)

:T7PX communication port (conventional wired setting).

:Receiver channel 1

:Receiver channel 2

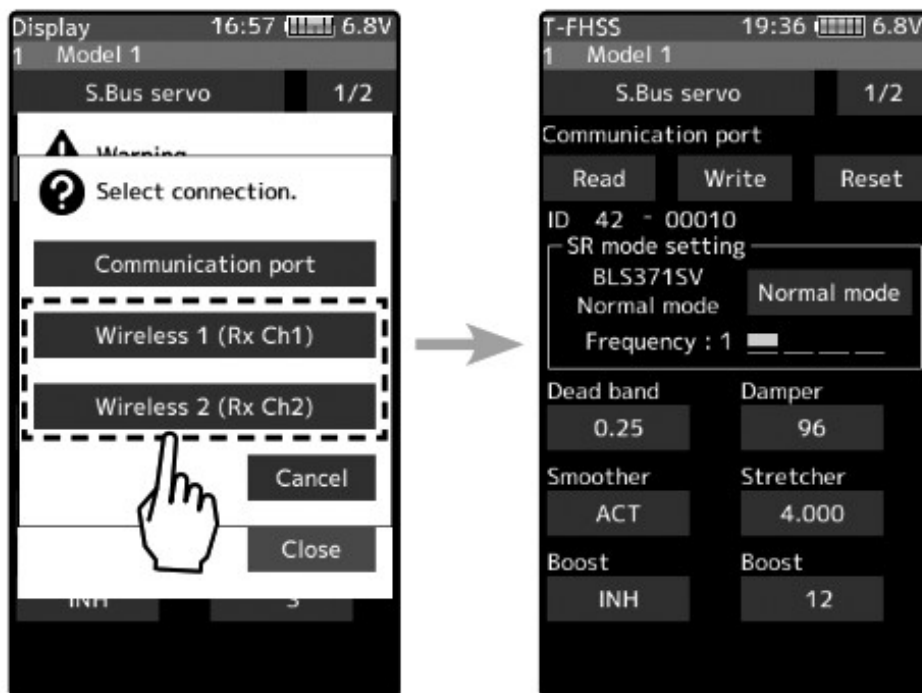

-“Reading succeeded” is displayed on the screen and the servo’s ID cord and currently set contents are read.

– If “Failed” is displayed on the screen, communication with the servo is not being performed normally. Check the T7PX and servo connection to servo and repeat [Read]. (Check receiver power supply etc.)

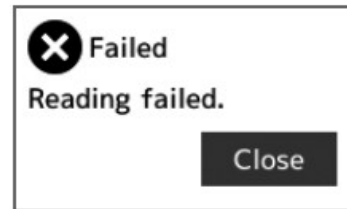
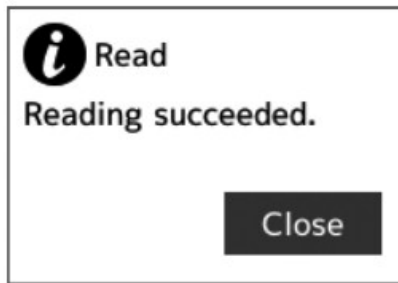

## Other changes and additions

- Operation change in the “Acceleration” range (instruction manual page 60) within EPA setting range.
- Added poll number setting and gear ratio setting on Telemetry Link setting screen of non-Futaba sensor (Castle TL 0).
- Added support to change SR mode of BLS373SV.

Futaba has added a function to program your Futaba R334SBS / R334SBS-E receiver from the T7PX. To update the receiver, you need a PC that can be connected to the Internet, a mini driver (to push the switch of the receiver), a micro SD card (commercial product), and a cord for CGY750 / GY701 / GY520 (optional) or DSC cord (optional).

## Preparing for update

- Download the zip file of the update data from our website or your local distributor’s website.
- Extract the zip file on your computer. A folder named “FUTABA” is created.
- Insert the micro SD card that contains the “FUTABA” folder into the T7PX (see page 31 of the manual).

## Connection between T7PX and receiver

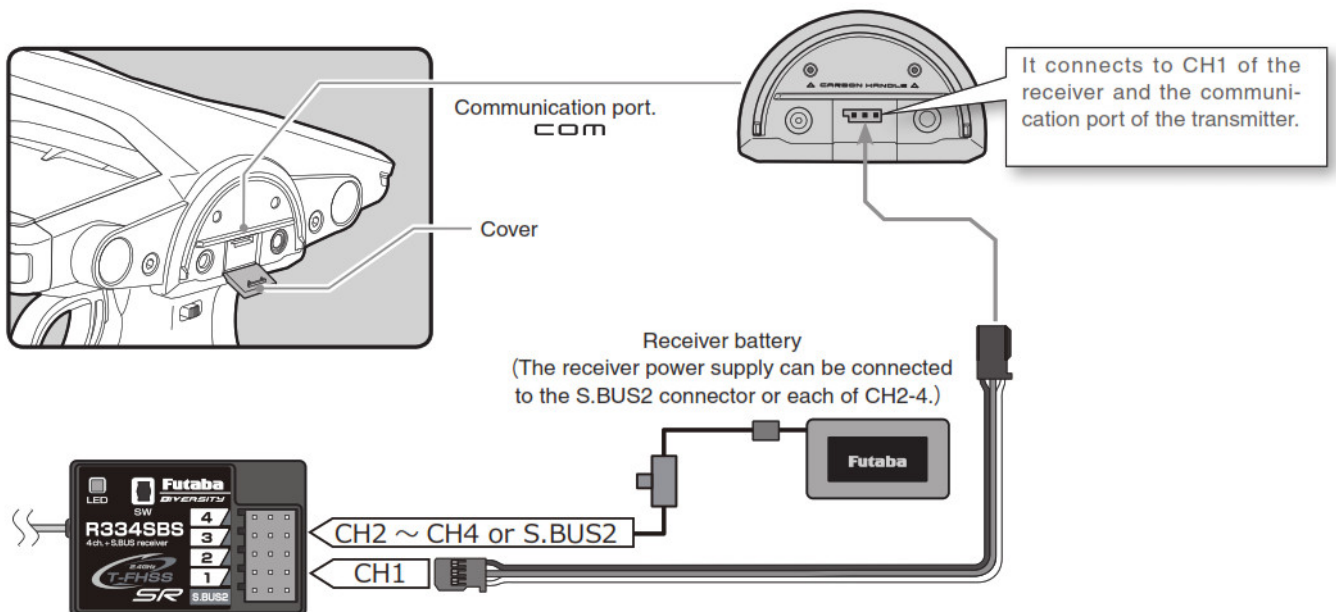

Turn on the DSP or PWR switch of T7PX and display the receiver update screen.



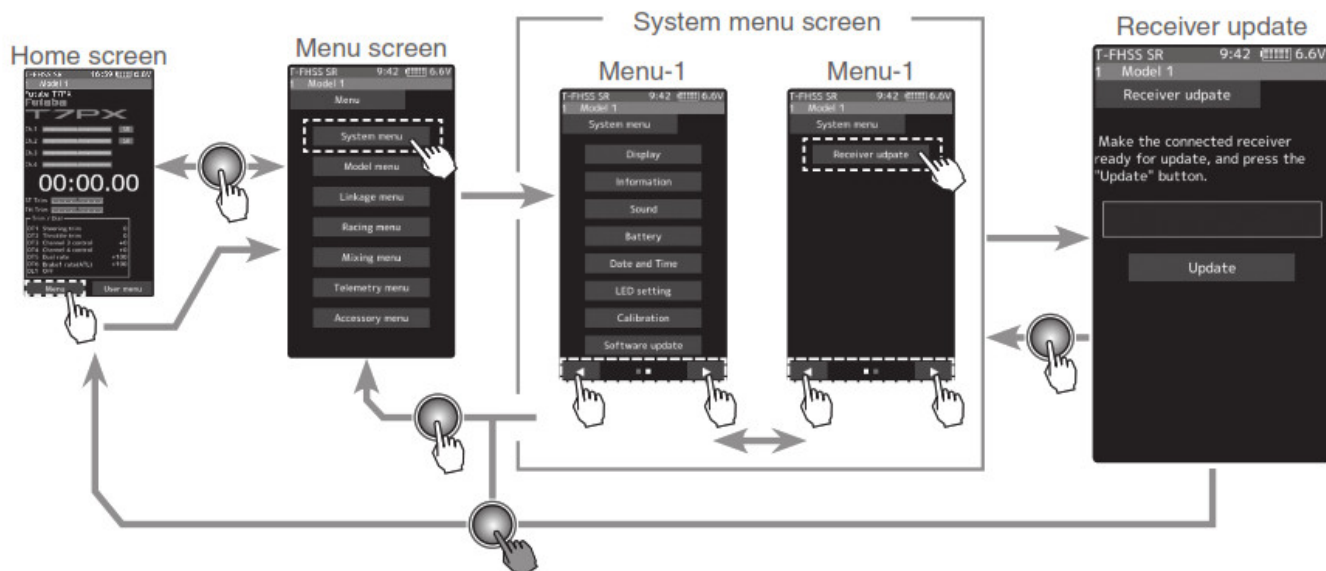

## Update method

1. Hold down the Link switch first, and turn ON the receiver. LED After the LED flashes red once, release the Link switch and then press it again. As you continue holding down the Link switch, the LED starts flashing red and green. (Once flashing Red and Green, the initial process is complete. )  
 – If red and green do not turn on at the same time, please start over from the beginning.

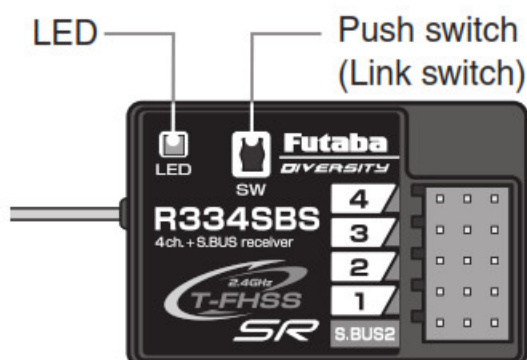

2. Tap the “Update” button on the screen. The update will start. A progress bar will be displayed indicating the progress. The LED of the receiver turns green, and it blinks green for a moment every time it accepts data from the T7PX.  
 – Do not turn off the power of T7PX while updating.



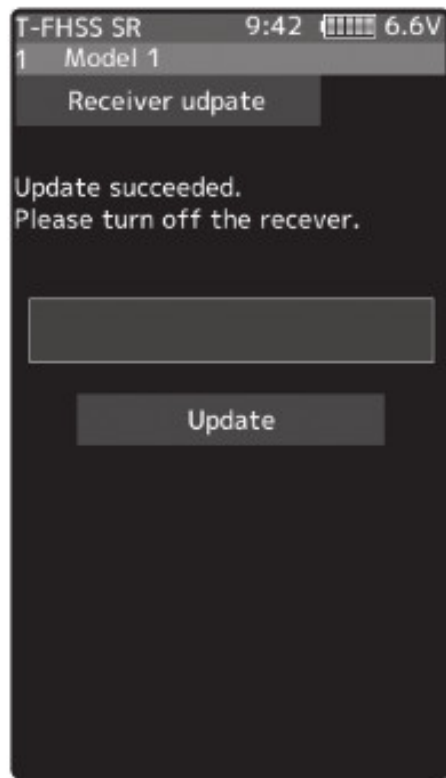

3. When the update is completed, a message is displayed on the screen, and the LED of the receiver stays flashes green. Please turn off the power of the receiver. Please check the operation before running (cruising).
4. When finished, return to the System menu screen by pressing the HOME button.  
 Error If an error display appeared, reinstall the update from the beginning.
  - The receiver is not in the update wait state.
  - The cable is disconnected.
  - The power has been turned off
  - The micro SD card is not inserted in the T7PX.
  - There is no data on micro SD card.

## Forced initialization

In the unlikely event that the model data is damaged and the T7PX stops working properly, it is possible to initialize the current model data in the following way.

### Note:

This operation completely initializes the model data. Please do not use it except when data is broken.

## How to Initialize

1. While pressing the PS6 switch, turn on the transmitter power.

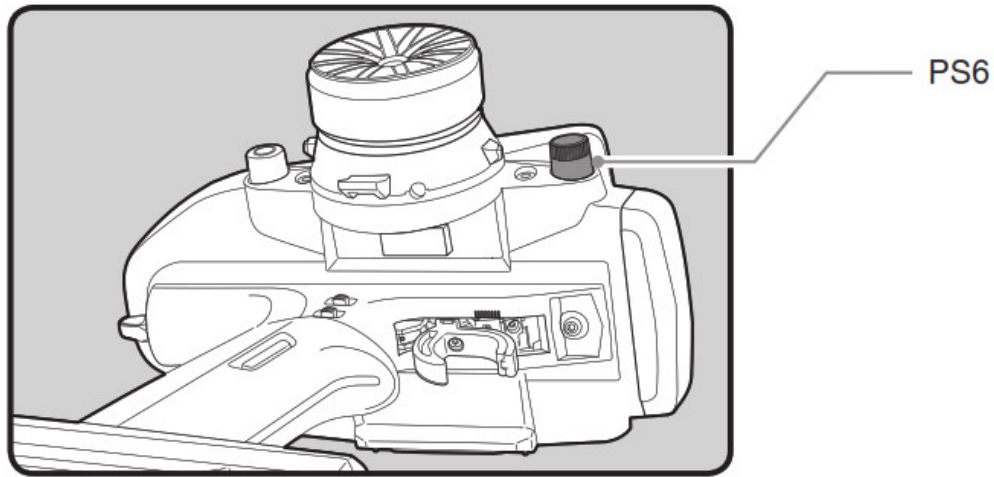

2. A confirmation screen, "Caution!! The current model data will be initialized. Sure?", will be displayed.
3. Touch [Yes] to carry out initialization and turn off the power. Since the current model data will be initialized, please re-set the data and check the operation carefully before use. To cancel the operation, touch [No]. The power is turned off without initializing the data.

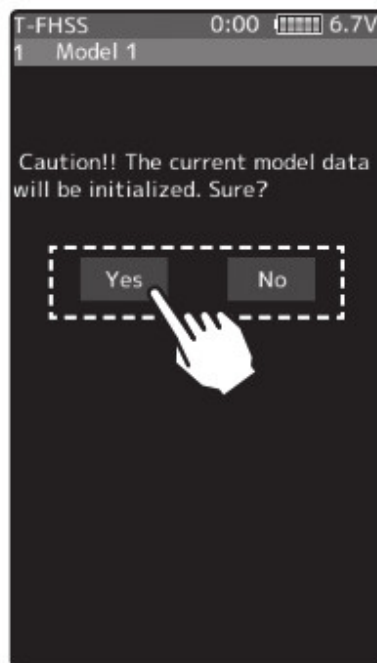

– After initialization, the current model data will be initialized, so please set the data again before using and confirm the operation.

## Documents / Resources

	<p><a href="#">Futaba T7PX Software Update Method</a> [pdf] User Guide</p> <p>T7PX Software Update Method</p>
--	---