



# Futaba T16IZ Transmitter Remote Control Instructions

[Home](#) » [Futaba](#) » Futaba T16IZ Transmitter Remote Control Instructions

## Contents [ [hide](#) ]

- [1 Futaba T16IZ Transmitter Remote Control](#)
- [2 How to update T16IZ](#)
- [3 T16IZ SOFTWARE UPDATE CHANGES](#)
- [4 T16IZ SOFTWARE UPDATE CHANGES](#)
- [5 GYA553 Addition of setting parameters](#)
- [6 Documents / Resources](#)
- [7 Related Posts](#)

The Futaba logo, consisting of the word 'Futaba' in a bold, black, sans-serif font with a registered trademark symbol (®) at the end.

**Futaba T16IZ Transmitter Remote Control**



## How to update T16IZ

Your Futaba T16IZ transmitter programming can be updated easily online. When functions are added or improved, the update file can be downloaded from our website. Copy the update files to the microSD card and then use the following procedure to update the program. Check our web site for the FAQ regarding updating for more information.

### Updating procedure

**Note:** If the battery fully discharges during program updating, updating will fail. When the remaining battery capacity is 50% or less, always recharge the battery before updating.

**Note:** The model data in the transmitter can be used unchanged after updating, but to be safe, back up the model data before updating.

1. Download the zip file of the update data from gyr website

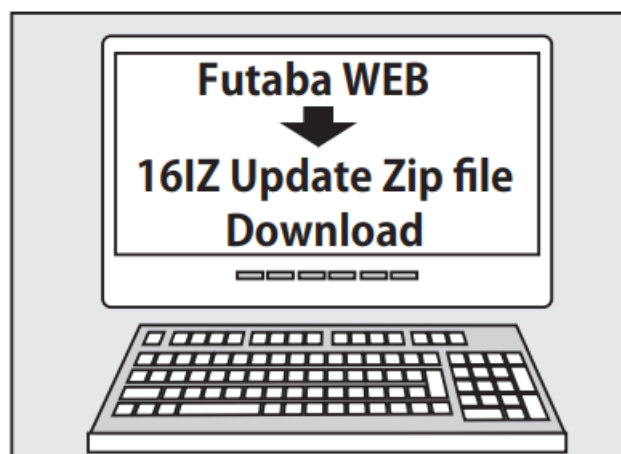

2. Extract the zip file on your computer.

3. The "FUTABA" folder will be created on your Computer.
4. Copy the "FUTABA" folder into your microSD Card

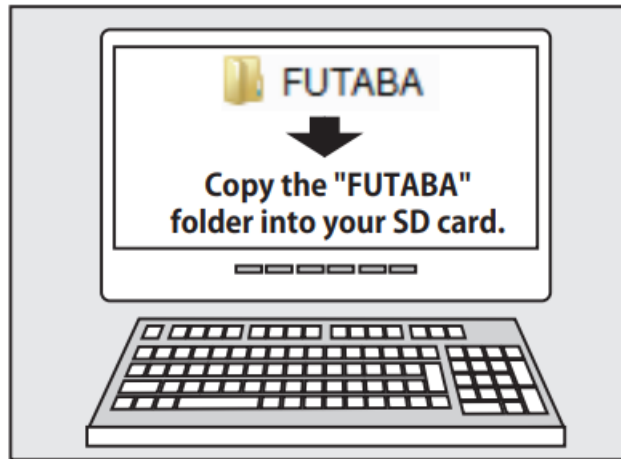

**Note:** If the microSD card has already had "another FUTABA" folder before you make a copy, the "FUTABA" folder is OVERWRITTEN.

5. Insert the microSD card with "FUTABA" folder that contained the update software into the SD card slot on your T16IZ radio transmitter.

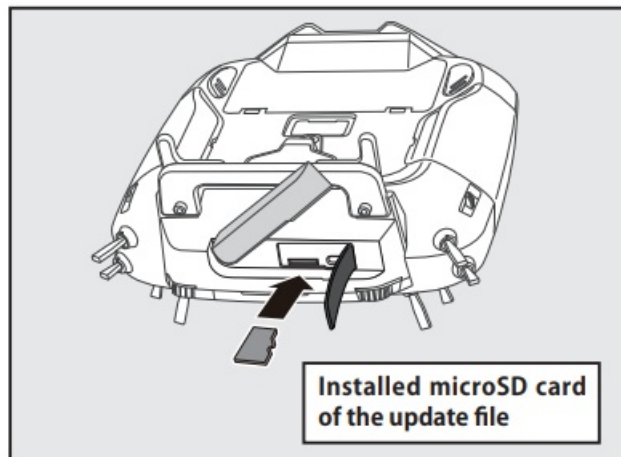

6. Turn on the transmitter power while pressing down the "HOME/EXIT" button. The update screen appears on the LCD display of your T16IZ and the software update is started.

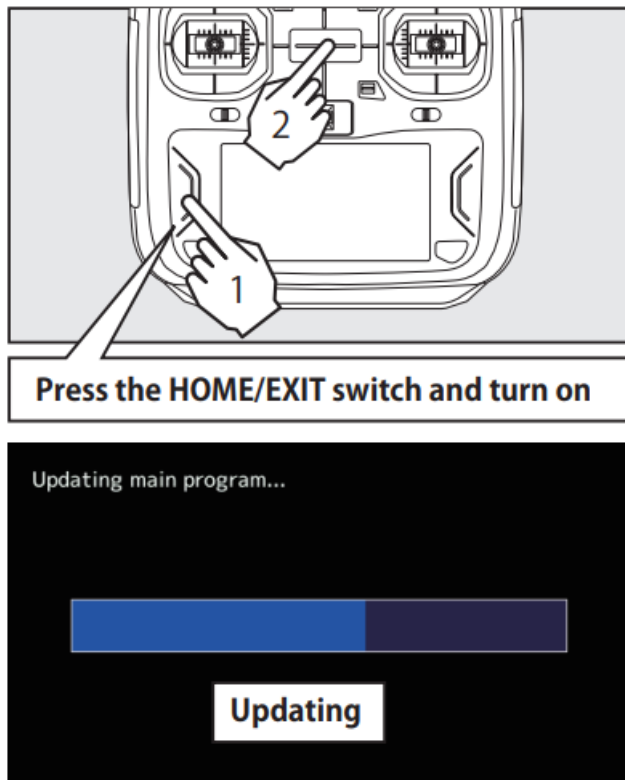

7. When the software update is completed, “Completed” message is shown on the LCD display of your T16IZ.  
(Show below picture.)

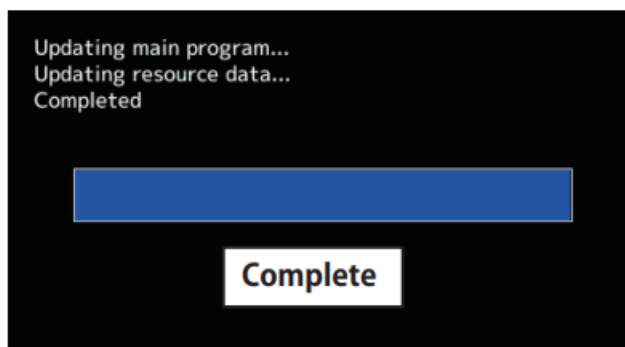

8. Turn off the power switch of your T16IZ and remove the microSD card from the card slot.

### Possible Problems

When one of the error messages shown below appears on the LCD screen your T16IZ, the software update will not be completed.

“Low battery.”

Software update is postponed because of low battery. Retry the software update after the battery is recharged.

The T16IZ cannot find the update file on the microSD card. Check to be sure all the update files have been copied onto the microSD card. update file may be broken or for another transmitter.

“Write error.” The software update procedure is stopped for an unknown reason. Contact your local service center when this error message appears on the LCD screen of your T16IZ.

Don’t absolutely remove the battery and the microSD card from the transmitter during the update. There is a possibility that the transmitter will be damaged. Recovering a failed update

If you failed to update for any reason, it may transmitter will not start. In that case, please update again transmitter in the following procedure.

1. Detach the battery from the transmitter.
2. Insert the microSD card that contained
3. Attach the battery to the transmitter while pressing down the “HOME/EXIT” button.
4. The update will start.

Even after the above steps, if the transmitter fails to update or does not start, please have it serviced.

## **T16IZ SOFTWARE UPDATE CHANGES**

This software updates or alters the functions and features noted below. The instructions and information that follow are meant as a supplement to the original instruction manual that accompanied the T16IZ transmitter. Please refer to the original instruction manual where applicable, but replace the steps indicated below with these instructions. Please check to ensure that the update has been installed.

1. Select the System Menu.
2. Touch the [Information] button.
3. Confirm that the information in the display indicates the version numbers as noted above.

### **GYA553 New firmware Version 2.x support. →Refer to T16IZ GYA553 V2 Setting manual**

1. CH3 (THR) can be output to the RUD2 / S.BUS2 port.
2. The Holding Power rate of the aircraft in AVCS mode has been expanded to 5 types from C1 to C5, and each rate can be set by switching the display.
3. Added the setting of switching CH of Holding Power rate C1 to C5 to S.BUS basic menu.

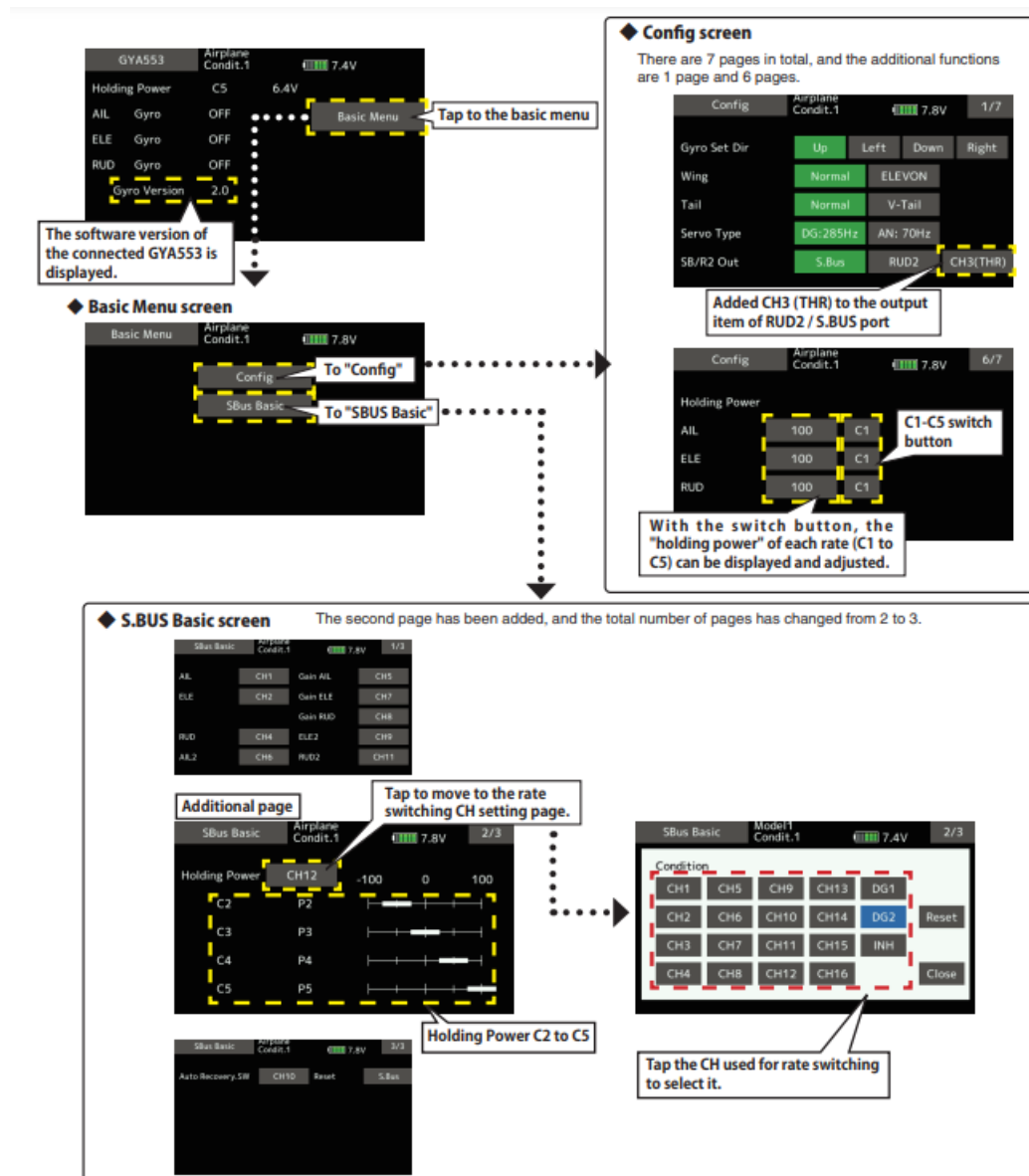

The current rate numbers C1 to C5 are displayed by operating the channel of the transmitter. Like the flight condition function of the transmitter, you can set up to 5 different data for the attitude holding force rate of the aircraft in AVCS mode by operating the switch from the transmitter, and switch between them. You can set the holding power rate selector switch to the channel with the AFR function of the transmitter, and set the point for each rate on the AFR point curve to switch. It is also possible to use the flight condition switch to work with the flight condition switch.

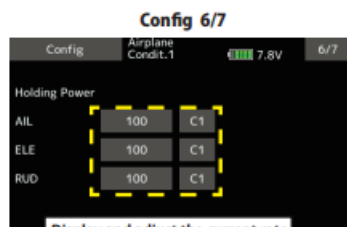

Display and adjust the current rate numbers C1 to C5 by operating the channel on the transmitter.

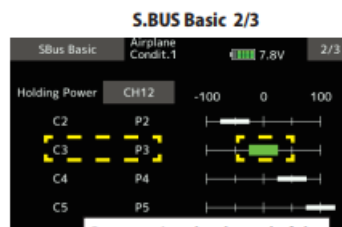

By operating the channel of the transmitter, the channel position of the current rate numbers C1 to C5 will be displayed in green.

When set to SW of DG1 or DG2

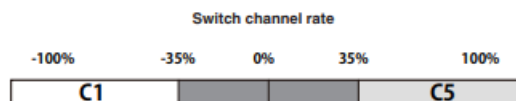
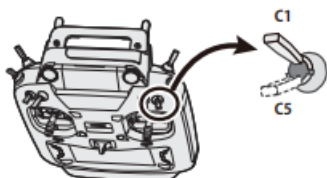

When set to dial or lever

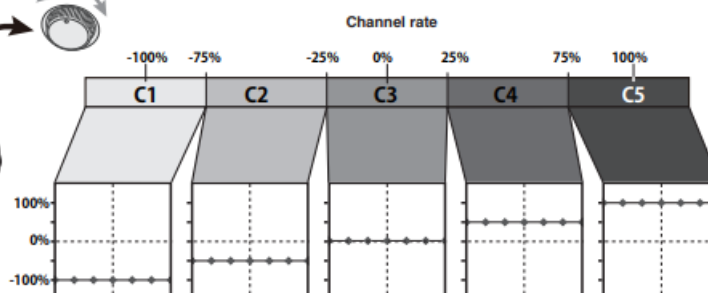
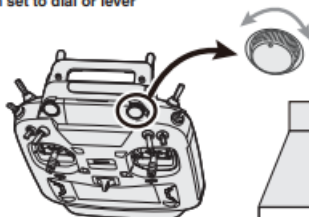

## O.S.ENGINE EM-100 New firmware Version 9.11 support.

If you have used the EM-100, the update will unregister the EM-100 from the "Sensor" screen. Register the EM-100 again on the "Sensor" screen.

## T16IZ SOFTWARE UPDATE CHANGES

This software updates or alters the functions and features noted below. The instructions and information that follow are meant as a supplement to the original instruction manual that accompanied the T16IZ transmitter. Please refer to the original instruction manual where applicable, but replace the steps indicated below with these instructions. Please check to ensure that the update has been installed.

1. Select the System Menu.
2. Touch the [Information] button.
3. Confirm that the information in the display indicates the version numbers as noted above.

Fixed an issue where the Vario Melody settings were not saved.

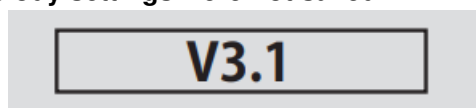

Fixed telemetry voice for Futaba ESC and Hobbywing ESC.  
Fixed the problem that model copy fails.

Compatible with Futaba ESC MC-980H/A, MC-9130H/A, MC-9200H/A

Supports the telemetry function of MC-980H/A, MC-9130H/A, and MC-9200H/A.

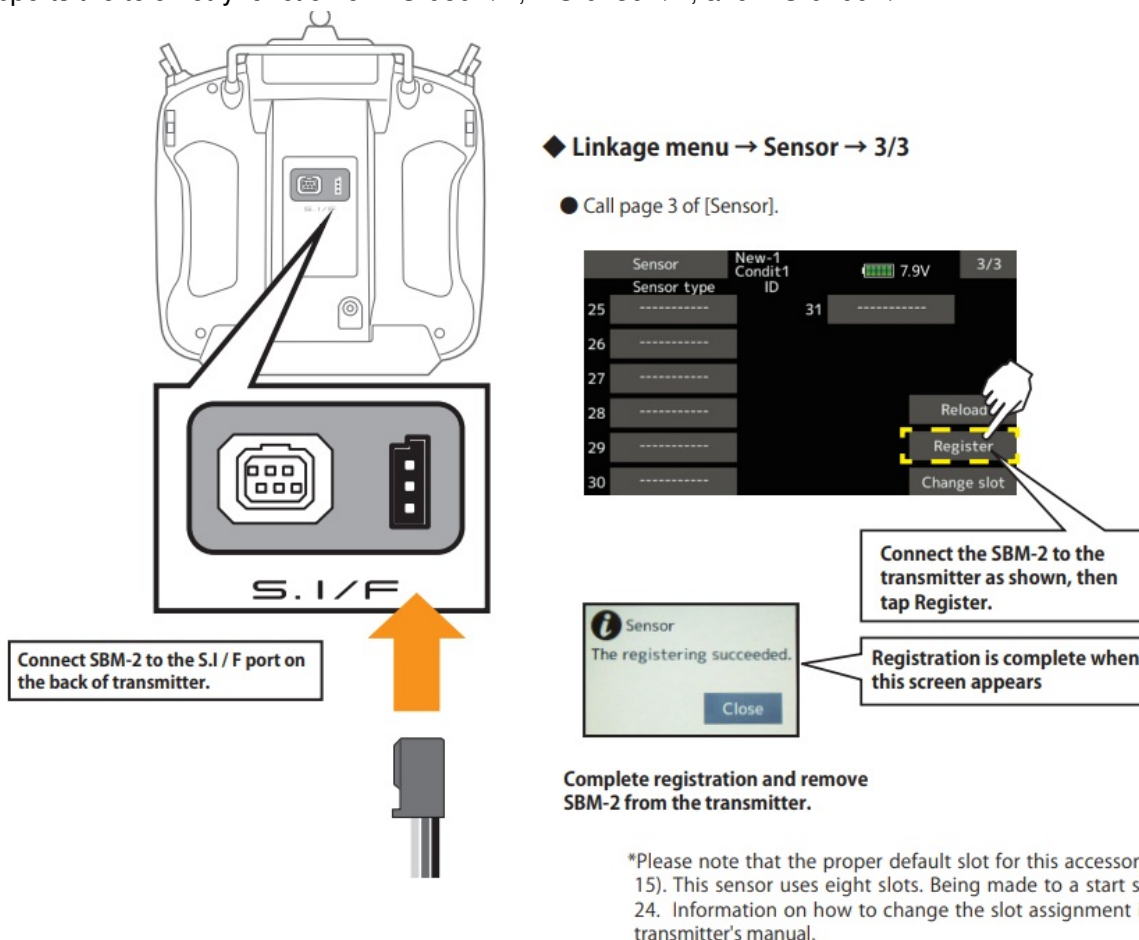

The registered ESC will be displayed as "Futaba ESC".

The registered Hobbywing ESC is displayed as "Hobbywing ESC".

For details on Hobbywing ESC telemetry support, refer to the Hobbywing website.

## MC-9130H / A telemetry connection example

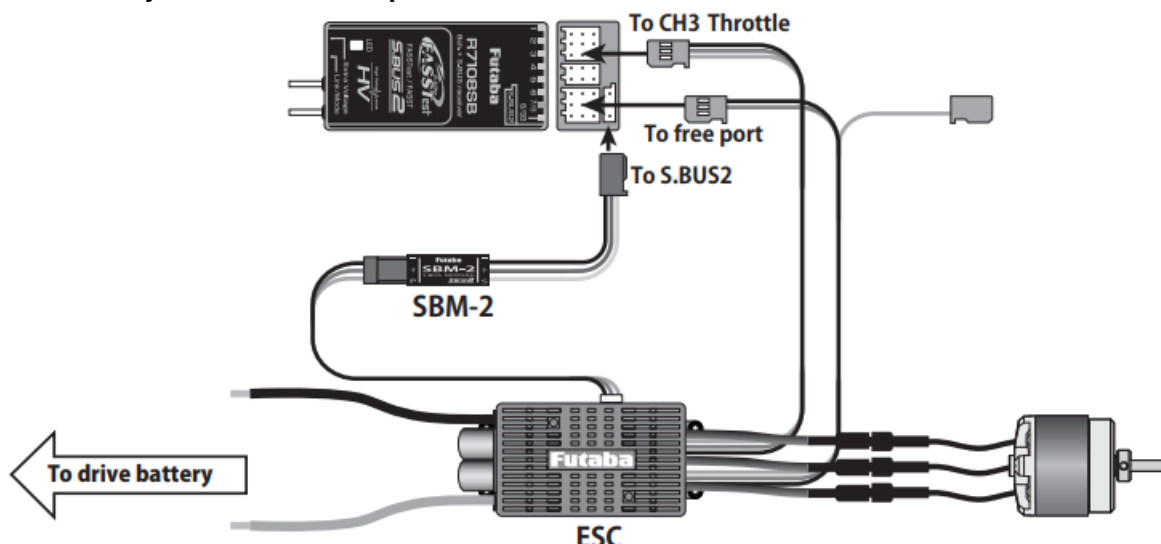



## ESC telemetry display screen

The ESC status is displayed. Alarm setting is also possible.

### ESC telemetry display screen

The ESC status is displayed. Alarm setting is also possible.

**ESC telemetry display screen (Page 1/2):**

- Current: 0.0 / 0.0A → Tap to move to the current setting page.
- Voltage: 0.0 / 0.0V → Tap to move to the voltage setting page.
- Capacity: 0 / 0mAh → Tap to move to the capacity setting page.
- Rotation: 0 / 0rpm → Tap to move to the rotation setting page.
- Display max / min value: Press and hold to reset.

**ESC telemetry display screen (Page 2/2):**

- ESC Temperature: 0 / 0°C → Tap to move to the temperature setting page.
- Throttle: 0 / 0% → Shows the output level from the ESC to the motor, not the position of the throttle stick. Even if the stick is in the 50% position, the output may not be 50% depending on the ESC setting. Tap to move to the throttle setting page.
- Status: Throttle not at 0%, Over temperature, Over current, Motor locked, Low voltage, Throttle signal lost.
- Display max / min value: Press and hold to reset.

**Alarm setting screen:**

- Alarm: Inhibit (Upward arrow indicates alarm when current reaches above set value; Downward arrow indicates alarm when current reaches below set value).
- Vibrator: Inhibit
- Limit: 100A (Sets the current on which the alarm operates).
- Speech: OFF (Allows Speech to be turned ON or OFF).
- Alarm is chosen from Buzzer, Voice, and Inhibit.

\*The current and capacity consumption display may vary depending on the usage conditions, so use it as a guide.

Alarms can be set for Voltage, Capacity, Rotation, ESC temperature, and Throttle using the same procedure.

### Alarms can be set for Voltage, Capacity, Rotation, ESC temperature, and Throttle using the same procedure.

**Alarm setting screen:**

- Speech: OFF
- Pole: 14 (Enter the number of poles for your motor.)
- Gear ratio: 1.00 (If the gear is down, enter the gear ratio to display the helicopter rotor speed and the airplane gear down propeller speed.)
- Status: Alarm (When enabled, the alarm will be activated in the following warning state.)
- Vibrator: Inhibit (When enabled, the vibrator will start in the following warning state.)

**Warning state:**

Throttle not at 0%	When the throttle stick is not low when ESC is started
Low voltage	When the battery voltage is below the cutoff voltage
Over temperature	When the ESC temperature is 110 °C or higher
Over current	Peak current over
Motor locked	When the motor locks
Throttle signal lost	When no throttle signal is received for more than 0.25 s

## GYA553 Addition of setting parameters

AIL / ELE / RUD holding power setting has been added to the setting parameters of GYA553.

**Config Airplane Condit.1 7.8V 6/7**

**Holding Power**

AIL	100
ELE	100
RUD	100

Adjusted the gyro holding force of the aircraft in AVCS mode. Decreasing the value weakens the holding power and makes the operation feeling closer to the Normal mode.

1. Add GYA553 Airplane Gyro setting function. (Refer the T16IZ GYA553 Setting Manual)

2. Compatible with SCORPION ESC telemetry  
Added support for SCORPION POWER SYSTEM ESC some models.

## Documents / Resources

	<p><a href="#">Futaba T16IZ Transmitter Remote Control</a> [pdf] Instructions T16IZ, Transmitter Remote Control, Transmitter Remote, T16IZ, Remote Control</p>
---	--