



Futaba FDLS-1 Dual RX Link System Instruction Manual

[Home](#) » [Futaba](#) » Futaba FDLS-1 Dual RX Link System Instruction Manual 

Futaba

1M23N37402

Dual RX Link System

FDLS-1

Instruction Manual

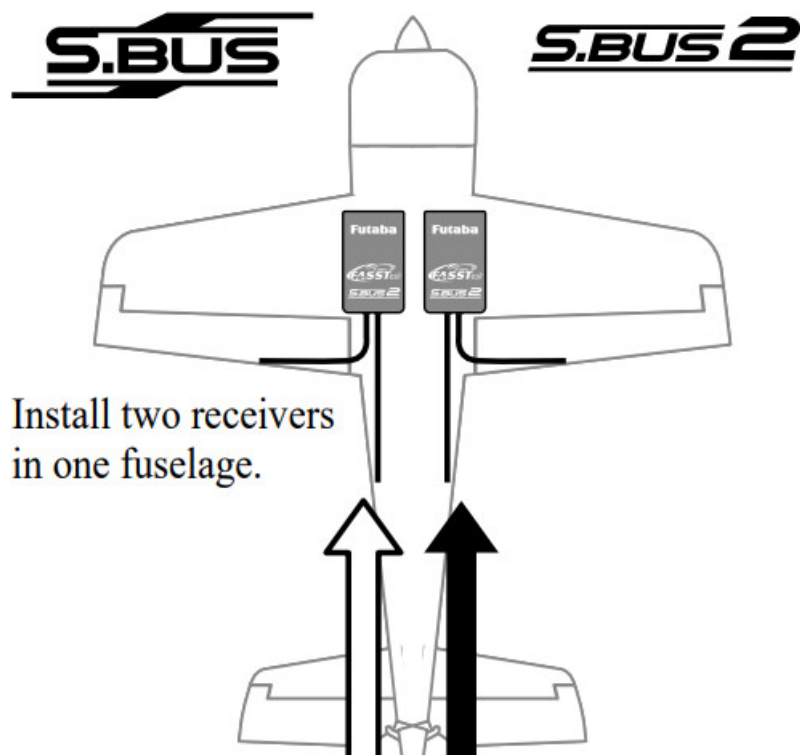

FDLS-1 is a secure system. In the event of trouble with the main receiver, the **FDLS-1** will automatically switch to the sub receiver and fly safely

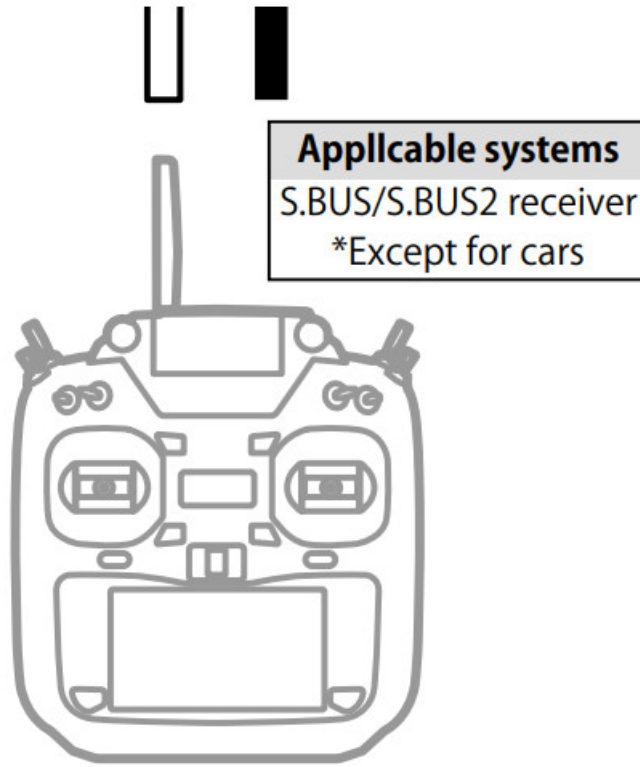

Contents

- [1 How to Use](#)
- [2 LED Indication](#)
- [3 Precautions](#)
- [4 Wiring](#)
- [5 Documents / Resources](#)
- [6 Related Posts](#)

How to Use

1. Install two receivers on the aircraft as shown in the wiring diagram on the next page.
2. Link the two receivers using the dual receiver feature of the transmitter.

For systems without dual receiver capability, link each receiver in turn.

The transmitter in link mode

For FASSTest 18CH Select dual-mode and link primary



*Follow the link procedure
for each receiver manual.



**Turn on the main
receiver and link**

Transmitter in link mode

For FASSTest 18CH Select dual mode and link secondary



**Turn on the sub
receiver and link**

◆ About telemetry system

When using the dual receiver function

- The telemetry function of the main receiver can be used
- Sub-receiver telemetry function is not available

Other than the dual receiver function

- Telemetry not available
- Set telemetry to INH (disabled)

Thank you for purchasing the FDLS-1. Before using your new FDLS-1, please read this manual thoroughly and use the FDLS- 1 properly and safely. After reading this manual, store it in a safe place.



Use: Two receivers communication switching device

Length : 240 mm (9.5 in)

Weight : 6.5 g (0.2 oz)

Operating voltage : DC3.7 V to 7.4 V (Acceptable: DC3.5 V to 8.4 V)

LED Indication

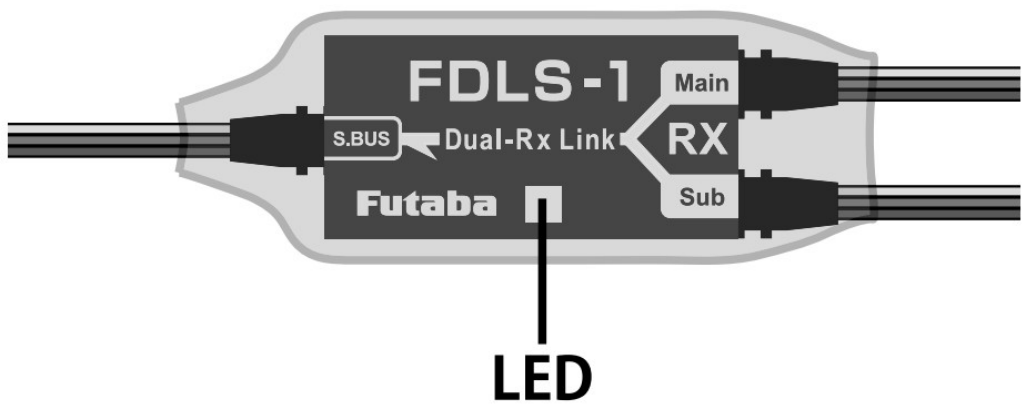

Green 1 blink	Main Rx operation
Green 2 blinks	Sub Rx operation
Red	No signal reception
Green/Red Alternate blink	Unrecoverable error

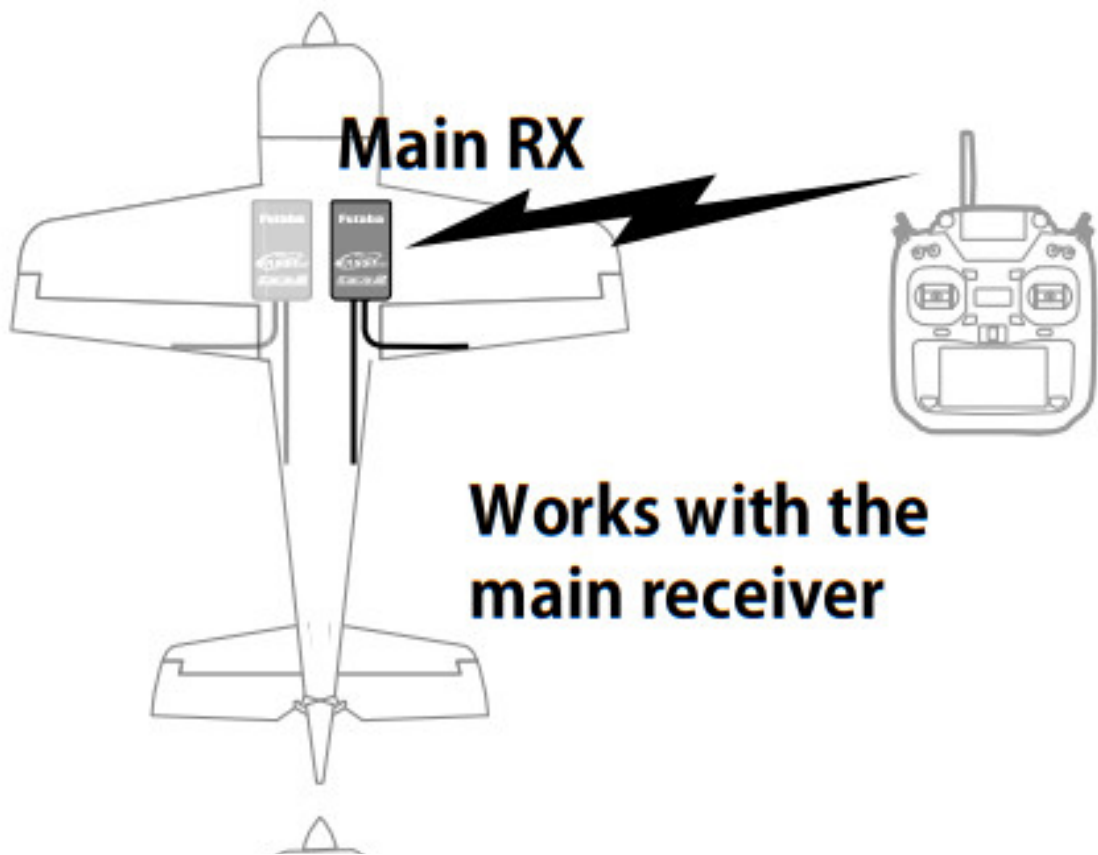

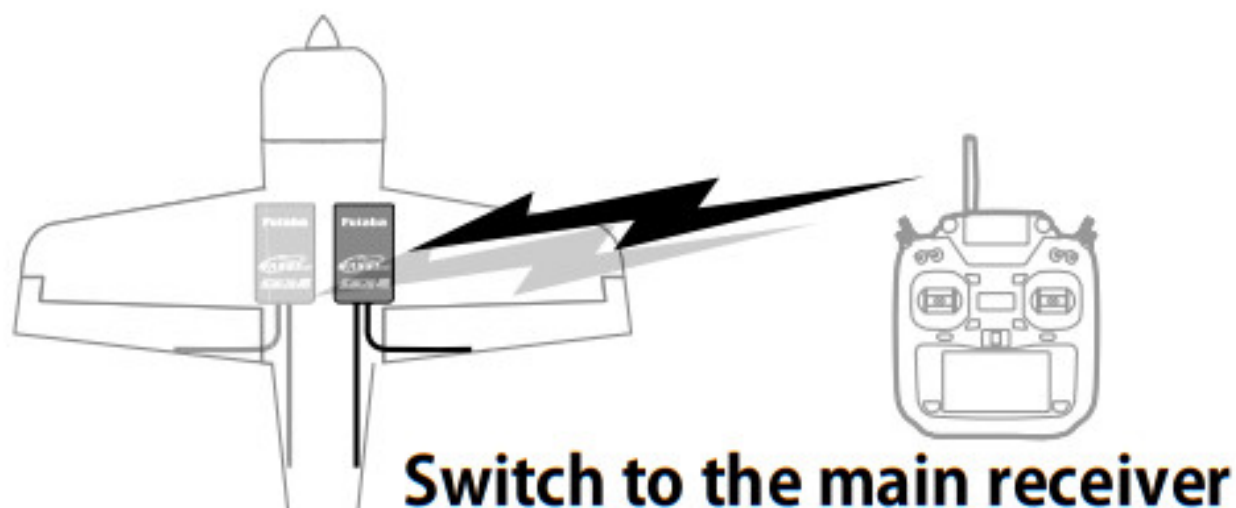
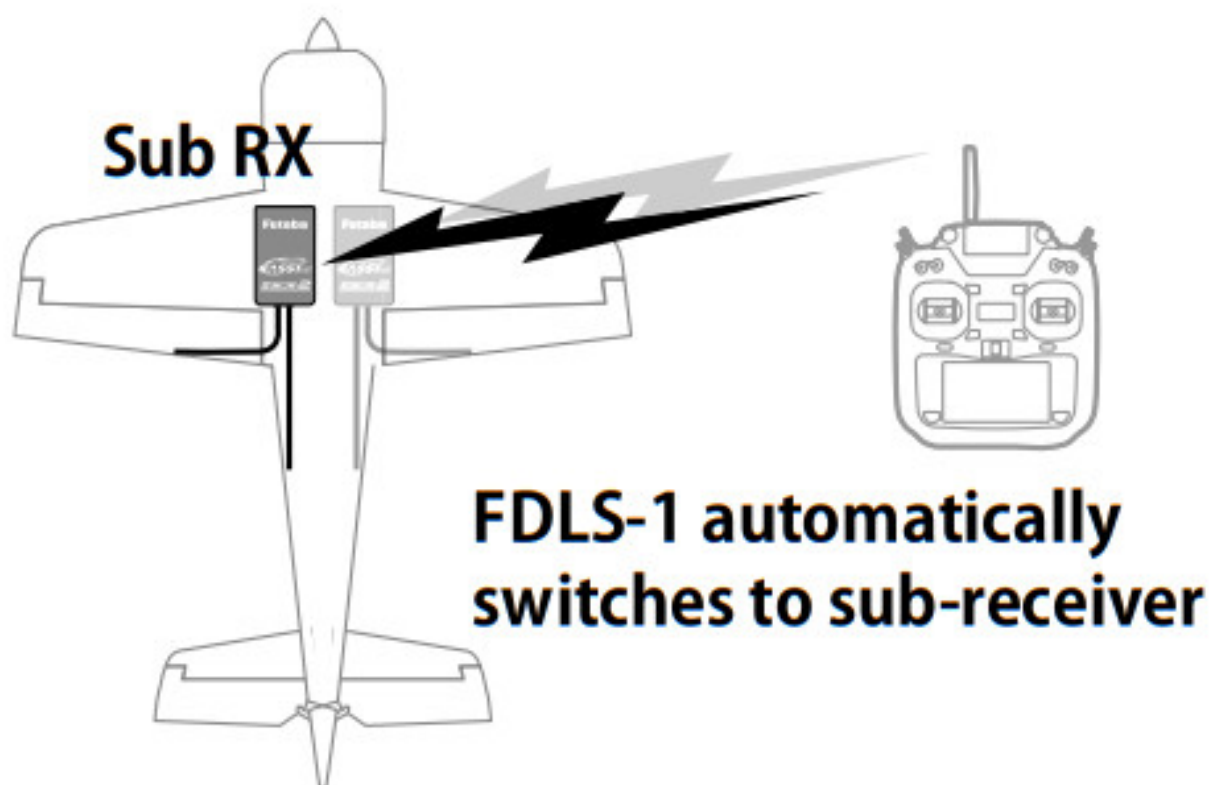
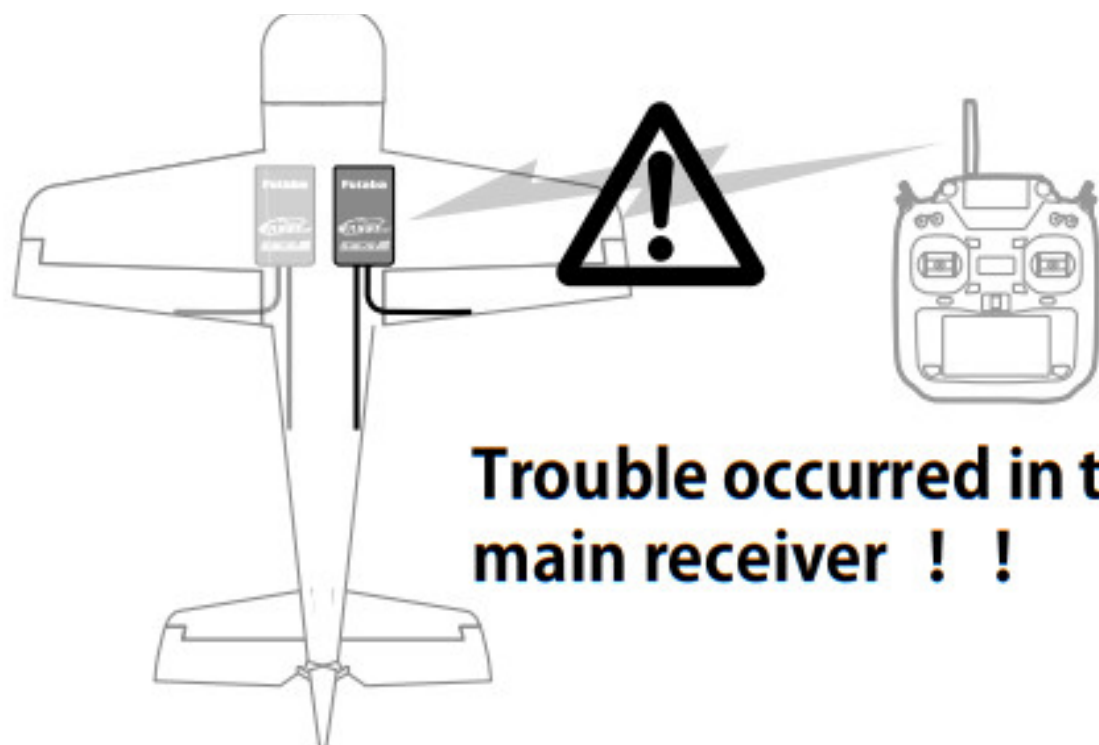

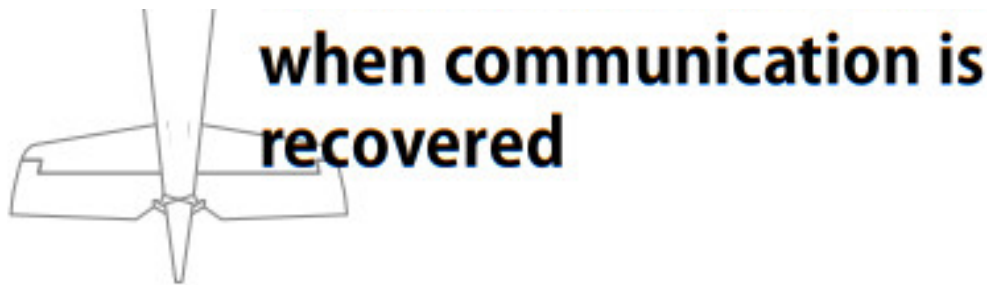

Precautions



WARNING

Failure to follow these safety precautions may result in severe injury to yourself and others.



In order to prevent any short circuits, please observe the polarity of all connections.



Ensure that the unit is connected properly to the receiver.

- If the connector is disconnected during flight, it becomes inoperable.



Ensure that the unit is mounted in an area that will eliminate exposure to fuel, water, and vibration.

- As with any electronic components, proper precautions are urged to prolong the life and increase the performance of the unit.



Allow a slight amount of slack in the unit cables and fasten them at a suitable location to prevent any damage from vibration during flight.



Be sure to link the two receivers with the transmitter.

- It will not work unless the two receivers are linked. After startup, even if the link on one side is disconnected, the other side will continue to operate normally.



Used in a set of Futaba S.BUS / S.BUS2 systems.



Do not supply receiver power from the ESC. When using the receiver power supply type ESC, remove the red (+) cord of the 3ch wiring from the ESC so that the power is not supplied from the ESC.

- Use a dedicated battery to power the receiver/servo.



Don't mount FDLS-1 away from magnetic bodies.



To ensure that the FDLS-1 is functioning as desired, please test accordingly.

- Do not fly until the inspection is complete.



Before the flight, disconnect the wiring of the main receiver from the FDLS-1 that is operating normally, and check if the sub receiver alone can control it.

- Check if the FDLS-1 switches.



Do not use the FDLS-1 with anything other than an R/C model.

Wiring

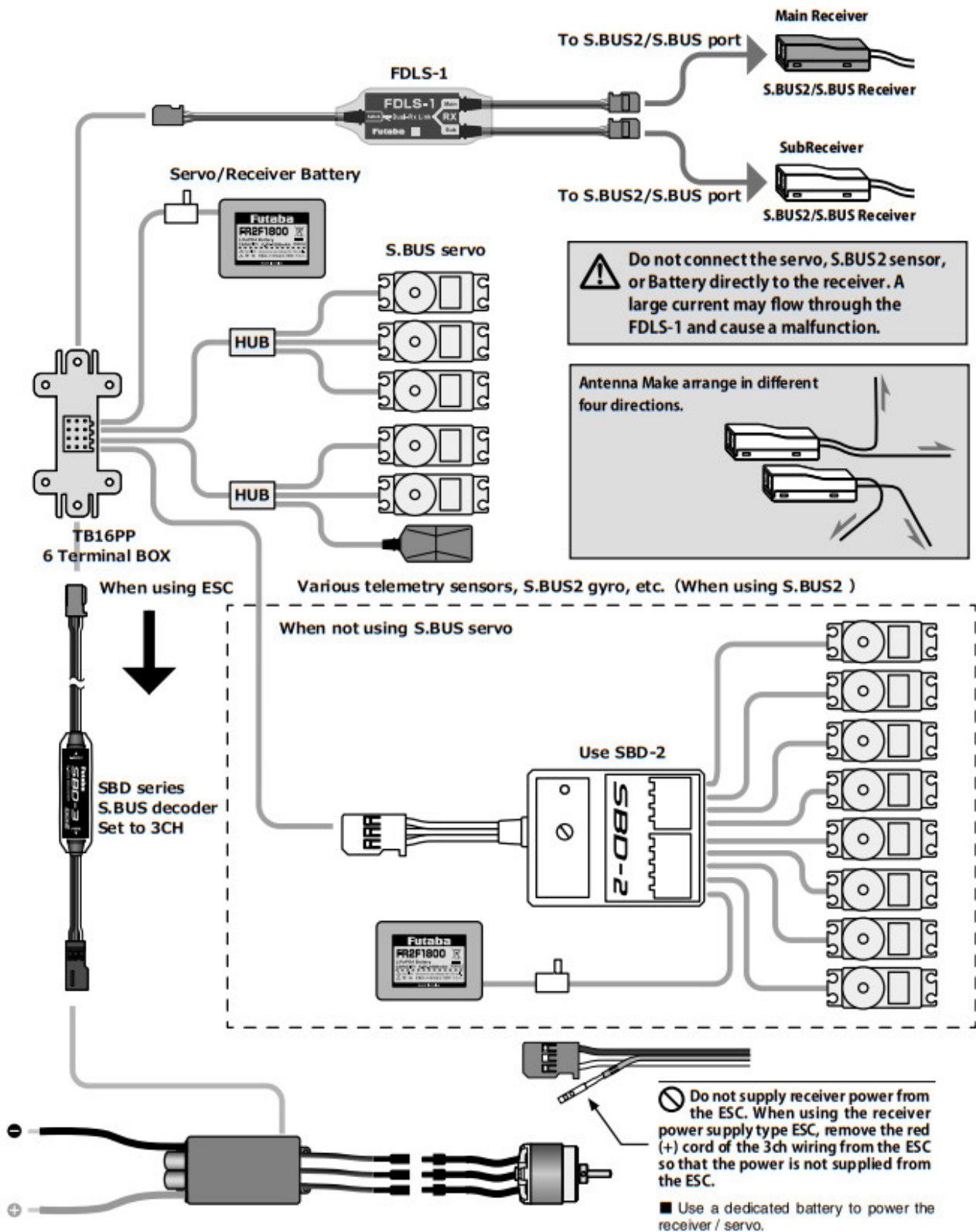

FUTABA CORPORATION

Hobby Radio Control Business Center Sales & Marketing Department
 1080 Yabutsuka, Chosei-mura, Chosei-gun, Chiba-ken, 299-4395, Japan
 TEL: +81-475-32-6051, FAX: +81-475-32-2915

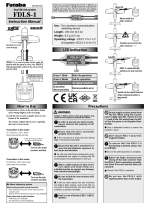

[Futaba FDLS-1 Dual RX Link System](#) [pdf] Instruction Manual
FDLS-1, Dual RX Link System