

FUSION[®]

FUSION SG-TW10
Signature
Component
Tweeter



FUSION SG-TW10 Signature Component Tweeter Instruction Manual

[Home](#) » [FUSION](#) » FUSION SG-TW10 Signature Component Tweeter Instruction Manual 

Contents

- [1 FUSION SG-TW10 Signature Component Tweeter](#)
- [2 Product Information](#)
- [3 Important Safety Information](#)
- [4 Tools Needed](#)
- [5 Troubleshooting](#)
- [6 Specifications](#)
- [7 Dimension Drawings](#)
- [8 Documents / Resources](#)
 - [8.1 References](#)
- [9 Related Posts](#)

FUSION[®]

FUSION SG-TW10 Signature Component Tweeter



Product Information

Specifications

- Product Name: SG-TW10 SIGNATURE SERIES COMPONENT TWEETER
- Designed for high-frequency music detail in Fusion Signature Series speakers
- Compatible with specific DSP-enabled stereos rated at 2 Ohm stable (per channel)
- Includes a terminated 2 m (6.5 ft.) cable for each speaker

Important Safety Information

WARNING

See the Important Safety and Product Information guide in the product box for product warnings and other important information.

This device must be installed according to these instructions.

Disconnect the vessel's power supply before beginning to install this device.

CAUTION

Continuous exposure to sound pressure levels over 100 dBA may cause permanent hearing loss. The volume is typically too loud if you cannot hear people speaking around you. Limit the amount of time you listen at high volume. If you experience ringing in your ears or muffled speech, stop listening and have your hearing checked. To avoid possible personal injury, always wear safety goggles, ear protection, and a dust mask when drilling, cutting, or sanding.

NOTICE

When drilling or cutting, always check what is on the opposite side of the surface to avoid damaging the vessel. It is strongly recommended that you have your audio system installed by a professional installer to ensure optimum performance.

You must read all installation instructions before beginning the installation. If you experience difficulty during the installation, go to support.garmin.com for product support.

After installing an audio system, you should run the connected speakers and subwoofers at low to medium volumes for the first few hours of use. This helps to improve the overall sound by gradually loosening up the moving components of new speakers and subwoofers, such as the cone, spider, and surround.

Tools Needed

- Electric drill
- Drill bit (size varies based on surface material)
- 51 mm (2 in.) hole saw
- Phillips screwdriver
- Wire strippers
- 16 AWG (1.3 through 1.5 mm²) or larger marine-grade, fully-tinned copper speaker wire (optional¹) If needed, you can purchase this wire from your Fusion® or Garmin® dealer:
 - 010-12899-00: 7.62 m (25 ft.)
 - 010-12899-10: 15.24 m (50 ft.)
 - 010-12899-20: 100m (328 ft.)
- Solder and water-tight heat shrink tubing or water-tight, heat-shrink, butt-splice connectors (optional)
- Marine sealant (optional)

NOTE: For customized installations, additional tools and materials may be needed.

Mounting Considerations

This component tweeter is designed to fill in high-frequency music detail in your system when you install Fusion Signature Series speakers in a low area on the boat.

NOTICE

This product is compatible only with Fusion Signature Series speakers and with specific DSP-enabled stereos rated at 2 Ohm stable (per channel). You must confirm that this product is compatible with your speakers and stereo before installing, because installing this product with an incompatible speaker or stereo may result in damage. Check with your local Fusion dealer or go to garmin.com for compatibility information.

NOTE: You should connect, configure, and listen to the tweeters to confirm their ideal placement before cutting any mounting holes in your vessel (Configuring the Tweeter Speakers, page 5).
Selecting the correct mounting location is critical to optimize the performance of each tweeter.

- You should place the tweeters as close as possible to the paired Fusion Signature Series speakers, and high enough that the high-frequency sounds are heard and a sound stage effect is achieved.
- You should select mounting locations that enable you to hear sound from all speakers and tweeters at the same time to achieve a sound stage effect. To achieve this effect, you should not mount the speakers side-by-side.
- You must select mounting locations that provide sufficient clearance for the mounting depth of the tweeters as specified in the product specifications.
- You should select a flat mounting surface for the best seal.
- You should protect the speaker wires from sharp objects and always use rubber grommets when wiring through panels.
- You should select mounting locations that avoid potential obstacles, such as fuel and hydraulic lines and wiring.
- To avoid interference with a magnetic compass, you should not mount the tweeters closer to a compass than the compass-safe distance value listed in the product specifications.

NOTICE

You should protect all terminals and connections from grounding and from each other. Failure to do so could result in permanent damage to the audio system and void the product warranty.

You must turn off the audio system before making any connections to the source unit, amplifier, or speakers. Failure to do so could result in permanent damage to the audio system.

Mounting the Tweeter Speakers

Before mounting the tweeters, you must choose a location following the guidelines above.

Before cutting the mounting surface you should verify that there is enough clearance for the tweeter behind the surface. Refer to the specifications for clearance information.

1. Mark the center location of the tweeter on the mounting surface.
2. Using a 51 mm (2 in.) hole saw, cut the hole for the tweeter.
3. Place the tweeter in the hole to test the fit.
4. If necessary, use a file and sandpaper to refine the size of the hole.
5. After the tweeter fits correctly in the hole, mark the mounting holes for the tweeter on the surface.
6. Remove the tweeter from the hole.
7. Using an appropriately sized drill bit for the mounting surface and screw type, drill the pilot holes.

NOTICE

Do not drill the pilot holes through the holes on the tweeter. Drilling through the tweeter may damage it.

8. Route the speaker wires on the included 2 m (6.5 ft.) cable through the hole and connect it to the paired speaker and the stereo (Speaker Connections, page 4).

NOTE: Avoid routing the speaker wire near sources of electrical interference.

9. Connect the speaker wires the included 2 m (6.5 ft.) cable.

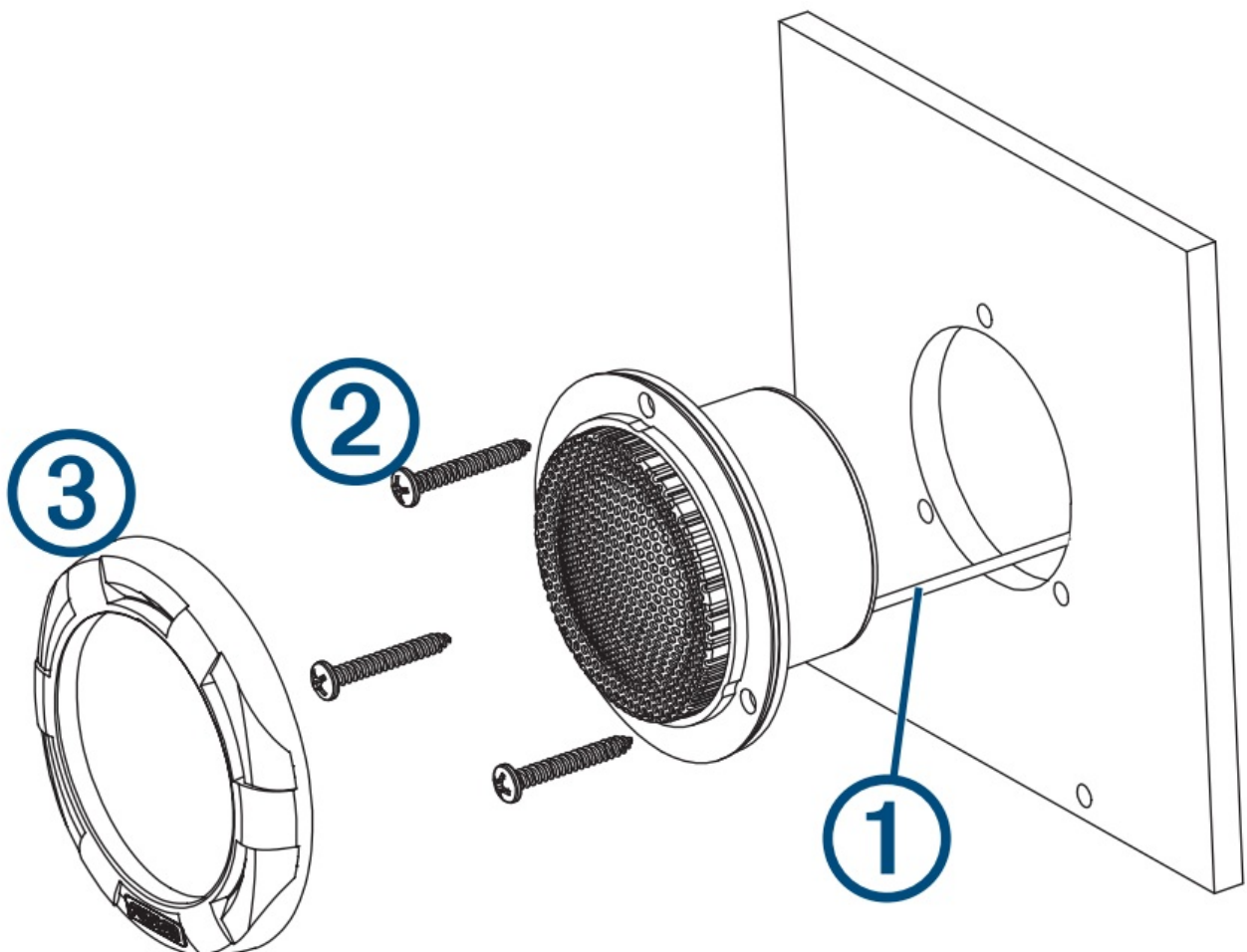

10. Place the tweeter in the cutout.

11. Test the tweeter to make sure it plays music correctly.
12. Secure the tweeter to the mounting surface using the included screws .

NOTE: Do not over tighten the screws, especially if the mounting surface is not flat.

13. Push the bezel onto the tweeter front until it snaps in place.

NOTE: The bezel attaches securely to the tweeter when you snap it in place. You should test the tweeter for correct operation before attaching the bezel.

Speaker Connections

These component tweeters are designed for use with Fusion Signature Series speakers.

The tweeter contains an internal passive crossover, and no additional crossover module is required. You must connect the speaker wire from the stereo to the same wires as the Fusion Signature Series speaker using the included 2 m (6.5 ft) cable. You should use 16 AWG (1.3 through 1.5 mm²) or larger speaker wire if an extension is required.

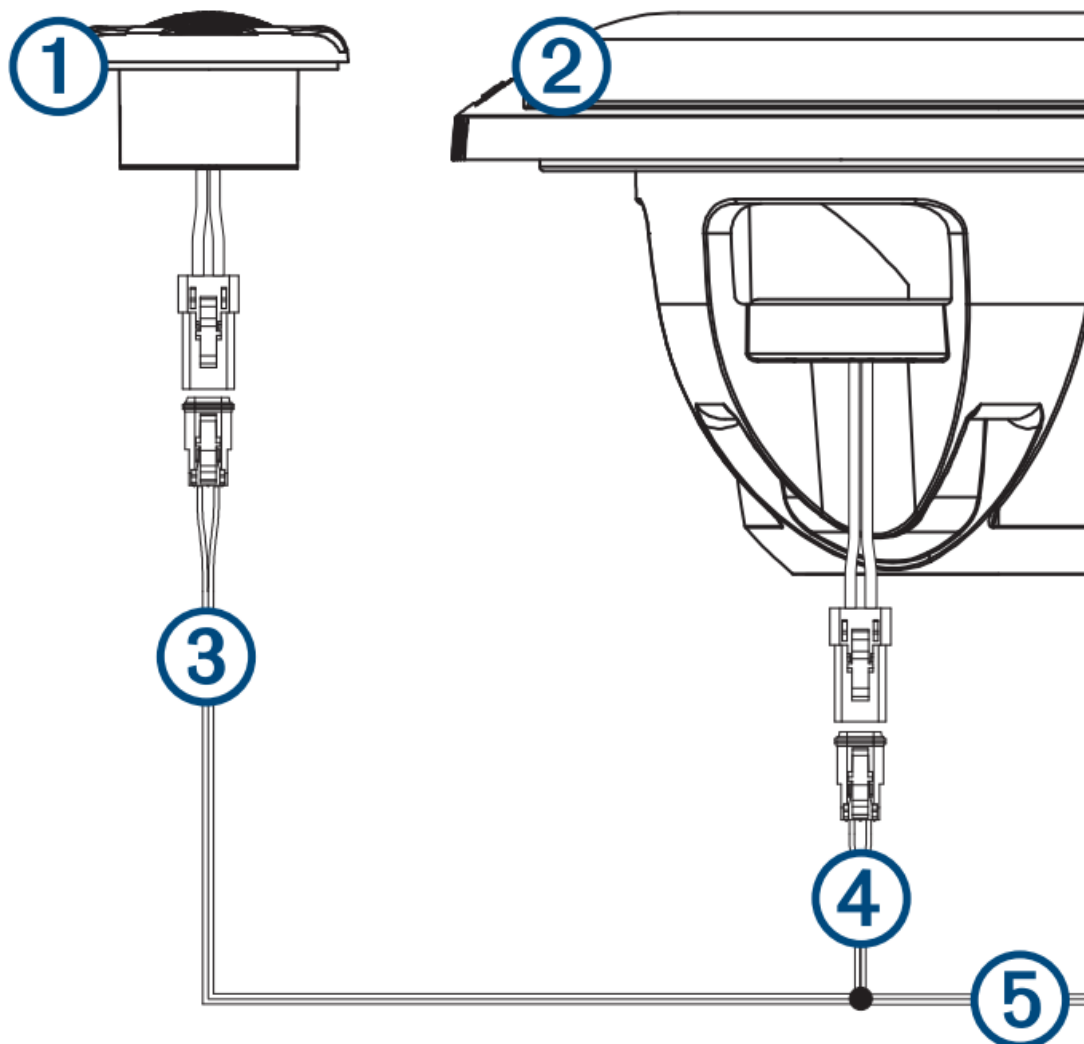

1	SG-TW10 Component Tweeter
2	Fusion Signature Series speaker
3	2 m (6.5 ft) cable (included with the SG-TW10 Component Tweeter)
4	Speaker wire harness (included with the Fusion Signature Series speaker)
5	Speaker wire from the stereo (not included)

You should use a water-tight connection method when connecting the wires from the speakers to the stereo.

Wire Strain Relief

NOTICE

Failure to secure the wiring-harness connections can damage the speaker.

The wires connected to the speaker and the included wiring harness use Amphenol™ AT Series™ connectors, and these connectors must be secured during installation to provide strain relief for the internal wire connections to the speaker. You can secure these connections using various methods.

- You can use cable ties or other third-party fastening devices to secure the connection to an appropriate location.
- You can use the various Amphenol A Series™ clips produced by Amphenol to secure the connection. You can check with your local electronics or marine dealer, or go to the Amphenol-Sine website for more information.

Configuring the Tweeter Speakers

For proper performance, you must configure the DSP profile on your stereo for the tweeters.

1. After you connect the tweeters to the Fusion Signature Series speakers, turn on your DSP-capable stereo.
2. Using the Fusion-Link™ remote control app, open the DSP settings for the stereo.
3. Select the DSP profile for the Fusion Signature Series speakers and tweeter, and apply it to the stereo.
4. If necessary, fine tune the tweeter output by adjusting the treble from the tone settings on the stereo. See the owner's manual for your stereo for more details on adjusting the tone settings.

Speaker Information

True-Marine™ Products

True-Marine products are subjected to rigorous environmental testing under harsh marine conditions to surpass industry guidelines for marine products.

Any product that bears the True-Marine stamp of assurance has been designed for simplicity of use and combines advanced marine technologies to deliver an industry leading entertainment experience. All True-Marine products are supported by the Fusion 3-year worldwide limited consumer warranty.

Cleaning the Speakers

NOTE: When mounted correctly, these speakers are rated IP65 for dust and water ingress protection under normal conditions. They are not designed to withstand high pressure water spray, which may occur when you wash down your vessel. Failure to carefully spray-clean the vessel may damage the product and void the warranty.

NOTICE

Do not use harsh or solvent-based cleaners on the speakers. Using such cleaners may damage the product and void the warranty.

1. Clean all salt water and salt residue from the speaker with a damp cloth soaked in fresh water.
2. Use a mild detergent to remove a heavy buildup of salt or stains.

Troubleshooting

Before you contact your Fusion dealer or service center, you should perform a few simple troubleshooting steps to help diagnose the problem.

If the Fusion speaker has been installed by a professional installation company, you should contact the company so the technicians can assess the problem and advise you about possible solutions.

There is no sound coming from the speakers

Verify that all connections from the source device and/or the amplifier are connected correctly to the speaker terminals.

The audio is distorted

- Verify that the source volume is not too loud for the speaker, and reduce the volume if necessary.
- Verify that the panels surrounding the speaker on the vessel are not rattling.
- Verify that the source device and/or the amplifier are connected to the speaker terminals correctly.
- If the speaker is connected to an amplifier, verify that the input level of the amplifier is matched to the output level of the stereo. For more information, see the manual for the amplifier.

Specifications

Max. power (Watts)	330 W
RMS power (Watts)	60 W
Efficiency (1 W/1 m)	91 dB
Frequency response	3 kHz to 20 kHz
Impedance	4 Ohm nominal
Impedance when connected to a Fusion Signature Series speaker	2 Ohm nominal
Recommended amplifier power (RMS)	From 25 to 140 W per channel
Diaphragm material	Aluminum (hard dome)
Min. mounting depth (clearance)	31 mm (1 1/4 in.)
Mounting diameter (clearance)	51 mm (2 in.)
Compass-safe distance	110 cm (3 ft. 7 1/4 in.)
Operating temperature range	From 0 to 50°C (from 32 to 122°F)
Storage temperature range	From -20 to 70°C (from -4 to 158°F)
Ingress protection rating	IEC 60529 IP65 (protected against dust and water ingress)
Wiring connector type	Amphenol AT Series AT 2-way

Dimension Drawings

Side View

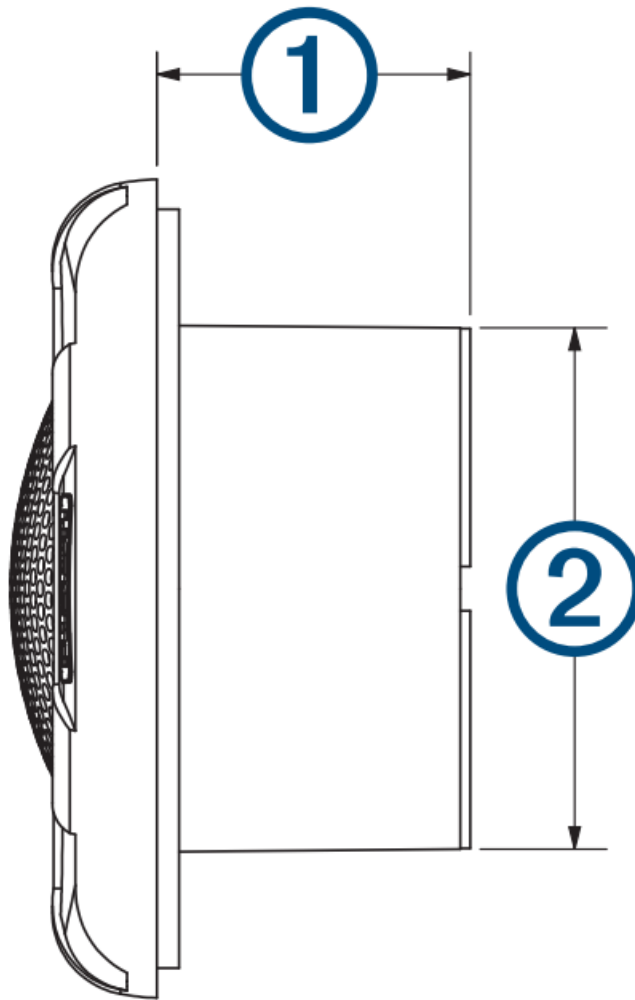

1	28 mm (1 1/8 in.)
2	47 mm (1 7/8 in.)

Front View

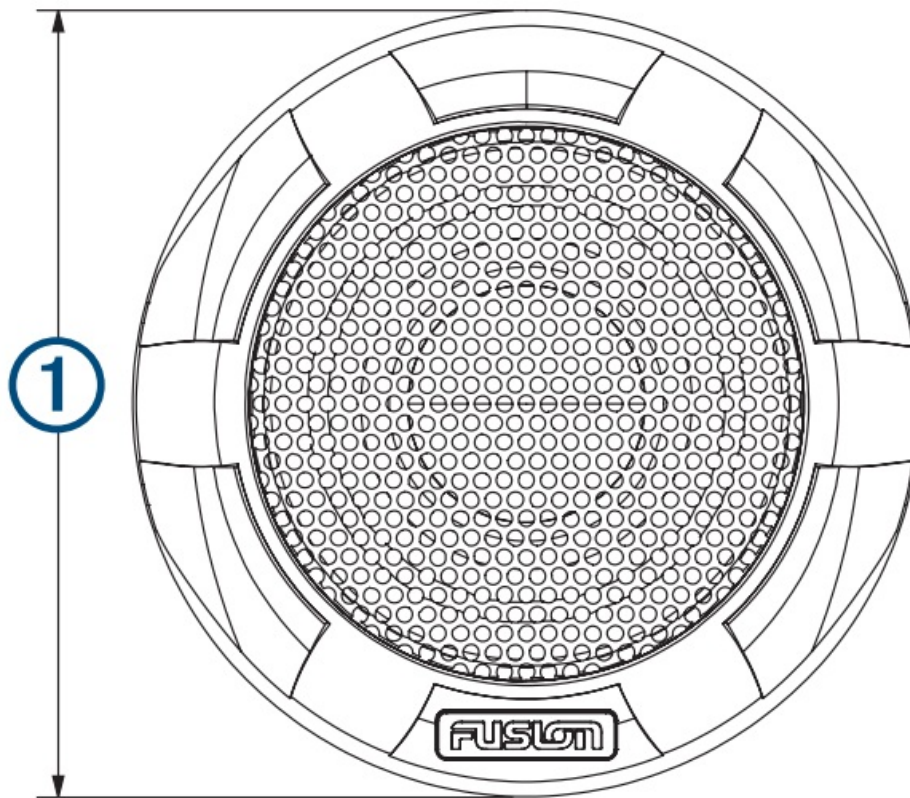

1. 74 mm (2 15/16 in.)

© 2022 Garmin Ltd. or its subsidiaries
support.garmin.com

FAQ

Q: What should I do if I experience difficulty during installation?

A: Visit support.garmin.com for product support if you encounter any challenges during installation.

Q: How should I protect the speaker wires during installation?

A: Ensure that all terminals and connections are shielded from grounding and each other to prevent damage to the audio system and avoid voiding the product warranty.

Documents / Resources

	<p>FUSION SG-TW10 Signature Component Tweeter [pdf] Instruction Manual SG-TW10 Signature Component Tweeter, SG-TW10, Signature Component Tweeter, Component Tweeter</p>
--	------------------------------------------------------------------------------------------------------------------------------------------------------------------------------------------------------

References

- ▲ [Garmin Official Site](#)
- ▲ [Garmin | Australia | Support Center](#)
- ▲ [Garmin Official Site](#)

- [User Manual](#)

[Manuals+](#), [Privacy Policy](#)

This website is an independent publication and is neither affiliated with nor endorsed by any of the trademark owners. The "Bluetooth®" word mark and logos are registered trademarks owned by Bluetooth SIG, Inc. The "Wi-Fi®" word mark and logos are registered trademarks owned by the Wi-Fi Alliance. Any use of these marks on this website does not imply any affiliation with or endorsement.